

TOWN HWY. No.	LENGTH IN MILES CLASS 3	CLASS 4
8	1.90	
9	3.27	
10	0.30	
11	1.25	
12	0.48	
13	1.55	
15	2.45	
16	0.52	(0.26)
17	0.86	
18	0.12	
19	2.30	
20	0.02	
21	0.46	(0.19)
22	0.70	
23	0.59	(0.26)
24	0.08	
25	0.93	(0.18)
26	0.70	(0.83)
27	0.36	
28	1.36	
29	0.90	
30	0.05	
31	0.75	
32	0.59	
33	1.65	
34	1.00	
35	1.87	
36	0.10	
37		(0.15)
39		(0.05)
40	0.10	
41	0.05	
42	0.08	
43	0.04	
44	0.06	
45	0.15	
47	0.12	
48	0.03	
49	0.30	
50	0.18	
51	0.15	
52	0.74	
53	0.54	
54	0.21	
55	0.56	
56	0.26	
57	1.09	
58	0.80	
59	0.87	
60	0.25	
61	0.15	
62	0.06	
63	0.61	
64	0.30	
65	0.02	
66	0.08	
67	0.43	
68	0.17	
69	0.20	
70	0.16	
71	0.12	
72	0.60	
73	0.12	
75	0.21	
76	0.50	
77	0.20	
78	0.26	
79	0.64	
80	0.28	
81	0.32	
82	0.05	
83	0.06	
84	0.19	
85	0.14	
86	0.11	
87	0.33	
88	0.16	
89	0.39	
90	0.16	
91	0.28	
92	0.10	
93	0.30	
94	0.09	
95	0.16	
TOTAL	41.64	1.92

MILEAGE SUMMARY

CLASS 2	6.110
TH-1	3.110
TH-2	4.490
TH-3	1.750
TH-4	0.430
TH-5	3.120
TH-6	1.490
TH-7	
TOTAL CLASS 2	20.500
CLASS 2 - Ramps	0.020
TH-1	0.020
TOTAL CLASS 2 - Ramps	0.020
CLASS 3	
TOTAL CLASS 3	41.64
TOTAL TOWN	62.160
STATE HIGHWAY	
VT-15	3.787
VT-117	2.893
TOTAL STATE HIGHWAY	6.680
TOTAL STATE	6.680

TOTAL, TRAVELED HIGHWAYS, FEB. 10, 2026: 68.840 (Excludes Class 4 and Legal Trail Mileage)

TOWN HWY. No. LENGTH IN MILES "NOT UP TO STANDARD"

26	(0.12)
31	(0.41)
48	(0.02)
65	(0.45)
TOTAL	1.00

\*The sections of the town highways listed above are legally Class 3, but have been deemed "Not Up To Standard" and are functionally Class 4 Town Highways

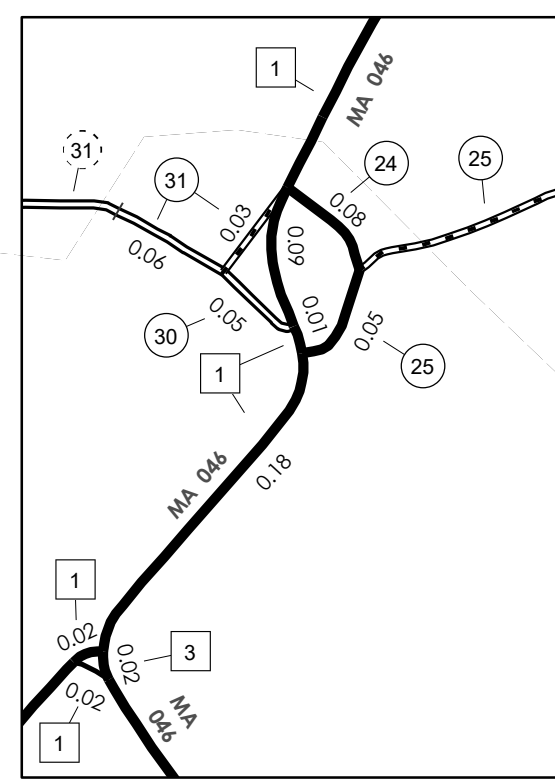

INSET 2 SCALE 1:6,336

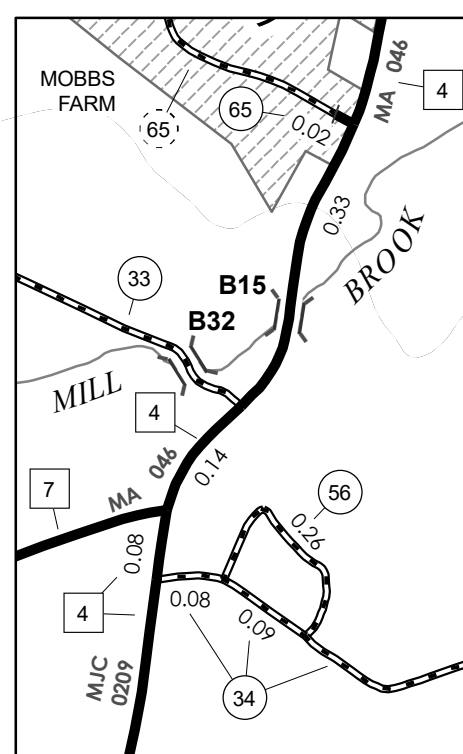

INSET 3 SCALE 1:12,672

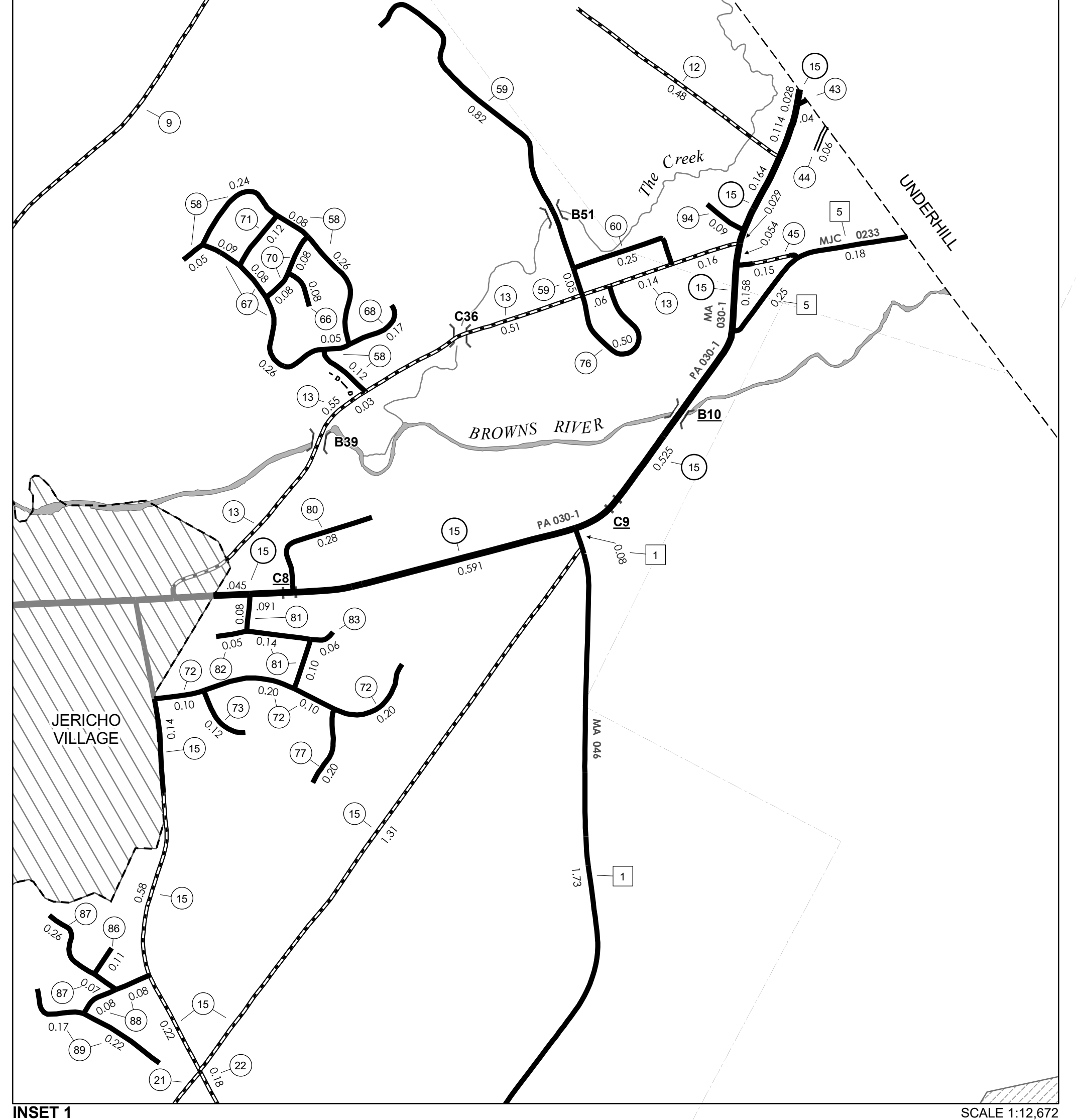
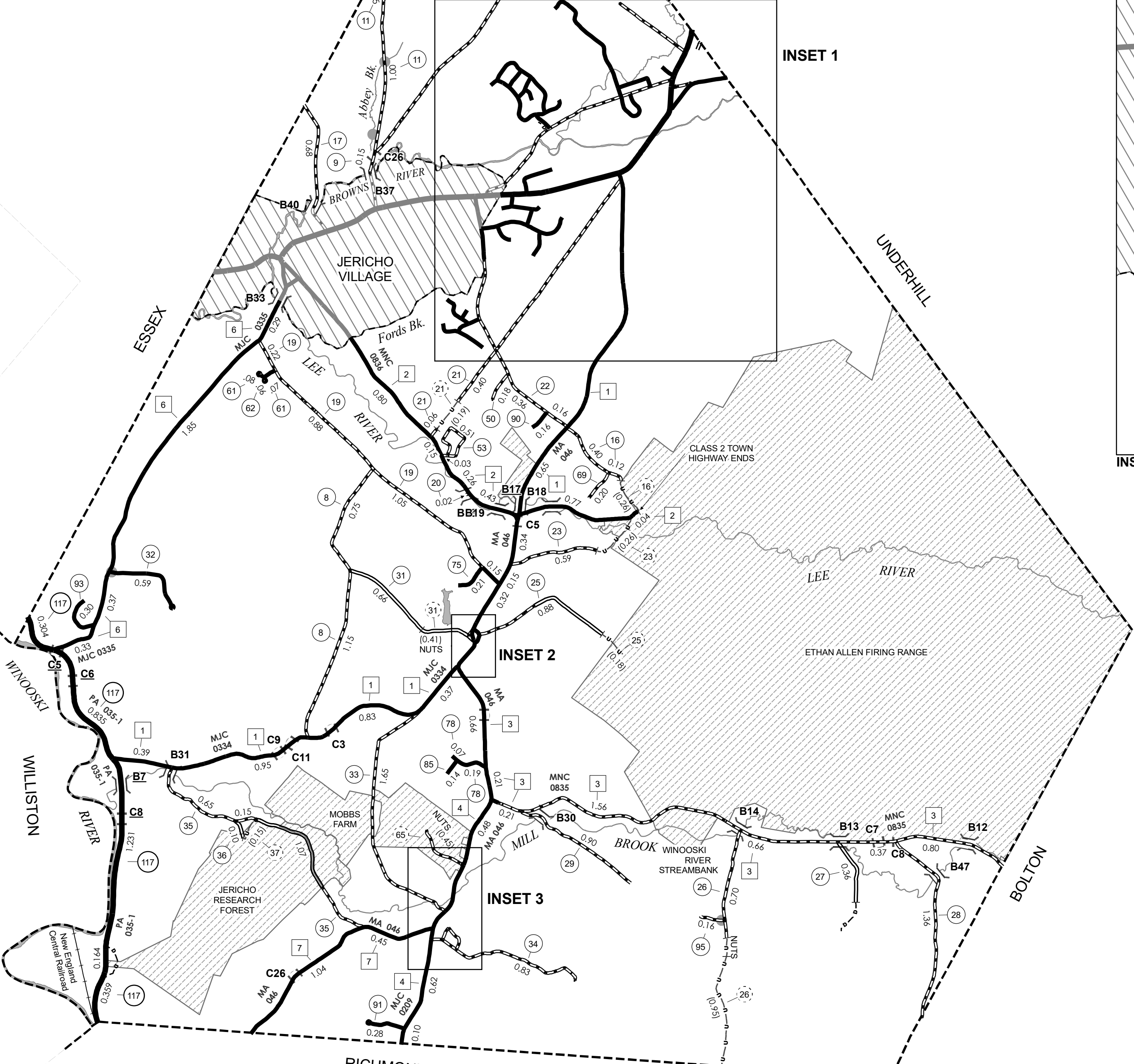

INSET 1 SCALE 1:12,672

0 0.15 0.3 Miles

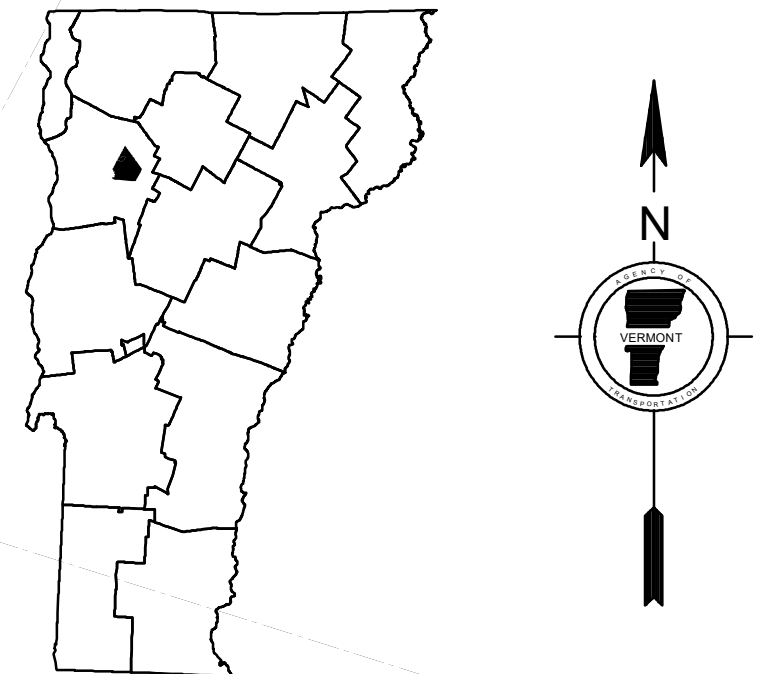

VERMONT GENERAL HIGHWAY MAP Town of Jericho CHITTENDEN COUNTY

Transportation District #5 Prepared by the Vermont Agency of Transportation Highway Division in cooperation with U.S. Department of Transportation Federal Highway Administration

Mileage as of February 10, 2026 Map prepared May 27, 2026

SCALE 1:31,680

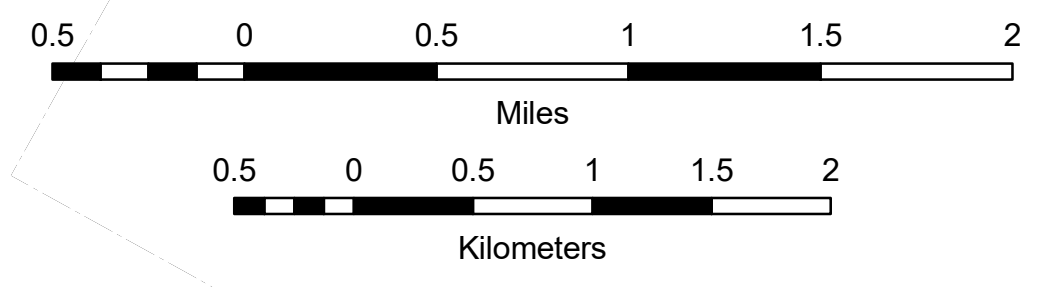

- HIGHWAYS**
  - INTERSTATE
  - U.S. ROUTE
  - STATE ROUTE
  - CLASS 1
  - CLASS 2
  - CLASS 3
  - CLASS 4
  - LEGAL TRAIL
  - PARK AND RIDE
- INTERSTATE OR DIVIDED HIGHWAY
- STATE - HARD SURFACE OR PAVED
- TOWN - HARD SURFACE OR PAVED
- GRAVEL
- SOIL OR GRADED AND DRAINED EARTH
- UNIMPROVED OR PRIMITIVE
- IMPASSABLE OR UNTRAVELED
- LEGAL TRAIL
- DISCONTINUED
- HIGHWAY CLASS CHANGE
- RAILROAD
- INACTIVE RAILROAD
- PUBLIC LAND - NATIONAL FOREST
- PUBLIC LAND - STATE/MUNICIPAL
- NFR NATIONAL FOREST ROAD
- ACE ARMY CORPS OF ENGINEERS
- USGH UNITED STATES GOV. HWY.

- POLITICAL SUBDIVISIONS**
  - STATE BOUNDARY
  - COUNTY BOUNDARY
  - TOWN BOUNDARY
  - VILLAGE BOUNDARY
  - URBAN COMPACT BOUNDARY
  - WATER BODY
  - STREAM OR BROOK
- BRIDGE OR CULVERT**
  - BRIDGE OR CULVERT > 20'
  - BRIDGE OR CULVERT 6' - 20'
  - BIKE PATH STRUCTURE
  - VT CULVERTS BRIDGE
  - VT CULVERTS CULVERT > 6'
- FEDERAL CLASSIFICATION IDENTIFIER**
  - MA MINOR ARTERIAL
  - MJC MAJOR COLLECTOR
  - MNC MINOR COLLECTOR
  - PA PRINCIPAL ARTERIAL
- B34 / C34 STATE BRIDGE OR CULVERT IDENTIFIER**
- B34 / C34 TOWN BRIDGE OR CULVERT IDENTIFIER**

Vermont State Plane Coordinate System North American Datum of 1983 SPCS\_Zone\_Identifier: 4400 Geodetic Reference System 80 4,000-meter grid, Easting - Northing

DISCLAIMER: The untraveled highways (laid-out town highways), discontinued highways, and legal trails herein are those of which the Agency of Transportation has record; others may exist. Highway and bridge data by the Agency of Transportation. Town short structures drawn from the VTCULVERTS (formerly VOBICIT) online database. All other data from the Vermont Open Geodata Portal. Only named streams shown. Accessibility Statement: The Agency of Transportation is committed to ensuring accessibility and digital accessibility for all. If you need language assistance, reasonable accommodation, or alternative format, please email johnathan.croft@vermont.gov.