

TOWN HWY. No.	LENGTH IN MILES CLASS 3	CLASS 4
8	1.90	
9	3.27	
10	0.30	
11	1.25	
12	0.48	
13	1.55	
15	2.45	(0.26)
16	0.52	
17	0.86	
18	0.12	
19	2.30	
20	0.02	
21	0.46	(0.19)
22	0.70	
23	0.59	(0.26)
24	0.08	
25	0.93	(0.18)
26	0.70	(0.83)
27	0.36	
28	1.36	
29	0.90	
30	0.05	
31	0.75	
32	0.59	
33	1.65	
34	1.00	
35	1.87	
36	0.10	
37		(0.15)
39		(0.05)
40	0.10	
41	0.05	
42	0.08	
43	0.04	
44	0.06	
45	0.15	
47	0.12	
48	0.03	
49	0.30	
50	0.18	
51	0.15	
52	0.74	
53	0.54	
54	0.21	
55	0.56	
56	0.26	
57	1.09	
58	0.80	
59	0.87	
60	0.25	
61	0.15	
62	0.06	
63	0.61	
64	0.30	
65	0.02	
66	0.08	
67	0.43	
68	0.17	
69	0.20	
70	0.16	
71	0.12	
72	0.60	
73	0.12	
75	0.21	
76	0.50	
77	0.20	
78	0.26	
79	0.64	
80	0.28	
81	0.32	
82	0.05	
83	0.06	
84	0.19	
85	0.14	
86	0.11	
87	0.33	
88	0.16	
89	0.39	
90	0.16	
91	0.28	
92	0.10	
93	0.30	
94	0.09	
TOTAL	41.48	1.92

**MILEAGE SUMMARY**

CLASS	LENGTH IN MILES	TOTAL
CLASS 2	6.110	20.500
CLASS 3	41.48	41.48
TOTAL CLASS 2	6.110	20.500
TOTAL CLASS 3	41.48	41.48
TOTAL TOWN	61.980	61.980
STATE HIGHWAY VT-15	3.787	3.787
VT-117	2.893	2.893
TOTAL STATE HIGHWAY	6.680	6.680
TOTAL STATE	6.680	6.680

**TOTAL TRAVELED HIGHWAYS, FEB. 10, 2015: 68.660**  
(Excludes Class 4, Legal Trail, and Unidentified Corridor Mileage)

**TOWN LENGTH IN MILES "NOT UP TO STANDARD"**

TOWN HWY. No.	LENGTH IN MILES
26	(0.12)
31	(0.41)
48	(0.02)
65	(0.45)
TOTAL	1.00

\*The sections of the town highways listed above are legally Class 3, but have been deemed "Not Up To Standard" and are functionally Class 4 Town Highways

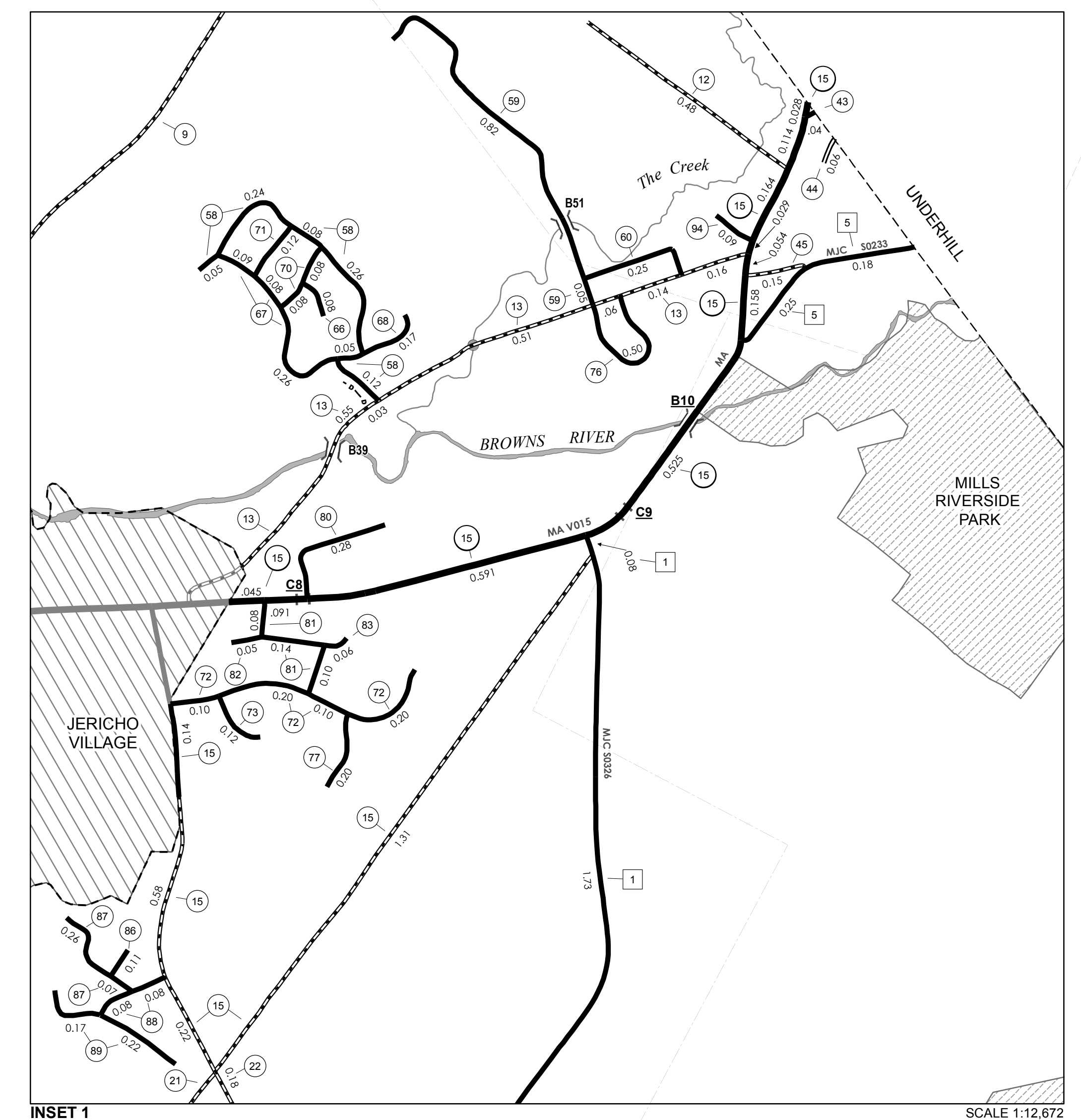
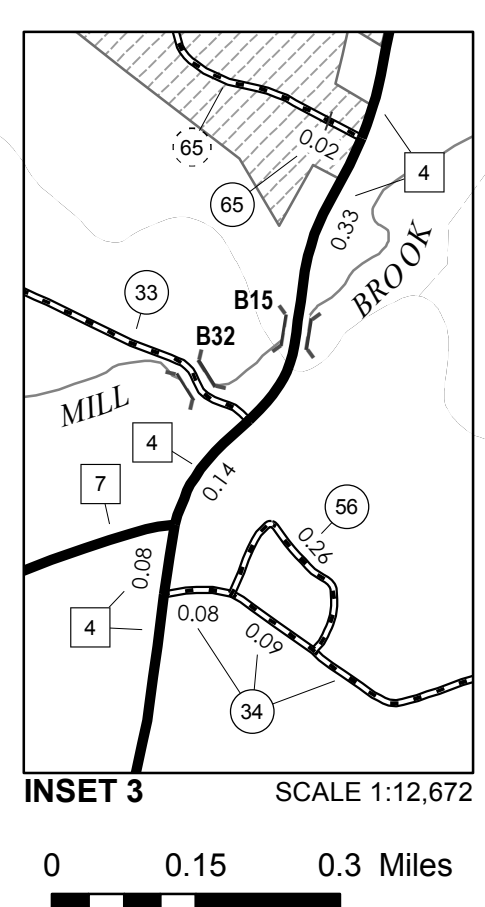
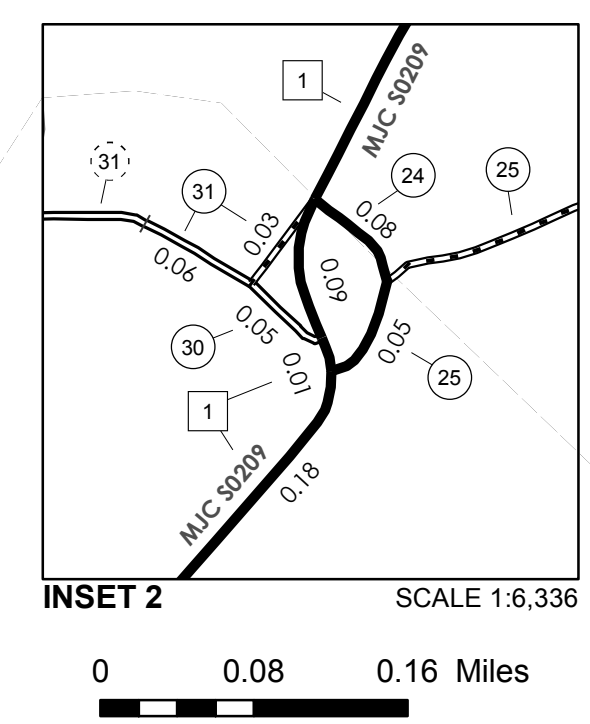

- HIGHWAYS**
- INTERSTATE
  - STATE - HARD SURFACE OR PAVED
  - TOWN - HARD SURFACE OR PAVED
  - GRAVEL
  - SOIL OR GRADED AND DRAINED EARTH
  - UNIMPROVED OR PRIMITIVE
  - IMPASSABLE OR UNTRAVELED
  - LEGAL TRAIL
  - DISCONTINUED
  - HIGHWAY CLASS CHANGE
  - RAILROAD
  - INACTIVE RAILROAD
  - NATIONAL FOREST ROAD
  - STATE FOREST HIGHWAY
  - PARK AND RIDE
- PUBLIC LAND - GREEN MOUNTAIN NATIONAL FOREST**
- PUBLIC LAND - STATE/MUNICIPAL
- POLITICAL SUBDIVISIONS**
- STATE BOUNDARY
  - COUNTY BOUNDARY
  - TOWN BOUNDARY
  - VILLAGE BOUNDARY
  - URBAN COMPACT BOUNDARY
  - WATER BODY
  - STREAM OR BROOK
- BRIDGE OR CULVERT**
- BRIDGE OR CULVERT > 20'
  - BRIDGE OR CULVERT 6' - 20'
  - VOBCIT BRIDGE
  - VOBCIT CULVERT > 6'
  - STATE BRIDGE OR CULVERT IDENTIFIER
  - TOWN BRIDGE OR CULVERT IDENTIFIER
- FEDERAL CLASSIFICATION IDENTIFIER**
- FAU - URBAN ARTERIAL OR COLLECTOR
  - MA - MINOR ARTERIAL
  - MJC - MAJOR COLLECTOR
  - MNC - MINOR COLLECTOR
  - PA - PRINCIPAL ARTERIAL

Vermont State Plane Coordinate System  
North American Datum of 1983  
SPCS\_Zone\_Identifier: 4400  
Geodetic Reference System 80  
4,000-meter grid, Easting - Northing

**DISCLAIMER:**  
The untraveled highways (laid-out town highways), discontinued highways, and legal trails hereon are those of which the Agency of Transportation has record; others may exist.

Highway and bridge data by the Agency of Transportation. Town short structures are drawn from the Vermont Online Bridge & Culvert Inventory Tool (VOBCIT) database. All other data from the Vermont Center for Geographic Information. Only named streams are shown.

**VERMONT GENERAL HIGHWAY MAP**  
**Town of Jericho**  
CHITTENDEN COUNTY  
Transportation District #5

Prepared by the  
Vermont Agency of Transportation  
Division of Policy, Planning and Intermodal Development  
in cooperation with  
U.S. Department of Transportation  
Federal Highway Administration

Mileage as of February 10, 2015  
Map prepared June 04, 2015  
SCALE 1:31,680