



MILEAGE SUMMARY

CLASS 2	6.680
TH-1	2.960
TH-2	3.440
TH-3	0.210
TH-4	0.750
TH-5	0.750
TH-6	2.030
TH-7	0.800
TH-8	2.200
TH-9	1.300
TH-10	0.140
TH-11	0.380
TH-12	0.090
TH-13	0.170
TH-14	
TOTAL CLASS 2	21.870
CLASS 3	70.13
TOTAL CLASS 3	70.13
TOTAL TOWN	92.000
STATE HIGHWAY	2.431
VT-2A	1.361
VT-15	0.142
VT-127	
TOTAL STATE HIGHWAY	3.934
US HIGHWAY	2.196
US-2	0.960
US-7	
TOTAL US HIGHWAY	9.156
TOTAL STATE	13.090
INTERSTATE	7.568
I-89	
TOTAL INTERSTATE	7.568
INTERSTATE - Ramps	2.206
I-89	
TOTAL INTERSTATE - Ramps	2.206
TOTAL INTERSTATE	9.774
TOTAL, TRAVELED HIGHWAYS, FEB. 10, 2017:	114.864

(Excludes Class 4 and Legal Trail Mileage)

TOWN LENGTH IN MILES "NOT UP TO STANDARD"

HWY No.	Length (Miles)
18	0.08
61	0.04
TOTAL	0.12

**The sections of the town highways listed above are legally Class 3, but have been deemed "Not Up To Standard" and are functionally Class 4 Town Highways*

LEGAL TRAIL LENGTH IN MILES

No.	Length (Miles)
1	0.39
2	0.09
3	0.20
TOTAL	0.68

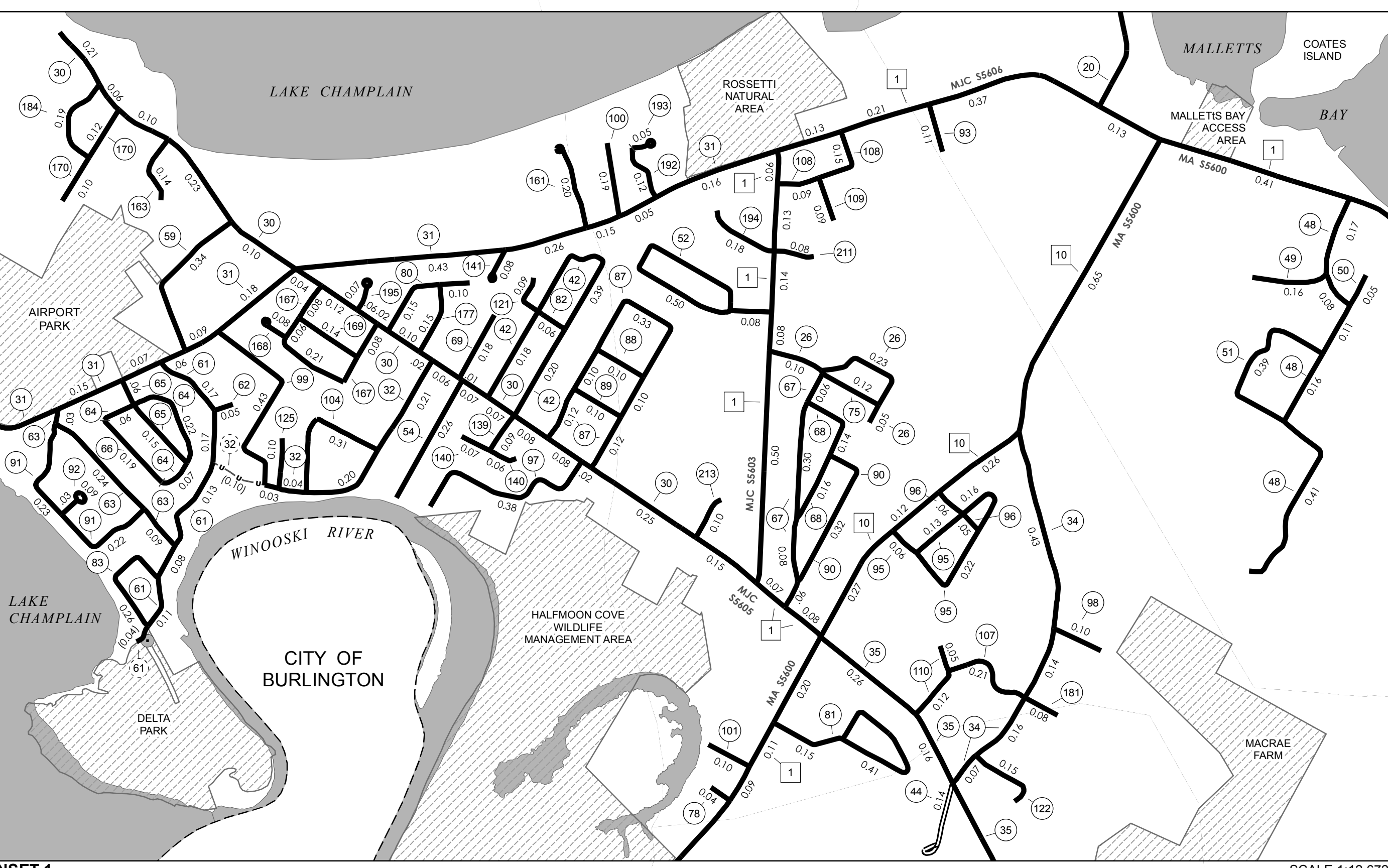
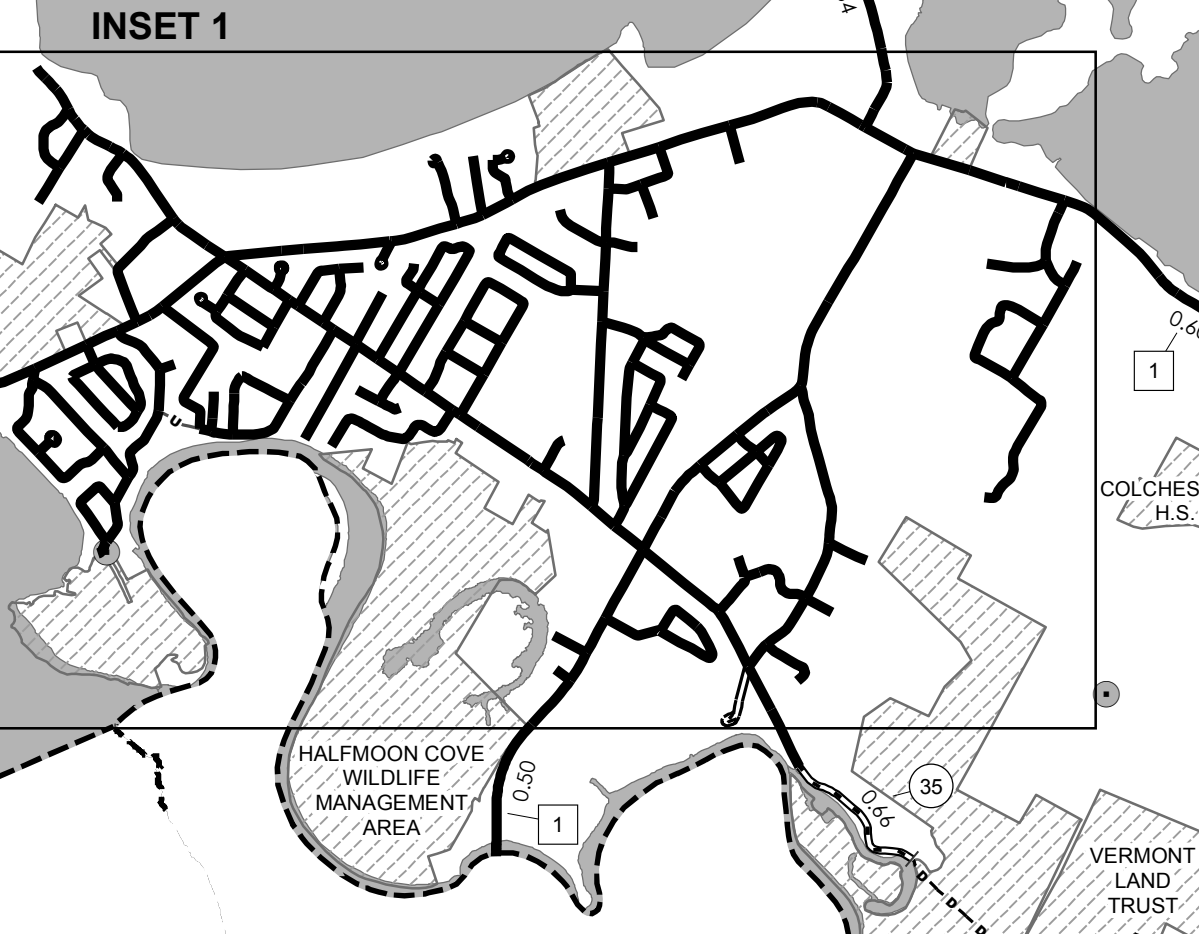
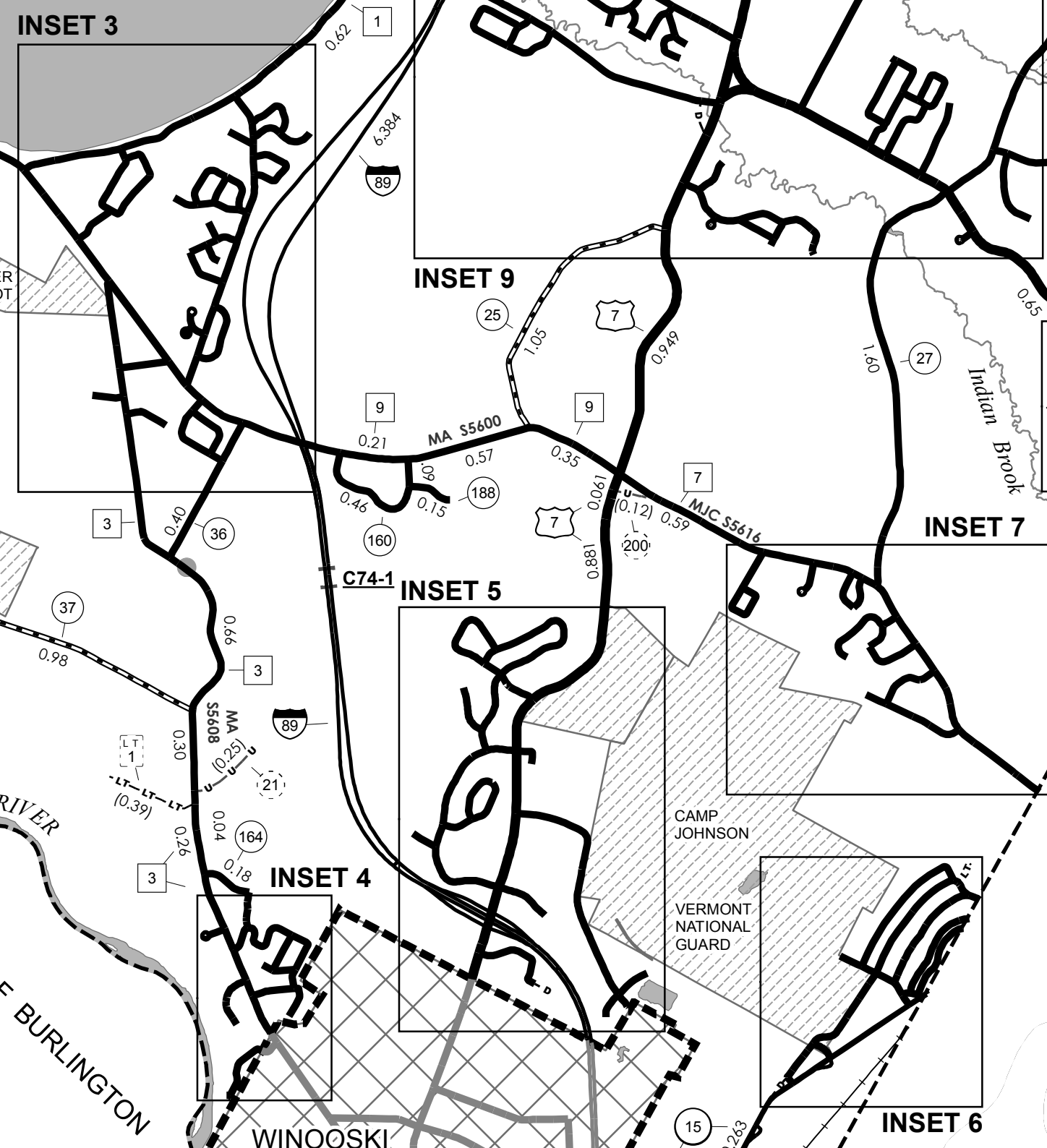
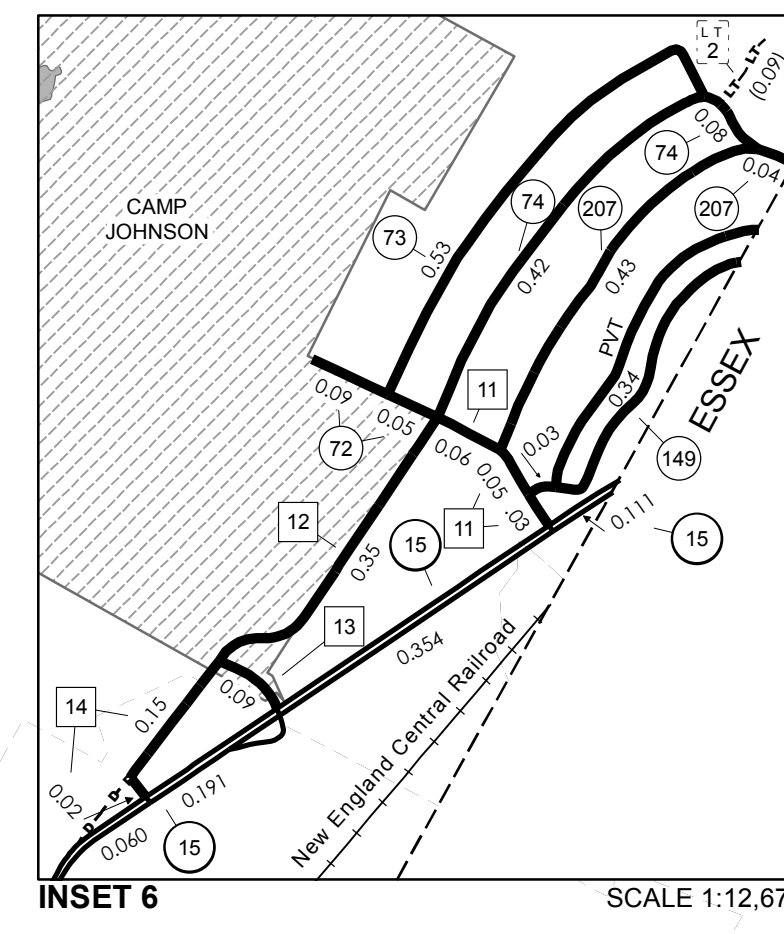
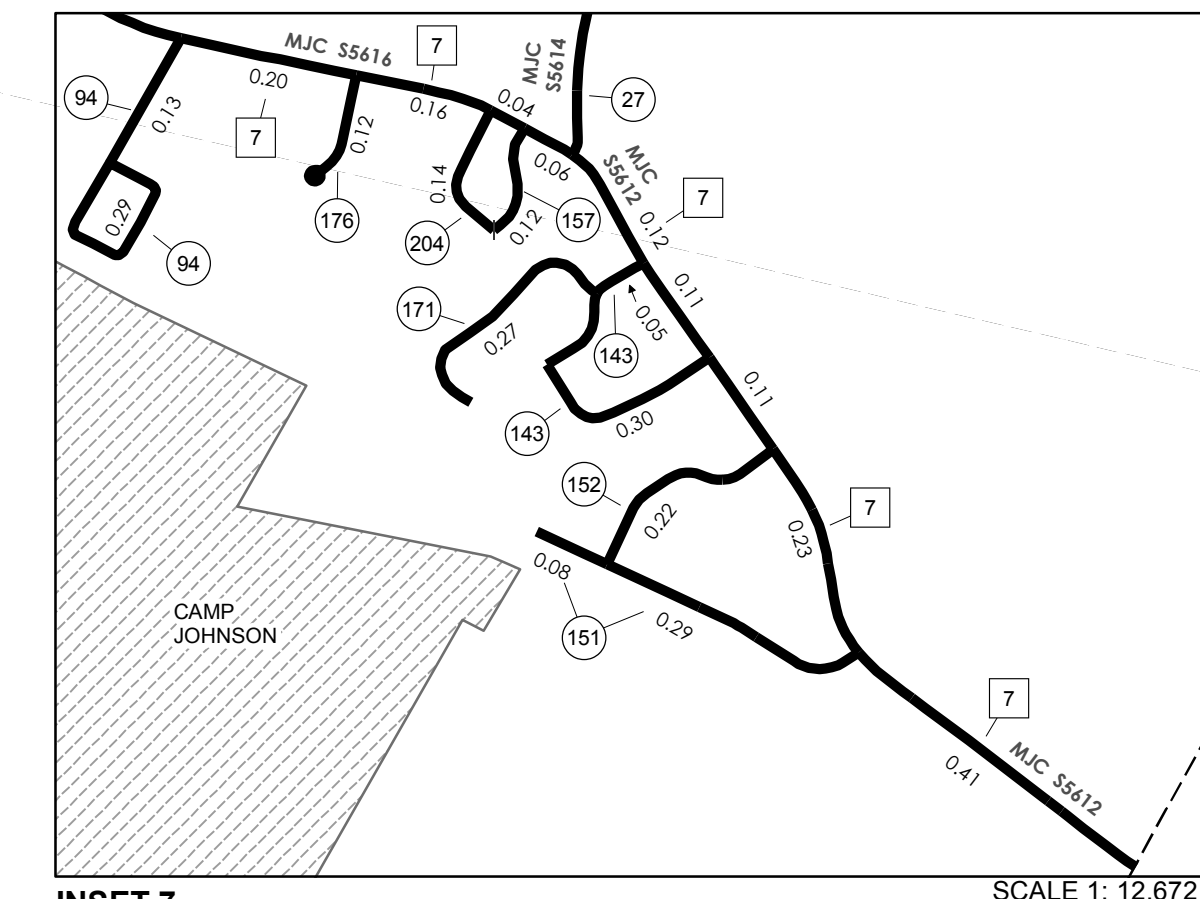
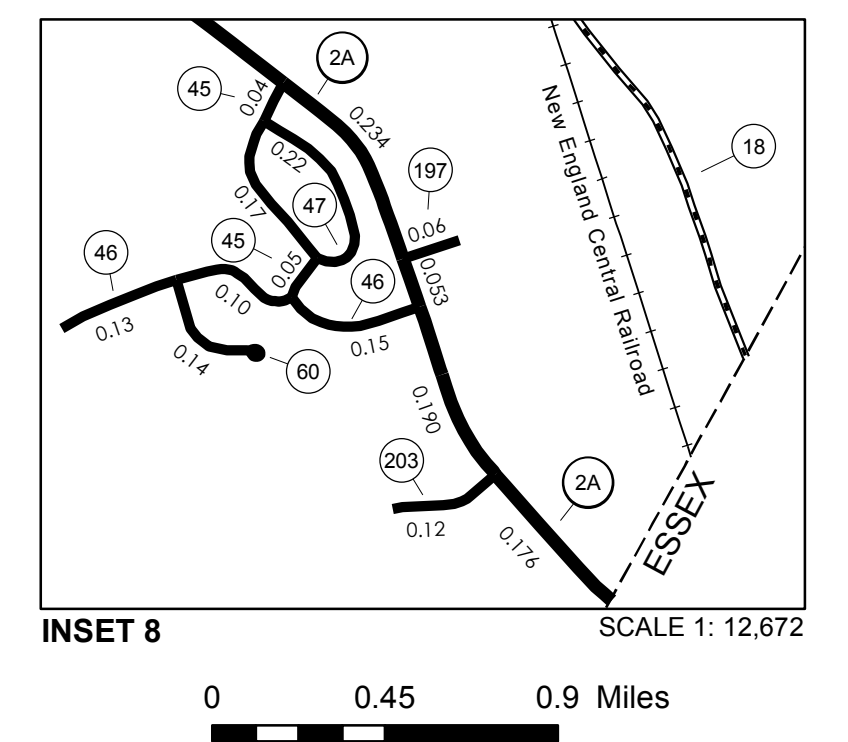
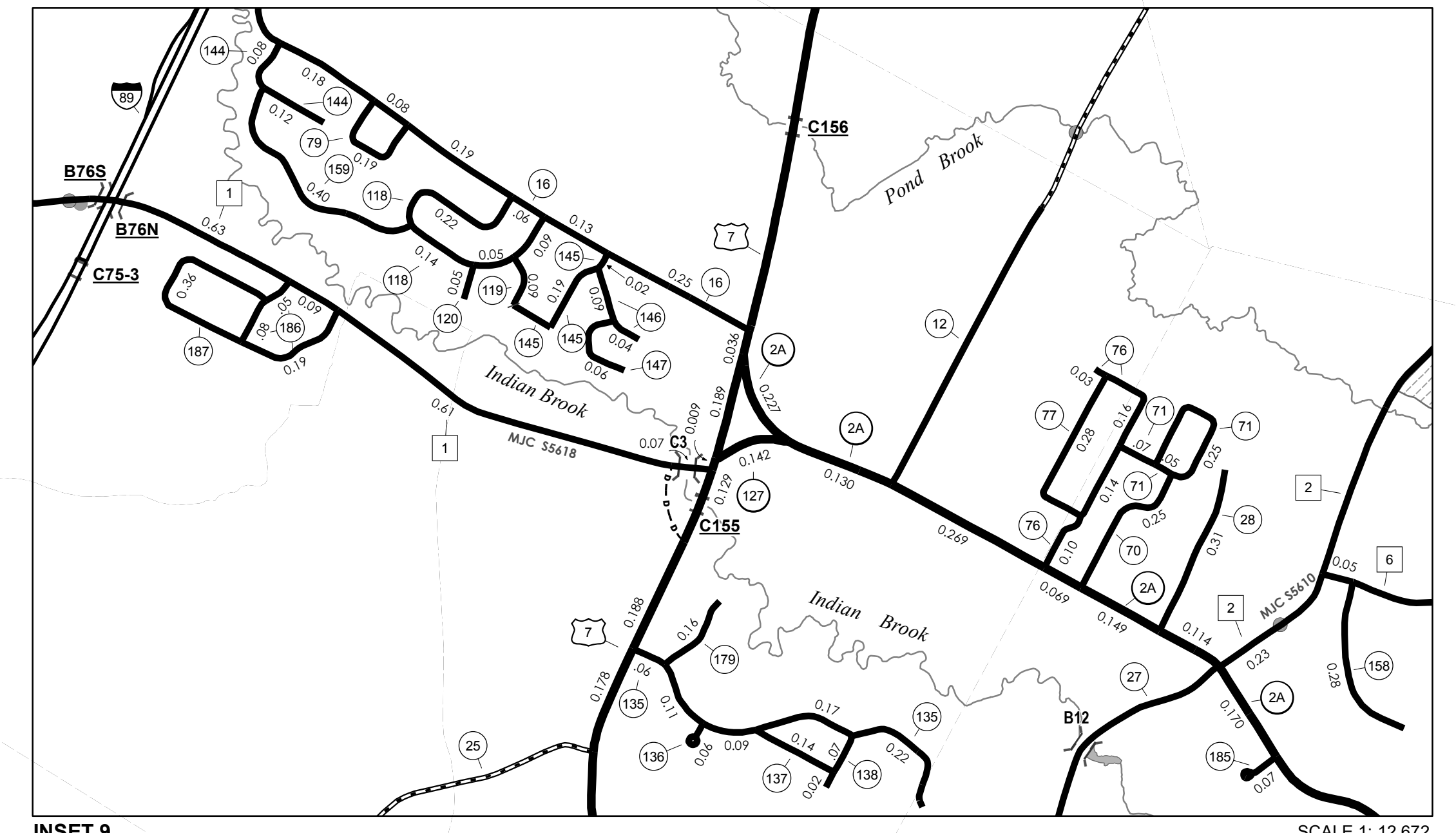
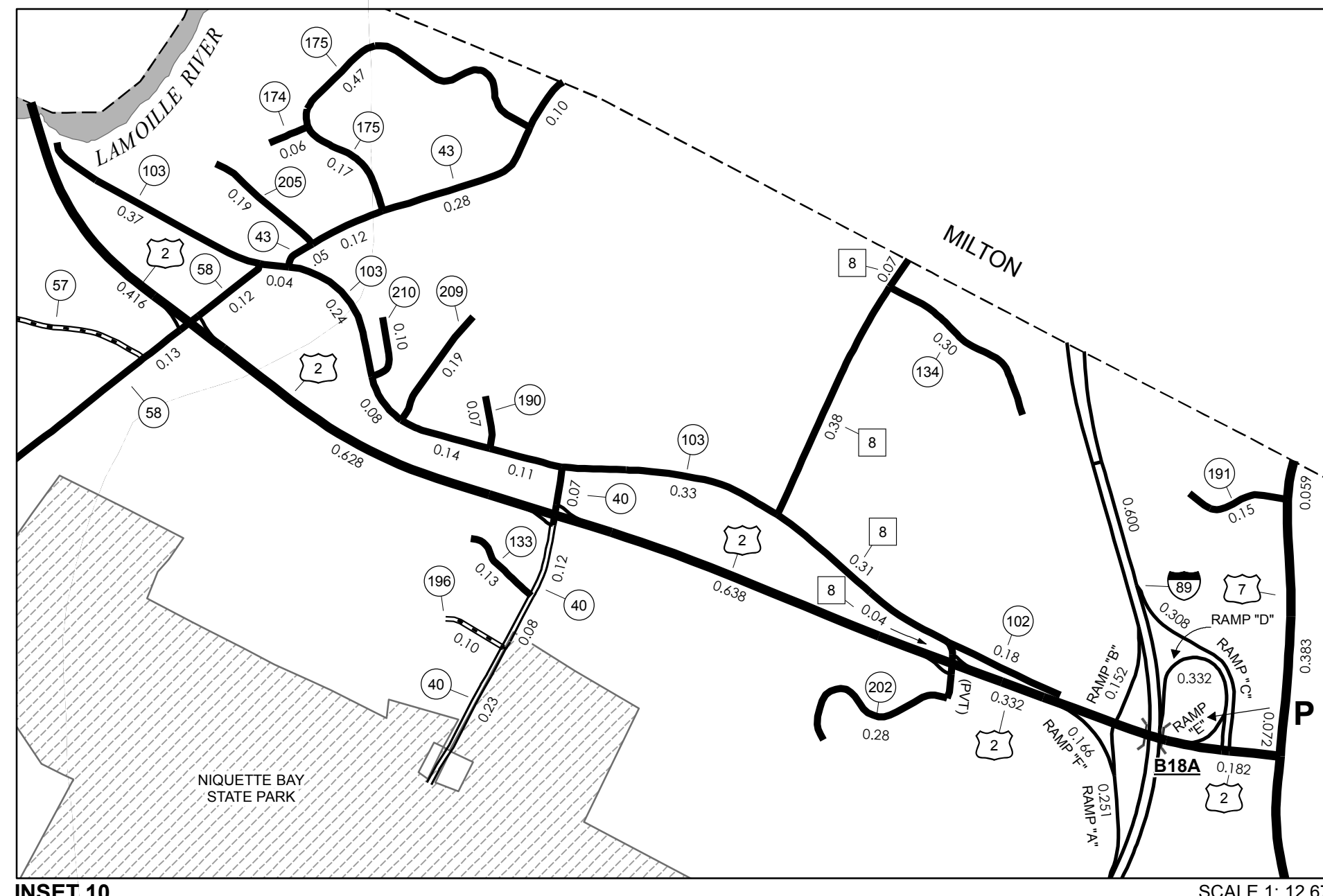
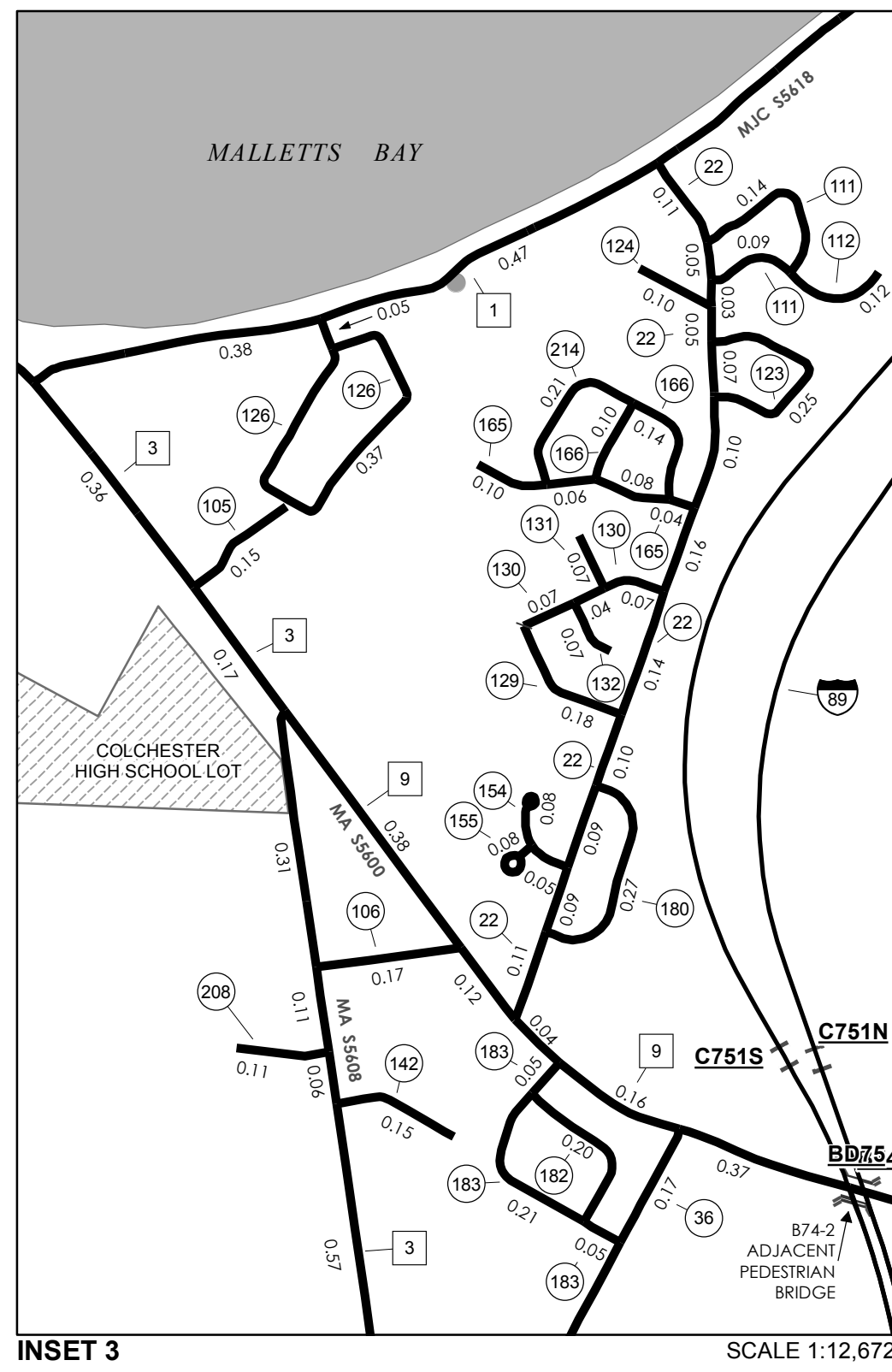
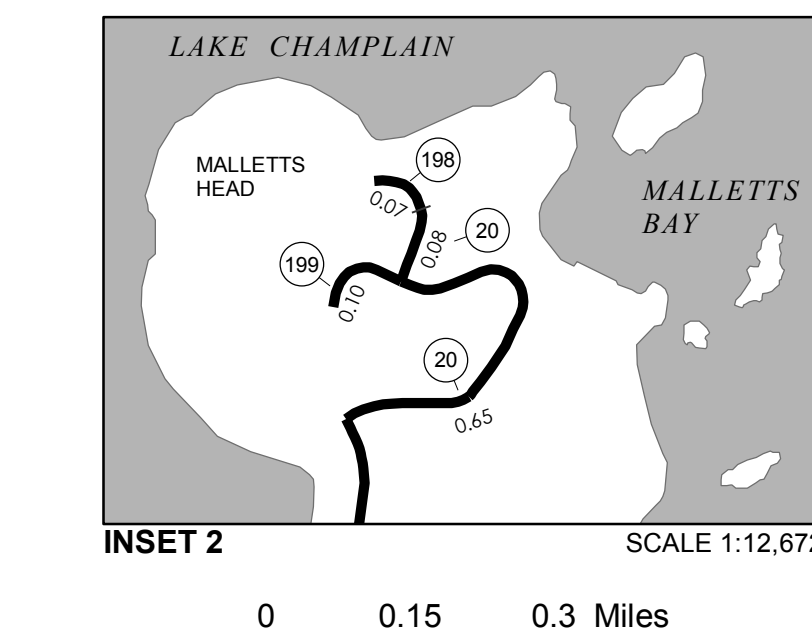

DISCLAIMER:
The untraveled highways (laid-out town highways), discontinued highways, and legal trails hereon are those of which the Agency of Transportation has record; others may exist.

Highway and bridge data by the Agency of Transportation. Town short structures are drawn from the Vermont Online Bridge & Culvert Inventory Tool (VOBCIT) database. All other data from the Vermont Center for Geographic Information. Only named streams are shown.

Vermont State Plane Coordinate System
North American Datum of 1983
SPCS Zone Identifier: 4400
Geodetic Reference System 80
4,000-meter grid, Easting - Northing

VERMONT GENERAL HIGHWAY MAP
Town of Colchester
CHITTENDEN COUNTY
Transportation District #5
Prepared by the Vermont Agency of Transportation
Division of Policy, Planning and Intermodal Development
in cooperation with
U.S. Department of Transportation
Federal Highway Administration

