

TOWN HWY. No.	LENGTH IN MILES CLASS 3	CLASS 4
4		(0.20)
5	2.15	
6		(0.06)
7	1.97	(0.79)
8		(0.15)
9	3.42	
10	0.60	
11	0.60	
12	0.15	
13	0.33	
14	0.95	(0.31)
15	1.70	
16		(0.20)
17	1.50	
18	0.45	
19	1.37	
21	0.70	
22	0.11	(0.14)
23	3.15	
24	1.90	
25	0.03	
26	0.65	
28	0.34	
30	0.06	
32	0.32	(0.63)
33	0.60	
35		(0.28)
36	0.10	(0.30)
37	1.09	
38	2.98	
39	0.40	
40	0.10	
41	1.60	
42		(0.75)
43	0.40	(0.30)
44	1.85	
45	1.98	
48	0.35	
49	0.10	(0.55)
50	0.10	
51	0.38	
52	0.19	
<b>TOTAL</b>	<b>34.67</b>	<b>4.66</b>

**MILEAGE SUMMARY**

CLASS 2		
TH-1	7.820	
TH-2	1.900	
TH-3	2.590	
<b>TOTAL CLASS 2</b>		<b>12.310</b>
CLASS 3		
<b>TOTAL CLASS 3</b>		<b>34.67</b>
<b>TOTAL TOWN</b>		<b>46.980</b>
STATE HIGHWAY		
VT-5A	3.204	
<b>TOTAL STATE HIGHWAY</b>		<b>3.204</b>
US HIGHWAY		
US-5	7.329	
<b>TOTAL US HIGHWAY</b>		<b>7.329</b>
<b>TOTAL STATE</b>		<b>10.533</b>
<b>TOTAL, TRAVELED HIGHWAYS, FEB. 10, 2017:</b>		<b>57.513</b>

(Excludes Class 4 and Legal Trail Mileage)

**LEGAL TRAIL**

No.	LENGTH IN MILES LEGAL TRAIL
1	(0.37)
2	(1.20)
3	(0.75)
4	(1.05)
5	(0.40)
<b>TOTAL</b>	<b>3.77</b>

- HIGHWAYS**
- INTERSTATE
  - U.S. ROUTE
  - STATE ROUTE
  - CLASS 1
  - CLASS 2
  - CLASS 3
  - CLASS 4
  - LEGAL TRAIL
  - PARK AND RIDE
  - INTERSTATE OR DIVIDED HIGHWAY
  - STATE - HARD SURFACE OR PAVED
  - TOWN - HARD SURFACE OR PAVED
  - GRAVEL
  - SOIL OR GRADED AND DRAINED EARTH
  - UNIMPROVED OR PRIMITIVE
  - IMPASSABLE OR UNTRAVELED
  - LEGAL TRAIL
  - DISCONTINUED
  - HIGHWAY CLASS CHANGE
  - RAILROAD
  - INACTIVE RAILROAD
  - PUBLIC LAND - NATIONAL FOREST
  - PUBLIC LAND - STATE/MUNICIPAL
  - NATIONAL FOREST ROAD
  - STATE FOREST HIGHWAY

- POLITICAL SUBDIVISIONS**
- STATE BOUNDARY
  - COUNTY BOUNDARY
  - TOWN BOUNDARY
  - VILLAGE BOUNDARY
  - URBAN COMPACT BOUNDARY
  - WATER BODY
  - STREAM OR BROOK
- BRIDGE OR CULVERT**
- BRIDGE OR CULVERT > 20'
  - BRIDGE OR CULVERT 6' - 20'
  - BIKE PATH STRUCTURE
  - VOCBIT BRIDGE
  - VOCBIT CULVERT > 6'
  - STATE BRIDGE OR CULVERT IDENTIFIER
  - TOWN BRIDGE OR CULVERT IDENTIFIER

- FEDERAL CLASSIFICATION IDENTIFIER**
- MA MINOR ARTERIAL
  - MJC MAJOR COLLECTOR
  - MNC MINOR COLLECTOR
  - PA PRINCIPAL ARTERIAL

**DISCLAIMER:**  
The untraveled highways (laid-out town highways), discontinued highways, and legal trails hereon are those of which the Agency of Transportation has record; others may exist.

Highway and bridge data by the Agency of Transportation. Town short structures drawn from the Vermont Online Bridge & Culvert Inventory Tool (VOBCIT) database. All other data from the Vermont Center for Geographic Information. Only named streams shown.

Vermont State Plane Coordinate System  
North American Datum of 1983  
SPCS\_Zone\_Identifier: 4400  
Geodetic Reference System 80  
4,000-meter grid, Easting - Northing

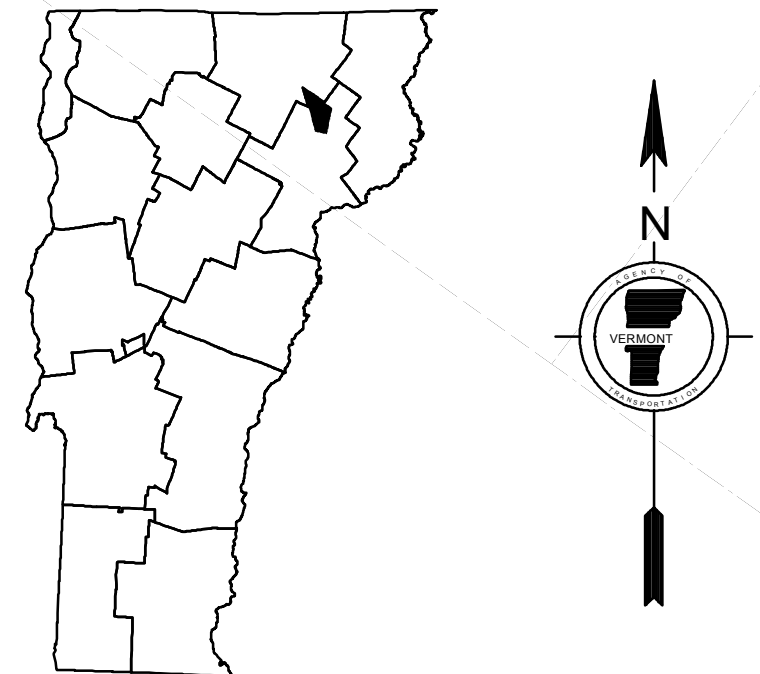
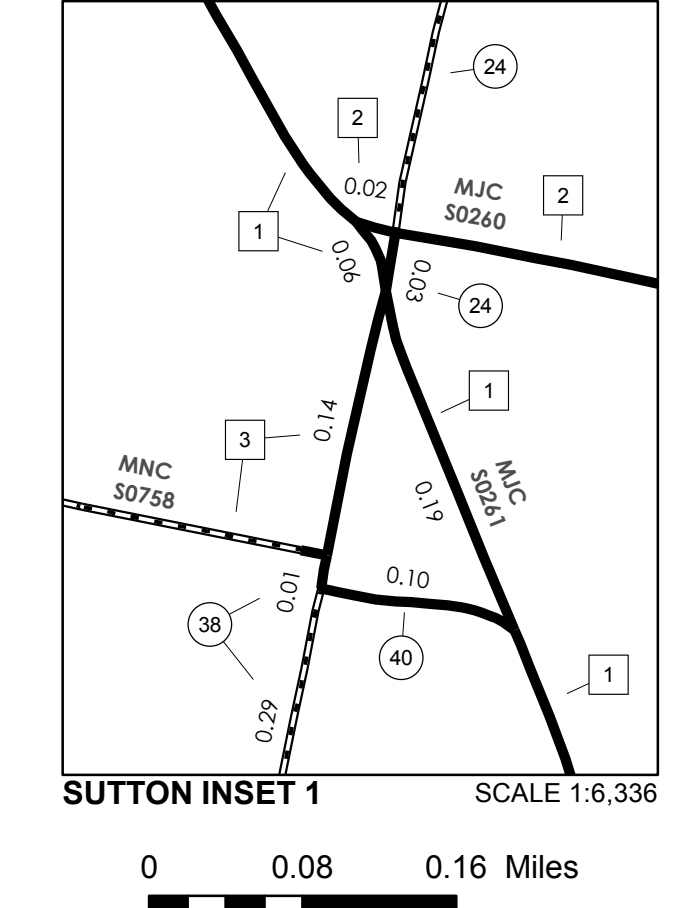
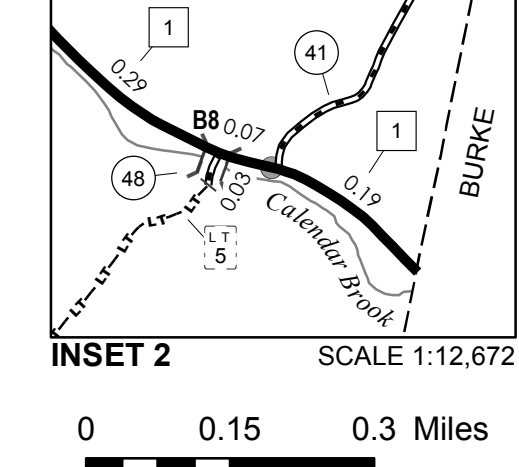
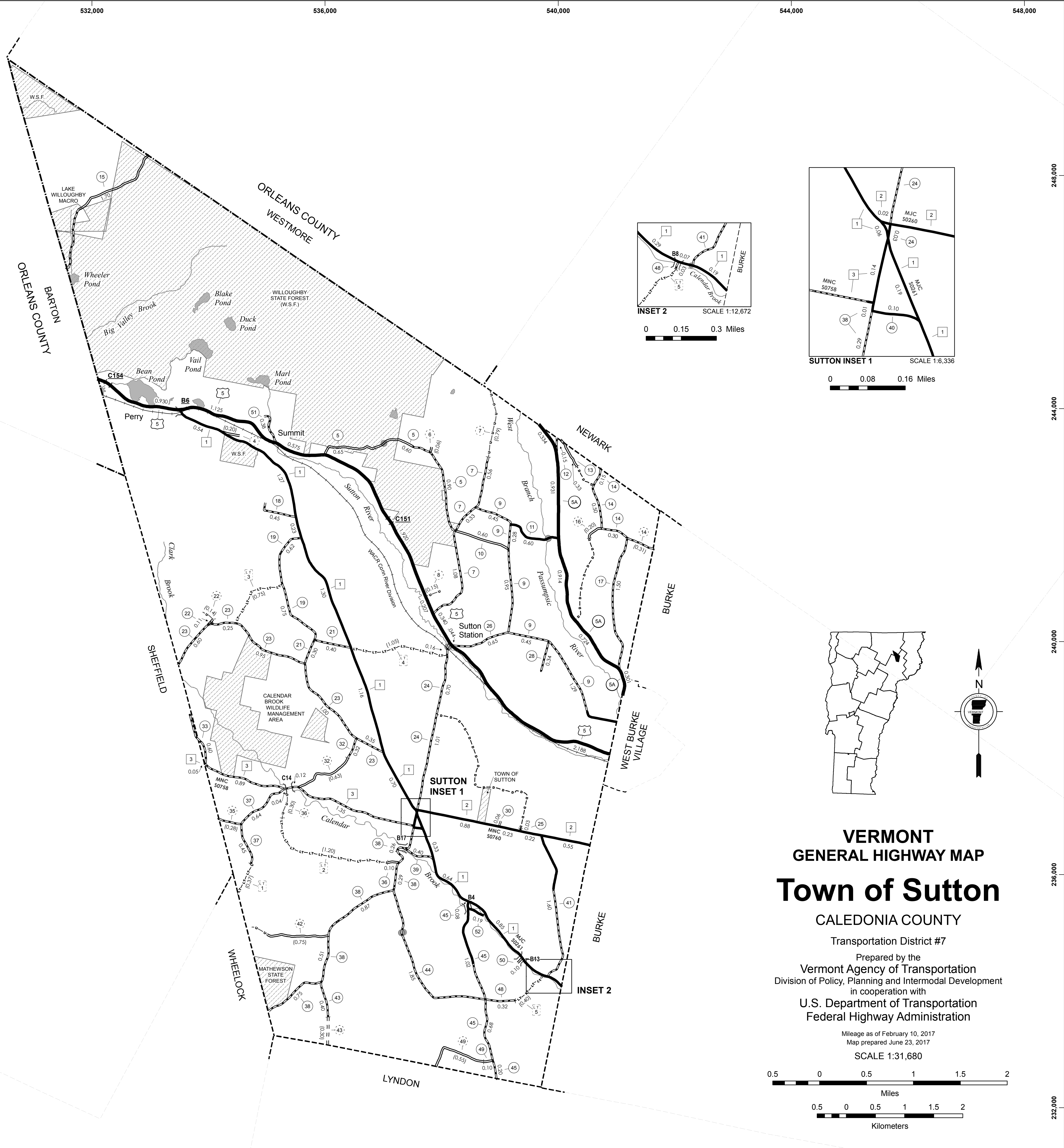

**VERMONT GENERAL HIGHWAY MAP**  
**Town of Sutton**  
CALEDONIA COUNTY  
Transportation District #7  
Prepared by the Vermont Agency of Transportation  
Division of Policy, Planning and Intermodal Development  
in cooperation with  
U.S. Department of Transportation  
Federal Highway Administration  
Mileage as of February 10, 2017  
Map prepared June 23, 2017  
SCALE 1:31,680