

TOWN HWY. No.	LENGTH IN MILES CLASS 3	LENGTH IN MILES CLASS 4
4		(0.20)
5	2.15	
6		(0.06)
7	1.97	(0.79)
8		(0.15)
9	3.42	
10	0.60	
11	0.60	
12	0.15	
13	0.60	
14	0.95	(0.31)
15	1.70	
16		(1.15)
17	1.50	
18	0.45	
19	1.37	
21	0.70	
22	0.11	(0.14)
23	3.15	
24	1.90	
25	0.03	
26	0.65	
28	0.34	
30	0.06	
32	0.32	(0.63)
33	0.60	
35		(0.28)
36	0.10	(0.30)
37	1.09	
38	2.98	
39	0.40	
40	0.10	
41	1.60	
42		(0.75)
43	0.40	(0.30)
44	1.85	
45	1.98	
48	0.35	
49	0.10	(0.55)
50	0.10	
51	0.38	
52	0.19	
<b>TOTAL</b>	<b>34.94</b>	<b>5.61</b>

**MILEAGE SUMMARY**

CLASS 2		
TH-1	7.820	
TH-2	1.900	
TH-3	2.590	
<b>TOTAL CLASS 2</b>	<b>12.310</b>	
CLASS 3		
<b>TOTAL CLASS 3</b>	<b>34.94</b>	
<b>TOTAL TOWN</b>	<b>47.260</b>	
STATE HIGHWAY		
VT-5A	3.204	
<b>TOTAL STATE HIGHWAY</b>	<b>3.204</b>	
US HIGHWAY		
US-5	7.329	
<b>TOTAL US HIGHWAY</b>	<b>7.329</b>	
<b>TOTAL STATE</b>	<b>10.533</b>	
<b>TOTAL, TRAVELED HIGHWAYS, FEB. 10, 2015:</b>	<b>57.783</b>	

*(Excludes Class 4, Legal Trail, and Unidentified Corridor Mileage)*

**LEGAL TRAIL**

No.	LENGTH IN MILES LEGAL TRAIL
1	(0.37)
2	(1.20)
3	(0.75)
4	(1.05)
5	(0.40)
<b>TOTAL</b>	<b>3.77</b>

- HIGHWAYS**
- INTERSTATE
  - U.S. ROUTE
  - STATE ROUTE
  - CLASS 1
  - CLASS 2
  - CLASS 3
  - CLASS 4
  - LEGAL TRAIL
- INTERSTATE OR DIVIDED HIGHWAY  
STATE - HARD SURFACE OR PAVED  
TOWN - HARD SURFACE OR PAVED  
GRAVEL  
SOIL OR GRADED AND DRAINED EARTH  
UNIMPROVED OR PRIMITIVE  
IMPASSABLE OR UNTRAVELED  
LEGAL TRAIL  
DISCONTINUED  
HIGHWAY CLASS CHANGE  
RAILROAD  
INACTIVE RAILROAD  
NFR NATIONAL FOREST ROAD  
SFH STATE FOREST HIGHWAY  
P PARK AND RIDE

- PUBLIC LAND - GREEN MOUNTAIN NATIONAL FOREST  
PUBLIC LAND - STATE/MUNICIPAL
- POLITICAL SUBDIVISIONS**
- STATE BOUNDARY
  - COUNTY BOUNDARY
  - TOWN BOUNDARY
  - VILLAGE BOUNDARY
  - URBAN COMPACT BOUNDARY
- WATER BODY  
STREAM OR BROOK
- BRIDGE OR CULVERT**
- BRIDGE OR CULVERT > 20'
  - BRIDGE OR CULVERT 6' - 20'
  - VOBCIT BRIDGE
  - VOBCIT CULVERT > 6'
  - B34 / C34 STATE BRIDGE OR CULVERT IDENTIFIER
  - B34 / C34 TOWN BRIDGE OR CULVERT IDENTIFIER

- FEDERAL CLASSIFICATION IDENTIFIER**
- FAU URBAN ARTERIAL OR COLLECTOR
  - MA MINOR ARTERIAL
  - MJC MAJOR COLLECTOR
  - MNC MINOR COLLECTOR
  - PA PRINCIPAL ARTERIAL

**DISCLAIMER:**  
The untraveled highways (laid-out town highways), discontinued highways, and legal trails hereon are those of which the Agency of Transportation has record; others may exist.

Highway and bridge data by the Agency of Transportation. Town short structures are drawn from the Vermont Online Bridge & Culvert Inventory Tool (VOBCIT) database. All other data from the Vermont Center for Geographic Information. Only named streams are shown.

Vermont State Plane Coordinate System  
North American Datum of 1983  
SPCS\_Zone\_Identifier: 4400  
Geodetic Reference System 80  
4,000-meter grid, Easting - Northing

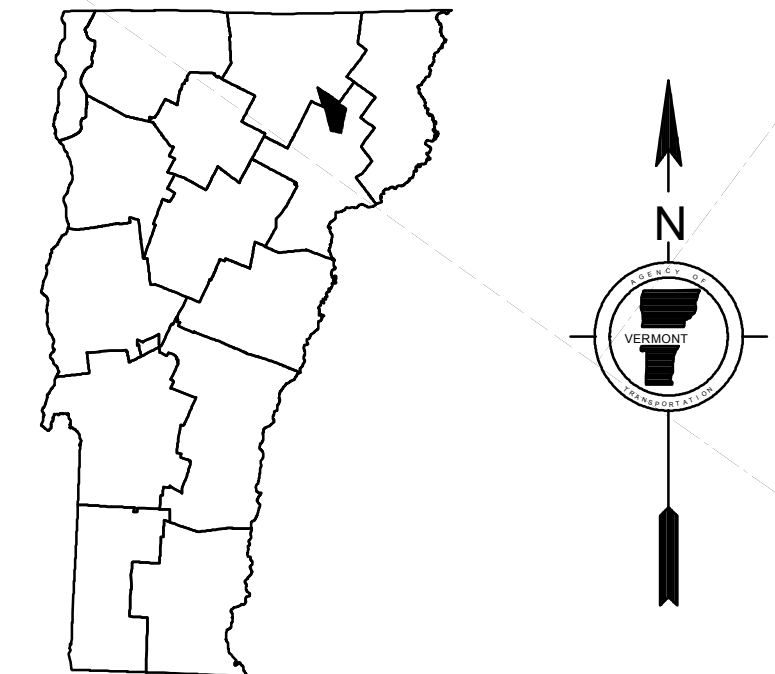
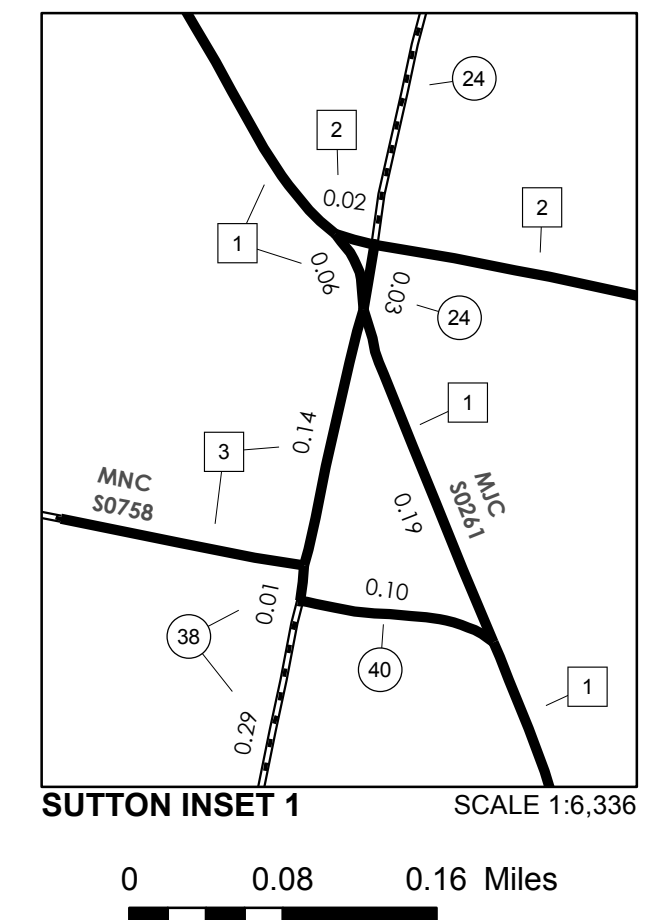
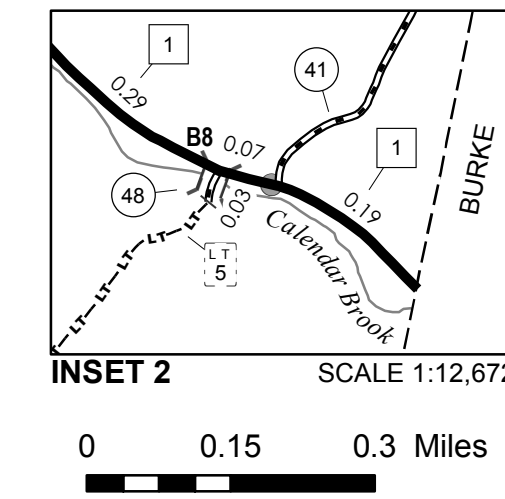
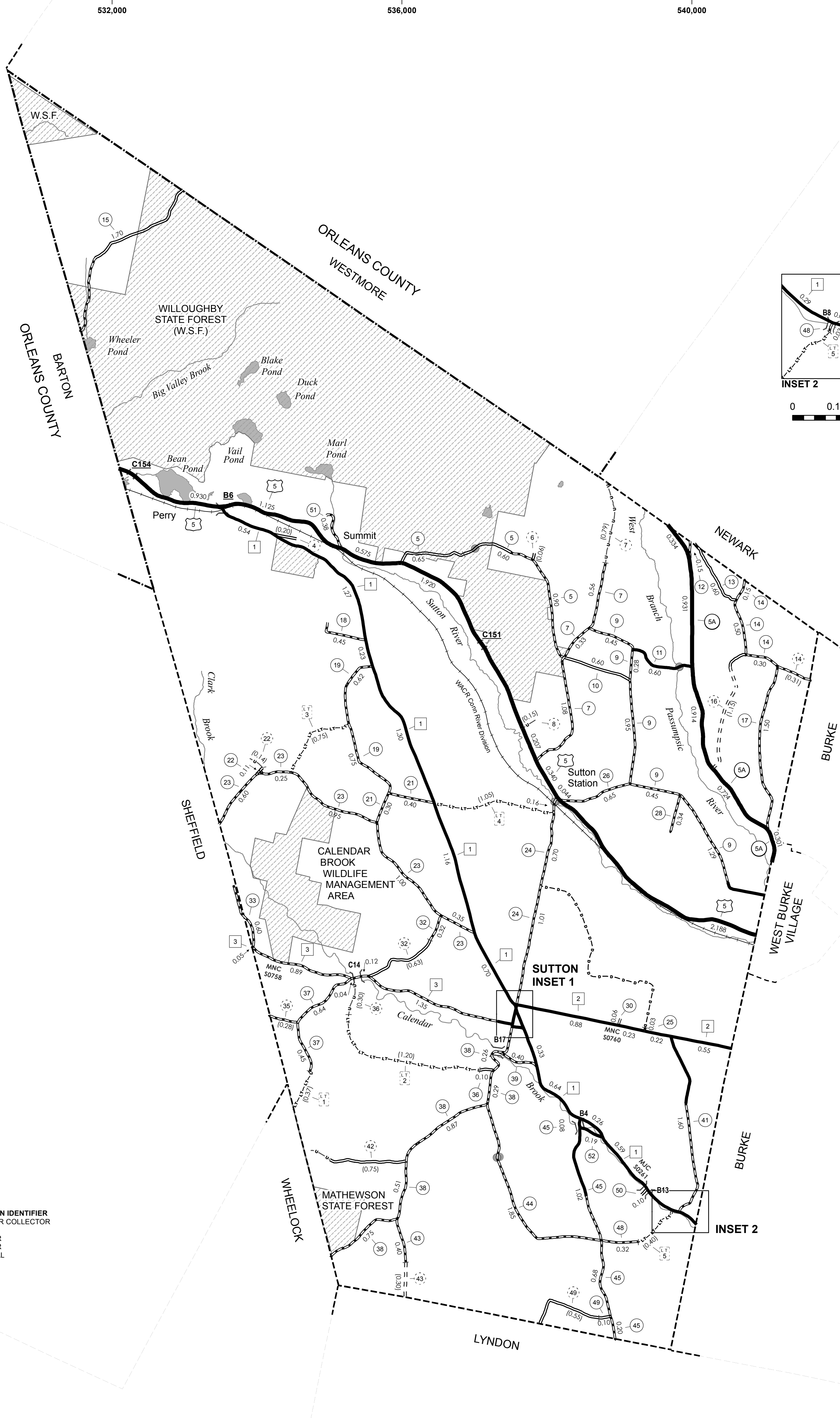

**VERMONT GENERAL HIGHWAY MAP**  
**Town of Sutton**  
CALEDONIA COUNTY  
Transportation District #7  
Prepared by the Vermont Agency of Transportation  
Division of Policy, Planning and Intermodal Development  
in cooperation with  
U.S. Department of Transportation  
Federal Highway Administration

