

TOWN HWY. No.	LENGTH IN MILES CLASS 3	LENGTH IN MILES CLASS 4	MILEAGE SUMMARY	
6	4.64		CLASS 2	4,910
7	5.07		TH-1	0.350
8	1.86		TH-2	0.180
9	0.28		TH-3	2.320
10	0.22		TH-4	1.730
11	0.40		TH-5	4.470
12	0.18		TH-6	
13		(0.97)	TOTAL CLASS 2	13,960
15	0.04		TOTAL CLASS 3	43.24
16	0.75		TOTAL TOWN	57,200
17	0.71	(0.08)	US HIGHWAY	7,386
18	3.60		US-5	3,698
20	0.16		US-302	
21	0.73		TOTAL US HIGHWAY	11,084
22	0.07		TOTAL STATE	11,084
25	0.80		INTERSTATE	
26	0.21		I-91	6,241
28	1.46	(0.69)	TOTAL INTERSTATE	6,241
31	0.80		TOTAL INTERSTATE	6,241
32	0.77			
34	0.23		TOTAL, TRAVELED HIGHWAYS, FEB. 10, 2024:	74,525
37	0.94	(0.51)	(Excludes Class 4 and Legal Trail Mileage)	
38	0.07			
39	0.35			
40	0.35			
41	0.30			
42	0.34			
43	0.30			
44	1.94			
45	0.73			
46	0.38			
47	0.16			
48	0.80	(0.25)		
49		(0.21)		
51	0.63		LEGAL TRAIL	LENGTH IN MILES
52	0.16		No.	LEGAL TRAIL
53	0.84		1	(0.18)
54	0.32		2	(0.76)
55		(0.52)	3	(0.41)
56	0.30		4	(0.46)
58	0.33		5	(0.35)
60	0.31	(0.39)	6	(0.20)
61	2.35		7	(0.15)
63	0.82		8	(0.50)
65	0.60		9	(0.31)
66	0.55		10	(0.41)
67	0.23		11	(0.69)
68		(1.57)	12	(1.10)
69		(0.05)	13	(0.67)
70			14	(2.63)
71	0.02	(0.16)	15	(0.14)
72	0.17	(0.13)	TOTAL	8.96
73	0.20			
74	0.20			
78	0.10			
80		(0.11)		
81	0.40			
82	0.08			
87	0.14			
88	0.29	(0.61)		
89	0.27			
90	0.40			
91	0.12			
92	1.01			
93	0.20			
300	0.10			
302	0.36			
304	0.16			
306	0.06			
308	0.61			
310	0.17			
312	0.04			
314	0.23			
318	0.30			
320	0.05			
322	0.07			
324	0.06			
TOTAL	43.24	6.25		

TOWN HWY. No.	LENGTH IN MILES "NOT UP TO STANDARD"
67	(0.06)
71	(0.04)
316	(0.19)
TOTAL	0.29

* The sections of the town highways listed above are legally Class 3, but have been deemed "Not Up to Standard" and are functionally Class 4 Town Highways

- HIGHWAYS**
 - INTERSTATE OR DIVIDED HIGHWAY
 - STATE - HARD SURFACE OR PAVED
 - TOWN - HARD SURFACE OR PAVED
 - GRAVEL
 - SOIL OR GRADED AND DRAINED EARTH
 - UNIMPROVED OR PRIMITIVE
 - IMPASSABLE OR UNTRAVELED
 - LEGAL TRAIL
 - DISCONTINUED
 - HIGHWAY CLASS CHANGE
 - RAILROAD
 - INACTIVE RAILROAD
 - PUBLIC LAND - NATIONAL FOREST
 - PUBLIC LAND - STATE/MUNICIPAL
 - NFR NATIONAL FOREST ROAD
 - ACE ARMY CORPS OF ENGINEERS
 - USGH UNITED STATES GOV. HWY.
- POLITICAL SUBDIVISIONS**
 - STATE BOUNDARY
 - COUNTY BOUNDARY
 - TOWN BOUNDARY
 - VILLAGE BOUNDARY
 - URBAN COMPACT BOUNDARY
 - WATER BODY
 - STREAM OR BROOK
- BRIDGE OR CULVERT**
 - BRIDGE OR CULVERT > 20'
 - BRIDGE OR CULVERT 6' - 20'
 - BIKE PATH STRUCTURE
 - VTCULVERTS BRIDGE
 - VTCULVERTS CULVERT > 6'
- FEDERAL CLASSIFICATION IDENTIFIER**
 - MA MINOR ARTERIAL
 - MJC MAJOR COLLECTOR
 - MNC MINOR COLLECTOR
 - PA PRINCIPAL ARTERIAL
- STATE BRIDGE OR CULVERT IDENTIFIER**
 - B34 / C34
- TOWN BRIDGE OR CULVERT IDENTIFIER**
 - B34 / C34

DISCLAIMER:
The untraveled highways (laid-out town highways), discontinued highways, and legal trails hereon are those of which the Agency of Transportation has record; others may exist.

Highway and bridge data by the Agency of Transportation. Town short structures drawn from the VTCULVERTS (formerly VOBCIT) online database. All other data from the Vermont Open Geodata Portal. Only named streams shown.

Vermont State Plane Coordinate System
North American Datum of 1983
SPCS_Zone_Identifier: 4400
Geodetic Reference System 80
4,000-meter grid, Easting - Northing

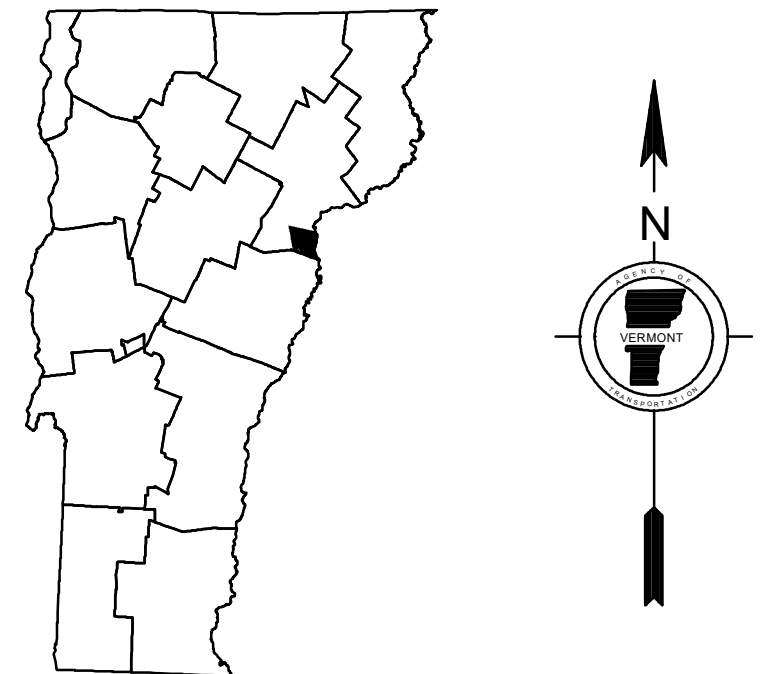
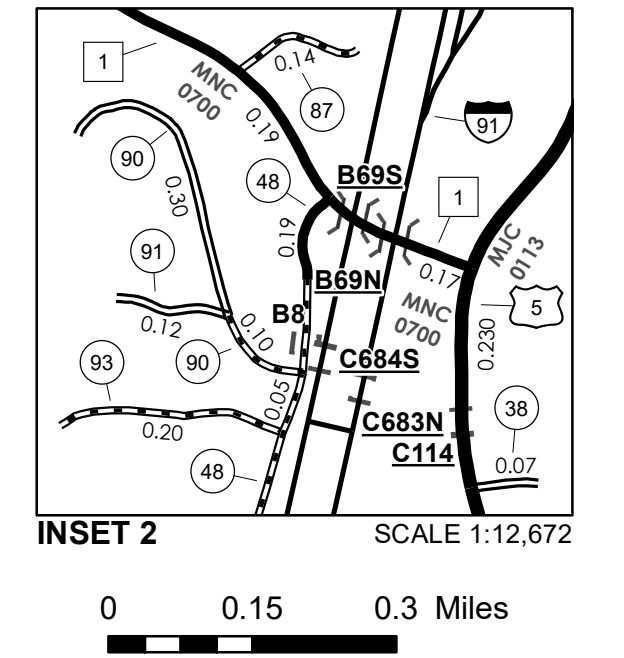
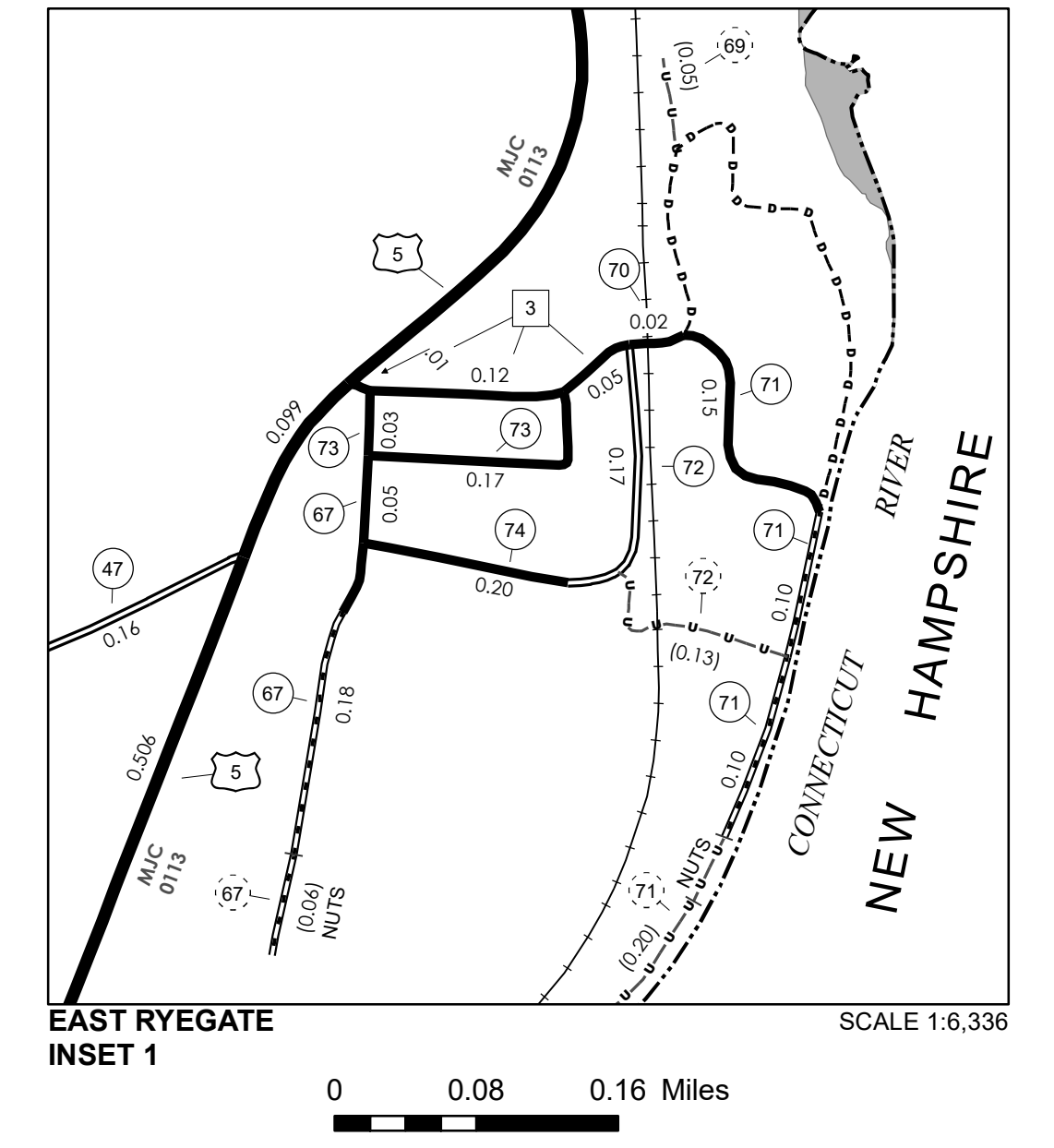
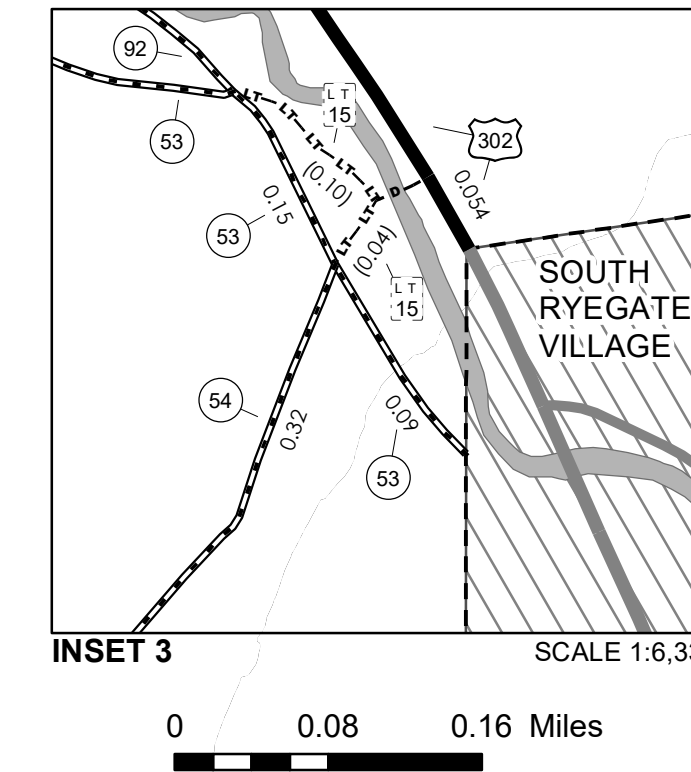

VERMONT
GENERAL HIGHWAY MAP
Town of Ryegate
CALEDONIA COUNTY
Transportation District #7
Prepared by the
Vermont Agency of Transportation
Division of Policy, Planning and Intermodal Development
in cooperation with
U.S. Department of Transportation
Federal Highway Administration

