

TOWN HWY. No.	LENGTH IN MILES CLASS 3	LENGTH IN MILES CLASS 4	MILEAGE SUMMARY CLASS 2	
6	4.64		TH-1	4,910
7	5.07		TH-2	0,350
8	1.86		TH-3	0,180
9	0.28		TH-4	2,320
10	0.22		TH-5	1,730
11	0.40		TH-6	4,470
12	0.18		TOTAL CLASS 2	13,960
13	0.04	(0.97)	TOTAL CLASS 3	43,24
16	0.75		TOTAL TOWN	57,200
17	0.71	(0.08)	US HIGHWAY	
18	3.60		US-5	7,386
20	0.16		US-302	3,698
21	0.73		TOTAL US HIGHWAY	11,084
22	0.07		TOTAL STATE	11,084
25	0.80		INTERSTATE	
26	0.21		I-91	6,241
28	1.46	(0.68)	TOTAL INTERSTATE	6,241
29	0.21	(0.42)	TOTAL INTERSTATE	6,241
31	0.80			
32	0.77			
34	0.23			
37	0.94	(0.51)		
38	0.07			
39	0.35			
40	0.35			
41	0.30			
42	0.34			
43	0.30			
44	1.94			
45	0.73			
46	0.38			
47	0.16	(0.25)		
48	0.80	(0.21)		
49	0.80			
51	0.63			
52	0.16	(0.18)		
53	0.84	(0.76)		
54	0.32	(0.41)		
55	0.30	(0.46)		
56	0.30	(0.35)		
58	0.33	(0.20)		
60	0.31	(0.15)		
61	2.35	(0.50)		
63	0.82	(0.31)		
65	0.60	(0.41)		
66	0.55	(0.69)		
67	0.23	(1.10)		
68	0.33	(0.73)		
69	0.27	(2.63)		
70	0.02	(0.14)		
71	0.35	(0.16)		
72	0.17	(0.13)		
73	0.20			
74	0.20			
78	0.10			
80	0.10	(0.11)		
81	0.40			
82	0.08			
87	0.14			
88	0.29	(0.61)		
89	0.27			
90	0.40			
91	0.12			
92	1.01			
93	0.20			
300	0.10			
302	0.36			
304	0.16			
306	0.06			
308	0.61			
310	0.17	(0.06)		
312	0.04	(0.04)		
314	0.23	(0.19)		
318	0.30			
320	0.05			
322	0.07			
324	0.06			
<b>TOTAL</b>	<b>43.24</b>	<b>6.66</b>		

**TOTAL, TRAVELED HIGHWAYS, FEB. 10, 2020: 74.525**  
 (Excludes Class 4 and Legal Trail Mileage)

LEGAL TRAIL No.	LENGTH IN MILES LEGAL TRAIL
1	(0.18)
2	(0.76)
3	(0.41)
4	(0.46)
5	(0.35)
6	(0.20)
7	(0.15)
8	(0.50)
9	(0.31)
10	(0.41)
11	(0.69)
12	(1.10)
13	(0.73)
14	(2.63)
15	(0.14)
<b>TOTAL</b>	<b>9.02</b>

TOWN HWY. No.	LENGTH IN MILES "NOT UP TO STANDARD"
67	(0.06)
71	(0.04)
316	(0.19)
<b>TOTAL</b>	<b>0.29</b>

\* The sections of the town highways listed above are legally Class 3, but have been deemed "Not Up to Standard" and are functionally Class 4 Town Highways

- HIGHWAYS**
  - INTERSTATE
  - U.S. ROUTE
  - STATE ROUTE
  - CLASS 1
  - CLASS 2
  - CLASS 3
  - CLASS 4
  - LEGAL TRAIL
  - PARK AND RIDE
  - INTERSTATE OR DIVIDED HIGHWAY
  - STATE - HARD SURFACE OR PAVED
  - TOWN - HARD SURFACE OR PAVED
  - GRAVEL
  - SOIL OR GRADED AND DRAINED EARTH
  - UNIMPROVED OR PRIMITIVE
  - IMPASSABLE OR UNTRAVELED
  - LEGAL TRAIL
  - DISCONTINUED
  - HIGHWAY CLASS CHANGE
  - RAILROAD
  - INACTIVE RAILROAD
  - PUBLIC LAND - NATIONAL FOREST
  - PUBLIC LAND - STATE/MUNICIPAL
  - NFR NATIONAL FOREST ROAD
  - SFH STATE FOREST HIGHWAY
- POLITICAL SUBDIVISIONS**
  - STATE BOUNDARY
  - COUNTY BOUNDARY
  - TOWN BOUNDARY
  - VILLAGE BOUNDARY
  - URBAN COMPACT BOUNDARY
  - WATER BODY
  - STREAM OR BROOK
  - BRIDGE OR CULVERT
    - BRIDGE OR CULVERT > 20'
    - BRIDGE OR CULVERT 6' - 20'
    - BIKE PATH STRUCTURE
    - VT CULVERTS BRIDGE
    - VT CULVERTS CULVERT > 6'
  - B34 / C34 STATE BRIDGE OR CULVERT IDENTIFIER
  - B34 / C34 TOWN BRIDGE OR CULVERT IDENTIFIER
- FEDERAL CLASSIFICATION IDENTIFIER**
  - MA MINOR ARTERIAL
  - MJC MAJOR COLLECTOR
  - MNC MINOR COLLECTOR
  - PA PRINCIPAL ARTERIAL

**DISCLAIMER:**  
 The untraveled highways (laid-out town highways), discontinued highways, and legal trails herein are those of which the Agency of Transportation has record; others may exist.

Highway and bridge data by the Agency of Transportation. Town short structures drawn from the VTCULVERTS (formerly VOBCIT) online database. All other data from the Vermont Open Geodata Portal. Only named streams shown.

Vermont State Plane Coordinate System  
 North American Datum of 1983  
 SPCS\_Zone\_Identifier: 4400  
 Geodetic Reference System 80  
 4,000-meter grid, Easting - Northing

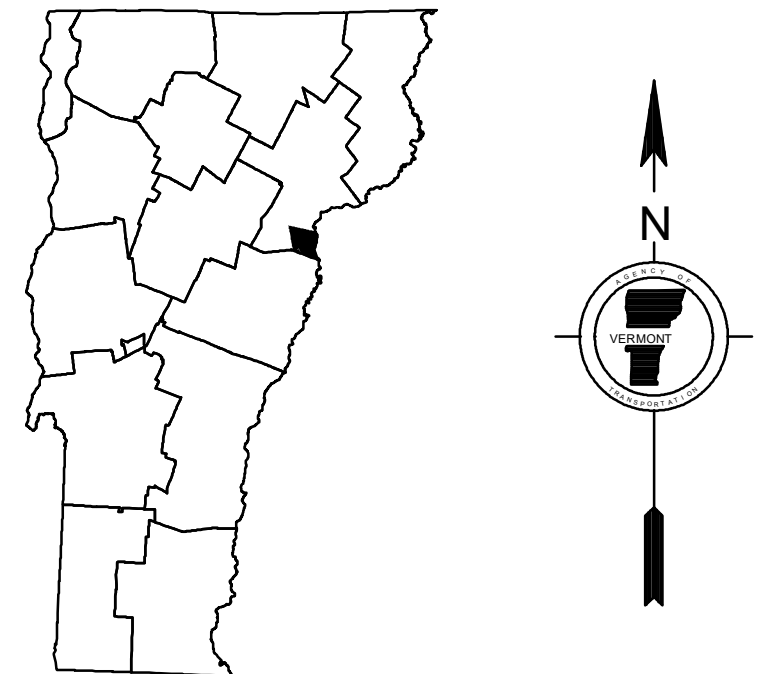
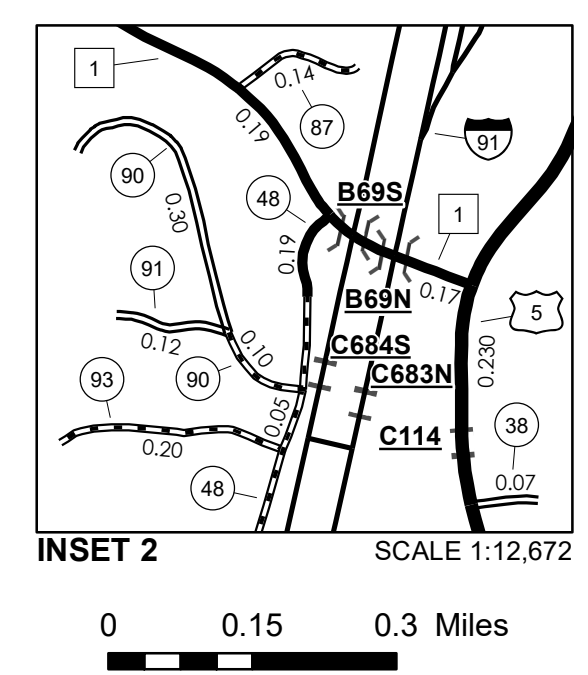
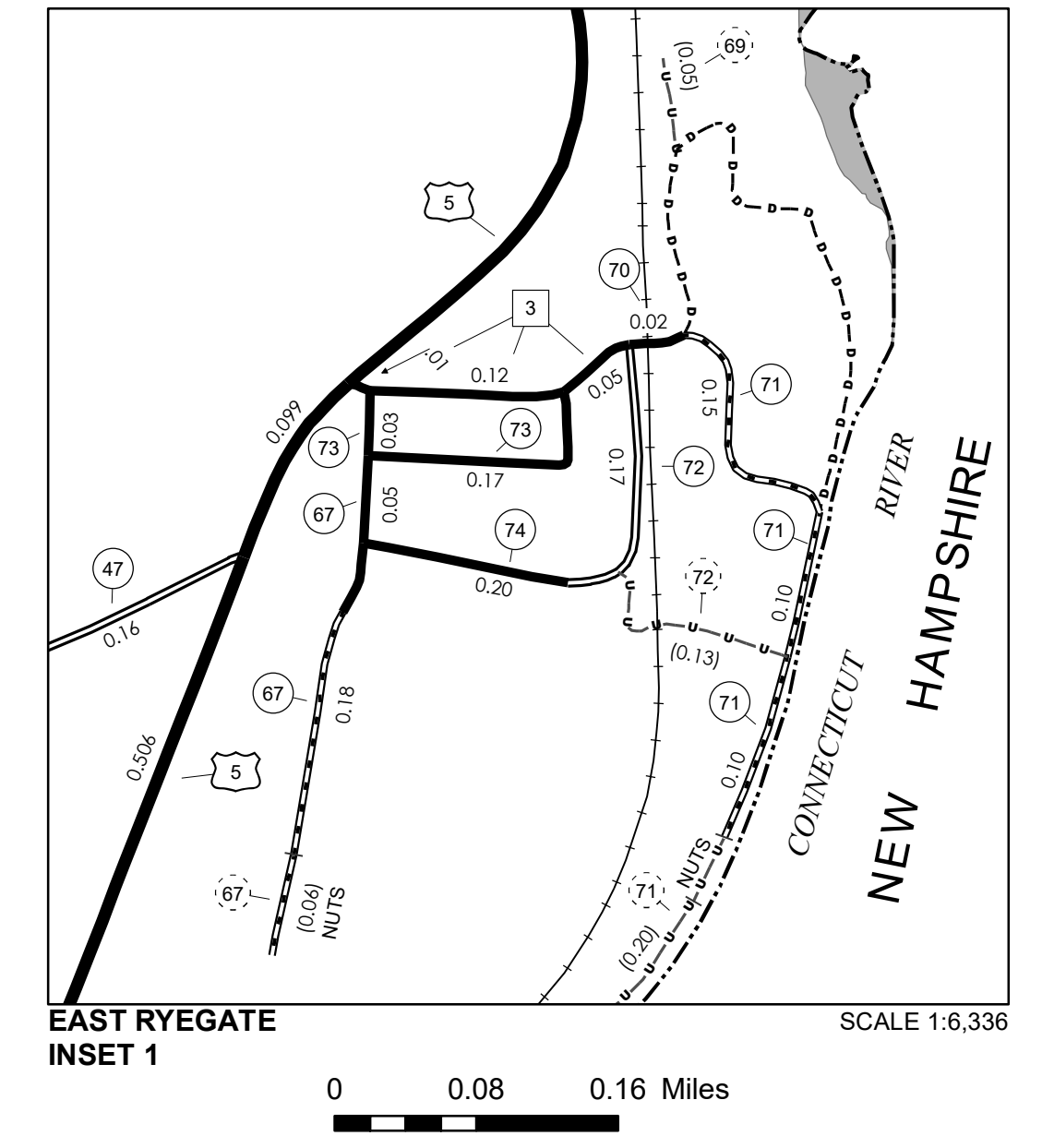
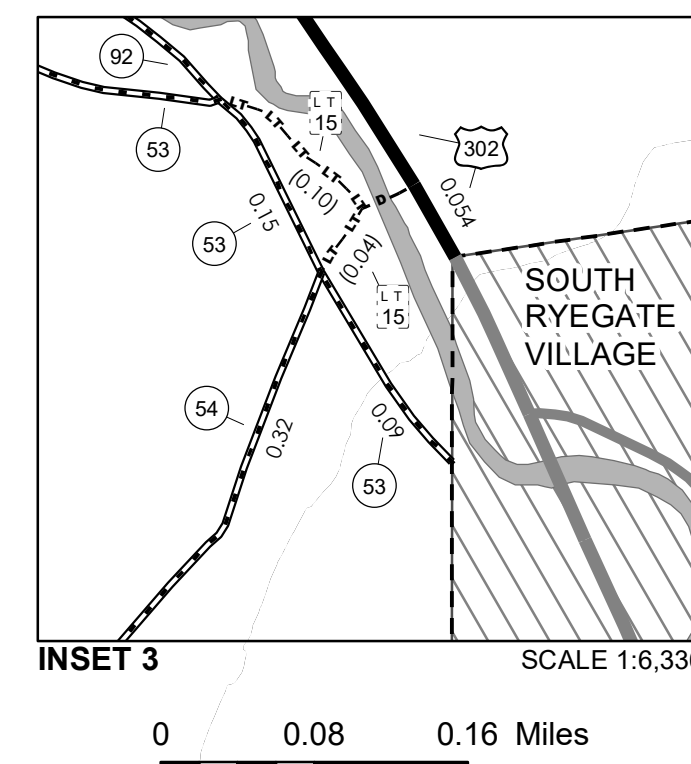

**VERMONT**  
**GENERAL HIGHWAY MAP**  
**Town of Ryegate**  
 CALEDONIA COUNTY  
 Transportation District #7  
 Prepared by the  
 Vermont Agency of Transportation  
 Division of Policy, Planning and Intermodal Development  
 in cooperation with  
 U.S. Department of Transportation  
 Federal Highway Administration

