

TOWN HWY. NO.	LENGTH IN MILES CLASS 3	LENGTH IN MILES CLASS 4
8	1.040	304
9	1.150	306
10	4.610	308
11	0.190	310
12	1.920	312
13	0.170	314
14	1.410	316
15	0.200	318
16	0.050	322
17	0.080	324
18	1.550	326
19		328
20	2.950	330
21	0.350	332
22	2.300	334
23	0.270	336
24	0.400	338
25	0.070	340
26	0.750	342
27	0.150	344
28	1.650	346
29	1.500	348
30	0.120	349
31	1.100	350
32	1.240	351
33	1.750	352
34		354
35	0.150	356
36	0.080	358
37	0.380	360
39	1.650	362
40		364
42	0.180	365
43		366
45	3.450	367
46	0.910	368
48	0.450	370
49	0.700	372
50	0.200	374
51	2.220	376
52	0.060	378
53	0.100	380
54	0.900	382
55	0.990	384
56		386
57	0.700	388
58		389
59	0.120	390
60	0.070	392
61	0.100	393
62	0.120	394
63	0.580	396
64	1.250	398
65	0.400	400
68	0.040	402
69	0.140	404
70	0.240	406
71	0.950	410
73	0.100	412
300	0.540	414
302	0.040	416
TOTAL	53.430	5.720

MILEAGE SUMMARY			
CLASS 1			
TH-1	0.986		
TH-2	0.514		
TOTAL CLASS 1	1.500		
CLASS 2			
TH-1	1.050		
TH-2	3.170		
TH-3	5.205		
TH-4	0.100		
TH-5	0.330		
TH-6	0.200		
TH-7	0.340		
TOTAL CLASS 2	10.395		
CLASS 3			
TOTAL CLASS 3	53.430		
TOTAL TOWN	65.325		
STATE HIGHWAY			
VT-14	5.514		
VT-15	6.212		
VT-16	4.420		
TOTAL STATE HIGHWAY	16.146		
TOTAL STATE	16.146		

TOTAL, TRAVELED HIGHWAYS, FEB. 10, 2007: 81.471
(Excludes Class 4 and Legal Trail Mileage)

LEGAL LENGTH IN MILES TRAIL			
NO.	LEGAL TRAIL		
1	(1.600)		
2	(0.020)		
TOTAL	1.620		

- HIGHWAYS**
- INTERSTATE
 - U.S. ROUTE
 - STATE ROUTE
 - CLASS 1
 - CLASS 2
 - CLASS 3
 - CLASS 4
 - LEGAL TRAIL
 - INTERSTATE OR DIVIDED HIGHWAY
 - STATE - HARD SURFACE OR PAVED
 - TOWN - HARD SURFACE OR PAVED
 - GRAVEL
 - SOIL OR GRADED AND DRAINED EARTH
 - UNIMPROVED OR PRIMITIVE
 - IMPASSABLE OR UNTRAVELED
 - LEGAL TRAIL
 - DISCONTINUED
 - HIGHWAY CLASS CHANGE
 - RAILROAD
- FEDERAL CLASSIFICATION IDENTIFIER**
- FAU URBAN ARTERIAL OR COLLECTOR
 - MA MINOR ARTERIAL
 - MJC MAJOR COLLECTOR
 - MNC MINOR COLLECTOR
 - PA PRINCIPAL ARTERIAL

- PUBLIC LAND**
- POLITICAL SUBDIVISIONS**
- STATE BOUNDARY
 - COUNTY BOUNDARY
 - TOWN BOUNDARY
 - VILLAGE BOUNDARY
 - URBAN COMPACT
- WATER BODIES**
- OPEN WATER
 - SWAMP
 - STREAM OR BROOK
- BRIDGE OR CULVERT**
- BRIDGE OR CULVERT GREATER THAN 20'
 - BRIDGE OR CULVERT 6' - 20'
- B34 STATE BRIDGE IDENTIFIER**
- B34 TOWN BRIDGE IDENTIFIER**

DISCLAIMER:

The untraveled highways (laid-out town highways), discontinued highways, and legal trails shown herein are those of which the Agency of Transportation has record; others may exist.

Highway and bridge data by the Agency of Transportation, Policy & Planning Division. All other data from the Vermont Center for Geographic Information.

Vermont State Plane Coordinate System
North American Datum of 1983
SPCS_Zone_Identifier: 4400
Geodetic Reference System 80
4,000-meter grid, Easting - Northing

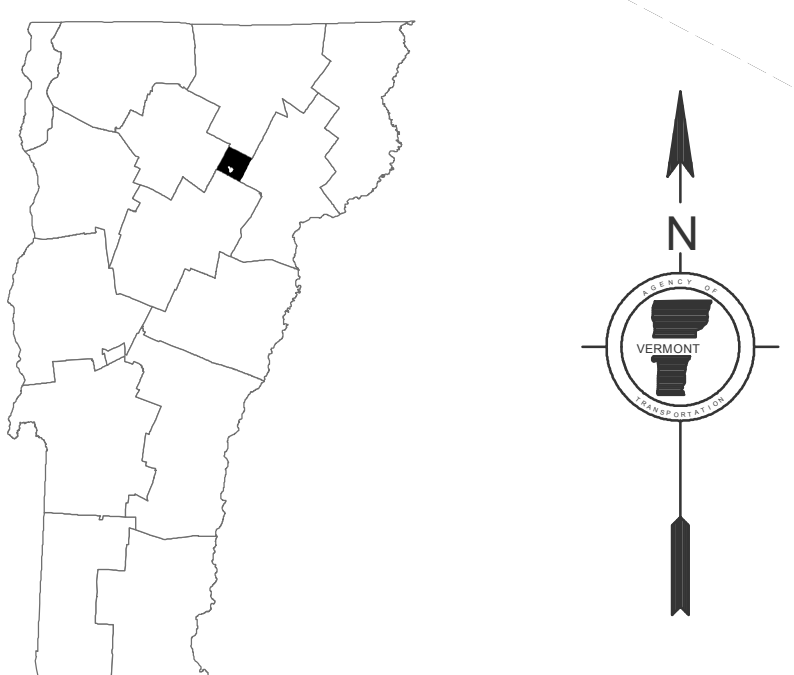
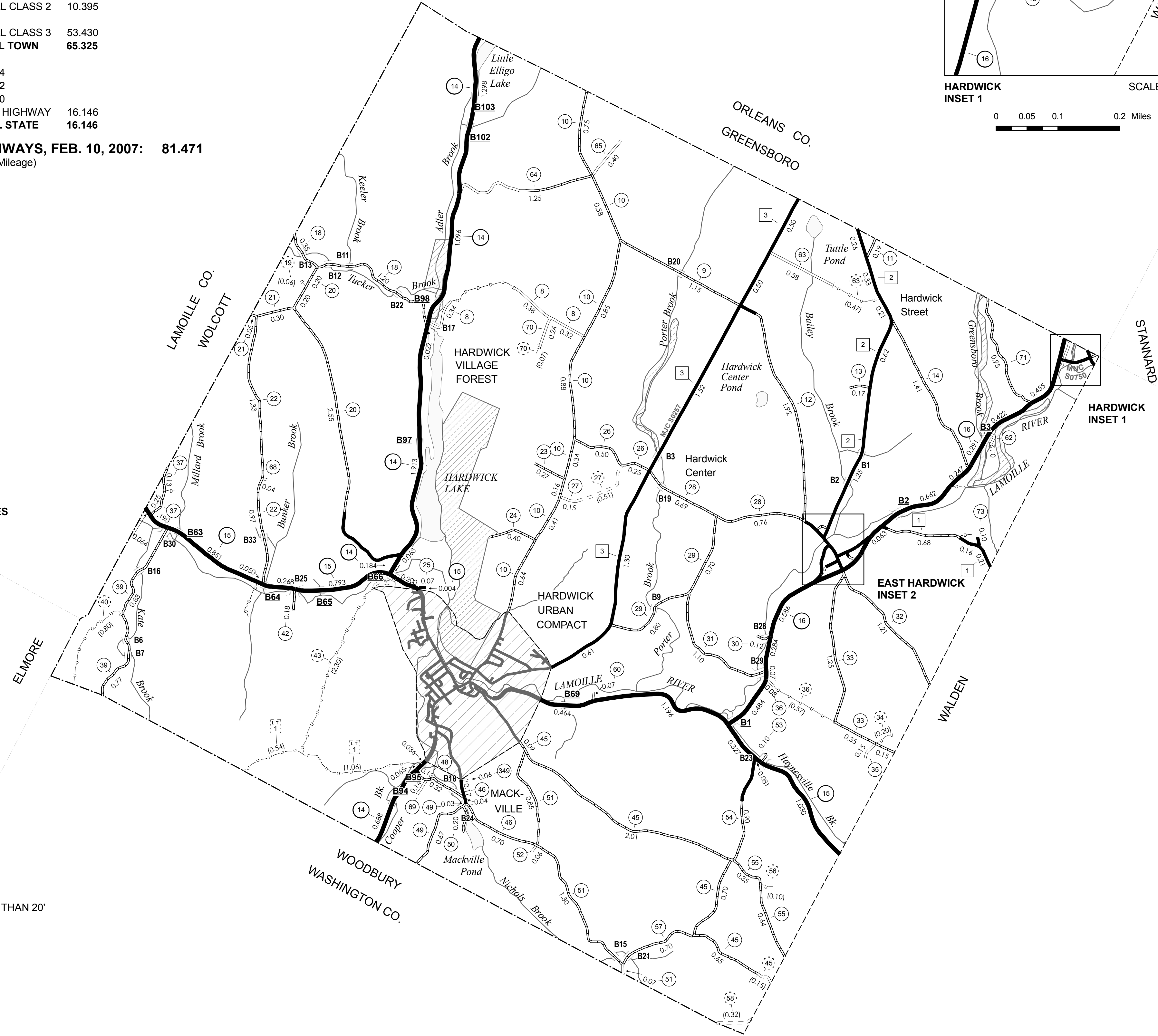
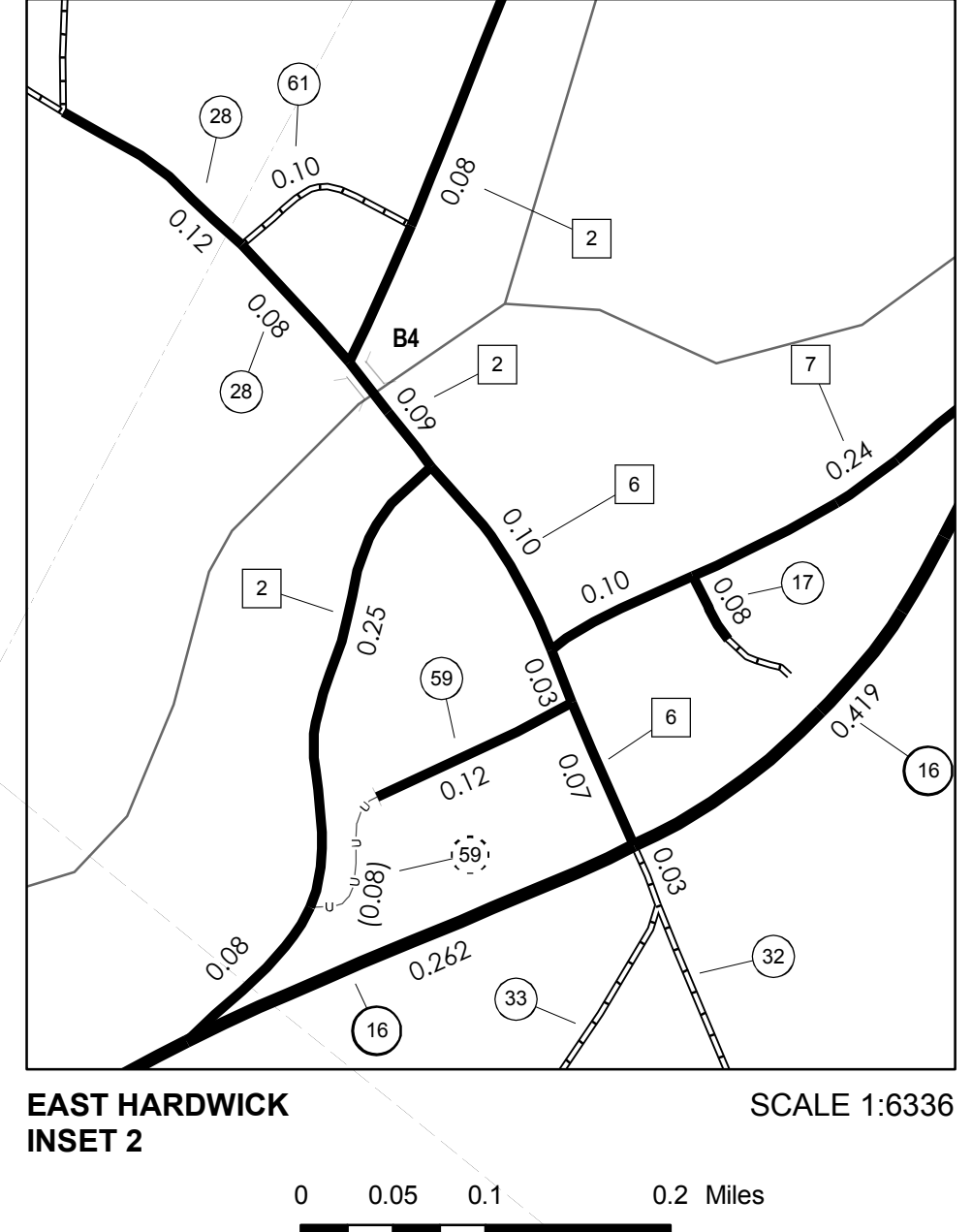
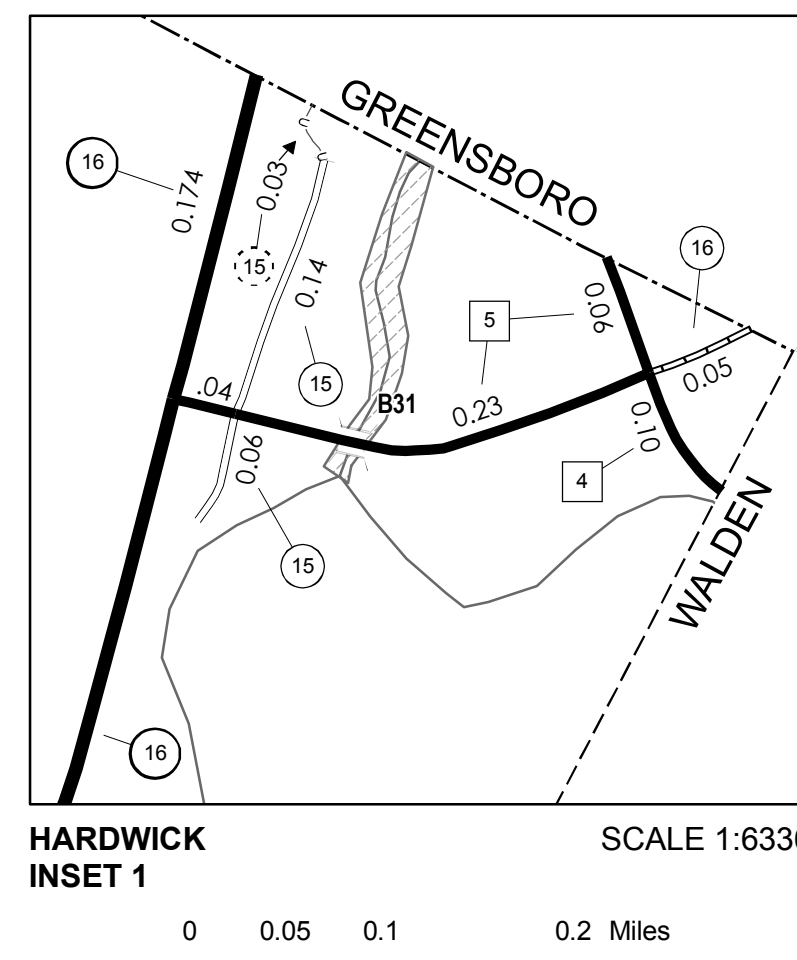

VERMONT GENERAL HIGHWAY MAP
Town of Hardwick
CALEDONIA COUNTY

Transportation District #7

Prepared by the
Vermont Agency of Transportation
Policy & Planning Division
in cooperation with
U.S. Department of Transportation
Federal Highway Administration

Mileage as of: Feb. 10, 2007
Map generated: October, 2007

