

TOWN HWY. No.	LENGTH IN MILES CLASS 3	LENGTH IN MILES CLASS 4	TOWN ROAD NAME
5	0.15		GOODFELLOW RD
17	0.10		TINKHAM RD
19	0.10		BRANCH BROOK RD
31	0.45		WELD RD
32	0.04		PINE ST
32	0.04		TANNERY BROOK RD
32	0.44	(0.06)	TH-32
47	0.12		LITTLE ITALY RD
47		(0.02)	POWER HOUSE RD
47		(0.01)	TH 47
48	0.25		POWER HOUSE RD
49	0.12		WELTON RD
50	0.10		MILL ST
50	0.10		PARK ST
51	0.10		CHECCHI ST
51	0.26		LITTLE ITALY RD
52		(0.07)	TH-52
52		(0.06)	TH 52
53	0.32		RAILROAD ST
54	0.10		SNUG HBR
55	0.07		COAL KILN RD
56	0.07		RIVER ST
57	0.09		LITTLE ITALY RD
61	0.14		CEMETERY RD
TOTAL	3.06	0.22	

MILEAGE SUMMARY			
CLASS 2	0.550		
TH-1	0.200		
TH-2			0.750
TOTAL CLASS 2			0.750
CLASS 3			
TOTAL CLASS 3			3.06
TOTAL TOWN			3.810
US HIGHWAY	2.105		
US-302			
TOTAL US HIGHWAY			2.105
TOTAL STATE			2.105

TOTAL, TRAVELED HIGHWAYS, FEB. 10, 2020: 5.915
(Excludes Class 4 and Legal Trail Mileage)

TOWN HWY. No.	LENGTH IN MILES "NOT UP TO STANDARD"
50	(0.03)
TOTAL	0.03

* The sections of the town highways listed above are legally Class 3, but have been deemed "Not Up To Standard" and are functionally Class 4 Town Highways

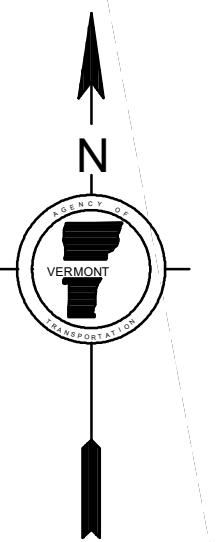
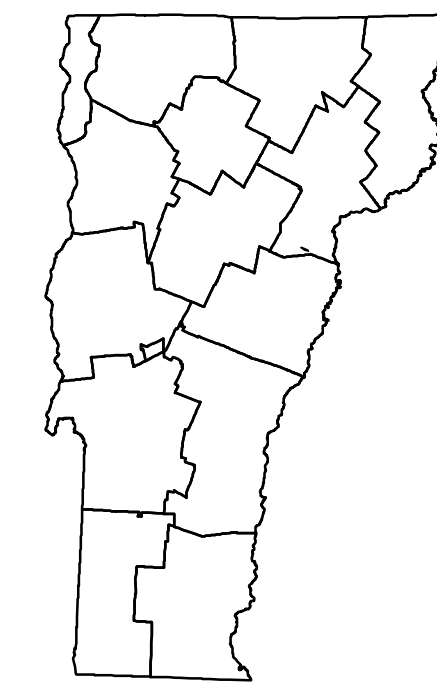
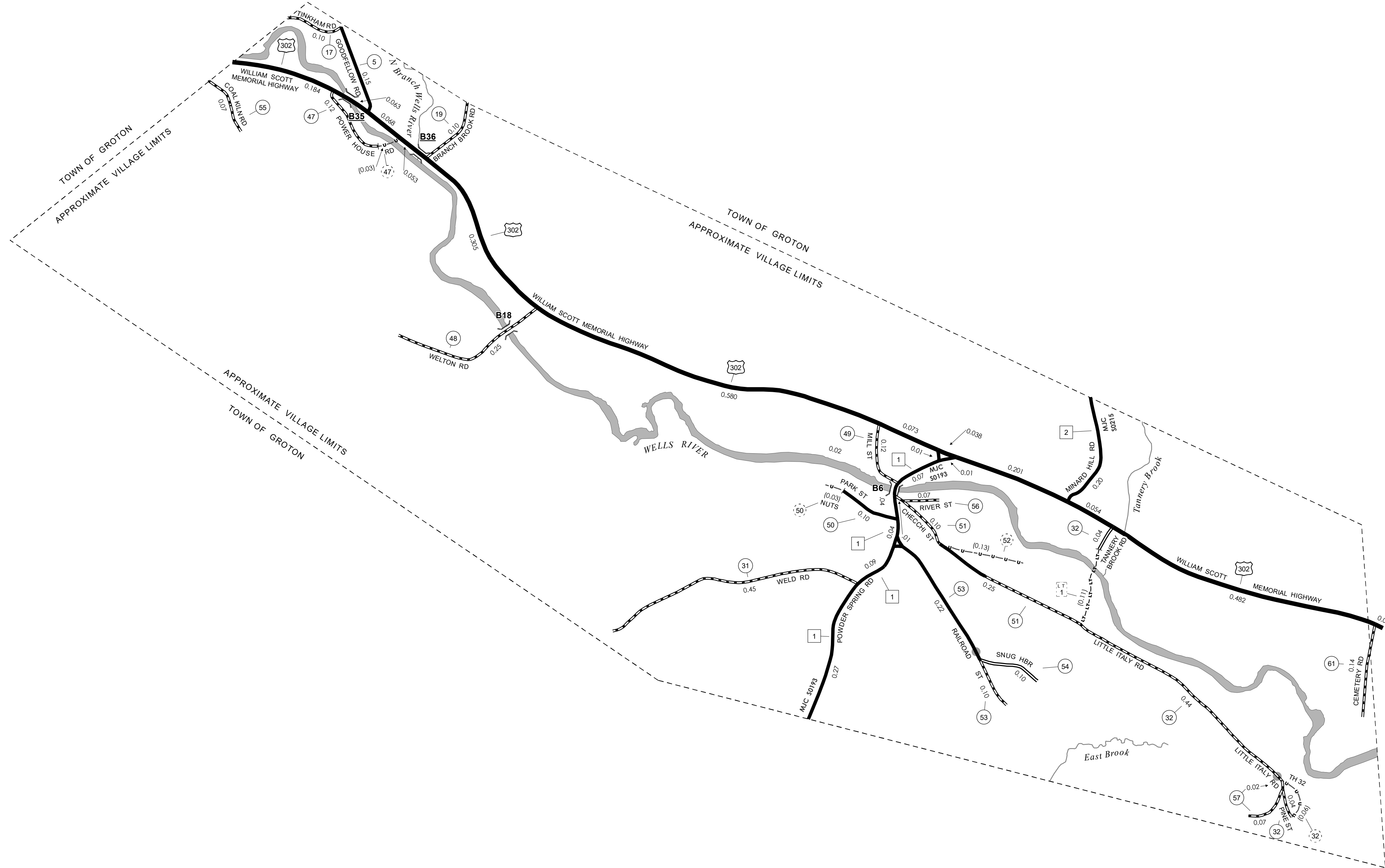

VERMONT
GENERAL HIGHWAY MAP
Village of Groton
CALEDONIA COUNTY

Transportation District #7
Prepared by the
Vermont Agency of Transportation
Division of Policy, Planning and Intermodal Development
in cooperation with
U.S. Department of Transportation
Federal Highway Administration

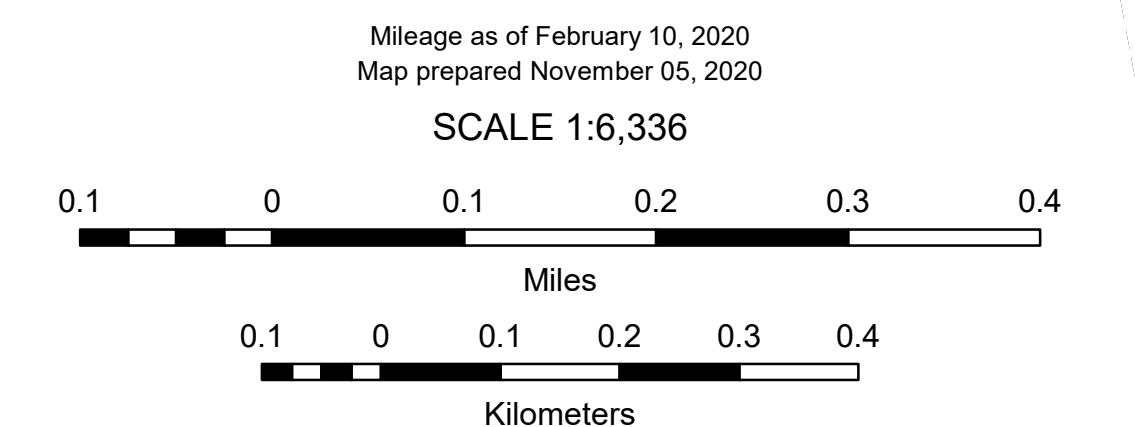

HIGHWAYS		POLITICAL SUBDIVISIONS		BRIDGE OR CULVERT		FEDERAL CLASSIFICATION IDENTIFIER	
	INTERSTATE OR DIVIDED HIGHWAY		STATE BOUNDARY		BRIDGE OR CULVERT > 20'		MA MINOR ARTERIAL
	U.S. ROUTE		COUNTY BOUNDARY		BRIDGE OR CULVERT 6' - 20'		MJC MAJOR COLLECTOR
	STATE ROUTE		TOWN BOUNDARY		BIKE PATH STRUCTURE		MNC MINOR COLLECTOR
	CLASS 1		VILLAGE BOUNDARY		VTCULVERTS BRIDGE		PA PRINCIPAL ARTERIAL
	CLASS 2		URBAN COMPACT BOUNDARY		VTCULVERTS CULVERT > 6'		
	CLASS 3		WATER BODY		STATE BRIDGE OR CULVERT IDENTIFIER		
	CLASS 4		STREAM OR BROOK		TOWN BRIDGE OR CULVERT IDENTIFIER		
	LEGAL TRAIL		DISCONTINUED				
	PARK AND RIDE		HIGHWAY CLASS CHANGE				
			RAILROAD				
			INACTIVE RAILROAD				
			PUBLIC LAND - NATIONAL FOREST				
			PUBLIC LAND - STATE/MUNICIPAL				
			NFR NATIONAL FOREST ROAD				
			SFH STATE FOREST HIGHWAY				

DISCLAIMER:
The untraveled highways (laid-out town highways), discontinued highways, and legal trails hereon are those of which the Agency of Transportation has record; others may exist.

Highway and bridge data by the Agency of Transportation. Town short structures drawn from the VTCULVERTS (formerly VOBCIT) online database. All other data from the Vermont Open Geodata Portal. Only named streams shown.

Vermont State Plane Coordinate System
North American Datum of 1983
SPCS_Zone_Identifier: 4400
Geodetic Reference System: 80
2,000-meter grid, Easting - Northing