

MILEAGE SUMMARY

CLASS 2			
TH-1	2,250		
TH-2	2,540		
TH-3	2,080		
TOTAL CLASS 2	6,870		
CLASS 3			
TOTAL CLASS 3	24.12		
TOTAL TOWN	30.990		
STATE HIGHWAY			
VT-232	7.182		
TOTAL STATE HIGHWAY	7.182		
US HIGHWAY			
US-302	7.904		
TOTAL US HIGHWAY	7.904		
TOTAL STATE	15.086		

TOTAL, TRAVELED HIGHWAYS, FEB. 10, 2015: 46.076
(Excludes Class 4, Legal Trail, and Unidentified Corridor Mileage)

TOWN HWY. No.

TOWN HWY. No.	LENGTH IN MILES CLASS 3	LENGTH IN MILES CLASS 4
4	3.20	
5	2.25	(2.40)
6		(0.79)
7	0.93	(0.78)
8		(1.25)
9	0.25	
10	0.14	
11	0.08	
12		(0.38)
13	2.20	
14	0.42	
15	0.15	
17	0.22	(0.07)
18	0.35	
19	1.01	
20	0.60	
21	0.42	
22	0.15	
23		(0.35)
24	1.58	
25		(0.28)
26	0.15	(0.57)
27	0.58	(0.72)
28	0.14	(0.05)
29	0.12	
30	0.22	
31	0.45	
32	0.52	(0.17)
33		(0.88)
34	0.20	
35	1.81	
36		(0.52)
37	0.75	
38	0.30	
39		(0.05)
40	0.10	
41	0.71	(0.10)
42		(0.36)
43	0.11	(0.09)
44	0.63	
45		(0.08)
46	0.13	
47	0.12	(0.03)
48	0.25	
49	0.12	
50	0.10	
51	0.36	
52		(0.13)
53	0.32	
54	0.10	
55	0.12	
56	0.07	
57	0.09	
58	0.54	
59	0.09	
60	0.30	
61	0.14	
62	0.15	
63	0.10	
64		(0.58)
65	0.28	
TOTAL	24.12	10.63

TOWN HWY. No.

TOWN HWY. No.	LENGTH IN MILES "NOT UP TO STANDARD"
50	(0.03)
59	(0.07)
TOTAL	0.10

* The sections of the town highways listed above are legally Class 3, but have been deemed "Not Up to Standard" and are functionally Class 4 Town Highways

DISCLAIMER: The untraveled highways (laid-out town highways), discontinued highways, and legal trails hereon are those of which the Agency of Transportation has record; others may exist.

Highway and bridge data by the Agency of Transportation. Town short structures are drawn from the Vermont Online Bridge & Culvert Inventory Tool (VOBCIT) database. All other data from the Vermont Center for Geographic Information. Only named streams are shown.

HIGHWAYS

- INTERSTATE
- U.S. ROUTE
- STATE ROUTE
- CLASS 1
- CLASS 2
- CLASS 3
- CLASS 4
- LEGAL TRAIL

INTERSTATE OR DIVIDED HIGHWAY

STATE - HARD SURFACE OR PAVED

TOWN - HARD SURFACE OR PAVED

GRAVEL

SOIL OR GRADED AND DRAINED EARTH

UNIMPROVED OR PRIMITIVE

IMPASSABLE OR UNTRAVELED

LEGAL TRAIL

DISCONTINUED

HIGHWAY CLASS CHANGE

RAILROAD

INACTIVE RAILROAD

NFR NATIONAL FOREST ROAD

SFH STATE FOREST HIGHWAY

P PARK AND RIDE

PUBLIC LAND - GREEN MOUNTAIN NATIONAL FOREST

PUBLIC LAND - STATE/MUNICIPAL

POLITICAL SUBDIVISIONS

- STATE BOUNDARY
- COUNTY BOUNDARY
- TOWN BOUNDARY
- VILLAGE BOUNDARY
- URBAN COMPACT BOUNDARY

BRIDGE OR CULVERT

- BRIDGE OR CULVERT > 20'
- BRIDGE OR CULVERT 6' - 20'
- VOBCIT BRIDGE
- VOBCIT CULVERT > 6'
- STATE BRIDGE OR CULVERT IDENTIFIER
- TOWN BRIDGE OR CULVERT IDENTIFIER

FEDERAL CLASSIFICATION IDENTIFIER

- FAU URBAN ARTERIAL OR COLLECTOR
- MA MINOR ARTERIAL
- MJC MAJOR COLLECTOR
- MNC MINOR COLLECTOR
- PA PRINCIPAL ARTERIAL

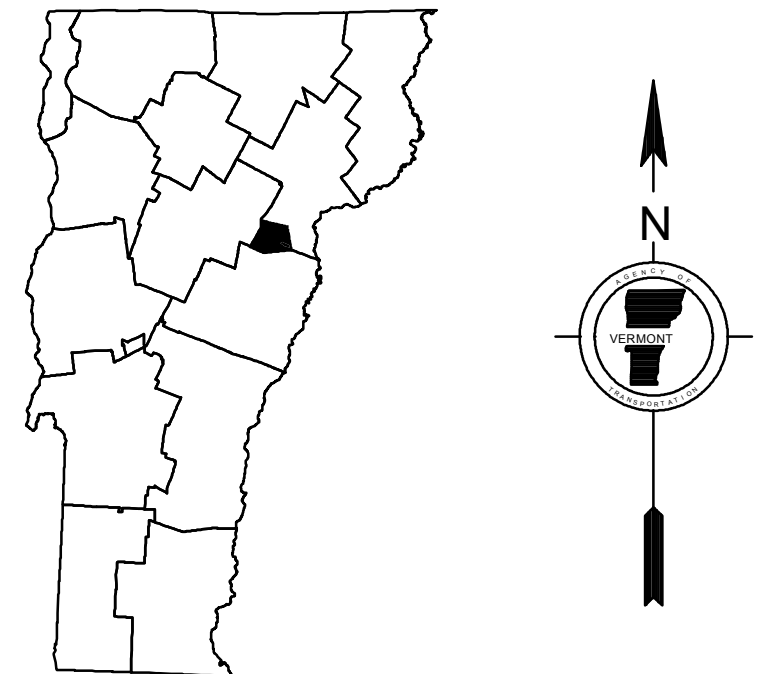
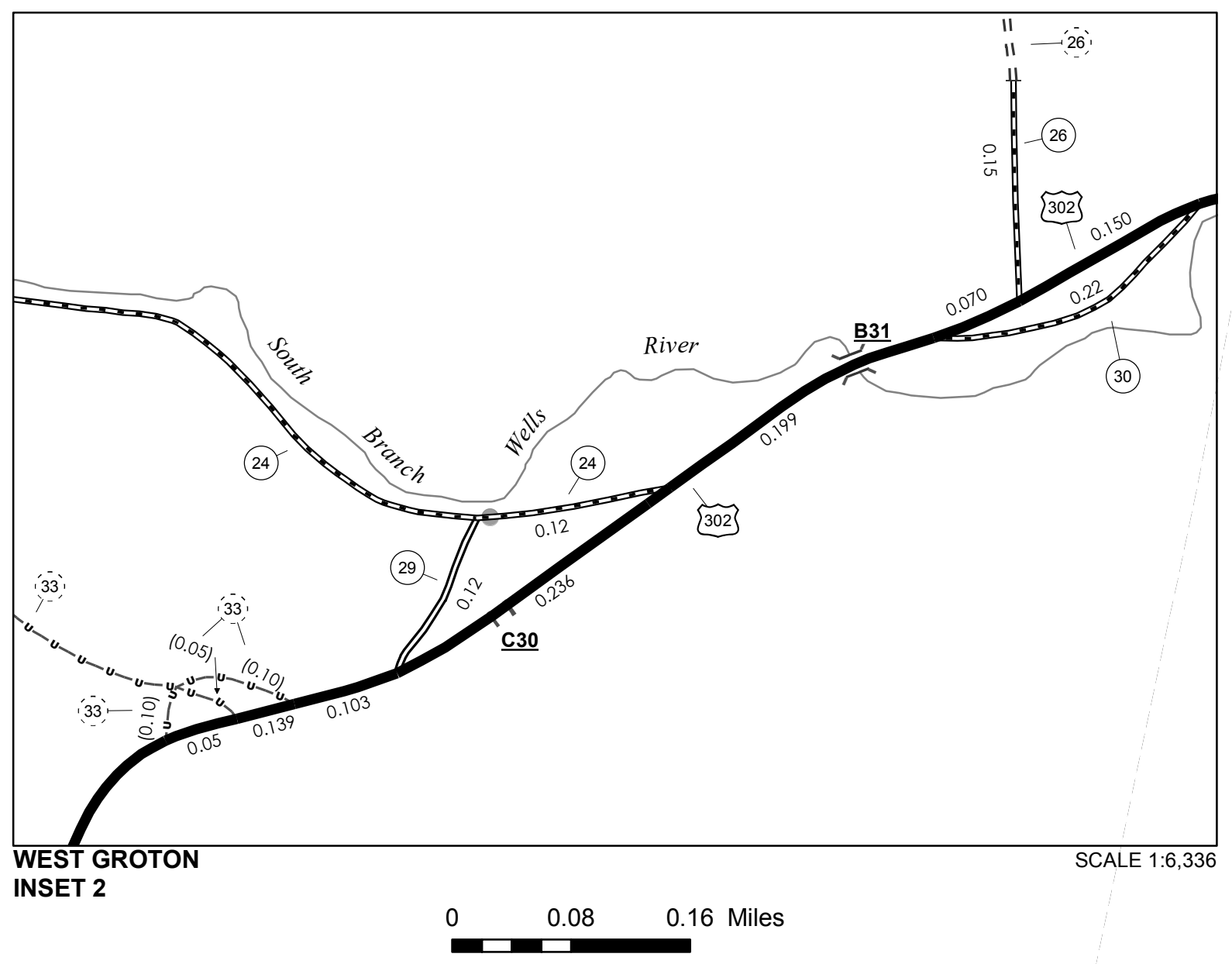
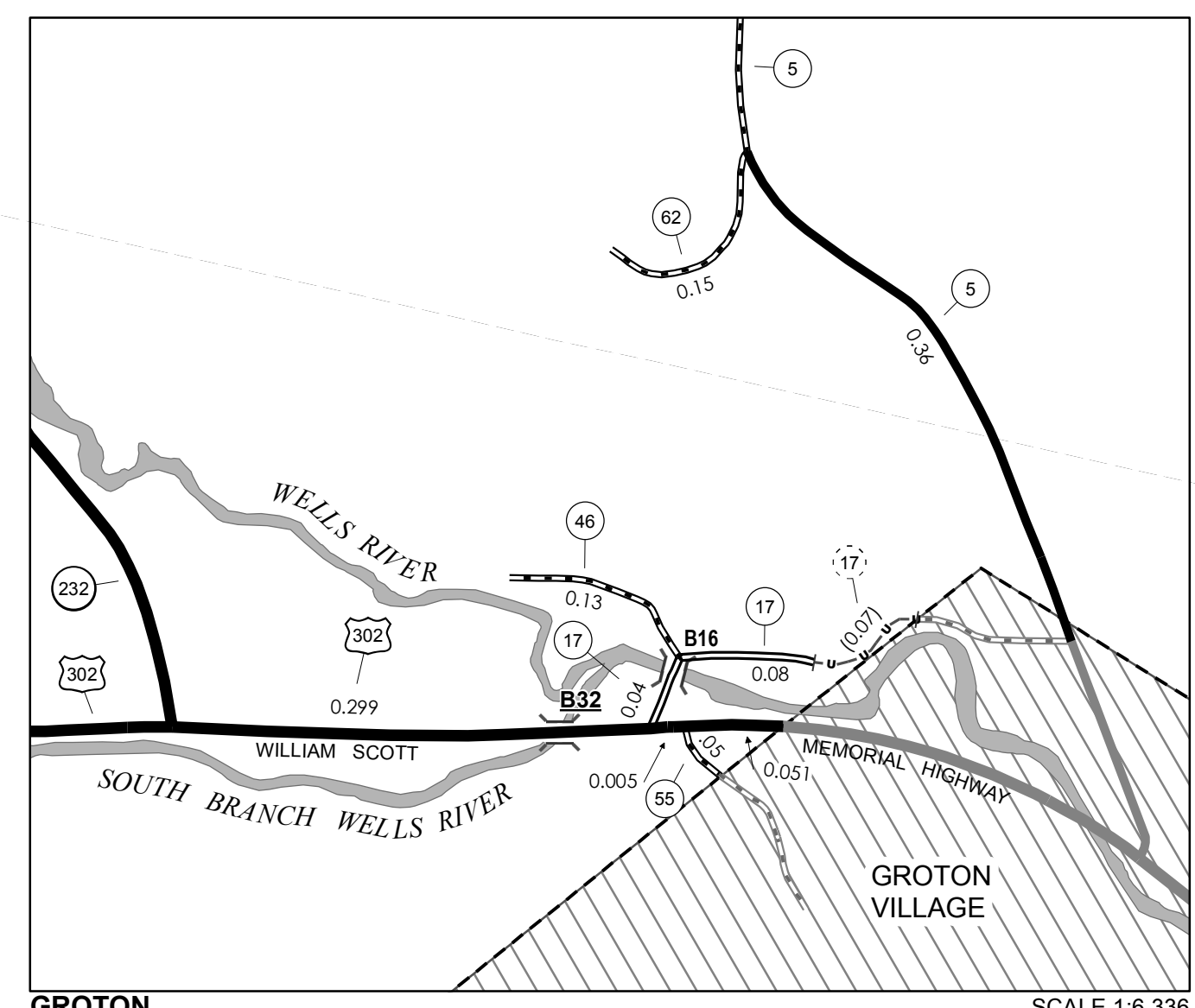
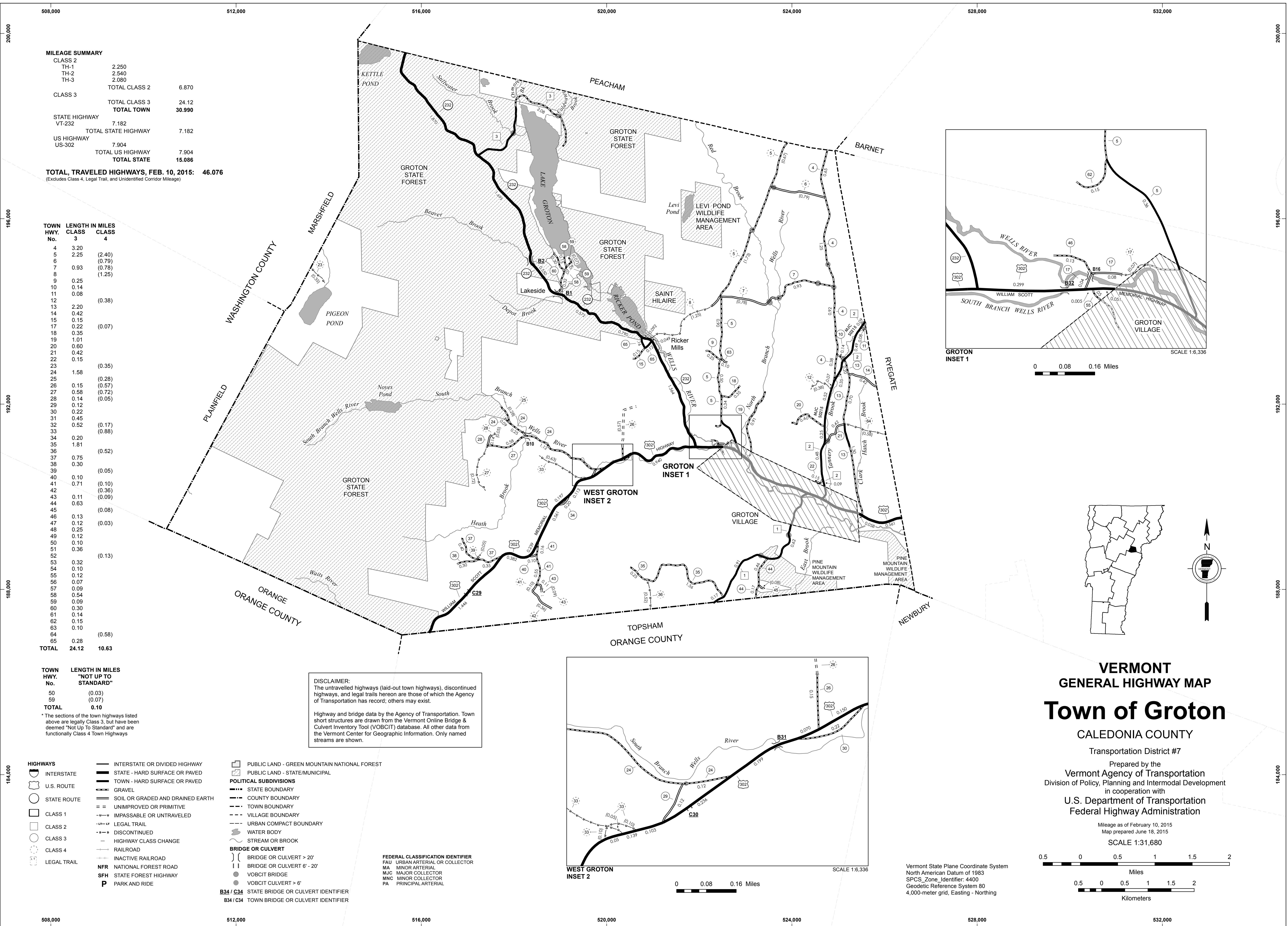

VERMONT GENERAL HIGHWAY MAP

Town of Groton

CALEDONIA COUNTY

Transportation District #7

Prepared by the Vermont Agency of Transportation
Division of Policy, Planning and Intermodal Development
in cooperation with
U.S. Department of Transportation
Federal Highway Administration

Mileage as of February 10, 2015
Map prepared June 18, 2015

SCALE 1:31,680

0.5 0 0.5 1 1.5 2 Miles

0.5 0 0.5 1 1.5 2 Kilometers

Vermont State Plane Coordinate System
North American Datum of 1983
SPCS Zone Identifier: 4400
Geodetic Reference System 80
4,000-meter grid, Easting - Northing