

MILEAGE SUMMARY

CLASS 2		
TH-1	2,250	
TH-2	2,540	
TH-3	2,080	
TOTAL CLASS 2	6,870	
CLASS 3		
TOTAL CLASS 3	25.01	
TOTAL TOWN	31.880	
STATE HIGHWAY		
VT-232	7.182	
TOTAL STATE HIGHWAY	7.182	
US HIGHWAY		
US-302	7.904	
TOTAL US HIGHWAY	7.904	
TOTAL STATE	15.086	

TOTAL TRAVELED HIGHWAYS, FEB. 10, 2013: 46.966
(Excludes Class 4, Legal Trail, and Unidentified Corridor Mileage)

TOWN HWY. No.

TOWN HWY. No.	LENGTH IN MILES CLASS 3	LENGTH IN MILES CLASS 4
4	3.20	
5	2.25	(2.40)
6		(0.79)
7	0.93	(0.78)
8		(1.25)
9	0.25	
10	0.14	
11	0.08	
12		(0.38)
13	2.20	
14	0.42	
15	0.15	
17	0.22	(0.07)
18	0.35	
19	1.01	
20	0.60	
21	0.42	
22	0.15	
23		(0.35)
24	2.47	
25		(0.28)
26	0.15	(0.57)
27	0.58	(0.72)
28	0.14	(0.05)
29	0.12	
30	0.22	
31	0.45	
32	0.52	(0.17)
33		(0.88)
34	0.20	
35	1.81	
36		(0.52)
37	0.75	
38	0.30	
39		(0.05)
40	0.10	
41	0.71	(0.10)
42		(0.36)
43	0.11	(0.09)
44	0.63	
45		(0.08)
46	0.13	
47	0.12	(0.03)
48	0.25	
49	0.12	
50	0.10	
51	0.36	
52		(0.13)
53	0.32	
54	0.10	
55	0.12	
56	0.07	
57	0.09	
58	0.54	
59	0.09	
60	0.30	
61	0.14	
62	0.15	
63	0.10	
64		(0.58)
65	0.28	
TOTAL	25.01	10.63

TOWN HWY. No.

TOWN HWY. No.	LENGTH IN MILES "NOT UP TO STANDARD"
50	(0.03)
59	(0.07)
TOTAL	0.10

* The sections of the town highways listed above are legally Class 3, but have been deemed "Not Up To Standard" and are functionally Class 4 Town Highways

DISCLAIMER: The untraveled highways (laid-out town highways), discontinued highways, and legal trails hereon are those of which the Agency of Transportation has record; others may exist. Highway and bridge data by the Agency of Transportation. All other data from the Vermont Center for Geographic Information. Only named streams are shown.

- HIGHWAYS**
 - INTERSTATE
 - U.S. ROUTE
 - STATE ROUTE
 - CLASS 1
 - CLASS 2
 - CLASS 3
 - CLASS 4
 - LEGAL TRAIL
- INTERSTATE OR DIVIDED HIGHWAY
- STATE - HARD SURFACE OR PAVED
- TOWN - HARD SURFACE OR PAVED
- GRAVEL
- SOIL OR GRADED AND DRAINED EARTH
- UNIMPROVED OR PRIMITIVE
- IMPASSABLE OR UNTRAVELED
- LEGAL TRAIL
- DISCONTINUED
- HIGHWAY CLASS CHANGE
- RAILROAD
- INACTIVE RAILROAD
- NFR NATIONAL FOREST ROAD
- SFH STATE FOREST HIGHWAY
- P PARK AND RIDE

- PUBLIC LAND - GREEN MOUNTAIN NATIONAL FOREST
- PUBLIC LAND - STATE/MUNICIPAL
- POLITICAL SUBDIVISIONS**
 - STATE BOUNDARY
 - COUNTY BOUNDARY
 - TOWN BOUNDARY
 - VILLAGE BOUNDARY
 - URBAN COMPACT BOUNDARY
- WATER BODY
- STREAM OR BROOK
- BRIDGE OR CULVERT**
 - BRIDGE OR CULVERT GREATER THAN 20'
 - BRIDGE OR CULVERT 6' - 20'
 - STATE BRIDGE OR CULVERT IDENTIFIER
 - TOWN BRIDGE OR CULVERT IDENTIFIER
- FEDERAL CLASSIFICATION IDENTIFIER
 - FAU URBAN ARTERIAL OR COLLECTOR
 - MA MINOR ARTERIAL
 - MJC MAJOR COLLECTOR
 - MNC MINOR COLLECTOR
 - PA PRINCIPAL ARTERIAL

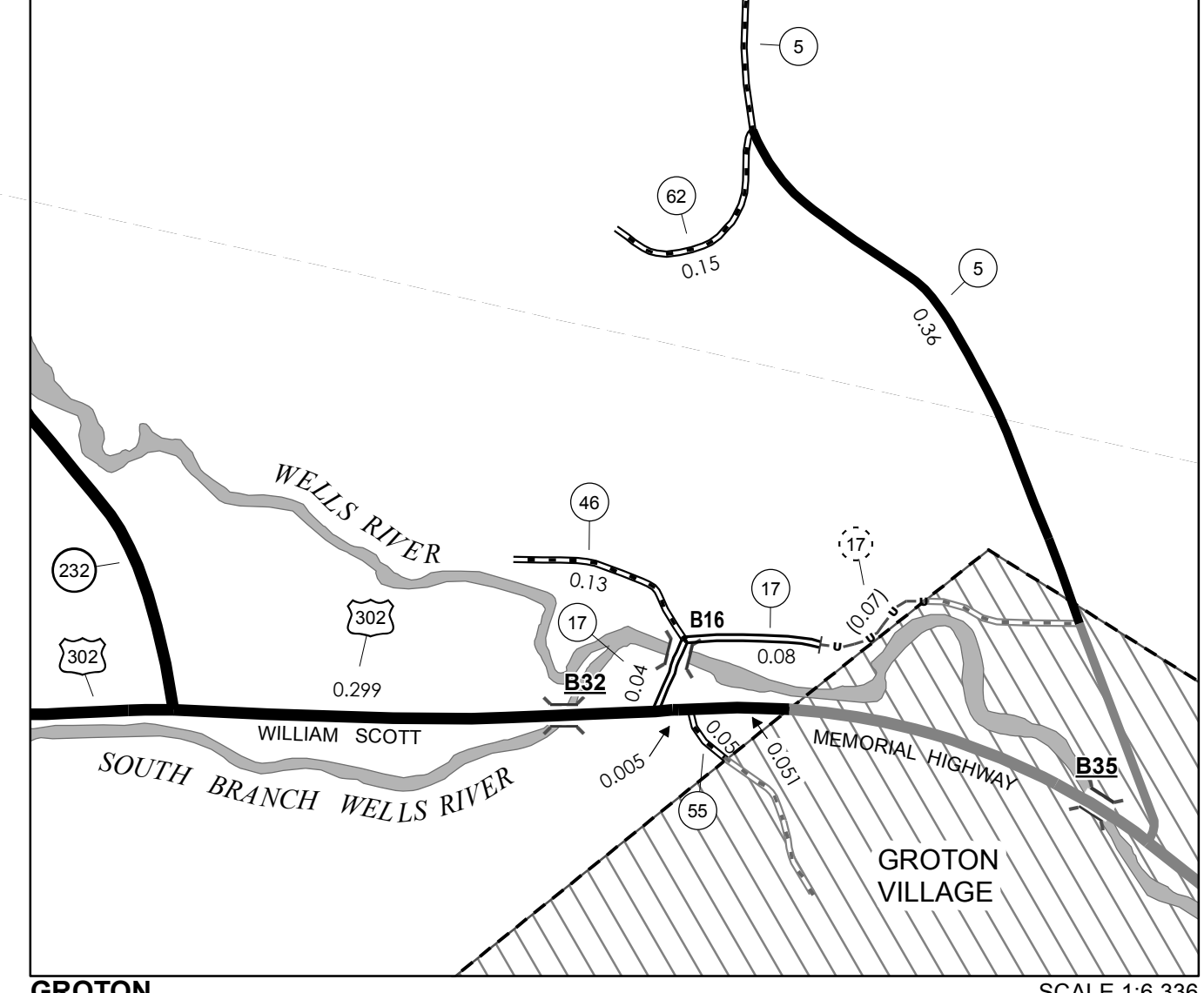

0 0.08 0.16 Miles

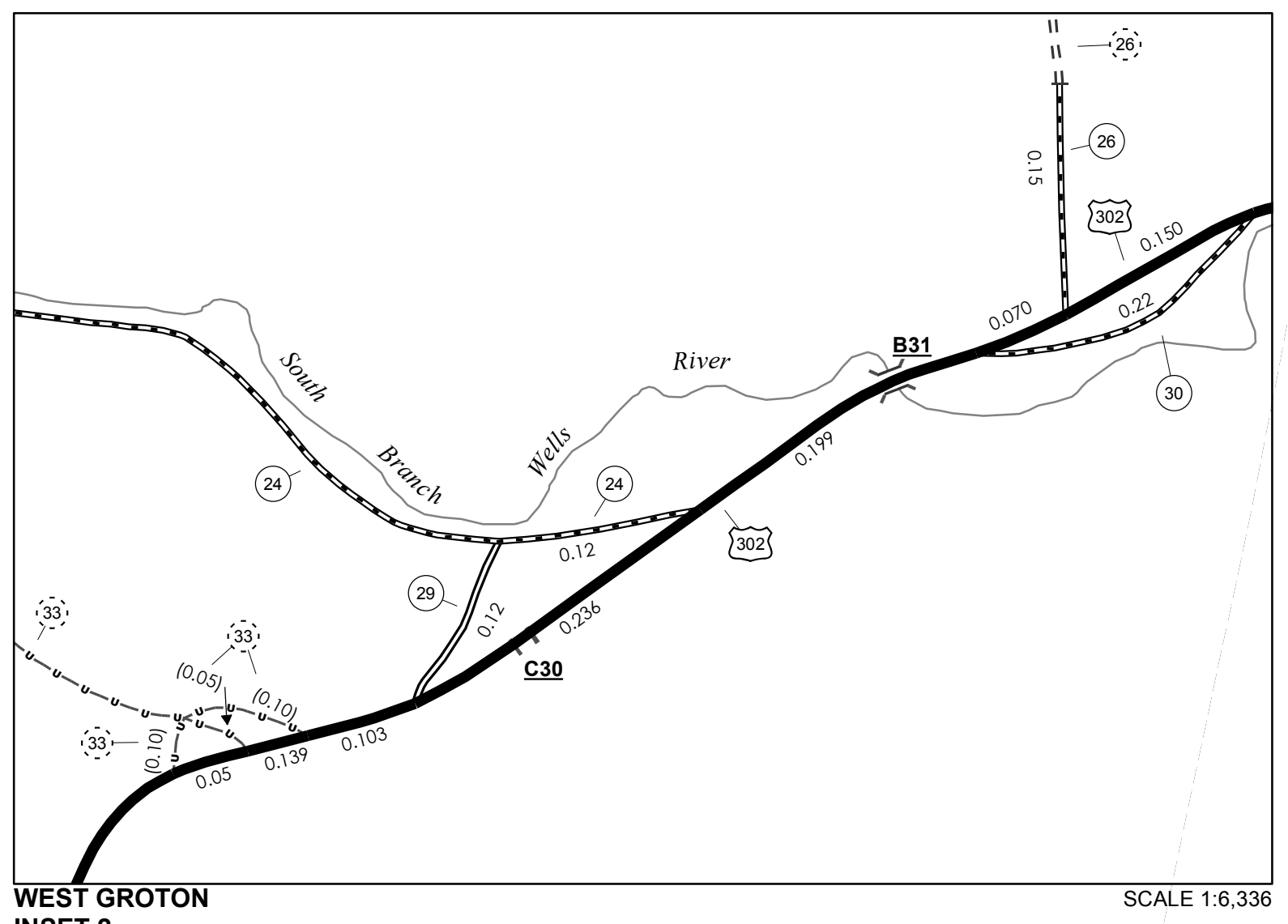

0 0.08 0.16 Miles

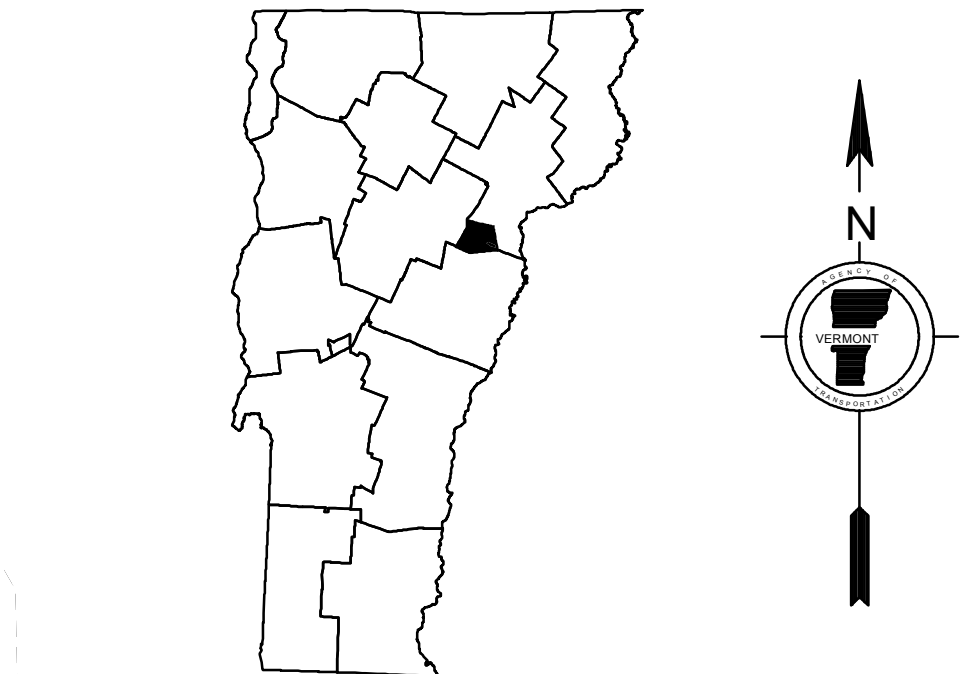

VERMONT
GENERAL HIGHWAY MAP
Town of Groton
 CALEDONIA COUNTY
 Transportation District #7
 Prepared by the
 Vermont Agency of Transportation
 Division of Policy, Planning and Intermodal Development
 in cooperation with
 U.S. Department of Transportation
 Federal Highway Administration
 Mileage as of February 10, 2013
 Map prepared October 03, 2013
 SCALE 1:31,680

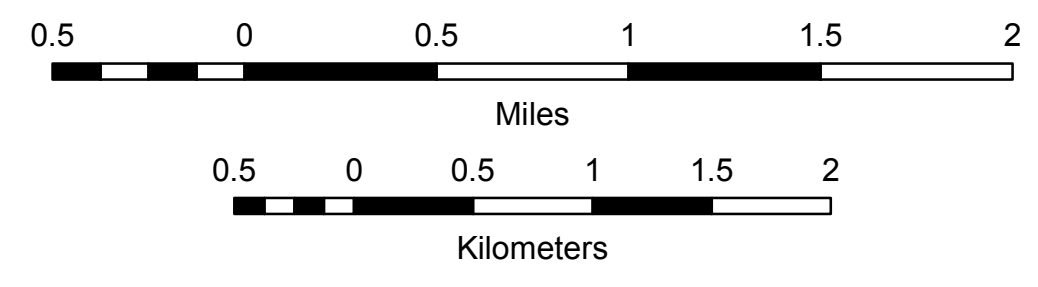

Vermont State Plane Coordinate System
 North American Datum of 1983
 SPCS Zone Identifier: 4400
 Geodetic Reference System 80
 4,000-meter grid, Easting - Northing