

TOWN HWY. No.	LENGTH IN MILES CLASS 3	LENGTH IN MILES CLASS 4	TOWN HWY. No.	LENGTH IN MILES CLASS 3	LENGTH IN MILES CLASS 4
2	1.15		41	1.09	
3	2.60		42	0.50	
5	0.23	(0.91)	43	0.27	
6	3.54		44	0.29	
7	0.21	(1.16)	45	0.15	
8	0.14		46	0.44	
9		(0.06)	47	0.28	
10	0.34		48	0.72	
12	0.41		49	0.22	
13	0.80		50	0.77	
14	0.22		51	0.32	
15	2.10		52	0.11	
16	0.46	(0.60)	53	0.12	
17	0.10		54	0.96	
19		(0.09)	55	0.48	
20	0.78		56	0.08	
21		(0.09)	57	0.30	
22	0.19		58	0.43	
23	0.31		60	0.34	
24	0.33		62	0.41	
25		(0.19)	63	0.21	
26	0.11		64	0.24	
27	1.20		65	0.22	
28	0.06		66	0.13	
29	0.29		67	0.30	
30	0.15		68	0.09	
31	1.74		69	0.07	
32	0.72		70	0.03	
33	0.25		71	0.05	
34	0.25		72	0.07	
35	0.39		74	0.26	
36	0.63		75	0.42	
37	0.10		76	0.21	
38	0.10		77	0.30	
39	0.49		78	0.47	
40	0.34				
TOTAL			32.08		3.10

MILEAGE SUMMARY

CLASS 2			
TH-1	3.563		
TH-2	6.480		
TH-3	0.110		
TH-4	1.370		
TOTAL CLASS 2			11.523
CLASS 3			
TOTAL CLASS 3			32.08
TOTAL TOWN			43.603
STATE HIGHWAY			
VT-11	4.135		
VT-30	7.752		
NSH-WSH	0.402		
TOTAL STATE HIGHWAY			12.289
TOTAL STATE			12.289

TOTAL, TRAVELED HIGHWAYS, FEB. 10, 2014: 55.892
 (Excludes Class 4, Legal Trail, and Unidentified Corridor Mileage)

TOWN HWY. No.	LENGTH IN MILES "NOT UP TO STANDARD"
5	(0.06)
7	(0.03)
TOTAL	0.09

* The sections of the town highways listed above are legally Class 3, but have been deemed "Not Up To Standard" and are functionally Class 4 Town Highways

LEGAL TRAIL No.	LENGTH IN MILES LEGAL TRAIL
1	(0.49)
TOTAL	0.49

DISCLAIMER:
 The untraveled highways (laid-out town highways), discontinued highways, and legal trails hereon are those of which the Agency of Transportation has record; others may exist.
 Highway and bridge data by the Agency of Transportation. Town short structures are drawn from the Vermont Online Bridge & Culvert Inventory Tool (VOBCIT) database. All other data from the Vermont Center for Geographic Information. Only named streams are shown.

Vermont State Plane Coordinate System
 North American Datum of 1983
 SPCS_Zone_Identifier: 4400
 Geodetic Reference System 80
 4,000-meter grid, Easting - Northing

- HIGHWAYS**
- INTERSTATE
 - U.S. ROUTE
 - STATE ROUTE
 - CLASS 1
 - CLASS 2
 - CLASS 3
 - CLASS 4
 - LEGAL TRAIL
- INTERSTATE OR DIVIDED HIGHWAY
 STATE - HARD SURFACE OR PAVED
 TOWN - HARD SURFACE OR PAVED
 GRAVEL
 SOIL OR GRADED AND DRAINED EARTH
 UNIMPROVED OR PRIMITIVE
 IMPASSABLE OR UNTRAVELED
 LEGAL TRAIL
 DISCONTINUED
 HIGHWAY CLASS CHANGE
 RAILROAD
 INACTIVE RAILROAD
 NATIONAL FOREST ROAD
 STATE FOREST HIGHWAY
 PARK AND RIDE
- PUBLIC LAND - GREEN MOUNTAIN NATIONAL FOREST
 PUBLIC LAND - STATE/MUNICIPAL
- POLITICAL SUBDIVISIONS**
- STATE BOUNDARY
 - COUNTY BOUNDARY
 - TOWN BOUNDARY
 - VILLAGE BOUNDARY
 - URBAN COMPACT BOUNDARY
 - WATER BODY
 - STREAM OR BROOK
- BRIDGE OR CULVERT**
- BRIDGE OR CULVERT > 20'
 - BRIDGE OR CULVERT 6' - 20'
 - VOBCIT BRIDGE
 - VOBCIT CULVERT > 6'
 - STATE BRIDGE OR CULVERT IDENTIFIER
 - TOWN BRIDGE OR CULVERT IDENTIFIER
- FEDERAL CLASSIFICATION IDENTIFIER**
- FAU URBAN ARTERIAL OR COLLECTOR
 - MA MINOR ARTERIAL
 - MJC MAJOR COLLECTOR
 - MNC MINOR COLLECTOR
 - PA PRINCIPAL ARTERIAL

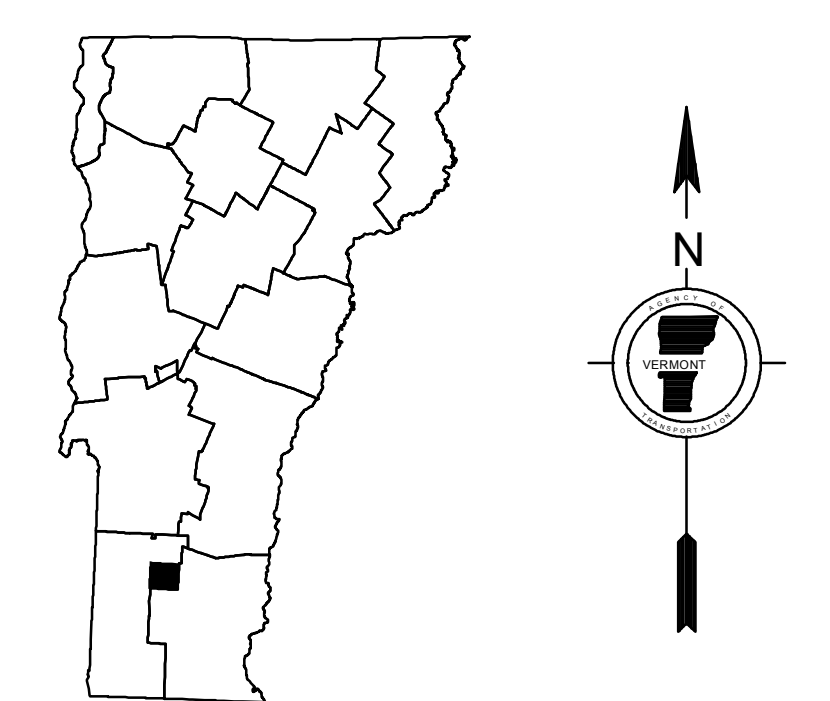
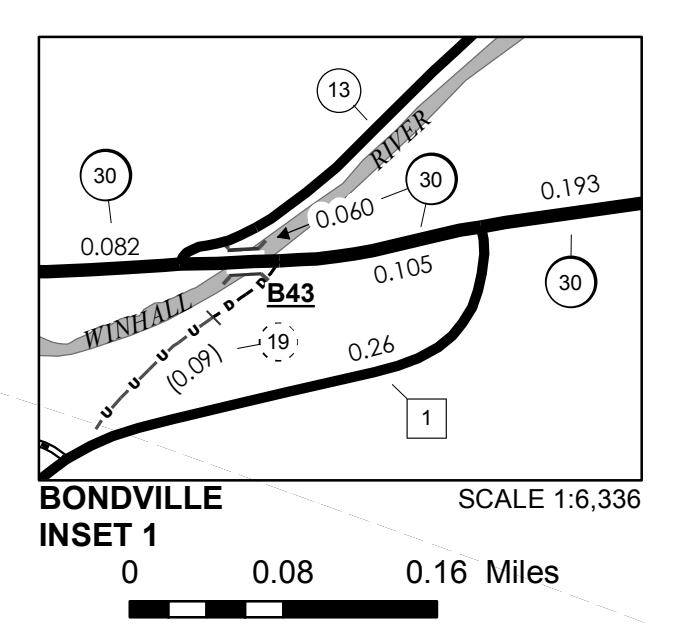
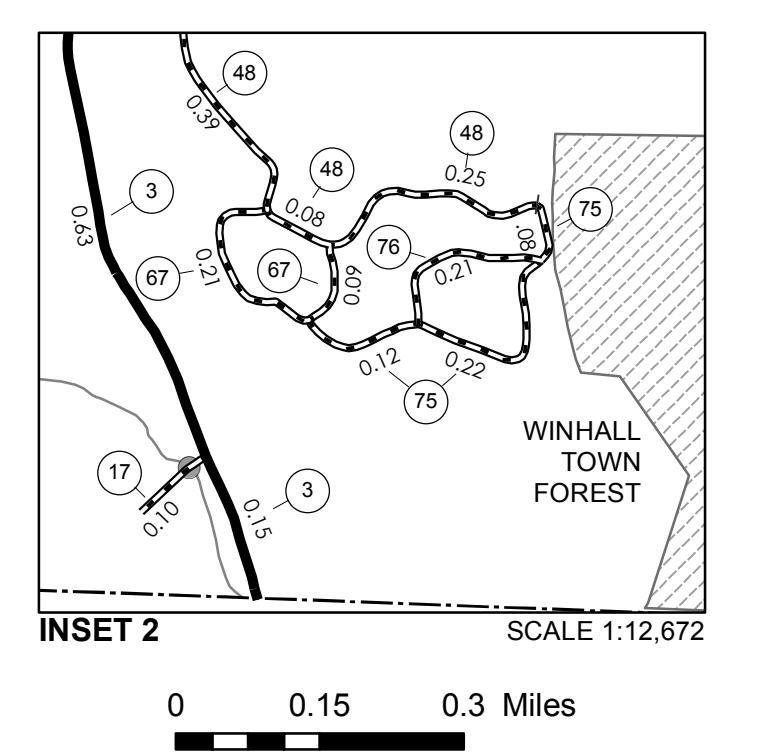
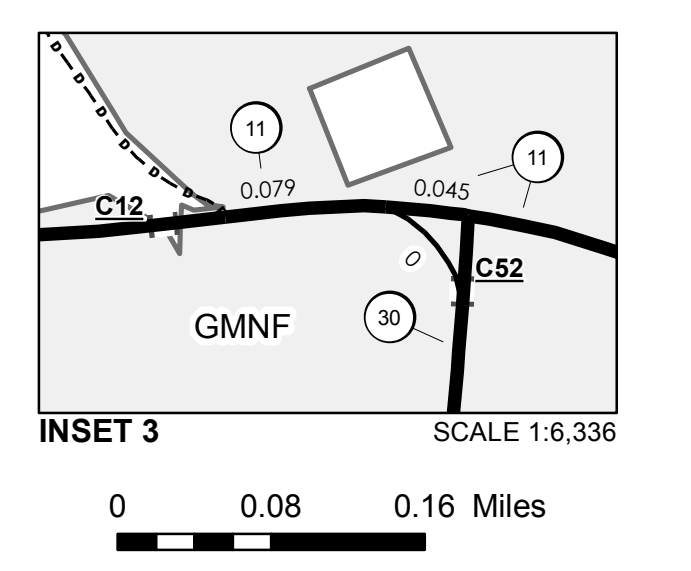

VERMONT
GENERAL HIGHWAY MAP
Town of Winhall
 BENNINGTON COUNTY
 Transportation District #1
 Prepared by the
 Vermont Agency of Transportation
 Division of Policy, Planning and Intermodal Development
 in cooperation with
 U.S. Department of Transportation
 Federal Highway Administration
 Mileage as of February 10, 2014
 Map prepared October 02, 2014
 SCALE 1:25,344
 0.35 0 0.35 0.7 1.05 1.4
 Miles
 0.4 0 0.4 0.8 1.2 1.6
 Kilometers