

TOWN HWY. NO.	LENGTH IN MILES CLASS 3	LENGTH IN MILES CLASS 4	TOTAL
2	1.150	40	0.340
3	2.600	41	1.090
5	0.230 (0.910)	42	0.500
* 5	0.230 (0.060)	43	0.270
6	3.540	44	0.290
7	0.210 (1.160)	45	0.150
* 8	0.140 (0.030)	46	0.440
9	0.210 (0.060)	47	0.280
10	0.340	48	0.720
12	0.410	49	0.220
13	0.800	50	0.770
14	0.220	51	0.320
15	2.100	52	0.110
16	0.460 (0.600)	53	0.120
17	0.100	54	0.960
19	0.100 (0.090)	55	0.480
20	0.780	56	0.080
21	0.430	57	0.300
22	0.190	58	0.430
23	0.310	60	0.340
24	0.330	62	0.410
25	0.190	63	0.210
26	0.110	64	0.240
27	1.200	65	0.220
28	0.060	66	0.130
29	0.290	67	0.300
30	0.150	68	0.090
31	1.740	69	0.070
32	0.720	70	0.030
33	0.250	71	0.050
34	0.250	72	0.070
35	0.390	74	0.260
36	0.630	75	0.420
37	0.100	76	0.210
38	0.100	77	0.300
39	0.490	78	0.470
TOTAL	32.080	3.530	0.490

* This portion of town highway is Class 3, but is functionally Class 4

MILEAGE SUMMARY

CLASS	TH-1	TH-2	TH-3	TH-4	TOTAL CLASS
CLASS 2	3.563	6.480	0.110	1.370	11.523
CLASS 3					32.080
TOTAL CLASS 3					32.080
TOTAL CLASS 2					11.523
TOTAL CLASS 3 & 2					43.603

STATE HIGHWAY	STATE HIGHWAY - Ramp	TOTAL STATE HIGHWAY
VT-11	4.135	4.135
VT-30	7.752	7.752
NSH-WSH	0.402	0.402
TOTAL STATE HIGHWAY		12.289
VT-30	0.000	0.000
TOTAL STATE HIGHWAY - Ramp		0.000
TOTAL STATE		12.289

TOTAL, TRAVELED HIGHWAYS, FEB. 10, 2007: 55.892
(Excludes Class 4 and Legal Trail Mileage)

- HIGHWAYS**
- INTERSTATE
 - U.S. ROUTE
 - STATE ROUTE
 - CLASS 1
 - CLASS 2
 - CLASS 3
 - CLASS 4
 - LEGAL TRAIL
 - INTERSTATE OR DIVIDED HIGHWAY
 - STATE - HARD SURFACE OR PAVED
 - TOWN - HARD SURFACE OR PAVED
 - GRAVEL
 - SOIL OR GRADED AND DRAINED EARTH
 - UNIMPROVED OR PRIMITIVE
 - IMPASSABLE OR UNTRAVELED
 - LEGAL TRAIL
 - DISCONTINUED
 - HIGHWAY CLASS CHANGE
 - RAILROAD
- FEDERAL CLASSIFICATION IDENTIFIER**
- FAU URBAN ARTERIAL OR COLLECTOR
 - MA MINOR ARTERIAL
 - MJC MAJOR COLLECTOR
 - MNC MINOR COLLECTOR
 - PA PRINCIPAL ARTERIAL
- POLITICAL SUBDIVISIONS**
- STATE BOUNDARY
 - COUNTY BOUNDARY
 - TOWN BOUNDARY
 - VILLAGE BOUNDARY
 - URBAN COMPACT BOUNDARY
- WATER BODIES**
- OPEN WATER
 - SWAMP
 - STREAM OR BROOK
- BRIDGE OR CULVERT**
- BRIDGE OR CULVERT GREATER THAN 20'
 - BRIDGE OR CULVERT 6' - 20'
- STATE BRIDGE IDENTIFIER**
B34
- TOWN BRIDGE IDENTIFIER**
B34

DISCLAIMER:
The untraveled highways (laid-out town highways), discontinued highways, and legal trails shown hereon are those of which the Agency of Transportation has record; others may exist.
Highway and bridge data by the Agency of Transportation, Policy & Planning Division. All other data from the Vermont Center for Geographic Information.

Vermont State Plane Coordinate System
North American Datum of 1983
SPCS Zone Identifier: 4400
Geodetic Reference System 80
4,000-meter grid, Easting - Northing

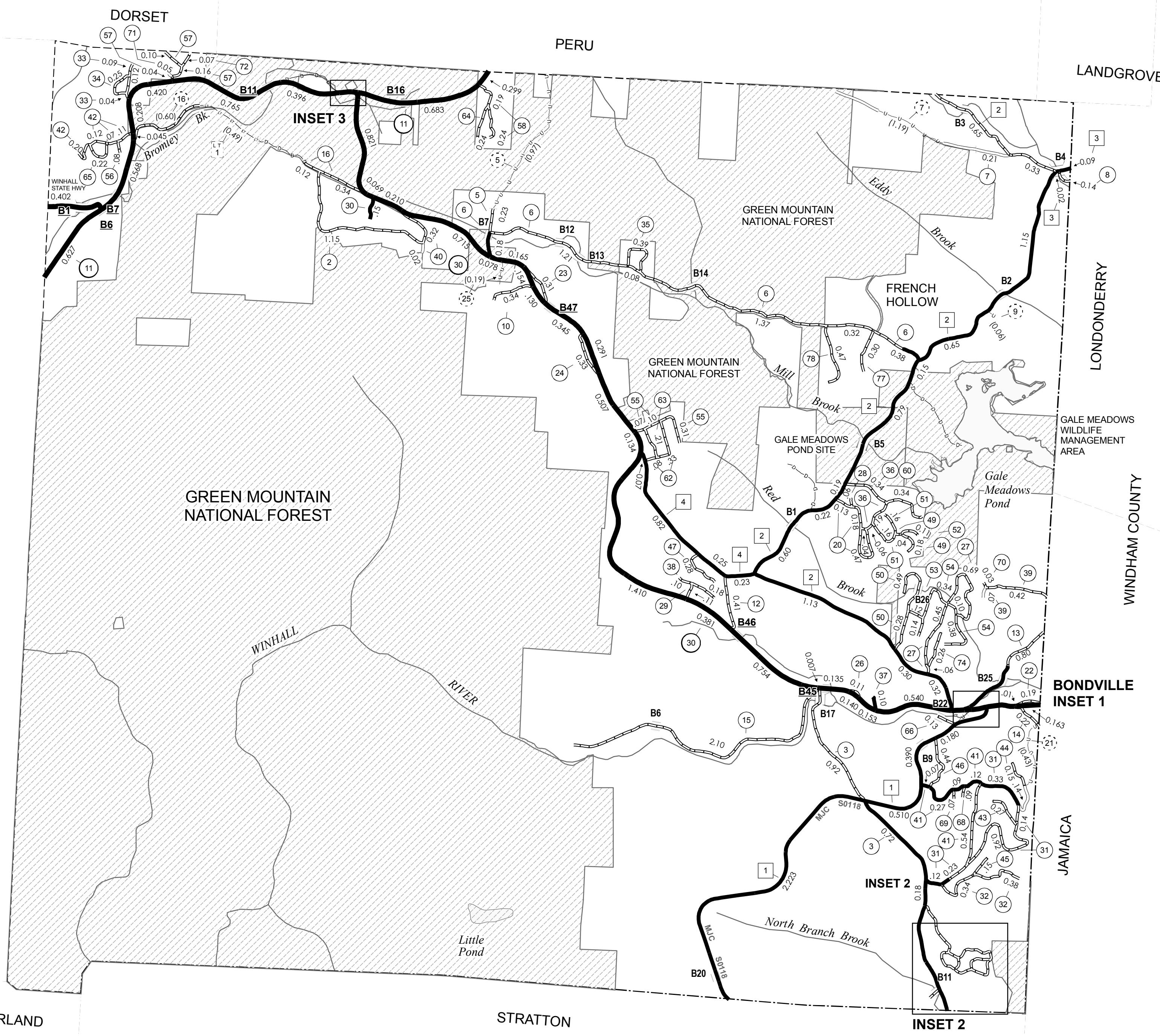
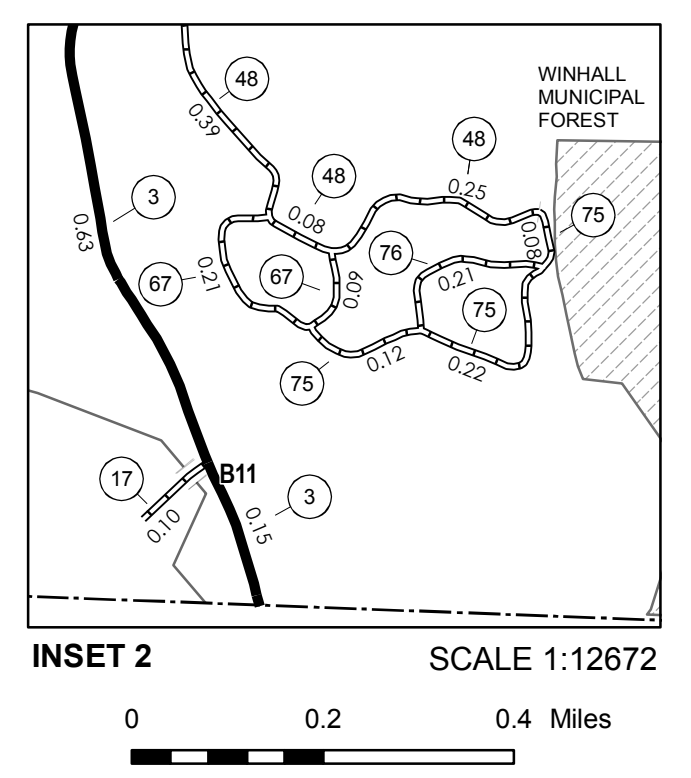
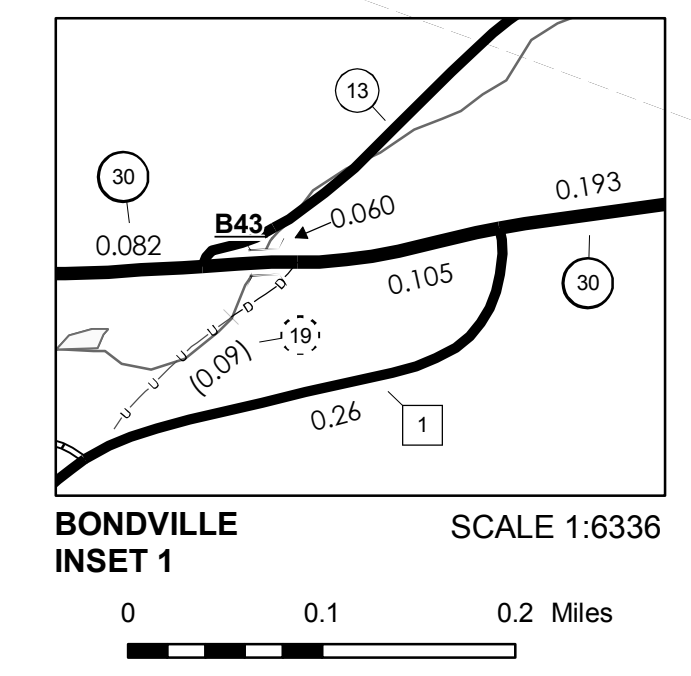
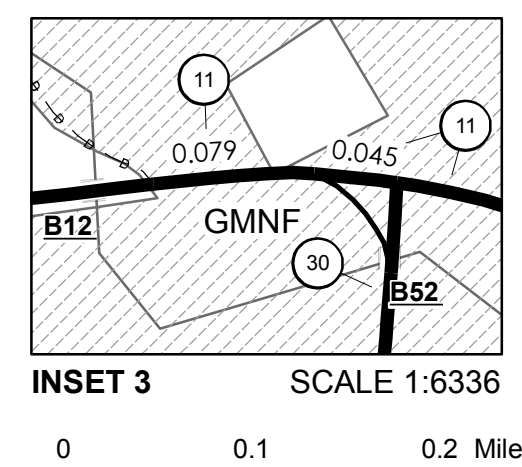

VERMONT
GENERAL HIGHWAY MAP
Town of Winhall
BENNINGTON COUNTY

Transportation District #1

Prepared by the
Vermont Agency of Transportation
Policy & Planning Division
in cooperation with
U.S. Department of Transportation
Federal Highway Administration

Map as of: Feb. 10, 2007
Map generated: October, 2007

