

TOWN HWY. NO.	LENGTH IN MILES CLASS 3	LENGTH IN MILES CLASS 4	LEGAL TRAIL NO.	LENGTH IN MILES LEGAL TRAIL
7	3.55		50	0.20
8	1.27		52	0.28
9	7.05		53	0.14
10	1.55		54	2.72
11	0.27		55	0.13
12	0.54		56	0.13
13	0.17		58	0.14
14	0.35		59	0.13
15	0.50		60	0.21
16	0.34		61	0.12
17	0.23	(0.22)	62	0.07
18	1.31		63	0.10
19	0.08		64	0.87
20	1.60		66	0.51
21	0.25		67	1.88
22	0.85		68	0.38
23	0.04		71	0.43
24	0.07		72	0.40
25	0.60		73	0.10
26	2.08		74	0.36
27	1.25		76	0.14
28	0.45		77	0.25
29	0.71		77	(0.27)
30	0.72		78	(0.26)
31	0.16		81	0.55
32	0.13		82	0.06
33	1.18		83	0.08
34	0.36		86	0.14
35	0.88		87	0.07
36	0.19		88	0.20
37	0.13		90	0.15
38	0.73		91	0.14
39	0.69		92	0.32
40	0.75		93	0.20
41	0.57		94	0.06
42	1.35		95	0.09
43	1.61		96	0.48
44	0.85		97	0.18
45	1.05		98	0.09
46	0.30		99	0.24
47	0.51		100	0.13
48	0.13		101	(0.95)
49	0.17			
TOTAL	50.44	1.70		

LEGAL TRAIL NO. 1 (0.80)
TOTAL 0.80

(The above is a listing of confirmed Legal Trails, unconfirmed Legal Trails also exist)

* This portion of town highway is Class 3, but is functionally Class 4

MILEAGE SUMMARY	
CLASS 2	
TH-1	2.010
TH-2	0.270
TH-3	2.840
TH-4	0.470
TH-5	7.120
TH-6	2.000
TH-7	5.280
TOTAL CLASS 2	19.990
CLASS 3	
TOTAL CLASS 3	50.440
TOTAL TOWN	70.430
STATE HIGHWAY	
VT-7A	6.895
VT-67	3.590
TOTAL STATE HIGHWAY	10.485
US HIGHWAY	
US-7	5.364
TOTAL US HIGHWAY	5.364
TOTAL STATE	15.849
TOTAL, TRAVELED HIGHWAYS, FEB. 10, 2011:	86.279

(Excludes Class 4, Legal Trail, and Unidentified Corridor Mileage)

- HIGHWAYS**
 - INTERSTATE
 - U.S. ROUTE
 - STATE ROUTE
 - CLASS 1
 - CLASS 2
 - CLASS 3
 - CLASS 4
 - LEGAL TRAIL
 - INTERSTATE OR DIVIDED HIGHWAY
 - STATE - HARD SURFACE OR PAVED
 - TOWN - HARD SURFACE OR PAVED
 - GRAVEL
 - SOIL OR GRADED AND DRAINED EARTH
 - UNIMPROVED OR PRIMITIVE
 - IMPASSABLE OR UNTRAVELED
 - LEGAL TRAIL
 - DISCONTINUED
 - HIGHWAY CLASS CHANGE
 - RAILROAD
 - INACTIVE RAILROAD
- PUBLIC LAND**
- POLITICAL SUBDIVISIONS**
 - STATE BOUNDARY
 - COUNTY BOUNDARY
 - TOWN BOUNDARY
 - VILLAGE BOUNDARY
 - URBAN COMPACT BOUNDARY
 - WATER BODY
 - STREAM OR BROOK
 - BRIDGE OR CULVERT
 - BRIDGE OR CULVERT GREATER THAN 20'
 - BRIDGE OR CULVERT 6' - 20'
 - TOWN SHORT STRUCTURE
- FEDERAL CLASSIFICATION IDENTIFIER**
 - FAU URBAN ARTERIAL OR COLLECTOR
 - MA MINOR ARTERIAL
 - MJC MAJOR COLLECTOR
 - MNC MINOR COLLECTOR
 - PA PRINCIPAL ARTERIAL

STRUCTURES - SURFACE WATER NOTE:

STRUCTURES:
 Town short structures (bridges or culverts from 6-feet to less than 20-feet) are drawn from the Vermont Online Bridge & Culvert Inventory Tool (VOBCIT) database.
 NOTE: Town shorts are not consistently tagged within VOBCIT.

SURFACE WATERS:
 The surface waters are from the Vermont Hydrological Dataset (VHD). Only the named streams are shown.

DISCLAIMER:

The untraveled highways (laid-out town highways), discontinued highways, and legal trails shown hereon are those of which the Agency of Transportation has record; others may exist.

Highway and bridge data by the Agency of Transportation. All other data from the Vermont Center for Geographic Information.

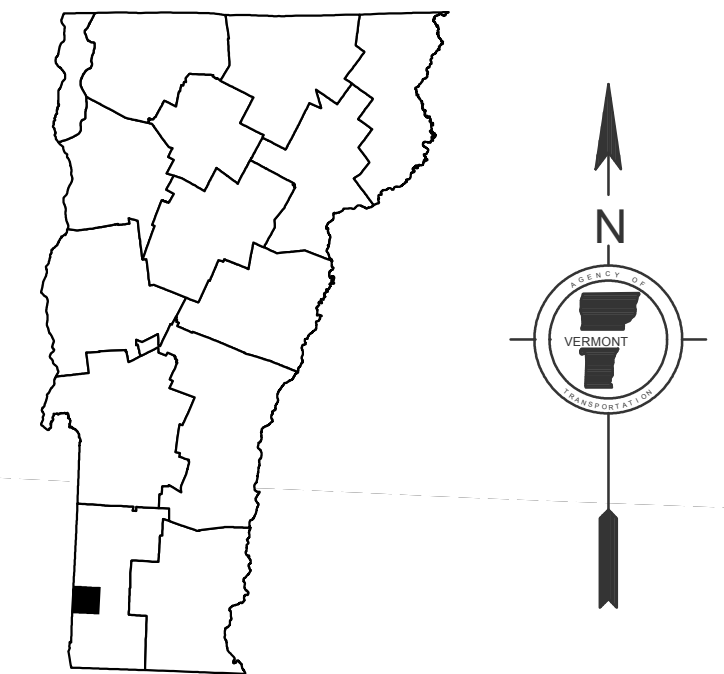
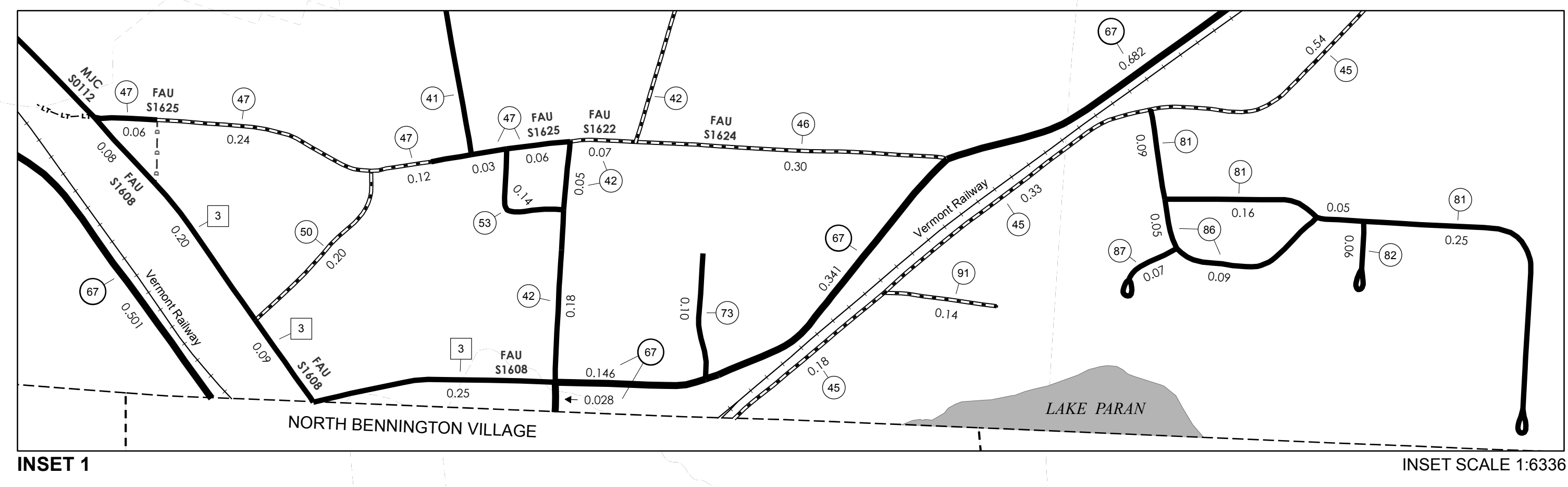
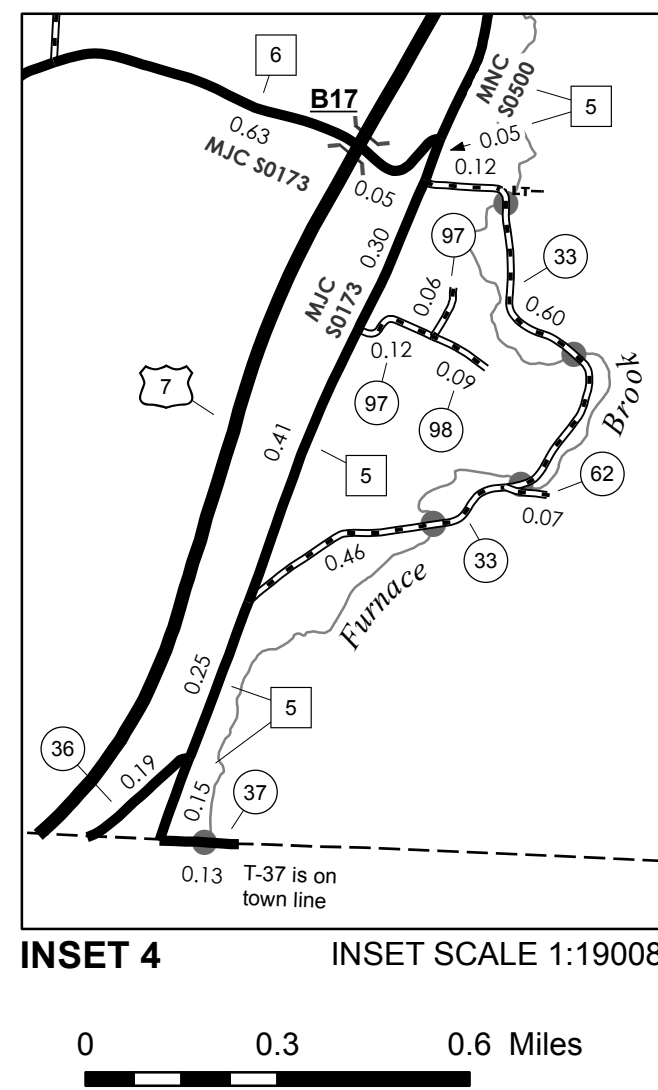
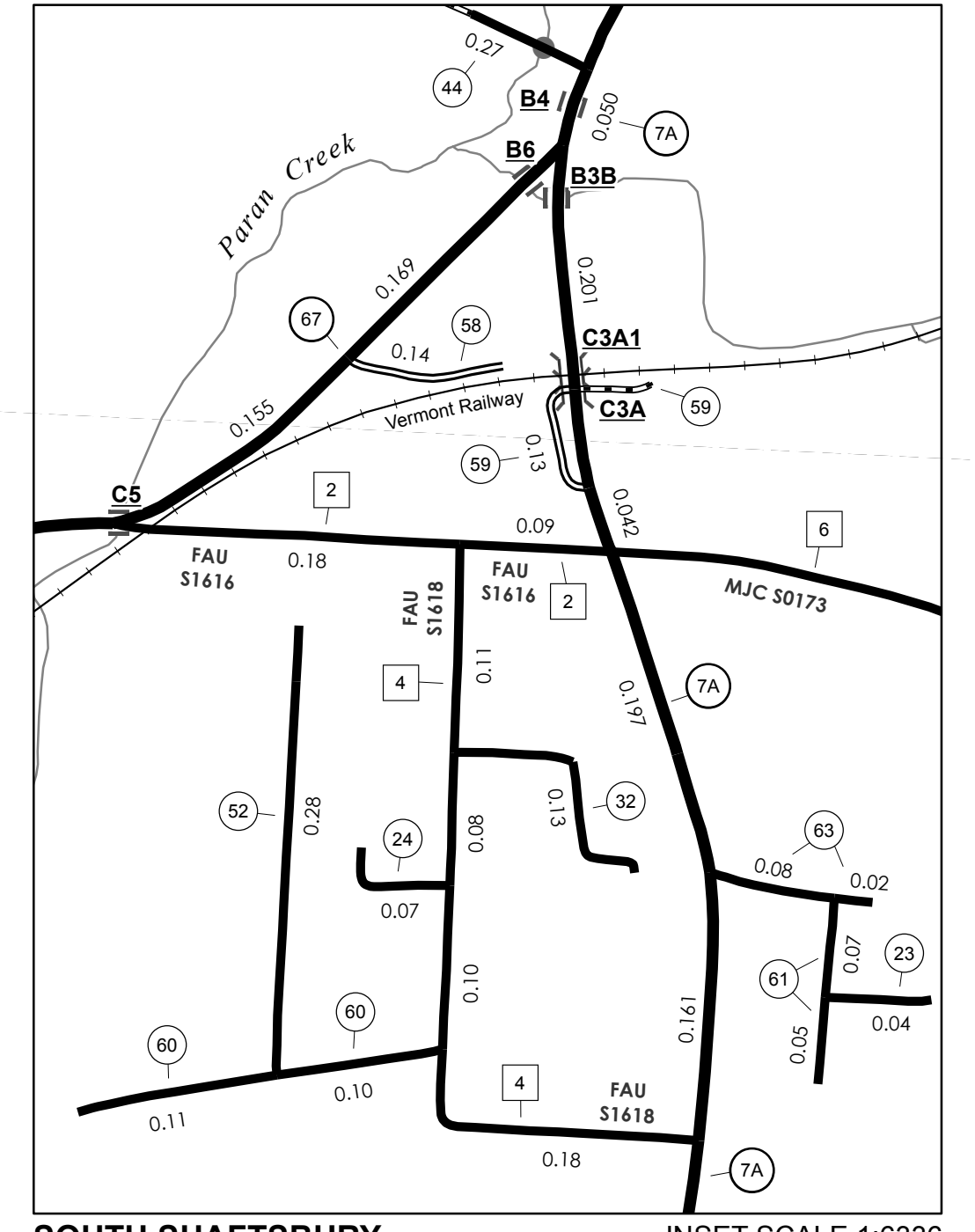
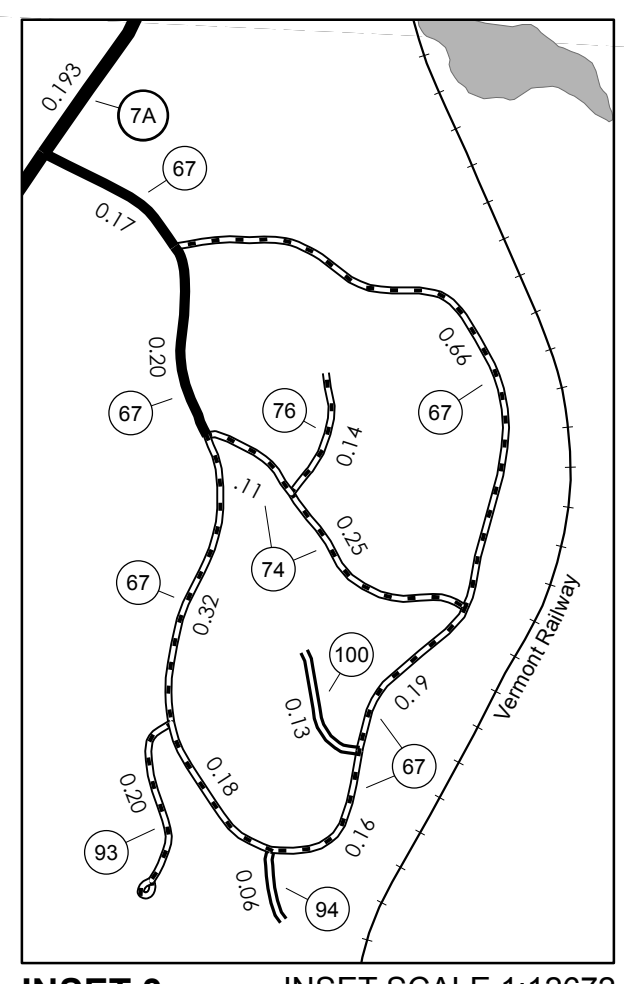
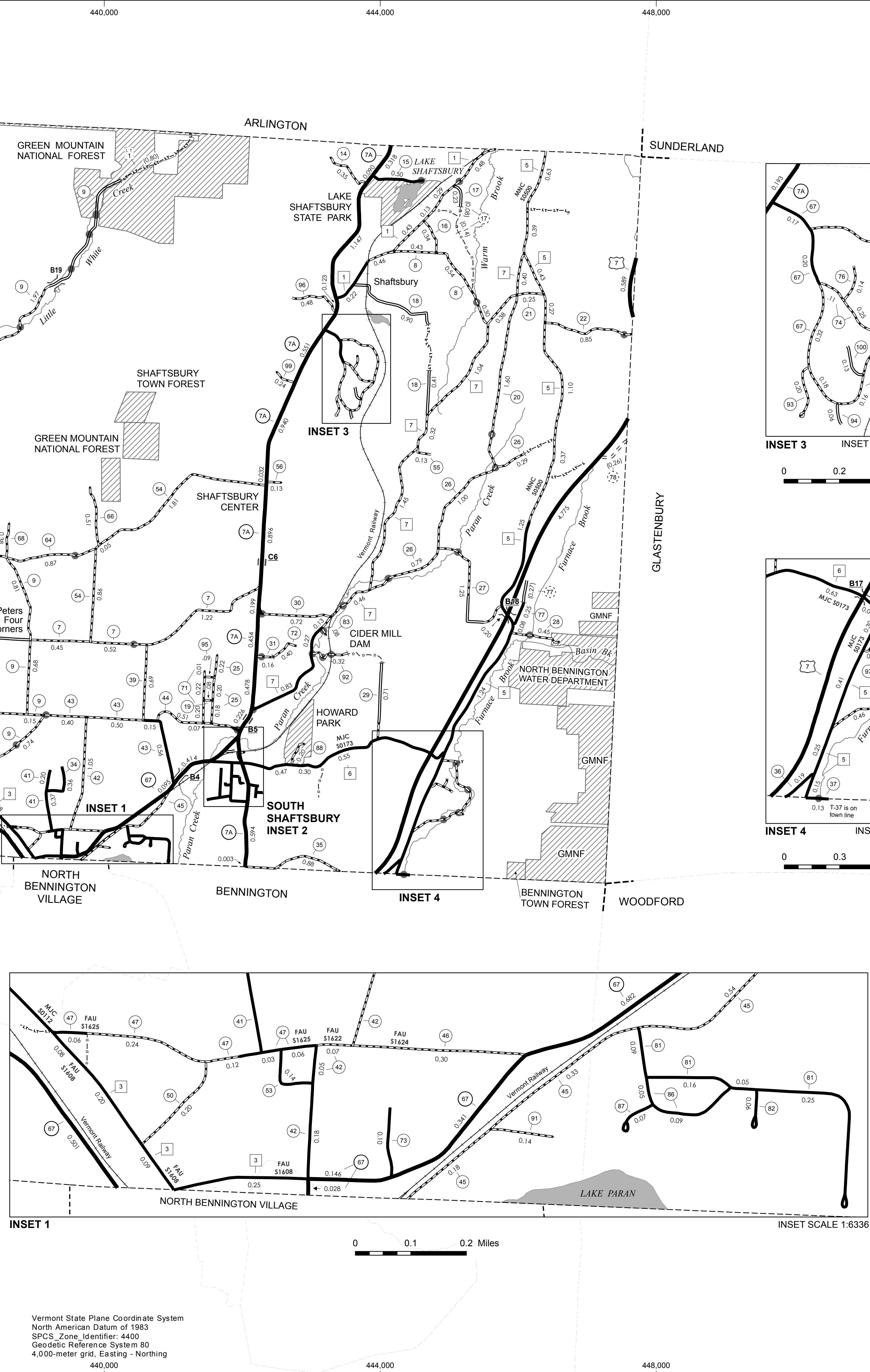

VERMONT GENERAL HIGHWAY MAP
Town of Shaftsbury
 BENNINGTON COUNTY
 Transportation District #1

Prepared by the
 Vermont Agency of Transportation
 Division of Policy, Planning & Intermodal Development
 in cooperation with
 U.S. Department of Transportation
 Federal Highway Administration

Mileage as of February 10, 2011
 Map prepared October 25, 2011

SCALE 1:31,680

0.5 0 0.5 1 1.5 2 Miles

1 0 1 2 Kilometers

Vermont State Plane Coordinate System
 North American Datum of 1983
 SPCS Zone Identifier: 4400
 Geoidetic Reference System 80
 4,000-meter grid, Easting - Northing