

NORTH POWNA INSET 1

0 0.075 0.15 Miles

SCALE 1:6,336

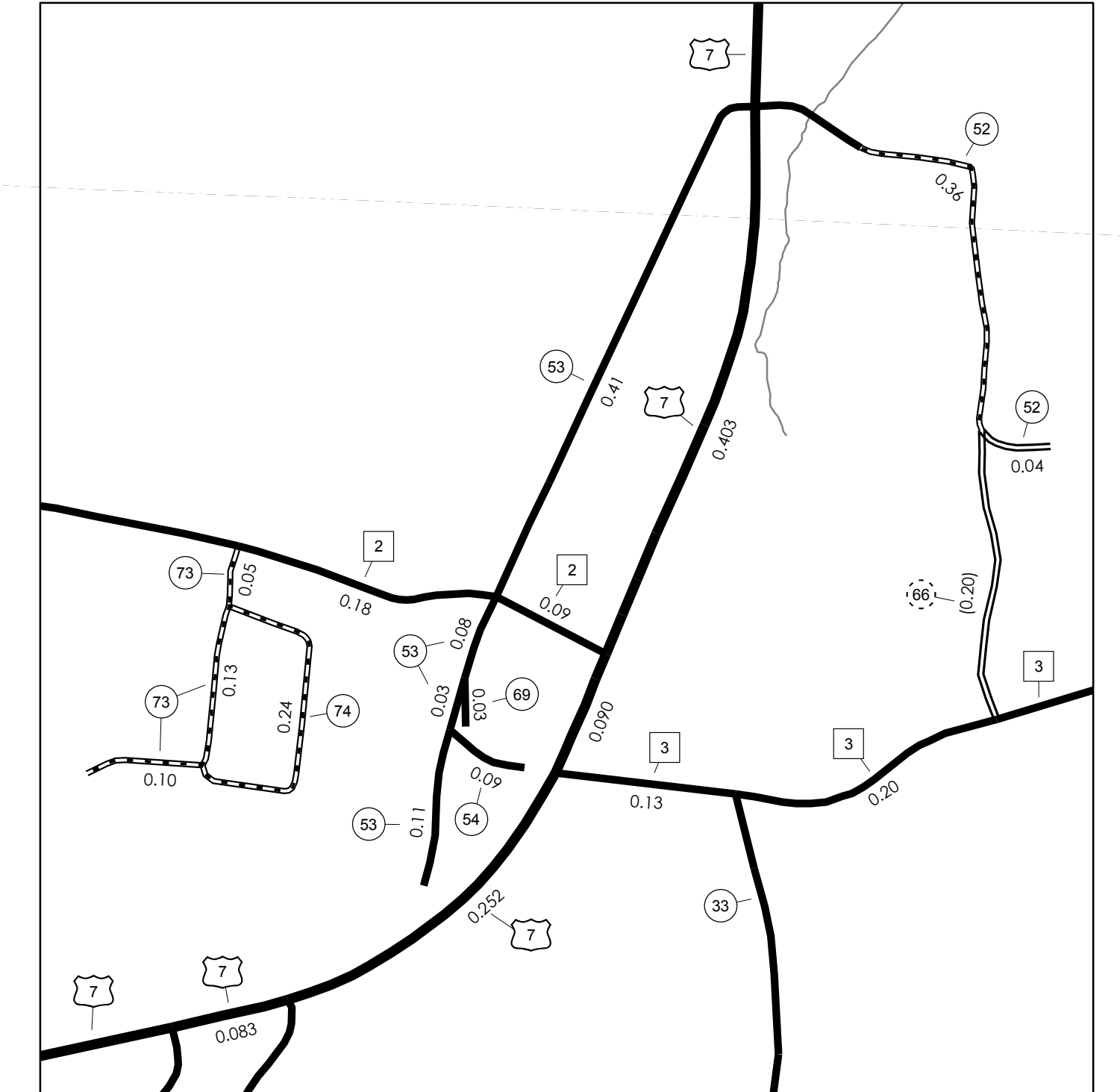

POWNA CENTER INSET 3

0 0.08 0.16 Miles

SCALE 1:6,336

MILEAGE SUMMARY

CLASS 2			
TH-1	0.300		
TH-2	2.890		
TH-3	5.250		
TH-4	3.410		
TOTAL CLASS 2	11.850		
CLASS 3			
TOTAL CLASS 3	51.98		
TOTAL TOWN	63.830		
STATE HIGHWAY			
VT-346	4.628		
TOTAL STATE HIGHWAY	4.628		
US HIGHWAY			
US-7	7.988		
TOTAL US HIGHWAY	7.988		
TOTAL STATE	12.616		
TOTAL, TRAVELED HIGHWAYS, FEB. 10, 2013:	76.446		

(Excludes Class 4, Legal Trail, and Unidentified Corridor Mileage)

TOWN HWY. No.	LENGTH IN MILES "NOT UP TO STANDARD"
29	(0.14)
34	(0.24)
38	(0.63)
TOTAL	1.01

* The sections of the town highways listed above are legally Class 3, but have been deemed "Not Up To Standard" and are functionally Class 4 Town Highways

LEGAL TRAIL No.	LENGTH IN MILES LEGAL TRAIL
1	(0.10)
TOTAL	0.10

TOWN HWY. No.	LENGTH IN MILES CLASS 3	LENGTH IN MILES CLASS 4	TOWN HWY. No.	LENGTH IN MILES CLASS 3	LENGTH IN MILES CLASS 4	TOWN HWY. No.	LENGTH IN MILES CLASS 3	LENGTH IN MILES CLASS 4
4	3.80		29	1.12	(0.53)	54	0.09	
5	3.85		30	0.45		55	0.08	
6	3.27		31	0.47		56	0.31	
8	0.62	(0.82)	32	0.20		57	0.09	
9	1.80		33	1.30		58	0.09	
10	2.50		34	1.51		59	0.11	
11	1.10		35	1.32	(2.28)	60	0.59	
12	1.11	(0.09)	36	1.58	(1.34)	61	0.05	
13		(0.40)	37	0.89		62	0.08	
14	0.32	(0.40)	39	0.01	(0.19)	63	0.28	
15	0.43		40	2.38	(0.42)	64	0.40	
16	1.77		41	0.60		65	0.51	
17	2.32		42	0.95	(0.72)	66		(0.20)
18	0.37		43	0.31		67	0.54	
19	1.95		44	0.70		68	0.25	
20	0.35		45	0.28		69	0.03	
21	0.09	(0.31)	46	0.04		70	0.19	
22	0.52		47	1.22		71	0.13	
23	0.51		48	0.28		72	0.08	
24	0.52		49	0.28	(0.37)	73	0.28	
25	0.23		50	0.11		74	0.24	
26	0.25		51	0.05		75	0.32	
27	1.00		52	0.40		76	0.11	
28	0.85		53	0.63		77	0.54	
TOTAL	51.98		TOTAL	8.07				

- HIGHWAYS**
- INTERSTATE OR DIVIDED HIGHWAY
 - INTERSTATE
 - U.S. ROUTE
 - STATE ROUTE
 - CLASS 1
 - CLASS 2
 - CLASS 3
 - CLASS 4
 - LEGAL TRAIL
 - DISCONTINUED
 - HIGHWAY CLASS CHANGE
 - RAILROAD
 - INACTIVE RAILROAD
 - NFR NATIONAL FOREST ROAD
 - SFH STATE FOREST HIGHWAY
 - P PARK AND RIDE

- PUBLIC LAND - GREEN MOUNTAIN NATIONAL FOREST
- PUBLIC LAND - STATE/MUNICIPAL
- POLITICAL SUBDIVISIONS**
- STATE BOUNDARY
- COUNTY BOUNDARY
- TOWN BOUNDARY
- VILLAGE BOUNDARY
- URBAN COMPACT BOUNDARY
- WATER BODY
- STREAM OR BROOK
- BRIDGE OR CULVERT**
- BRIDGE OR CULVERT GREATER THAN 20'
- BRIDGE OR CULVERT 6' - 20'
- B34 / C34 STATE BRIDGE OR CULVERT IDENTIFIER
- B34 / C34 TOWN BRIDGE OR CULVERT IDENTIFIER

- FEDERAL CLASSIFICATION IDENTIFIER**
- FAU URBAN ARTERIAL OR COLLECTOR
 - MA MINOR ARTERIAL
 - MAJ.C MAJOR COLLECTOR
 - MNC MINOR COLLECTOR
 - PA PRINCIPAL ARTERIAL

DISCLAIMER:
The untraveled highways (laid-out town highways), discontinued highways, and legal trails hereon are those of which the Agency of Transportation has record; others may exist.

Highway and bridge data by the Agency of Transportation. All other data from the Vermont Center for Geographic Information. Only named streams are shown.

Vermont State Plane Coordinate System
North American Datum of 1983
SPCS_Zone_Identifier: 4400
Geodetic Reference System 80
4,000-meter grid, Easting - Northing

**VERMONT
GENERAL HIGHWAY MAP**

Town of Pownal

BENNINGTON COUNTY

Transportation District #1

Prepared by the
Vermont Agency of Transportation
Division of Policy, Planning and Intermodal Development
in cooperation with

U.S. Department of Transportation
Federal Highway Administration

Mileage as of February 10, 2013
Map prepared October 15, 2013

SCALE 1:31,680

