

TOWN HWY. No.	LENGTH IN MILES CLASS 3	LENGTH IN MILES CLASS 4	TOWN HWY. No.	LENGTH IN MILES CLASS 3	LENGTH IN MILES CLASS 4
8	0.50		45	0.12	
9	0.22		46	0.18	
10	0.35	(0.06)	48	0.61	
11	1.80		49	0.29	
12	0.79		51	0.16	
13		(2.85)	52	0.47	
14	0.34		53	0.38	
15	0.32		54	0.25	
16	0.04	(0.86)	55	1.16	
18	0.45		56	0.45	
19	0.69		57	0.33	
20	1.04		58	0.11	
21	1.18		60	0.07	
22	0.58		61	0.22	
23	0.09		62	0.16	
24	0.38		63	0.30	
25	0.14		64	0.42	
26	0.60	(1.87)	65	0.16	
28	0.23		66	0.10	
29	0.11		67	0.28	
31	0.54		68	0.23	
32	0.34		69	0.09	
33	0.15		70	0.09	
34		(0.12)	72	0.72	
35	0.62		75	0.21	
36	0.70		76	0.17	
37	0.52	(1.00)	77	0.50	
38	0.13		78	0.37	
40	0.04		79	0.36	
41	0.19		80	0.16	
42	0.20		81	0.21	
43	0.19		82	0.27	
44	0.11		83	0.10	
TOTAL			23.37		6.76

TOWN HWY. No.	LENGTH IN MILES "NOT UP TO STANDARD"
13	(0.50)
39	(0.15)
TOTAL	0.65

* The sections of the town highways listed above are legally Class 3, but have been deemed "Not Up to Standard" and are functionally Class 4 Town Highways

MILEAGE SUMMARY		
CLASS 1		
TH-1	3.127	
TH-2	0.309	
TH-3	1.272	
TOTAL CLASS 1	4.708	
CLASS 1 - Ramps		
TH-1	0.025	
TOTAL CLASS 1 - Ramps	0.025	
CLASS 2		
TH-3	2.170	
TH-4	1.980	
TH-5	0.400	
TH-6	3.870	
TH-7	1.750	
TH-8	2.100	
TH-9	0.070	
TH-10	1.520	
TH-11	1.790	
TOTAL CLASS 2	15.650	
CLASS 3		
TOTAL CLASS 3	23.37	
TOTAL TOWN	43.763	
STATE HIGHWAY		
VT-7A	3.047	
VT-11	1.991	
VT-30	2.480	
TOTAL STATE HIGHWAY	7.518	
US HIGHWAY		
US-7	7.520	
TOTAL US HIGHWAY	7.520	
US HIGHWAY - Ramps		
US-7	1.558	
TOTAL US HIGHWAY - Ramps	1.558	
TOTAL STATE	16.596	

TOTAL, TRAVELED HIGHWAYS, FEB. 10, 2017: 60.349
(Excludes Class 4 and Legal Trail Mileage)

DISCLAIMER:
The untraveled highways (laid-out town highways), discontinued highways, and legal trails hereon are those of which the Agency of Transportation has record; others may exist.

Highway and bridge data by the Agency of Transportation. Town short structures drawn from the Vermont Online Bridge & Culvert Inventory Tool (VOBCIT) database. All other data from the Vermont Center for Geographic Information. Only named streams shown.

Vermont State Plane Coordinate System
North American Datum of 1983
SPCS_Zone_Identifier: 4400
Geodetic Reference System 80
4,000-meter grid, Easting - Northing

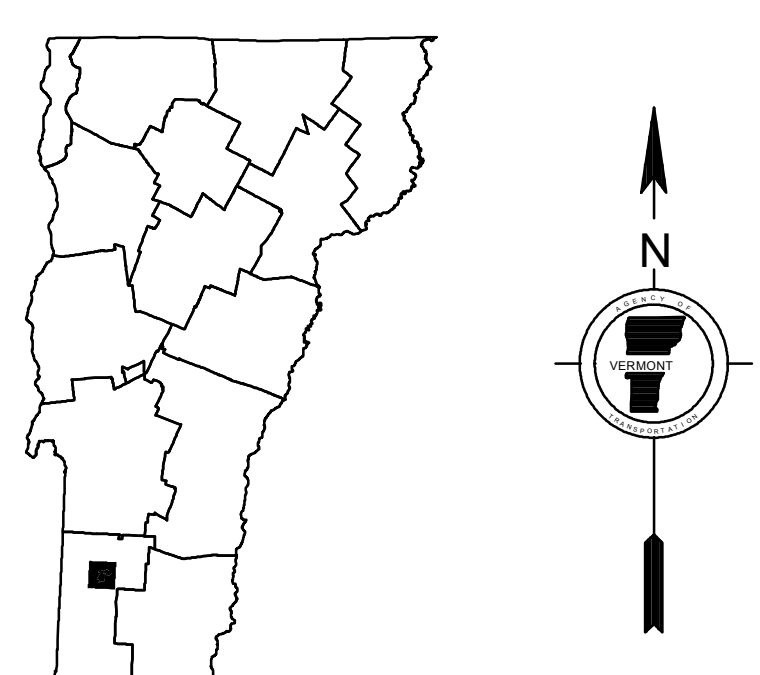
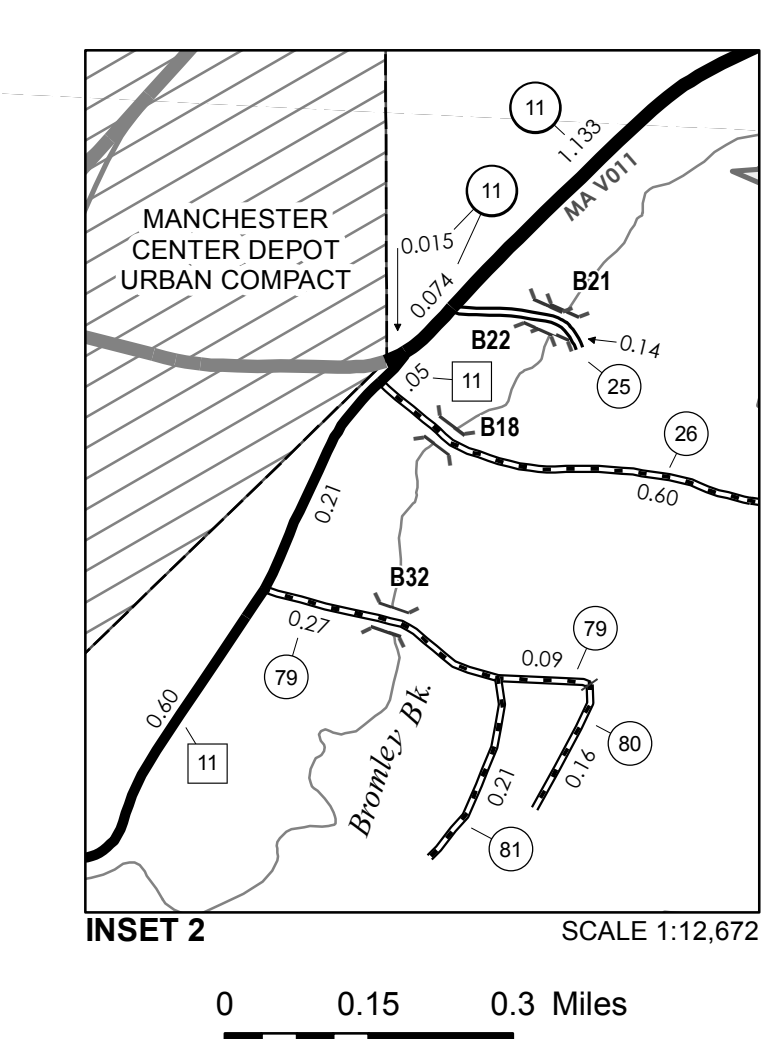
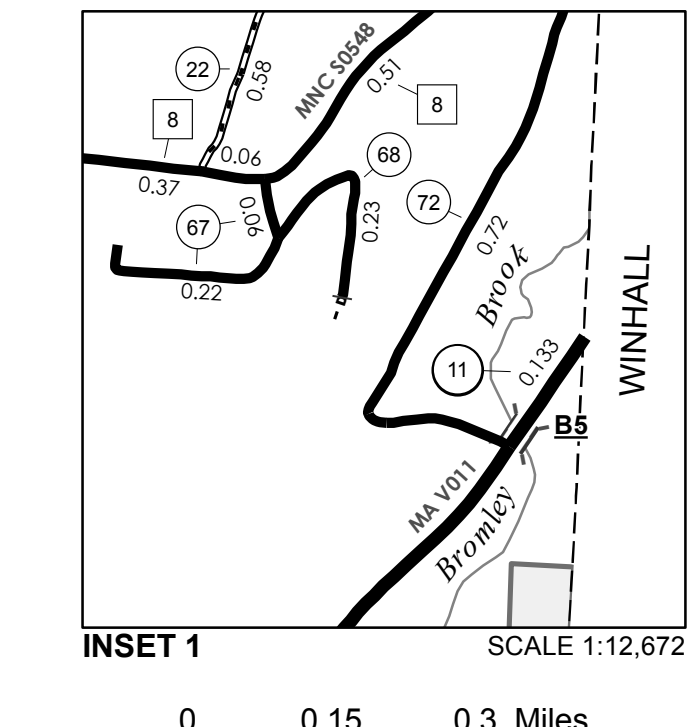
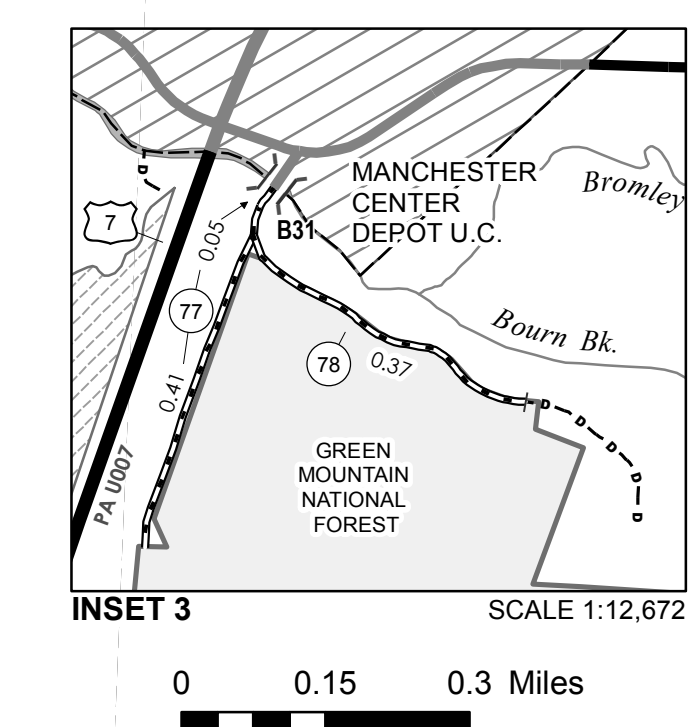
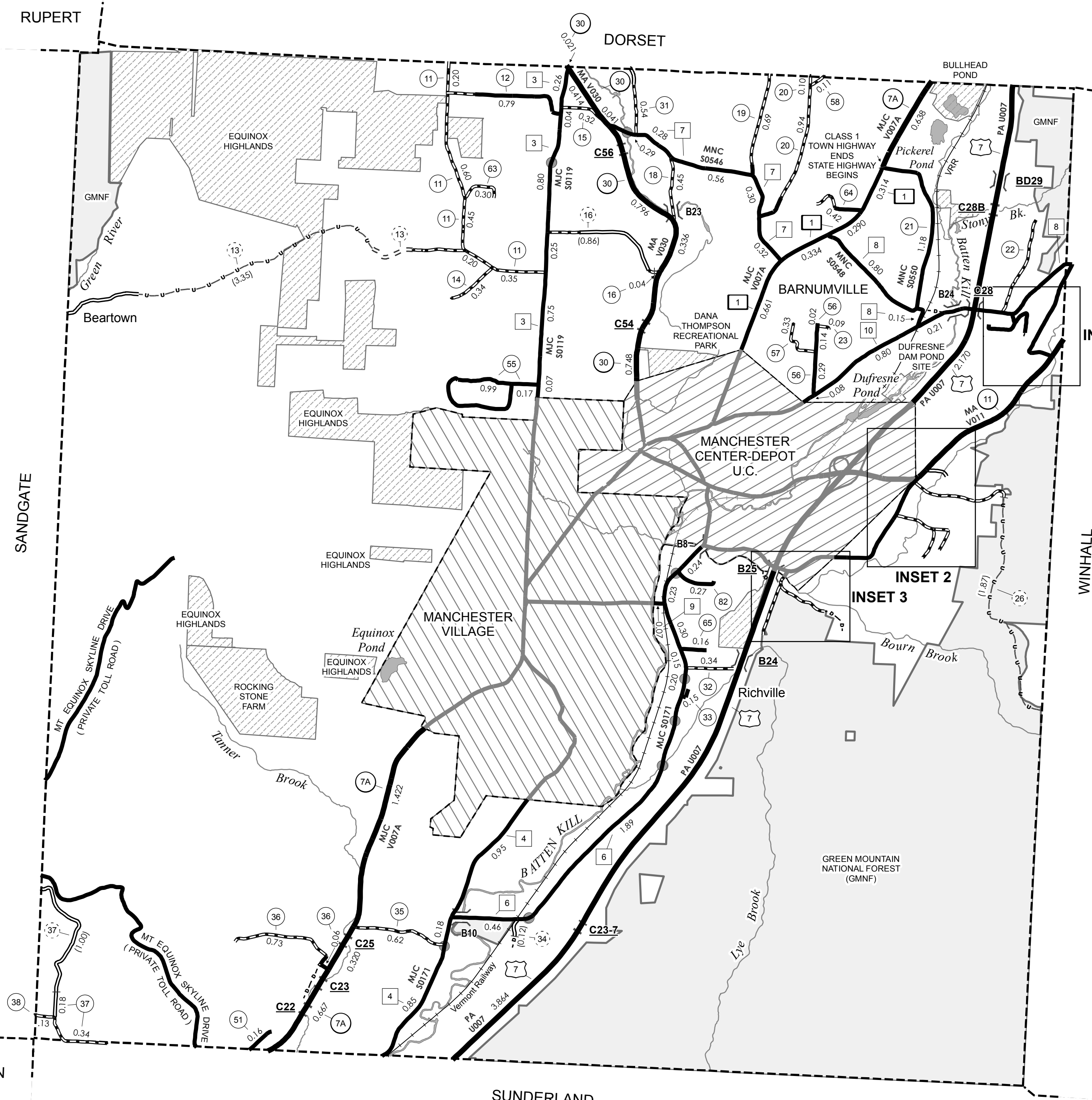

VERMONT GENERAL HIGHWAY MAP Town of Manchester

BENNINGTON COUNTY
Transportation District #1

Prepared by the
Vermont Agency of Transportation
Division of Policy, Planning and Intermodal Development
in cooperation with
U.S. Department of Transportation
Federal Highway Administration

Mileage as of February 10, 2017
Map prepared June 23, 2017
SCALE 1:31,680

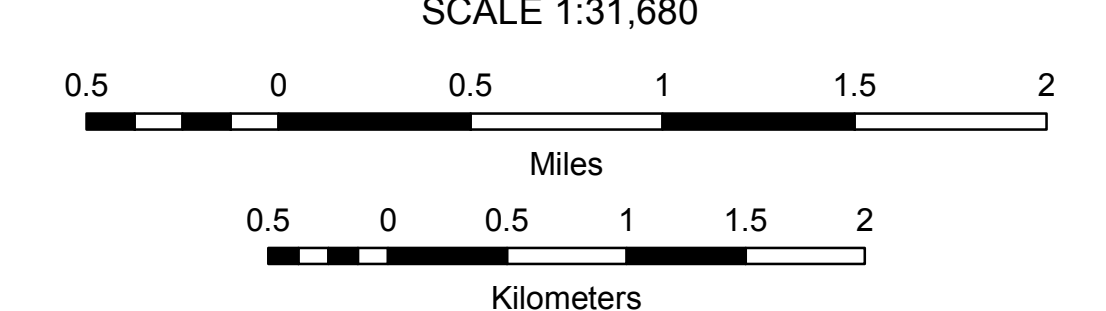

- HIGHWAYS**
- INTERSTATE
- U.S. ROUTE
- STATE ROUTE
- CLASS 1
- CLASS 2
- CLASS 3
- CLASS 4
- LEGAL TRAIL
- PARK AND RIDE
- INTERSTATE OR DIVIDED HIGHWAY
- STATE - HARD SURFACE OR PAVED
- TOWN - HARD SURFACE OR PAVED
- GRAVEL
- SOIL OR GRADED AND DRAINED EARTH
- UNIMPROVED OR PRIMITIVE
- IMPASSABLE OR UNTRAVELED
- LEGAL TRAIL
- DISCONTINUED
- HIGHWAY CLASS CHANGE
- RAILROAD
- INACTIVE RAILROAD
- PUBLIC LAND - NATIONAL FOREST
- PUBLIC LAND - STATE/MUNICIPAL
- NATIONAL FOREST ROAD
- STATE FOREST HIGHWAY
- POLITICAL SUBDIVISIONS
- STATE BOUNDARY
- COUNTY BOUNDARY
- TOWN BOUNDARY
- VILLAGE BOUNDARY
- URBAN COMPACT BOUNDARY
- WATER BODY
- STREAM OR BROOK
- BRIDGE OR CULVERT
- BRIDGE OR CULVERT > 20'
- BRIDGE OR CULVERT 6' - 20'
- BIKE PATH STRUCTURE
- VOBCIT BRIDGE
- VOBCIT CULVERT > 6'
- STATE BRIDGE OR CULVERT IDENTIFIER
- TOWN BRIDGE OR CULVERT IDENTIFIER
- FEDERAL CLASSIFICATION IDENTIFIER
- MA MINOR ARTERIAL
- MJC MAJOR COLLECTOR
- MNC MINOR COLLECTOR
- PA PRINCIPAL ARTERIAL