

TOWN HWY. No.	LENGTH IN MILES CLASS 3	LENGTH IN MILES CLASS 4	TOWN HWY. No.	LENGTH IN MILES "NOT UP TO STANDARD"
4	6.30		12	(0.53)
5	1.40		20	(0.29)
6	1.60		23	(0.26)
7	0.10		30	(0.16)
8	0.95			
9	0.45			
10	1.35			
11		(0.40)		
13	0.08			
14	2.90			
15	1.45			
16	0.30			
17	0.20			
18	0.35			
19	1.17			
20	0.11	(0.50)		
21	2.15			
22		(1.10)		
23	1.14	(0.55)		
24	1.60			
25	2.16			
26	0.50			
27	2.55			
29	0.32			
30	0.20	(0.04)		
32	2.58			
33	0.20			
34	0.70			
35	0.80			
36	2.50			
37	0.35			
38	0.33			
39	1.35			
40	3.40			
41	1.20	(0.16)		
42	2.90			
43	1.85			
44	2.10			
45	0.07			
<b>TOTAL</b>	<b>49.46</b>	<b>2.75</b>		

\*The sections of the town highways listed above are legally Class 3, but have been deemed "Not Up To Standard" and are functionally Class 4 Town Highways

LEGAL TRAIL No.	LENGTH IN MILES LEGAL TRAIL
1	(0.63)
2	(0.60)
<b>TOTAL</b>	<b>1.23</b>

MILEAGE SUMMARY		
CLASS 2		
TH-1	3.550	
TH-2	4.100	
TH-3	4.600	
TH-4	2.250	
<b>TOTAL CLASS 2</b>	<b>14.500</b>	
CLASS 3		
<b>TOTAL CLASS 3</b>	<b>49.46</b>	
<b>TOTAL TOWN</b>	<b>63.960</b>	
STATE HIGHWAY		
VT-22A	6.429	
VT-73	4.986	
<b>TOTAL STATE HIGHWAY</b>	<b>11.415</b>	
<b>TOTAL STATE</b>	<b>11.415</b>	

**TOTAL, TRAVELED HIGHWAYS, FEB. 10, 2017: 75.375**  
(Excludes Class 4 and Legal Trail Mileage)

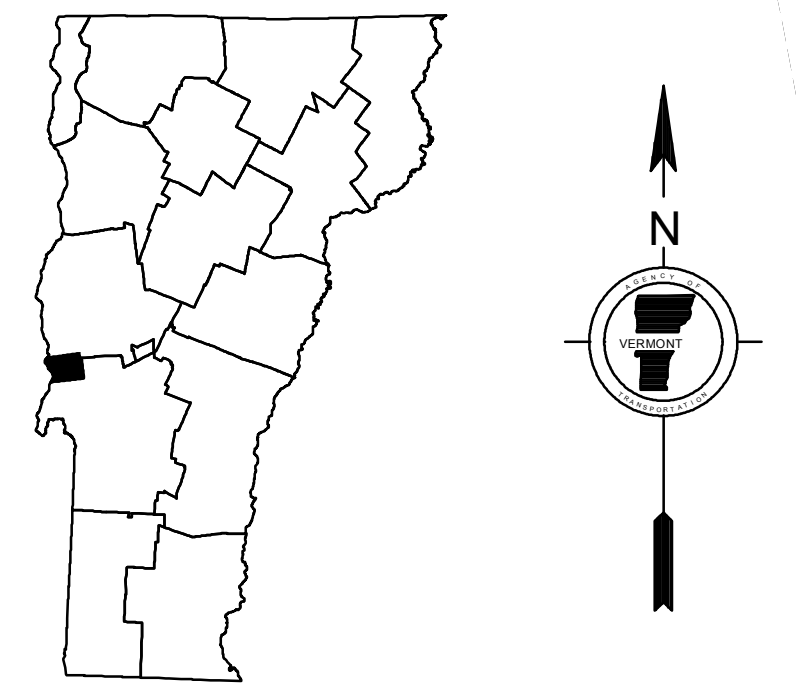
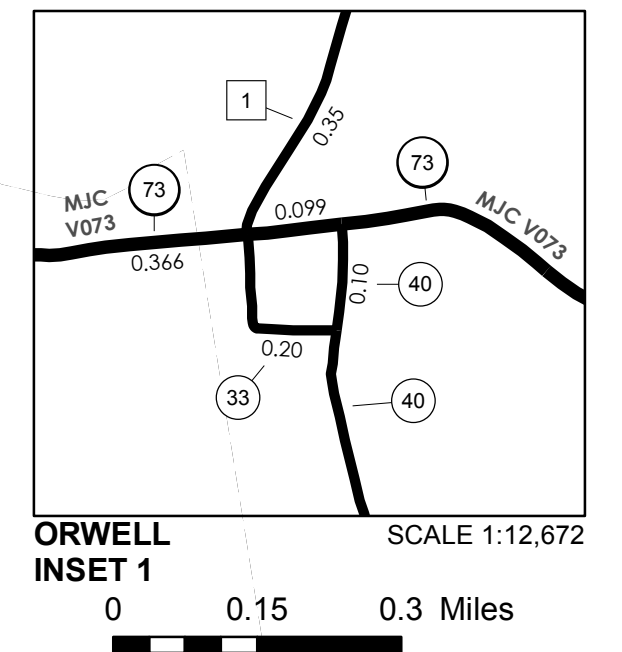

**VERMONT**  
**GENERAL HIGHWAY MAP**  
**Town of Orwell**  
ADDISON COUNTY  
Transportation District #3

Prepared by the  
Vermont Agency of Transportation  
Division of Policy, Planning and Intermodal Development  
in cooperation with  
U.S. Department of Transportation  
Federal Highway Administration

Mileage as of February 10, 2017  
Map prepared June 29, 2017  
SCALE 1:31,680

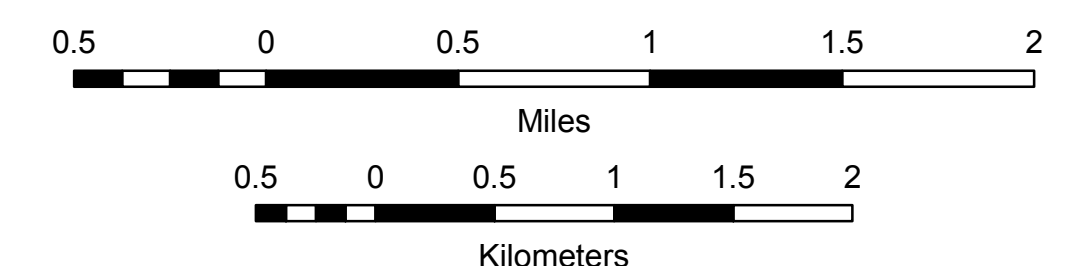

- |                 |  |  |
|-----------------|--|--|
| <b>HIGHWAYS</b> | <b>BRIDGE OR CULVERT</b>                     | <b>POLITICAL SUBDIVISIONS</b>            |
| INTERSTATE      | BRIDGE OR CULVERT > 20'                      | STATE BOUNDARY                           |
| U.S. ROUTE      | BRIDGE OR CULVERT 6' - 20'                   | COUNTY BOUNDARY                          |
| STATE ROUTE     | BIKE PATH STRUCTURE                          | TOWN BOUNDARY                            |
| CLASS 1         | VOBCIT BRIDGE                                | VILLAGE BOUNDARY                         |
| CLASS 2         | VOBCIT CULVERT > 6'                          | URBAN COMPACT BOUNDARY                   |
| CLASS 3         | B34 / C34 STATE BRIDGE OR CULVERT IDENTIFIER | WATER BODY                               |
| CLASS 4         | B34 / C34 TOWN BRIDGE OR CULVERT IDENTIFIER  | STREAM OR BROOK                          |
| LEGAL TRAIL     |  |  |
| PARK AND RIDE   |  |  |
|                 |  | <b>FEDERAL CLASSIFICATION IDENTIFIER</b> |
|                 |  | MA MINOR ARTERIAL                        |
|                 |  | MJC MAJOR COLLECTOR                      |
|                 |  | MNC MINOR COLLECTOR                      |
|                 |  | PA PRINCIPAL ARTERIAL                    |

**DISCLAIMER:**  
The untraveled highways (laid-out town highways), discontinued highways, and legal trails herein are those of which the Agency of Transportation has record; others may exist.

Highway and bridge data by the Agency of Transportation. Town short structures drawn from the Vermont Online Bridge & Culvert Inventory Tool (VOBCIT) database. All other data from the Vermont Center for Geographic Information. Only named streams shown.

Vermont State Plane Coordinate System  
North American Datum of 1983  
SPCS\_Zone\_Identifier: 4400  
Geodetic Reference System 80  
4,000-meter grid, Easting - Northing