

TOWN LENGTH IN MILES

HWY. NO.	CLASS 3	CLASS 4	LENGTH IN MILES
6			3.89
7			1.80
8			1.56
9			1.05
10			0.36
11			1.44
13			1.10
14	(0.10)		0.32
15			0.36
16	(0.50)		0.36
17			0.70
19			3.70
20	(0.96)		0.92
21			0.32
22			0.67
23			0.80
24			1.26
25			0.09
26			0.35
27			1.95
28			0.42
29			0.25
30	(0.07)		0.51
31	(0.04)		0.51
31	(0.13)		0.13
33			0.10
34			0.33
35			1.95
36			0.69
37	(0.10)		0.26
38			0.27
40			0.56
41			0.15
42			0.10
43			0.21
44			0.10
45			0.27
46			0.48
47			0.31
48			0.03
49			0.06
50			0.05
51			0.21
52			0.16
53			0.04
54			0.26
55			0.26
56			0.09
57			0.22
58			0.17
59			0.17
60			0.03
61			0.23
62			0.06
63			0.12
64			0.53
65			0.19
66			0.25
68			0.20
TOTAL	46.30	2.83	

LEGAL TRAIL NO. 1 LENGTH IN MILES (0.65) TOTAL 0.65

* This portion of town highway is Class 3, but is functionally Class 4

MILEAGE SUMMARY

CLASS	TH	LENGTH IN MILES
CLASS 1	TH-1	1.528
CLASS 1	TH-2	1.250
CLASS 1	TH-3	0.680
TOTAL CLASS 1		3.458
CLASS 2	TH-4	0.770
CLASS 2	TH-5	0.960
CLASS 2	TH-6	4.280
CLASS 2	TH-7	3.500
CLASS 2	TH-8	0.100
CLASS 2	TH-9	2.000
CLASS 2	TH-10	2.120
CLASS 2	TH-11	0.700
CLASS 2	TH-12	1.260
CLASS 2	TH-13	0.030
TOTAL CLASS 2		15.720
CLASS 3		46.300
TOTAL CLASS 3		46.300
TOTAL TOWN		65.478
STATE HIGHWAY	VT-30	0.550
STATE HIGHWAY	VT-116	6.759
STATE HIGHWAY	VT-125	3.427
TOTAL STATE HIGHWAY		10.736
US HIGHWAY	US-7	6.032
TOTAL US HIGHWAY		6.032
TOTAL STATE		16.768

TOTAL, TRAVELED HIGHWAYS, FEB. 10, 2010: 82.246 (Excludes Class 4 and Legal Trail Mileage)

STRUCTURES - SURFACE WATER NOTE:
STRUCTURES: Town short structures (bridges or culverts from 4-feet to less than 20-feet) are drawn from the Vermont Online Bridge & Culvert Inventory Tool (VOBCIT) database.
NOTE: Town shorts are not consistently tagged within VOBCIT.
The surface waters are from the Vermont Hydrological Dataset (VHD). Only the named streams are shown.

DISCLAIMER:
The untraveled highways (laid-out town highways), discontinued highways, and legal trails shown hereon are those of which the Agency of Transportation has record; others may exist.
Highway and bridge data by the Agency of Transportation. All other data from the Vermont Center for Geographic Information.

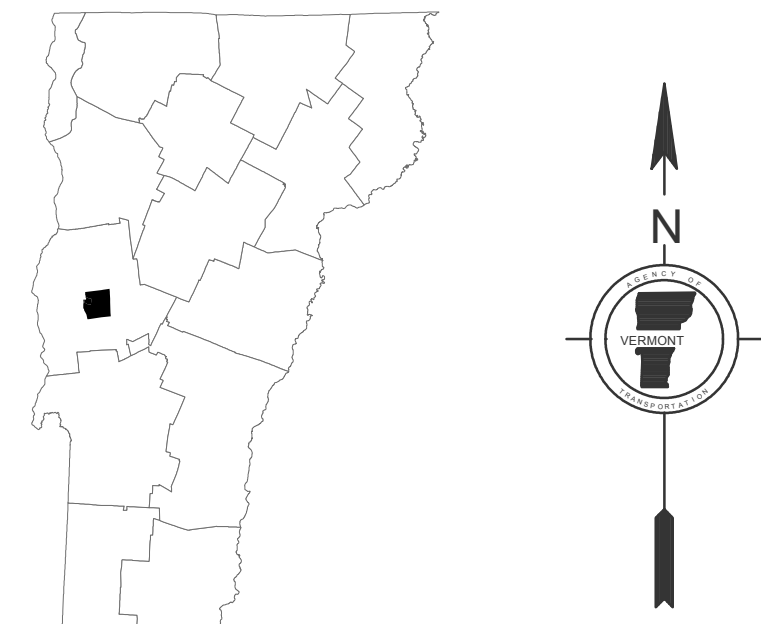
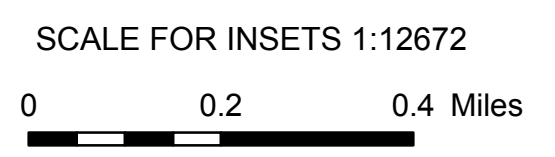
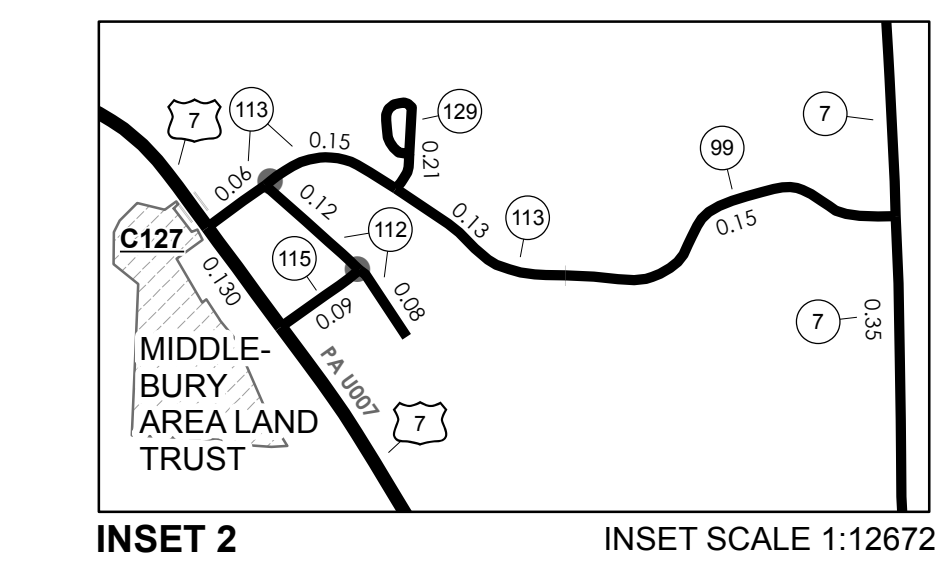
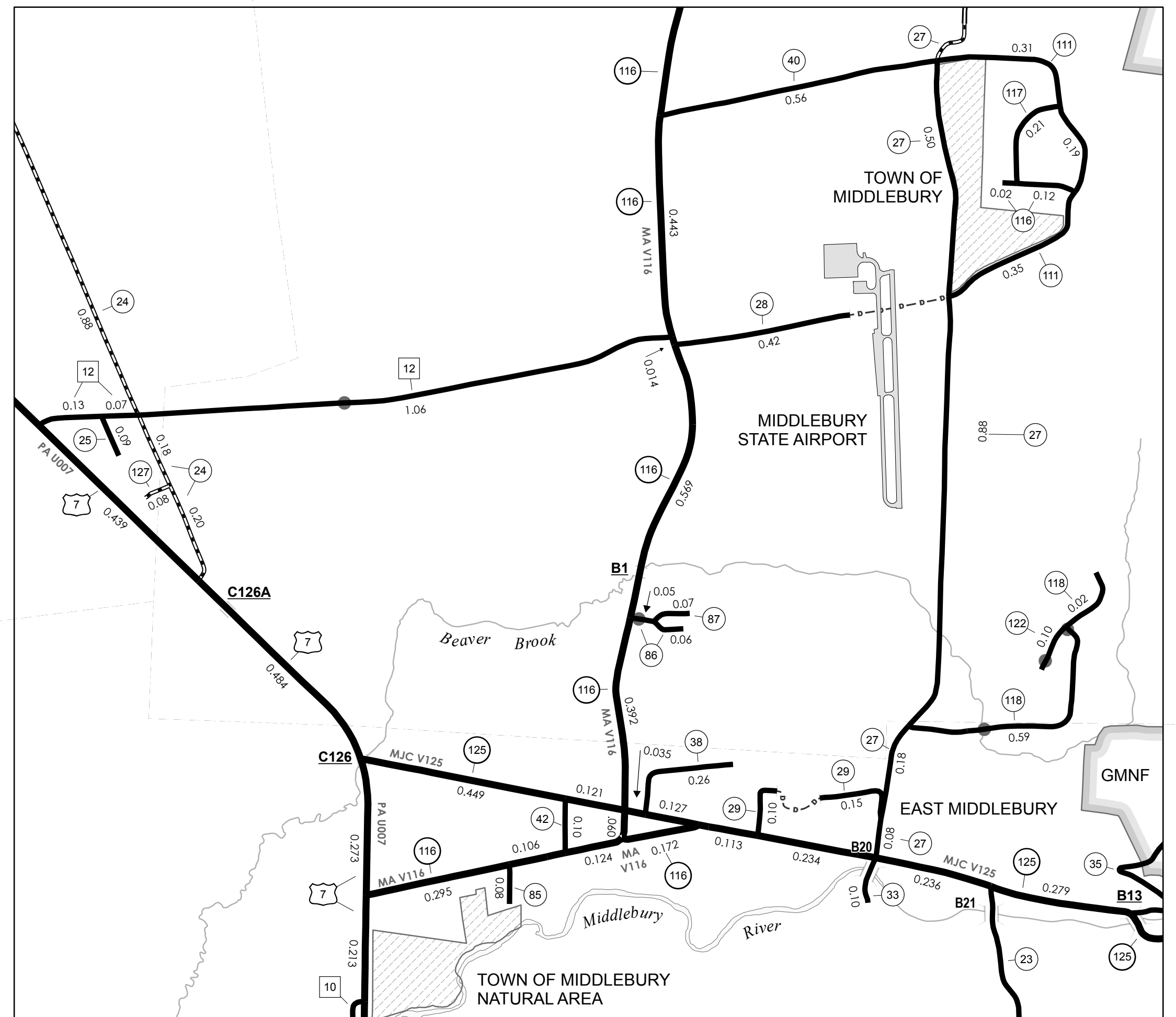
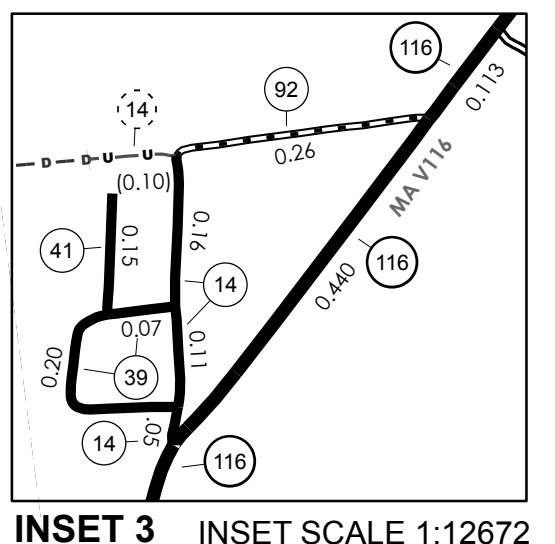
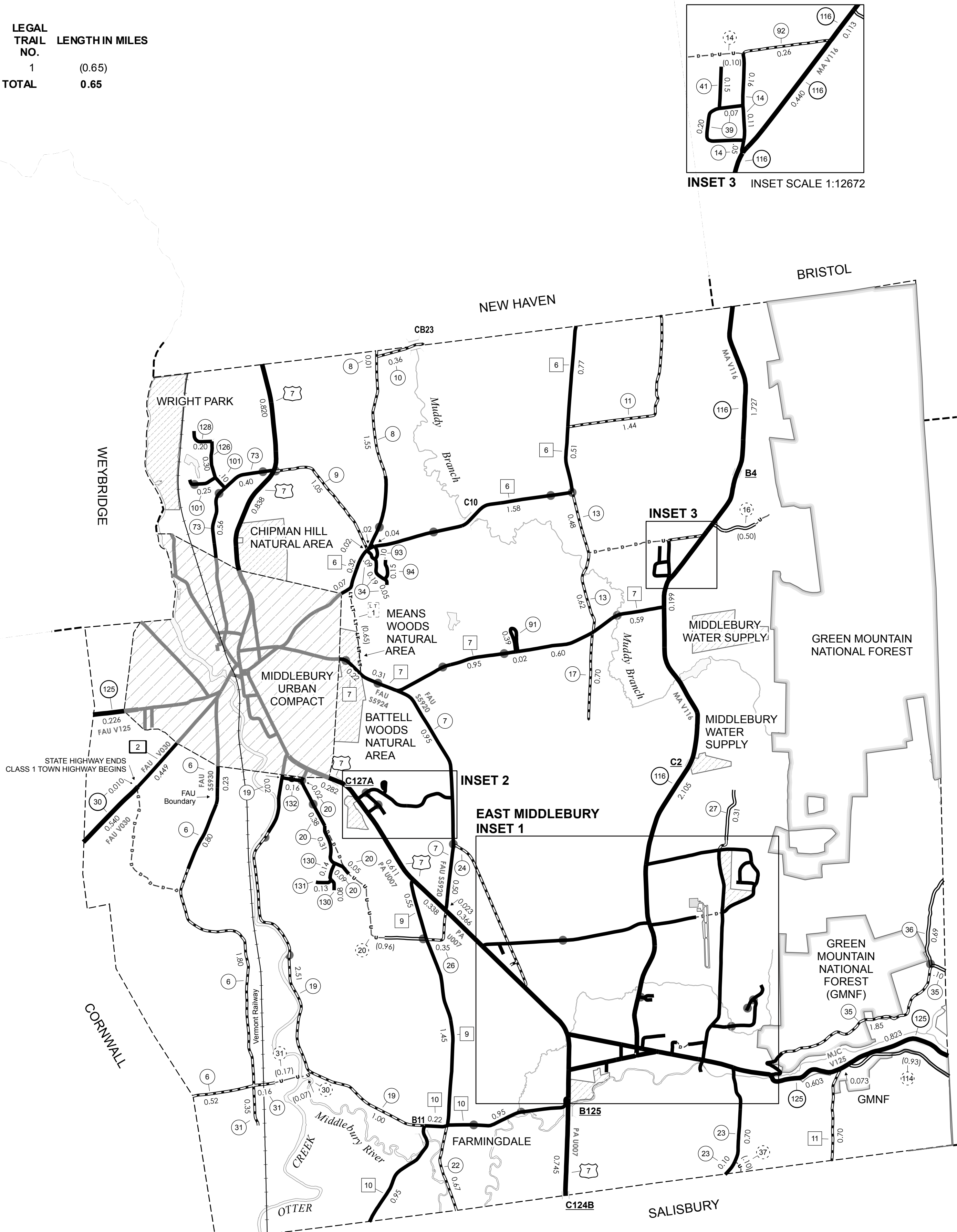

VERMONT GENERAL HIGHWAY MAP
Town of Middlebury

ADDISON COUNTY
Transportation District #5

Prepared by the
Vermont Agency of Transportation
Division of Planning, Outreach
and Community Affairs
in cooperation with
U.S. Department of Transportation
Federal Highway Administration

Mileage as of February 10, 2010
Map prepared June 30, 2010

SCALE 1:31,680

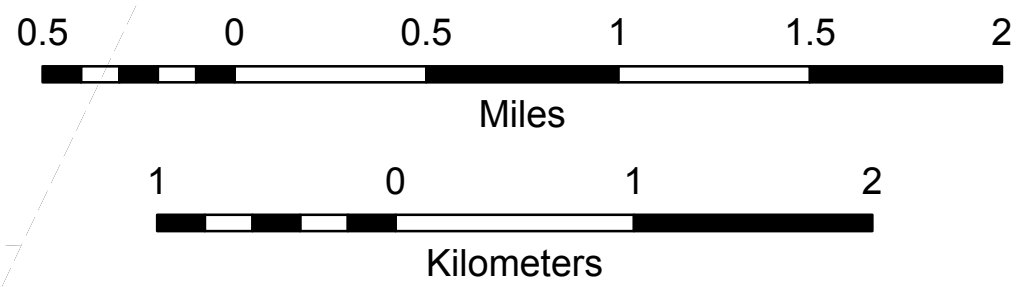

B34 / C34 STATE BRIDGE OR CULVERT IDENTIFIER
B34 / C34 TOWN BRIDGE OR CULVERT IDENTIFIER

FEDERAL CLASSIFICATION IDENTIFIER
FAU URBAN ARTERIAL OR COLLECTOR
MA MINOR ARTERIAL
MJC MAJOR COLLECTOR
MNC MINOR COLLECTOR
PA PRINCIPAL ARTERIAL

Vermont State Plane Coordinate System
North American Datum of 1983
SPOCS Zone Identifier: 4400
Geodetic Reference System 80
4,000-meter grid, Easting - Northing

- HIGHWAYS**
- INTERSTATE OR DIVIDED HIGHWAY
 - STATE - HARD SURFACE OR PAVED
 - TOWN - HARD SURFACE OR PAVED
 - GRAVEL
 - SOIL OR GRADED AND DRAINED EARTH
 - UNIMPROVED OR PRIMITIVE
 - IMPASSABLE OR UNTRAVELED
 - LEGAL TRAIL
 - DISCONTINUED
 - HIGHWAY CLASS CHANGE
 - RAILROAD
 - INACTIVE RAILROAD
- POLITICAL SUBDIVISIONS**
- STATE BOUNDARY
 - COUNTY BOUNDARY
 - TOWN BOUNDARY
 - VILLAGE BOUNDARY
 - URBAN COMPACT BOUNDARY
 - WATER BODIES
 - STREAM OR BROOK
- BRIDGE OR CULVERT**
- BRIDGE OR CULVERT GREATER THAN 20'
 - BRIDGE OR CULVERT 6' - 20'
 - TOWN SHORT STRUCTURE
- PUBLIC LAND - STATE/MUNICIPAL**
- PUBLIC LAND - NATIONAL FOREST**
- CLASS 1**
- CLASS 2**
- CLASS 3**
- CLASS 4**
- LEGAL TRAIL**