

TOWN HWY. No.	LENGTH IN MILES CLASS 3	CLASS 4
4	2.70	
5	0.51	
6	4.61	
7	1.91	
8	0.88	
9	0.80	
10	0.10	
11	0.69	(0.21)
12	0.62	
13	0.75	(0.14)
14	0.27	
15	0.22	(0.88)
16	0.51	(0.24)
17	0.85	(1.65)
18	0.85	
19	0.75	
20	1.20	
21		(0.26)
22	0.24	
23	0.97	
24	0.40	
25	0.57	(1.28)
26	0.78	
27	1.75	
28	1.40	
31	0.13	
32	2.25	(0.60)
33	3.93	
34	1.40	
35	0.44	
36	0.36	(0.13)
37		(0.21)
38	0.08	
39	0.12	
40	0.29	
41	1.10	
42	0.22	
43	0.29	
45	0.02	
46	0.17	
47		(0.36)
TOTAL	35.13	5.96

TOWN HWY. No.	LENGTH IN MILES "NOT UP TO STANDARD"
29	(0.06)
40	(0.04)
TOTAL	0.10

* The sections of the town highways listed above are legally Class 3, but have been deemed "Not Up To Standard" and are functionally Class 4 Town Highways

MILEAGE SUMMARY		
CLASS 2		
TH-1	8.600	
TH-2	3.890	
TH-3	4.490	
TOTAL CLASS 2	16.980	
CLASS 3		
TOTAL CLASS 3	35.13	
TOTAL TOWN	52.110	
TOTAL STATE	0.000	

TOTAL, TRAVELED HIGHWAYS, FEB. 10, 2018: 52.110
(Excludes Class 4 and Legal Trail Mileage)

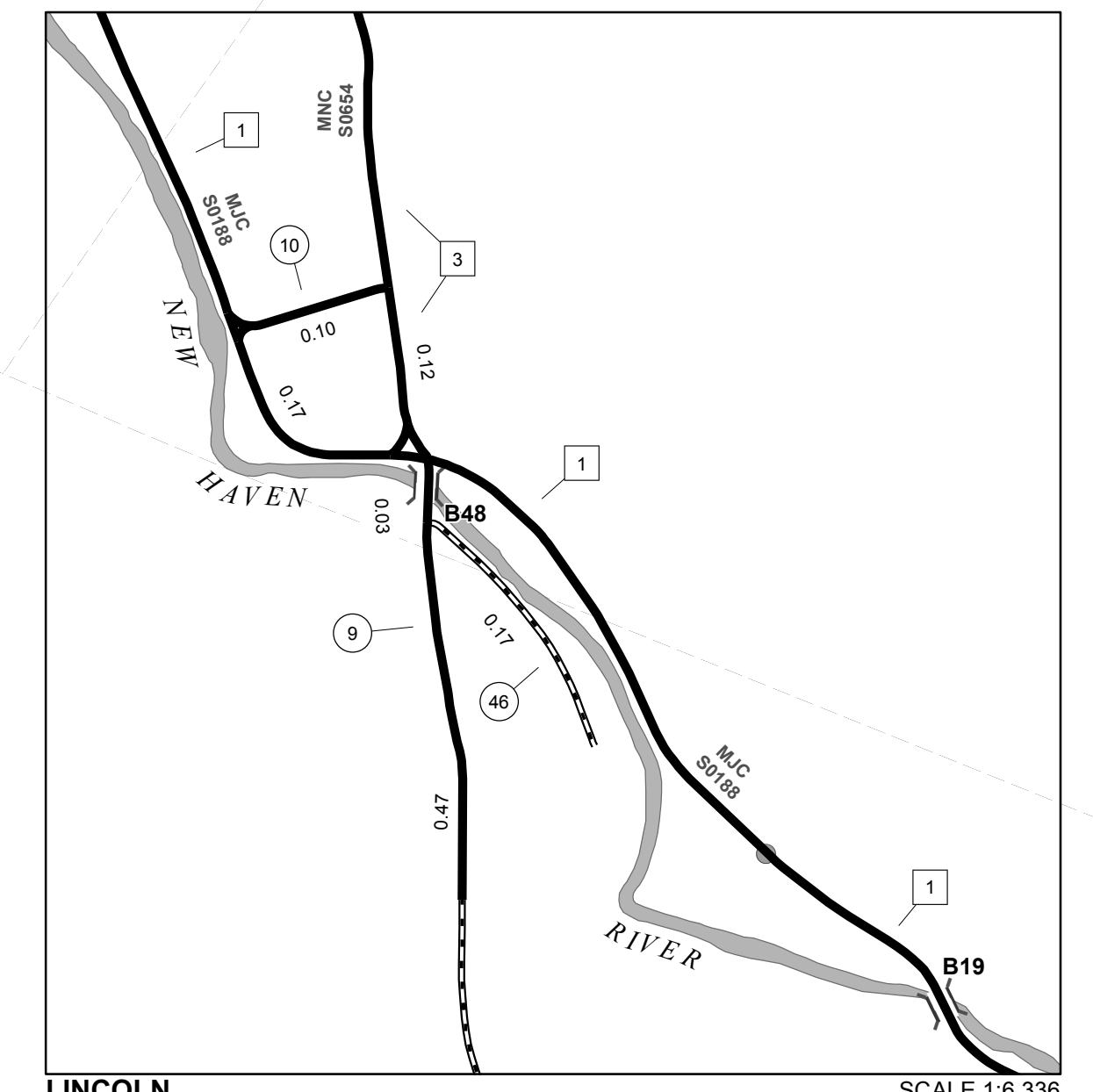

0 0.08 0.16 Miles

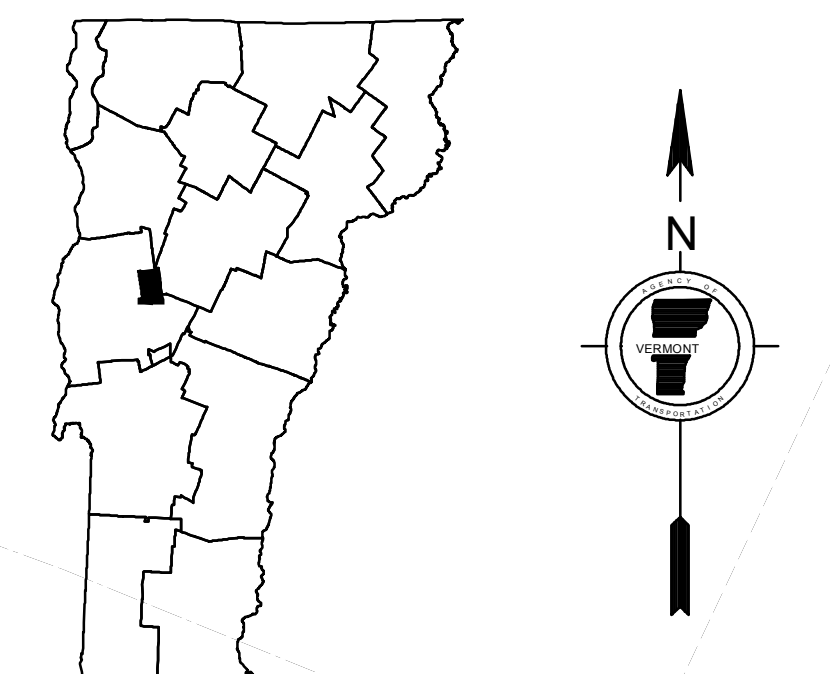

**VERMONT
GENERAL HIGHWAY MAP
Town of Lincoln**
ADDISON COUNTY

Transportation District #5

Prepared by the
Vermont Agency of Transportation
Division of Policy, Planning and Intermodal Development
in cooperation with
U.S. Department of Transportation
Federal Highway Administration

Mileage as of February 10, 2018
Map prepared July 25, 2018
SCALE 1:31,680

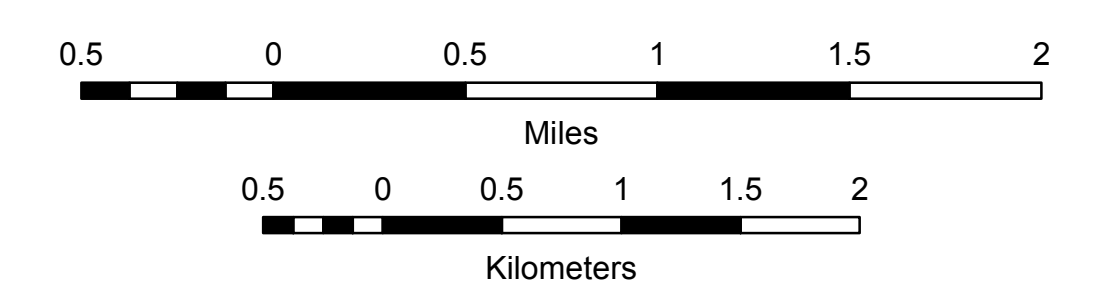

- HIGHWAYS**
- INTERSTATE OR DIVIDED HIGHWAY
- STATE - HARD SURFACE OR PAVED
- TOWN - HARD SURFACE OR PAVED
- GRAVEL
- SOIL OR GRADED AND DRAINED EARTH
- UNIMPROVED OR PRIMITIVE
- IMPASSABLE OR UNTRAVELED
- LEGAL TRAIL
- DISCONTINUED
- HIGHWAY CLASS CHANGE
- RAILROAD
- INACTIVE RAILROAD
- PARK AND RIDE
- INTERSTATE OR DIVIDED HIGHWAY
- STATE - HARD SURFACE OR PAVED
- TOWN - HARD SURFACE OR PAVED
- GRAVEL
- SOIL OR GRADED AND DRAINED EARTH
- UNIMPROVED OR PRIMITIVE
- IMPASSABLE OR UNTRAVELED
- LEGAL TRAIL
- DISCONTINUED
- HIGHWAY CLASS CHANGE
- RAILROAD
- INACTIVE RAILROAD
- PARK AND RIDE

- POLITICAL SUBDIVISIONS**
- STATE BOUNDARY
- COUNTY BOUNDARY
- TOWN BOUNDARY
- VILLAGE BOUNDARY
- URBAN COMPACT BOUNDARY
- WATER BODY
- STREAM OR BROOK
- BRIDGE OR CULVERT**
- BRIDGE OR CULVERT > 20'
- BRIDGE OR CULVERT 6' - 20'
- BIKE PATH STRUCTURE
- VT CULVERTS BRIDGE
- VT CULVERTS CULVERT > 6'
- B34 / C34 STATE BRIDGE OR CULVERT IDENTIFIER
- B34 / C34 TOWN BRIDGE OR CULVERT IDENTIFIER

- FEDERAL CLASSIFICATION IDENTIFIER**
- MA MINOR ARTERIAL
- MJC MAJOR COLLECTOR
- MNC MINOR COLLECTOR
- PA PRINCIPAL ARTERIAL

DISCLAIMER:
The untraveled highways (laid-out town highways), discontinued highways, and legal trails hereon are those of which the Agency of Transportation has record; others may exist.

Highway and bridge data by the Agency of Transportation. Town short structures drawn from the VTCULVERTS (formerly VOBCIT) online database. All other data from the Vermont Center for Geographic Information. Only named streams shown.

Vermont State Plane Coordinate System
North American Datum of 1983
SPCS_Zone_Identifier: 4400
Geodetic Reference System 80
4,000-meter grid, Easting - Northing