



TOWN HWY. No.	LENGTH IN MILES CLASS 3	CLASS 4
4	1.75	
5	3.29	
6	0.20	
7	0.70	
9	0.70	
10	2.40	
11	0.90	
12	1.20	
13	2.25	
14	0.40	
15	0.19	
16	1.43	
17	3.62	
18	0.25	
19	0.10	(1.79)
20		(0.65)
21	1.10	
22	0.60	
23	1.66	
24	1.25	
25	0.33	
26	2.05	
27	2.15	
28	0.76	
29	0.08	
30	1.19	
31	2.89	
32	0.42	
33		(0.11)
34	0.20	
36		(1.90)
37	1.80	
38	1.70	
39	0.40	
40	2.00	
41		(1.67)
42	0.86	
43	0.55	(0.60)
44	1.21	
45	0.58	
46	0.38	
47		(0.35)
<b>TOTAL</b>	<b>43.54</b>	<b>7.07</b>

**MILEAGE SUMMARY**

<b>CLASS 2</b>			
TH-1	6.000		
TH-2	1.400		
TH-3	5.880		
<b>TOTAL CLASS 2</b>		<b>13.280</b>	
<b>CLASS 3</b>			
<b>TOTAL CLASS 3</b>		<b>43.54</b>	
<b>TOTAL TOWN</b>		<b>56.820</b>	
<b>STATE HIGHWAY</b>			
VT-22A	6.301		
VT-125	8.189		
<b>TOTAL STATE HIGHWAY</b>		<b>14.490</b>	
<b>TOTAL STATE</b>		<b>14.490</b>	

**TOTAL, TRAVELED HIGHWAYS, FEB. 10, 2019: 71.310**  
(Excludes Class 4 and Legal Trail Mileage)

**DISCLAIMER:**  
The untraveled highways (laid-out town highways), discontinued highways, and legal trails hereon are those of which the Agency of Transportation has record; others may exist.

Highway and bridge data by the Agency of Transportation. Town short structures drawn from the VT/CULVERTS (formerly VOBCIT) online database. All other data from the Vermont Open Geodata Portal. Only named streams shown.

Vermont State Plane Coordinate System  
North American Datum of 1983  
SPCS\_Zone\_Identifier: 4400  
Geodetic Reference System 80  
4,000-meter grid, Easting - Northing

- HIGHWAYS**
- INTERSTATE
- U.S. ROUTE
- STATE ROUTE
- CLASS 1
- CLASS 2
- CLASS 3
- CLASS 4
- LEGAL TRAIL
- PARK AND RIDE
- INTERSTATE OR DIVIDED HIGHWAY
- STATE - HARD SURFACE OR PAVED
- TOWN - HARD SURFACE OR PAVED
- GRAVEL
- SOIL OR GRADED AND DRAINED EARTH
- UNIMPROVED OR PRIMITIVE
- IMPASSABLE OR UNTRAVELED
- LEGAL TRAIL
- DISCONTINUED
- HIGHWAY CLASS CHANGE
- RAILROAD
- INACTIVE RAILROAD
- PUBLIC LAND - NATIONAL FOREST
- PUBLIC LAND - STATE/MUNICIPAL
- NFR NATIONAL FOREST ROAD
- SFH STATE FOREST HIGHWAY
- POLITICAL SUBDIVISIONS
- STATE BOUNDARY
- COUNTY BOUNDARY
- TOWN BOUNDARY
- VILLAGE BOUNDARY
- URBAN COMPACT BOUNDARY
- WATER BODY
- STREAM OR BROOK
- BRIDGE OR CULVERT
- BRIDGE OR CULVERT > 20'
- BRIDGE OR CULVERT 6' - 20'
- BIKE PATH STRUCTURE
- VT/CULVERTS BRIDGE
- VT/CULVERTS CULVERT > 6'
- B34 / C34 STATE BRIDGE OR CULVERT IDENTIFIER
- B34 / C34 TOWN BRIDGE OR CULVERT IDENTIFIER
- FEDERAL CLASSIFICATION IDENTIFIER
- MA MINOR ARTERIAL
- MJC MAJOR COLLECTOR
- MNC MINOR COLLECTOR
- PA PRINCIPAL ARTERIAL

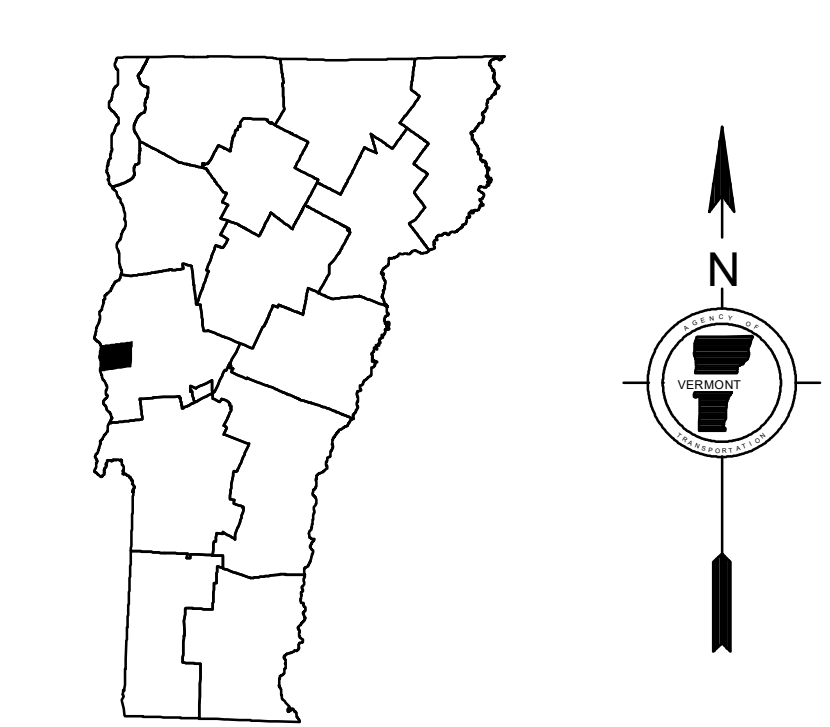
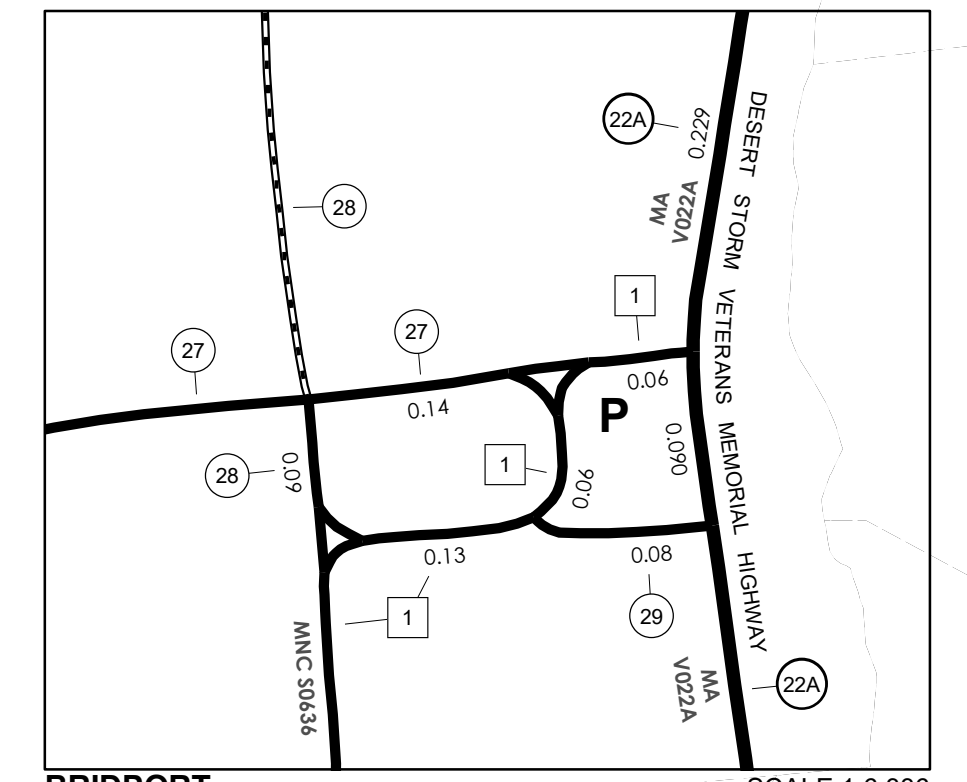

**VERMONT**  
**GENERAL HIGHWAY MAP**  
**Town of Bridport**  
ADDISON COUNTY  
Transportation District #5  
Prepared by the  
Vermont Agency of Transportation  
Division of Policy, Planning and Intermodal Development  
in cooperation with  
U.S. Department of Transportation  
Federal Highway Administration

