

TOWN NO.	HWY. CLASS 3	LENGTH IN MILES	HWY. CLASS 4
6		2.38	
7		1.07	
8		1.70	
9		0.39	
10		1.80	
11		3.55	
12		0.20	
13		0.43	
14			(0.55)
15		1.26	
16		1.19	
17		1.27	
18		0.25	
19			(0.12)
20		1.50	
21		0.15	
22		0.20	
23		0.15	
24		0.42	
25		0.13	
26		0.14	(0.16)
27		0.38	
28		0.67	
29			(0.20)
31		0.35	
32		0.10	
33		2.18	
34			(0.45)
35		1.47	
36		1.64	
37			(0.10)
38		2.10	
39		0.20	
43		0.10	
44		0.20	
45		0.17	
46		0.06	
47		0.65	
48		0.06	
51			(0.14)
52		0.08	
53		0.35	
54		0.20	
55		0.10	
56		0.34	
57		0.11	
58		0.70	
59		0.43	
60		0.29	
61		0.13	
62		0.14	
63		0.08	
<b>TOTAL</b>	<b>31.46</b>	<b>1.72</b>	

MILEAGE SUMMARY	
CLASS 2	
TH-1	1.590
TH-2	2.840
TH-3	4.450
TH-4	1.830
<b>TOTAL CLASS 2</b>	<b>10.710</b>
CLASS 3	
<b>TOTAL CLASS 3</b>	<b>31.460</b>
<b>TOTAL TOWN</b>	<b>42.170</b>
STATE HIGHWAY	
VT-78	3.333
VT-129	2.739
<b>TOTAL STATE HIGHWAY</b>	<b>6.072</b>
US HIGHWAY	
US-2	11.732
<b>TOTAL US HIGHWAY</b>	<b>11.732</b>
<b>TOTAL STATE</b>	<b>17.804</b>

**TOTAL, TRAVELED HIGHWAYS, FEB. 10, 2011: 59.974**  
 (Excludes Class 4, Legal Trail, and Unidentified Corridor Mileage)

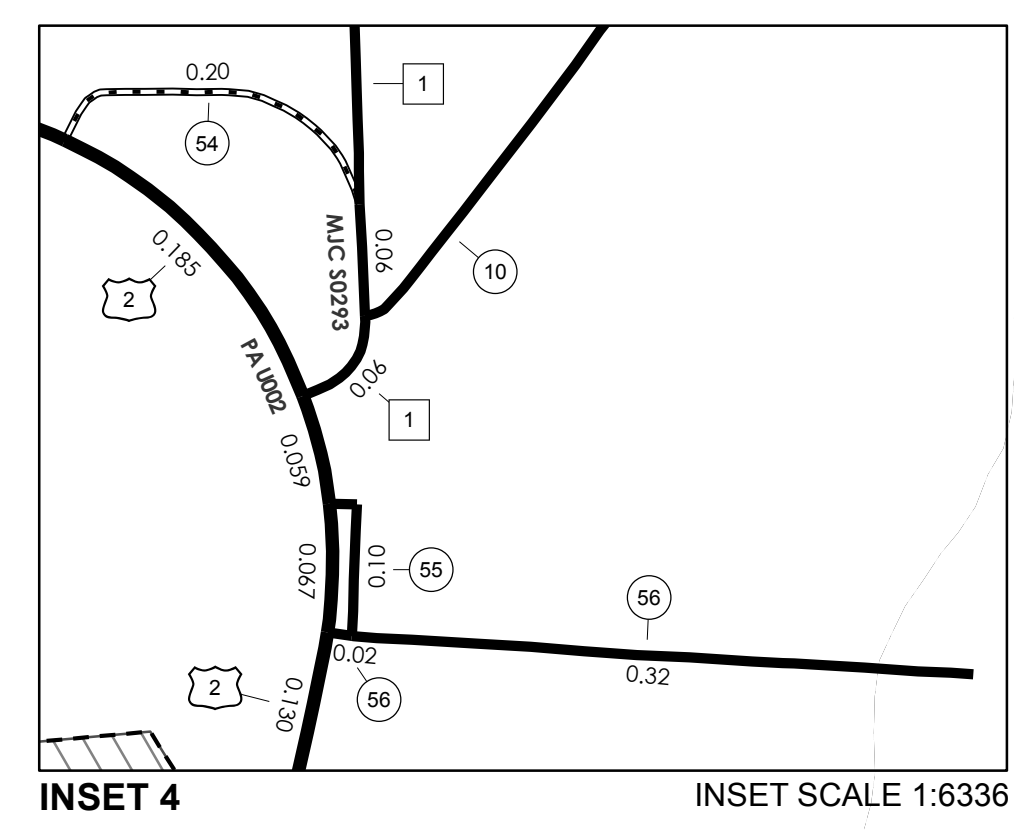
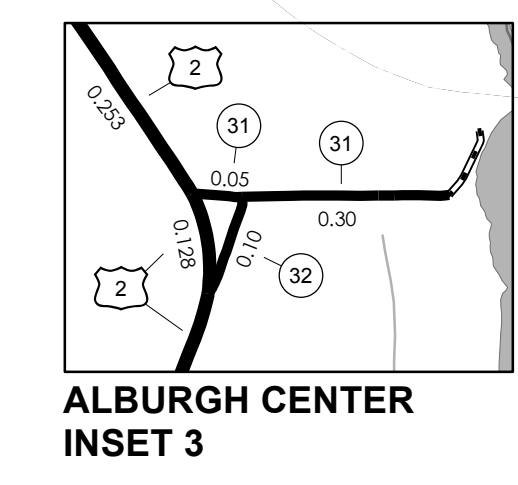
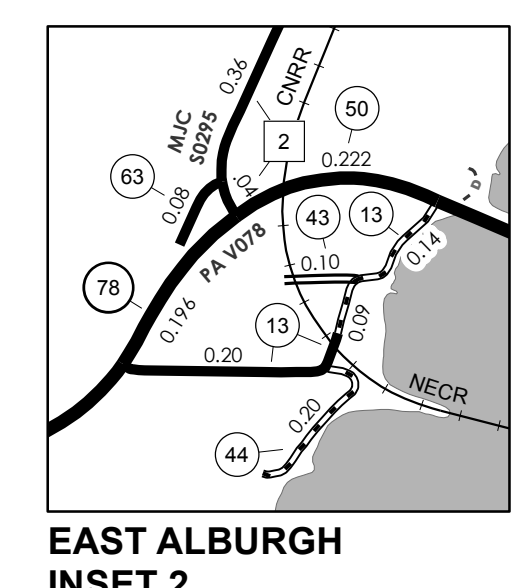
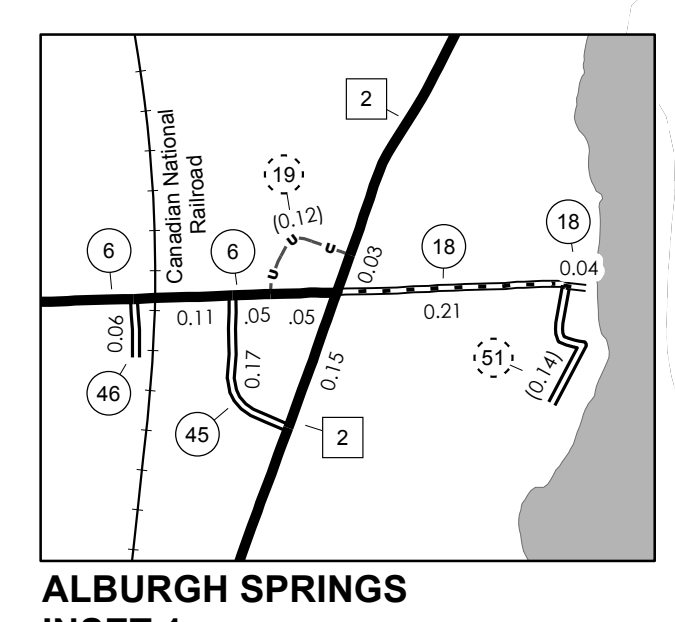

SCALE FOR INSETS 1:12672  
 (UNLESS OTHERWISE NOTED)

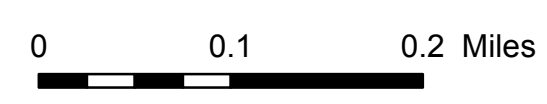
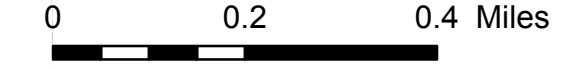

# VERMONT GENERAL HIGHWAY MAP

## Town of Alburgh

GRAND ISLE COUNTY

Transportation District #8

Prepared by the  
 Vermont Agency of Transportation  
 Division of Policy, Planning & Intermodal Development  
 in cooperation with  
 U.S. Department of Transportation  
 Federal Highway Administration

Mileage as of February 10, 2011  
 Map prepared October 26, 2011

SCALE 1:31,680

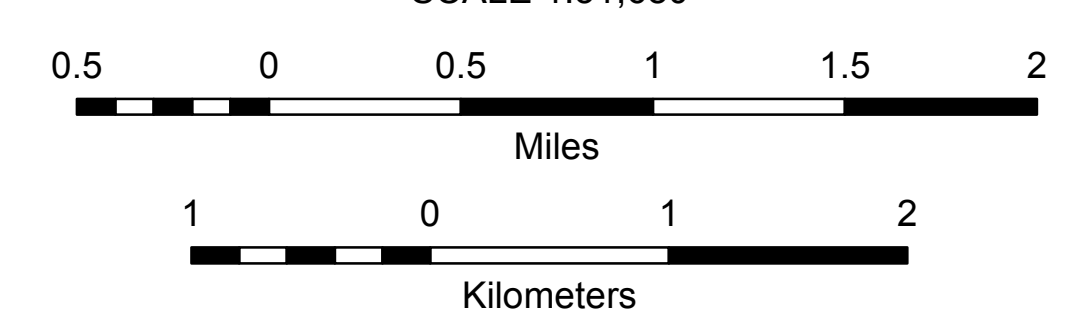

- HIGHWAYS**
- INTERSTATE
- U.S. ROUTE
- STATE ROUTE
- CLASS 1
- CLASS 2
- CLASS 3
- CLASS 4
- LEGAL TRAIL
- INTERSTATE OR DIVIDED HIGHWAY
- STATE - HARD SURFACE OR PAVED
- TOWN - HARD SURFACE OR PAVED
- GRAVEL
- SOIL OR GRADED AND DRAINED EARTH
- UNIMPROVED OR PRIMITIVE
- IMPASSABLE OR UNTRAVELED
- LEGAL TRAIL
- DISCONTINUED
- HIGHWAY CLASS CHANGE
- RAILROAD
- INACTIVE RAILROAD
- PUBLIC LAND
- POLITICAL SUBDIVISIONS**
- STATE BOUNDARY
- COUNTY BOUNDARY
- TOWN BOUNDARY
- VILLAGE BOUNDARY
- URBAN COMPACT BOUNDARY
- WATER BODY
- STREAM OR BROOK
- BRIDGE OR CULVERT**
- BRIDGE OR CULVERT GREATER THAN 20'
- BRIDGE OR CULVERT 6' - 20'
- TOWN SHORT STRUCTURE
- B34 / C34 STATE BRIDGE OR CULVERT IDENTIFIER**
- B34 / C34 TOWN BRIDGE OR CULVERT IDENTIFIER**
- FEDERAL CLASSIFICATION IDENTIFIER**
- FAU URBAN ARTERIAL OR COLLECTOR
- MA MINOR ARTERIAL
- MJC MAJOR COLLECTOR
- MNC MINOR COLLECTOR
- PA PRINCIPAL ARTERIAL

**STRUCTURES - SURFACE WATER NOTE:**

**STRUCTURES:**  
 Town short structures (bridges or culverts from 6-feet to less than 20-feet) are drawn from the Vermont Online Bridge & Culvert Inventory Tool (VOBCIT) database.  
 NOTE: Town shorts are not consistently tagged within VOBCIT.

**SURFACE WATERS:**  
 The surface waters are from the Vermont Hydrological Dataset (VHD). Only the named streams are shown.

**DISCLAIMER:**

The untraveled highways (laid-out town highways), discontinued highways, and legal trails shown hereon are those of which the Agency of Transportation has record; others may exist.

Highway and bridge data by the Agency of Transportation. All other data from the Vermont Center for Geographic Information.

Vermont State Plane Coordinate System  
 North American Datum of 1983  
 SPCS\_Zone\_Identifier: 4400  
 Geodetic Reference System 80  
 4,000-meter grid, Easting - Northing



- HIGHWAYS**
- INTERSTATE
  - STATE HIGHWAY SYSTEM
  - TOWN HIGHWAY SYSTEM
  - U - IMPASSABLE OR UNTRAVELED
  - D - DISCONTINUED
  - LT - LEGAL TRAIL
  - FT - FOOT TRAIL

- 89 INTERSTATE ROUTE
- 2 U. S. NUMBERED ROUTE
- 3 STATE NUMBERED ROUTE
- 7 INTERCHANGE NUMBER
- 4 CLASS 1 TOWN HIGHWAY
- 2 CLASS 2 TOWN HIGHWAY
- 8 CLASS 3 TOWN HIGHWAY
- 6 CLASS 4 TOWN HIGHWAY
- NFR NATIONAL FOREST ROAD
- SFH STATE FOREST HIGHWAY

- BRIDGE OR CULVERT < 6'
- BRIDGE OR CULVERT 6' - 20'
- BRIDGE GREATER THAN 20'
- CB COVERED BRIDGE

TOWN HWY NO.	LENGTH IN MILES CLASS	IN MILES CLASS
21	0.130	3
23	0.150	4
24	0.420	3
25	0.130	3
48	0.060	3
52	0.080	3
53	0.350	3
57	0.110	3
58	0.060	3
59	0.200	3
61	0.080	3
62	0.140	3
<b>TOTAL</b>	<b>1.910</b>	<b>0.000</b>

MILEAGE SUMMARY

CLASS 1 TOWN HIGHWAYS:		
TOTAL, CLASS 1 TOWN HWYS.	0.000	
CLASS 2 TOWN HIGHWAYS:		
NO. 3	0.060	
TOTAL, CLASS 2 TOWN HWYS.	0.060	
CLASS 3 TOWN HIGHWAYS:		
TOTAL, CLASS 3 TOWN HWYS.	1.910	1.970
TOTAL, TOWN HWYS.		1.970
STATE HIGHWAYS:		
INTERSTATE RAMPS	0.000	
TOTAL, INTERSTATE HWYS.	0.000	
STATE HWY. 2	1.429	
TOTAL, NON-INTERSTATE HWYS.	1.429	1.429
TOTAL, STATE HWYS.		1.429
TOTAL, TRAVELLED HWYS., FEB. 10, 2004 (EXCLUDES CLASS 4 MILEAGE)		3.399

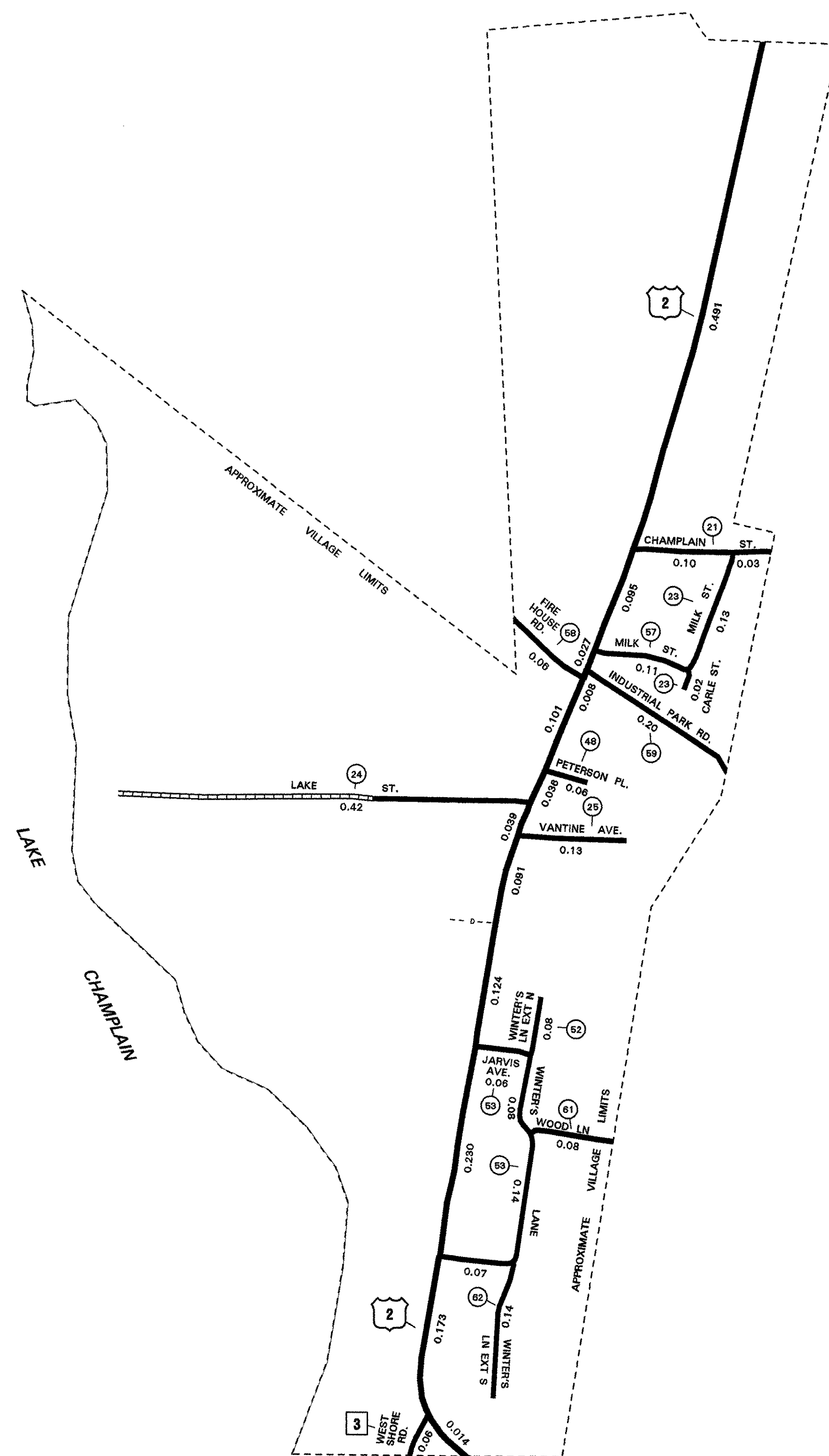
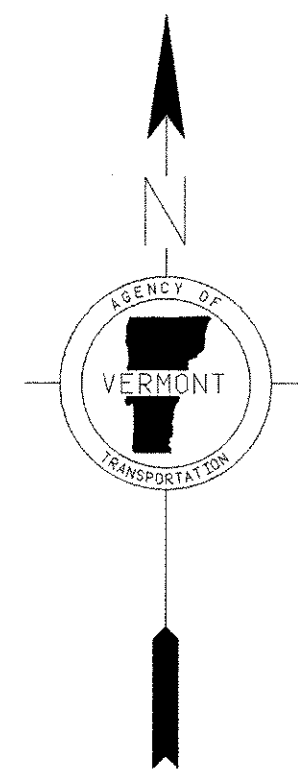

- ROAD SURFACE TYPES**
- STATE PAVED
  - OTHER PAVED
  - STATE GRAVEL
  - OTHER GRAVEL
  - GRADED AND DRAINED
  - UNIMPROVED/PRIMITIVE

- POLITICAL SUBDIVISIONS**
- STATE BOUNDARY
  - COUNTY BOUNDARY
  - TOWN BOUNDARY
  - CITY BOUNDARY
  - VILLAGE BOUNDARY
  - URBAN COMPACT BOUNDARY

- NATURAL FEATURES**
- SINGLE LINE STREAM
  - OPEN WATER
  - SWAMP

- MISCELLANEOUS**
- DAM

- OTHER TRANSPORTATION**
- RAILROAD
  - AIRPORT TERMINAL

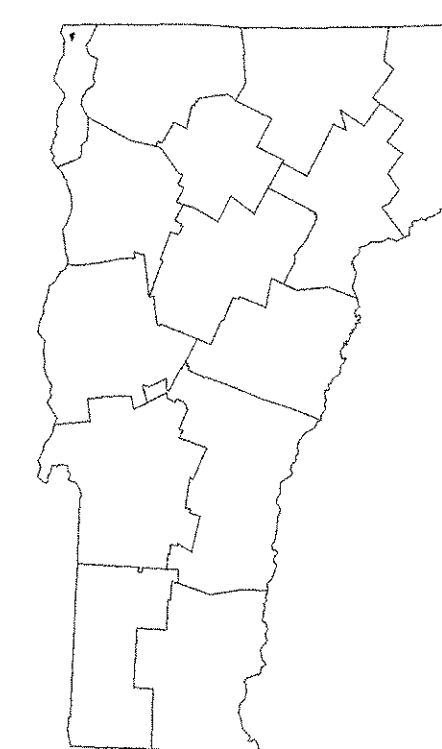

# VERMONT GENERAL HIGHWAY MAP VILLAGE OF ALBURG

PREPARED BY THE  
VERMONT AGENCY OF TRANSPORTATION  
PROGRAM DEVELOPMENT DIVISION  
IN COOPERATION WITH  
U. S. DEPARTMENT OF TRANSPORTATION  
FEDERAL HIGHWAY ADMINISTRATION

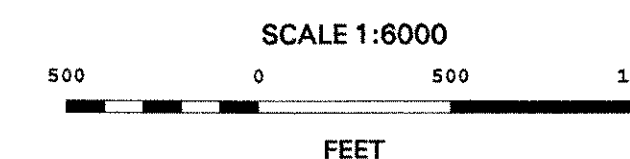

DISCLAIMER:  
Highway and bridge data by Vermont Agency of Transportation, Division of Program Development. All other data from Vermont Center for Geographic Information.

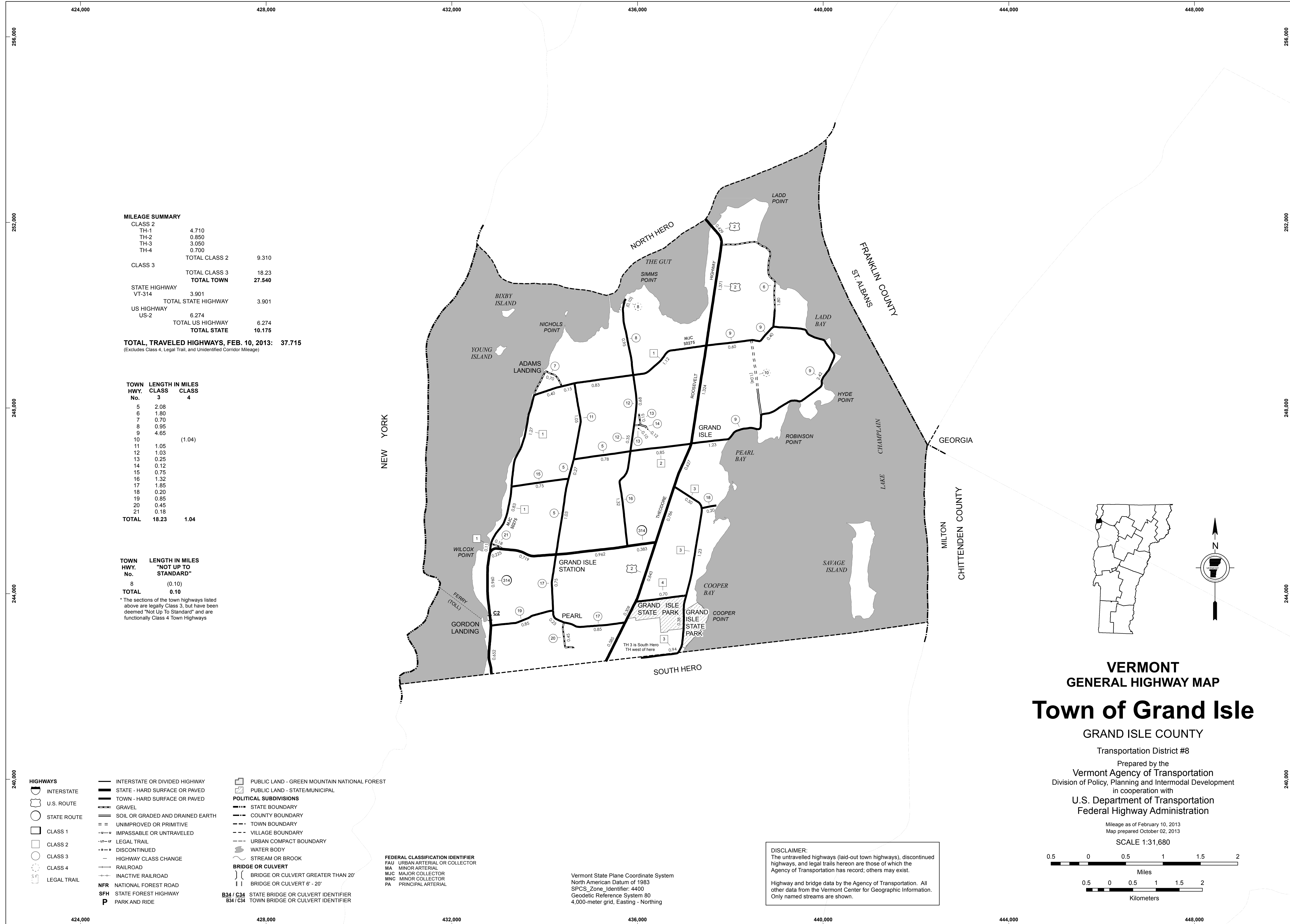

**MILEAGE SUMMARY**

<b>CLASS 2</b>			
TH-1	4.710		
TH-2	0.850		
TH-3	3.050		
TH-4	0.700		
	<b>TOTAL CLASS 2</b>	<b>9.310</b>	
<b>CLASS 3</b>			
	<b>TOTAL CLASS 3</b>	<b>18.23</b>	
	<b>TOTAL TOWN</b>	<b>27.540</b>	
<b>STATE HIGHWAY</b>			
VT-314	3.901		
	<b>TOTAL STATE HIGHWAY</b>	<b>3.901</b>	
<b>US HIGHWAY</b>			
US-2	6.274		
	<b>TOTAL US HIGHWAY</b>	<b>6.274</b>	
	<b>TOTAL STATE</b>	<b>10.175</b>	
	<b>TOTAL, TRAVELED HIGHWAYS, FEB. 10, 2013:</b>	<b>37.715</b>	

(Excludes Class 4, Legal Trail, and Unidentified Corridor Mileage)

TOWN HWY. No.	LENGTH IN MILES CLASS 3	CLASS 4
5	2.08	
6	1.80	
7	0.70	
8	0.95	
9	4.65	
10		(1.04)
11	1.05	
12	1.03	
13	0.25	
14	0.12	
15	0.75	
16	1.32	
17	1.85	
18	0.20	
19	0.85	
20	0.45	
21	0.18	
<b>TOTAL</b>	<b>18.23</b>	<b>1.04</b>

TOWN HWY. No.	LENGTH IN MILES "NOT UP TO STANDARD"
8	(0.10)
<b>TOTAL</b>	<b>0.10</b>

\*The sections of the town highways listed above are legally Class 3, but have been deemed "Not Up To Standard" and are functionally Class 4 Town Highways

NEW YORK

GEORGIA

MILTON CHITTENDEN COUNTY

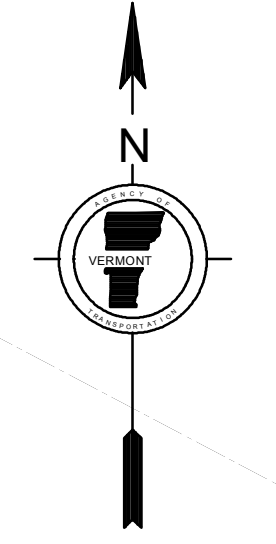
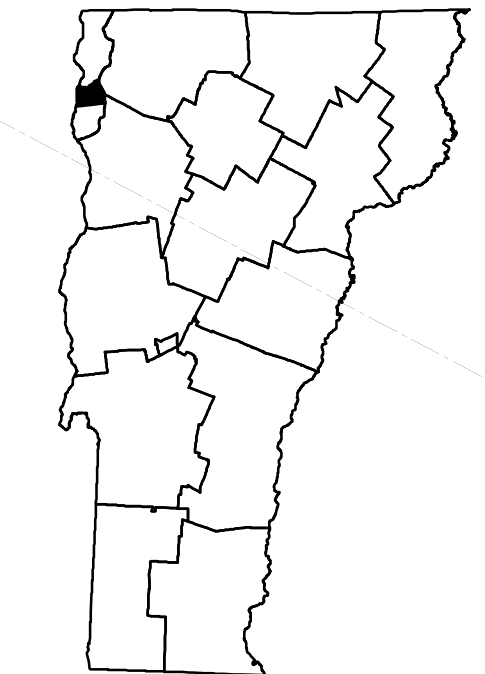

**VERMONT**  
**GENERAL HIGHWAY MAP**  
**Town of Grand Isle**

GRAND ISLE COUNTY

Transportation District #8

Prepared by the  
**Vermont Agency of Transportation**  
 Division of Policy, Planning and Intermodal Development  
 in cooperation with  
**U.S. Department of Transportation**  
**Federal Highway Administration**

Mileage as of February 10, 2013  
 Map prepared October 02, 2013

SCALE 1:31,680

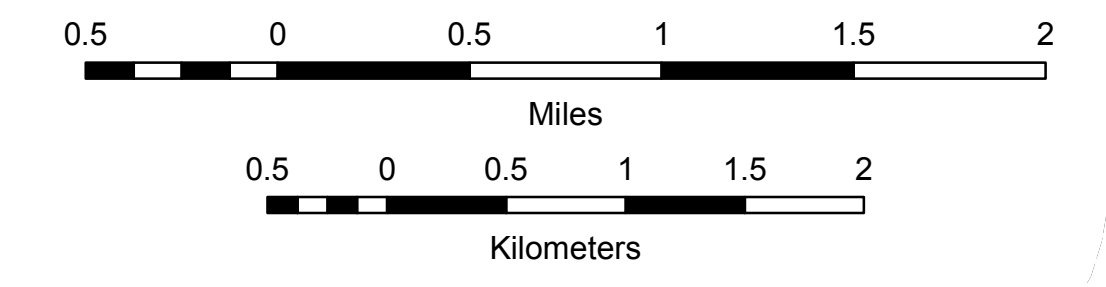

**FEDERAL CLASSIFICATION IDENTIFIER**  
 FAU URBAN ARTERIAL OR COLLECTOR  
 MA MINOR ARTERIAL  
 MJC MAJOR COLLECTOR  
 MNC MINOR COLLECTOR  
 PA PRINCIPAL ARTERIAL

Vermont State Plane Coordinate System  
 North American Datum of 1983  
 SPCS\_Zone\_Identifier: 4400  
 Geodetic Reference System 80  
 4,000-meter grid, Easting - Northing

**DISCLAIMER:**  
 The untraveled highways (laid-out town highways), discontinued highways, and legal trails hereon are those of which the Agency of Transportation has record; others may exist.  
 Highway and bridge data by the Agency of Transportation. All other data from the Vermont Center for Geographic Information. Only named streams are shown.

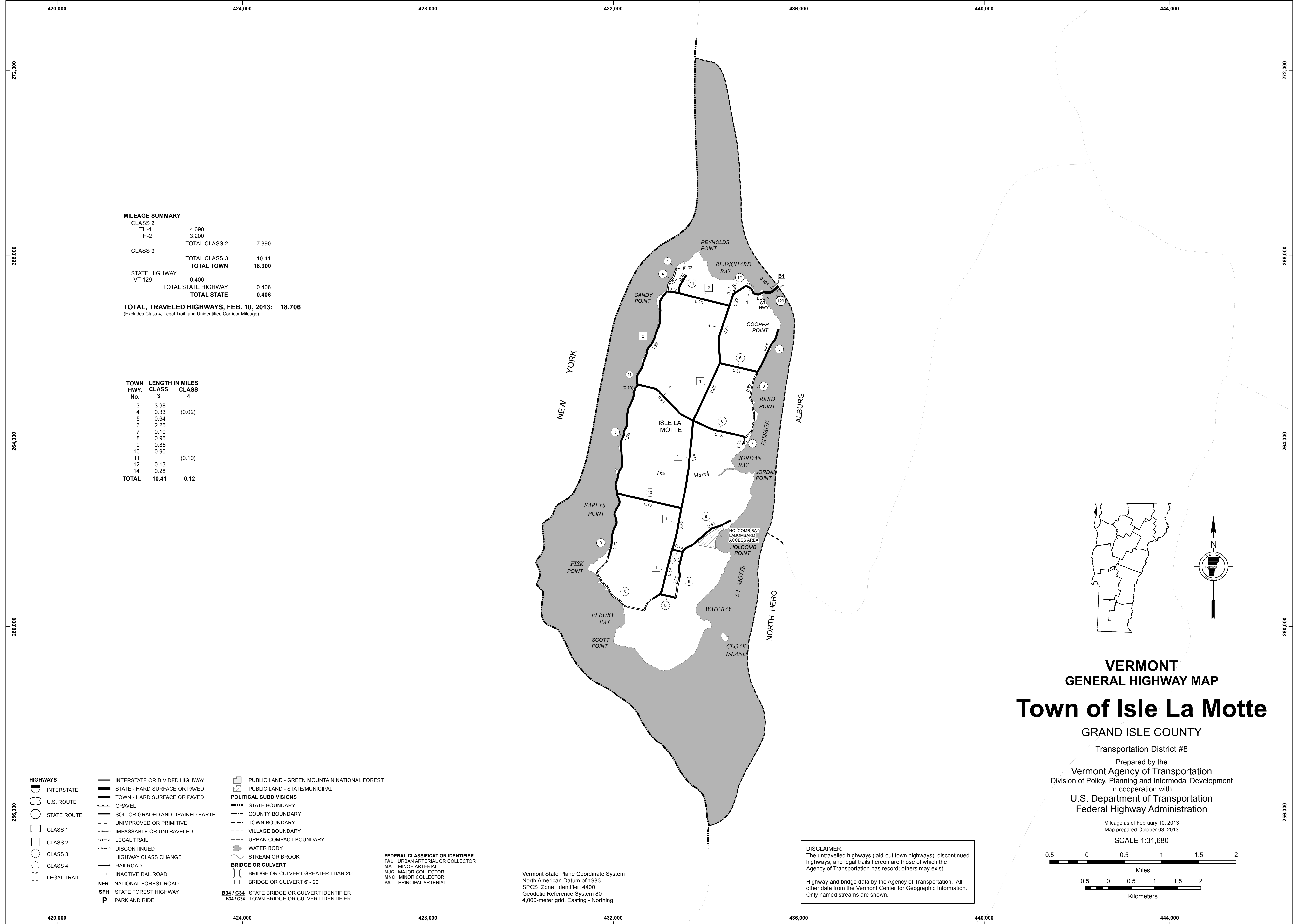

**MILEAGE SUMMARY**

CLASS 2			
TH-1	4.690		
TH-2	3.200		
	<b>TOTAL CLASS 2</b>	<b>7.890</b>	
CLASS 3			
	<b>TOTAL CLASS 3</b>	<b>10.41</b>	
	<b>TOTAL TOWN</b>	<b>18.300</b>	
STATE HIGHWAY			
VT-129	0.406		
	<b>TOTAL STATE HIGHWAY</b>	<b>0.406</b>	
	<b>TOTAL STATE</b>	<b>0.406</b>	

**TOTAL, TRAVELED HIGHWAYS, FEB. 10, 2013: 18.706**  
(Excludes Class 4, Legal Trail, and Unidentified Corridor Mileage)

TOWN HWY. No.	LENGTH IN MILES CLASS 3	CLASS 4
3	3.98	
4	0.33	(0.02)
5	0.64	
6	2.25	
7	0.10	
8	0.95	
9	0.85	
10	0.90	
11		(0.10)
12	0.13	
14	0.28	
<b>TOTAL</b>	<b>10.41</b>	<b>0.12</b>

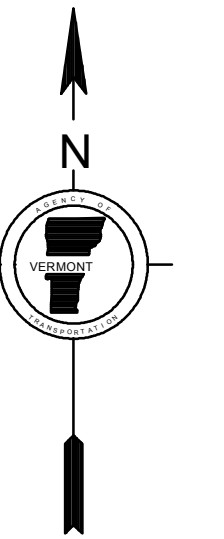
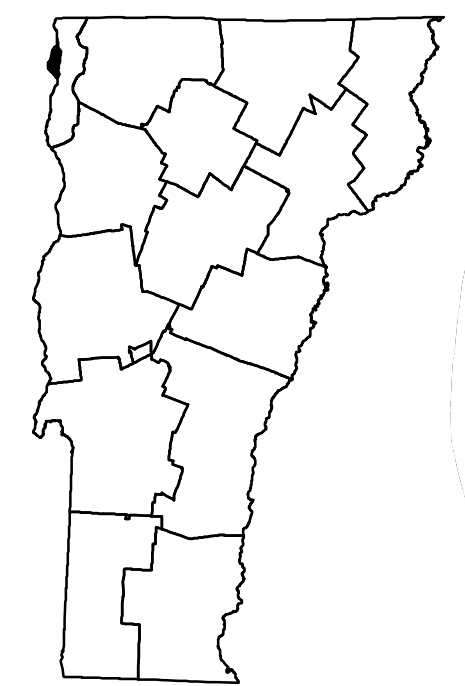

**VERMONT**  
**GENERAL HIGHWAY MAP**  
**Town of Isle La Motte**

GRAND ISLE COUNTY

Transportation District #8

Prepared by the  
Vermont Agency of Transportation  
Division of Policy, Planning and Intermodal Development  
in cooperation with  
U.S. Department of Transportation  
Federal Highway Administration

Mileage as of February 10, 2013  
Map prepared October 03, 2013

SCALE 1:31,680

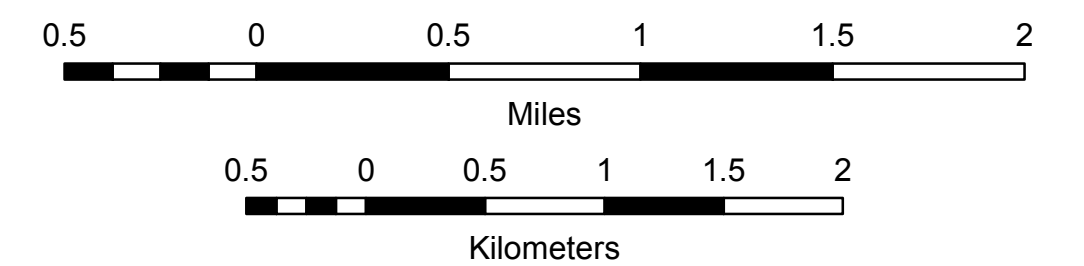

**DISCLAIMER:**  
The untraveled highways (laid-out town highways), discontinued highways, and legal trails hereon are those of which the Agency of Transportation has record; others may exist.  
Highway and bridge data by the Agency of Transportation. All other data from the Vermont Center for Geographic Information. Only named streams are shown.

- PUBLIC LAND - GREEN MOUNTAIN NATIONAL FOREST
- ▨ PUBLIC LAND - STATE/MUNICIPAL
- POLITICAL SUBDIVISIONS**
- STATE BOUNDARY
- COUNTY BOUNDARY
- TOWN BOUNDARY
- VILLAGE BOUNDARY
- URBAN COMPACT BOUNDARY
- WATER BODY
- STREAM OR BROOK
- BRIDGE OR CULVERT**
- BRIDGE OR CULVERT GREATER THAN 20'
- BRIDGE OR CULVERT 6' - 20'
- B34 / C34** STATE BRIDGE OR CULVERT IDENTIFIER
- B34 / C34** TOWN BRIDGE OR CULVERT IDENTIFIER

- FEDERAL CLASSIFICATION IDENTIFIER**
- FAU URBAN ARTERIAL OR COLLECTOR
- MA MINOR ARTERIAL
- MJC MAJOR COLLECTOR
- MNC MINOR COLLECTOR
- PA PRINCIPAL ARTERIAL

Vermont State Plane Coordinate System  
North American Datum of 1983  
SPCS\_Zone\_Identifier: 4400  
Geodetic Reference System 80  
4,000-meter grid, Easting - Northing

**MILEAGE SUMMARY**

CLASS 2		
TH-1	4.000	
TH-2	3.690	
TH-3	1.740	
	<b>TOTAL CLASS 2</b>	<b>9.430</b>
CLASS 3		
	<b>TOTAL CLASS 3</b>	<b>8.66</b>
	<b>TOTAL TOWN</b>	<b>18.090</b>
US HIGHWAY		
US-2	9.340	
	<b>TOTAL US HIGHWAY</b>	<b>9.340</b>
	<b>TOTAL STATE</b>	<b>9.340</b>

**TOTAL, TRAVELED HIGHWAYS, FEB. 10, 2012: 27.430**  
 (Excludes Class 4, Legal Trail, and Unidentified Corridor Mileage)

TOWN HWY. No.	LENGTH IN MILES CLASS 3	CLASS 4
4	1.04	
5	0.30	(0.10)
6	0.24	
7	1.05	
8	1.91	
9	0.93	
10	0.96	
11	1.10	
12	0.19	
13	0.38	
14	0.22	
15	0.34	
<b>TOTAL</b>	<b>8.66</b>	<b>0.10</b>

- HIGHWAYS**
- INTERSTATE
  - U.S. ROUTE
  - STATE ROUTE
  - CLASS 1
  - CLASS 2
  - CLASS 3
  - CLASS 4
  - LEGAL TRAIL
  - INTERSTATE OR DIVIDED HIGHWAY
  - STATE - HARD SURFACE OR PAVED
  - TOWN - HARD SURFACE OR PAVED
  - GRAVEL
  - SOIL OR GRADED AND DRAINED EARTH
  - UNIMPROVED OR PRIMITIVE
  - IMPASSABLE OR UNTRAVELED
  - LEGAL TRAIL
  - DISCONTINUED
  - HIGHWAY CLASS CHANGE
  - RAILROAD
  - INACTIVE RAILROAD
  - PUBLIC LAND - GREEN MOUNTAIN NATIONAL FOREST
  - PUBLIC LAND - STATE/MUNICIPAL
- POLITICAL SUBDIVISIONS**
- STATE BOUNDARY
  - COUNTY BOUNDARY
  - TOWN BOUNDARY
  - VILLAGE BOUNDARY
  - URBAN COMPACT BOUNDARY
  - WATER BODY
  - STREAM OR BROOK
- BRIDGE OR CULVERT**
- BRIDGE OR CULVERT GREATER THAN 20'
  - BRIDGE OR CULVERT 6' - 20'
- B34 / C34 STATE BRIDGE OR CULVERT IDENTIFIER**
- B34 / C34 TOWN BRIDGE OR CULVERT IDENTIFIER**
- P** PARK AND RIDE
- FEDERAL CLASSIFICATION IDENTIFIER**
- FAU URBAN ARTERIAL OR COLLECTOR
  - MA MINOR ARTERIAL
  - MJC MAJOR COLLECTOR
  - MNC MINOR COLLECTOR
  - PA PRINCIPAL ARTERIAL

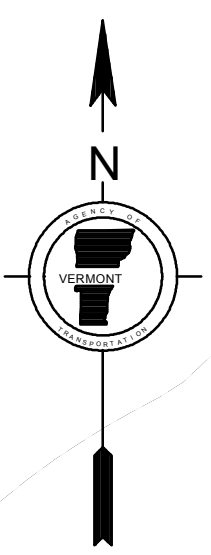
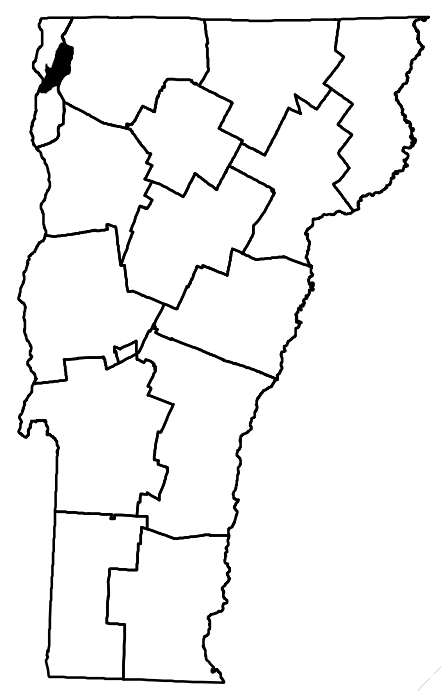
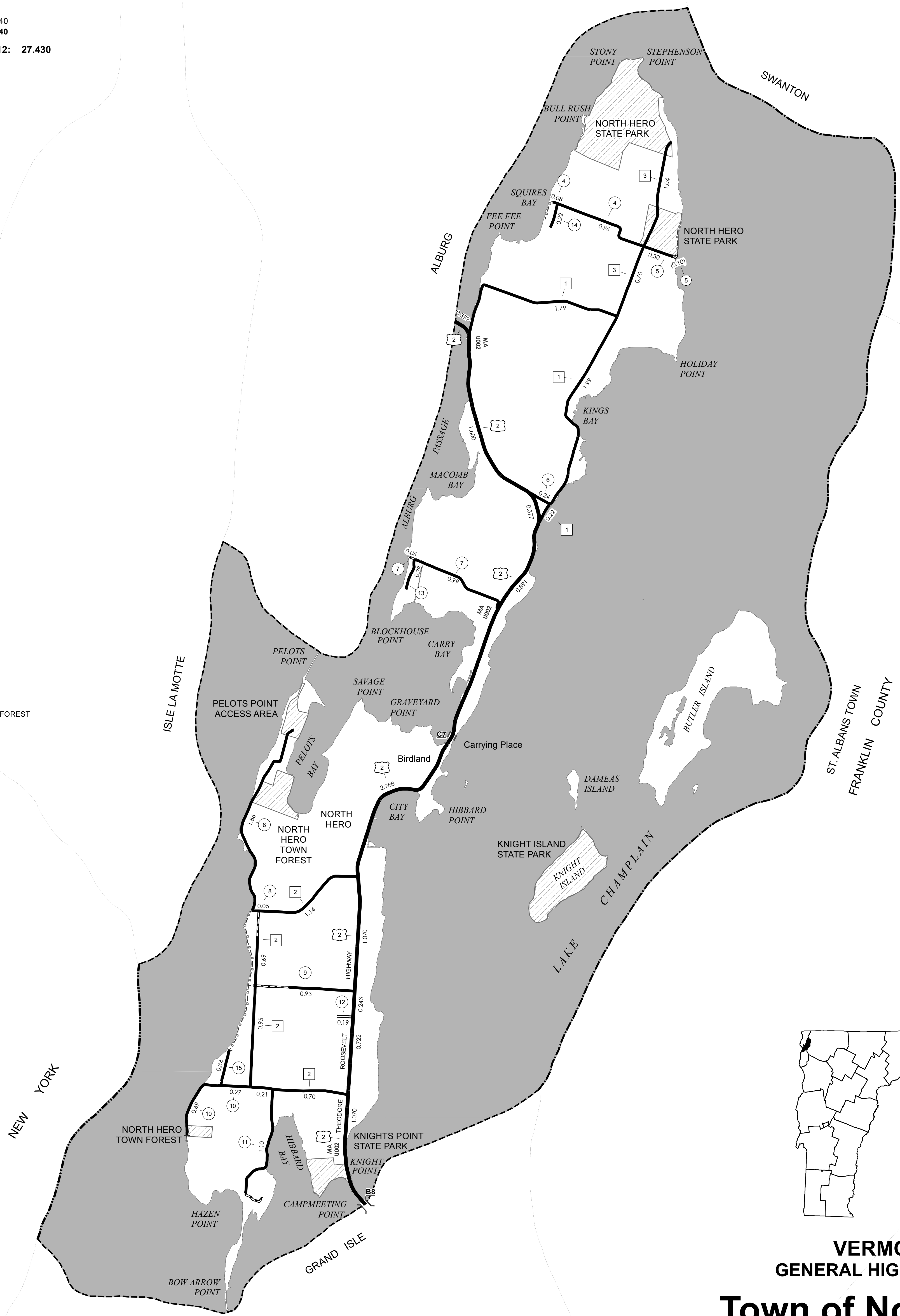

**VERMONT**  
**GENERAL HIGHWAY MAP**  
**Town of North Hero**

GRAND ISLE COUNTY  
 Transportation District #8  
 Prepared by the  
 Vermont Agency of Transportation  
 Division of Policy, Planning and Intermodal Development  
 in cooperation with  
 U.S. Department of Transportation  
 Federal Highway Administration

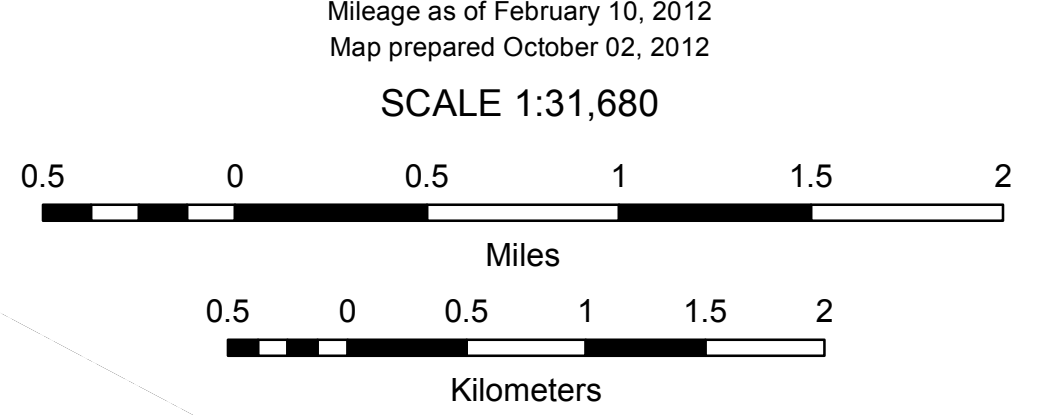

**DISCLAIMER:**  
 The untraveled highways (laid-out town highways), discontinued highways, and legal trails hereon are those of which the Agency of Transportation has record; others may exist.

Highway and bridge data by the Agency of Transportation. All other data from the Vermont Center for Geographic Information. Only named streams are shown.

Vermont State Plane Coordinate System  
 North American Datum of 1983  
 SPCS\_Zone\_Identifier: 4400  
 Geodetic Reference System 80  
 4,000-meter grid, Easting - Northing



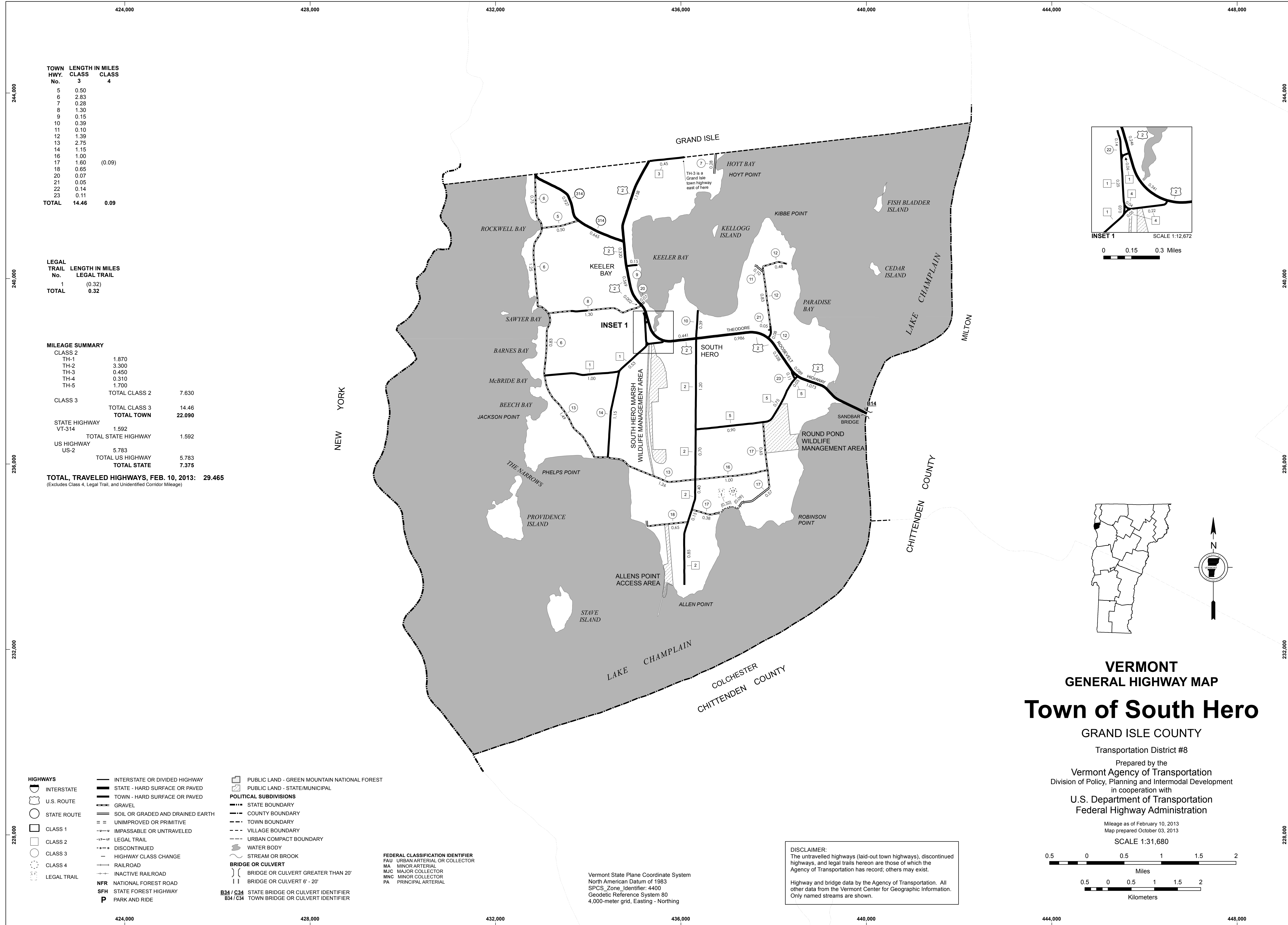

TOWN HWY. No.	LENGTH IN MILES CLASS 3	CLASS 4
5	0.50	
6	2.83	
7	0.28	
8	1.30	
9	0.15	
10	0.39	
11	0.10	
12	1.39	
13	2.75	
14	1.15	
16	1.00	
17	1.60	(0.09)
18	0.65	
20	0.07	
21	0.05	
22	0.14	
23	0.11	
<b>TOTAL</b>	<b>14.46</b>	<b>0.09</b>

LEGAL TRAIL No.	LENGTH IN MILES LEGAL TRAIL
1	(0.32)
<b>TOTAL</b>	<b>0.32</b>

MILEAGE SUMMARY		
CLASS 2		
TH-1	1.870	
TH-2	3.300	
TH-3	0.450	
TH-4	0.310	
TH-5	1.700	
<b>TOTAL CLASS 2</b>	<b>7.630</b>	
CLASS 3		
<b>TOTAL CLASS 3</b>	<b>14.46</b>	
<b>TOTAL TOWN</b>	<b>22.090</b>	
STATE HIGHWAY		
VT-314	1.592	
<b>TOTAL STATE HIGHWAY</b>	<b>1.592</b>	
US HIGHWAY		
US-2	5.783	
<b>TOTAL US HIGHWAY</b>	<b>5.783</b>	
<b>TOTAL STATE</b>	<b>7.375</b>	

**TOTAL, TRAVELED HIGHWAYS, FEB. 10, 2013: 29.465**  
 (Excludes Class 4, Legal Trail, and Unidentified Corridor Mileage)

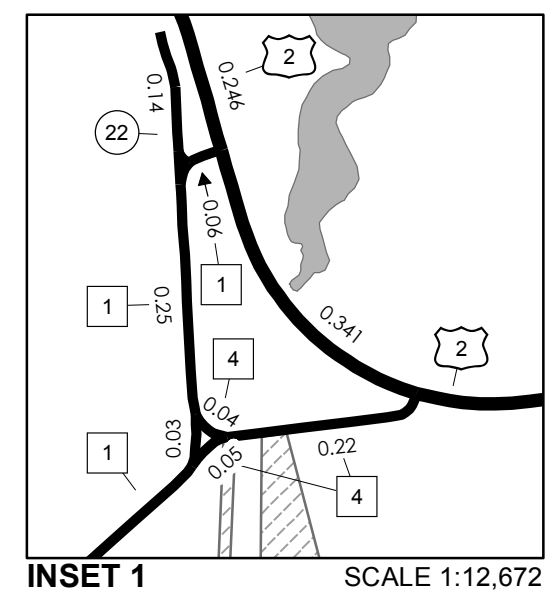

INSET 1 SCALE 1:12,672  
 0 0.15 0.3 Miles

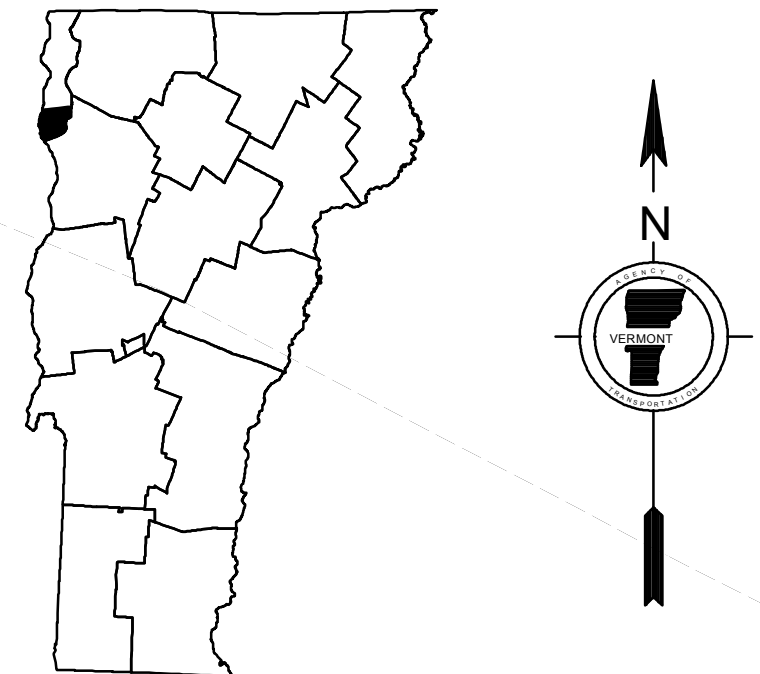

# VERMONT GENERAL HIGHWAY MAP

## Town of South Hero

GRAND ISLE COUNTY

Transportation District #8

Prepared by the  
 Vermont Agency of Transportation  
 Division of Policy, Planning and Intermodal Development  
 in cooperation with

U.S. Department of Transportation  
 Federal Highway Administration

Mileage as of February 10, 2013  
 Map prepared October 03, 2013

SCALE 1:31,680

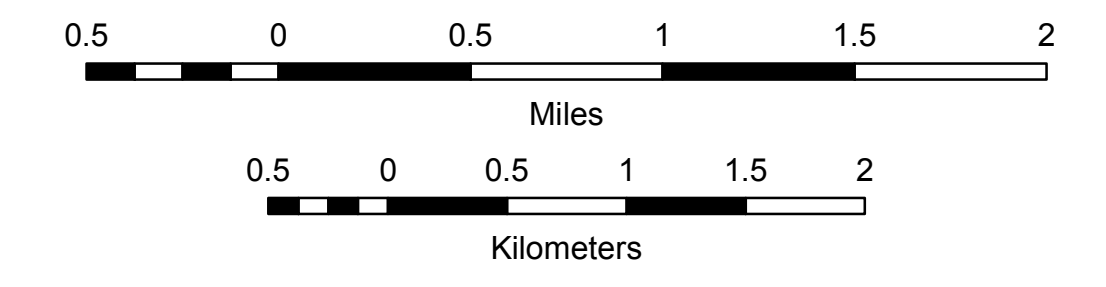

- INTERSTATE OR DIVIDED HIGHWAY
- STATE - HARD SURFACE OR PAVED
- TOWN - HARD SURFACE OR PAVED
- GRAVEL
- SOIL OR GRADED AND DRAINED EARTH
- UNIMPROVED OR PRIMITIVE
- IMPASSABLE OR UNTRAVELED
- LEGAL TRAIL
- DISCONTINUED
- HIGHWAY CLASS CHANGE
- RAILROAD
- INACTIVE RAILROAD
- NFR NATIONAL FOREST ROAD
- SFH STATE FOREST HIGHWAY
- P PARK AND RIDE

- PUBLIC LAND - GREEN MOUNTAIN NATIONAL FOREST
- PUBLIC LAND - STATE/MUNICIPAL
- POLITICAL SUBDIVISIONS**
- STATE BOUNDARY
- COUNTY BOUNDARY
- TOWN BOUNDARY
- VILLAGE BOUNDARY
- URBAN COMPACT BOUNDARY
- WATER BODY
- STREAM OR BROOK
- BRIDGE OR CULVERT**
- BRIDGE OR CULVERT GREATER THAN 20'
- BRIDGE OR CULVERT 6' - 20'
- B34 / C34 STATE BRIDGE OR CULVERT IDENTIFIER
- B34 / C34 TOWN BRIDGE OR CULVERT IDENTIFIER

- FEDERAL CLASSIFICATION IDENTIFIER
- FAU URBAN ARTERIAL OR COLLECTOR
- MA MINOR ARTERIAL
- MJC MAJOR COLLECTOR
- MNC MINOR COLLECTOR
- PA PRINCIPAL ARTERIAL

Vermont State Plane Coordinate System  
 North American Datum of 1983  
 SPCS\_Zone\_Identifier: 4400  
 Geodetic Reference System 80  
 4,000-meter grid, Easting - Northing

**DISCLAIMER:**  
 The untraveled highways (laid-out town highways), discontinued highways, and legal trails hereon are those of which the Agency of Transportation has record; others may exist.  
 Highway and bridge data by the Agency of Transportation. All other data from the Vermont Center for Geographic Information. Only named streams are shown.