

# Highway Changes Prompted by 2026 Mileage Certificates

# Vermont Agency of Transportation

VTrans\_notify\_rpt

Contact: Kerry Alley, GIS Professional III, Email: [kerry.alley@vermont.gov](mailto:kerry.alley@vermont.gov)

Wednesday, May 27, 2026

Report Location:

[https://vtransmaps.vermont.gov/Maps/Publications/MileageCertificates/MileageAnnualUpdates/MileageAnnualUpdates/2026\\_StateHwyChanges.pdf](https://vtransmaps.vermont.gov/Maps/Publications/MileageCertificates/MileageAnnualUpdates/MileageAnnualUpdates/2026_StateHwyChanges.pdf)

Town Highway Map Webpage: <https://vtrans.vermont.gov/planning/maps/town-maps>

(New "ancient" roads are listed under Reclassified/Remeasured)

County	Town	New Highway Mileage	Reclassified/Remeasured	Discontinued Mileage	VTrans Notes
ADDISON	PANTON		1.15 mi TH-14 (West Rd) reclassified from CL4 to CL3		Off VT-22A, TH-14 (West Rd) 1.15 mi CL4 reclassified to CL3 MM 1.11, west (left) side
BENNINGTON	BENNINGTON	VT-67A roundabout reconfiguration at intersection with TH-11 (Matteson Rd) and TH-26 (Silk Rd) (no mileage change) 0.28 mi CL3 TH-512 (Duffy Dr) new road; 0.10 mi CL3 TH-513 (Jayne Ln) new road; 0.12 mi CL3 TH-514 (Hildur Hl) new road			VT-67A roundabout reconfiguration at intersection with TH-11 (Matteson Rd) and TH-26 (Silk Rd) between MMs 1.019 to 1.134
BENNINGTON	POWNAI	+0.017 mi CL2 TH-2 approach (S0103WA001) added not previously mapped approach at VT346 +0.23 mi TH-24 (Dean Rd) extension designated CL3 Provisional pursuant to 19 VSA 302c	-0.017 mi CL2 TH-2 (N Pownal Rd, S0103) remeasured to 3 decimal places 1.01 mi CL3 TH-5 (Carpenter Hill Rd West) designated NUTS designated Not Up To Standard (NUTS) pursuant to 19 VSA 305(a) 0.10 mi CL3 TH-45 (Orchard St) designated Not Up To Standard (NUTS) pursuant to 19 VSA 305(a)		No net mileage change for CL2 TH-2
CHITTENDEN	COLCHESTER		I-89 Exit 17 Interchange reconfiguration: +0.084 mi Ramp A - I089-0000SR017A +0.052 mi Ramp B - I089-0000SR017B -0.042 mi Ramp D - I089-0000NR017D +0.072 mi Ramp D - I089-0000NS017D -0.072 mi Ramp E - I089-0000NR017E +0.231 mi Ramp E - I089-0000SR017E -0.166 mi Ramp F - I089-0000SR017F		Reconfiguration of I-89 and US-2 interchange (I-89 Exit 17) Project: NH 028-1(31) PIN: 14T213
FRANKLIN	FAIRFIELD			-0.17 mi CL4 TH-73 (Sherman St) discontinued - was NUTs	Off VT-36, CL4 TH-73 (Sherman St) discontinued at MM = 9.836, south (right) side - was NUTs

(New "ancient" roads are listed under Reclassified/Remeasured)

<i>County</i>	<i>Town</i>	<i>New Highway Mileage</i>	<i>Reclassified/Remeasured</i>	<i>Discontinued Mileage</i>	<i>VTrans Notes</i>
WINDHAM	WILMINGTON		+0.02 mi CL2 TH-3 (Higley Hill Rd) added previously unmapped approach and remeasured -0.03 mi CL3 TH-76 (Top of Hill Rd) remeasured to end Town owned ROW at turn around		Off VT-100, CL2 TH-3 (Higley Hill Rd) centerline updated to reflect approach at MM = 5.590, east (right) side

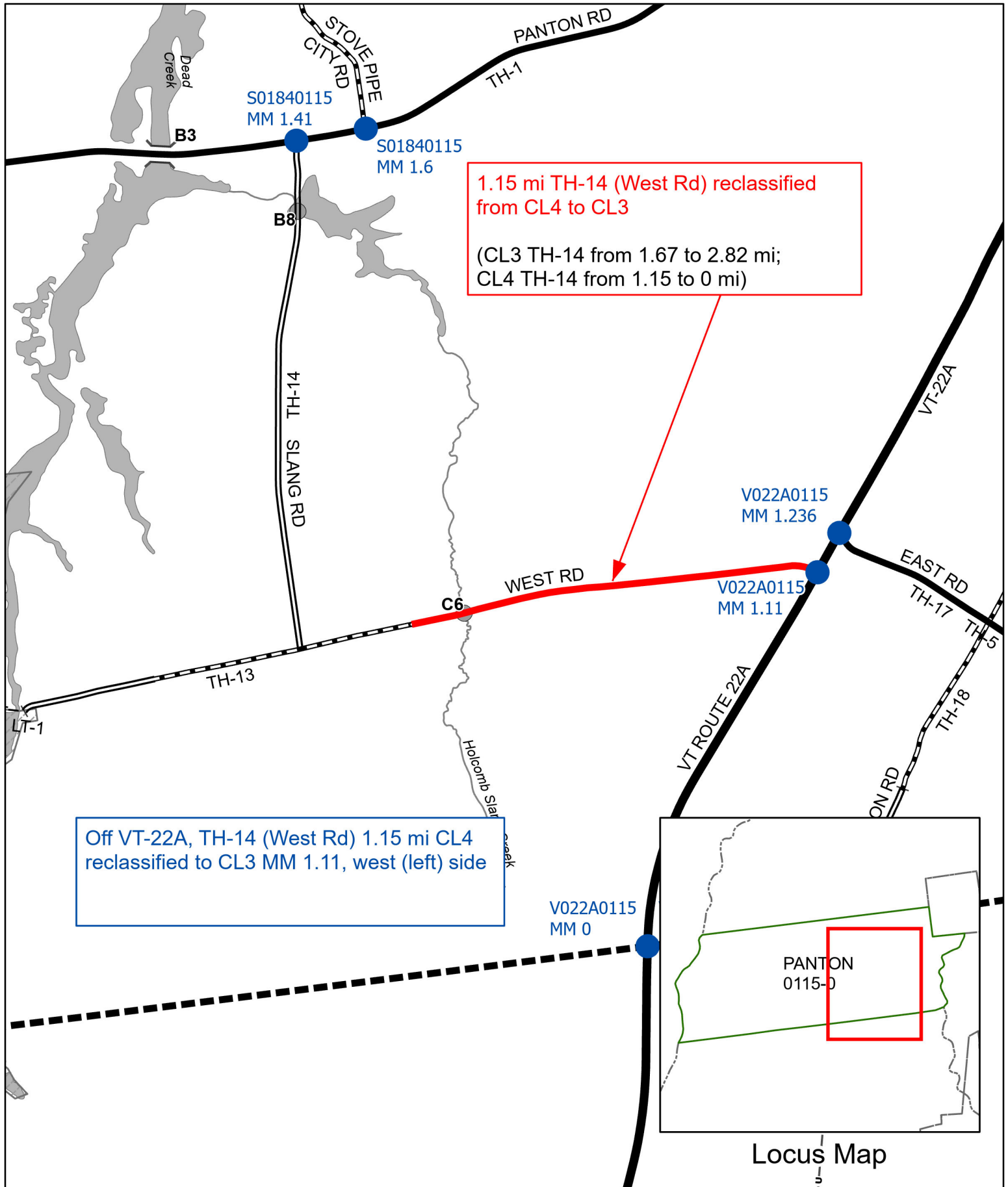

**Mileage Certificate Changes 2026**  
**PANTON TH-14**  
 (CTUA:0115-0)  
 (CERTCODE:0115-0)

Mapping Unit  
 Highway Division  
 Vermont Agency of Transportation -- March 2, 2026

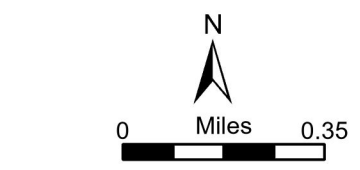

VT-67A roundabout reconfiguration at intersection with TH-11 (Matteson Rd) and TH-26 (Silk Rd) between MMs 1.019 to 1.134

VT-67A roundabout reconfiguration at intersection with TH-11 (Matteson Rd) and TH-26 (Silk Rd) (no mileage change)

Previous intersection configuration

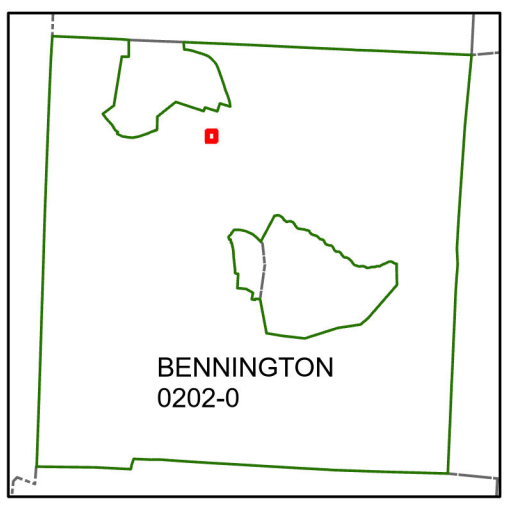
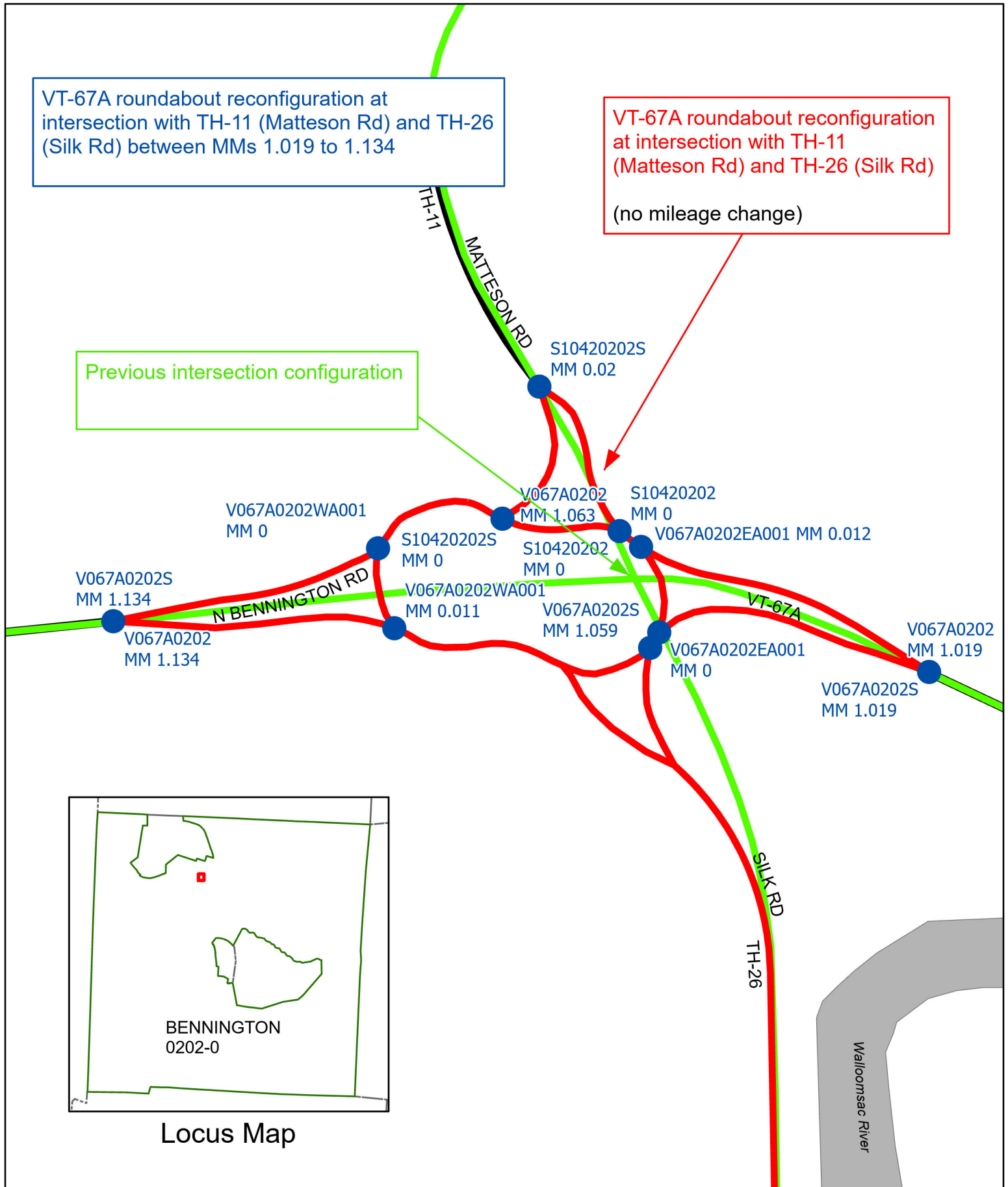

Locus Map

**Mileage Certificate Changes 2026  
BENNINGTON VT-67A**

(CTUA:0202-0)  
(CERTCODE:0202-0)

Mapping Section  
Highway Division  
Vermont Agency of Transportation -- December 31, 2025

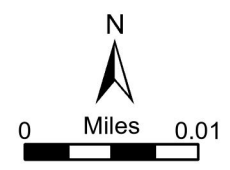

**I-89 Exit 17 Interchange reconfiguration:**  
 +0.084 mi Ramp A - I089-0000SR017A  
 +0.052 mi Ramp B - I089-0000SR017B  
 -0.042 mi Ramp D - I089-0000NR017D  
 +0.072 mi Ramp D - I089-0000NS017D  
 -0.072 mi Ramp E - I089-0000NR017E  
 +0.231 mi Ramp E - I089-0000SR017E  
 -0.166 mi Ramp F - I089-0000SR017F  
 (Previous alignments shown in blue)

(State Ramps from 2.206 to 2.040 mi)

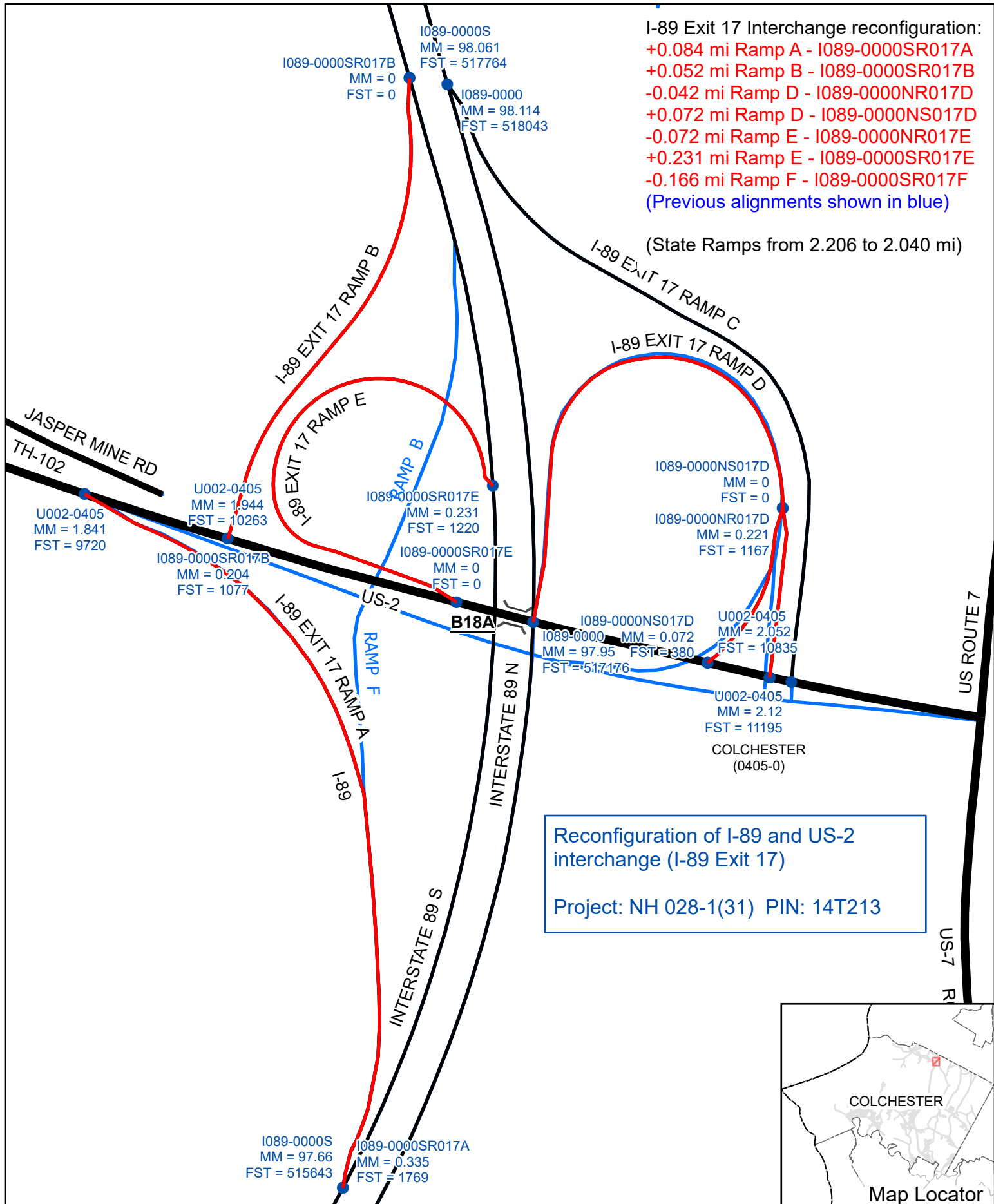

Reconfiguration of I-89 and US-2 interchange (I-89 Exit 17)  
 Project: NH 028-1(31) PIN: 14T213



**Mileage Certificate Changes 2026**  
**COLCHESTER**

(CTUA:0405-0)  
 (CERTCODE:0405-0)

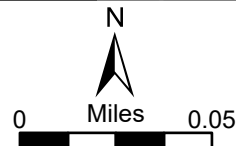

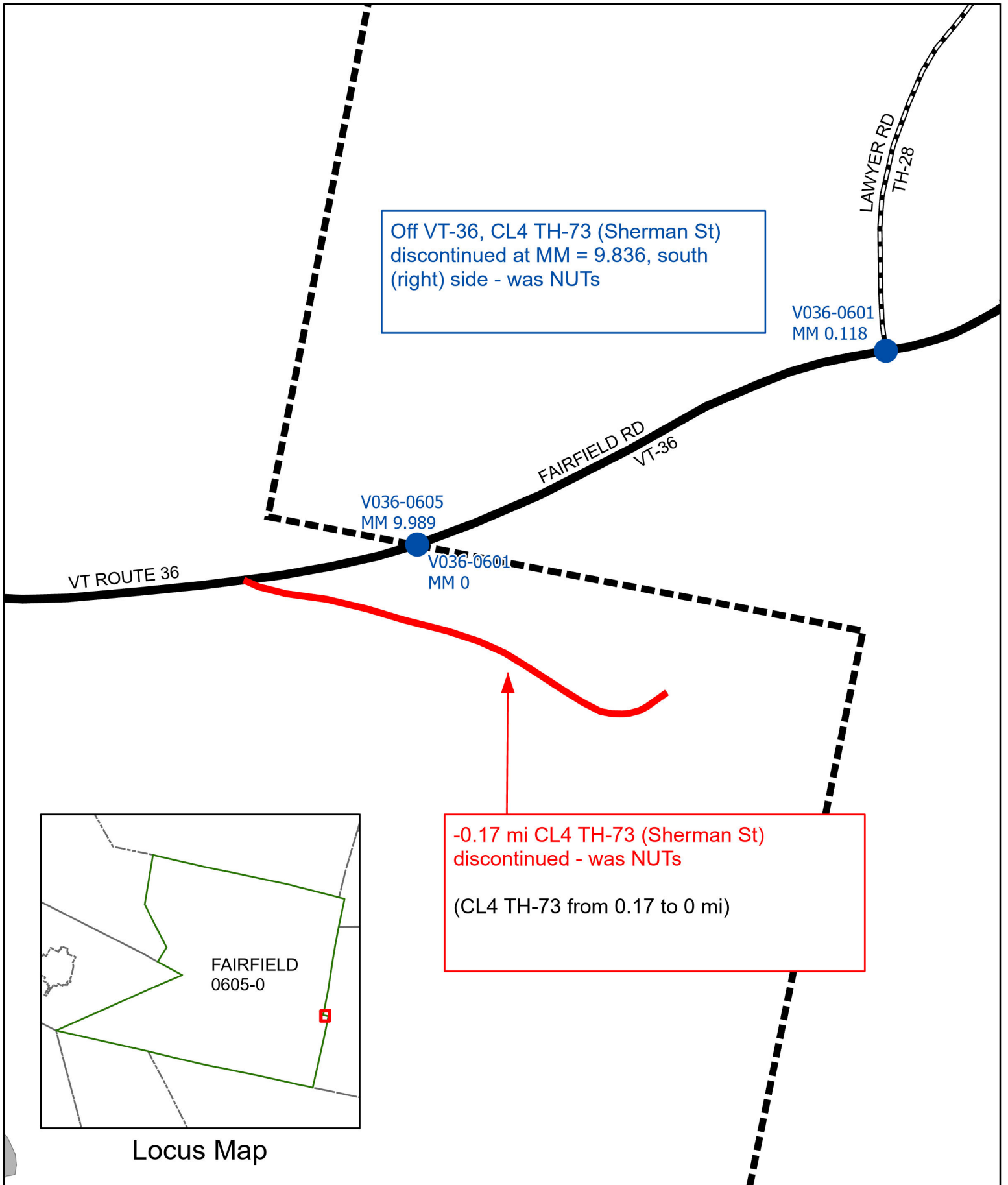

Off VT-36, CL4 TH-73 (Sherman St)  
discontinued at MM = 9.836, south  
(right) side - was NUTs

V036-0601  
MM 0.118

V036-0605  
MM 9.989

V036-0601  
MM 0

-0.17 mi CL4 TH-73 (Sherman St)  
discontinued - was NUTs  
  
(CL4 TH-73 from 0.17 to 0 mi)

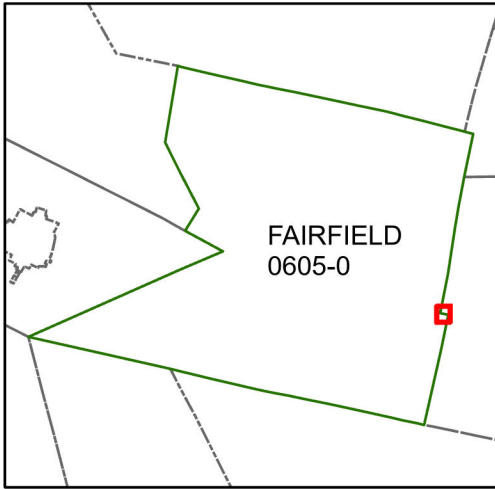

Locus Map

**Mileage Certificate Changes 2026  
FAIRFIELD TH-73**

(CTUA:0605-0)  
(CERTCODE:0605-0)

Mapping Unit  
Highway Division  
Vermont Agency of Transportation -- February 25, 2026

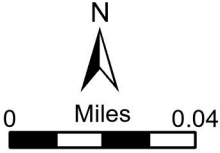

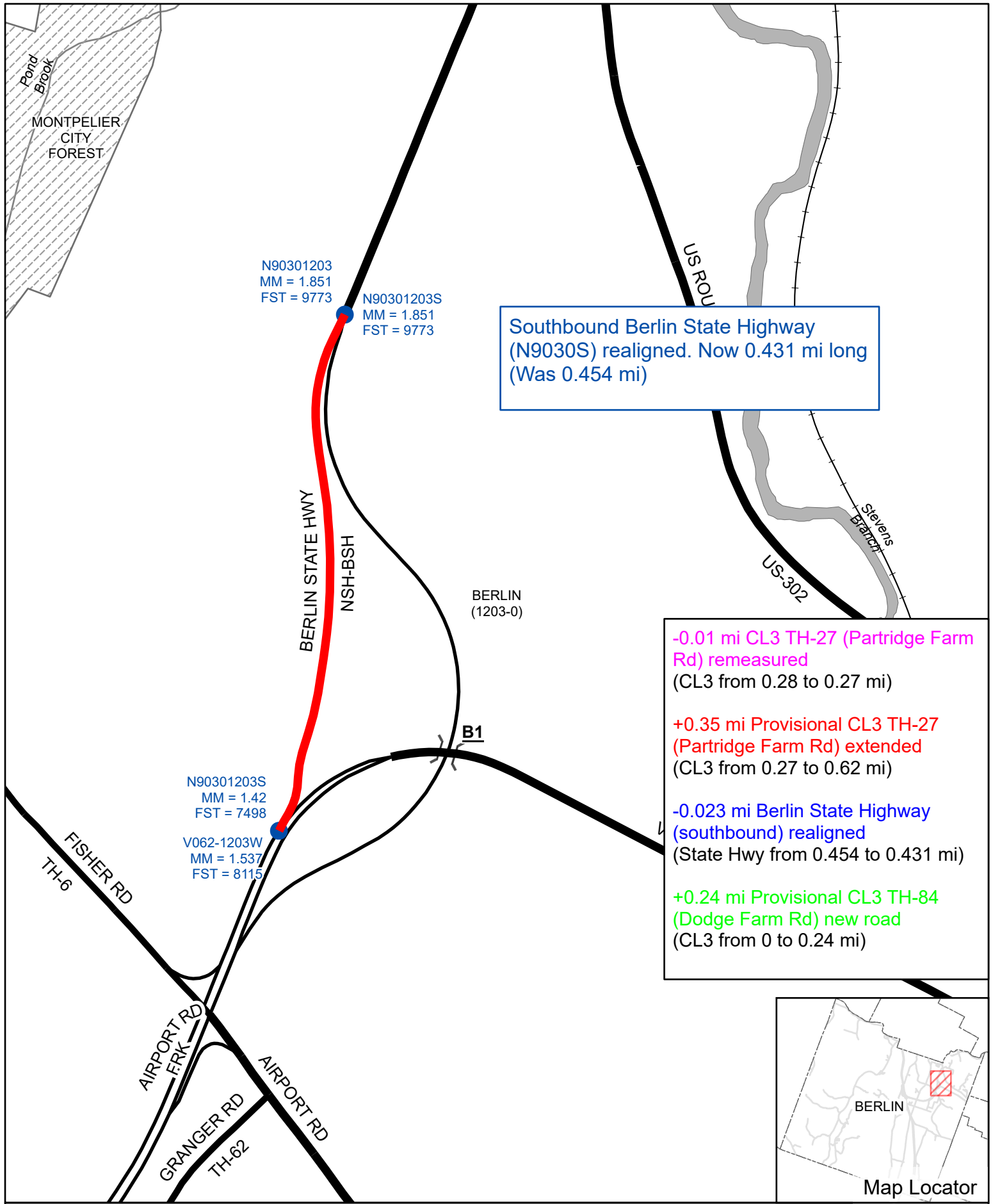

Southbound Berlin State Highway (N9030S) realigned. Now 0.431 mi long (Was 0.454 mi)

- 0.01 mi CL3 TH-27 (Partridge Farm Rd) remeasured (CL3 from 0.28 to 0.27 mi)
- +0.35 mi Provisional CL3 TH-27 (Partridge Farm Rd) extended (CL3 from 0.27 to 0.62 mi)
- 0.023 mi Berlin State Highway (southbound) realigned (State Hwy from 0.454 to 0.431 mi)
- +0.24 mi Provisional CL3 TH-84 (Dodge Farm Rd) new road (CL3 from 0 to 0.24 mi)



**Mileage Certificate Changes 2026**

**BERLIN**  
 (CTUA:1203-0)  
 (CERTCODE:1203-0)

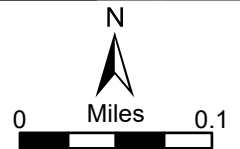

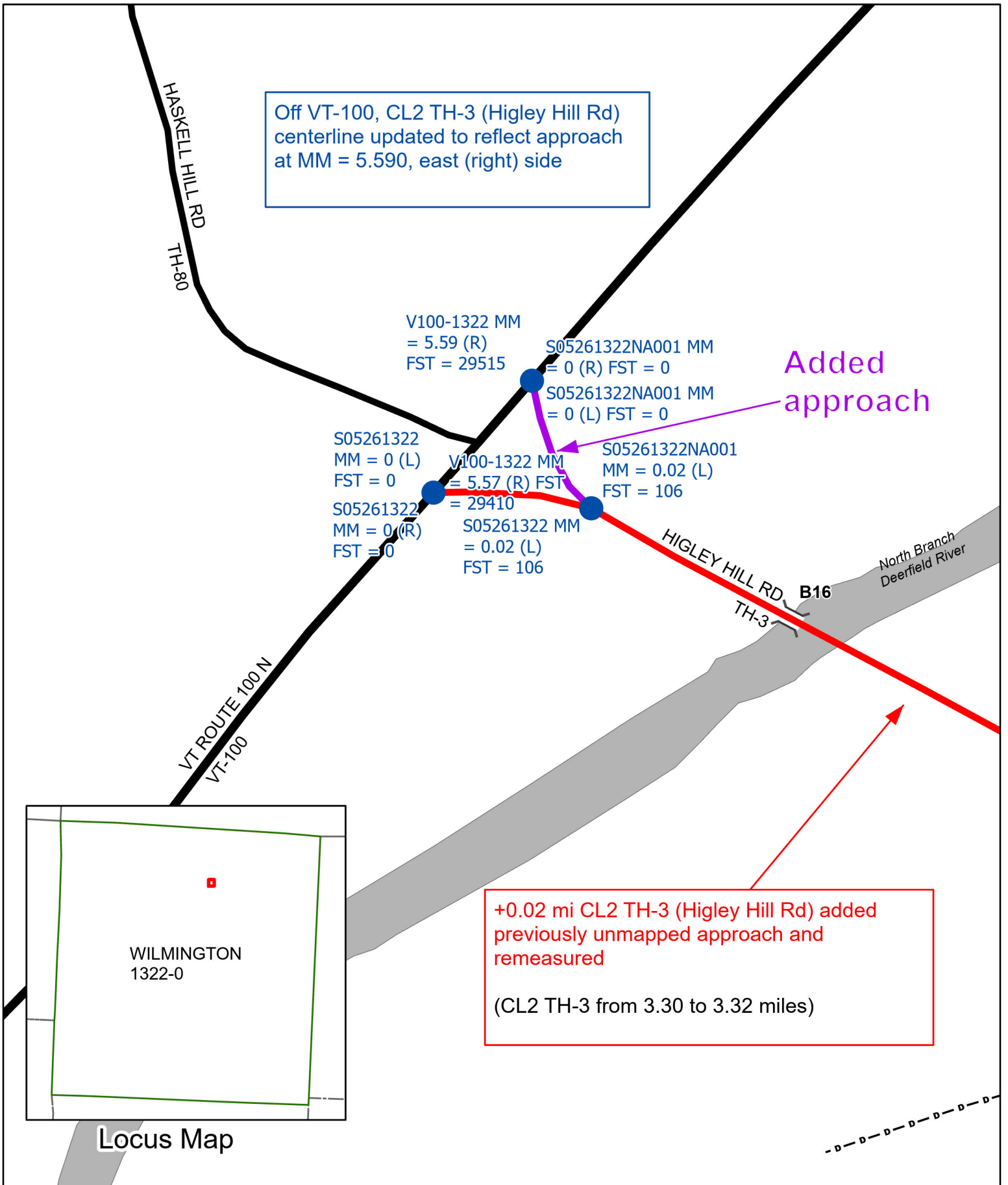

**Mileage Certificate Changes 2026**

**WILMINGTON TH-3**

(CTUA:1322-0)  
(CERTCODE:1322-0)

Mapping Section  
Highway Division  
Vermont Agency of Transportation -- December 30, 2025

