

Highway Changes Prompted by 2022 Mileage Certificates

Vermont Agency of Transportation

VTrans_notify_rpt

Contact: Kerry Alley, GIS Professional III, Email: kerry.alley@vermont.gov

Thursday, August 4, 2022

Report Location:

https://vtransmaps.vermont.gov/Maps/Publications/MileageCertificates/MileageAnnualUpdates/MileageAnnualUpdates/2022_StateHwyChanges.pdf

Town Highway Map Webpage: <https://vtrans.vermont.gov/planning/maps/town-maps>

(New "ancient" roads are listed under Reclassified/Remeasured)

County	Town	New Highway Mileage	Reclassified/Remeasured	Discontinued Mileage	VTrans Notes
ADDISON	MIDDLEBURY		Changes due to updated line work and remeasurement project 18V220: -0.011 mi US-7 (State Hwy) (-0.019 mi in Town, +0.008 mi in UC) +0.01 mi CL1 TH-1 approach (U007-0111NA002) +0.011 mi CL1 TH-1 (US-7 Southbound at Court Sq) -0.003 mi CL1 TH-1 (US-7 main line / NB)		State Highway US-7 updated line work and remeasurement from mile marker 0 to 7.476
FRANKLIN	BERKSHIRE		0.04 mi CL3 TH-11 (Potato Hill Rd) reclassified to CL4 TH-11 0.03 mi CL3 TH-18 (Town Hwy 18) reclassified to CL4 TH-18 0.07 mi CL3 TH-21 (Short St) reclassified to CL4 TH-21		Off VT-120, TH-21 reclassified from CL3 to CL4 MM = 0.178, north (left) side
FRANKLIN	ENOSBURGH			-0.30 mi Legal Trail LT-3 discontinued -1.02 mi Legal Trail LT-4 discontinued -0.10 mi Legal Trail LT-6 discontinued	Off VT-105, Legal Trail LT-3 discontinued at MM = 3.608, north (left) side
FRANKLIN	SAINT ALBANS TOWN	+0.28 CL3 TH-103 (Loomis Ln) new road +0.10 CL3 TH-104 (Ethel Ct) new road	-0.041 mi VT-105 realignment of ramp V105-0613EA001 intersection at VT-105		Off VT-38, CL 3 TH-103 new road at MM = 1.458 right (north) side VT-105 approach (V105-0613EA001) realignment at intersection with VT-105 from mile marker 0 to 0.231

(New "ancient" roads are listed under Reclassified/Remeasured)

<i>County</i>	<i>Town</i>	<i>New Highway Mileage</i>	<i>Reclassified/Remeasured</i>	<i>Discontinued Mileage</i>	<i>VTrans Notes</i>
LAMOILLE	HYDE PARK		-0.31 miles CL2 TH-1 (Center Rd and Centerville Rd) remeasured -0.09 mi CL3 TH-59 remeasured (-0.04 tw, -0.05 vil) -0.08 mi CL4 TH-59 remeasured (-0.12 tw, +0.04 vil) -0.01 mi CL3 TH-64 remeasured +0.07 mi CL4 TH-72 remeasured		Off VT-100, CL3 TH-59 centerline updated to reflect perpendicular approach, now at MM = 1.005, south (right) side
ORANGE	THETFORD		Designated 0.31 mi CL3 TH-54 Not Up To Standards (NUTS) pursuant to 19 VSA 305(a)		Off VT-132, CL3 TH-54 Not Up to Standards (NUTS) now CL4 at MM = 4.57, west (right) side
ORLEANS	NEWPORT CITY		-0.08 mi CL3 TH-139 (Gardner St) discontinued. City sold property to Passumpsic Savings Bank in 2004.		Off I91 Access Rd and US-5, CL3 TH-139 discontinued
RUTLAND	WEST RUTLAND		-0.195 mi BR-4 Jughandle removed -0.076 mi BR-4 Slip ramp removed Project #s STP FVAP (18) & STPG SGNL (50)		Off US-4 and VT-4A. Slip ramp and jughandle removed
WINDSOR	BETHEL		-0.006 mi VT-12 new alignment and length change due to bridge 38 project (BETHEL - BHF 0241(38) - 10C216).		VT-12 centerline adjusted from intersection with VT-107 at MM 1.383 to 1.453 and from MM = 2.345 to MM = 7.013 (Randolph town line)
WINDSOR	HARTFORD	+0.040 miles US-5 for approaches at roundabout +0.02 for CL2 TH-10 approaches S03251408WA001 and S03251408EA001 at roundabout (each approach +0.01 miles)	-0.01 miles CL3 TH-179 due to moving eastbound TH-10 south		Construction of roundabout after US-5 MM 3.025 and US 5 S MM 3.147 Approaches added: +0.018 mi US5-NA001 +0.022 mi US5-SA001

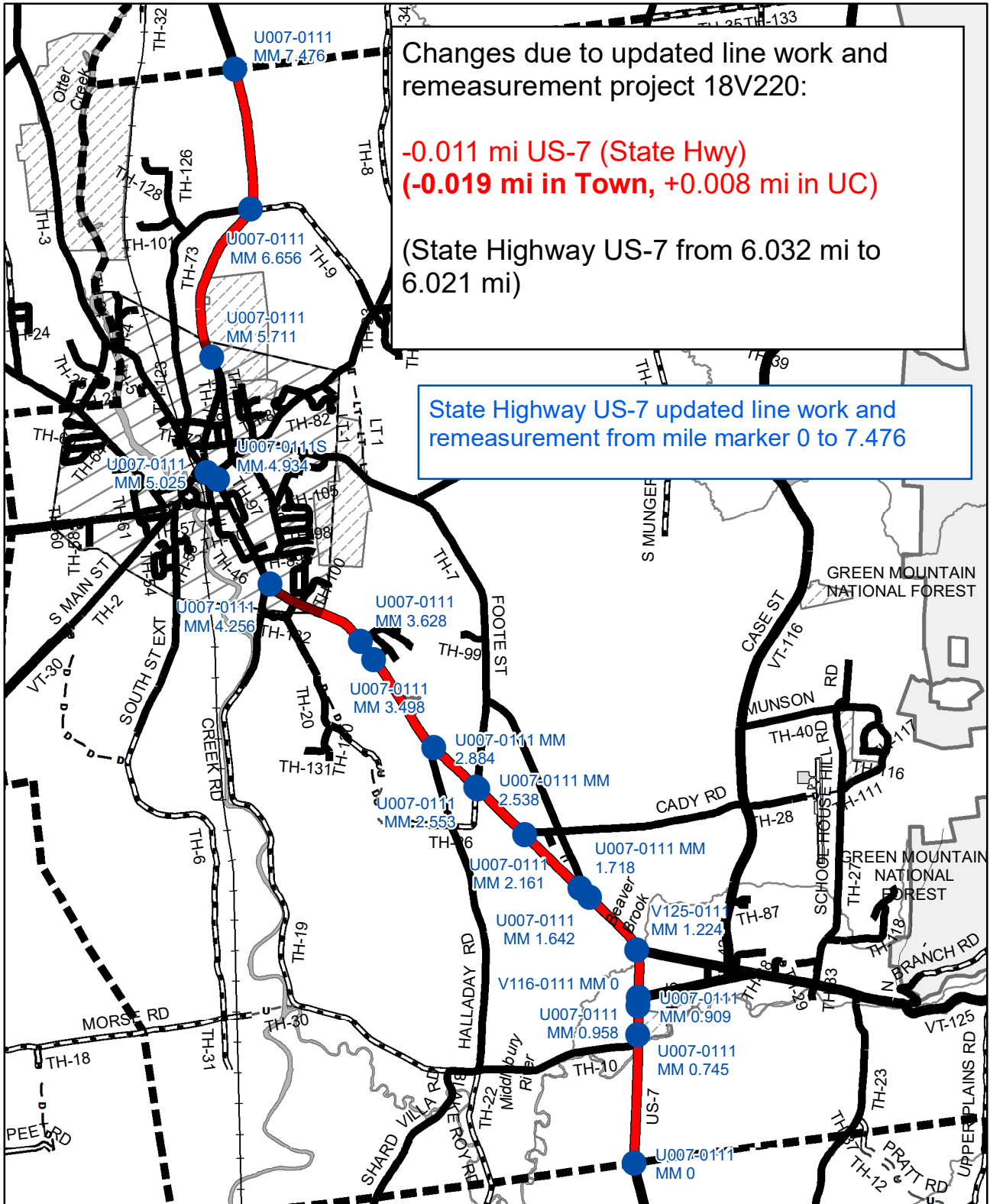

Changes due to updated line work and remeasurement project 18V220:

-0.011 mi US-7 (State Hwy)
(-0.019 mi in Town, +0.008 mi in UC)

(State Highway US-7 from 6.032 mi to 6.021 mi)

State Highway US-7 updated line work and remeasurement from mile marker 0 to 7.476

Mileage Certificate Changes
MIDDLEBURY
 (CTUA:0111-0)
 (CERTCODE:0111-0)

Mapping Section
 Division of Policy and Planning
 Vermont Agency of Transportation -- April 6, 2022

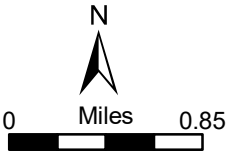

0.07 mi CL3 TH-21 (Short St) reclassified
to CL4 TH-21

(CL3 TH-21 from 0.07 mi to 0 mi,
CL4 TH-21 from 0 to 0.07 mi)

Off VT-120, TH-21 reclassified from
CL3 to CL4
MM = 0.178, north (left) side

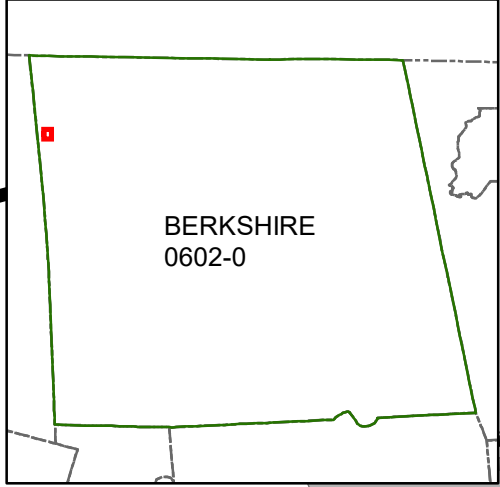
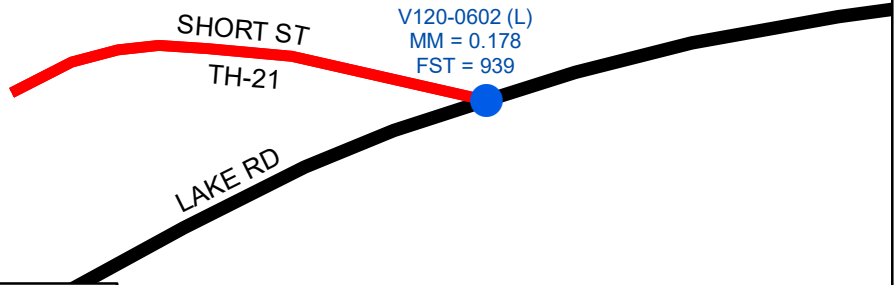

Mileage Certificate Changes
BERKSHIRE

Mapping Section
Division of Policy and Planning
Vermont Agency of Transportation -- April 4, 2022

(CTUA:0602-0)
(CERTCODE:0602-0)

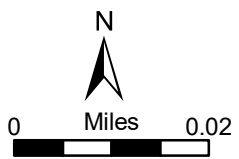

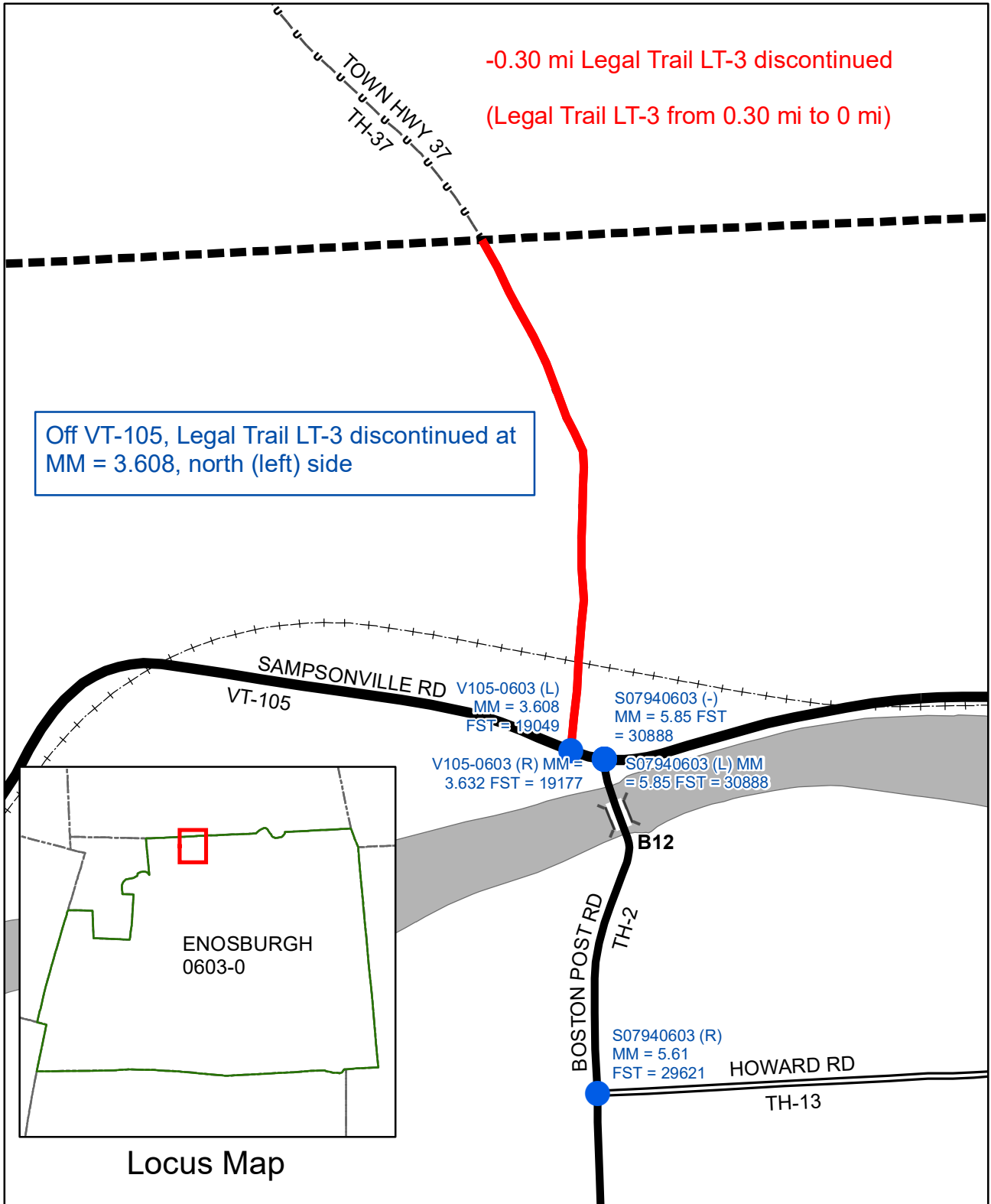

Mileage Certificate Changes ENOSBURGH

(CTUA:0603-0)
(CERTCODE:-0603-0)

Mapping Section
 Division of Policy and Planning
 Vermont Agency of Transportation -- April 4, 2022

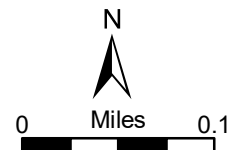

0.28 miles CL3 TH-103 (Loomis Lane) new road.

0.10 miles CL3 TH-104 (Ethel Court) new road

(CL3 TH-103 0 miles to 0.28 miles
CL3 TH-104 0 miles to 0.10 miles)

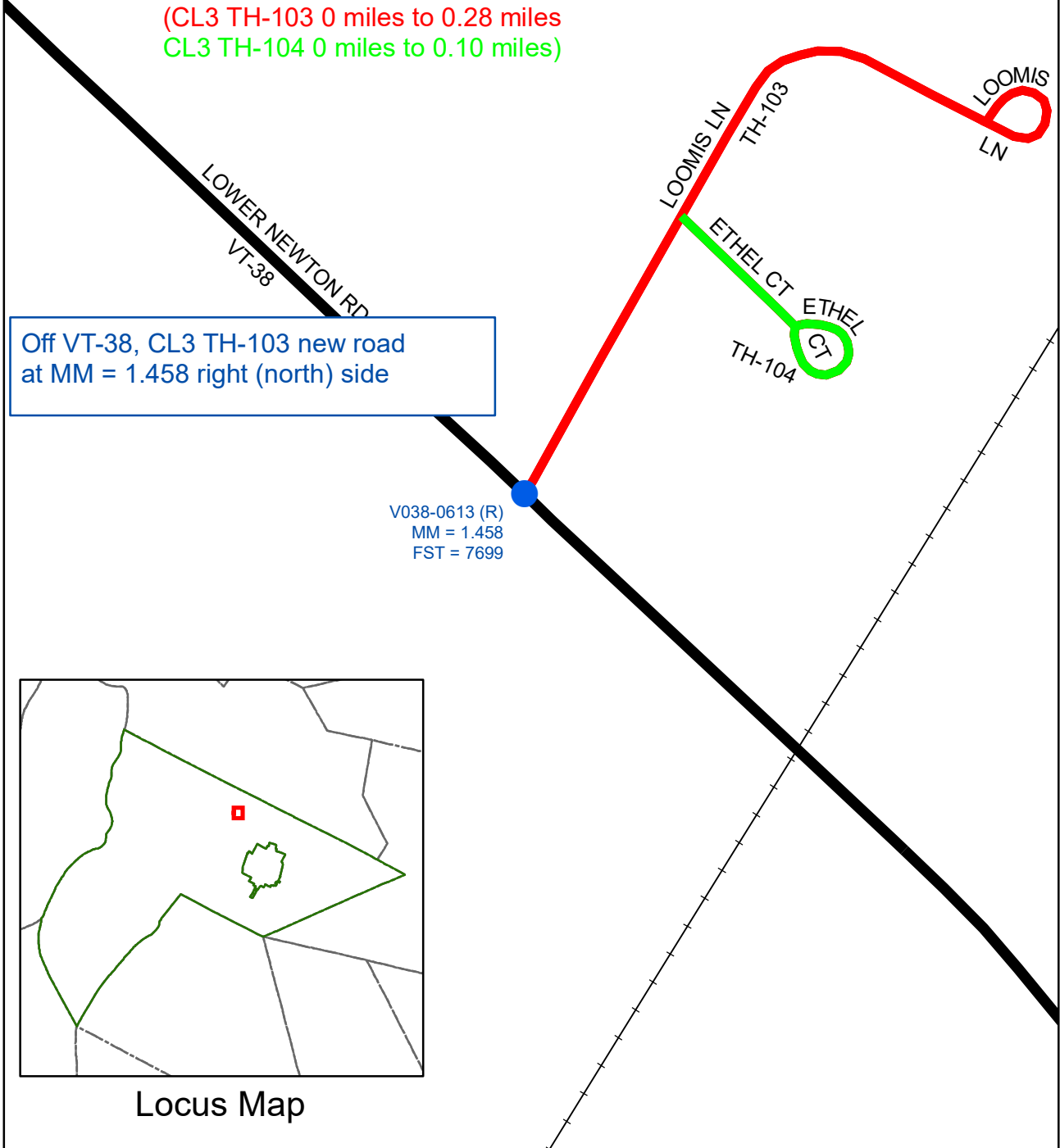

Off VT-38, CL3 TH-103 new road
at MM = 1.458 right (north) side

V038-0613 (R)
MM = 1.458
FST = 7699

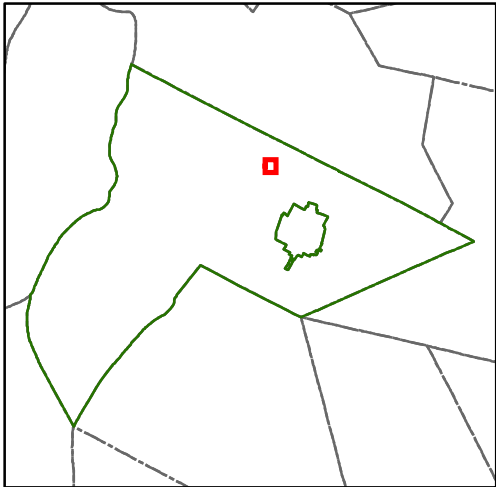

Locus Map

**Mileage Certificate Changes
SAINT ALBANS TOWN**

(CTUA:0613-0)
(CERTCODE:-0613-0)

Mapping Section
Division of Policy and Planning
Vermont Agency of Transportation -- April 6, 2022

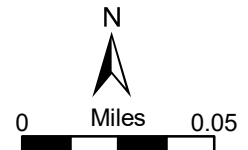

VT-105 approach (V105-0613EA001) realignment at intersection with VT-105 from mile marker 0 to 0.231

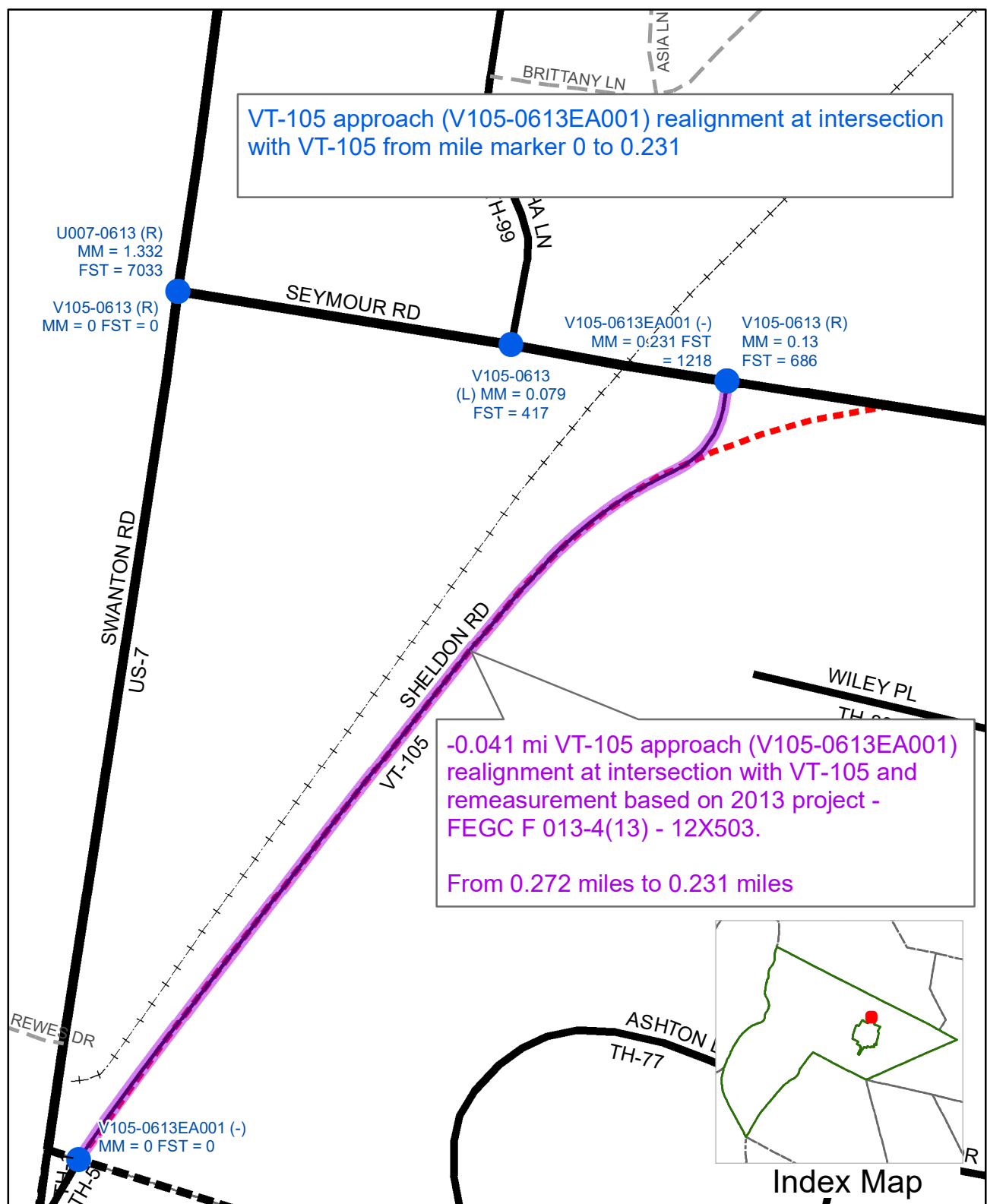

U007-0613 (R)
MM = 1.332
FST = 7033

V105-0613 (R)
MM = 0 FST = 0

V105-0613EA001 (-)
MM = 0.231 FST = 1218

V105-0613 (R)
MM = 0.13
FST = 686

V105-0613 (L)
MM = 0.079
FST = 417

-0.041 mi VT-105 approach (V105-0613EA001) realignment at intersection with VT-105 and remeasurement based on 2013 project - FEGC F 013-4(13) - 12X503.
From 0.272 miles to 0.231 miles

V105-0613EA001 (-)
MM = 0 FST = 0

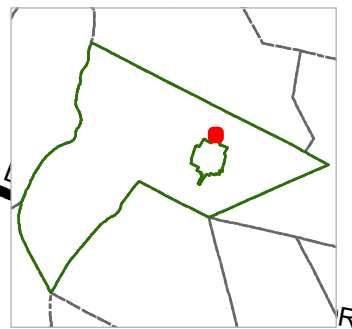

Index Map

Mileage Certificate Changes 2022
SAINT ALBANS TOWN
(CTUA: 0613-0)

Mapping Section
Division of Policy and Planning
Vermont Agency of Transportation -- April 6, 2022

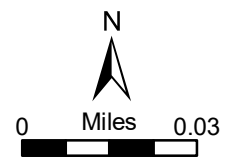

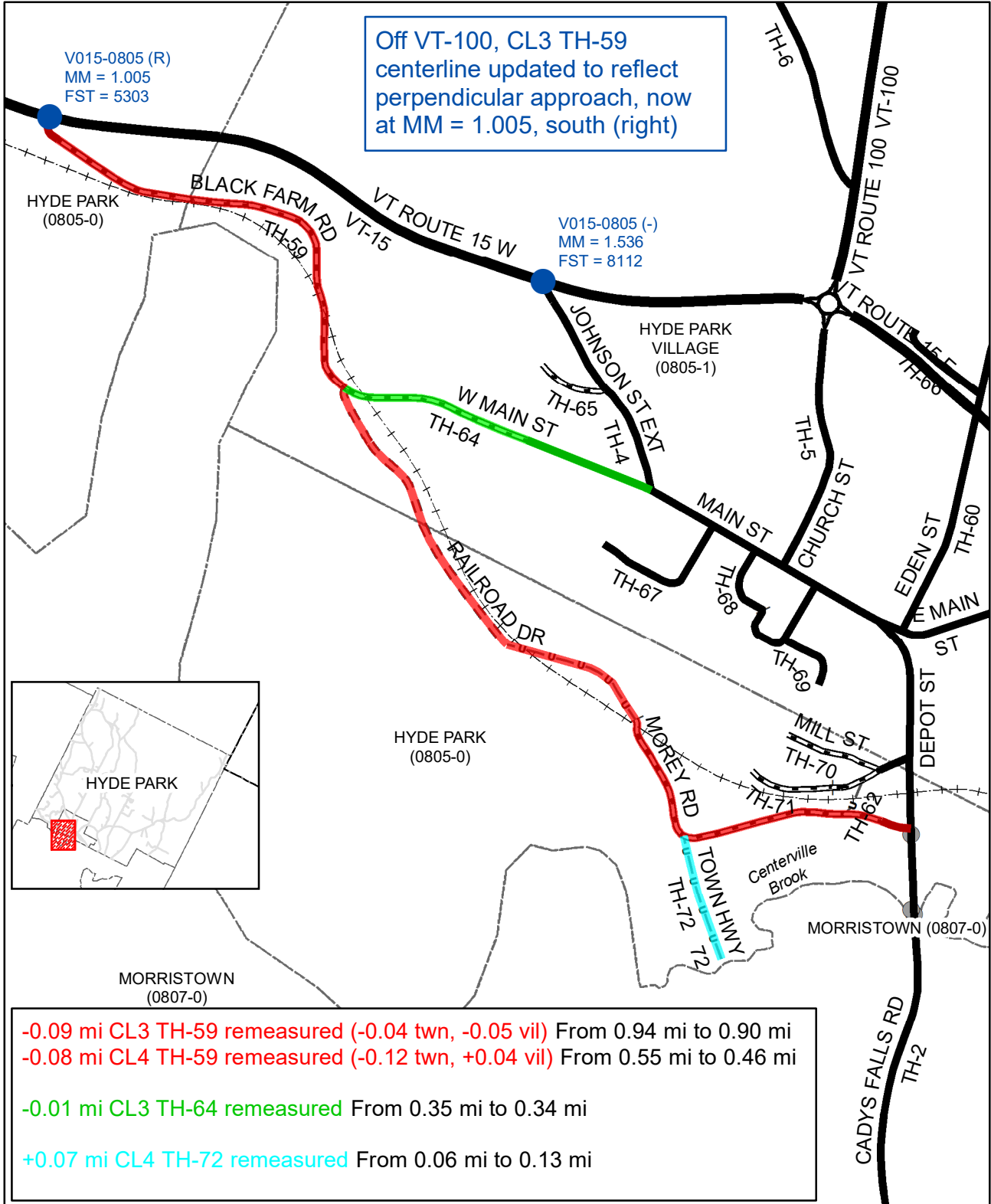

Mileage Certificate Changes 2022
HYDE PARK

(CTUA:0805-0)
 (CERTCODE:0805-0)

Mapping Section
 Division of Policy and Planning
 Vermont Agency of Transportation -- March 10, 2022

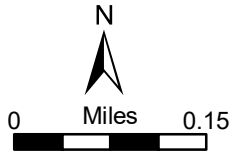

Designated 0.31 mi CL3 TH-54 (Town Hwy 54) Not Up To Standard (NUTS) pursuant to 19 V.S.A. 305(a).

(CL3 TH-54 from 0.49 mi to 0.18 mi, CL4 TH-54 from 0 mi to 0.31 mi)

Off VT-132, CL3 TH-54 Not up to Standards (NUTS) now CL4 at MM = 4.57, west (right) side

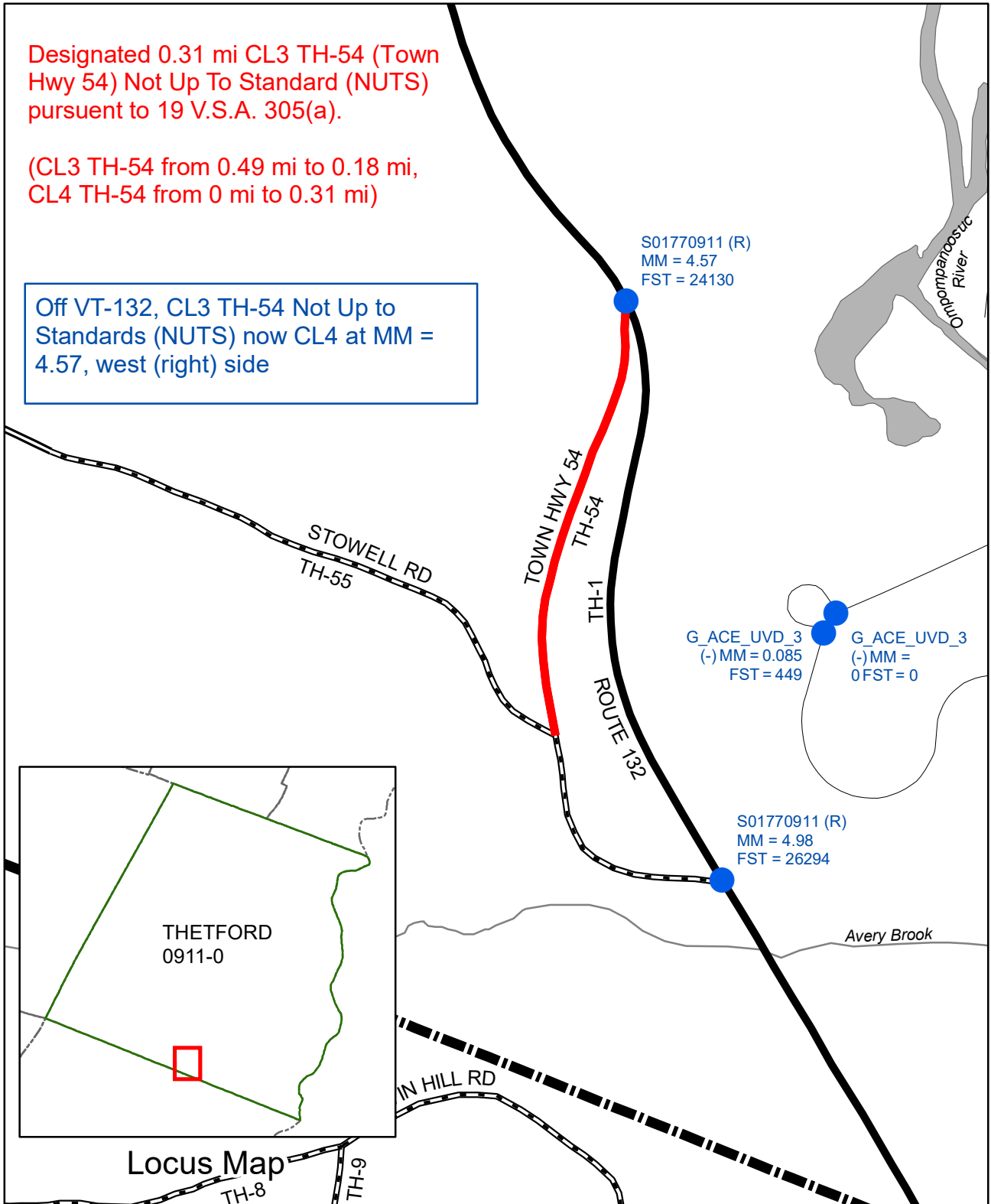

Mileage Certificate Changes THETFORD

(CTUA:0911-0)
(CERTCODE:-0911-0)

Mapping Section
Division of Policy and Planning
Vermont Agency of Transportation -- April 7, 2022

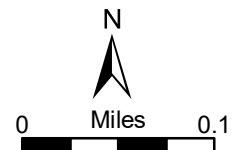

-0.08 mi CL3 TH-139 (Gardner St) discontinued. City sold property to Passumpsic Savings Bank in 2004.

Town road existed before construction of the bank and parking lot sometime between 2006 and 2008. Since then, there has not been a public road through this parcel.

(CL3 TH-139 from 0.08 mi to 0 mi)

Off I91 Access Rd and US-5, CL3 TH-139 discontinued



Locus Map

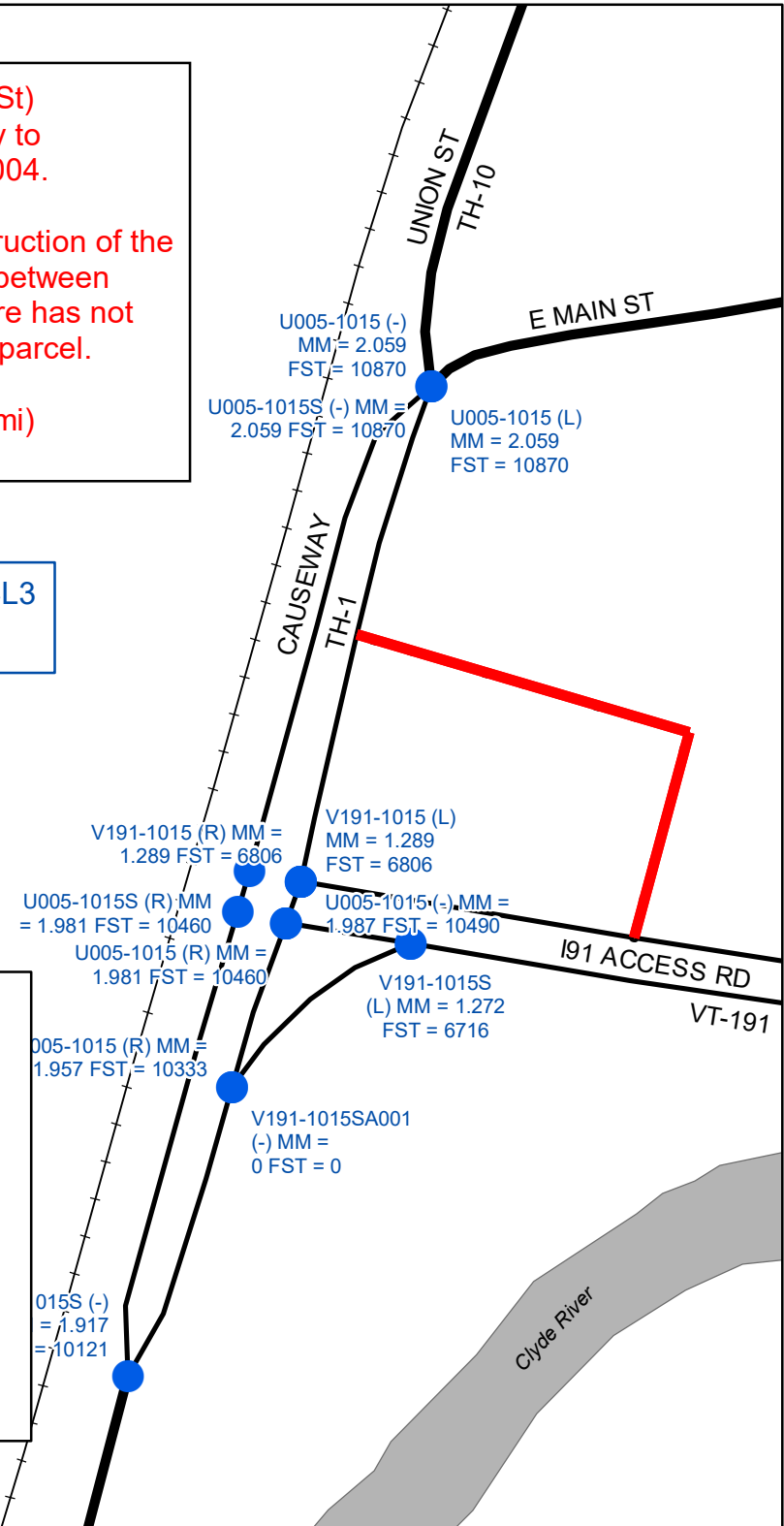

**Mileage Certificate Changes
NEWPORT CITY**

(CTUA:1015-0)
(CERTCODE:-1015-0)

Mapping Section
Division of Policy and Planning
Vermont Agency of Transportation -- April 4, 2022

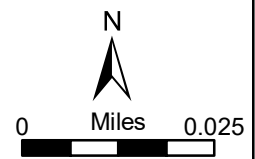

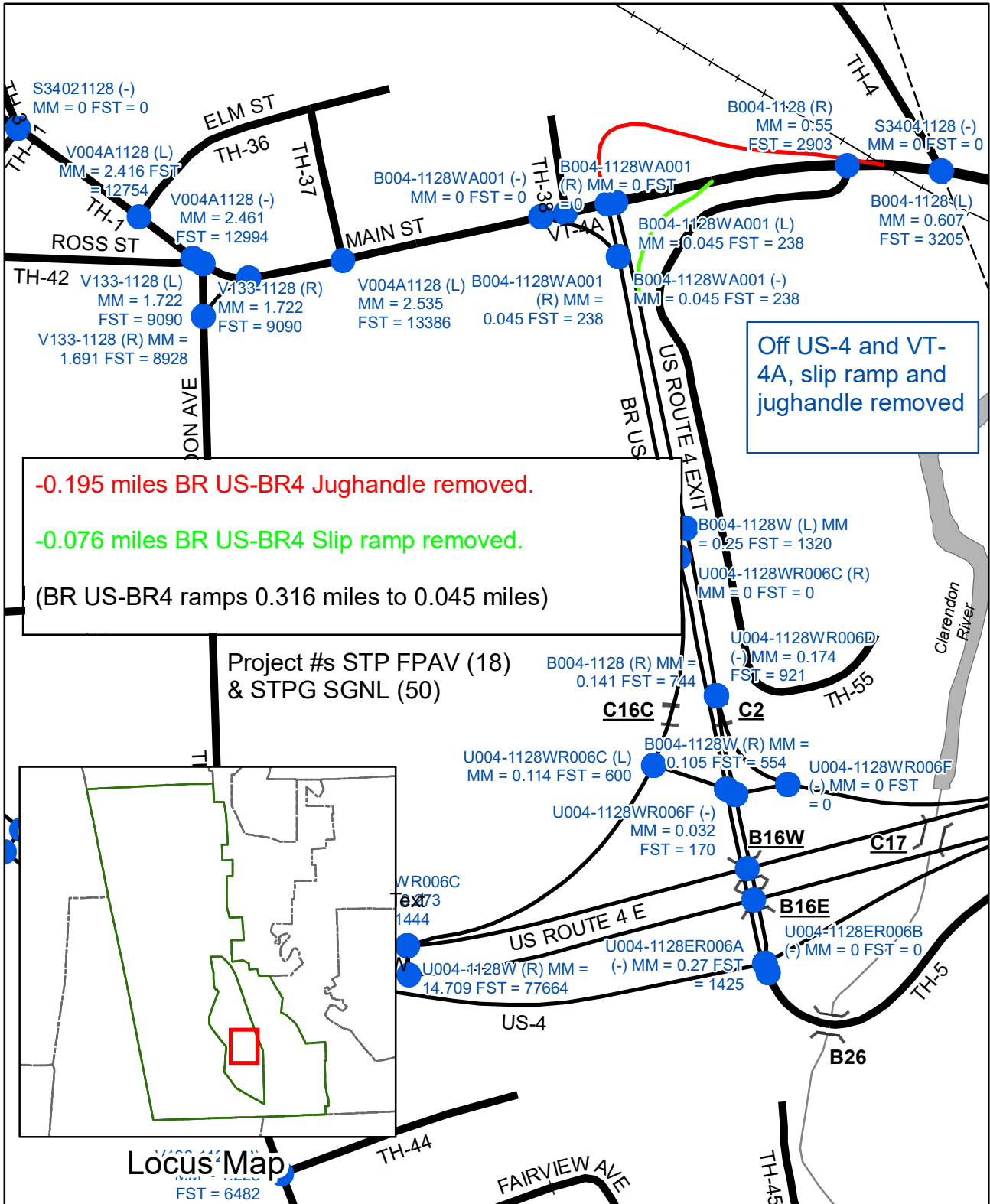

**Mileage Certificate Changes
WEST RUTLAND**

(CTUA:1128-1)
(CERTCODE:-1128-0)

Mapping Section
Division of Policy and Planning
Vermont Agency of Transportation -- April 4, 2022

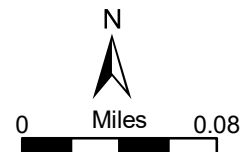

Locus Map
FST = 6482

-0.006 mi VT-12 new alignment and length change due to Bridge #38 project (BETHEL - BHF 0241(38) - 10C216)

(State Highway VT-12 from 6.127 mi to 6.121 mi)

VT-12 centerline adjusted from intersection with VT-107 at MM 1.383 to 1.453 and from MM = 2.345 to MM = 7.013 (Randolph town line)

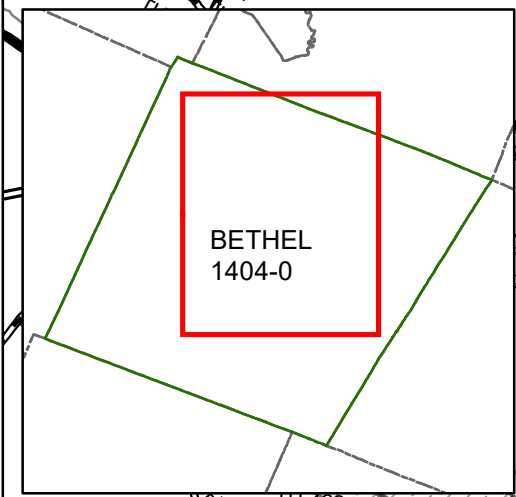

Locus Map

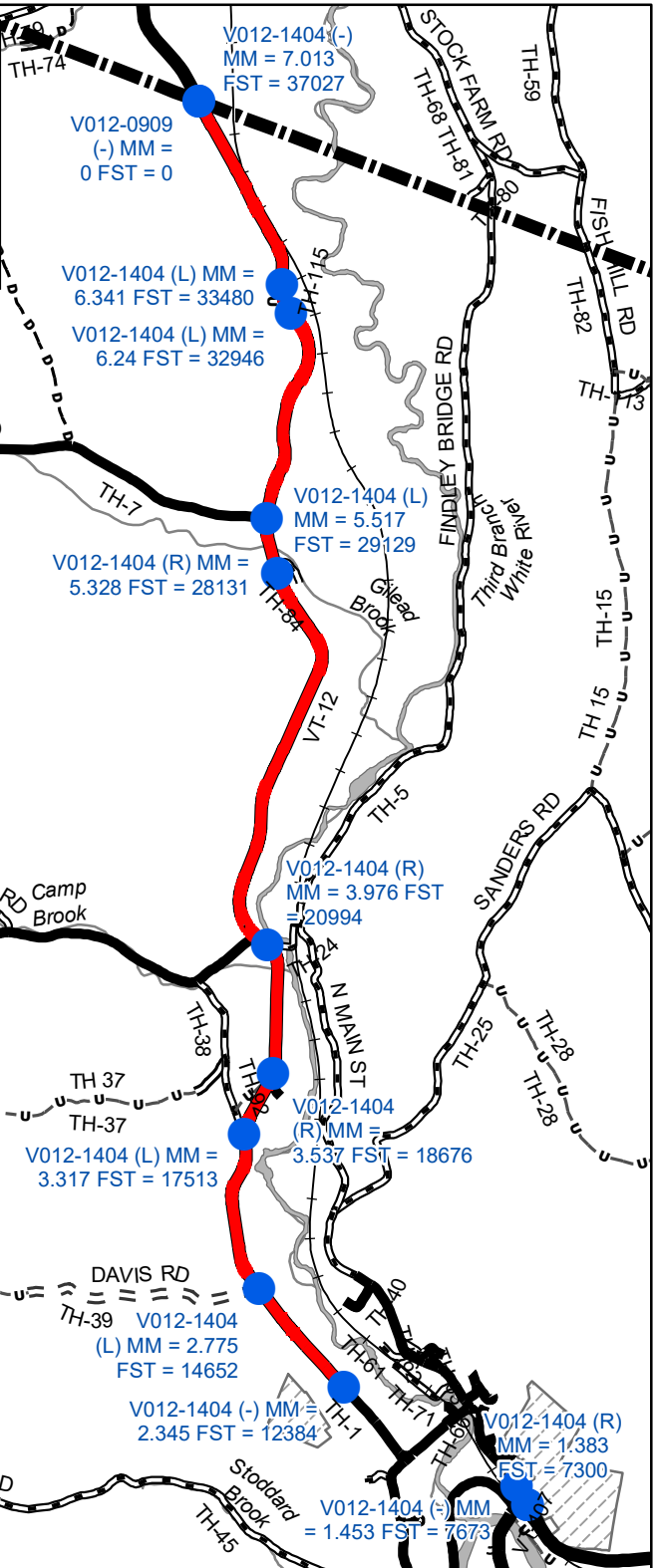

Mileage Certificate Changes
BETHEL

(CTUA:1404-0)
(CERTCODE:1404-0)

Mapping Section
Division of Policy and Planning
Vermont Agency of Transportation -- April 7, 2022

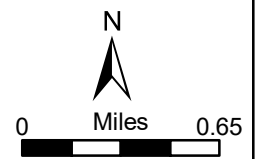

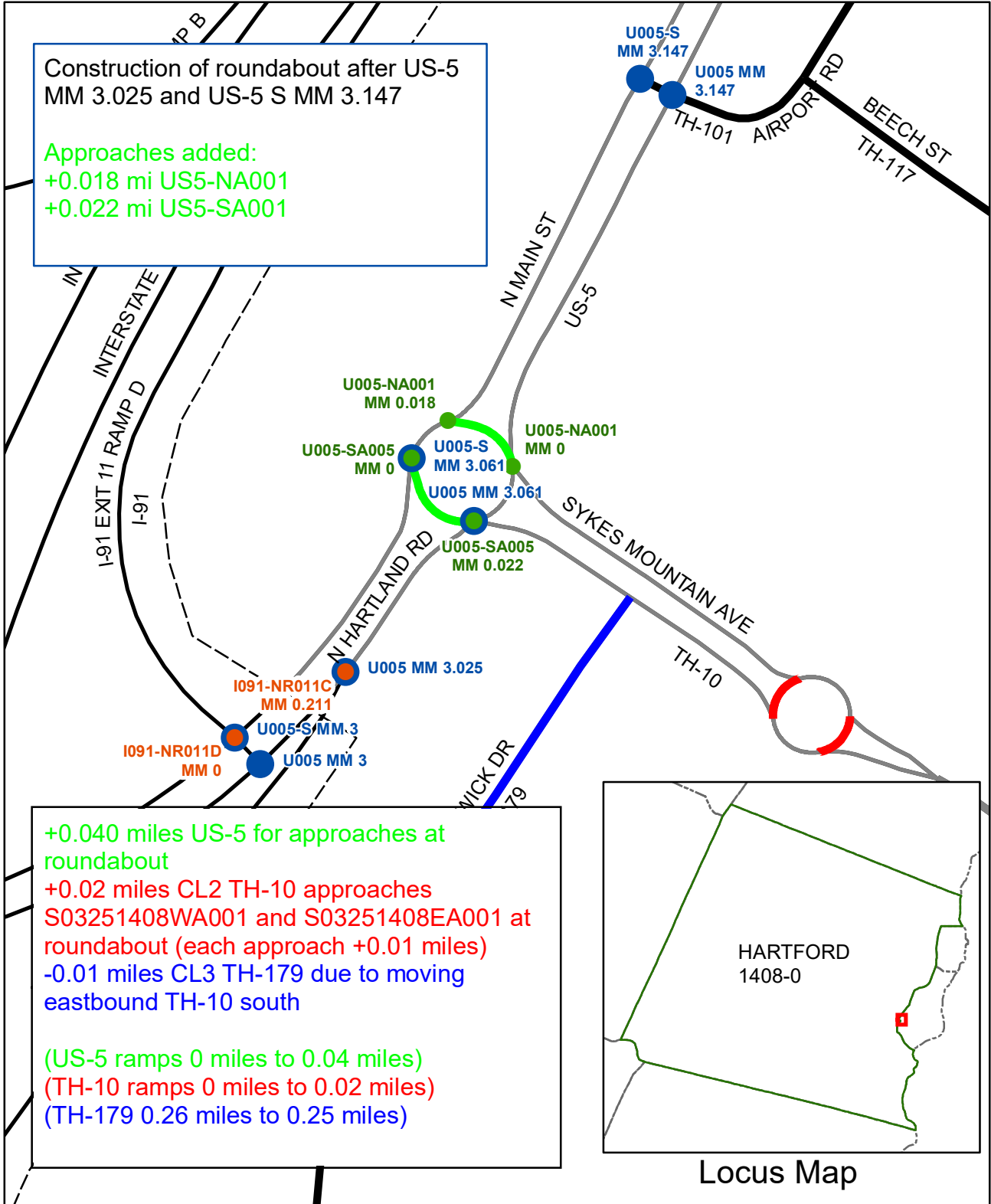

Mileage Certificate Changes

HARTFORD

(CTUA:1408-1)
 (CERTCODE:-1408-0)

Mapping Section
 Division of Policy and Planning
 Vermont Agency of Transportation -- April 19, 2022

