

Highway Changes Prompted by 2020 Mileage Certificates

Vermont Agency of Transportation

VTrans_notify_rpt

Contact: Sara Moulton, GIS Professional III, Email: sara.moulton@vermont.gov

Tuesday, December 8, 2020

Report Location:

https://vtransmaps.vermont.gov/Maps/Publications/MileageCertificates/MileageAnnualUpdates/MileageAnnualUpdates/2020_StateHwyChanges.pdf

Town Highway Map Webpage: <https://vtrans.vermont.gov/planning/maps/town-maps>

(New "ancient" roads are listed under Reclassified/Remeasured)

County	Town	New Highway Mileage	Reclassified/Remeasured	Discontinued Mileage	VTrans Notes
ADDISON	MIDDLEBURY		-0.032 mi VT-125 due to review and remeasurement of E Main St section (from 3.473 mi to 3.441 mi)		VT-125: -0.032 mi due to remeasurement (E Main St) between US-7 and town line, begin MM = 1.224, end MM = 4.285
BENNINGTON	DORSET	+0.05 mi CL4 TH-52 (Read Farm Ln) (from 0.00 to 0.05)			Off VT-7A: CL4 TH-52 (Read Farm Ln) at MM = 0.644, west side
CHITTENDEN	COLCHESTER	+0.35 mi CL3 TH-218 (Lomatire Dr) new road +0.21 mi CL3 TH-219 (Wildlife Loop) new road +0.11 mi CL3 TH-220 (Churchill Ln) new road	- 0.013 miles of VT-2A due to project STP 5600(9)S [PIN 97d206] (intersection realignment and remeasurement)	-0.10 mi CL4 TH-32 discontinued	Project STP 5600(9)S: Realignment of US-7 and VT-2A intersection : Off US-7, intersection with VT-2A now at MM = 3.607, right (east) side. VT-2A now measures 2.418 mi (includes remeasurement)
CHITTENDEN	WESTFORD		+0.005 mi VT-15 at Westford/Cambridge town line, reference Underhill-Cambridge STP PS19 (11) PIN 16V159 (from 2.822 mi to 2.827 mi)		+0.005 mi VT-15 at Westford/Cambridge town line, reference Underhill-Cambridge STP PS19 (11) PIN 16V159 (from 2.822 mi to 2.827 mi)

(New "ancient" roads are listed under Reclassified/Remeasured)

<i>County</i>	<i>Town</i>	<i>New Highway Mileage</i>	<i>Reclassified/Remeasured</i>	<i>Discontinued Mileage</i>	<i>VTrans Notes</i>
FRANKLIN	HIGHGATE	+0.01 mi CL3 TH-55 (Platt Rd) approach added	-0.02 mi CL2 TH-3 (Franklin Rd) intersection with VT-76 realigned and remeasured, 2014 Project STP RS 0301(1) SA -0.03 mi CL3 TH-16 (Old Dock Rd) reconfiguration of intersection with TH-17 and US-7 and remeasured 0.23 mi CL3 TH-38 (WAUGH Farm Rd) designated Not Up To Standard (NUTS) pursuant to 19 V.S.A. 305(a) 0.02 mi CL3 TH-58 (Beyor Rd) designated Not Up To Standard (NUTS) pursuant to 19 V.S.A. 305(a) -0.02 mi CL3 TH-58 (Beyor Rd) remeasured (0.05 mi maintained) -0.01 mi CL3 TH-60 (Lackey Rd) remeasured		Off VT-78, intersection with CL2 TH-3 (Franklin Rd) realigned in 2014: Project STP RS 0301(1) SA Was at MM = 4.648, now MM = 4.693, left (north) side Off US-7, realignment of CL3 intersection (historic project): TH-16 (Old Dock Rd) no longer intersects US-7, instead TH-17 (Shipyard Rd) now intersects at MM = 2.949 on left (west) side.
LAMOILLE	MORRISTOWN	+0.35 mi Provisional CL3 TH-122 (Belanger Ln) new road (deeds needed) +0.05 mi CL3 TH-550 (Westside Ct) new road +0.09 mi CL3 TH-551 (Old Creamery Rd) new road	0.231 mi VT-100 (Laporte Rd) relinquished to Town as CL1 TH-1, Project STP F029-1(2)	-0.10 mi CL3 TH-34 (Miller Bridge Rd) discontinued -0.02 mi CL3 TH-540 (VFW St) partially discontinued -0.02 mi CL3 TH-542 (Wabun Ave) due to Alt-100 construction	Off ALT VT-100, CL3 TH-551 (Old Creamery Rd) officially accepted as CL3, at MM = 0.815 on left (west) side VT-100 (Laporte Rd) now CL1 (relinquished to Town) from MM = 4.641 to MM = 4.835.
LAMOILLE	WOLCOTT	+0.30 mi CL3 TH-50 (Pinnacle Ln) new road	0.38 mi CL4 TH-10 (Reed Rd) reclassified as CL3		Off VT-15, CL3 TH-50 (Pinnacle Ln) now public, at MM = 5.737 on north (left) side.
ORLEANS	BARTON		-0.017 mi VT-16, now in Village due to charter changing Village/Town boundary		VT-16: Village boundary changed by Statute
ORLEANS	BARTON VILLAGE		+0.017 mi VT-16 now in Village (was in Barton Town) due to charter changing Village/Town boundary.		VT-16: Village boundary changed by Statute and intersection with TH-4 realigned. Village boundary now at MM = 1.722 and intersection with TH-4 at MM = 1.727 (west side). VT-16 becomes TH-2 at MM = 1.739 (no change).

(New "ancient" roads are listed under Reclassified/Remeasured)

<i>County</i>	<i>Town</i>	<i>New Highway Mileage</i>	<i>Reclassified/Remeasured</i>	<i>Discontinued Mileage</i>	<i>VTrans Notes</i>
ORLEANS	CHARLESTON		0.63 mi CL4 TH-19 (Batchelder Rd) reclassified to Legal Trail LT-5 (CL4 TH-19 from 1.07 mi to 0.44 mi, LT-5 from 0.23 mi to 0.86 mi)		Off VT-5A: TH-19 reclassified from CL4 to LT-5 (Batchelder Rd) at MM = 1.253, west side
ORLEANS	COVENTRY			-0.05 mi CL3 TH-12 (Thayer Rd) Discontinued (from 0.05 mi to 0.00 mi)	Off US-5: CL3 TH-39 Discontinued (Whelock Rd) at MM = 1.025, east side
				-0.10 mi CL3 TH-25 (Blake Rd) Discontinued (from 0.10 mi to 0.00 mi)	Off VT-14: CL3 TH-12 Discontinued (Thayer Rd) at MM = 3.237, west side
				-0.07 mi CL3 TH-39 (Whelock Rd) Discontinued (from 0.07 mi to 0.00 mi)	Off VT-14: CL3 TH-25 Discontinued (Blake Rd) at MM = 2.099, west side
				-0.10 mi CL3 TH-41 (Pelkey Rd) Discontinued (from 0.10 mi to 0.00 mi)	
				-0.12 mi CL3 TH-60 (Pleasant View Rd) Discontinued (from 0.12 mi to 0.00 mi)	
RUTLAND	BRANDON		Changes due to project NH099-3(496) Segment 6 -0.020 mi US-7 +0.005 mi VT-73 +0.006 mi CL1 TH-1 -0.023 mi CL1 TH-2 (Park St) -0.015 mi CL1 TH-3 (Champlain St) -0.04 mi CL2 TH-5 (Union St) -0.04 mi CL2 TH-5 (Carver St) -0.03 mi CL2 TH-4 +0.02 mi CL2 TH-4 reclassified as CL3 TH-92 +0.01 CL3 TH-42 (Carver St) -0.04 mi CL3 TH-79 +0.11 mi CL3 TH-93 (was CL1 TH-2/US-7)		US-7 and VT-73 (see summary maps for details)
WINDSOR	SPRINGFIELD		+0.02 mi CL2 TH-9 (Reservoir Rd) due to swap of mainline and approach at intersection with VT-106 (from 1.25 mi to 1.27 mi)		Off VT-106: TH-9 (Reservoir Rd) mainline at MM = 1.925, east side TH-9 (Reservoir Rd Frk) approach at MM = 1.898, east side

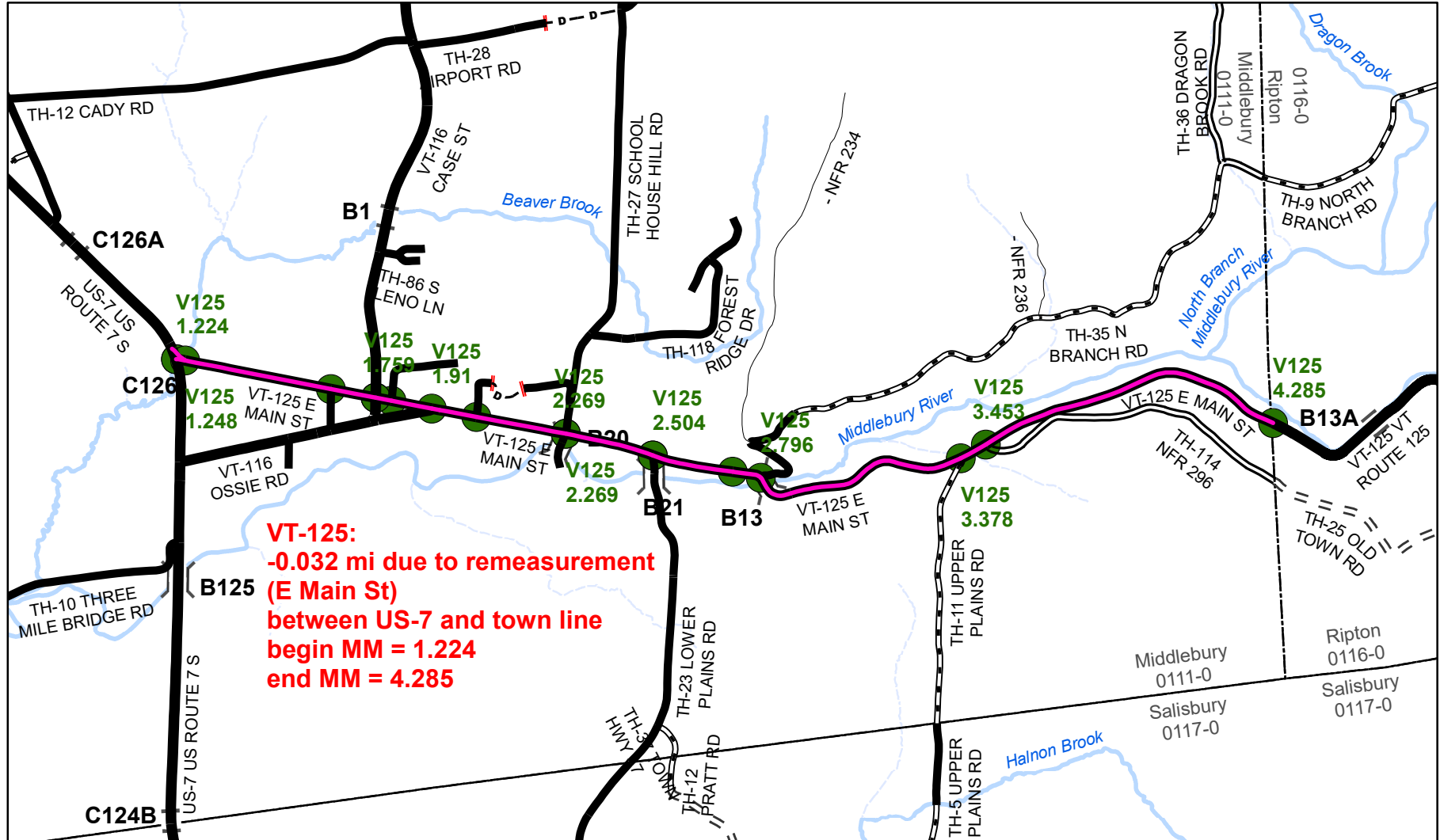

Mileage Certificate Change 2020
MIDDLEBURY
 (CERTCODE: 0111-0)

Mapping Section
 Division of Policy, Planning and Intermodal Development
 Vermont Agency of Transportation -- February 28, 2020

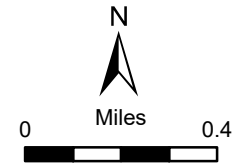

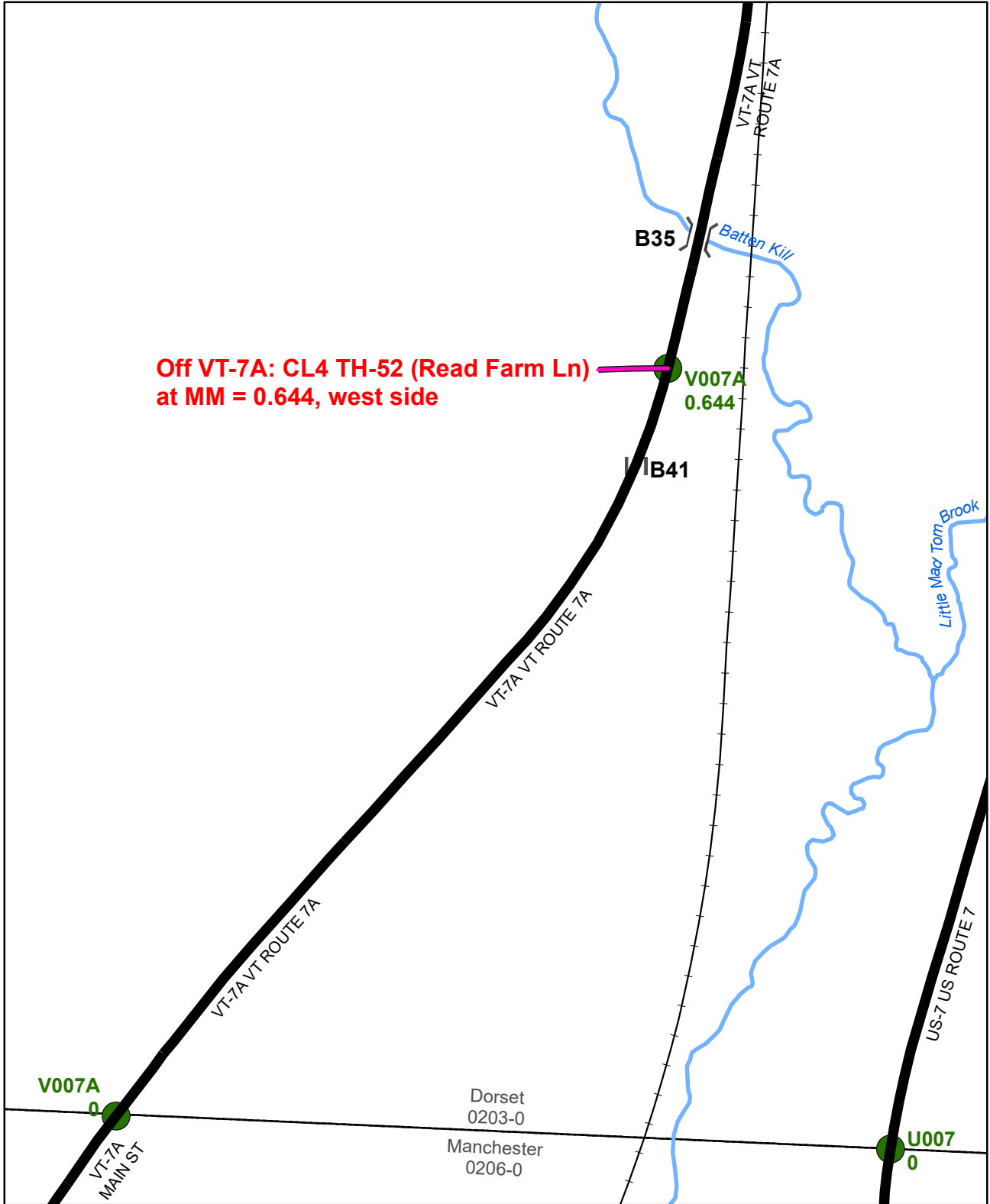

Mileage Certificate Change 2020
DORSET

(CERTCODE: 0203-0)

Mapping Section
 Division of Policy, Planning and Intermodal Development
 Vermont Agency of Transportation -- February 24, 2020

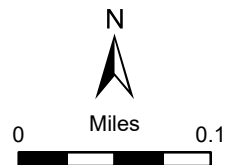

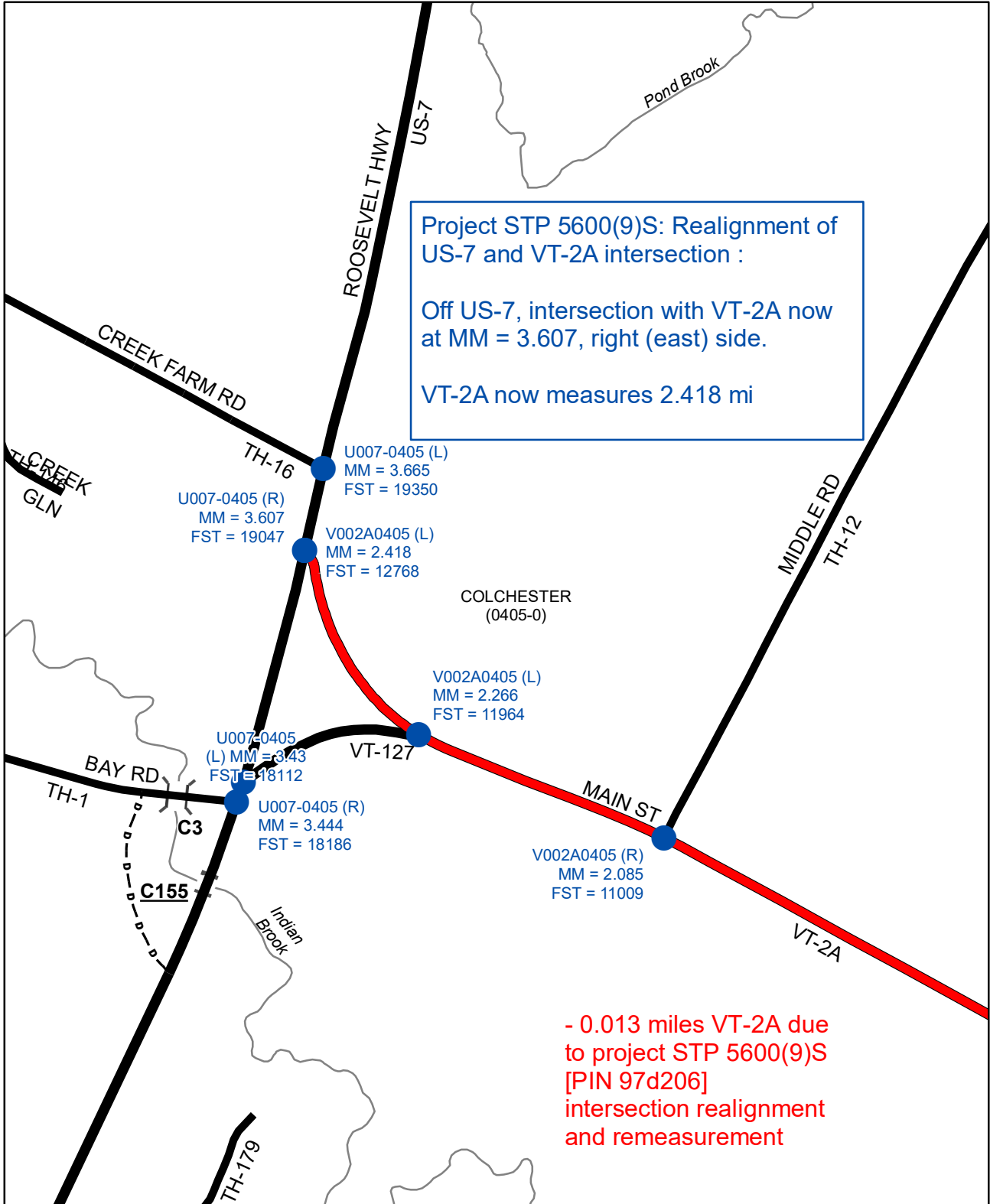

**Mileage Certificate Changes
COLCHESTER**
(CTUA: 0405-0)

Mapping Section
Division of Policy and Planning
Vermont Agency of Transportation -- December 7, 2020

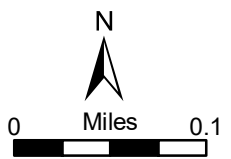

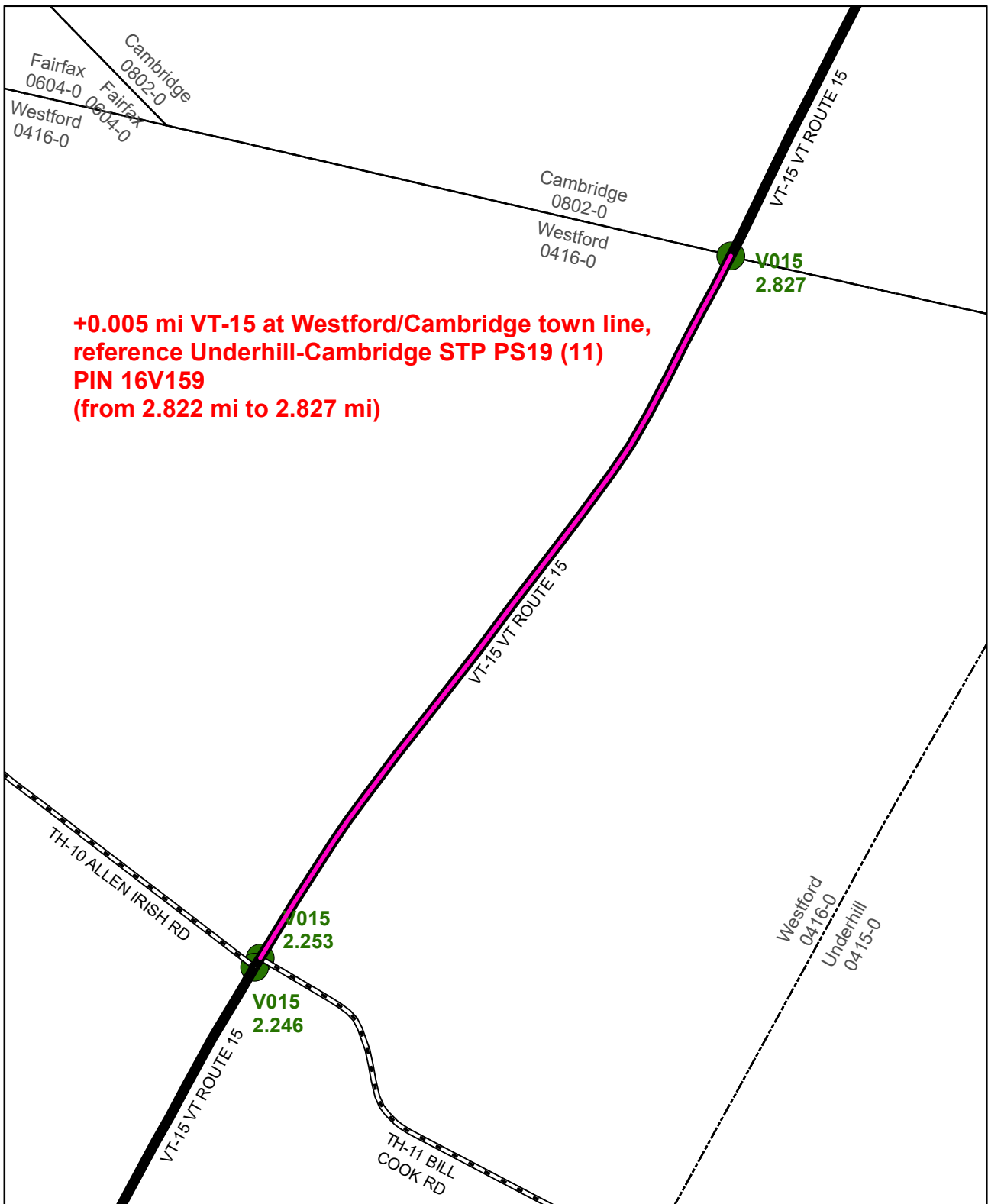

Mileage Certificate Change 2020

WESTFORD

(CERTCODE: 0416-0)

Mapping Section
 Division of Policy, Planning and Intermodal Development
 Vermont Agency of Transportation -- February 26, 2020

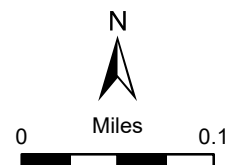

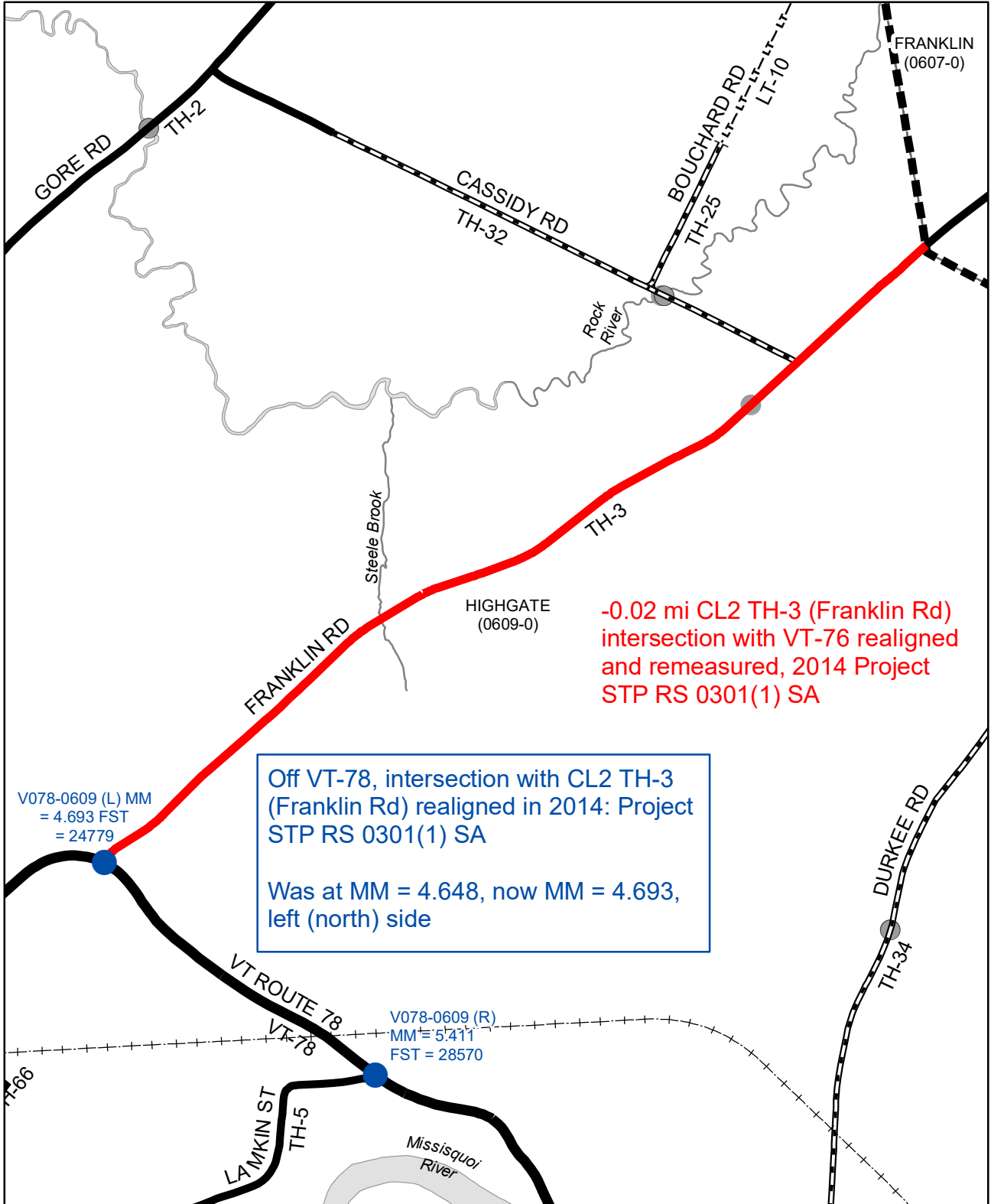

-0.02 mi CL2 TH-3 (Franklin Rd) intersection with VT-76 realigned and remeasured, 2014 Project STP RS 0301(1) SA

Off VT-78, intersection with CL2 TH-3 (Franklin Rd) realigned in 2014: Project STP RS 0301(1) SA

Was at MM = 4.648, now MM = 4.693, left (north) side

Mileage Certificate Changes 2020
HIGHGATE
 (CTUA: 0609-0)

Mapping Section
 Division of Policy and Planning
 Vermont Agency of Transportation -- December 7, 2020

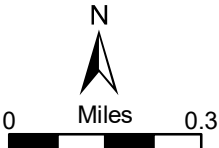

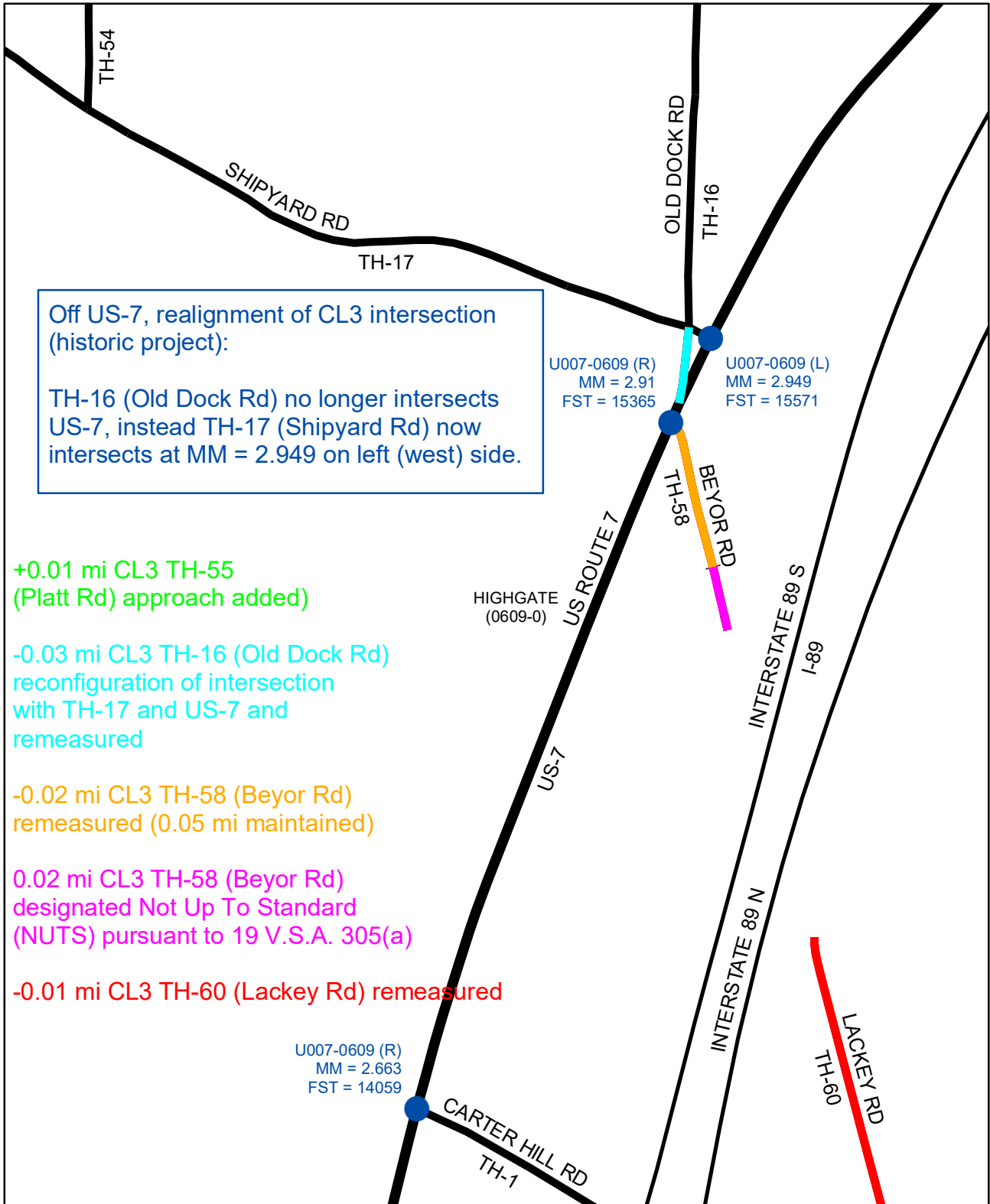

+0.01 mi CL3 TH-55 (Platt Rd) approach added

-0.03 mi CL3 TH-16 (Old Dock Rd) reconfiguration of intersection with TH-17 and US-7 and remeasured

-0.02 mi CL3 TH-58 (Beyor Rd) remeasured (0.05 mi maintained)

0.02 mi CL3 TH-58 (Beyor Rd) designated Not Up To Standard (NUTS) pursuant to 19 V.S.A. 305(a)

-0.01 mi CL3 TH-60 (Lackey Rd) remeasured

Mileage Certificate Changes 2020

HIGHGATE

(CTUA: 0609-0)

Mapping Section
Division of Policy and Planning
Vermont Agency of Transportation -- December 7, 2020

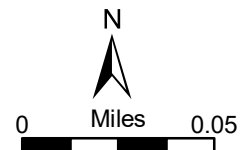

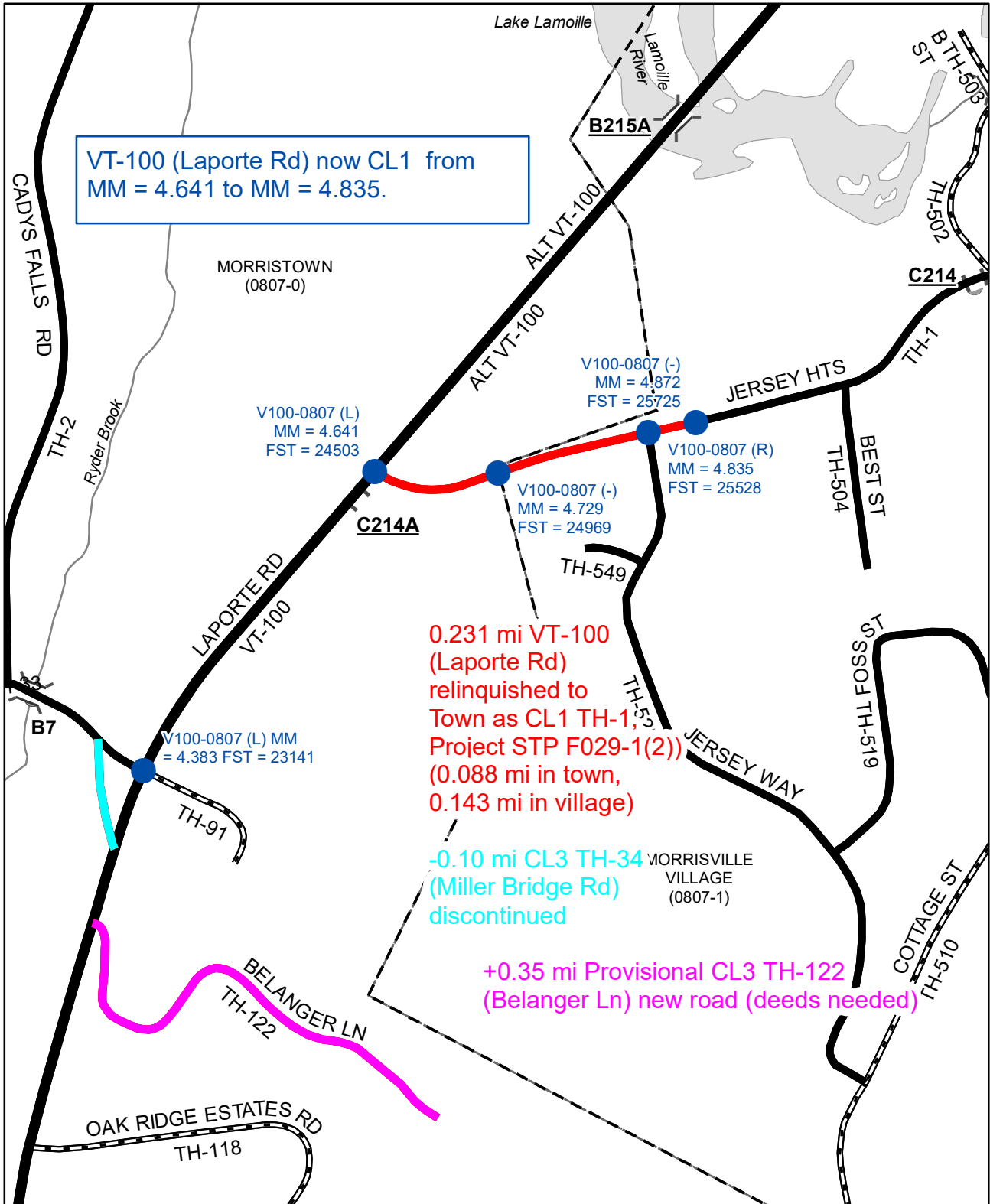

VT-100 (Laporte Rd) now CL1 from MM = 4.641 to MM = 4.835.

0.231 mi VT-100 (Laporte Rd) relinquished to Town as CL1 TH-1, Project STP F029-1(2) (0.088 mi in town, 0.143 mi in village)

-0.10 mi CL3 TH-34 (Miller Bridge Rd) discontinued

+0.35 mi Provisional CL3 TH-122 (Belanger Ln) new road (deeds needed)

Mileage Certificate Changes 2020
MORRISTOWN
 (CTUA: 0807-0)

Mapping Section
 Division of Policy and Planning
 Vermont Agency of Transportation -- December 4, 2020

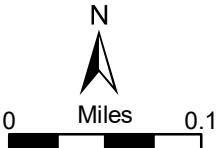

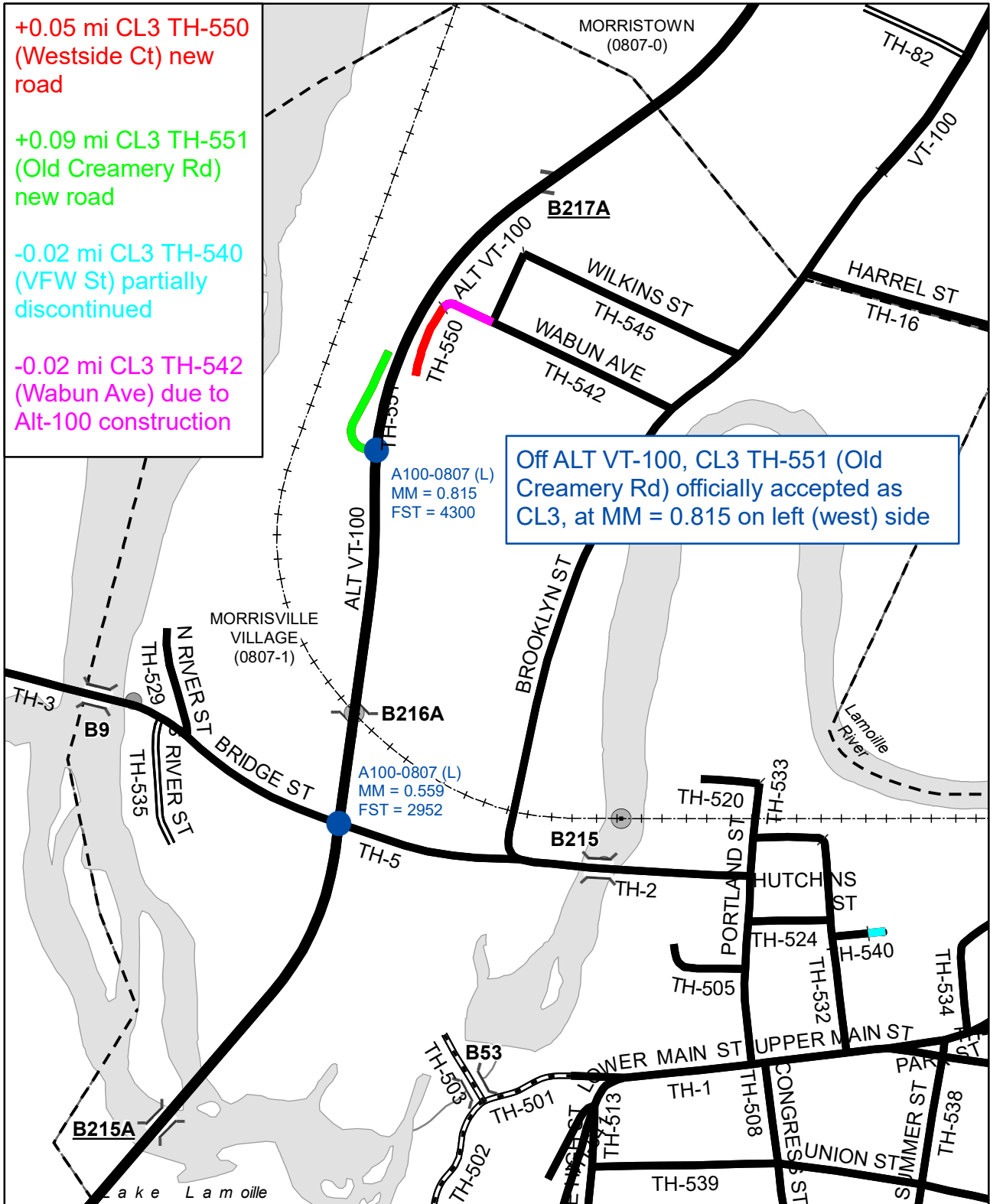

- +0.05 mi CL3 TH-550 (Westside Ct) new road
- +0.09 mi CL3 TH-551 (Old Creamery Rd) new road
- 0.02 mi CL3 TH-540 (VFW St) partially discontinued
- 0.02 mi CL3 TH-542 (Wabun Ave) due to Alt-100 construction

Off ALT VT-100, CL3 TH-551 (Old Creamery Rd) officially accepted as CL3, at MM = 0.815 on left (west) side

**Mileage Certificate Changes 2020
MORRISVILLE VI**

Mapping Section
 Division of Policy and Planning
 Vermont Agency of Transportation -- December 4, 2020

(CERTCODE: 0807-0)
 (CTUA: 0807-1)

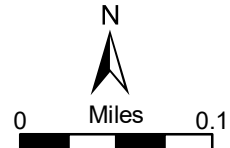

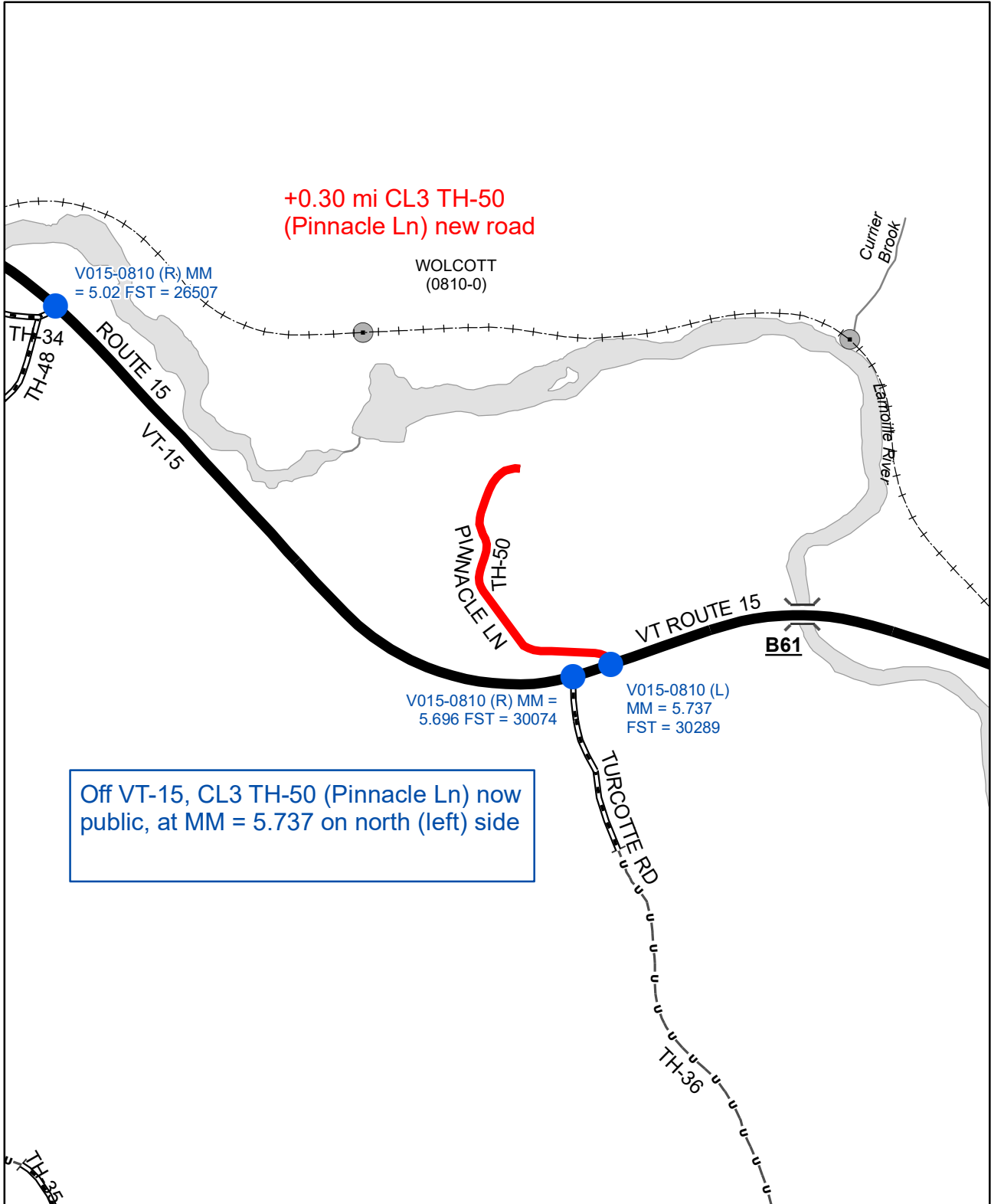

Mileage Certificate Changes 2020

WOLCOTT

(CTUA: 0810-0)

Mapping Section
 Division of Policy and Planning
 Vermont Agency of Transportation -- December 4, 2020

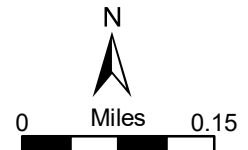

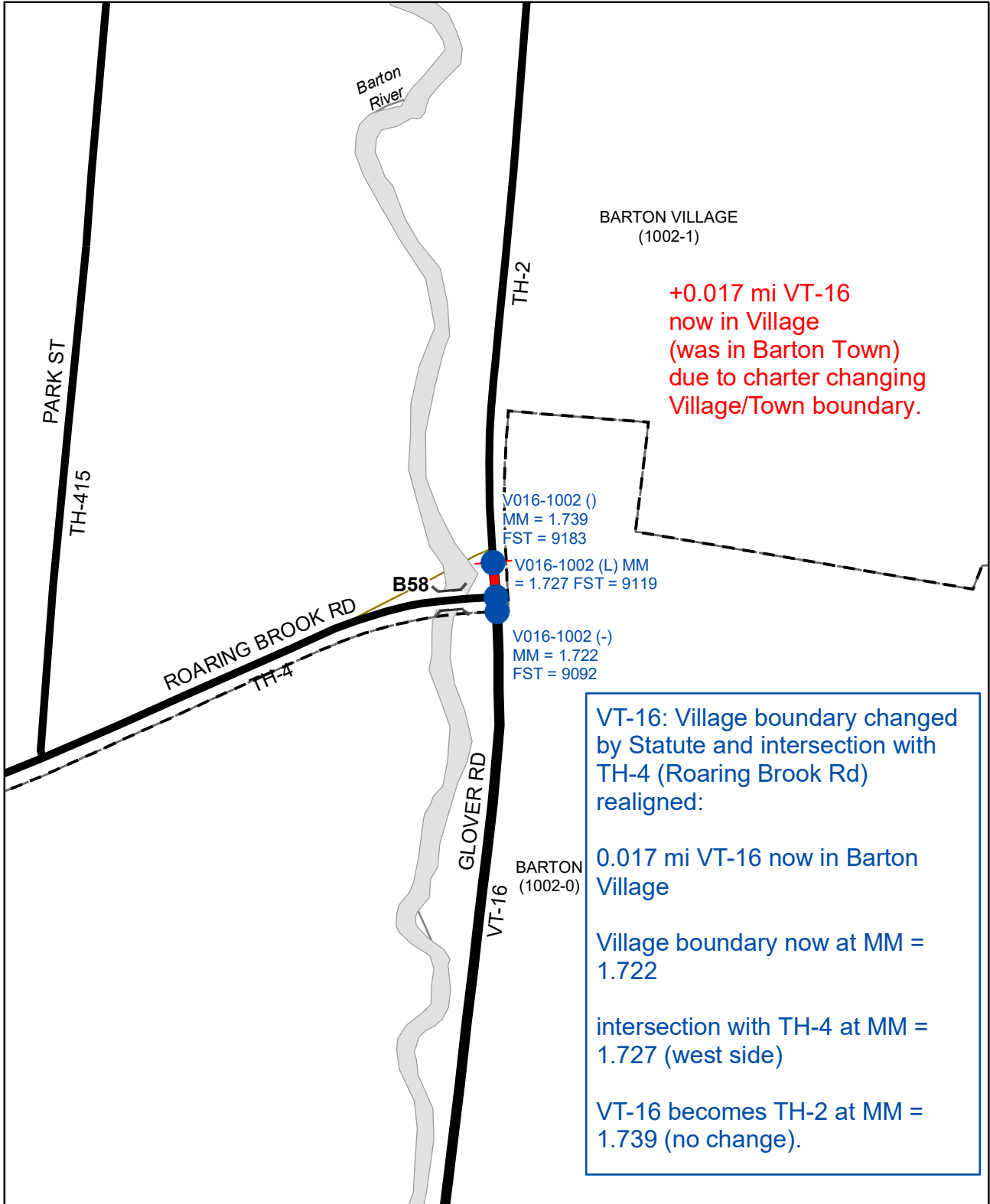

Mileage Certificate Changes 2020
BARTON VILLAGE
 (CTUA: 1002-1)

Mapping Section
 Division of Policy and Planning
 Vermont Agency of Transportation -- December 4, 2020

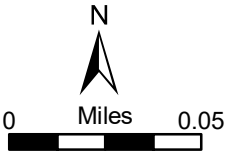

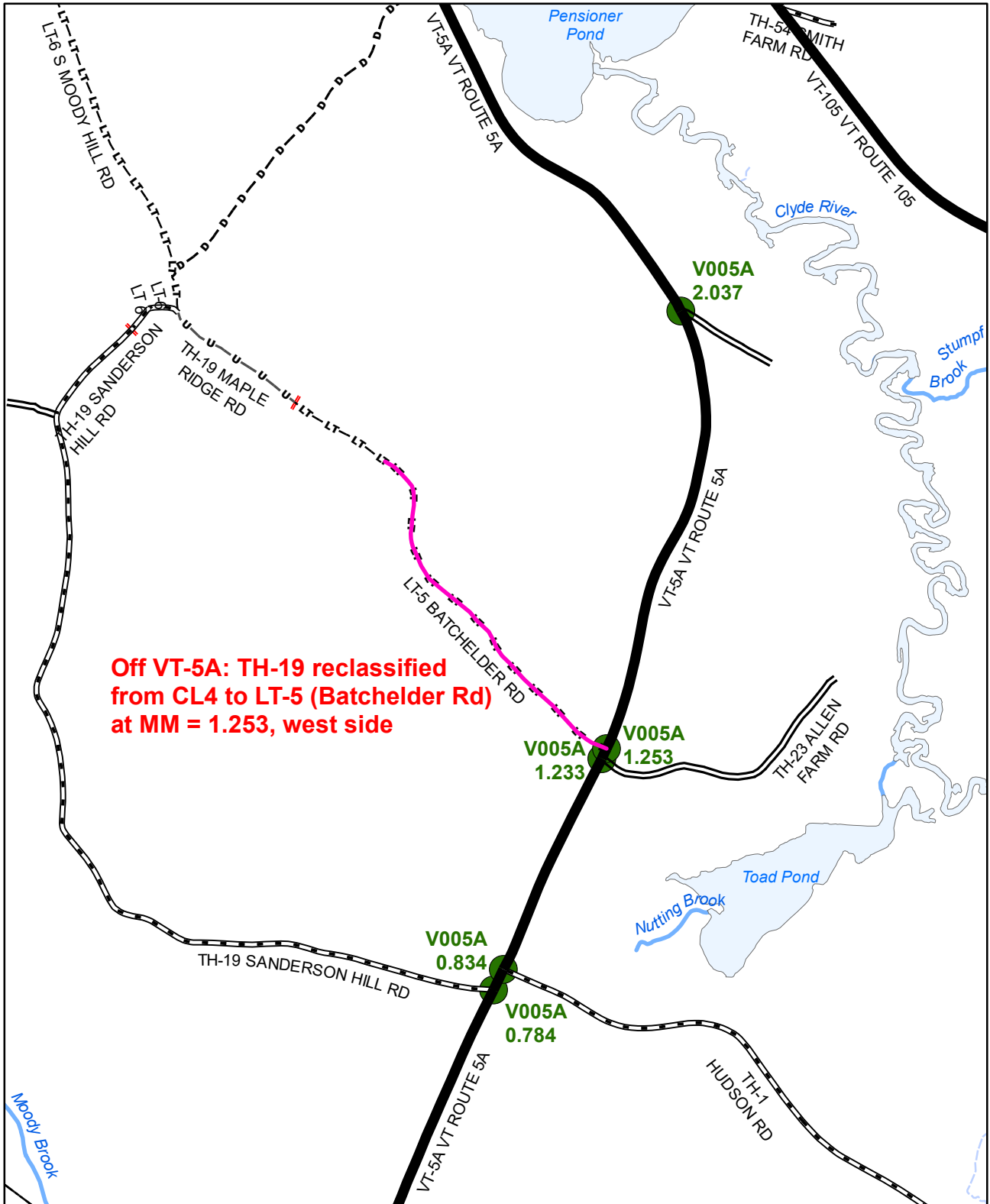

Off VT-5A: TH-19 reclassified from CL4 to LT-5 (Batchelder Rd) at MM = 1.253, west side

Mileage Certificate Change 2020

CHARLESTON

(CERTCODE: 1004-0)

Mapping Section
 Division of Policy, Planning and Intermodal Development
 Vermont Agency of Transportation -- February 24, 2020

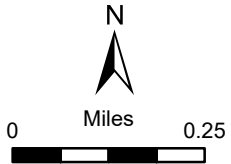

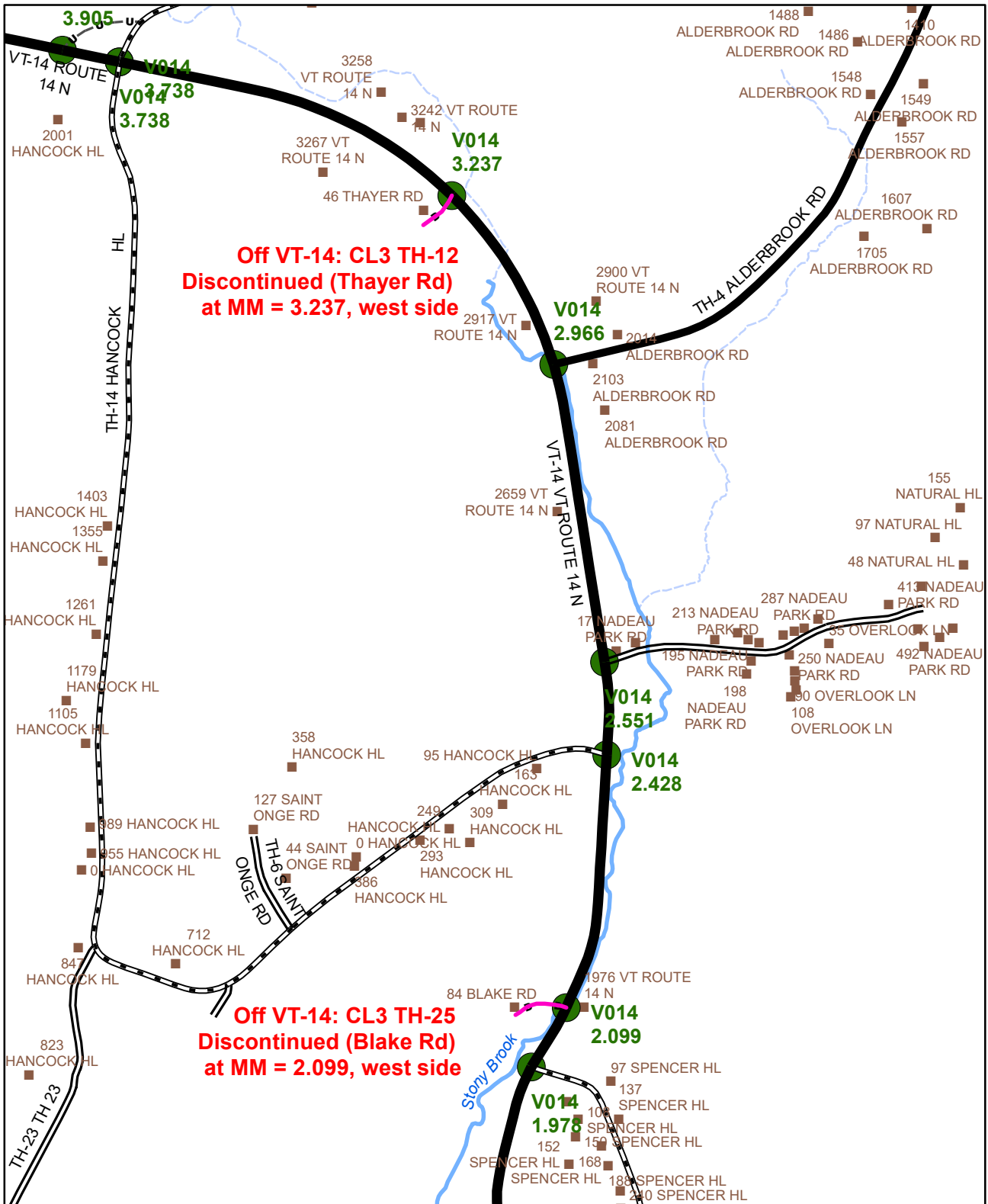

**Off VT-14: CL3 TH-12
Discontinued (Thayer Rd)
at MM = 3.237, west side**

**Off VT-14: CL3 TH-25
Discontinued (Blake Rd)
at MM = 2.099, west side**

**Mileage Certificate Change 2020
COVENTRY**

(CERTCODE: 1005-0)

Mapping Section
Division of Policy, Planning and Intermodal Development
Vermont Agency of Transportation -- March 13, 2020

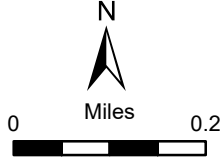

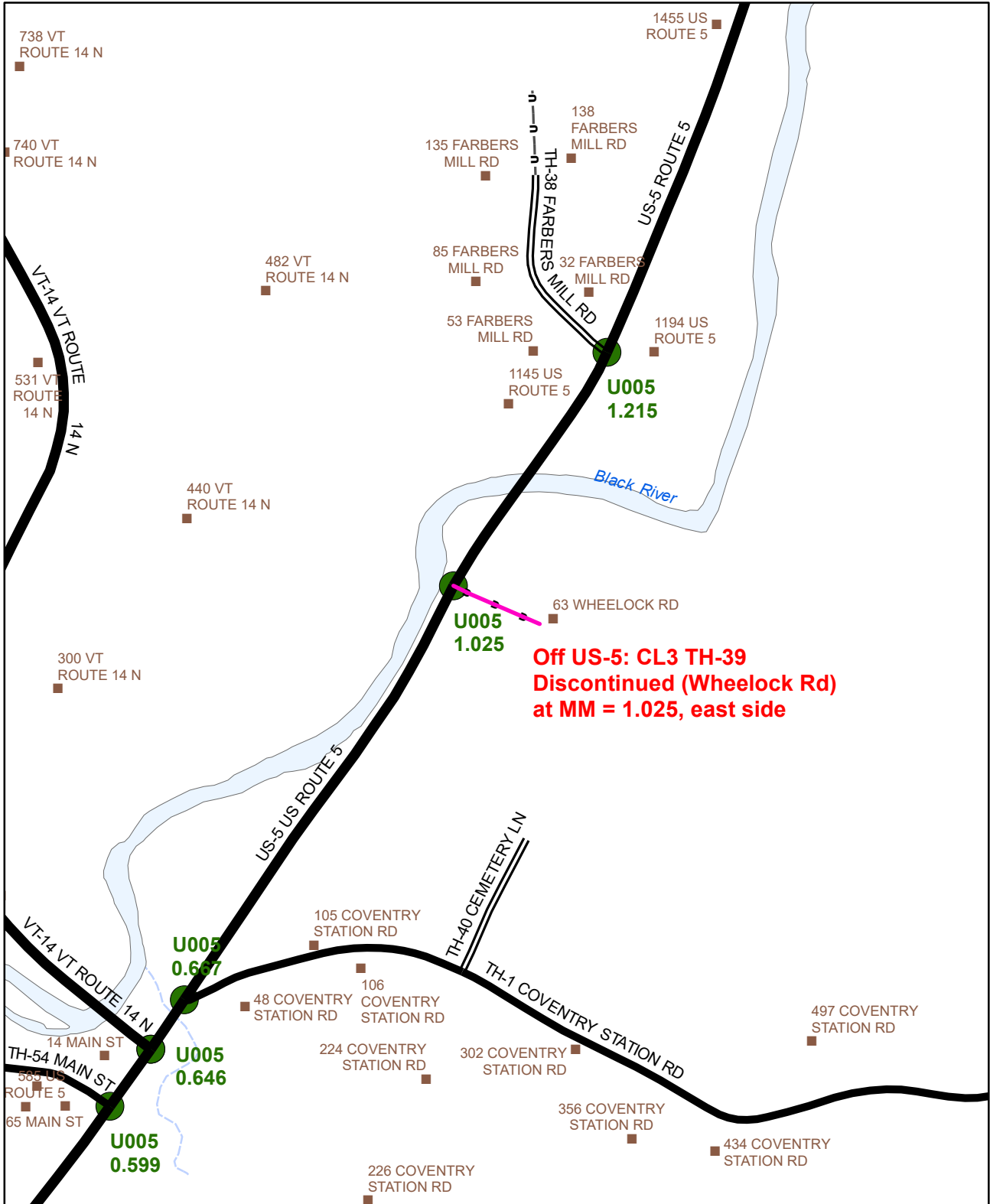

Mileage Certificate Change 2020

COVENTRY

(CERTCODE: 1005-0)

Mapping Section
 Division of Policy, Planning and Intermodal Development
 Vermont Agency of Transportation -- March 13, 2020

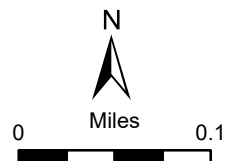

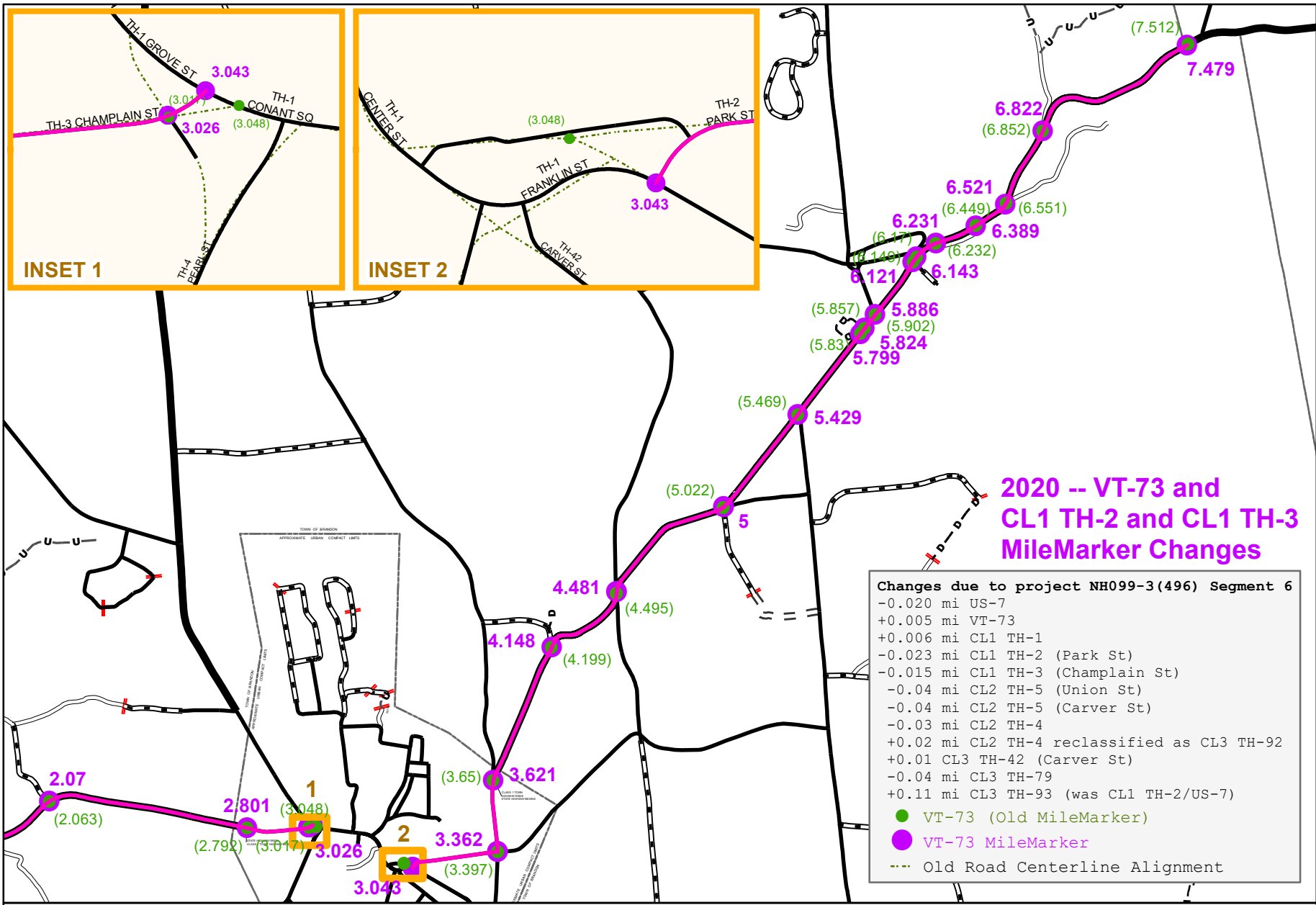

2020 -- VT-73 and CL1 TH-2 and CL1 TH-3 MileMarker Changes

- Changes due to project NH099-3(496) Segment 6**
- 0.020 mi US-7
 - +0.005 mi VT-73
 - +0.006 mi CL1 TH-1
 - 0.023 mi CL1 TH-2 (Park St)
 - 0.015 mi CL1 TH-3 (Champlain St)
 - 0.04 mi CL2 TH-5 (Union St)
 - 0.04 mi CL2 TH-5 (Carver St)
 - 0.03 mi CL2 TH-4
 - +0.02 mi CL2 TH-4 reclassified as CL3 TH-92
 - +0.01 CL3 TH-42 (Carver St)
 - 0.04 mi CL3 TH-79
 - +0.11 mi CL3 TH-93 (was CL1 TH-2/US-7)
- VT-73 (Old MileMarker)
 - VT-73 MileMarker
 - Old Road Centerline Alignment

Mapping Section
 Division of Policy, Planning and Intermodal Development
 Vermont Agency of Transportation - April 13, 2020

**Mileage Certificate Change 2020
 BRANDON URBAN COMPACT**
 (CERTCODE: 1102-0)

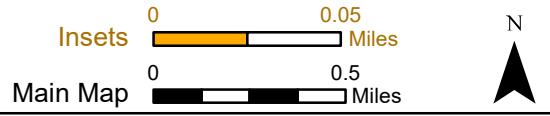

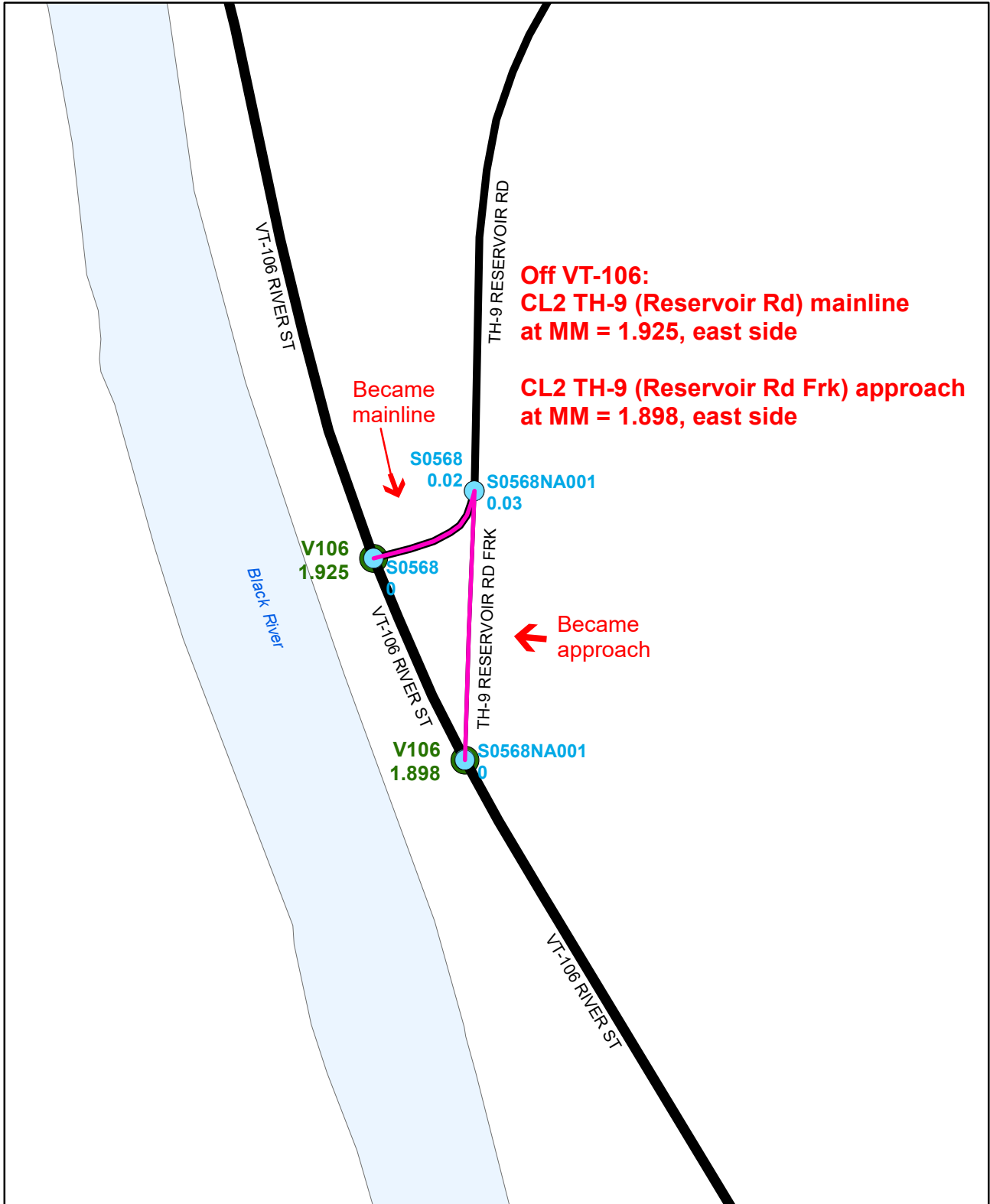

**Off VT-106:
CL2 TH-9 (Reservoir Rd) mainline
at MM = 1.925, east side**

**CL2 TH-9 (Reservoir Rd Frk) approach
at MM = 1.898, east side**

Became
mainline

Became
approach

**Mileage Certificate Change 2020
SPRINGFIELD (North Springfield U.C.)**
(CERTCODE: 1418-0)

Mapping Section
Division of Policy, Planning and Intermodal Development
Vermont Agency of Transportation -- February 27, 2020

