

Vermont Agency of Transportation Road Changes Prompted by 2007 Mileage Certificates

VTrans_notify_rpt
 Tuesday, April 17, 2007

Contact: Sara Moulton, Mapping and GIS Specialist, Tel: 802-828-2109 Email: sara.moulton@state.vt.us
 Report Location: http://www.aot.state.vt.us/planning/documents/HighResearch/Publications/2007_StateHwyChanges.pdf
 Town Highway Map Webpage: http://www.aot.state.vt.us/Planning/MapGIS/Town_Maps1.htm

County	Town	New Highway Mileage	Discontinued Mileage	Reclassified/Remeasured	VTrans Notes
ADDISON	ORWELL			0.63 mi LT-1 reclassified from CL4 TH-28 to Legal Trail LT-1 0.60 mi LT-2 reclassified from CL4 TH-31 to Legal Trail LT-2	LT-2, off VT-22A, MM 1.841, west side
BENNINGTON	BENNINGTON	0.89 mi TH-120 CL3 Fox Hill Rd	0.134 mi Bennington North State Highway - Deletion of jughandle		Deletion of Jughandle - Bennington North State Highway, off VT-7A, MM 2.356, west side
BENNINGTON	POWNA		0.068 mi VT-346 - Deletion of approach		CL3 TH-120, off VT-9, MM 2.919, south side VT-346 - deletion of approach -- off VT-346, MM 0.035 -- off US-7, MM 1.800
BENNINGTON	WINHALL	The following portions of TH-16 were previously VT-30. They were turned over to the town in 1947 and had not been drawn on a Town Highway Map since. 0.60 mi TH-16 CL4 (Old Snow Valley Rd) 0.49 mi LT-1 Legal Trail (Snow Valley Rd) 0.37 mi Discontinued (Snow Valley Rd)	0.06 mi TH-19 Discontinued (was CL4) Old Turnpike Rd was discontinued, it had not appeared on any VTrans Town Highway Maps (0.48 mi)	Class 2 Transfer - CL3 TH-11 to CL2 TH-4 (1.37 mi)	CL2 TH-4, off VT-30, MM 4.132, east side CL4 TH-16, off VT-11, MM 1.195, east side
CALEDONIA	HARDWICK			0.40 mi TH-24 reclassified from CL4 to CL3 (Billings Rd) Total 1.62 mi Legal Trail mileage approved by Selectboard LT-1 1.60 mi LT-2 0.02 mi	LT-1, off VT-14, MM 0.753, west side

County	Town	New Highway Mileage	Discontinued Mileage	Reclassified/Remeasured	VTrans Notes
CHITTENDEN	CHARLOTTE	0.23 mi TH-49 CL3 Higbee Rd (addition/relocation of intersection of TH-49 with US-7)	0.66 mi LT-1 (formerly TH-27) Discontinued (was Legal Trail) 0.34 mi portion of LT-2 (formerly TH-16) Discontinued (was Legal Trail)	0.46 mi portion of LT-2, renumbered to LT-3 (Mcguire Pent Rd, corrected to actual location)	CL3 TH-49, off US-7, MM1.872, east side (former intersection of TH-49 and US-7 is blocked)
CHITTENDEN	COLCHESTER	0.18 mi TH-194 CL3 Nottingham Ct 0.07 mi TH-195 CL3 Bloomfield Dr		0.39 mi LT-1 (Legal Trail mileage approved by Selectboard) 0.09 mi LT-2 (Legal Trail mileage approved by Selectboard)	LT-1 (Legal Trail) Discontinued, off US-7, MM1.563, east side CL3 TH-197, off VT-2A, MM 0.419, east side
CHITTENDEN	SHELBURNE	0.126 mi US 7 - Addition of Jughandle at TH-13 (Webster Rd) 0.17 mi TH-99 CL3 Chesapeake Dr			US-7 Split Into Divided Highway -- Shelburne: north of MM 2.441 -- South Burlington: south of MM 0.104 US 7 - Addition of Jughandle at TH-13 (Webster Rd)
CHITTENDEN	SO. BURLINGTON	US-7 Split Into Divided Highway, north of TH-13 (Lower Webster Rd) 0.61 mi TH-197 CL3 Nowland Farm Rd (addition) 0.65 mi TH-217 CL3 Golf Course Rd 0.59 mi TH-218 CL3 Park Rd 0.39 mi TH-219 CL3 Four Sisters Rd 0.03 mi TH-220 CL3 Dorey Rd 0.25 mi TH-221 CL3 Economou Farm Rd 0.36 mi TH-222 CL3 Holbrook Rd 0.13 mi TH-223 CL3 Tabor Pl 0.30 mi TH-224 CL3 Fairway Dr 0.15 mi TH-225 CL3 Old Schoolhouse Rd 0.40 mi TH-226 CL3 Cobblestone Cir 0.073 mi additional Class 1 Lane mileage US 2 - Williston Rd			US-7 Split Into Divided Highway -- Shelburne: north of MM 2.441 -- South Burlington: south of MM 0.104 US 7 - Addition of Jughandle at TH-13 (Webster Rd)
CHITTENDEN		US-7 Split Into Divided Highway, south of TH-26 (Allen Rd)			

County	Town	New Highway Mileage	Discontinued Mileage	Reclassified/Remeasured	VTrans Notes
CHITTENDEN	WESTFORD			Total 4.16 mi Legal Trail mileage approved by Selectboard LT-1 1.05 mi LT-2 0.79 mi LT-3 0.03 mi LT-4 1.45 mi LT-6 0.84 mi	LT-3, off VT-128, MM 3.998, south side

CHITTENDEN	WINOOSKI CITY			New Highway-Realignment- Reclassification -- Downtown Redevelopment Project -- Summary: CL1 +0.224, CL2 +0.54, CL3 -0.19	Downtown Redevelopment Project - Realignments -- US-7 from Winooski / Burlington boundary to Newells Ln -- VT-15 from Main St to Barlow St
ESSEX	LUNENBURG			Class 2 Transfer - CL3 TH-15 (1.46 mi) and CL3 TH-34 (0.45 mi) to CL2 TH-2 (1.91 mi)	CL2 TH-2, off US-2, MM 4.688, north side

FRANKLIN	BERKSHIRE	0.130 mi TH-42 due to VT-118 realignment	0.048 mi VT-118 - Realignment due to relocation of Bridge 26		Realignment of VT-118 and TH-42 CL3, VT-118 approx. MM 0.40 - 0.70

FRANKLIN	HIGHGATE	0.30 mi TH-71 CL3 Hoague Dr 0.08 mi TH-72 CL3 Eric Dr		Total 4.29 mi Legal Trail mileage approved by Selectboard LT-1 0.69 mi LT-2 0.15 mi LT-3 0.26 mi LT-4 0.07 mi LT-5 0.68 mi LT-6 0.11 mi LT-7 0.75 mi LT-8 0.26 mi LT-9 0.40 mi 0.67 mi LT-10, TH-25 reclassified from CL4 TH-25 to Legal Trail LT- 10 0.25 mi LT-11, TH-46 reclassified from CL4 TH-46 to Legal Trail LT-11	LT-3 (Legal Trail), off VT-207, MM 1.743, east - west sides LT-4 (Legal Trail), off VT-207, MM 1.594, east side

FRANKLIN	SAINT ALBANS CITY	0.08 mi CL3 Isham Dr 0.12 mi CL3 Warner Dr 0.12 mi CL3 Sunset Meadow(s) 0.21 mi CL3 Murray Dr 0.08 mi CL3 Bowles Ln 0.28 mi CL3 Guyette Cir 0.02 mi CL3 Edward St			CL3 Sunset Meadow, off VT-38, MM 0.289, north side CL3 Murray Dr, off VT-36, MM 0.114, south side

County	Town	New Highway Mileage	Discontinued Mileage	Reclassified/Remeasured	VTrans Notes
FRANKLIN	SWANTON	0.03 mi TH-73 CL3 Missisquoi St 0.04 mi TH-74 CL3 Short St 0.19 mi TH-75 CL3 Maple Grove Est	0.04 mi TH-56 Discontinued (Old Highgate Rd. was CL3)	0.09 mi TH-36 reclassified from CL4 to CL3 (Hubbard Ln)	CL3 TH-75, off US-7, MM 1.286, east side CL3 TH-73, off VT-78, MM 7.413, north side
ORANGE	CHELSEA			Total 6.65 mi Legal Trail mileage approved by Selectboard (LT-1 through LT-13)	LT-5 (Legal Trail), off VT-110, MM 5.209, west side LT-9 (Legal Trail), off VT-110, MM 4.289, west side LT-11 (Legal Trail), off VT-113, MM 0.318, north side
ORANGE	WEST FAIRLEE	1.90 mi TH-16 CL4 extension to Kidderhood Rd 1.37 mi TH-22 CL4 extension to Buck Hill Rd 1.14 mi TH-33 CL4 Wilson Rd			CL4 TH-33, off VT-244, MM 0.947, west side
ORLEANS	CHARLESTON			Total 5.83 mi Legal Trail mileage approved by Selectboard LT-1 0.95 mi LT-2 0.30 mi LT-3 1.00 mi LT-4 0.28 mi LT-5 0.23 mi LT-6 0.85 mi LT-7 0.61 mi LT-8 0.30 mi LT-9 0.25 mi LT-10 0.35 mi LT-11 0.71 mi	LT-7 (Legal Trail), off VT-105, MM 7.594, north side

County	Town	New Highway Mileage	Discontinued Mileage	Reclassified/Remeasured	VTrans Notes
ORLEANS	TROY		0.15 mi TH-7 Discontinued (Cross Rd, was CL3)	0.23 mi TH-7 remaining CL3 section remeasured distance (Cross Rd) 1.10 mi LT-1 reclassified from CL4 TH-30 to Legal Trail LT-1 (Boudreau Rd) 0.75 mi LT-2 reclassified from TH-34 CL4 to Legal Trail LT-2 (Brittain Rd) 0.15 mi LT-3 reclassified from TH-7 CL3 to Legal Trail LT-3 (Cross Rd)	Discontinued (was CL3 TH-7), off VT-105, MM 4.054, north side

RUTLAND	CLARENDON		0.14 mi TH-41 Discontinued, was CL4		Discontinued (was CL4 TH-41), off VT-7B, MM 2.970, west side

WASHINGTON	CALAIS			Class 2 Transfer - CL3 TH-46 (0.33 mi) to CL2 TH-7 (0.33 mi)	CL2 TH-7, off VT-14, MM 0.833, west side

WASHINGTON	WORCESTER			Total 8.26 mi Legal Trail mileage approved by Selectboard LT-1 2.05 mi LT-2 0.67 mi LT-3 1.03 mi LT-4 0.30 mi LT-5 0.30 mi LT-6 0.90 mi LT-7 1.40 mi LT-8 0.70 mi LT-9 0.63 mi LT-10 0.30 mi LT-11 0.08 mi	LT-3 (Legal Trail), off VT-12, MM 3.023, west side LT-9 (Legal Trail), off VT-12, MM 6.727, east side LT-10 (Legal Trail), off VT-12, MM 4.853, west side

WINDHAM	JAMAICA			Total 19.57 mi Legal Trail mileage approved by Selectboard (LT-1 through LT-25)	LT-18 (Legal Trail), off VT-100, MM 1.406, north side

WINDSOR	BRIDGEWATER		0.05 mi LT-5 Discontinued (was formerly TH-61, reclassified to Legal Trail in 1989, Legal Trail was discontinued in 1991, recorded with VTrans 2007)	Total 1.22 mi Legal Trail mileage approved by Selectboard LT-1 0.10 mi LT-2 0.15 mi LT-3 0.30 mi LT-4 0.07 mi LT-6 0.20 mi LT-7 0.40 mi	LT-2, off US-4, MM 0.118, north side

<i>County</i>	<i>Town</i>	<i>New Highway Mileage</i>	<i>Discontinued Mileage</i>	<i>Reclassified/Remeasured</i>	<i>VTrans Notes</i>
WINDSOR	ROYALTON			Class 2 Transfer - CL3 TH-79 (0.04 mi) to CL2 TH-7 (0.04 mi)	CL2 TH-7, off VT-107, MM 0.037, north side

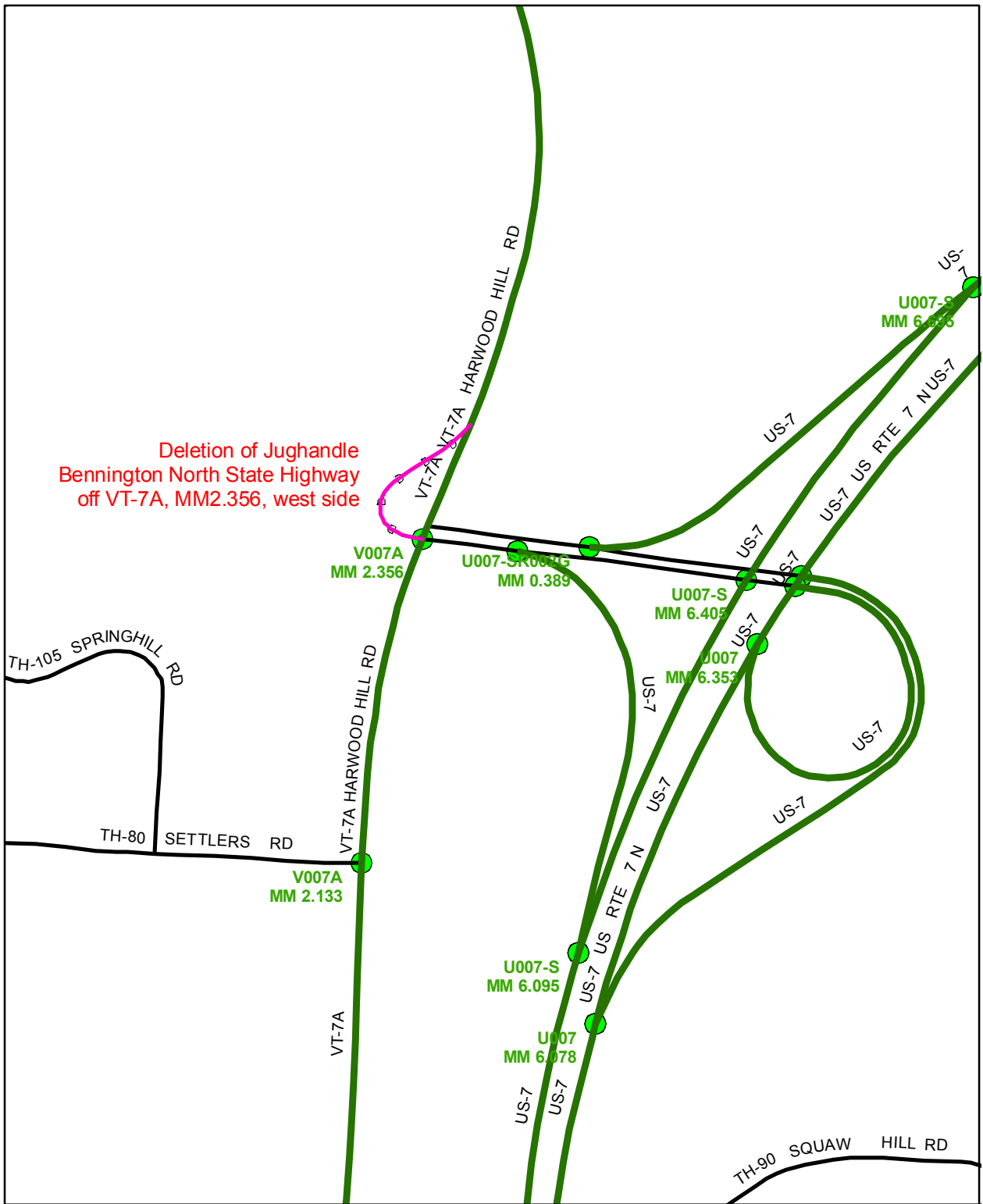

Deletion of Jughandle
Bennington North State Highway
off VT-7A, MM 2.356, west side

Mileage Certificate Change 2007 -- BENNINGTON

Mapping Unit
Policy & Planning Division
Vermont Agency of Transportation -- April 2007



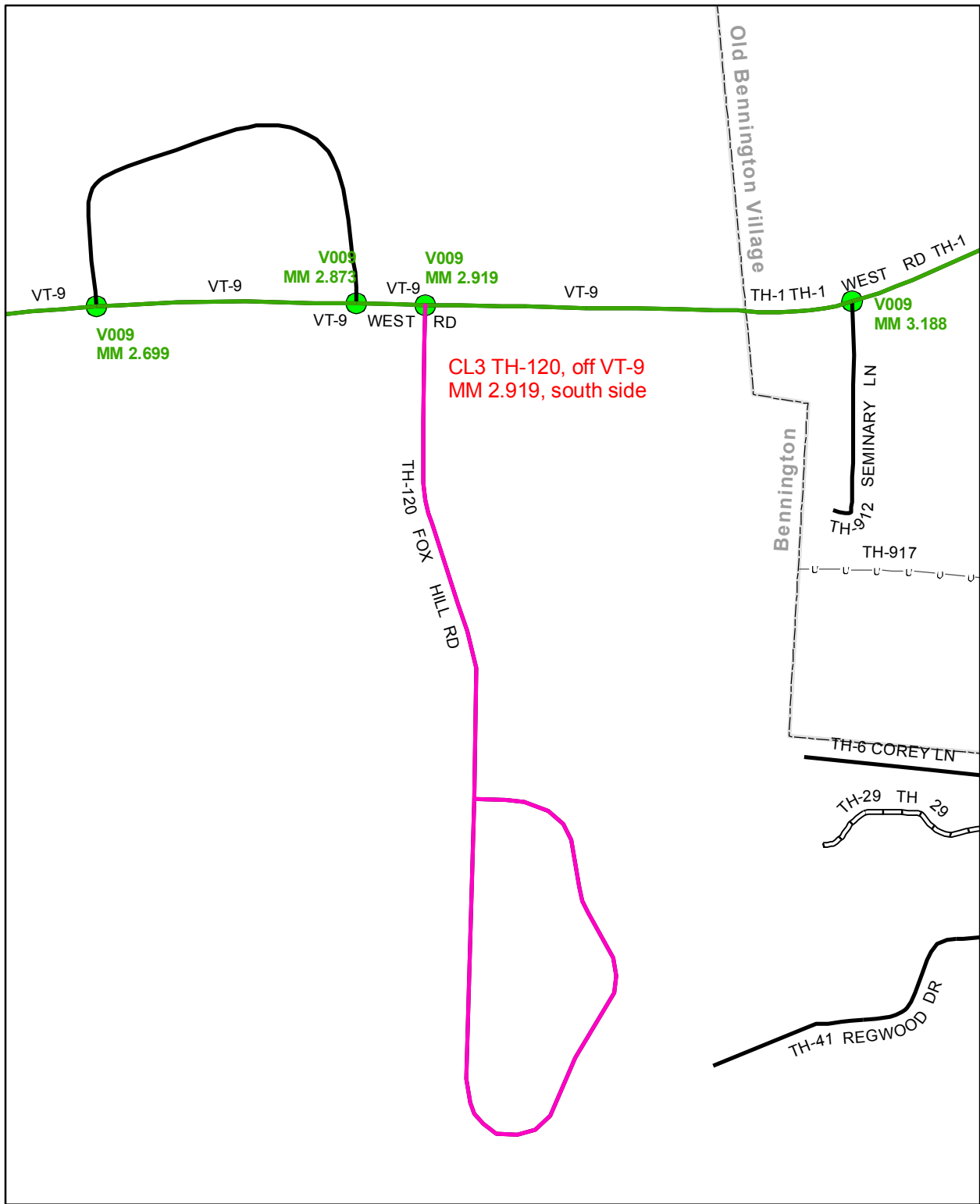

Mileage Certificate Change 2007 -- BENNINGTON

Mapping Unit
 Policy & Planning Division
 Vermont Agency of Transportation -- April 2007



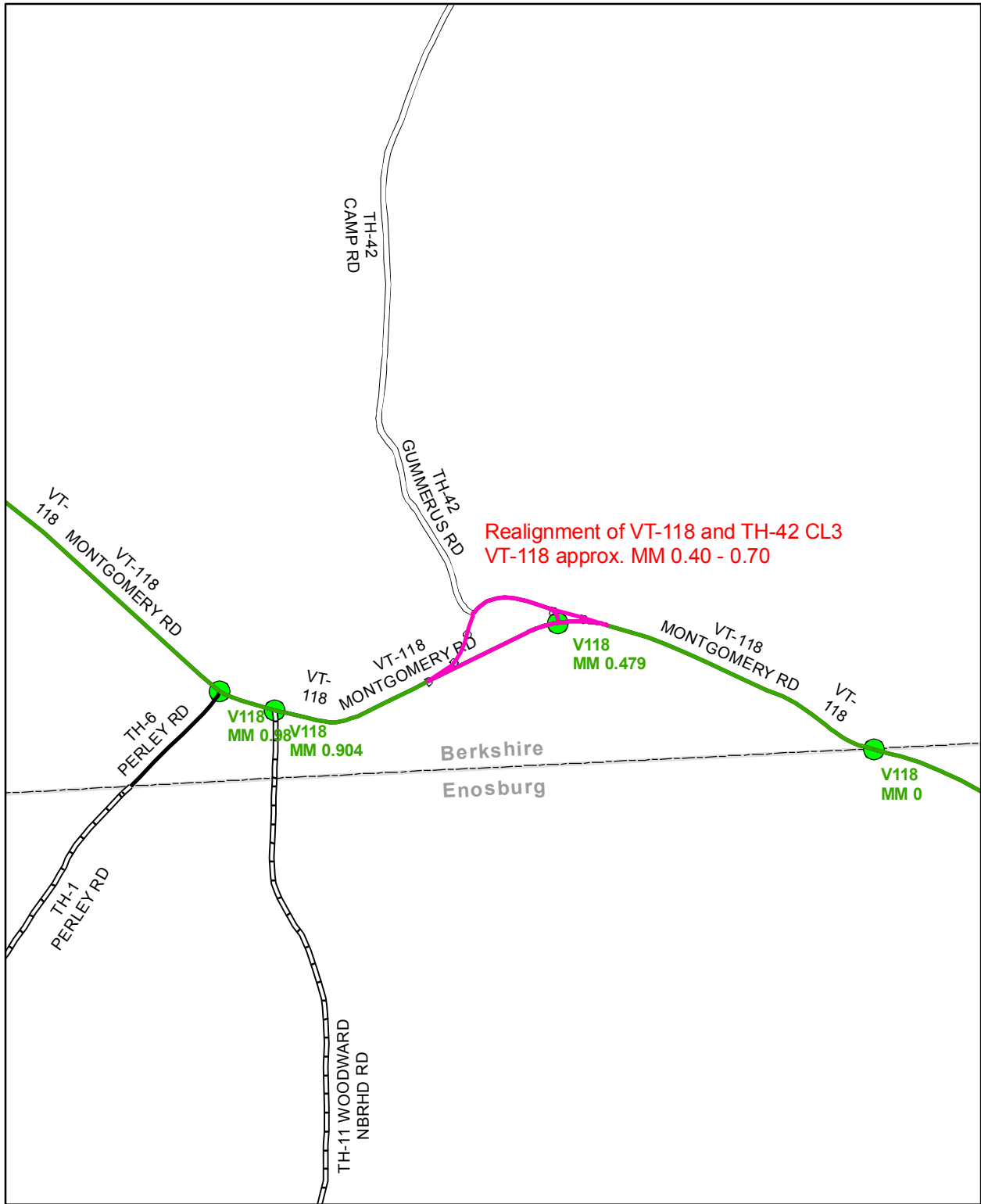

Mileage Certificate Change 2007 -- BERKSHIRE

Mapping Unit
Policy & Planning Division
Vermont Agency of Transportation -- April 2007



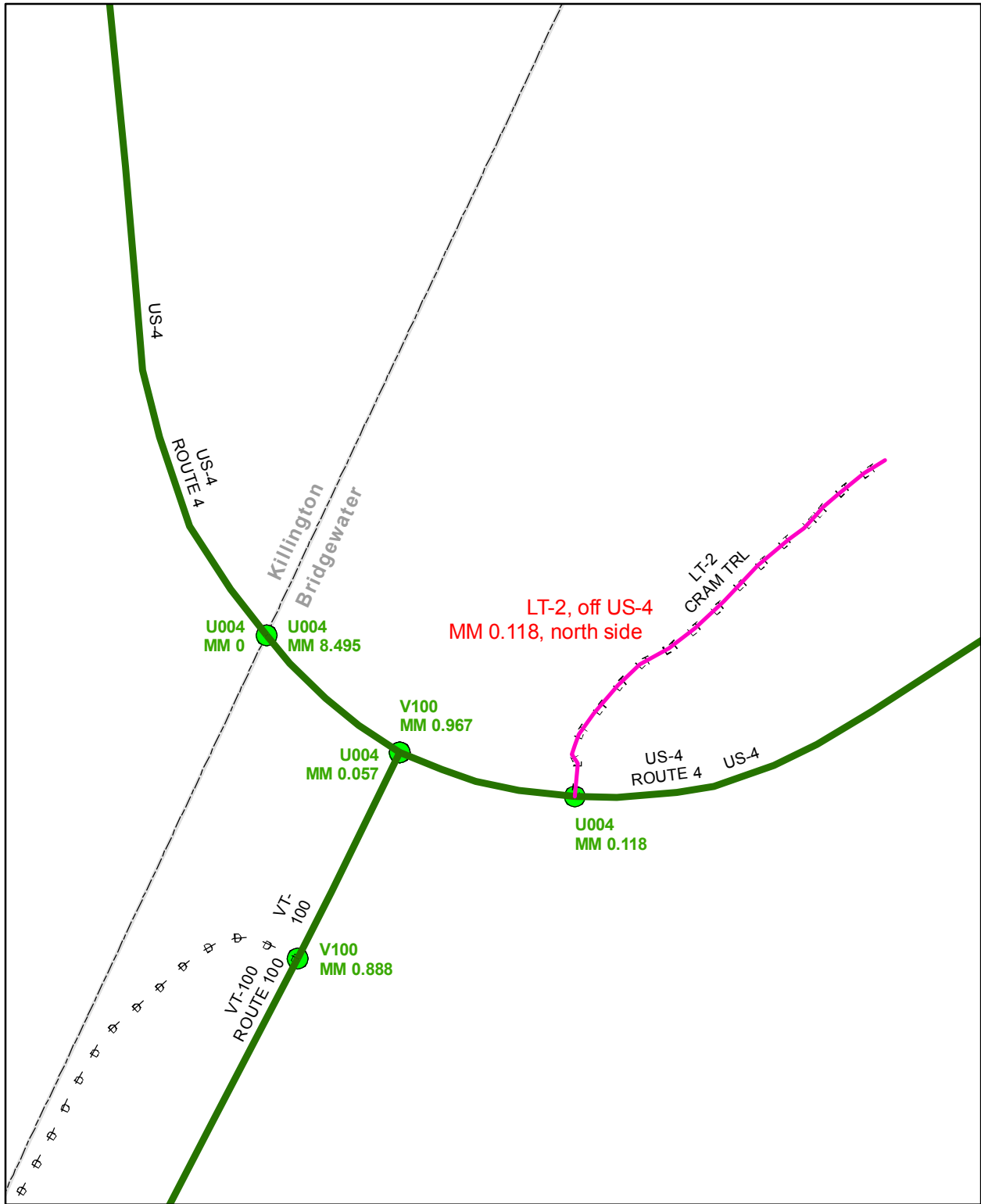

Mileage Certificate Change 2007 -- BRIDGEWATER

Mapping Unit
 Policy & Planning Division
 Vermont Agency of Transportation -- April 2007



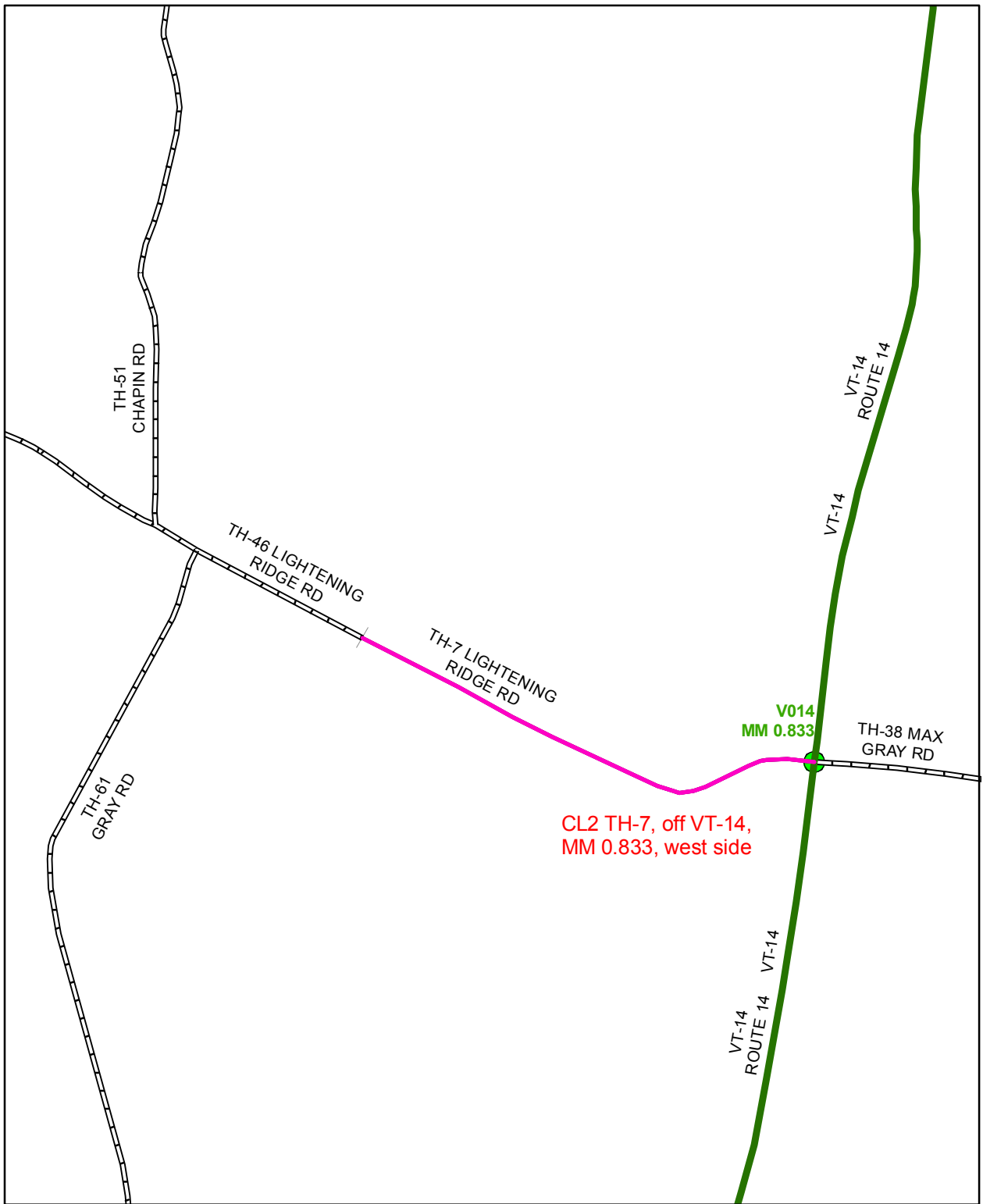

Mileage Certificate Change 2007 -- CALAIS

Mapping Unit
 Policy & Planning Division
 Vermont Agency of Transportation -- April 2007



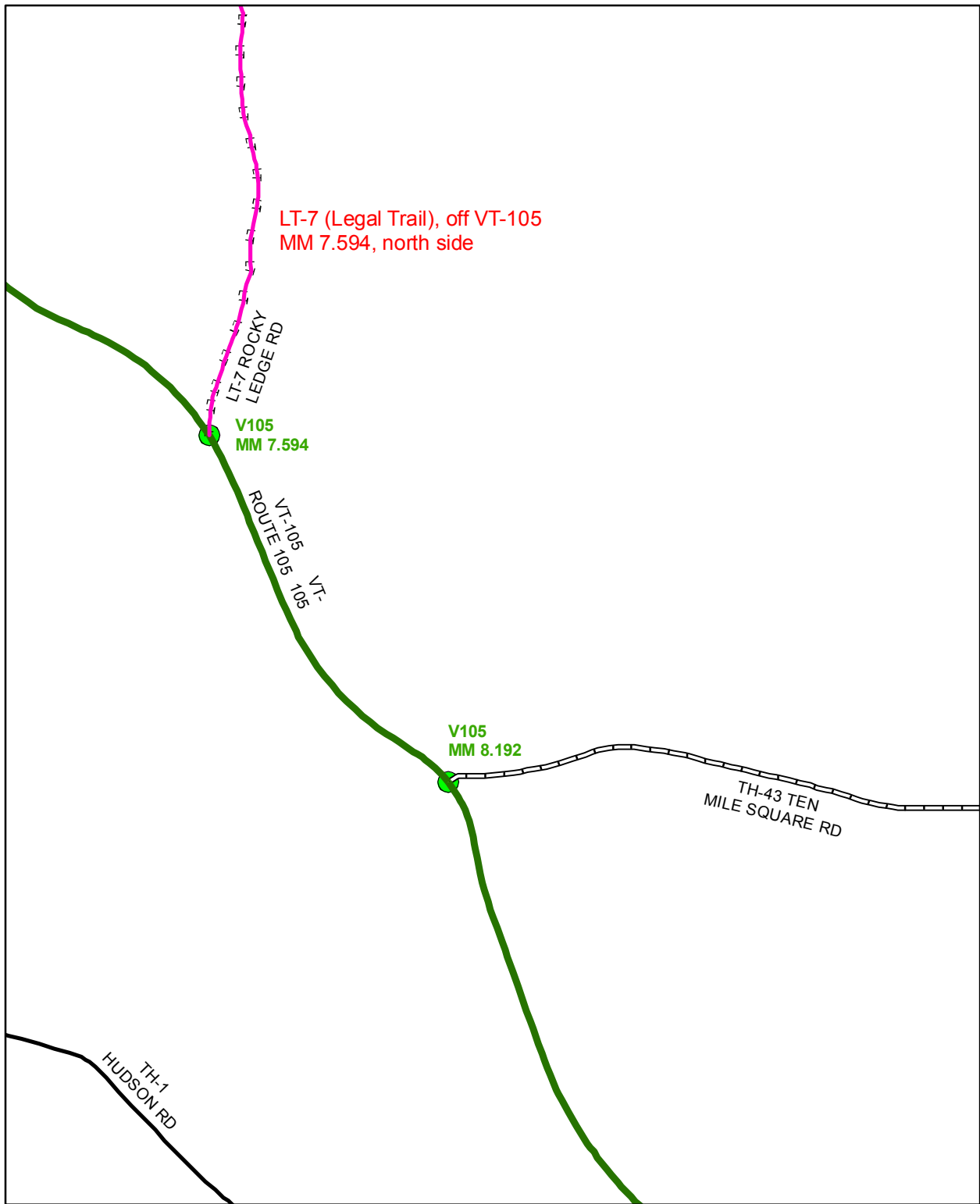

Mileage Certificate Change 2007 -- CHARLESTON

Mapping Unit
 Policy & Planning Division
 Vermont Agency of Transportation -- April 2007



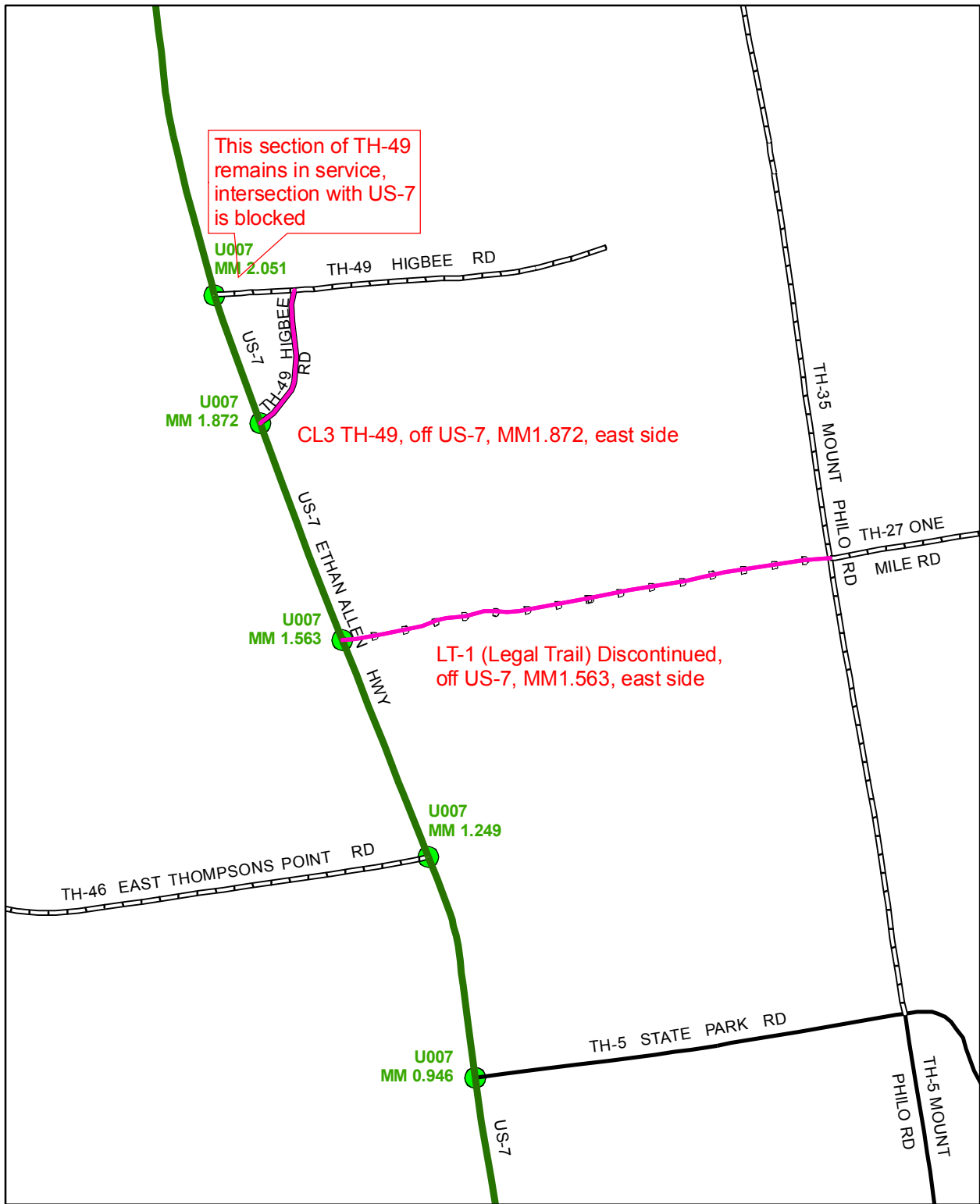

Mileage Certificate Change 2007 -- CHARLOTTE

Mapping Unit
 Policy & Planning Division
 Vermont Agency of Transportation -- April 2007



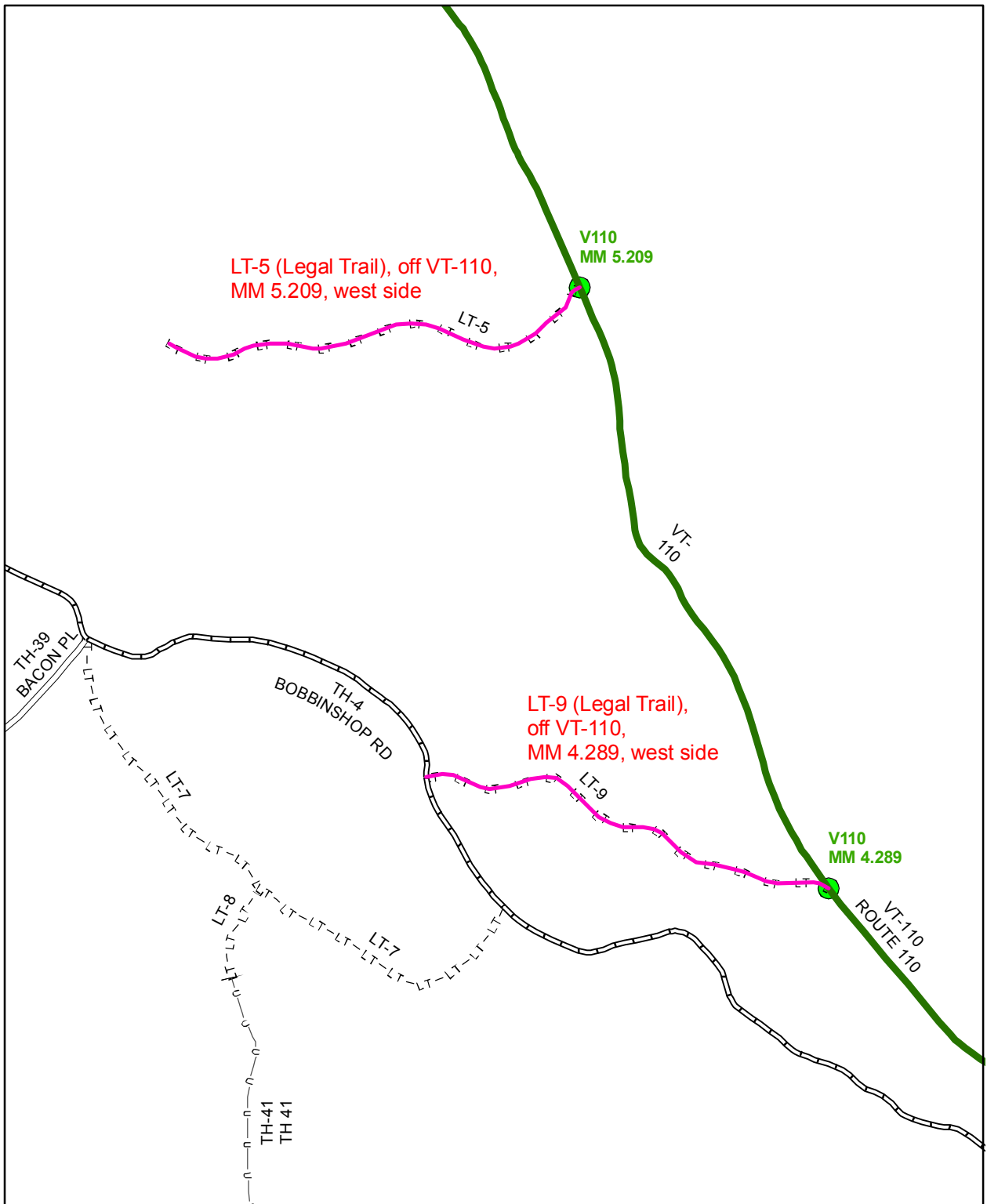

LT-5 (Legal Trail), off VT-110,
MM 5.209, west side

V110
MM 5.209

LT-5

LT-9 (Legal Trail),
off VT-110,
MM 4.289, west side

V110
MM 4.289

TH-39
BACON PL

TH-4
BOBBINSHOP RD

TH-41
TH 41

Mileage Certificate Change 2007 -- CHELSEA

Mapping Unit
Policy & Planning Division
Vermont Agency of Transportation -- April 2007



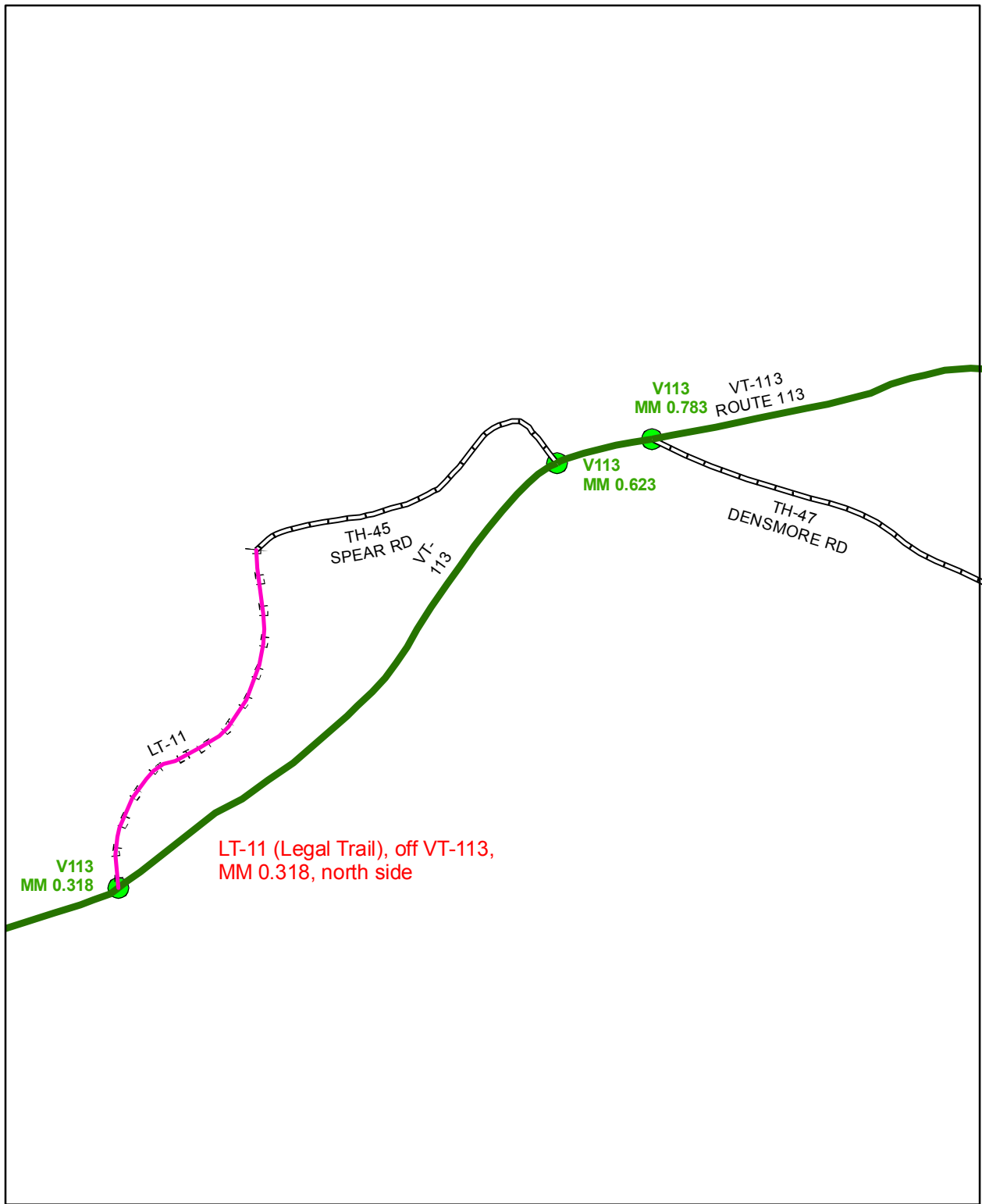

LT-11 (Legal Trail), off VT-113,
MM 0.318, north side

V113
MM 0.318

V113
MM 0.623

V113
MM 0.783

VT-113
ROUTE 113

TH-45
SPEAR RD
VT-113

TH-47
DENSMORE RD

LT-11

Mileage Certificate Change 2007 -- CHELSEA

Mapping Unit
Policy & Planning Division
Vermont Agency of Transportation -- April 2007



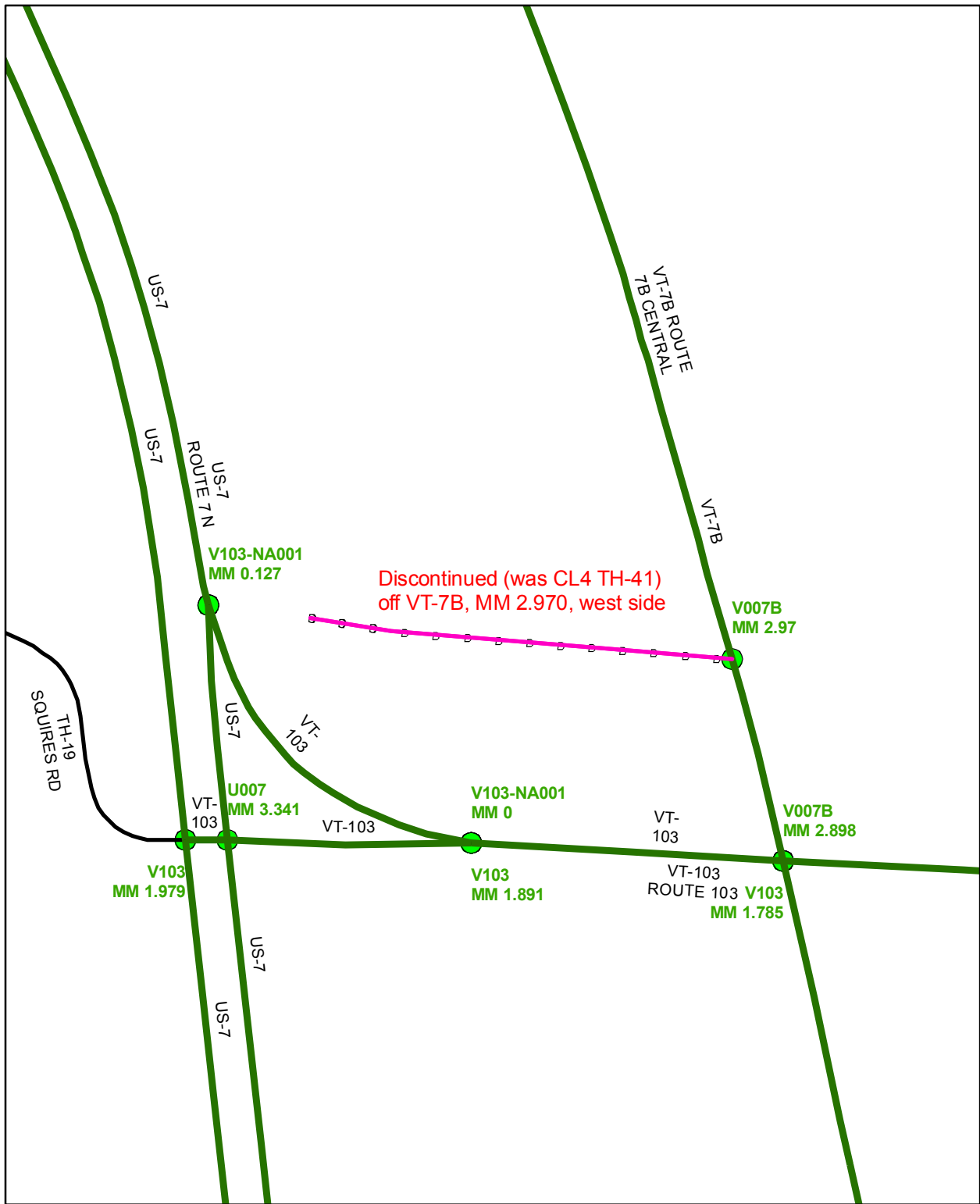

Mileage Certificate Change 2007 -- CLARENDON

Mapping Unit
 Policy & Planning Division
 Vermont Agency of Transportation -- April 2007



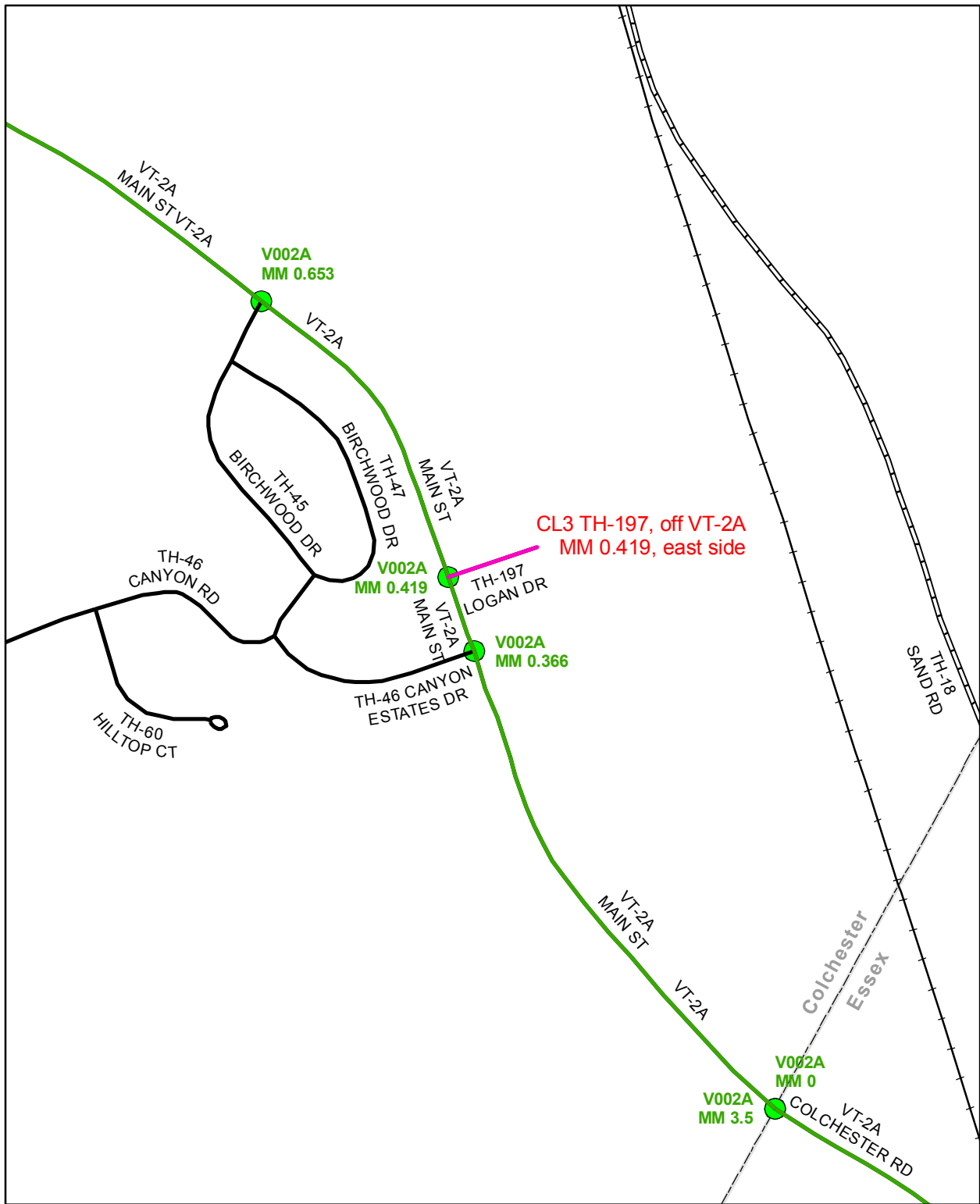

Mileage Certificate Change 2007 -- COLCHESTER

Mapping Unit
 Policy & Planning Division
 Vermont Agency of Transportation -- April 2007



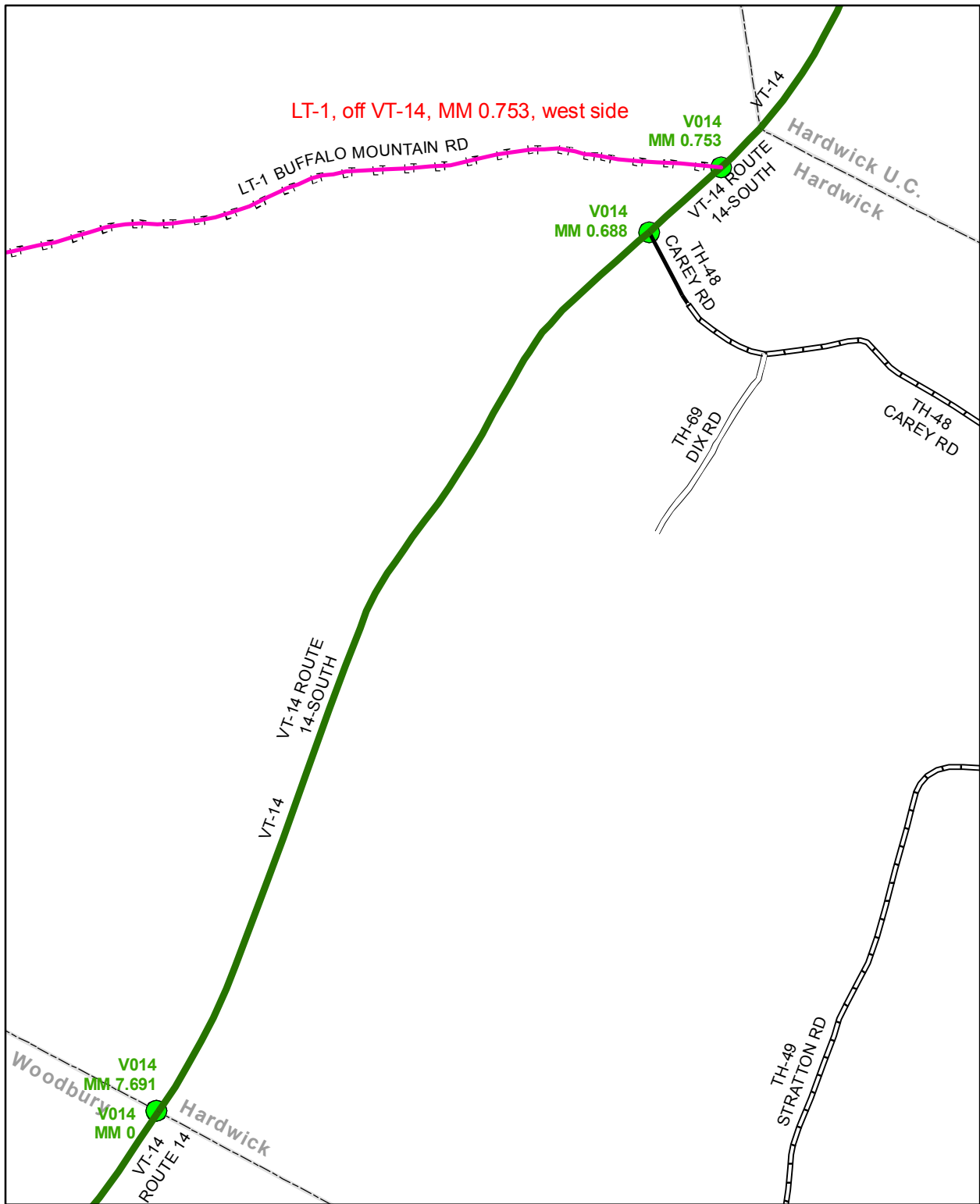

Mileage Certificate Change 2007 -- HARDWICK

Mapping Unit
 Policy & Planning Division
 Vermont Agency of Transportation -- April 2007



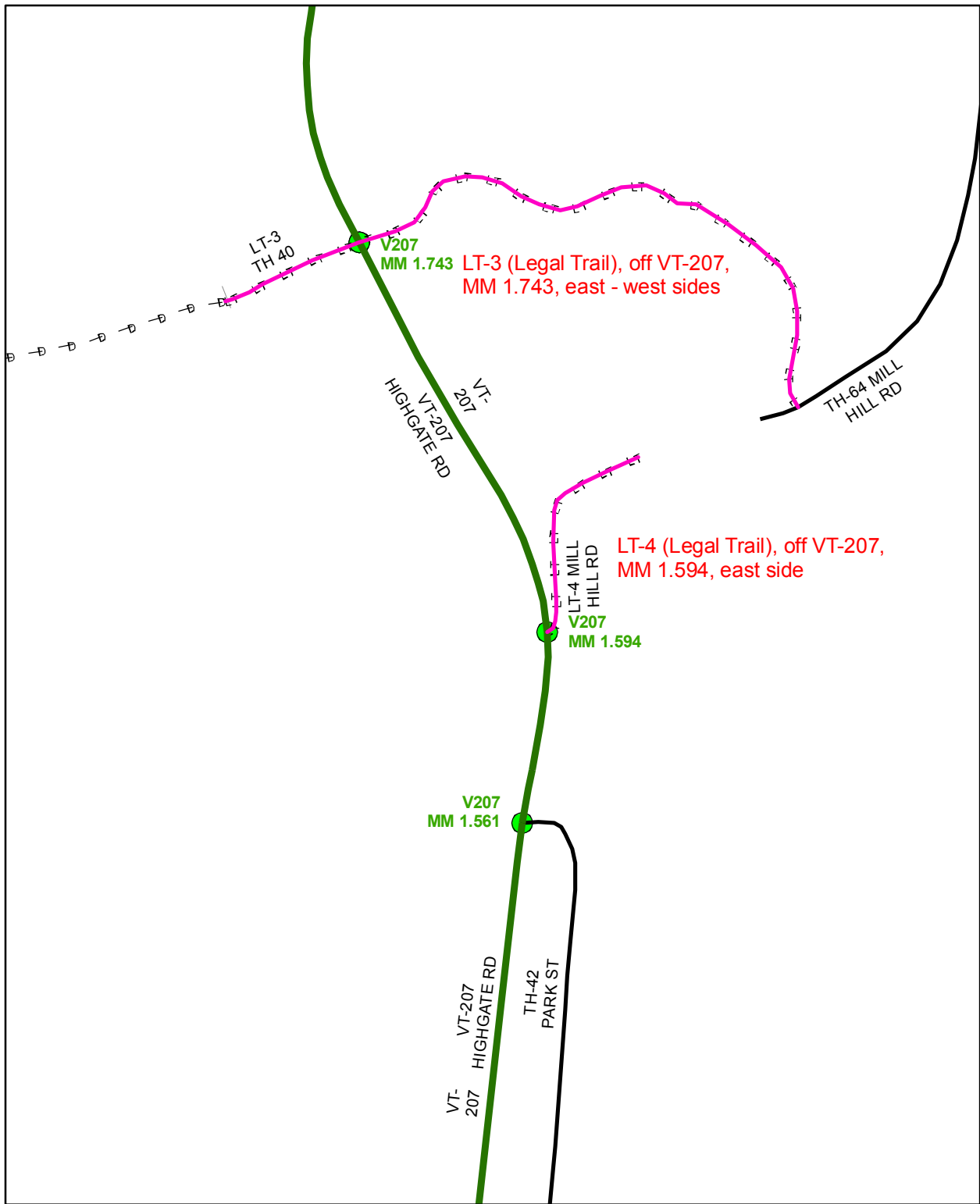

Mileage Certificate Change 2007 -- HIGHGATE

Mapping Unit
 Policy & Planning Division
 Vermont Agency of Transportation -- April 2007



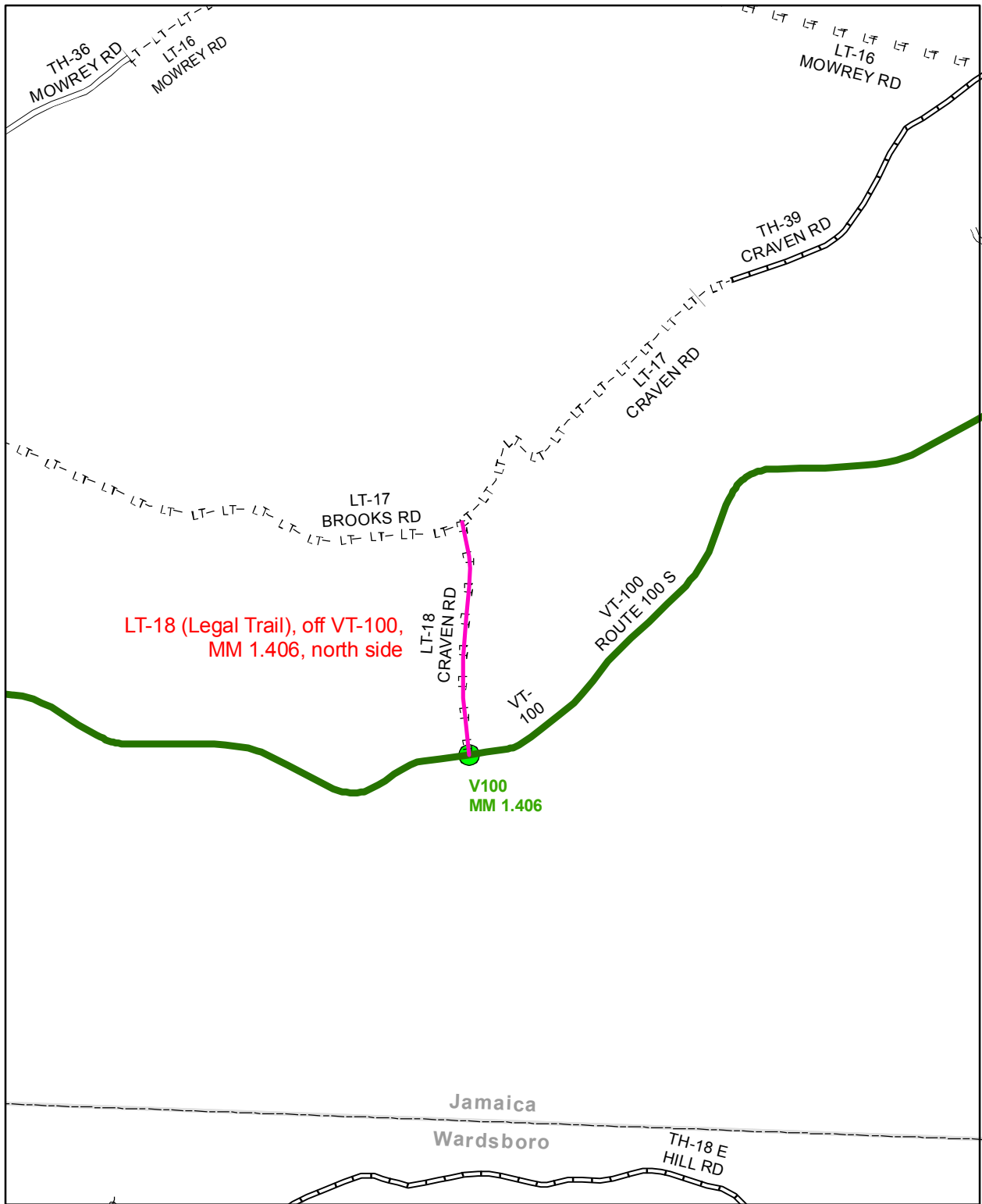

Mileage Certificate Change 2007 -- JAMAICA

Mapping Unit
 Policy & Planning Division
 Vermont Agency of Transportation -- April 2007



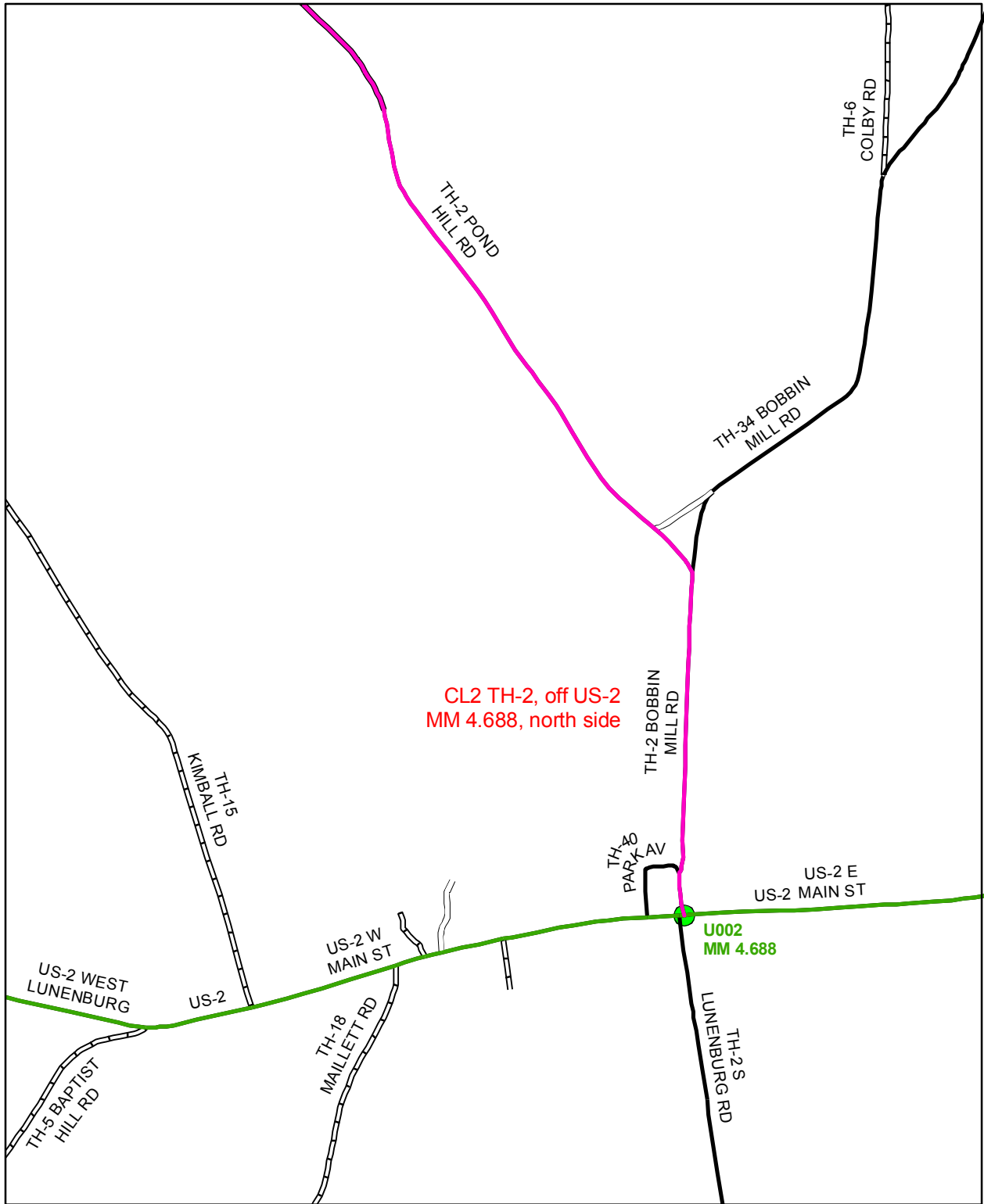

Mileage Certificate Change 2007 -- LUNENBURG

Mapping Unit
 Policy & Planning Division
 Vermont Agency of Transportation -- April 2007



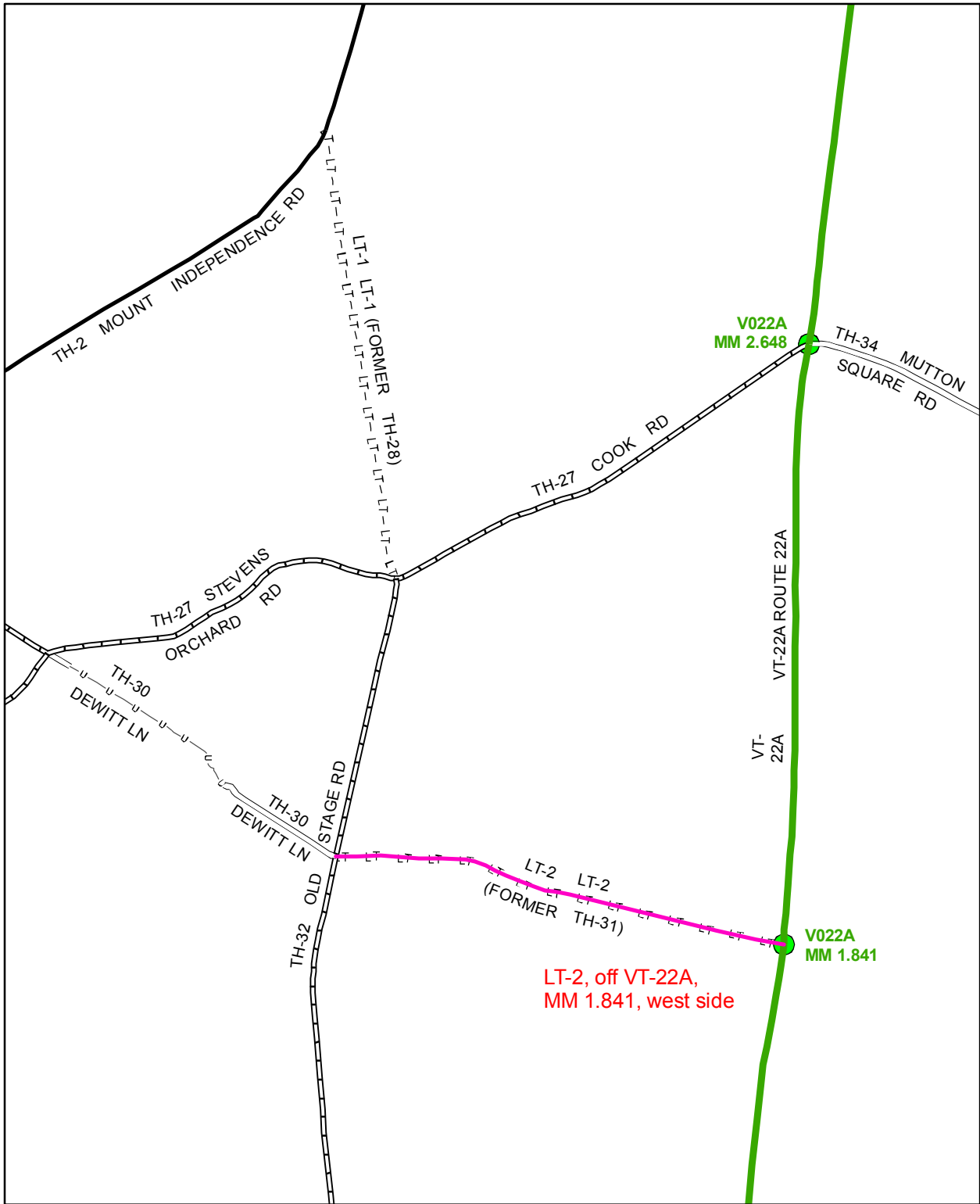

Mileage Certificate Change 2007 -- ORWELL

Mapping Unit
 Policy & Planning Division
 Vermont Agency of Transportation -- April 2007



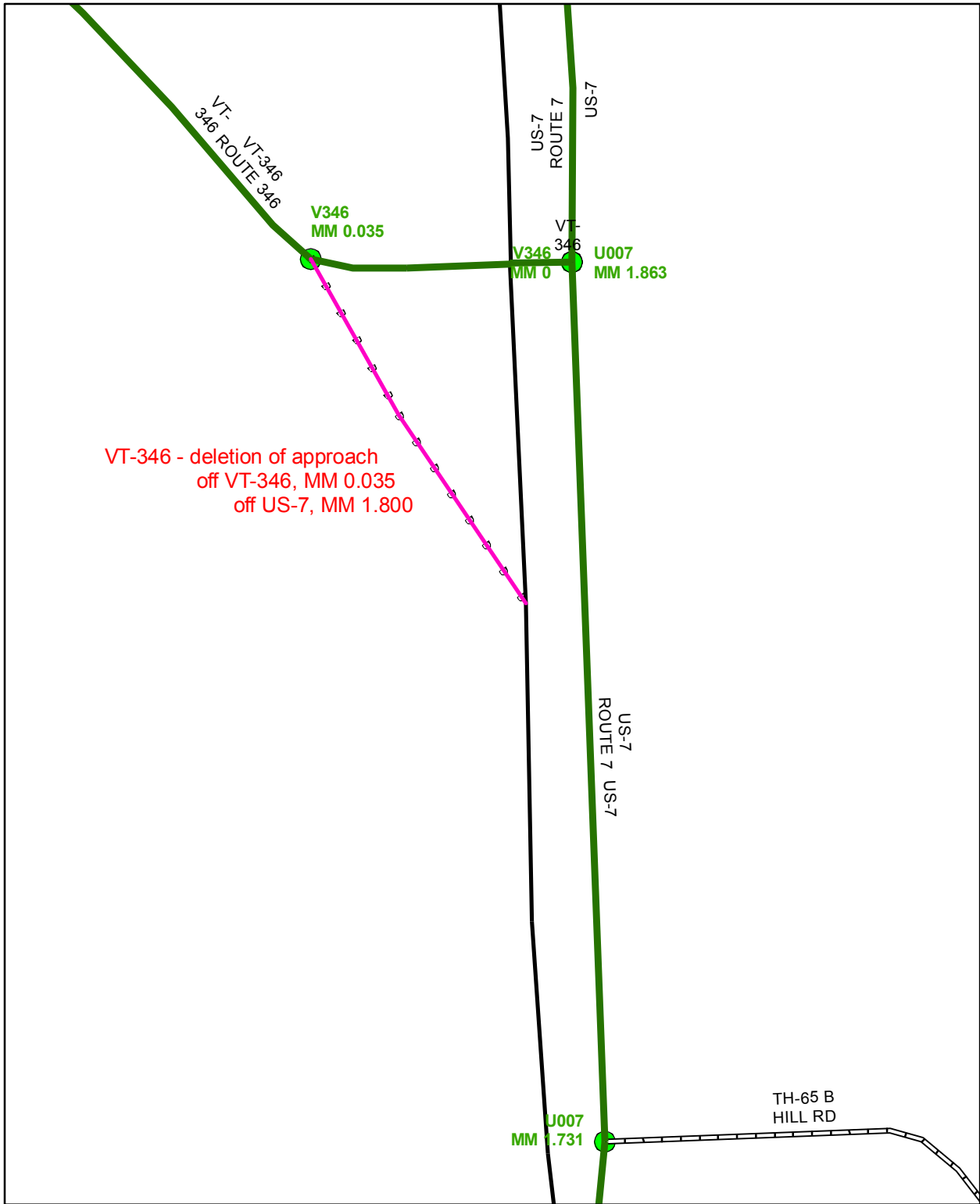

VT-346 - deletion of approach
 off VT-346, MM 0.035
 off US-7, MM 1.800

Mileage Certificate Change 2007 -- POWNAL

Mapping Unit
 Policy & Planning Division
 Vermont Agency of Transportation -- April 2007



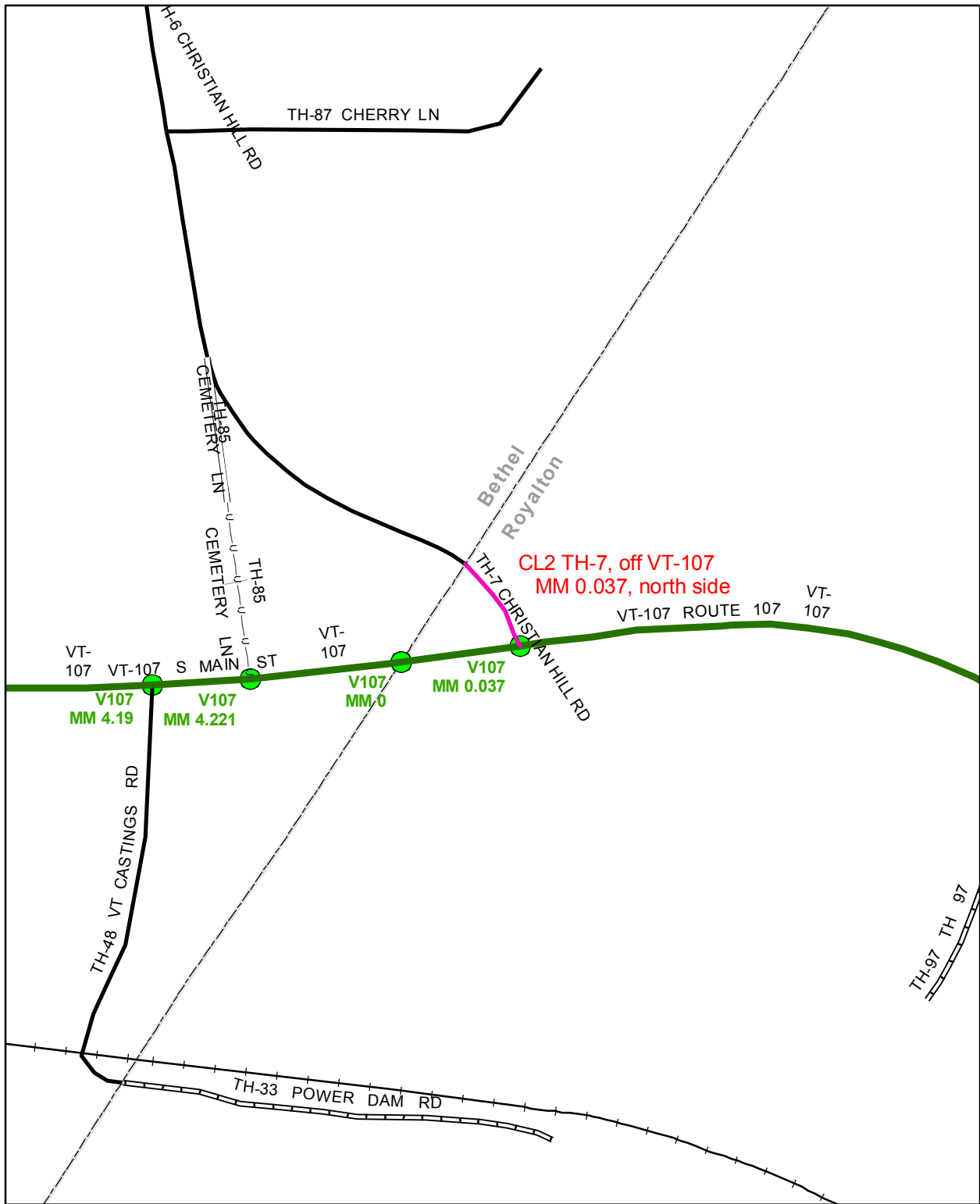

Mileage Certificate Change 2007 -- ROYALTON

Mapping Unit
 Policy & Planning Division
 Vermont Agency of Transportation -- April 2007



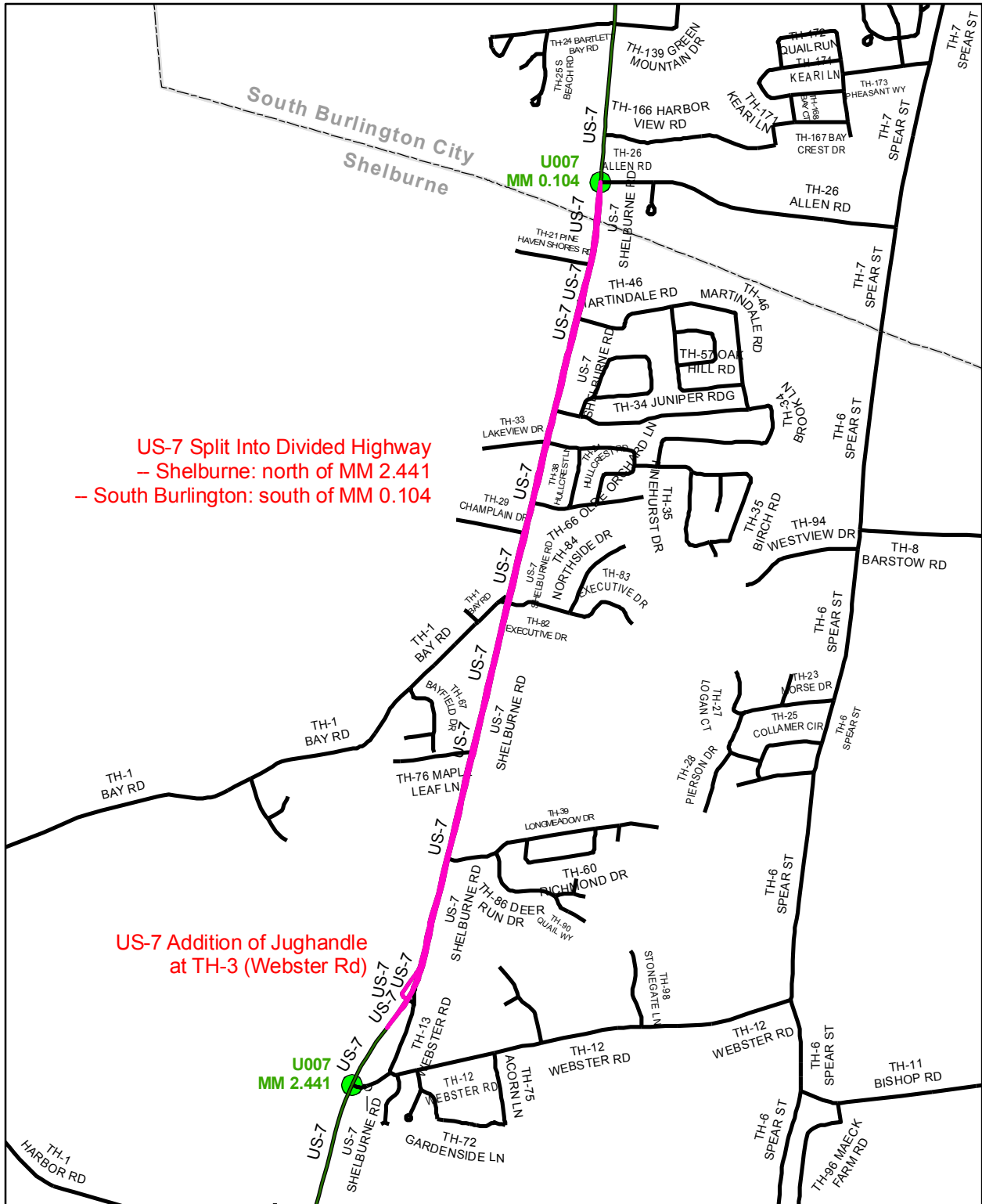

US-7 Split Into Divided Highway
 – Shelburne: north of MM 2.441
 – South Burlington: south of MM 0.104

US-7 Addition of Jughandle
 at TH-3 (Webster Rd)

**Mileage Certificate Change 2007
 SHELburne - SOUTH BURLINGTON**

Mapping Unit
 Policy & Planning Division
 Vermont Agency of Transportation -- April 2007



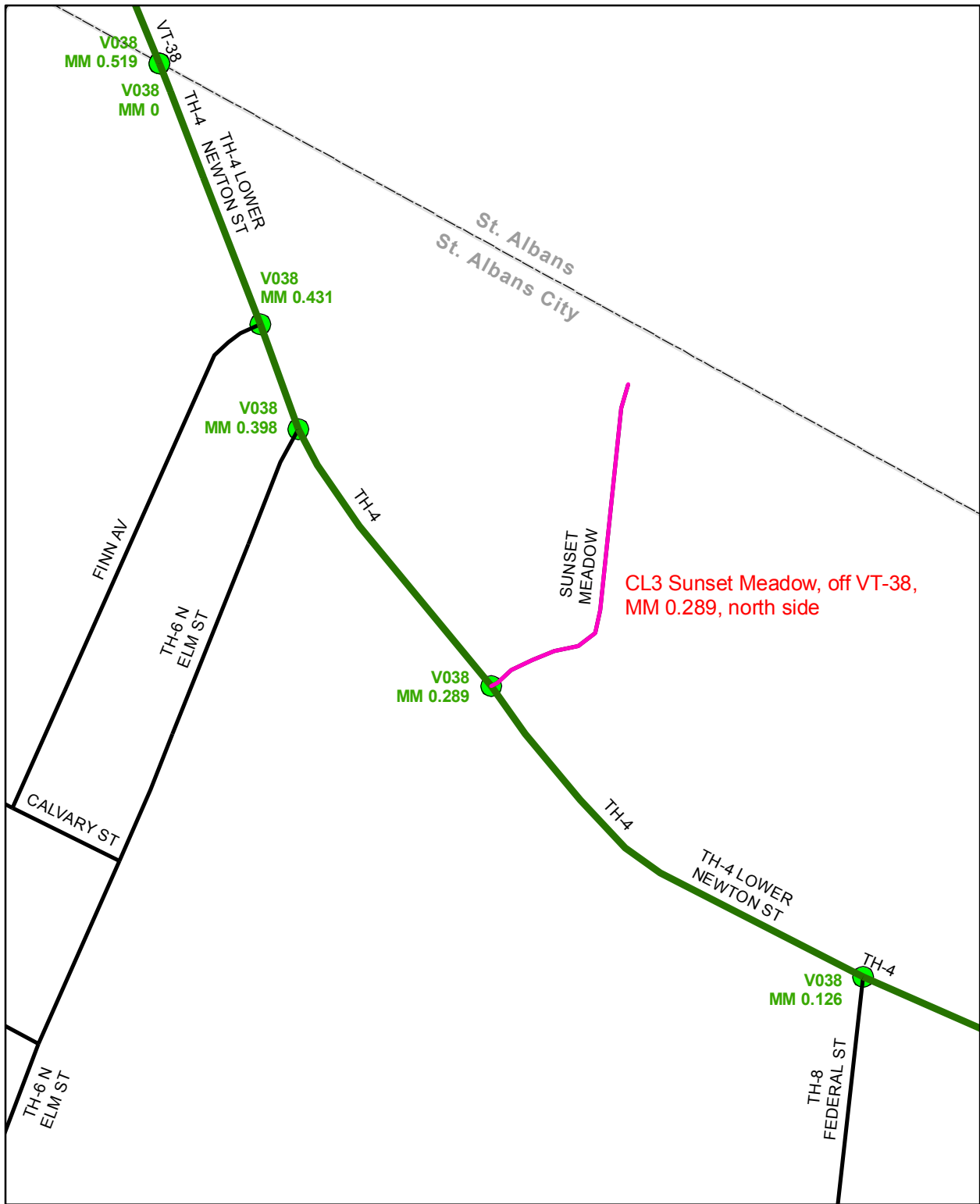

Mileage Certificate Change 2007 -- ST. ALBANS CITY

Mapping Unit
 Policy & Planning Division
 Vermont Agency of Transportation -- April 2007



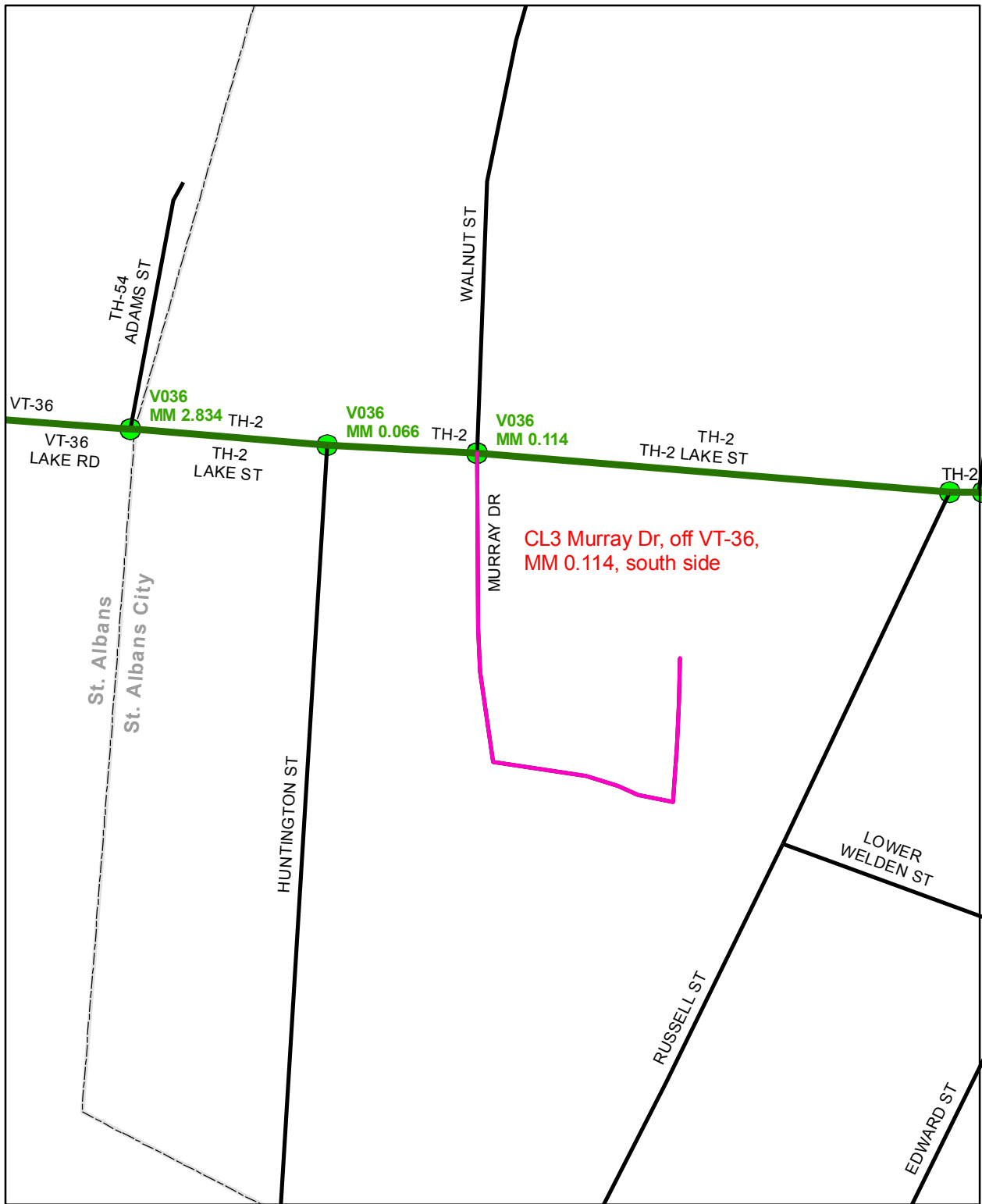

Mileage Certificate Change 2007 -- ST. ALBANS CITY

Mapping Unit
 Policy & Planning Division
 Vermont Agency of Transportation -- April 2007



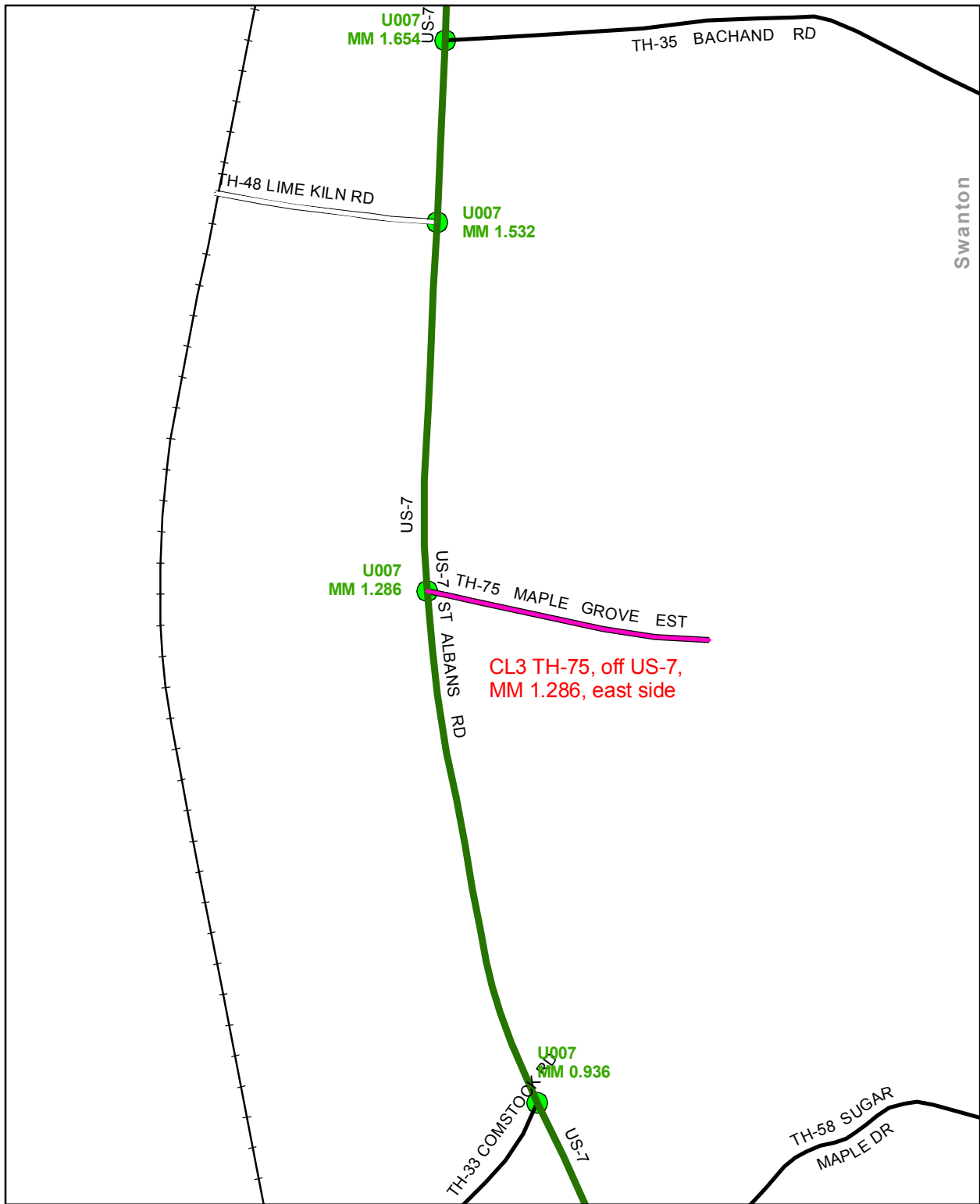

Mileage Certificate Change 2007 -- SWANTON

Mapping Unit
 Policy & Planning Division
 Vermont Agency of Transportation -- April 2007



0 0.1 Miles

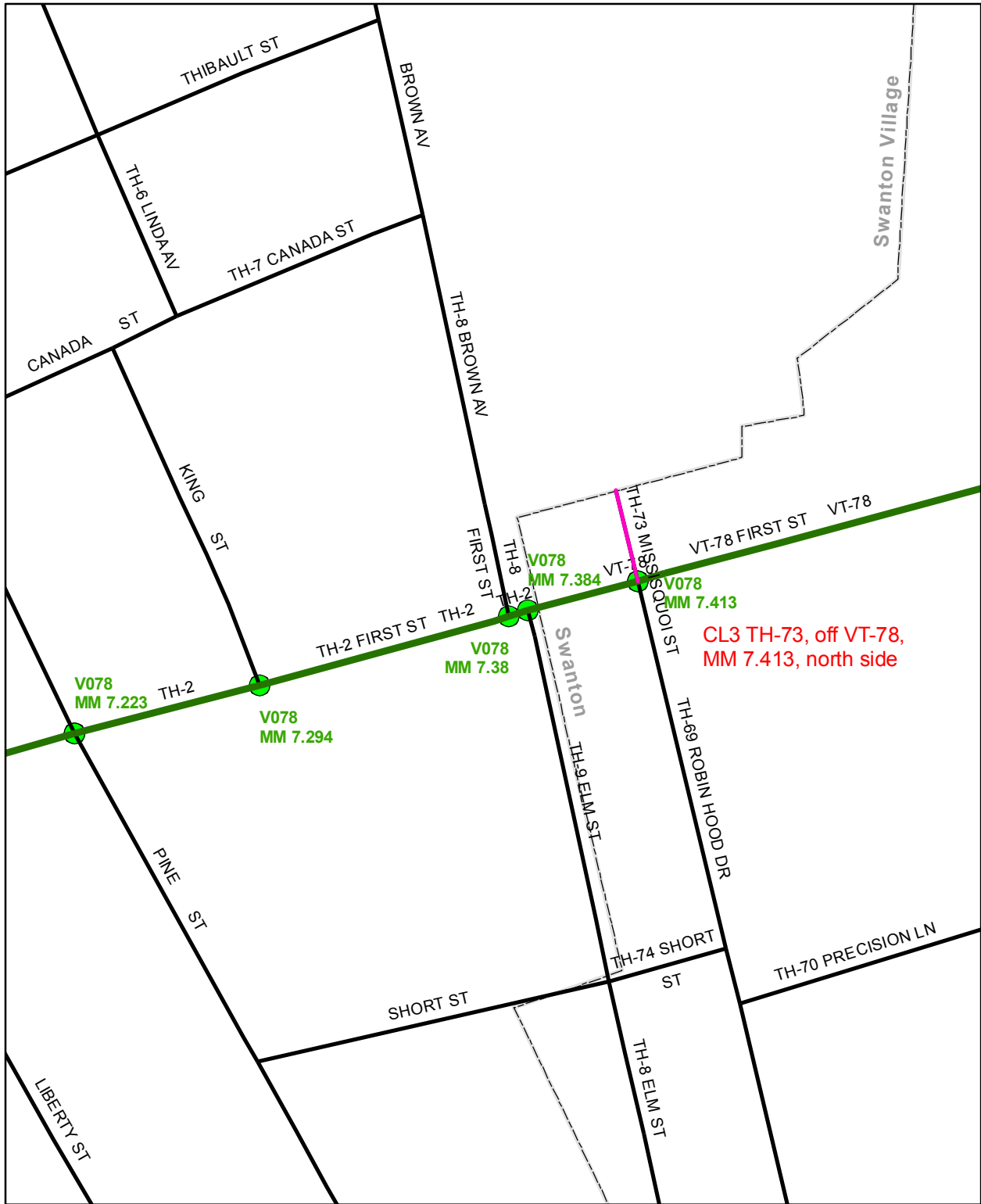

Mileage Certificate Change 2007 -- SWANTON

Mapping Unit
 Policy & Planning Division
 Vermont Agency of Transportation -- April 2007



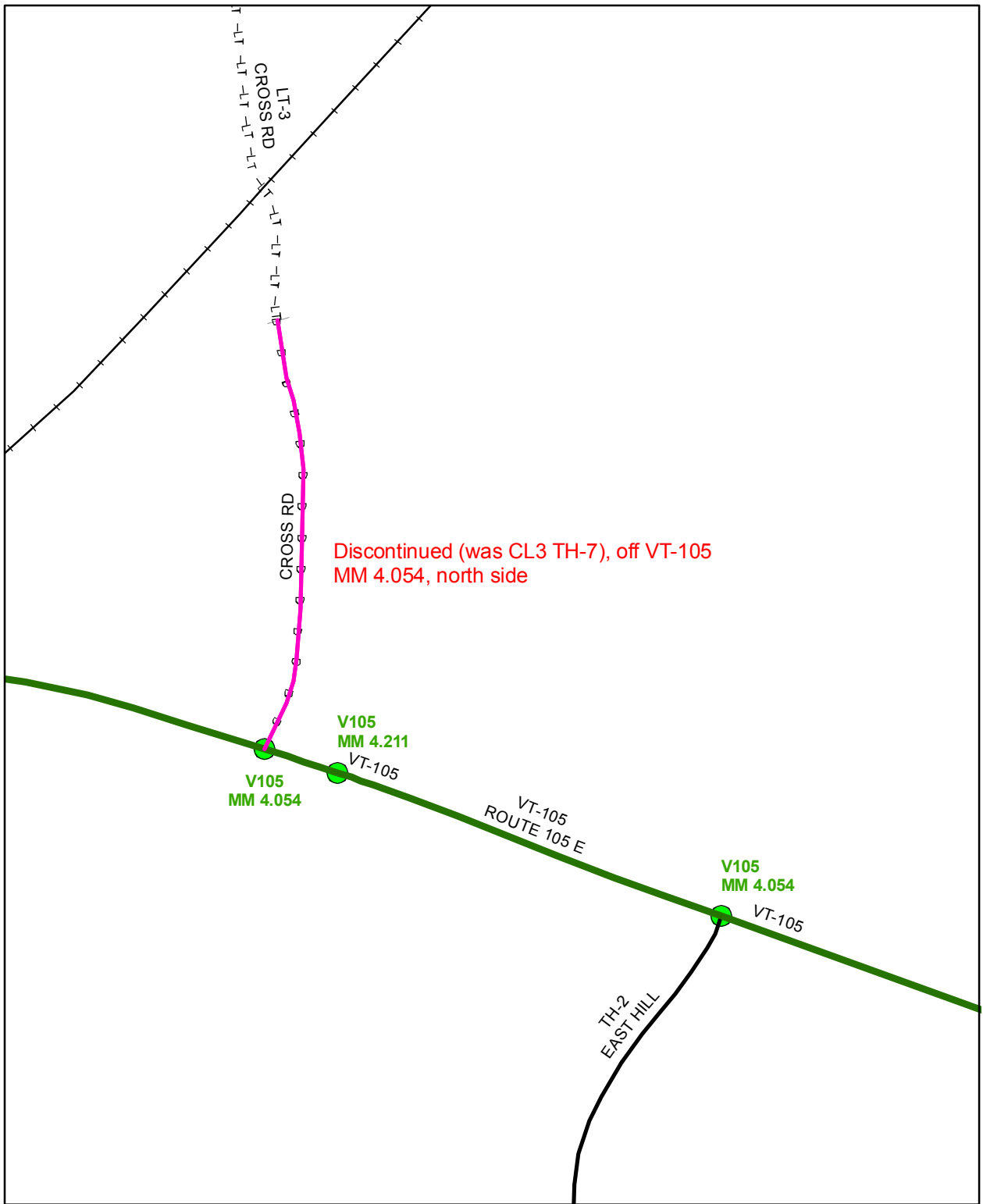

Discontinued (was CL3 TH-7), off VT-105
MM 4.054, north side

V105
MM 4.211
VT-105
V105
MM 4.054

VT-105
ROUTE 105 E

V105
MM 4.054
VT-105

TH-2
EAST HILL

Mileage Certificate Change 2007 -- TROY

Mapping Unit
Policy & Planning Division
Vermont Agency of Transportation -- April 2007

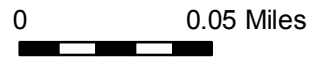

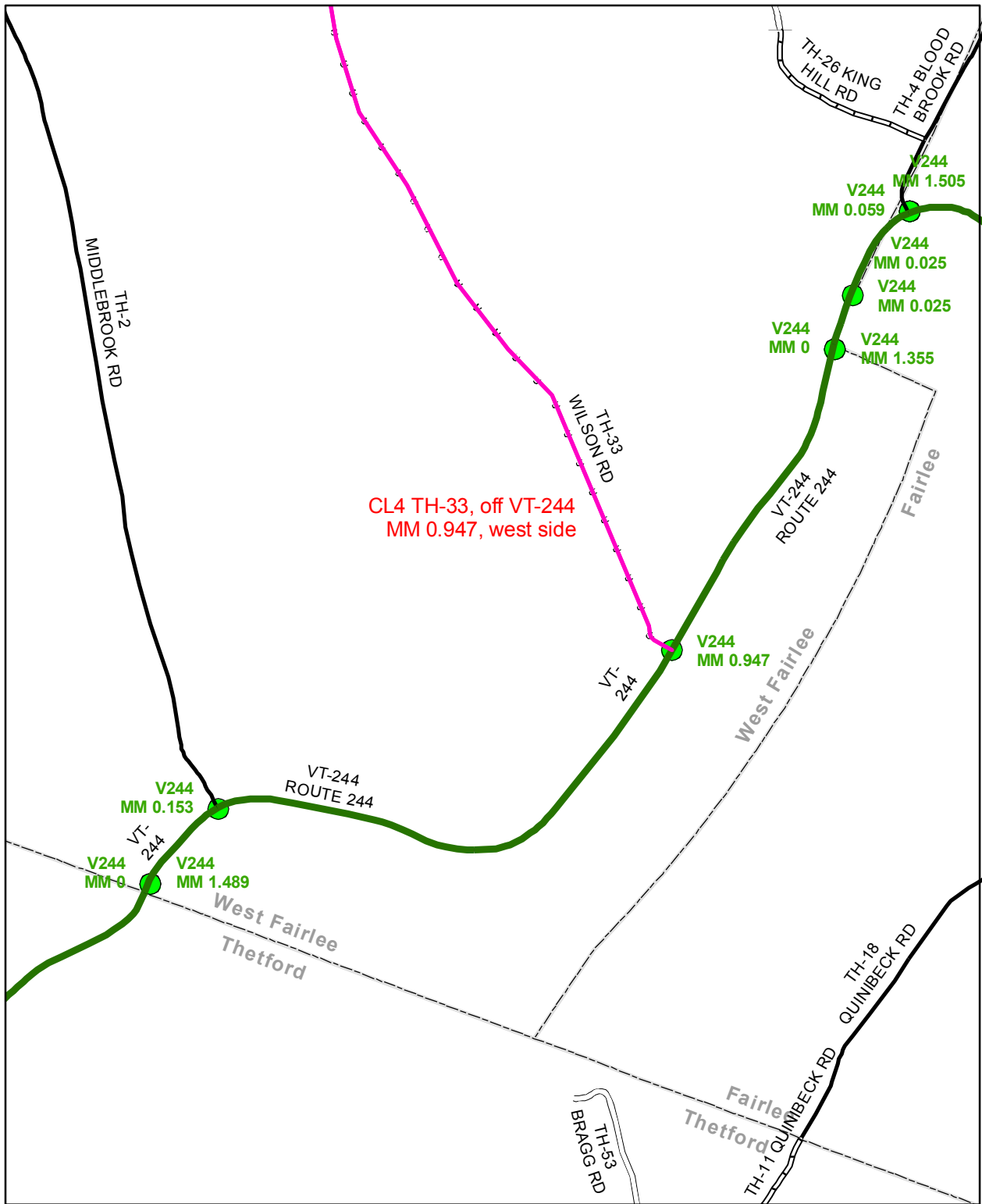

Mileage Certificate Change 2007 -- WEST FAIRLEE

Mapping Unit
 Policy & Planning Division
 Vermont Agency of Transportation -- April 2007



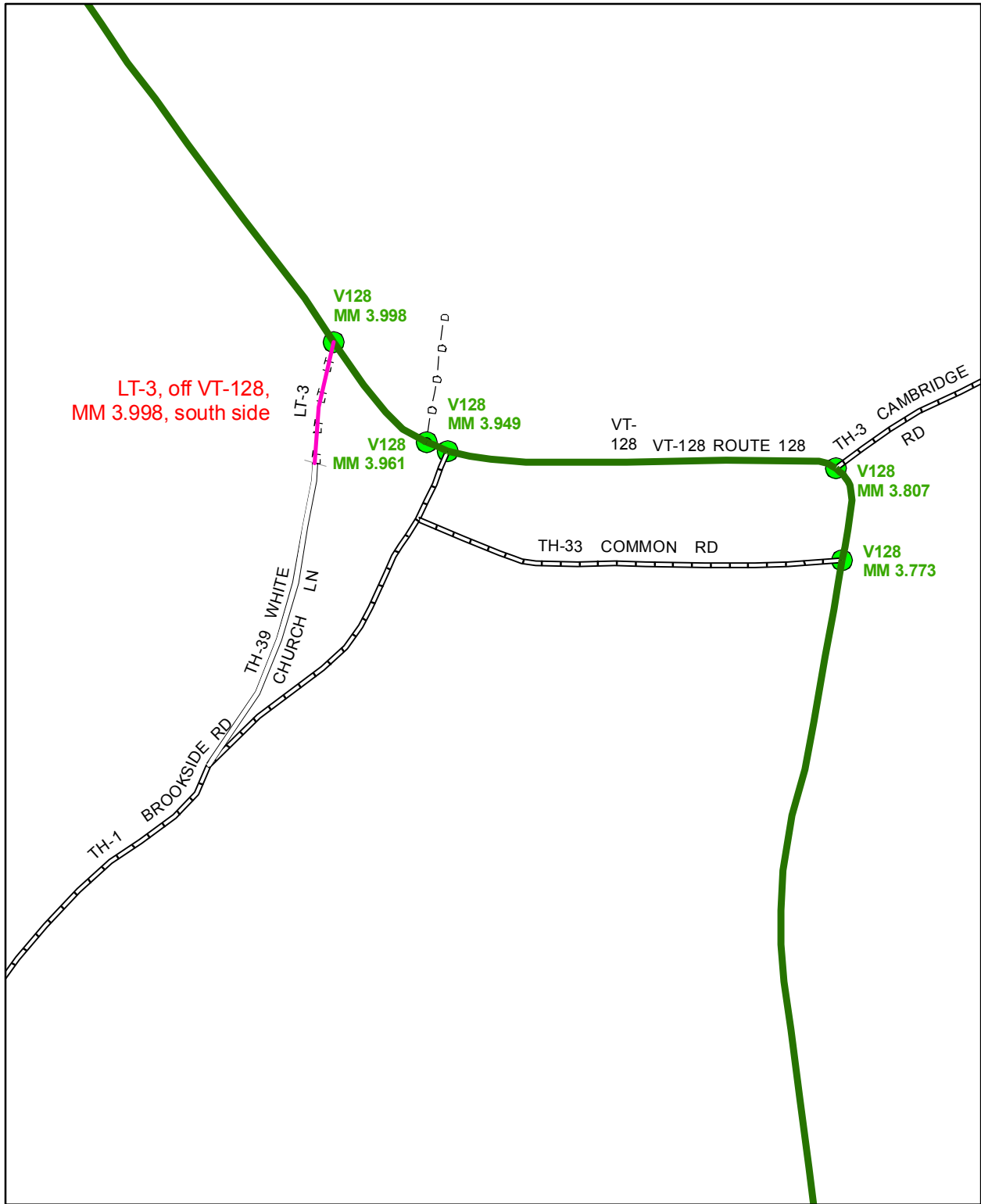

Mileage Certificate Change 2007 -- WESTFORD

Mapping Unit
 Policy & Planning Division
 Vermont Agency of Transportation -- April 2007



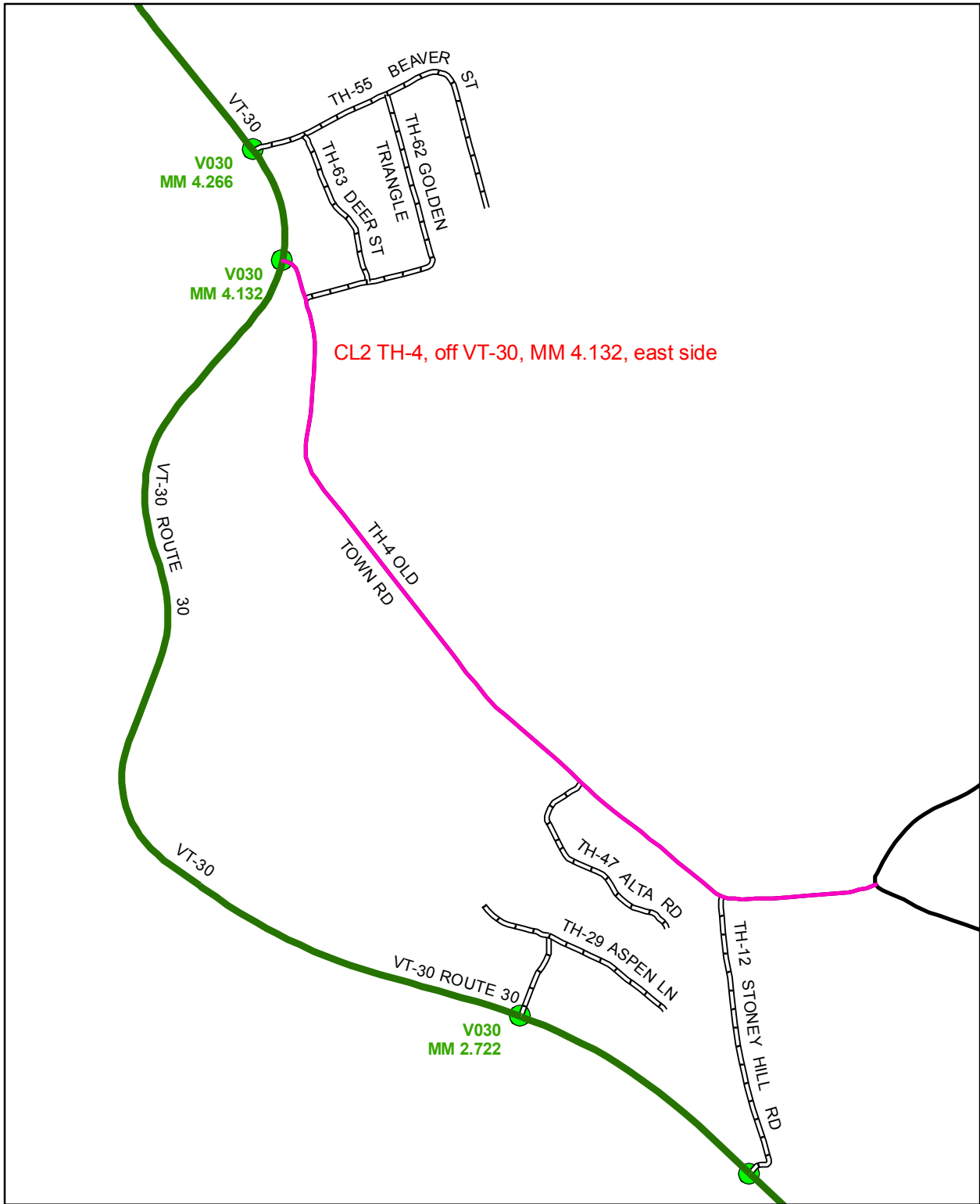

Mileage Certificate Change 2007 -- WINHALL

Mapping Unit
 Policy & Planning Division
 Vermont Agency of Transportation -- April 2007



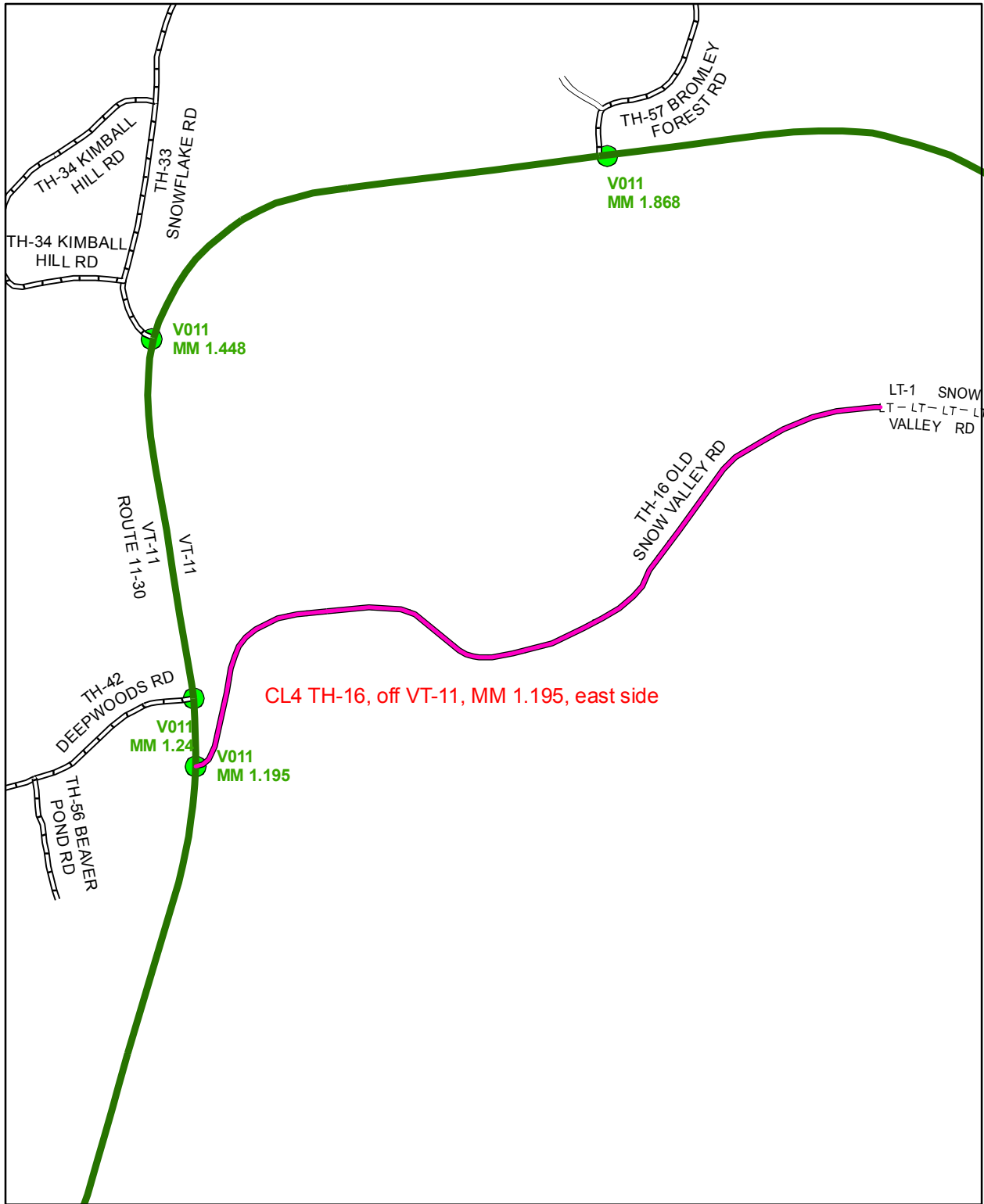

Mileage Certificate Change 2007 -- WINHALL

Mapping Unit
 Policy & Planning Division
 Vermont Agency of Transportation -- April 2007



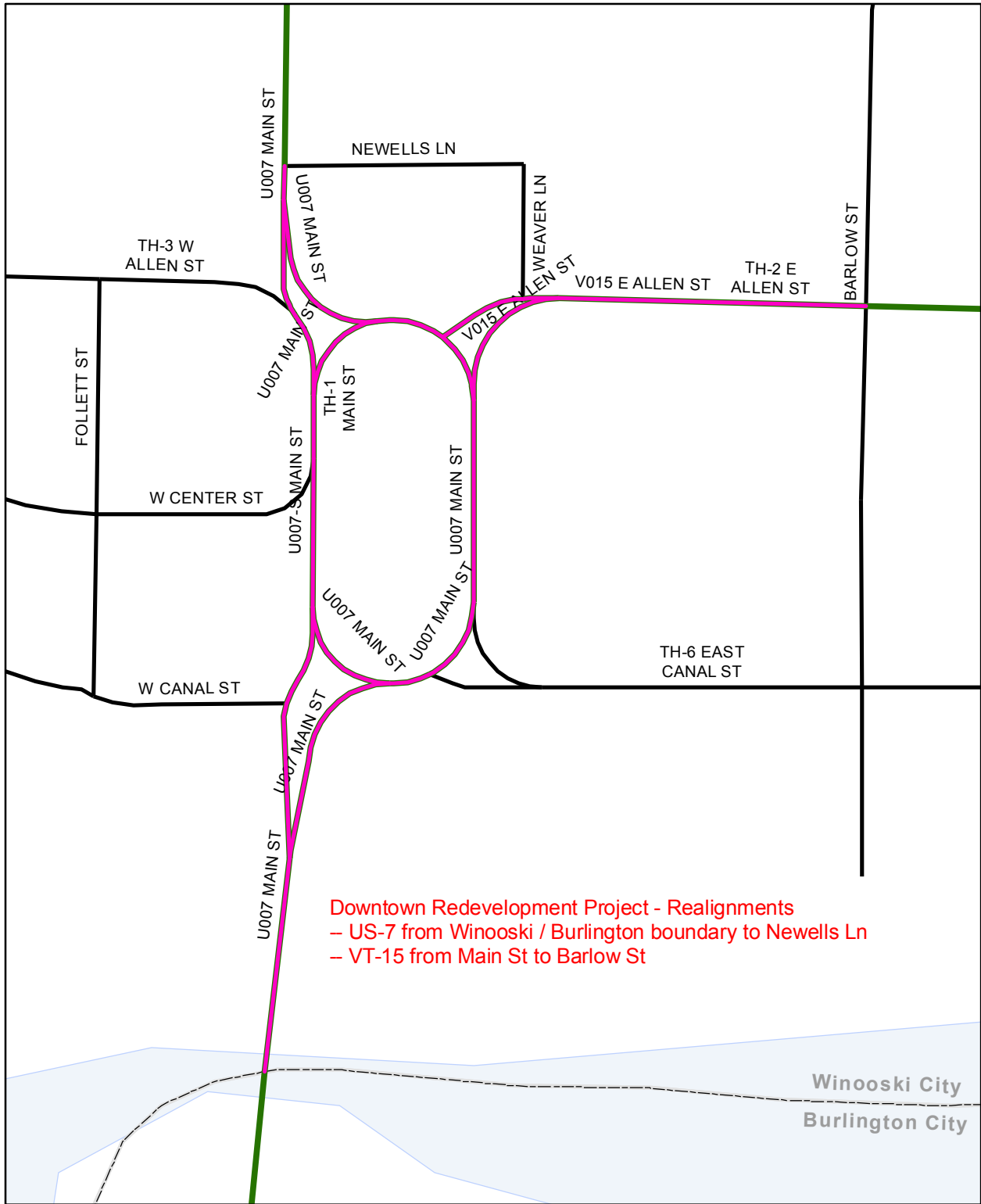

Mileage Certificate Change 2007 -- WINOOSKI

Mapping Unit
Policy & Planning Division
Vermont Agency of Transportation -- April 2007



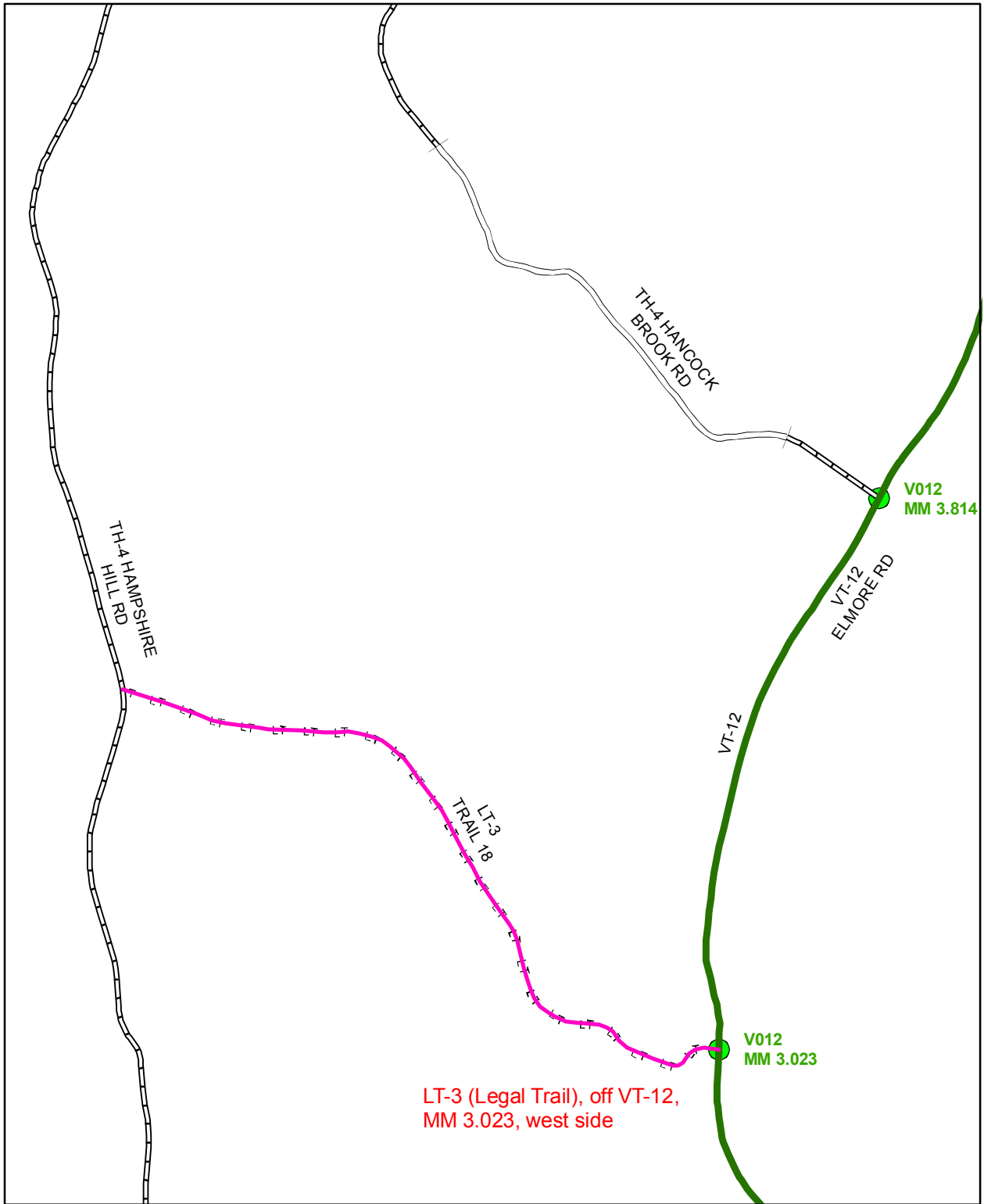

Mileage Certificate Change 2007 -- WORCESTER

Mapping Unit
 Policy & Planning Division
 Vermont Agency of Transportation -- April 2007



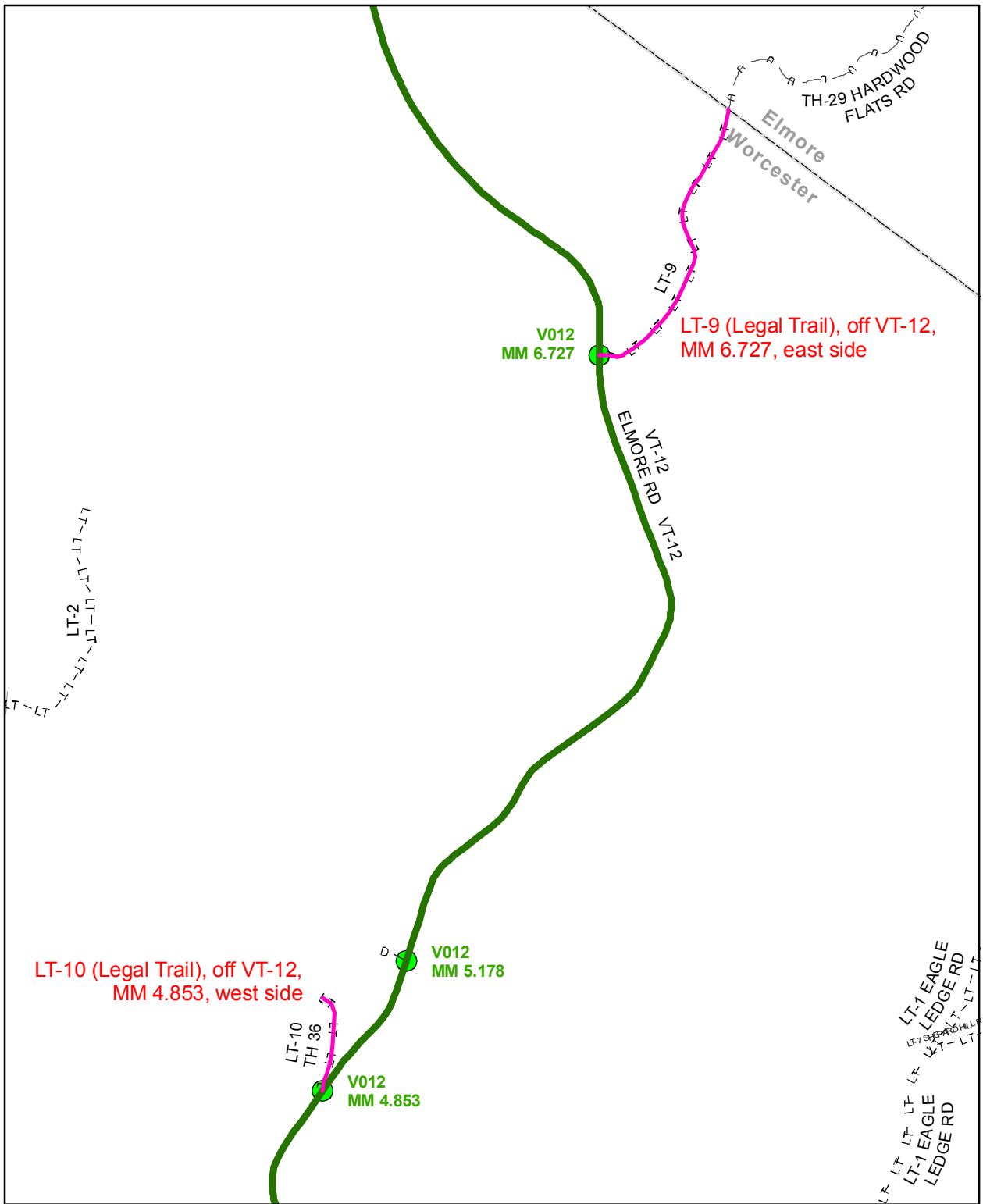

Mileage Certificate Change 2007 -- WORCESTER

Mapping Unit
 Policy & Planning Division
 Vermont Agency of Transportation -- April 2007

