

CERTIFICATE OF HIGHWAY MILEAGE

YEAR ENDING FEBRUARY 10, 2006

Amended

Fill out form, make and file copy with the Town Clerk, and mail ORIGINAL, before February 20, 2006 to: VT Agency of Transportation, Program Development Division, Drawer 33, Montpelier, VT 05633.

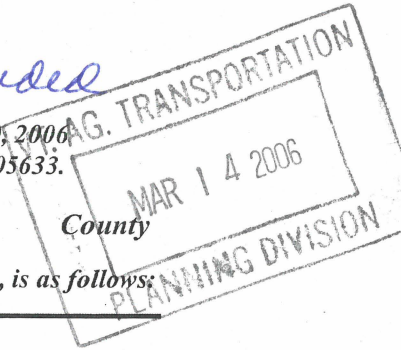

We, the Selectmen or Aldermen or Trustees of WOODSTOCK in WINDSOR County

on an oath state that the mileage of highways, according to Title 19, V.S.A, Sec #305, added 1985, is as follows:

PART I - CHANGES TOTALS - Please fill in and calculate totals.

Town Highways	Previous Mileage	Added Mileage	Subtracted Mileage	Total	Scenic Highways
Class 1	0.000				0.000
* Class 1 Lane	0.000				
Class 2	7.390				0.000
Class 3	62.620				1.490
State Highway	17.925				0.000
* Class 4	13.710	1.0		14.71	0.000
Total	87.935				1.490

* Class 1 Lane Mileage and Class 4 is NOT included in total.

PART II - INFORMATION AND DESCRIPTION OF CHANGES SHOWN ABOVE.

- NEW HIGHWAYS: Please attach Selectmen's "Certificate of Completion and Opening".
 TH 119 SCHOOL HOUSE RD. 0.90 m: (CLASS IV)
 TH 120 VONDELK RD 0.10 m: (CLASS IV)

ADD EXISTING ROAD TO MAP

2. DISCONTINUED: Please attach SIGNED copy of proceedings (minutes of meeting).

3. RECLASSIFIED/REMEASURED: Please attach SIGNED copy of proceedings (minutes of meeting).

4. SCENIC HIGHWAYS: Please attach a copy of order designating/discontinuing Scenic Highways.

IF THERE ARE NO CHANGES IN MILEAGE: Check box and sign below. []

PART III - SIGNATURES - PLEASE SIGN.

Selectmen/ Aldermen/ Trustees Signatures:

Handwritten signatures of selectmen/aldermen/trustees.

Clerk Signature:

Handwritten signature of the clerk.

Date Filed:

MARCH 7, 2006

Please sign ORIGINAL and return it for Transportation signature.

AGENCY OF TRANSPORTATION APPROVAL: Signed copy will be returned to T/C/V Clerk.

APPROVED:

Signature and name of Johnathan Croft, Representative, Agency of Transportation.

DATE:

4/11/2006

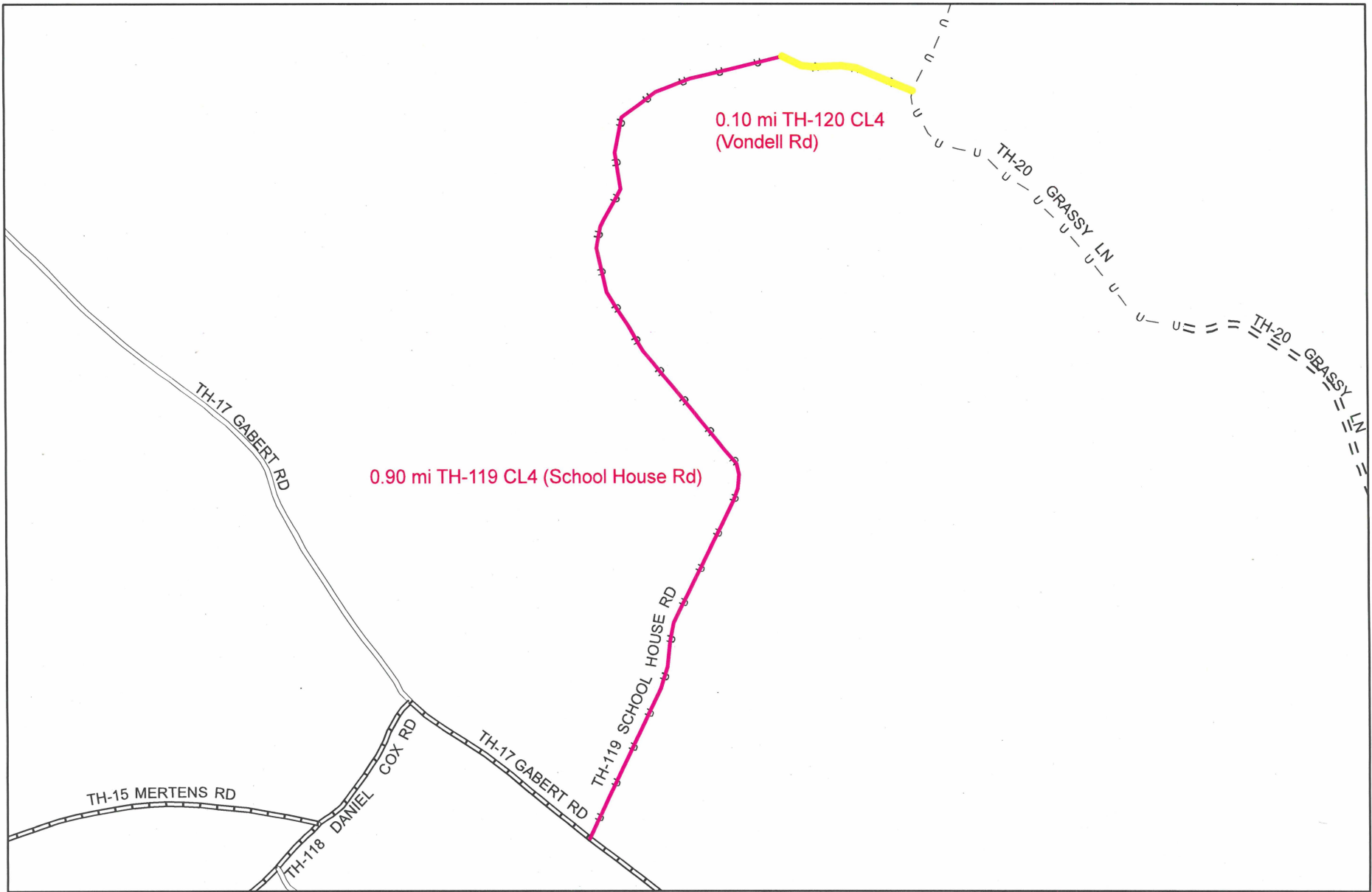

0.10 mi TH-120 CL4
(Vondell Rd)

0.90 mi TH-119 CL4 (School House Rd)

Mileage Certificate Change 2006 -- WOODSTOCK

Mapping Unit
Policy & Planning Division
Vermont Agency of Transportation -- March 2006

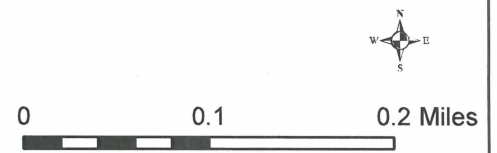

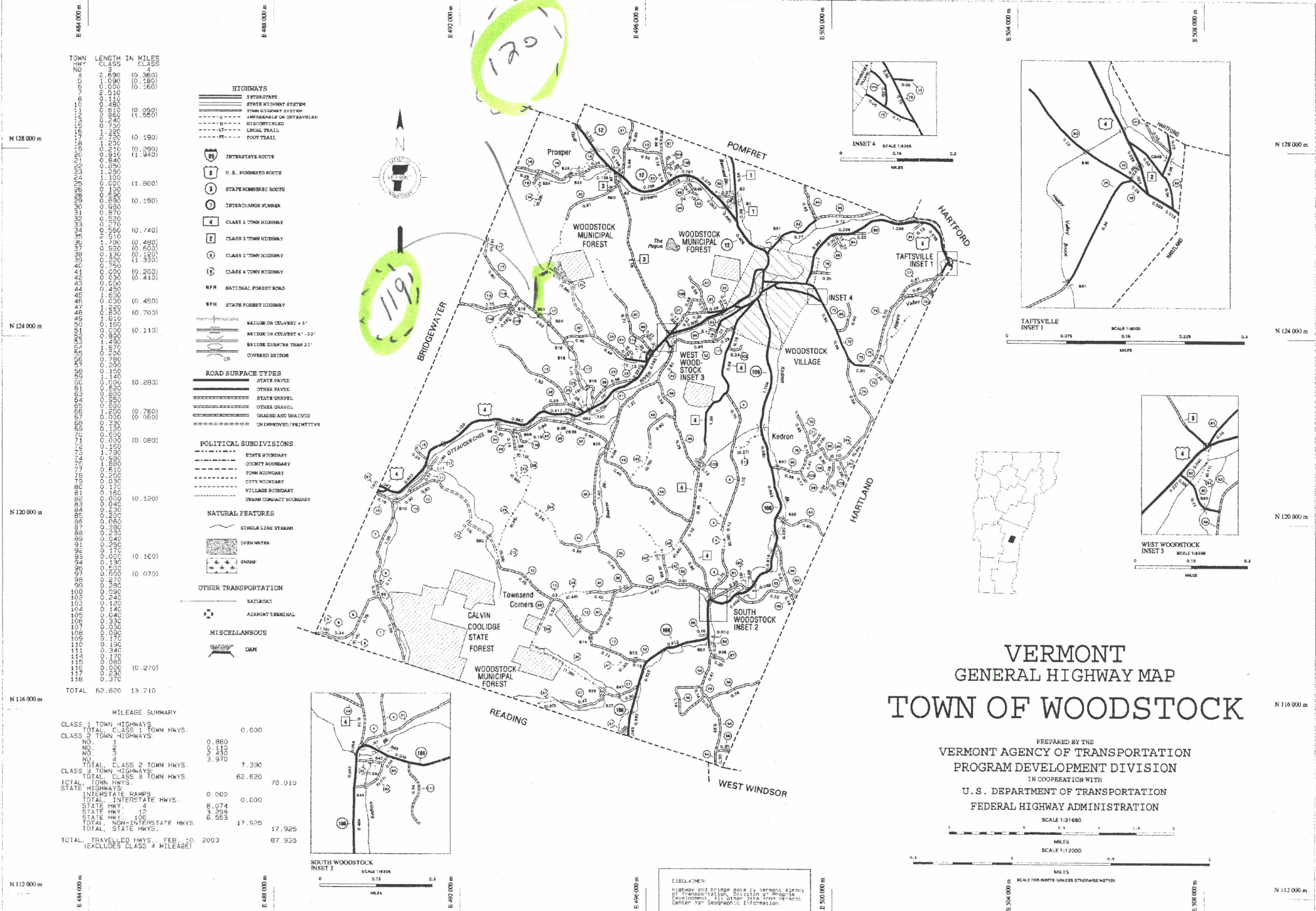

TOWN CLASS	LENGTH IN MILES
CLASS 1	0.360
CLASS 2	0.480
CLASS 3	0.160
TOTAL CLASS 1, 2, 3 TOWN HWYS.	1.000
CLASS 4	0.740
TOTAL CLASS 4 TOWN HWYS.	0.740
STATE HWYS.	0.620
TOTAL STATE HWYS.	0.620
INTERSTATE HWYS.	0.000
TOTAL INTERSTATE HWYS.	0.000
TOTAL TRAVELLED HWYS., FEB. 10, 2003 (EXCLUDES CLASS 4 MILEAGE)	2.360

- HIGHWAYS**
 - INTERSTATE
 - STATE HIGHWAY SYSTEM
 - TOWN LEGISLATIVE SYSTEM
 - ADVISORY OR UNTRAVELED
 - DISCONTINUED
 - LOCAL TRAIL
 - FOOT TRAIL
- INTERSTATE ROUTE** (I-88)
- U.S. NUMBERED ROUTE** (U.S. 4)
- STATE NUMBERED ROUTE** (VT 100, 102, 104, 106, 108, 110, 112, 114, 116, 118, 120, 122, 124, 126, 128, 130, 132, 134, 136, 138, 140, 142, 144, 146, 148, 150, 152, 154, 156, 158, 160, 162, 164, 166, 168, 170, 172, 174, 176, 178, 180, 182, 184, 186, 188, 190, 192, 194, 196, 198, 200, 202, 204, 206, 208, 210, 212, 214, 216, 218, 220, 222, 224, 226, 228, 230, 232, 234, 236, 238, 240, 242, 244, 246, 248, 250, 252, 254, 256, 258, 260, 262, 264, 266, 268, 270, 272, 274, 276, 278, 280, 282, 284, 286, 288, 290, 292, 294, 296, 298, 300, 302, 304, 306, 308, 310, 312, 314, 316, 318, 320, 322, 324, 326, 328, 330, 332, 334, 336, 338, 340, 342, 344, 346, 348, 350, 352, 354, 356, 358, 360, 362, 364, 366, 368, 370, 372, 374, 376, 378, 380, 382, 384, 386, 388, 390, 392, 394, 396, 398, 400, 402, 404, 406, 408, 410, 412, 414, 416, 418, 420, 422, 424, 426, 428, 430, 432, 434, 436, 438, 440, 442, 444, 446, 448, 450, 452, 454, 456, 458, 460, 462, 464, 466, 468, 470, 472, 474, 476, 478, 480, 482, 484, 486, 488, 490, 492, 494, 496, 498, 500, 502, 504, 506, 508, 510, 512, 514, 516, 518, 520, 522, 524, 526, 528, 530, 532, 534, 536, 538, 540, 542, 544, 546, 548, 550, 552, 554, 556, 558, 560, 562, 564, 566, 568, 570, 572, 574, 576, 578, 580, 582, 584, 586, 588, 590, 592, 594, 596, 598, 600, 602, 604, 606, 608, 610, 612, 614, 616, 618, 620, 622, 624, 626, 628, 630, 632, 634, 636, 638, 640, 642, 644, 646, 648, 650, 652, 654, 656, 658, 660, 662, 664, 666, 668, 670, 672, 674, 676, 678, 680, 682, 684, 686, 688, 690, 692, 694, 696, 698, 700, 702, 704, 706, 708, 710, 712, 714, 716, 718, 720, 722, 724, 726, 728, 730, 732, 734, 736, 738, 740, 742, 744, 746, 748, 750, 752, 754, 756, 758, 760, 762, 764, 766, 768, 770, 772, 774, 776, 778, 780, 782, 784, 786, 788, 790, 792, 794, 796, 798, 800, 802, 804, 806, 808, 810, 812, 814, 816, 818, 820, 822, 824, 826, 828, 830, 832, 834, 836, 838, 840, 842, 844, 846, 848, 850, 852, 854, 856, 858, 860, 862, 864, 866, 868, 870, 872, 874, 876, 878, 880, 882, 884, 886, 888, 890, 892, 894, 896, 898, 900, 902, 904, 906, 908, 910, 912, 914, 916, 918, 920, 922, 924, 926, 928, 930, 932, 934, 936, 938, 940, 942, 944, 946, 948, 950, 952, 954, 956, 958, 960, 962, 964, 966, 968, 970, 972, 974, 976, 978, 980, 982, 984, 986, 988, 990, 992, 994, 996, 998, 1000
- NATIONAL FOREST ROAD** (NFR)
- STATE FOREST HIGHWAY** (SFH)
- BRIDGE ON CULVERT 4'-6"**
- BRIDGE ON CULVERT 6'-20"**
- BRIDGE OVER 20' FEET**
- COVERED BRIDGE**

- ROAD SURFACE TYPES**
 - STATE PAVED
 - OTHER PAVED
 - STATE GRAVEL
 - OTHER GRAVEL
 - GRADED AND DRAINED
 - UNIMPROVED/PRIMITIVE

- POLITICAL SUBDIVISIONS**
 - STATE BOUNDARY
 - COUNTY BOUNDARY
 - TOWN BOUNDARY
 - CITY BOUNDARY
 - VILLAGE BOUNDARY
 - URBAN CONTACT BOUNDARY

- NATURAL FEATURES**
 - SINGLE LINE STREAM
 - OPEN WATER
 - SNOW

- OTHER TRANSPORTATION**
 - RAILROAD
 - AIRPORT TERMINAL

- MISCELLANEOUS**
 - DAM

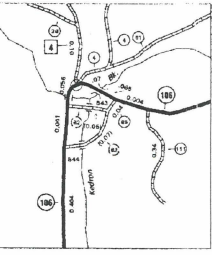

SOUTH WOODSTOCK INSET 2 SCALE 1:6250

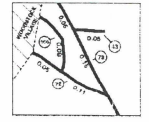

INSET 4 SCALE 1:6250

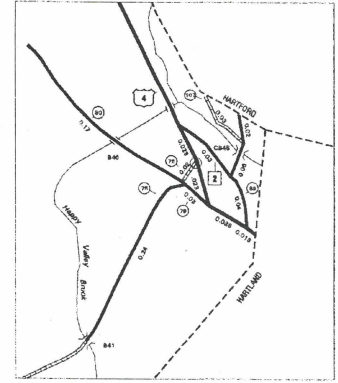

TAFTSVILLE INSET 1 SCALE 1:6250

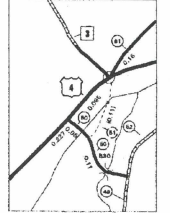

WEST WOODSTOCK INSET 3 SCALE 1:6250

VERMONT GENERAL HIGHWAY MAP

TOWN OF WOODSTOCK

PREPARED BY THE
 VERMONT AGENCY OF TRANSPORTATION
 PROGRAM DEVELOPMENT DIVISION
 IN COOPERATION WITH
 U.S. DEPARTMENT OF TRANSPORTATION
 FEDERAL HIGHWAY ADMINISTRATION

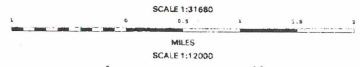

LEGEND:
 Highway and bridge data by Vermont Agency of Transportation, Division of Program Development, unless otherwise noted. Center for Geographic Information.



Woodstock, Vermont *The Shire Town of Windsor County*

TOWN-VILLAGE MANAGER GOVERNMENT

Town Hall • P.O. Box 488 • Woodstock, Vermont 05091 • 802/457-3456

September 9, 2005

Mr. Jonathan Croft
Vtrans
National Life Building
Drawer 33
Montpelier, VT 05633

Dear Mr. Croft:

I am writing to request that you add two roads to the official Town of Woodstock Highway Map.

Add School House Rd TH 119
Add Vondell Brook Rd. TH 120

Enclosed is a discontinuance hearing regarding the School House road. The road was not discontinued.

Therefore it is a town highway and should be on our official town highway map.

Enclosed is a copy of the town's map on which I have drawn on these two roads.

If you have any questions regarding this matter, please contact me at your convenience.

Sincerely,

Philip B. Swanson
Municipal Manager

PBS/mr



State of Vermont
County of Windsor
Town of Woodstock

**REPORT OF HEARING REGARDING
DISCONTINUANCE OF HIGHWAYS
OF AN OLD TOWN HIGHWAY OF NO NAME OR NUMBER**

Description of Road: Beginning at the intersection of TH 17 and the driveway of Charles Wright and extending easterly to Grassy Lane TH 20; traveling through lands owned by the Woodstock Aqueduct Co. The home of Charles Wright is former School No. 2 located on Gabert Rd.

WHEREAS at Woodstock on the 26th day of April, 2005 the Selectmen of the Town of Woodstock did give public notice that they had scheduled a public hearing for June 7th, 2005 at 7:00 P.M. to consider discontinuing the following described section of road:

Beginning at the intersection of TH 17 and the driveway of Charles Wright and extending easterly to Grassy Lane TH 20; traveling through lands owned by R. Richardson, Trustee and the Woodstock Aqueduct Co. The home of Charles Wright is former School No. 2 located on Gabert Rd.

WHEREUPON the said Selectmen did order and appoint that on the 7th day of June 2005 at 7:00 PM, Eastern Daylight Savings Time, they would conduct a site inspection at the intersection of the driveway of Charles Wright and Gabert Road. TH 17. Following this site visit, they would meet in their office at the Town Hall, to conduct a public hearing and hear the parties interested. They did give notice hereof in the Vermont Standard on May 5, 2005, mailing a copy of the notice to adjoining landowners, posting at the Town Clerk's office and giving a copy to the Planning Commission of said town and mailing a copy to the Commissioner of Forests & Parks.

ON the seventh day of June 2005, the Selectmen, to wit, Matthew Maxham, John D. Doten, Jr. and John Wetmore Bruce Gould and Preston Bristow held said site inspection, there also appeared Philip Swanson municipal manager, Charles Wright, Paul Gillies,, Richardson brothers and their attorney Jack Candon, Gordon Tuttle, Byron K. Kelly Sr., Lea Kachadorian, Harold Eaton, Paul Kendall, Jay Morgan Town Clerk.

SITE VISIT Charles Wright reviewed the property boundary, limits of the right of way and noted that the right of way runs through the house. He also stated that he believes the Selectmen intended to discontinue the road when they sold the property to his uncle Mr. Rutherford.

Mr. Kelly state that officially the road was never discontinued and is therefore a public highway.

TESTIMONY Charles Wright stated that he believes the language of the deed between the Town and his uncle Mr. Rutherford included the road and that therefore the Select Board has a duty to discontinue it.

Mr. Kelly read from the deed that states the property sold by the Town and now owned by Mr. Wright is bounded by two roads, one of them being this road in question.

Mr. Candon attorney for the Richardson Trust say that his client supports discontinuing the road.

Mr. Debevoise remembers when the garage was built and his father sputtering about it. He remembers that the neighborhood didn't fight the owner who built the garage, but wasn't very happy about the access being restricted. He sympathizes with Skip but believes the town needs to maintain its right of way.

Lea Kachadorian spoke about the need to restrict motor vehicles on this road because of danger to the wetlands and the town's water supply. She believes the right of way should be maintained by the Town, and motor vehicles restricted from using it.

Mr. Swanson stated that he received comments from the Woodstock Aqueduct, the Billings family and Tom Weschler who support discontinuing the road.

Motion of Mr. Maxham seconded by Mr. Gould Selectmen voted to close testimony

AFTER all testimony was received the Board of Selectmen voted to close testimony and deliberate the matter at a later time.

Deliberations June 21`

Preston Bristow recused himself from the decision because his firm is actively working to sell the Richardson property which is an abutter.

Bruce Gould stated that he thought that according to the Town's ordinance and in consideration of the fact that the road does connect two roads it would not be in the best interest of the Town of Woodstock to discontinue this road.

It was questioned if the road could remain a road, and the width narrowed to keep the house out of the highway right of way.

Lee Kachadorian spoke about the need to restrict motor vehicles on this road because of danger to the wetlands and the town's water supply. She believes the right of way should be maintained by the Town, and motor vehicles restricted from using it.

Paul Gillies stated that even if the Selectmen do discontinue the road, all property owners presently served by this road, continue to have a perpetual right of way across this road, that runs with their land.

Bob Holt suggested that if half of the right of way be discontinued, then Mr. Wright could have his house entirely on his own land.

It was said that the Select Board could encourage the Richardson bothers to cooperate with the Town of Woodstock by assisting Mr. Wright in acquiring a small amount of their land so that the town highway can be relocated. This would put the Town Highway on the land that people are using now and have been using for period of at least fifteen years.

Mr. Gillies stated that the fact that the public has been enjoying a crossing over this land of the Richardsons for more than fifteen years and may have earned prescriptive rights to continue to travel over this path.

The selectmen asked the town manager to contact the Richardson's and ask them if they would please cooperate with Mr. Wright and the Town and sell some land so that the road could be relocated. The Selectmen also asked the town manager to obtain an opinion as to discontinuing a portion of the road width and leaving a rod and a half of road width for public travel.

Mr. Gould made a motion to recess the hearing until a later date and time.

Deliberations August 2, 2005

Philip Swanson distributed copies of correspondence received from: VLCT staff attorney, who reports that the select board could narrow the width of a road if it followed the procedures laid out in statute, John Candon attorney for Richardson Trust Tom Richardson who reported that he is not interested in selling any land to Mr. Wright,, and Byron Kelly Sr. Who wishes the road to remain as is.

Bruce Gould stated that he thought that according to the Town's ordinance and in consideration of the fact that the road does connect two roads it would not be in the best interest of the Town of Woodstock to discontinue this road.

Matt Maxham stated that he believes the road should remain open to motor vehicle traffic because it is a road, and that is what roads are for.

Mr. Wetmore stated that it is in the town's best interest to retain the highway for future generations.

Motion was made by Bruce Gould seconded by John Wetmore to discontinue the road.

No votes in favor of this motion were recorded.

Four Negative votes were recorded .

Road remains a road.

DATED at Woodstock, Vermont in the County of Windsor and State of Vermont on the 23 day of August, 2005

Philip B. Swanson
Philip B. Swanson
Witness for all

Matthew S. Maxham
Matthew S. Maxham, Chair
John D. Doten, Jr.
John D. Doten, Jr.
Bruce C. Gould
Bruce C. Gould

John H. Wetmore
John H. Wetmore

WOODSTOCK, VT TOWN CLERK'S OFFICE
RECEIVED FOR RECORD

August 24 A.D. 20 05
at 9 o'clock 30 minutes A M
and recorded in Book ROADS Page 157-159
Attest: [Signature]
Town Clerk

Resolution
Naming TH 119 the School House Road
Creating a Section of this Road as a Pent Road

Be it resolved by the Board of Selectmen of the Town of Woodstock that the Class IV road between Gabert Road and Vondell Brook Road shall be known as the School House Road TH 119.

Pursuant to the authority contained in V.S.A. Title 19 section 304 (a) (5) the Board of Selectmen grant permission to Charles H. Wright to enclose with an unlocked gate the aforesaid School House Rd. at a location determined to be approximately 200 ft. north easterly of the intersection of this road with the said Gabert Road.

The Pent Road created by the unlocked gate is limited to the road between the gate and the said Gabert Road.

The speed limit over this Pent Road is 5 mph.

This action does not affect any of the School House Road located easterly of the unlocked gate.

This document to be recorded in the Highway Records of the Town of Woodstock.

Date: SEPTEMBER 6, 2005

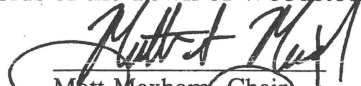
Matt Maxham, Chair



Preston Bristow

John Doten

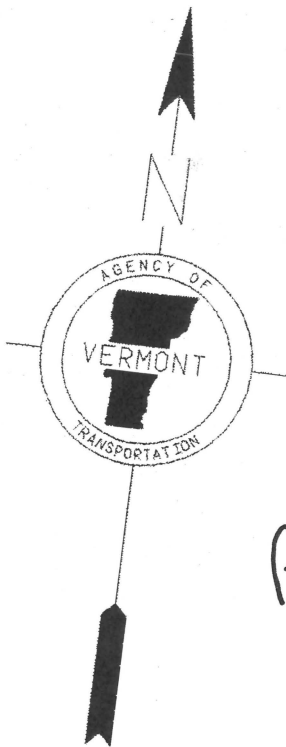

Bruce Gould

John Wetmore

A D
VONDELL B.S.
CLASS IV

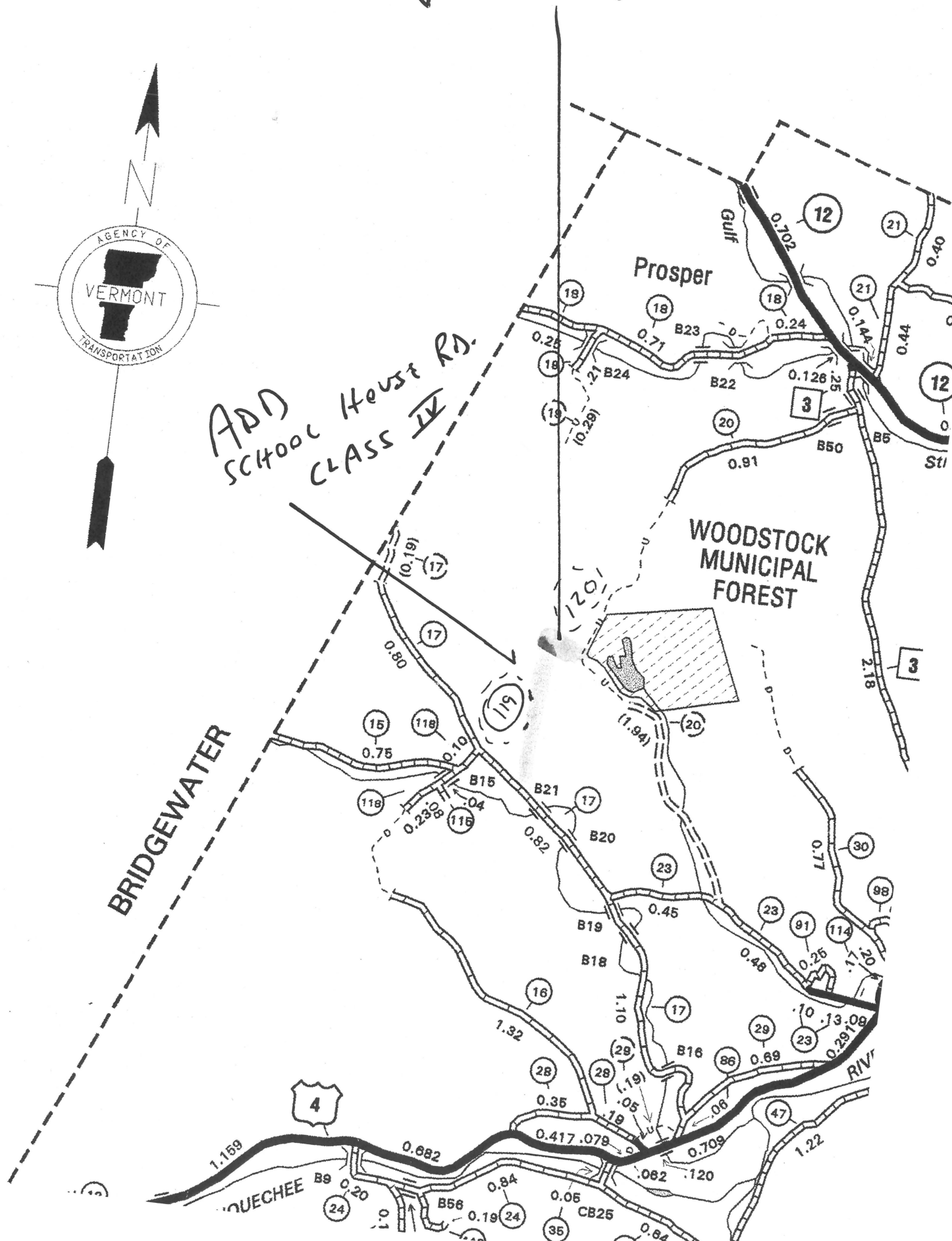

ADD
SCHOOL HOUSE RD.
CLASS IV



CERTIFICATE of COMPLETION and OPENING
of a HIGHWAY for PUBLIC TRAVEL

_____, Clerk of the _____ of _____,
(Clerk's Name) (City/Town/Village) (City/Town/Village)
_____, Vermont.
(City/Town/Village Name)

Pursuant to Title 19, V.S.A., Chapter 7, this is to certify that the following described section of
Class _____ Highway in the _____ of _____ was COMPLETED AND
(1,2,3 or 4) (City/Town/Village) (City/Town/Village Name)
OPENED FOR PUBLIC TRAVEL on _____,
(Month - Day) (Year)

DESCRIPTION OF RIGHT OF WAY: Beginning

TH 119 & TH 120

SEE SELECT BOARD MINUTES

and as shown on a Highway Map of the _____ of _____, dated
(City/Town/Village) (City/Town/Village Name)
_____, _____, and filed in Book _____ on page _____ of the Records of the
(Month - Day) (Year) (Book #) (Page #)
_____ of _____ by the _____ Clerk of said _____
(City/Town/Village) (City/Town/Village Name) (City/Town/Village) (City/Town/Village)
incorporated herein by reference and attested to on said map by said the _____ Clerk.
(City/Town/Village)

Dated at _____, County of _____ and State of Vermont,
(City/Town/Village Name) (County Name)
this _____ day of _____, A.D.,
(Date - Day) (Date - Month) (Date - Year)

BOARD
OF
SELECTMEN,
ALDERMAN,
or TRUSTEES

(Selectman/Alderman/Trustee Signature)

(Selectman/Alderman/Trustee Signature)

(Selectman/Alderman/Trustee Signature)

(Selectman/Alderman/Trustee Signature)

(Selectman/Alderman/Trustee Signature)

(Selectman/Alderman/Trustee Signature)

(Manager/Mayor Signature)
and the Manager/Mayor of the City/Town/Village of _____.
(City/Town/Village Name)

_____, VERMONT _____,
(City/Town/Village Name) (Month - Day) (Year)

THE ABOVE IS A TRUE COPY OF THE DESCRIPTION OF CLASS _____ HIGHWAY COMPLETED AND
(1,2,3 or 4)
OPENED FOR PUBLIC TRAVEL, RECORDED IN BOOK _____ ON PAGE _____ OF THE _____ RECORDS
(Book #) (Page #)
OF THE _____ OF _____ ON THE _____ DAY OF _____,
(City/Town/Village) (City/Town/Village Name) (Date - Day) (Date - Month)
_____, AT _____ O'CLOCK, _____ M.
(Date - Year) (Time) (A or P)

ATTEST: _____
(Clerk's Name)

(City/Town/Village) CLERK OF _____, VERMONT
(City/Town/Village Name)

CERTIFICATE OF HIGHWAY MILEAGE

YEAR ENDING FEBRUARY 10, 2006

Fill out form, make and file copy with the Town Clerk, and mail ORIGINAL, before February 20, 2006 to: VT Agency of Transportation, Program Development Division, Drawer 33, Montpelier, VT 05633.

We, the Selectmen or Aldermen or Trustees of WOODSTOCK in WINDSOR County

on an oath state that the mileage of highways, according to Title 19, V.S.A, Sec #305, added 1985, is as follows:

PART I - CHANGES TOTALS - Please fill in and calculate totals.

Table with 6 columns: Town Highways, Previous Mileage, Added Mileage, Subtracted Mileage, Total, Scenic Highways. Rows include Class 1, Class 1 Lane, Class 2, Class 3, State Highway, Class 4, and Total.

* Class 1 Lane Mileage and Class 4 is NOT included in total.

PART II - INFORMATION AND DESCRIPTION OF CHANGES SHOWN ABOVE.

- 1. NEW HIGHWAYS: Please attach Selectmen's "Certificate of Completion and Opening".
2. DISCONTINUED: Please attach SIGNED copy of proceedings (minutes of meeting).
3. RECLASSIFIED/REMEASURED: Please attach SIGNED copy of proceedings (minutes of meeting).
4. SCENIC HIGHWAYS: Please attach a copy of order designating/discontinuing Scenic Highways.

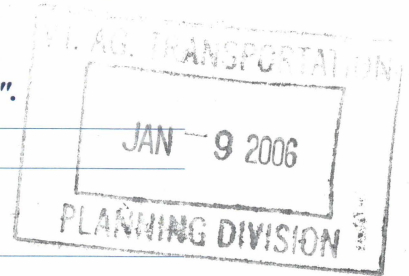

IF THERE ARE NO CHANGES IN MILEAGE: Check box and sign below. []

PART III - SIGNATURES - PLEASE SIGN.

Selectmen/ Aldermen/ Trustees Signatures:

Handwritten signatures of selectmen/aldermen/trustees.

Clerk Signature:

Handwritten signature of the clerk.

Date Filed:

JANUARY 5, 2006

Please sign ORIGINAL and return it for Transportation signature.

AGENCY OF TRANSPORTATION APPROVAL: Signed copy will be returned to T/C/V Clerk.

APPROVED:

Representative, Agency of Transportation

DATE:



State of Vermont
Agency of Transportation
National Life Building
Drawer 33
Montpelier, VT
05633-5001

VTrans *Working to Get You There*

February 24, 2006

Phil Swanson, Muncipal Manager
Town of Woodstock
31 The Green
Woodstock, VT 05091

Dear Mr. Swanson,

Please find enclosed the **2006 Certificate of Highway Mileage** for the Town of Woodstock, as per your request. I have included the original documentation sent with the certificate and copies of the information supplied during the summer related to sections of class 4 town highways.

Please feel free to contact me with any questions or comments; I can be reached at 802-828-2600 or via e-mail at johnathan.croft@state.vt.us

Sincerely,

A handwritten signature in black ink, appearing to read "Johnathan Croft".

Johnathan Croft
AOT GIS Database Administrator
VTrans Mapping Unit

JFC/jfc

Enclosures

www.aot.state.vt.us
Telecommunications Relay Service 1-800-253-0191

Vermont is an Equal Opportunity Employer



Woodstock, Vermont *The Shire Town of Windsor County*

TOWN-VILLAGE MANAGER GOVERNMENT

Town Hall • P.O. Box 488 • Woodstock, Vermont 05091 • 802/457-3456

September 9, 2005

Mr. Jonathan Croft
Vtrans
National Life Building
Drawer 33
Montpelier, VT 05633

Dear Mr. Croft:

I am writing to request that you add two roads to the official Town of Woodstock Highway Map.

Add School House Rd TH 119
Add Vondell Brook Rd. TH 120

Enclosed is a discontinuance hearing regarding the School House road. The road was not discontinued.

Therefore it is a town highway and should be on our official town highway map.

Enclosed is a copy of the town's map on which I have drawn on these two roads.

If you have any questions regarding this matter, please contact me at your convenience.

Sincerely,

Philip B. Swanson
Municipal Manager

PBS/mr



State of Vermont
County of Windsor
Town of Woodstock

**REPORT OF HEARING REGARDING
DISCONTINUANCE OF HIGHWAYS
OF AN OLD TOWN HIGHWAY OF NO NAME OR NUMBER**

Description of Road: Beginning at the intersection of TH 17 and the driveway of Charles Wright and extending easterly to Grassy Lane TH 20; traveling through lands owned by the Woodstock Aqueduct Co. The home of Charles Wright is former School No. 2 located on Gabert Rd.

WHEREAS at Woodstock on the 26th day of April, 2005 the Selectmen of the Town of Woodstock did give public notice that they had scheduled a public hearing for June 7th, 2005 at 7:00 P.M. to consider discontinuing the following described section of road:

Beginning at the intersection of TH 17 and the driveway of Charles Wright and extending easterly to Grassy Lane TH 20; traveling through lands owned by R. Richardson, Trustee and the Woodstock Aqueduct Co. The home of Charles Wright is former School No. 2 located on Gabert Rd.

WHEREUPON the said Selectmen did order and appoint that on the 7th day of June 2005 at 7:00 PM, Eastern Daylight Savings Time, they would conduct a site inspection at the intersection of the driveway of Charles Wright and Gabert Road. TH 17. Following this site visit, they would meet in their office at the Town Hall, to conduct a public hearing and hear the parties interested. They did give notice hereof in the Vermont Standard on May 5, 2005, mailing a copy of the notice to adjoining landowners, posting at the Town Clerk's office and giving a copy to the Planning Commission of said town and mailing a copy to the Commissioner of Forests & Parks.

ON the seventh day of June 2005, the Selectmen, to wit, Matthew Maxham, John D. Doten, Jr. and John Wetmore Bruce Gould and Preston Bristow held said site inspection, there also appeared Philip Swanson municipal manager, Charles Wright, Paul Gillies,, Richardson brothers and their attorney Jack Candon, Gordon Tuttle, Byron K. Kelly Sr., Lea Kachadorian, Harold Eaton, Paul Kendall, Jay Morgan Town Clerk.

SITE VISIT Charles Wright reviewed the property boundary, limits of the right of way and noted that the right of way runs through the house. He also stated that he believes the Selectmen intended to discontinue the road when they sold the property to his uncle Mr. Rutherford.

Mr. Kelly state that officially the road was never discontinued and is therefore a public highway.

TESTIMONY Charles Wright stated that he believes the language of the deed between the Town and his uncle Mr. Rutherford included the road and that therefore the Select Board has a duty to discontinue it.

Mr. Kelly read from the deed that states the property sold by the Town and now owned by Mr. Wright is bounded by two roads, one of them being this road in question.

Mr. Candon attorney for the Richardson Trust say that his client supports discontinuing the road.

Mr. Debevoise remembers when the garage was built and his father sputtering about it. He remembers that the neighborhood didn't fight the owner who built the garage, but wasn't very happy about the access being restricted. He sympathizes with Skip but believes the town needs to maintain its right of way.

Lea Kachadorian spoke about the need to restrict motor vehicles on this road because of danger to the wetlands and the town's water supply. She believes the right of way should be maintained by the Town, and motor vehicles restricted from using it.

Mr. Swanson stated that he received comments from the Woodstock Aqueduct, the Billings family and Tom Weschler who support discontinuing the road.

Motion of Mr. Maxham seconded by Mr. Gould Selectmen voted to close testimony

AFTER all testimony was received the Board of Selectmen voted to close testimony and deliberate the matter at a later time.

Deliberations June 21`

Preston Bristow recused himself from the decision because his firm is actively working to sell the Richardson property which is an abutter.

Bruce Gould stated that he thought that according to the Town's ordinance and in consideration of the fact that the road does connect two roads it would not be in the best interest of the Town of Woodstock to discontinue this road.

It was questioned if the road could remain a road, and the width narrowed to keep the house out of the highway right of way.

Lee Kachadorian spoke about the need to restrict motor vehicles on this road because of danger to the wetlands and the town's water supply. She believes the right of way should be maintained by the Town, and motor vehicles restricted from using it.

Paul Gillies stated that even if the Selectmen do discontinue the road, all property owners presently served by this road, continue to have a perpetual right of way across this road, that runs with their land.

Bob Holt suggested that if half of the right of way be discontinued, then Mr. Wright could have his house entirely on his own land.

It was said that the Select Board could encourage the Richardson bothers to cooperate with the Town of Woodstock by assisting Mr. Wright in acquiring a small amount of their land so that the town highway can be relocated. This would put the Town Highway on the land that people are using now and have been using for period of at least fifteen years.

Mr. Gillies stated that the fact that the public has been enjoying a crossing over this land of the Richardsons for more than fifteen years and may have earned prescriptive rights to continue to travel over this path.

The selectmen asked the town manager to contact the Richardson's and ask them if they would please cooperate with Mr. Wright and the Town and sell some land so that the road could be relocated. The Selectmen also asked the town manager to obtain an opinion as to discontinuing a portion of the road width and leaving a rod and a half of road width for public travel.

Mr. Gould made a motion to recess the hearing until a later date and time.

Deliberations August 2, 2005

Philip Swanson distributed copies of correspondence received from: VLCT staff attorney, who reports that the select board could narrow the width of a road if it followed the procedures laid out in statute, John Candon attorney for Richardson Trust Tom Richardson who reported that he is not interested in selling any land to Mr. Wright,, and Byron Kelly Sr. Who wishes the road to remain as is.

Bruce Gould stated that he thought that according to the Town's ordinance and in consideration of the fact that the road does connect two roads it would not be in the best interest of the Town of Woodstock to discontinue this road.

Matt Maxham stated that he believes the road should remain open to motor vehicle traffic because it is a road, and that is what roads are for.

Mr. Wetmore stated that it is in the town's best interest to retain the highway for future generations.

Motion was made by Bruce Gould seconded by John Wetmore to discontinue the road.

No votes in favor of this motion were recorded.

Four Negative votes were recorded .

Road remains a road.

DATED at Woodstock, Vermont in the County of Windsor and State of Vermont
on the 23 day of August, 2005

Philip B. Swanson
Philip B. Swanson
Witness for all

Matthew S. Maxham
Matthew S. Maxham, Chair
John D. Doten, Jr.
John D. Doten, Jr.
Bruce C. Gould
Bruce C. Gould

John H. Wetmore
John H. Wetmore

WOODSTOCK, VT TOWN CLERK'S OFFICE
RECEIVED FOR RECORD

August 24 A.D. 20 05
at 9 o'clock 30 minutes A M
and recorded in Book ROADS Page 157-159
Attest: Debra Levesque
Town Clerk

Resolution
Naming TH 119 the School House Road
Creating a Section of this Road as a Pent Road

Be it resolved by the Board of Selectmen of the Town of Woodstock that the Class IV road between Gabert Road and Vondell Brook Road shall be known as the School House Road TH 119.

Pursuant to the authority contained in V.S.A. Title 19 section 304 (a) (5) the Board of Selectmen grant permission to Charles H. Wright to enclose with an unlocked gate the aforesaid School House Rd. at a location determined to be approximately 200 ft. north easterly of the intersection of this road with the said Gabert Road.

The Pent Road created by the unlocked gate is limited to the road between the gate and the said Gabert Road.

The speed limit over this Pent Road is 5 mph.

This action does not affect any of the School House Road located easterly of the unlocked gate.

This document to be recorded in the Highway Records of the Town of Woodstock.

Date: SEPTEMBER 6, 2005

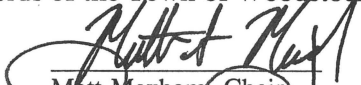

Matt Maxham, Chair

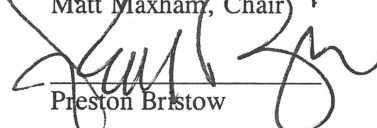

Preston Bristow

John Doten

Bruce Gould

John Wetmore

TOWN HWY NO.	LENGTH IN MILES	CLASS
1	0.000	4
2	0.690	4
3	0.090	(0.360)
4	0.000	(0.180)
5	0.110	(0.160)
6	0.480	
7	0.510	(0.080)
8	0.240	(1.550)
9	0.240	
10	0.200	(0.190)
11	0.210	(0.290)
12	0.810	(1.940)
13	0.850	
14	0.100	(1.800)
15	0.590	(0.190)
16	0.970	
17	0.520	(0.740)
18	0.270	(0.480)
19	0.560	(0.600)
20	0.700	(1.330)
21	0.920	
22	0.130	(0.120)
23	0.250	(1.330)
24	0.750	
25	0.000	(0.200)
26	0.000	(0.410)
27	0.450	
28	0.950	(0.450)
29	0.000	(0.700)
30	0.220	
31	0.160	(0.110)
32	0.490	
33	0.280	
34	0.200	
35	0.280	(0.280)
36	0.000	
37	0.800	(0.780)
38	0.250	(0.060)
39	0.000	
40	0.330	
41	0.120	(0.080)
42	0.600	
43	0.700	
44	1.980	
45	0.810	
46	0.510	
47	0.250	
48	0.030	
49	0.170	(0.120)
50	0.000	
51	0.040	
52	0.230	
53	0.380	
54	0.230	
55	0.040	
56	0.250	
57	0.170	(0.160)
58	0.000	
59	0.500	(0.070)
60	0.270	
61	0.280	
62	0.120	
63	0.140	
64	0.040	
65	0.330	
66	0.030	
67	0.090	
68	0.040	
69	0.170	
70	0.340	
71	0.170	
72	0.080	(0.270)
73	0.000	
74	0.230	
75	0.370	
76	0.000	
77	0.000	
78	0.000	
79	0.000	
80	0.000	
81	0.000	
82	0.000	
83	0.000	
84	0.000	
85	0.000	
86	0.000	
87	0.000	
88	0.000	
89	0.000	
90	0.000	
91	0.000	
92	0.000	
93	0.000	
94	0.000	
95	0.000	
96	0.000	
97	0.000	
98	0.000	
99	0.000	
100	0.000	
101	0.000	
102	0.000	
103	0.000	
104	0.000	
105	0.000	
106	0.000	
107	0.000	
108	0.000	
109	0.000	
110	0.000	
111	0.000	
112	0.000	
113	0.000	
114	0.000	
115	0.000	
116	0.000	
117	0.000	
118	0.000	
TOTAL	62.620	13.710

HIGHWAYS

- INTERSTATE
- STATE HIGHWAY SYSTEM
- TOWN HIGHWAY SYSTEM
- IMPASSABLE OR UNTRAVELED
- DISCONTINUED
- LEGAL TRAIL
- FOOT TRAIL

INTERSTATE ROUTE (89)

U.S. NUMBERED ROUTE (2)

STATE NUMBERED ROUTE (3)

INTERCHANGE NUMBER (7)

CLASS 1 TOWN HIGHWAY (4)

CLASS 2 TOWN HIGHWAY (2)

CLASS 3 TOWN HIGHWAY (8)

CLASS 4 TOWN HIGHWAY (6)

NFR NATIONAL FOREST ROAD

SFH STATE FOREST HIGHWAY

BRIDGE OR CULVERT < 6'

BRIDGE OR CULVERT 6' - 20'

BRIDGE GREATER THAN 20'

COVERED BRIDGE (CB)

ROAD SURFACE TYPES

- STATE PAVED
- OTHER PAVED
- STATE GRAVEL
- OTHER GRAVEL
- GRADED AND DRAINED
- UNIMPROVED/PRIMITIVE

POLITICAL SUBDIVISIONS

- STATE BOUNDARY
- COUNTY BOUNDARY
- TOWN BOUNDARY
- CITY BOUNDARY
- VILLAGE BOUNDARY
- URBAN COMPACT BOUNDARY

NATURAL FEATURES

- SINGLE LINE STREAM
- OPEN WATER
- SWAMP

OTHER TRANSPORTATION

- RAILROAD
- AIRPORT TERMINAL

MISCELLANEOUS

- DAM

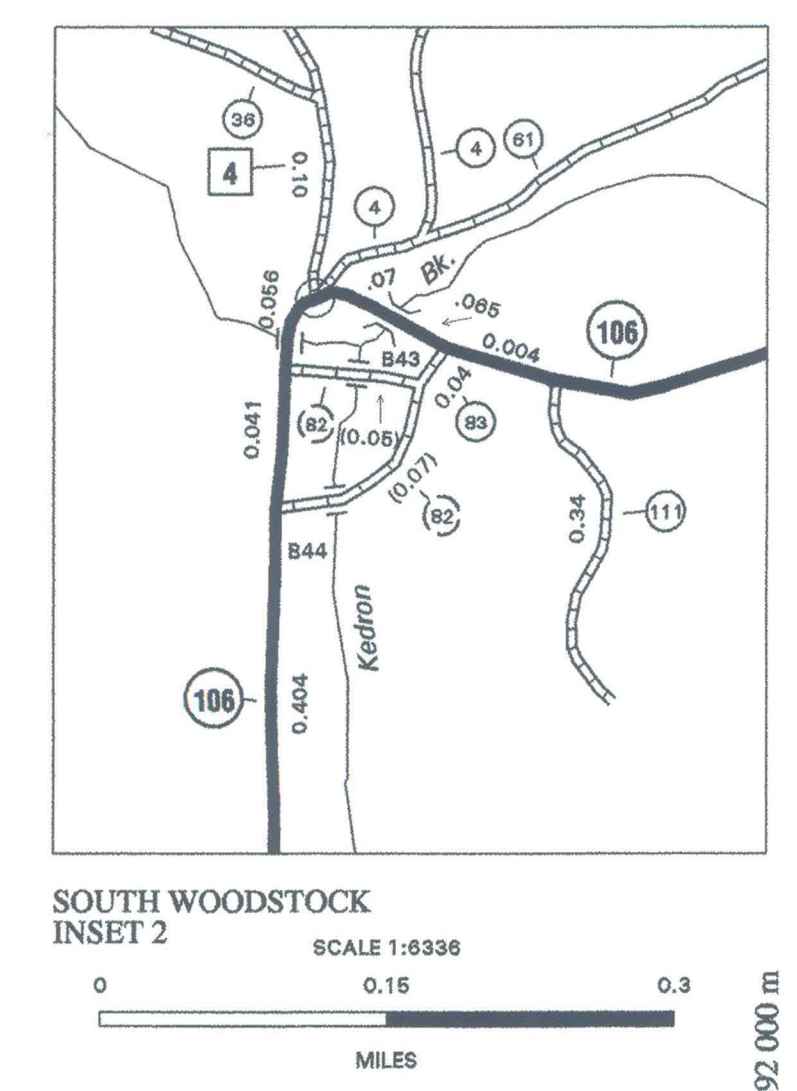
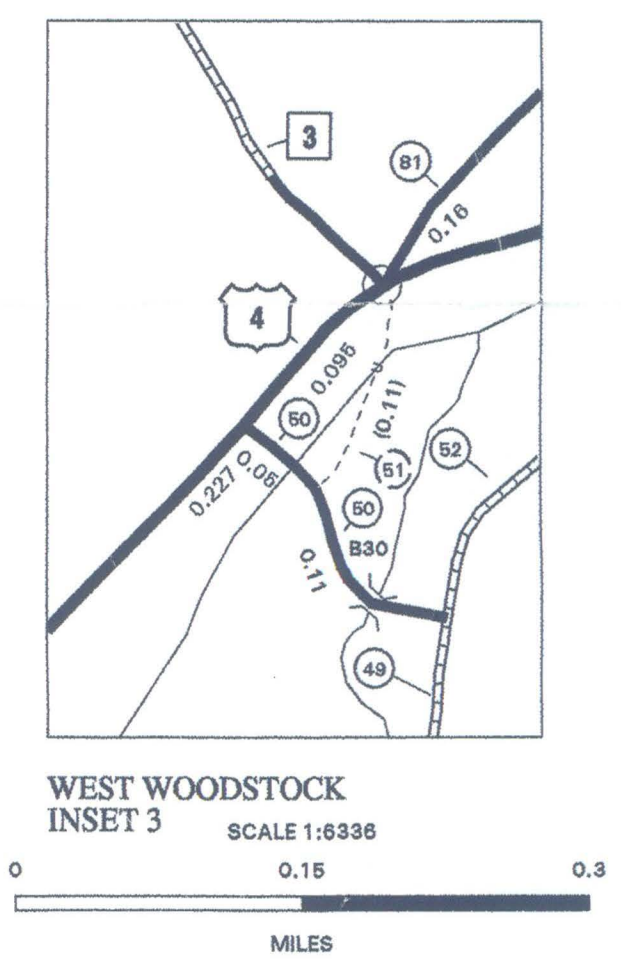
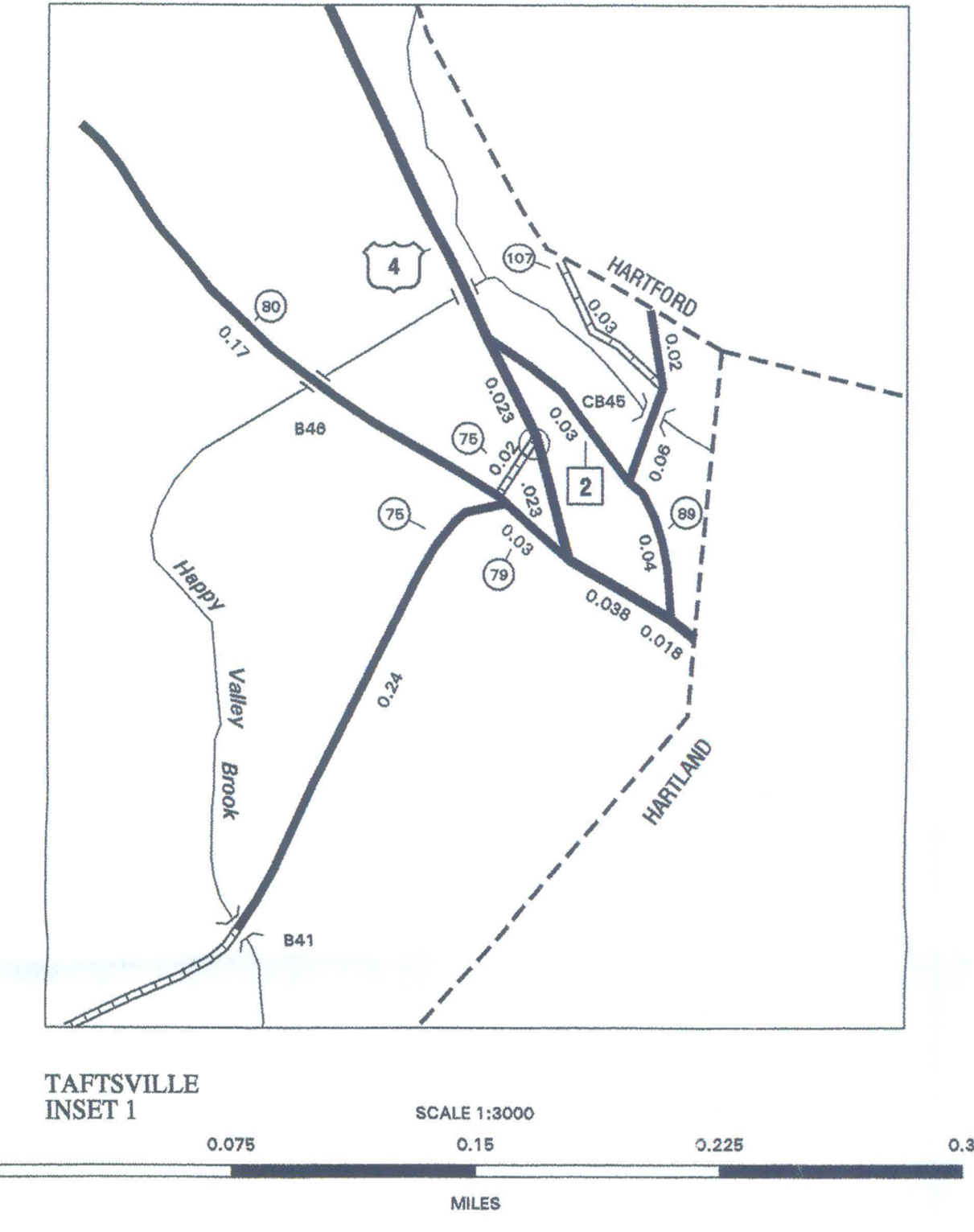
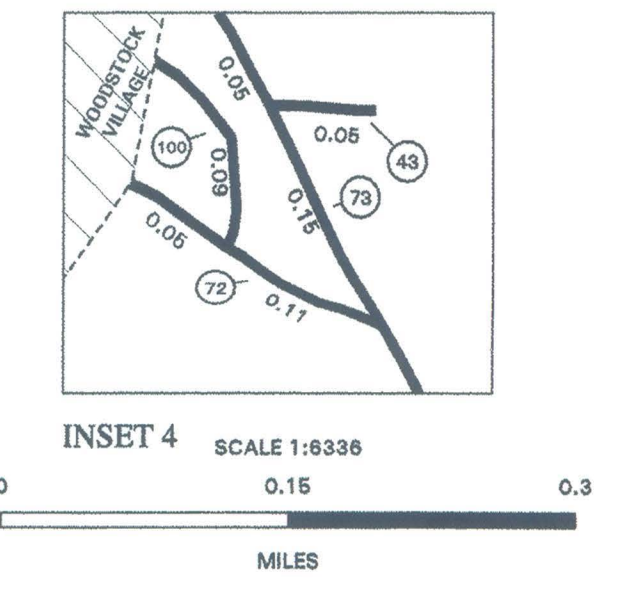
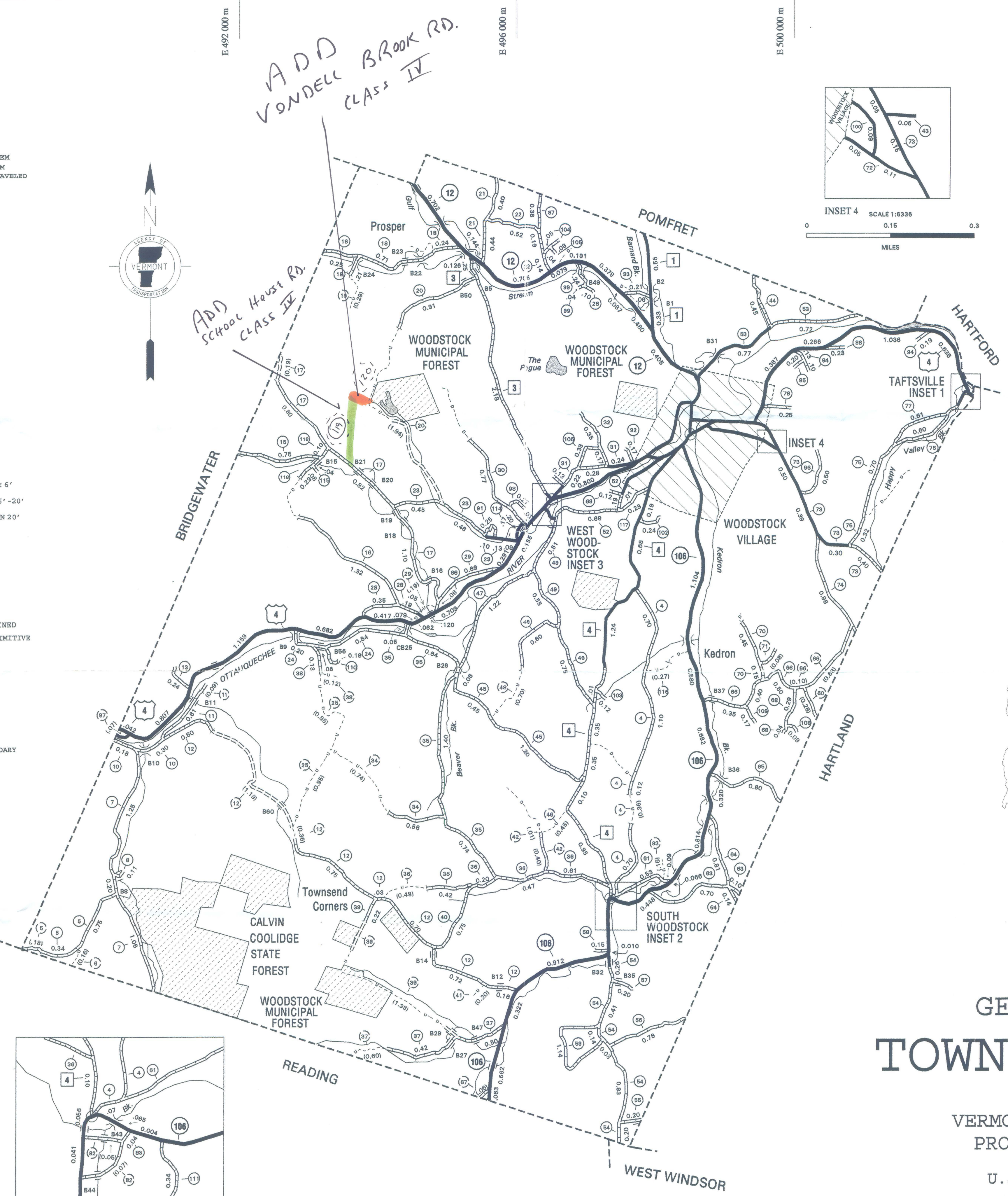
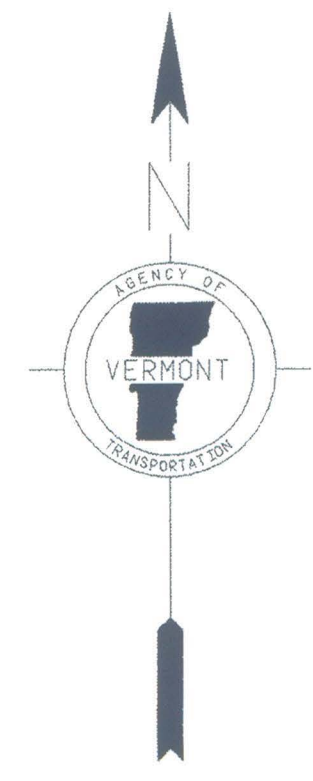

MILEAGE SUMMARY

CLASS 1 TOWN HIGHWAYS:		0.000
TOTAL CLASS 1 TOWN HWYS.		
CLASS 2 TOWN HIGHWAYS:	0.880	
NO. 1	0.110	
NO. 2	0.430	
NO. 3	0.970	
TOTAL CLASS 2 TOWN HWYS.	7.390	
CLASS 3 TOWN HIGHWAYS:		62.620
TOTAL CLASS 3 TOWN HWYS.		70.010
TOTAL TOWN HWYS.		
STATE HIGHWAYS:		
INTERSTATE RAMPS:	0.000	0.000
TOTAL INTERSTATE HWYS.		
STATE HWY. 4	0.074	
STATE HWY. 12	0.298	
STATE HWY. 106	0.553	
TOTAL NON-INTERSTATE HWYS.	17.925	17.925
TOTAL STATE HWYS.		
TOTAL TRAVELLED HWYS., FEB. 10, 2003		87.935

VERMONT GENERAL HIGHWAY MAP

TOWN OF WOODSTOCK

PREPARED BY THE
 VERMONT AGENCY OF TRANSPORTATION
 PROGRAM DEVELOPMENT DIVISION
 IN COOPERATION WITH
 U.S. DEPARTMENT OF TRANSPORTATION
 FEDERAL HIGHWAY ADMINISTRATION

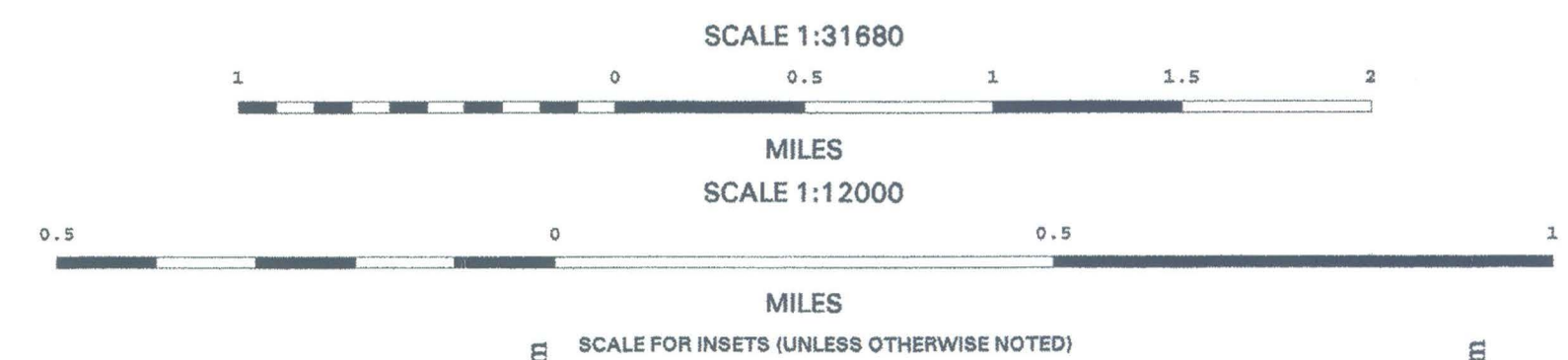

DISCLAIMER:
 Highway and bridge data by Vermont Agency of Transportation, Division of Program Development. All other data from Vermont Center for Geographic Information.