

**CERTIFICATE OF HIGHWAY MILEAGE
YEAR ENDING FEBRUARY 10, 2011**

Fill out form, make and file copy with the Town Clerk, and mail ORIGINAL, before February 20, 2011 to:
Vermont Agency of Transportation, Division of Planning, Outreach and Community Affairs, One National Life
Drive, Montpelier, VT 05633.

We, the members of the legislative body of POMFRET in WINDSOR County
on an oath state that the mileage of highways, according to Vermont Statutes Annotated, Title 19, Section 305,
added 1985, is as follows:

PART I - CHANGES TOTALS - Please fill in and calculate totals.

Town Highways	Previous Mileage	Added Mileage	Subtracted Mileage	Total	Scenic Highways
Class 1	0.000				0.000
Class 2	14.650				0.000
Class 3	47.75				0.000
State Highway	1.383				0.000
Total	63.783				0.000
* Class 1 Lane	0.000				0.000
* Class 4	6.11				
* Legal Trail	5.19				
* Unidentified Corridor	0.00				

* Mileage for Class 1 Lane, Class 4, Legal Trail, and Unidentified Corridor classifications are NOT included in total.

PART II - INFORMATION AND DESCRIPTION OF CHANGES SHOWN ABOVE.

1. NEW HIGHWAYS: Please attach Selectmen's "Certificate of Completion and Opening".
2. DISCONTINUED: Please attach SIGNED copy of proceedings (minutes of meeting).
3. RECLASSIFIED/REMEASURED: Please attach SIGNED copy of proceedings (minutes of meeting).
4. SCENIC HIGHWAYS: Please attach a copy of order designating/discontinuing Scenic Highways.

IF THERE ARE NO CHANGES IN MILEAGE: Check box and sign below. [V]

PART III - SIGNATURES - PLEASE SIGN.

Selectmen/ Aldermen/ Trustees Signatures: _____

[Handwritten signatures: David J. ...]

T/C/V Clerk Signature: _____

[Handwritten signature: Lynne A. Leavitt]

Date Filed: _____

[Handwritten date: 2/3/11]

Please sign ORIGINAL and return it for Transportation signature.

AGENCY OF TRANSPORTATION APPROVAL: _____

Signed copy will be returned to T/C/V Clerk.

APPROVED: _____

[Handwritten signature]
Representative, Agency of Transportation
Johnathan Croft

DATE: _____

[Handwritten date: 2/7/2011]

[Handwritten note: rec 1/5/11]

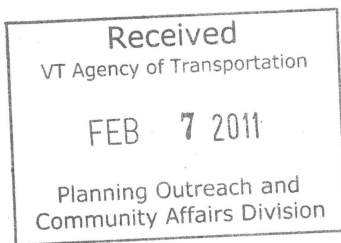

Vermont Statutes Annotated

19 V.S.A. § 305. Measurement and inspection

§ 305. Measurement and inspection

(a) After reasonable notice to the selectboard, a representative of the agency may measure and inspect the class 1, 2, and 3 town highways in each town to verify the accuracy of the records on file with the agency. Upon request, the selectboard or their designee shall be permitted to accompany the representative of the agency during the measurement and inspection. The agency shall notify the town when any highway, or portion of a highway, does not meet the standards for its assigned class. If the town fails, within one year, to restore the highway or portion of the highway to the accepted standard, or to reclassify, or to discontinue, or develop an acceptable schedule for restoring to the accepted standards, the agency for purposes of apportionment under section 306 of this title shall deduct the affected mileage from that assigned to the town for the particular class of the road in question.

(b) Annually, on or before February 10, the selectboard shall file with the town clerk a sworn statement of the description and measurements of all class 1, 2, 3, and 4 town highways and trails then in existence, including any special designation such as a throughway or scenic highway. When class 1, 2, 3, or 4 town highways, trails, or unidentified corridors are accepted, discontinued, or reclassified, a copy of the proceedings shall be filed in the town clerk's office and a copy shall be forwarded to the agency.

(c) All class 1, 2, 3, and 4 town highways and trails shall appear on the town highway maps by July 1, 2015.

(d) At least 45 days prior to first including a town highway or trail that is not clearly observable by physical evidence of its use as a highway or trail and that is legally established prior to February 10, 2006 in the sworn statement required under subsection (b) of this section, the legislative body of the municipality shall provide written notice and an opportunity to be heard at a duly warned meeting of the legislative body to persons owning lands through which a highway or trail passes or abuts.

(e) The agency shall not accept any change in mileage until the records required to be filed in the town clerk's office by this section are received by the agency. A request by a municipality to the agency for a change in mileage shall include a description of the affected highway or trail, a copy of any surveys of the affected highway or trail, minutes of meetings at which the legislative body took action with respect to the changes, and a current town highway map with the requested deletions and additions sketched on it. A survey shall not be required for class 4 town highways that are legally established prior to February 10, 2006. All records filed with the agency are subject to verification in accordance with subsection (a) of this section.

(f) The selectboard of any town who are aggrieved by a finding of the agency concerning the measurement, description or classification of a town highway may appeal to the transportation board by filing a notice of appeal with the executive secretary of the transportation board.

(g) The agency shall provide each town with a map of all of the highways in that town together with the mileage of each class 1, 2, 3, and 4 highway, as well as each trail, and such other information as the agency deems appropriate.

Excerpt of 19 V.S.A. § 305 - *Measurement and inspection* from Vermont Statutes Online located at – <http://www.leg.state.vt.us/statutes/fullsection.cfm?Title=19&Chapter=003&Section=00305>

12/20/2010

Moulton, Sara

From: Moulton, Sara
Sent: Monday, July 25, 2011 7:14 AM
To: FOXXFARM@aol.com
Cc: Croft, Johnathan
Subject: RE: Pomfret Highway map changes

Thank you for letting me know. I will remove the request from the list of town highway changes to be done this year.

Sara Moulton

From: FOXXFARM@aol.com [FOXXFARM@aol.com]
Sent: Friday, July 22, 2011 5:27 PM
To: Moulton, Sara
Cc: HEINET@aol.com; klessard1557@gmail.com; listeners@pomfretVT.us; treasurer@pomfretvt.us; clerk@pomfretVT.us
Subject: Re: Pomfret Highway map changes

Sara, I apologize for the delay in replying to your request. The selectboard has reconsidered the request to renumber the highways and is withdrawing that request. There are many legal references to highway numbers in deeds and our parcel numbers use highway numbers. Thank you.

Neil Lamson
PO Box 56
1695 Webster Hill Road
South Pomfret, VT 05067
tel/fax 802.763.2070

In a message dated 6/21/2011 10:36:47 A.M. Eastern Daylight Time, Sara.Moulton@state.vt.us writes:

I am starting to process the changes requested in the email below and in the attached map, and am wondering if you would have an objection if I used different numbers than those proposed on the map. For example, instead of swapping around various portions of TH-42 and TH-43, I would like to retire both numbers and assign new numbers (perhaps 62 and 63) to the various portions in the manner designated on the map.

Please let me know if that would be acceptable. Thank you.

Sara Moulton, GISP
Mapping & GIS Specialist, Mapping Unit
Division of Policy and Planning
Vermont Agency of Transportation (VTrans)
Tel: 802-828-2109

From: Croft, Johnathan
Sent: Tuesday, February 08, 2011 10:28 AM
To: Moulton, Sara
Subject: FW: Highway map corrections

FYI

From: FOXXFARM@aol.com [<mailto:FOXXFARM@aol.com>]
Sent: Thursday, December 30, 2010 10:48 AM

To: Croft, Johnathan
Subject: Re: Highway map corrections

Johnathan, Happy New Year! Attached is a copy of the Pomfret highway map with the changes I asked about in Nov. These changes will make our highway numbers agree with E911 highway names. Thanks.

Neil Lamson
PO Box 56
1695 Webster Hill Road
South Pomfret, VT 05067
tel/fax 802.763.8617

In a message dated 11/5/2010 9:17:31 A.M. Eastern Standard Time, FOXXFARM@aol.com writes:
Thanks, Johnathan. I will try to get our changes onto a pdf.

Neil Lamson
PO Box 56
1695 Webster Hill Road
South Pomfret, VT 05067
tel/fax 802.763.8617

In a message dated 11/5/2010 8:36:39 A.M. Eastern Daylight Time, Johnathan.Croft@state.vt.us writes:

Good morning Neil,

We don't tend to like making changes to the town highway numbers, as there are documents and reference tied to these numbers. Some of these include surveys, deeds, as well as our internal inventory information. Based on our information, we are able to store both town highway numbers and road names that may be different.

If the changes are minor and will not cause significant issues, we will consider making the alterations in the town highway numbers. You can make mark-ups to the segments on a town highway with the requested number changes and I will review the information. You can send scans to me via email, or hard copies to me at:

Johnathan Croft
VTrans Mapping Unit
1 National Life Drive
Montpelier, VT 05633-5001

Please let me know if you have any questions or comments regarding the town highway numbers, or mapping in general.

Johnathan Croft
VTrans Mapping Unit
(802) 828-2600

From: FOXXFARM@aol.com [<mailto:FOXXFARM@aol.com>]
Sent: Friday, November 05, 2010 7:16 AM
To: Croft, Johnathan
Subject: Highway map corrections

Jonathan, We have several highway number corrections so they will be the same as E911. Where do I send the corrected map? Thanks.

Neil Lamson
PO Box 56
1695 Webster Hill Road
South Pomfret, VT 05067
tel/fax 802.763.8617

Moulton, Sara

From: FOXXFARM@aol.com
Sent: Tuesday, June 28, 2011 5:52 AM
To: Moulton, Sara
Subject: Re: Pomfret Highway map changes

Sara, Sorry for the delay in replying. I have talked to the other select board members and we hesitant to change the highway numbers. There are many legal documents that use the highway numbers (deeds, classification changes, etc.). retiring numbers numbers would be confusing. We'll discuss it at our July 6 selectboard meeting and let you know. Thanks.

Neil Lamson

PO Box 56
1695 Webster Hill Road
South Pomfret, VT 05067
tel/fax 802.763.2070

In a message dated 6/21/2011 10:36:47 A.M. Eastern Daylight Time, Sara.Moulton@state.vt.us writes:

I am starting to process the changes requested in the email below and in the attached map, and am wondering if you would have an objection if I used different numbers than those proposed on the map. For example, instead of swapping around various portions of TH-42 and TH-43, I would like to retire both numbers and assign new numbers (perhaps 62 and 63) to the various portions in the manner designated on the map.

Please let me know if that would be acceptable. Thank you.

Sara Moulton, GISP

Mapping & GIS Specialist, Mapping Unit

Division of Policy and Planning

Vermont Agency of Transportation (VTrans)

Tel: 802-828-2109

From: Croft, Johnathan
Sent: Tuesday, February 08, 2011 10:28 AM
To: Moulton, Sara
Subject: FW: Highway map corrections

FYI

From: FOXXFARM@aol.com [mailto:FOXXFARM@aol.com]

Sent: Thursday, December 30, 2010 10:48 AM

To: Croft, Johnathan

Subject: Re: Highway map corrections

Johnathan, Happy New Year! Attached is a copy of the Pomfret highway map with the changes I asked about in Nov. These changes will make our highway numbers agree with E911 highway names. Thanks.

Neil Lamson
PO Box 56
1695 Webster Hill Road
South Pomfret, VT 05067
tel/fax 802.763.8617

In a message dated 11/5/2010 9:17:31 A.M. Eastern Standard Time, FOXXFARM@aol.com writes:

Thanks, Johnathan. I will try to get our changes onto a pdf.

Neil Lamson
PO Box 56
1695 Webster Hill Road
South Pomfret, VT 05067
tel/fax 802.763.8617

In a message dated 11/5/2010 8:36:39 A.M. Eastern Daylight Time, Johnathan.Croft@state.vt.us writes:

Good morning Neil,

We don't tend to like making changes to the town highway numbers, as there are documents and reference tied to these numbers. Some of these include surveys, deeds, as well as our internal inventory information. Based on our information, we are able to store both town highway numbers and road names that may be different.

If the changes are minor and will not cause significant issues, we will consider making the alterations in the town highway numbers. You can make mark-ups to the segments on a town highway with the requested number changes and I will review the information. You can send scans to me via email, or hard copies to me at:

Johnathan Croft

VTrans Mapping Unit

1 National Life Drive

Montpelier, VT 05633-5001

Please let me know if you have any questions or comments regarding the town highway numbers, or mapping in general.

Johnathan Croft
VTrans Mapping Unit
(802) 828-2600

From: FOXXFARM@aol.com [mailto:FOXXFARM@aol.com]

Sent: Friday, November 05, 2010 7:16 AM

To: Croft, Johnathan

Subject: Highway map corrections

Jonathan, We have several highway number corrections so they will be the same as E911. Where do I send the corrected map? Thanks.

Neil Lamson
PO Box 56
1695 Webster Hill Road
South Pomfret, VT 05067
tel/fax 802.763.8617

Moulton, Sara

From: Croft, Johnathan
Sent: Tuesday, February 08, 2011 10:28 AM
To: Moulton, Sara
Subject: FW: Highway map corrections
Attachments: Changes POMFRET_MILEAGE_2010.pdf

FYI

From: FOXXFARM@aol.com [<mailto:FOXXFARM@aol.com>]
Sent: Thursday, December 30, 2010 10:48 AM
To: Croft, Johnathan
Subject: Re: Highway map corrections

Johnathan, Happy New Year! Attached is a copy of the Pomfret highway map with the changes I asked about in Nov. These changes will make our highway numbers agree with E911 highway names. Thanks.

Neil Lamson
PO Box 56
1695 Webster Hill Road
South Pomfret, VT 05067
tel/fax 802.763.8617

In a message dated 11/5/2010 9:17:31 A.M. Eastern Standard Time, FOXXFARM@aol.com writes:

Thanks, Johnathan. I will try to get our changes onto a pdf.

Neil Lamson
PO Box 56
1695 Webster Hill Road
South Pomfret, VT 05067
tel/fax 802.763.8617

In a message dated 11/5/2010 8:36:39 A.M. Eastern Daylight Time, Johnathan.Croft@state.vt.us writes:

Good morning Neil,

We don't tend to like making changes to the town highway numbers, as there are documents and reference tied to these numbers. Some of these include surveys, deeds, as well as our internal inventory information. Based on our information, we are able to store both town highway numbers and road names that may be different.

If the changes are minor and will not cause significant issues, we will consider making the alterations in the town highway numbers. You can make mark-ups to the segments on a town highway with the requested number changes and I will review the information. You can send scans to me via email, or hard copies to me at:

Johnathan Croft

VTrans Mapping Unit

1 National Life Drive

Montpelier, VT 05633-5001

Please let me know if you have any questions or comments regarding the town highway numbers, or mapping in general.

Johnathan Croft
VTrans Mapping Unit
(802) 828-2600

From: FOXXFARM@aol.com [<mailto:FOXXFARM@aol.com>]

Sent: Friday, November 05, 2010 7:16 AM

To: Croft, Johnathan

Subject: Highway map corrections

Jonathan, We have several highway number corrections so they will be the same as E911. Where do I send the corrected map? Thanks.

Neil Lamson
PO Box 56
1695 Webster Hill Road
South Pomfret, VT 05067
tel/fax 802.763.8617

TOWN HWY. NO.	LENGTH IN MILES CLASS 3	LENGTH IN MILES CLASS 4
5	2.71	
6	4.38	(0.29)
7	4.31	
8		(0.10)
10	1.12	
11	2.90	
13	1.49	
14	0.56	
15	0.45	(0.51)
16	0.22	
17	0.59	
18	0.32	
19	1.20	
20	1.08	
21	0.24	
22	1.82	
23	0.58	
24	1.53	(0.54)
25	0.14	(0.48)
26	1.10	
28	0.98	
29	1.16	
30		(0.30)
31	0.51	
32	1.75	
33	2.41	(0.93)
34	0.15	
35	0.57	
37	3.19	
38	0.53	(1.30)
39	1.88	
41	0.30	
42	1.02	(1.03)
43	1.39	
44	0.62	(0.19)
45	0.16	(0.10)
46	0.37	
48	0.36	
50	0.62	
51	0.50	
52	0.32	
53	0.33	
54	0.06	(0.34)
55	0.15	
56	1.30	
57	0.32	
60	0.06	
TOTAL	47.75	6.11

MILEAGE SUMMARY	
CLASS 2	
TH-1	10.150
TH-2	2.730
TH-3	1.770
TOTAL CLASS 2	14.650
CLASS 3	
TOTAL CLASS 3	47.750
TOTAL TOWN	62.400
STATE HIGHWAY	
VT-12	1.383
TOTAL STATE HIGHWAY	1.383
TOTAL STATE	1.383

TOTAL, TRAVELED HIGHWAYS, FEB. 10, 2010: 63.783
(Excludes Class 4 and Legal Trail Mileage)

* This portion of town highway is Class 3, but is functionally Class 4

LEGAL TRAIL NO.	LENGTH IN MILES
1	(0.40)
2	(1.25)
3	(0.50)
4	(0.70)
5	(0.76)
6	(0.53)
7	(0.69)
8	(0.36)
TOTAL	5.19

- HIGHWAYS**
- INTERSTATE
 - U.S. ROUTE
 - STATE ROUTE
 - CLASS 1
 - CLASS 2
 - CLASS 3
 - CLASS 4
 - LEGAL TRAIL
 - INTERSTATE OR DIVIDED HIGHWAY
 - STATE - HARD SURFACE OR PAVED
 - TOWN - HARD SURFACE OR PAVED
 - GRAVEL
 - SOIL OR GRADED AND DRAINED EARTH
 - UNIMPROVED OR PRIMITIVE
 - IMPASSABLE OR UNTRAVELED
 - LEGAL TRAIL
 - DISCONTINUED
 - HIGHWAY CLASS CHANGE
 - RAILROAD

- PUBLIC LAND**
- POLITICAL SUBDIVISIONS**
- STATE BOUNDARY
 - COUNTY BOUNDARY
 - TOWN BOUNDARY
 - VILLAGE BOUNDARY
 - URBAN COMPACT BOUNDARY
 - WATER BODIES
 - STREAM OR BROOK
 - BRIDGE OR CULVERT
 - BRIDGE OR CULVERT GREATER THAN 20'
 - BRIDGE OR CULVERT 6' - 20'
 - TOWN SHORT STRUCTURE

B34 / C34 STATE BRIDGE OR CULVERT IDENTIFIER
B34 / C34 TOWN BRIDGE OR CULVERT IDENTIFIER

FEDERAL CLASSIFICATION IDENTIFIER

- FAU URBAN ARTERIAL OR COLLECTOR
- MA MINOR ARTERIAL
- MJC MAJOR COLLECTOR
- MNC MINOR COLLECTOR
- PA PRINCIPAL ARTERIAL

STRUCTURES - SURFACE WATER NOTE:

STRUCTURES: Town short structures (bridges or culverts from 4-feet to less than 20-feet) are drawn from the Vermont Online Bridge & Culvert Inventory Tool (VOBCIT) database.
NOTE: Town shorts are not consistently tagged within VOBCIT.

The surface waters are from the Vermont Hydrological Dataset (VHD). Only the named streams are shown.

DISCLAIMER:

The untraveled highways (laid-out town highways), discontinued highways, and legal trails shown hereon are those of which the Agency of Transportation has record; others may exist.

Highway and bridge data by the Agency of Transportation. All other data from the Vermont Center for Geographic Information.

Vermont State Plane Coordinate System
North American Datum of 1983
SPCS_Zone_Identifier: 4400
Geodetic Reference System 80
4,000-meter grid, Easting - Northing

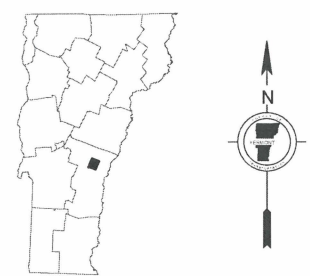
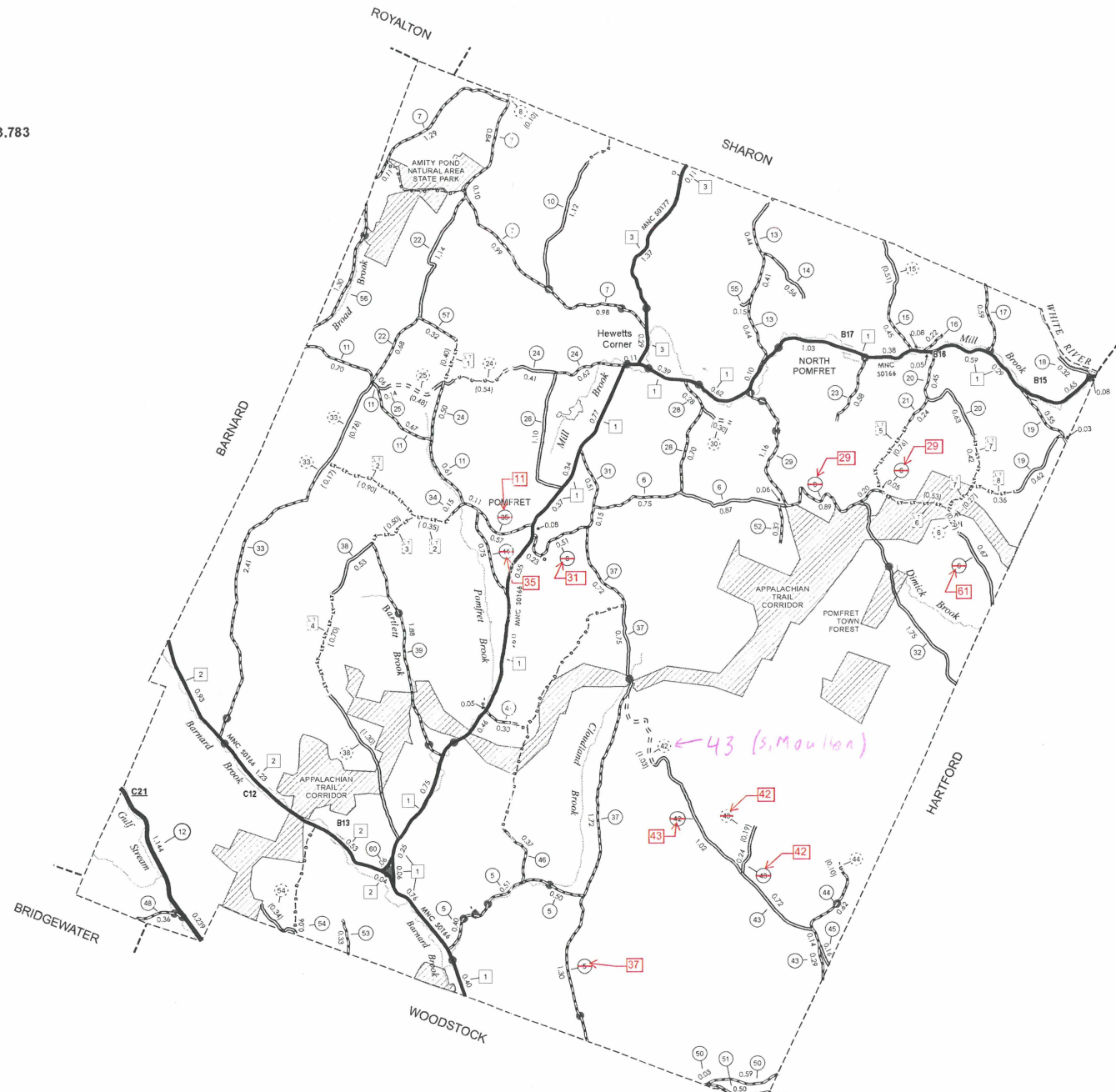

VERMONT GENERAL HIGHWAY MAP
Town of Pomfret
WINDSOR COUNTY

Transportation District #4

Prepared by the
Vermont Agency of Transportation
Division of Planning, Outreach
and Community Affairs
in cooperation with
U.S. Department of Transportation
Federal Highway Administration

Mileage as of February 10, 2010
Map prepared May 3, 2010

