

CERTIFICATE OF HIGHWAY MILEAGE
YEAR ENDING FEBRUARY 10, 2008

Fill out form, make and file copy with the Town Clerk, and mail ORIGINAL, before February 20, 2008 to: Vermont Agency of Transportation, Policy and Planning Division, One National Life Drive, Montpelier, VT 05633.

We, the Selectmen or Aldermen or Trustees of POMFRET in WINDSOR County on an oath state that the mileage of highways, according to Title 19, V.S.A, Sec #305, added 1985, is as follows:

PART I - CHANGES TOTALS - Please fill in and calculate totals.

Table with 6 columns: Town Highways, Previous Mileage, Added Mileage, Subtracted Mileage, Total, Scenic Highways. Rows include Class 1, Class 1 Lane, Class 2, Class 3, State Highway, Class 4, Legal Trail, and Total.

* Mileage for Class 1 Lane, Class 4, and Legal Trail classifications is NOT included in total.

PART II - INFORMATION AND DESCRIPTION OF CHANGES SHOWN ABOVE.

Totals by S. Moulton 1/25/08

- 1. NEW HIGHWAYS: Please attach Selectmen's "Certificate of Completion and Opening"
2. DISCONTINUED: Please attach SIGNED copy of proceedings (minutes of meeting)
3. RECLASSIFIED/REMEASURED: Please attach SIGNED copy of proceedings (minutes of meeting)
4. SCENIC HIGHWAYS: Please attach a copy of order designating/discontinuing Scenic Highways

IF THERE ARE NO CHANGES IN MILEAGE: Check box and sign below. []

PART III - SIGNATURES - PLEASE SIGN.

Selectmen/ Aldermen/ Trustees Signatures:

James D. Davill
Neil Larsson
Robert S. Harrington

T/C/V Clerk Signature: JoAnn Webb

Date Filed: January 18, 2008

Please sign ORIGINAL and return it for Transportation signature.

AGENCY OF TRANSPORTATION APPROVAL: Signed copy will be returned to T/C/V Clerk.

APPROVED:

Representative, Agency of Transportation

Johnathan Croft

DATE:

4/17/2008

Maritime
Agency of Transport

JAN 22 2008

Policy & Planning Division

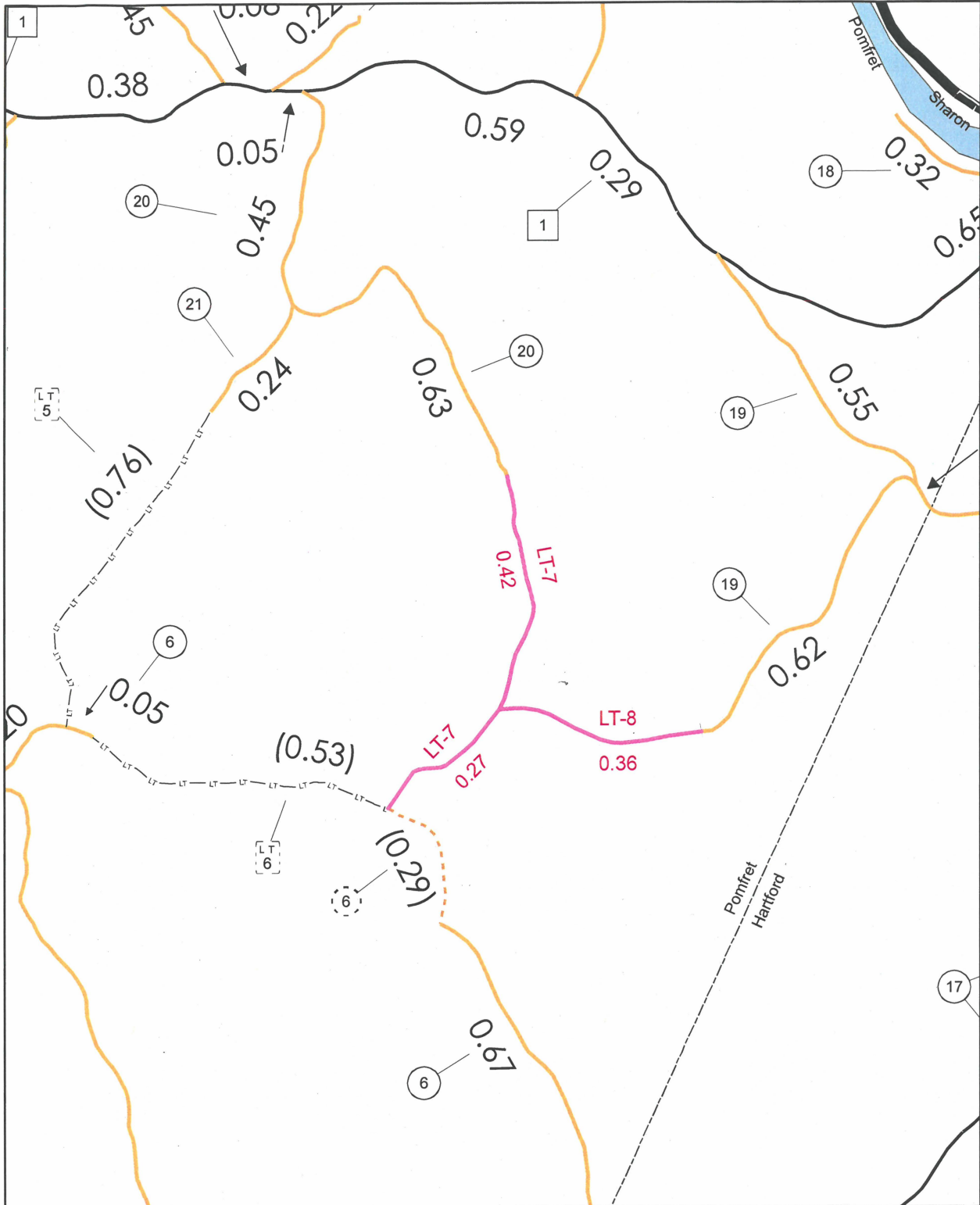

POMFRET -- Proposed LT-7 and LT-8

Mapping Unit
 Policy & Planning Division
 Vermont Agency of Transportation -- November 2007

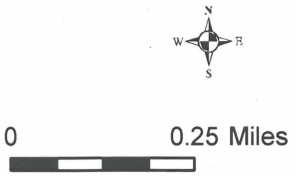

Moulton, Sara

From: Moulton, Sara
Sent: Wednesday, November 28, 2007 2:19 PM
To: 'pfellows@trorc.org'
Cc: Croft, Johnathan
Subject: RE: no RTNO # for the 3 LT arcs in Pomfret

Right, that's because of the status of those three Class 70 arcs. They're in limbo until they are re-certified on the 2008 Certificate of Highway Mileage. Then they'll be reassigned to AOTCLASS 7 and given their RTNO numbers.

I've attached a map that identifies how the RTNOs and mileages will be distributed for these arcs.

Sara Moulton
Mapping & GIS Specialist
Policy & Planning Division - Mapping Unit
Vermont Agency of Transportation (VTrans)
Tel: 802-828-2109

-----Original Message-----

From: Pete Fellows [mailto:pfellows@trorc.org]
Sent: Wednesday, November 28, 2007 11:18 AM
To: Croft, Johnathan
Cc: Moulton, Sara
Subject: no RTNO # for the 3 LT arcs in Pomfret

One another item-

Of the 573 LT class 70 arcs statewide, the three in Pomfret are the only ones w/o a RTNO.

Thanks
-Pete

Peter L. Fellows, GIS Manager
Two Rivers-Ottawaquechee Regional Commission
3117 Rose Hill, The King Farm
Woodstock, VT 05091
802-457-3188, fax 802-457-4728
<http://www.trorc.org>
pfellows at trorc.org

From: Pete Fellows [mailto:pfellows@trorc.org]
Sent: November 28, 2007 10:55 AM
To: 'Croft, Johnathan'
Cc: 'Moulton, Sara'
Subject: RE: CLASS 70 LT not yet approved Pomfret

Sara and Johnathan-

I am just worried that folks will see the LT on the general highway map and not know it is not certified (and going to be dropped in 2015). Attached is an idea for noting this on the GHM (Pomfret). Just a suggestion and the new PDFs look great.

I also attached the Pomfret pages from the March 2007 changes PDF that Sara made for everyone. I do not

see the uncertified LT on these maps. I actually think the two uncertified Pomfret LT changes were forwarded to VTrans this summer. Did you send them something else this summer or should I remind them this January to put these two LTs on their mileage certificate?

Thanks
-Pete

Peter L. Fellows, GIS Manager
Two Rivers-Ottawaquechee Regional Commission
3117 Rose Hill, The King Farm
Woodstock, VT 05091
802-457-3188, fax 802-457-4728
<http://www.trorc.org>
pfellows at trorc.org

From: Croft, Johnathan [mailto:Johnathan.Croft@state.vt.us]
Sent: November 28, 2007 10:16 AM
To: pfellows@trorc.org
Cc: Moulton, Sara
Subject: RE: CLASS 70 LT not yet approved Pomfret

Pete,

Sara sent each town a map with the highlighted legal trails sections and a listing of the known mileage from our files with the blank 2007 certificates. Some of these trails were added in 2007, whereas, others were not. Those that towns didn't add will certainly be noted in the next round, but ultimately, if towns don't get the mileage on the certificate, the trails might be dropped from the maps after 2015. The maps reflect what is on the mileage certificates and if the trail mileage is not accounted for, the map should reflect that.

Johnathan

From: Pete Fellows [mailto:pfellows@trorc.org]
Sent: Wednesday, November 28, 2007 10:12 AM
To: Croft, Johnathan
Subject: CLASS 70 LT not yet approved Pomfret

Johnathan-

I imagine you look at the subject lines of your RPC emails and just groan sometimes. Anyway, I noticed you added two LTs in Pomfret this summer and put them on the General Highway Map without LT shields. Is there going to be a process where you remind the Selectboards that they need to deal with these little buggers on the mileage certificate the next go-around? I am planning on displaying these on my maps as LTs...

Thanks
-Pete

Peter L. Fellows, GIS Manager
Two Rivers-Ottawaquechee Regional Commission
3117 Rose Hill, The King Farm
Woodstock, VT 05091
802-457-3188, fax 802-457-4728
<http://www.trorc.org>
pfellows at trorc.org

Moulton, Sara

From: Pete Fellows [pfellows@trorc.org]
Sent: Wednesday, November 28, 2007 12:18 PM
To: Moulton, Sara
Cc: Croft, Johnathan
Subject: RE: CLASS 70 LT not yet approved Pomfret

Sara-

Great, thanks, makes a lot more sense now. Can you cc the RPCs on these types of correspondence to the towns in the future? I was pretty confused because the towns rarely communicate this info to me and just ask why don't my maps look like the VTrans maps.

For Pomfret, it looks like you are going to add these automatically next year since the mileage certificate is pre-loaded. I still think the general highway maps should have some sort of note for class 70 unless you are going to pre-load all mileage certificates in order make sure these get included. It is kind of a new class-- "preliminary LT".

Thanks
-Pete

Peter L. Fellows, GIS Manager
Two Rivers-Ottawaquechee Regional Commission
3117 Rose Hill, The King Farm
Woodstock, VT 05091
802-457-3188, fax 802-457-4728
<http://www.trorc.org>
pfellows at trorc.org

From: Moulton, Sara [mailto:Sara.Moulton@state.vt.us]
Sent: November 28, 2007 11:46 AM
To: pfellows@trorc.org
Cc: Croft, Johnathan
Subject: RE: CLASS 70 LT not yet approved Pomfret

As part of the Year 2007 Mileage Certificate process, Pomfret requested the addition of two Legal Trails identified as LT-7 and LT-8. I did not accept these two Legal Trails and notified the town why (see attached document Pomfret_trail_no_accept.pdf). They asked for a reconsideration of my decision which I forwarded to Johnathan who accepted the town's request to add these Legal Trails. Please see the attached document titled LT_7-8.pdf which explained to the town how we planned to process the additions.

The attached document Cert_2008.pdf shows that the addition of these two Legal Trails has been "pre-loaded" into the Year 2008 Certificate. All the town has to do is to process the certificate as they normally would, and the trails will become incorporated as "Accepted".

Please let me know if you have any questions.

Sara Moulton
Mapping & GIS Specialist
Policy & Planning Division - Mapping Unit
Vermont Agency of Transportation (VTrans)
Tel: 802-828-2109

11/28/2007

-----Original Message-----

From: Pete Fellows [mailto:pfellows@trorc.org]
Sent: Wednesday, November 28, 2007 10:55 AM
To: Croft, Johnathan
Cc: Moulton, Sara
Subject: RE: CLASS 70 LT not yet approved Pomfret

Sara and Johnathan-

I am just worried that folks will see the LT on the general highway map and not know it is not certified (and going to be dropped in 2015). Attached is an idea for noting this on the GHM (Pomfret). Just a suggestion and the new PDFs look great.

I also attached the Pomfret pages from the March 2007 changes PDF that Sara made for everyone. I do not see the uncertified LT on these maps. I actually think the two uncertified Pomfret LT changes were forwarded to VTrans this summer. Did you send them something else this summer or should I remind them this January to put these two LTs on their mileage certificate?

Thanks
 -Pete

Peter L. Fellows, GIS Manager
 Two Rivers-Ottawaquechee Regional Commission
 3117 Rose Hill, The King Farm
 Woodstock, VT 05091
 802-457-3188, fax 802-457-4728
<http://www.trorc.org>
 pfellows at trorc.org

From: Croft, Johnathan [mailto:Johnathan.Croft@state.vt.us]
Sent: November 28, 2007 10:16 AM
To: pfellows@trorc.org
Cc: Moulton, Sara
Subject: RE: CLASS 70 LT not yet approved Pomfret

Pete,

Sara sent each town a map with the highlighted legal trails sections and a listing of the known mileage from our files with the blank 2007 certificates. Some of these trails were added in 2007, whereas, others were not. Those that towns didn't add will certainly be noted in the next round, but ultimately, if towns don't get the mileage on the certificate, the trails might be dropped from the maps after 2015. The maps reflect what is on the mileage certificates and if the trail mileage is not accounted for, the map should reflect that.

Johnathan

From: Pete Fellows [mailto:pfellows@trorc.org]
Sent: Wednesday, November 28, 2007 10:12 AM
To: Croft, Johnathan
Subject: CLASS 70 LT not yet approved Pomfret

Johnathan-

I imagine you look at the subject lines of your RPC emails and just groan sometimes. Anyway, I noticed you

added two LTs in Pomfret this summer and put them on the General Highway Map without LT shields. Is there going to be a process where you remind the Selectboards that they need to deal with these little buggers on the mileage certificate the next go-around? I am planning on displaying these on my maps as LTs...

Thanks
-Pete

Peter L. Fellows, GIS Manager
Two Rivers-Ottawquechee Regional Commission
3117 Rose Hill, The King Farm
Woodstock, VT 05091
802-457-3188, fax 802-457-4728
<http://www.trorc.org>
pfellows at trorc.org



State of Vermont
Policy & Planning Division-Mapping Unit
1 National Life Drive, Drawer 33
Montpelier, VT 05633-5001
<http://www.aot.state.vt.us>

Agency of Transportation

Telephone: 802-828-2600
Fax: 802-828-2334
Email: johnathan.croft@state.vt.us

July 20, 2007

Board of Selectmen
Town of Pomfret, c/o Lois Havill
PO Box 64
South Pomfret, VT 05067

Dear Ms. Havill;

Sara Moulton forwarded your request for a reconsideration of her non-acceptance of Legal Trails LT-7 and LT-8. Her concern was that the trails appeared to have been discontinued sometime between 1976 and 1982, according to the Town Highway Maps of those years. She was unsure that the Selectboard's action in 2002 adequately addressed those discontinuances.

I have reviewed our Pomfret town file, including the documentation from our Central Files that covers that time period, and will approve the classification of those two right-of-ways as Legal Trails (LT-7 and LT-8). The 2007 Mileage Certificate process was closed on April 15, 2007, so these two Legal Trails will not be included in the 2007 mileage totals. We will include these Legal Trails on the 2007 Town Highway Map, but they will not be assigned their identifier number and mileage in this year's map. **The 2008 Mileage Certificate for Pomfret will note the addition of the LT-7 and LT-8 mileage and the legal trails will be numbered with mileage on the 2008 Town Highway Map.**

If you have any questions or comments, please feel free to call me at 802-828-2600 or send e-mail to johnathan.croft@state.vt.us

Thank you.

Sincerely,

Johnathan Croft
AOT GIS Database Administrator
Policy & Planning Division - Mapping Unit

JFC/sem

cc: Pomfret Town Highway File

Preloaded into THDATA
for 2008 10 Sep 07
Used GIS calculated
mileage
LT-7 0.69 mi
LT-8 0.36 mi

