

CERTIFICATE OF HIGHWAY MILEAGE
YEAR ENDING FEBRUARY 10, 2016

Fill out form, make and file copy with the Town Clerk, and mail ORIGINAL, before February 20, 2016 to:
Vermont Agency of Transportation, Division of Policy, Planning and Intermodal Development, Mapping Section
One National Life Drive, Montpelier, VT 05633.

We, the members of the legislative body of HARTLAND in WINDSOR County
on an oath state that the mileage of highways, according to Vermont Statutes Annotated, Title 19, Section 305,
added 1985, is as follows:

PART I - CHANGES TOTALS - Please fill in and calculate totals.

Town Highways	Previous Mileage	Added Mileage	Subtracted Mileage	Total	Scenic Highways
Class 1	0.000				0.000
Class 2	16.260				0.000
Class 3	59.44	0.27		59.71	0.000
State Highway	24.722				0.000
Total	100.422			100.692	0.000
* Class 1 Lane	0.000				
* Class 4	2.96				0.000
* Legal Trail	4.58				

* Mileage for Class 1 Lane, Class 4, and Legal Trail classifications are NOT included in total.

PART II - INFORMATION AND DESCRIPTION OF CHANGES SHOWN ABOVE.

- 1. NEW HIGHWAYS: Please attach Selectmen's "Certificate of Completion and Opening". *Note by S. Moulton*
GARCIA LANE + 0.27 m. CL3 TH-90 3/30/2016
- 2. DISCONTINUED: Please attach SIGNED copy of proceedings (minutes of meeting).
- 3. RECLASSIFIED/REMEASURED: Please attach SIGNED copy of proceedings (minutes of meeting).
- 4. SCENIC HIGHWAYS: Please attach a copy of order designating/discontinuing Scenic Highways.

IF THERE ARE NO CHANGES IN MILEAGE: Check box and sign below. []

PART III - SIGNATURES - PLEASE SIGN.

Selectmen/ Aldermen/ Trustees Signatures:

Gordon Richardson
Martha McBlinn
May T. O'Brien
David Lee
Paul O'Brien

T/C/V Clerk Signature:

Clyde A. Glase

Date Filed:

3-22-16

Please sign ORIGINAL and return it for Transportation signature.

AGENCY OF TRANSPORTATION APPROVAL:

Signed copy will be returned to T/C/V Clerk.

APPROVED:

[Signature]
Representative, Agency of Transportation

DATE:

5/12/2016

Received

MAR 25 2016

Policy, Planning & Intermodal
Development Division

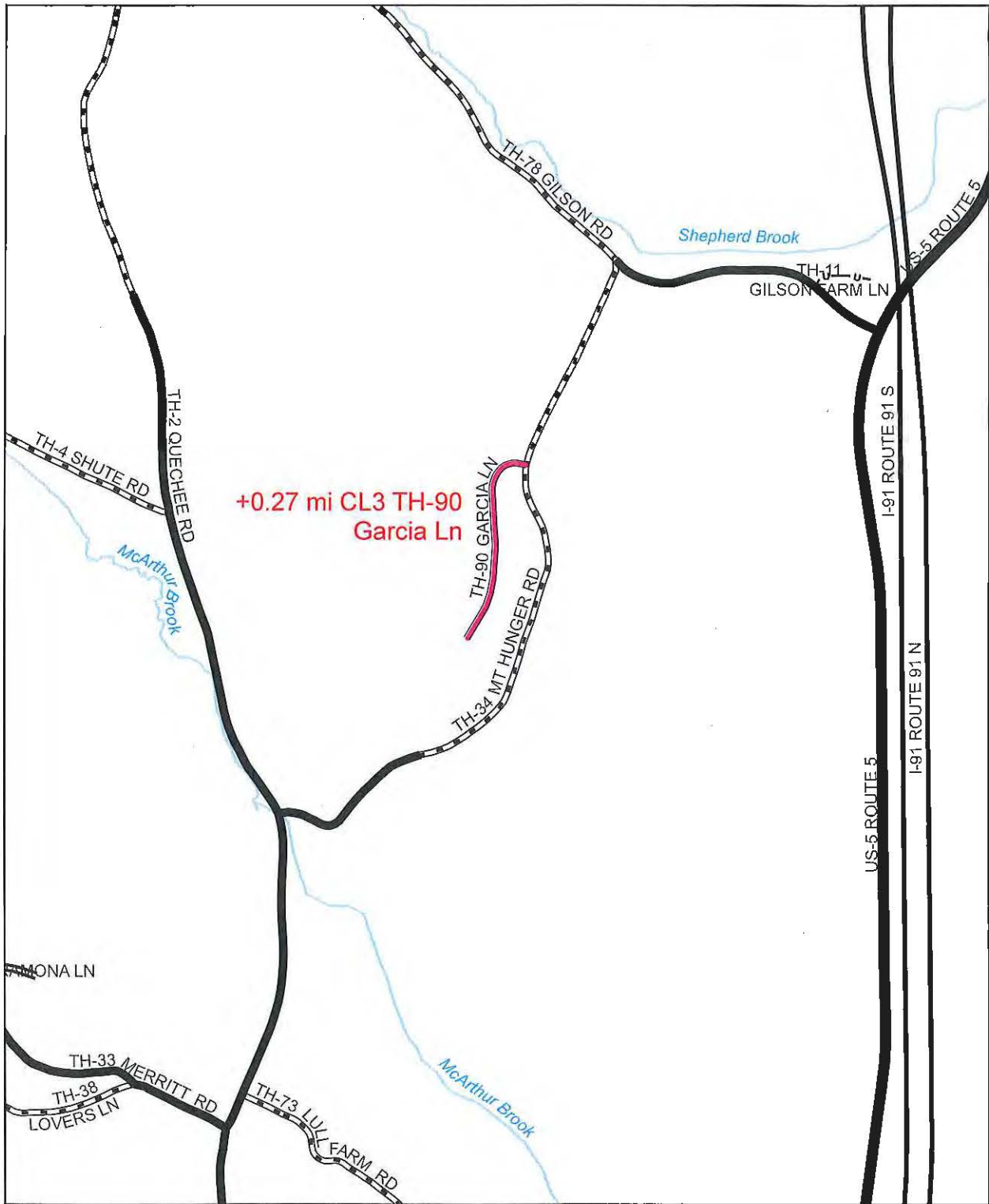

+0.27 mi CL3 TH-90
Garcia Ln

Mileage Certificate Change 2016 HARTLAND

(CTUA: 1409)

Mapping Section
Division of Policy, Planning and Intermodal Development
Vermont Agency of Transportation - March 2016

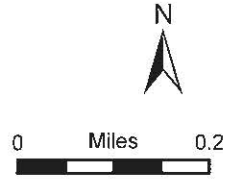

Town of Hartland

PO Box 349
Hartland, Vermont 05048

Town Manager's Office

802-436-2119

fax- 802-436-2464

bstacey@hartlandvt.org

March 23, 2016

Vermont Agency of Transportation
Division of Policy, Planning and Intermodal Development
Mapping Section
One National Life Drive
Montpelier, VT 05633

Re: Certificate of Highway Mileage

Please find enclosed the Certificate of Highway Mileage, Year Ending February 10, 2016 for the Town of Hartland. We had one short road (.27 miles) to add to our mileage total. I understand that I am tardy in getting this to you and if it does not make on the official map this year, so be it. Thank you.

Sincerely,

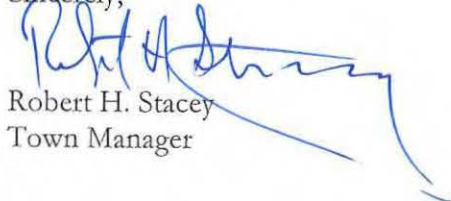
A handwritten signature in blue ink, appearing to read "Robert H. Stacey", written over a printed name and title.

Robert H. Stacey
Town Manager

Town of Hartland

PO Box 349
Hartland VT 05048-0349

Hearing on layout of a Public Highway known as Garcia Lane as per petition filed with the Selectman of the Town of Hartland on November 18, 2014.

STATE OF VERMONT)
WINDSOR COUNTY) SS. IN RE: LAYOUT OF A PUBLIC HIGHWAY KNOWN AS
GARCIA LANE

ORDER

The above-entitled matter came on for a hearing before the Selectmen of the Town of Hartland on the 1st day of June, 2015 pursuant to notice thereof in the following form:

“Whereas, a petition has been filed with the Selectmen of the Town of Hartland, Vermont, a municipal corporation having its situs at Hartland, to lay out a public highway from the road known as Gilson Road in the Town of Hartland across the lands of Gail J. Kelley. Trustee, Gary Barnes, Richard A Greenlee, and Roberto Garcia under 19 V.S.A. sec. 709, the Selectmen set June 1, 2015 at 5:45PM at Garcia Lane as a time to examine the premises and June 1, 2015 at 6:45PM as a time to hear parties interested as to the public good, necessity, and convenience of laying out the aforesaid highway as per 19 V.S.A. sec 709.

Dated December 7, 2015

Signed Gordon Richardson
 Thomas White
 Martha McGlinn
 Mary O'Brien
 Matthew Peeler
 Selectmen of the
 Town of Hartland,
 Vermont”

Notice was sent by Certified Mail to each of the abutting landowners; namely Gail Kelley, Mitchel and Debra Joslin, Lorraine Nichols and Gary Barnes, Yogi and Jessica Garcia, Norma and Roberto Garcia and Richard Greenlee and return receipts were received. Notice was also published in the *Valley News*, issue May 8, 2015, the legal newspaper for the Town of Hartland. Notice was filed with the Town Clerk and the Hartland Planning Commission.

At the hearing were present: Gordon Richardson, Tom White, Martha McGlinn, Matt Peeler from the Town of Hartland, Lorraine Nichols, Mitch Joslin, Yogi Garcia and Gail Kelley

It was noted that the Selectmen viewed the premises on June 1, 2015 at 5:45PM.

HARTLAND, VT Town Clerk's Office
Received for record
at December 10 A.D. 2015
at 10 o'clock 00 minutes A M
and Recorded in Book 7 Page 19-84
Attest: Clyde B. Jones
Town Clerk

Garcia Lane

2.

Upon hearing the parties and after examination of the premises it is found:

1. The Town will not officially take over the road for eighteen months.
2. The Town would take over Garcia Lane assuming that current Garcia conditions are addressed per Yogi Garcia's plans and those improvements discussed during the site visit.

It is therefore ordered that there be and there hereby is laid out a Public Highway fifty (50) feet in width off Gilson Road known as Garcia Lane, as described in the attached Easement Deeds. The total distance is .26 miles.

This order and survey shall be effective upon its recording and filing by the Town Clerk in the Hartland Road Records.

Dated at Hartland this 7th day of December, 2015.

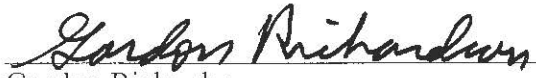
Gordon Richardson

Martha McGlinn

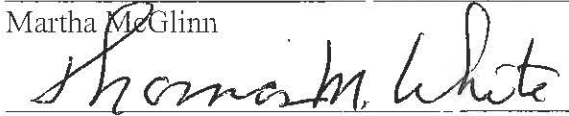
Thomas White

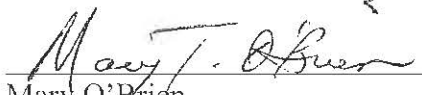
Mary O'Brien

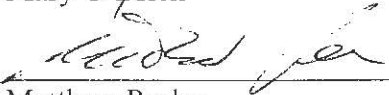
Matthew Peeler

Selectboard, Town of Hartland

VERMONT QUITCLAIM DEED

KNOW ALL PERSONS BY THESE PRESENTS, that we, GAIL J. KELLEY, TRUSTEE OF THE GAIL J. KELLEY REVOCABLE TRUST u/t/a JUNE 10, 1996, of Durham, in the County of Strafford and State of New Hampshire, RICHARD A. GREENLEE, of Hartland, in the County of Windsor and State of Vermont, GARY M. BARNES and LORRAINE T. NICHOLS, of Hartland, in the County of Windsor and State of Vermont, and ROBERTO GARCIA, SR., of Hartland, in the County of Windsor and State of Vermont, GRANTORS, in consideration of One Dollar and other good and valuable consideration paid to our full satisfaction by the SELECTBOARD OF THE TOWN OF HARTLAND, WINDSOR COUNTY, VERMONT, GRANTEE, have REMISED, RELEASED AND FOREVER QUITCLAIMED unto the said SELECTBOARD OF THE TOWN OF HARTLAND, VERMONT, all right and title which we or our respective heirs, successors and assigns have in and to those certain lands and premises, more particularly described and set forth as Garcia Lane on that certain survey titled: Road Survey for Garcia Lane Off Mt. Hunger Road, Hartland, Vermont, Farnsworth Surveys, Drawing No. 15-2308, dated October 7, 2015, and which said survey shall be recorded simultaneously herewith in the Hartland Land Records and to which survey reference is had for a more complete and particular description of the right of way (the said Garcia Lane) being conveyed hereby.

The intent of the GRANTORS is to convey an easement/right of way to the aforesaid Garcia Lane roadway to the SELECTBOARD OF THE TOWN OF HARTLAND, VERMONT for use by the Town as a Class 3 Town Highway, as more particularly defined and set forth in Title 19 of the Vermont Statutes Annotated.

By its recording of this Deed in the Hartland Land Records, the SELECTBOARD OF THE TOWN OF HARTLAND, VERMONT acknowledge its acceptance of the above-described Garcia Lane right-of-way for all purposes as a Class 3 Town Highway.

TO HAVE AND TO HOLD all of our right and title in and to said quitclaimed premises, with the appurtenances thereof, to the said SELECTBOARD OF THE TOWN OF HARTLAND, VERMONT, and its successors and assigns forever.

AND FURTHERMORE, we, the said GAIL J. KELLEY, TRUSTEE OF THE GAIL J. KELLEY IRREVOCABLE TRUST u/t/a JUNE 10, 1996, RICHARD A. GREENLEE, GARY M. BARNES and LORRAINE T. NICHOLS, and ROBERTO GARCIA, SR., do for ourselves and our heirs and assigns, covenant with the said SELECTBOARD OF THE TOWN OF HARTLAND, VERMONT and its successors and assigns, that from and after the ensembling of these presents we, GAIL J. KELLEY, TRUSTEE OF THE GAIL J. KELLEY IRREVOCABLE TRUST u/t/a JUNE 10, 1996, RICHARD A. GREENLEE, GARY M. BARNES and LORRAINE T. NICHOLS, and ROBERTO GARCIA, SR., will have and claim no right in or to the said quitclaimed premises.

GAIL J. KELLEY IRREVOCABLE TRUST

Date:

10/19/2015

BY:

Gail J. Kelley
Gail J. Kelley, Trustee

Date:

Oct 21, 2015

Richard A. Greenlee
Richard A. Greenlee

DESMEULES,

WILMSTEAD & OSTLER

POST OFFICE BOX 1090

DRWICH, VERMONT 05085

(802) 649-2001

GARY M. BARNES

BY: Mary M. Barnes by Lorraine T. Nichols
Lorraine T. Nichols - His Attorney

In Fact

Lorraine T. Nichols
Lorraine T. Nichols

Date: October 19, 2015

Date: October 19, 2015

Roberto Garcia Sr.
Robert Garcia, Sr.

Date: Oct 21, 2015

STATE OF VERMONT
WINDSOR COUNTY, SS.

At Norwich, in said County, this 19th day of October, 2015, before me personally appeared GAIL J. KELLEY, TRUSTEE OF THE GAIL J. KELLEY IRREVOCABLE TRUST, and she acknowledged that she executed this document as her free act and deed and the free act and deed of the GAIL J, KELLEY IRREVOCABLE TRUST.

Before me,

[Signature]
Notary Public

My Commission Expires: 02/10/2019

STATE OF VERMONT
WINDSOR COUNTY, SS.

At Hartland, in said County, this 21 day of October, 2015, before me personally appeared RICHARD E. GREENLEE, and he acknowledged that he executed this document as his free act and deed.

Before me,

[Signature]
Notary Public

My Commission Expires: 02/10/2019

STATE OF VERMONT
WINDSOR COUNTY, SS.

At Norwich, in said County, this 19th day of October, 2015, before me personally appeared LORRAINE T. NICHOLS, individually and as Attorney in Fact for GARY M. BARNES, and she acknowledged that she signed this instrument as her free act and deed, individually and as Attorney In Fact for Gary M. Barnes.

Before me,

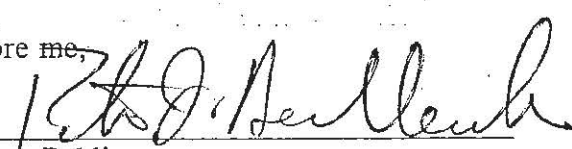
Notary Public

My Commission Expires: 02/10/2019

STATE OF VERMONT
WINDSOR COUNTY, SS.

At Hartland, in said County, this 21 day of October, 2015, before me personally appeared ROBERT GARCIA, SR., and he acknowledged that he executed this document as his free act and deed.

Before me,

Notary Public

My Commission Expires: 02/10/2019

p\nichols.lor\hartland.qcd

At 11:00 AM on November 04, 2015 at the Hartland Town Clerk's Office then received and recorded the foregoing instrument of which the above is a true photocopy.

Attest: Clyde A. Jeanne Town Clerk

Vermont Property Transfer Tax
32 V.S.A. Chap. 231

ACKNOWLEDGMENT

RETURNED RECEIVED

(INCLUDING CERTIFICATES AND IF REQUIRED,
ACT 250 DISCLOSURE STATEMENT)

ATTEST: Clyde A. Jeanne Clerk

DATE: November 4, 2015

DESMEULES,

ILMSTEAD & OSTLER

POST OFFICE BOX 1090

NORWICH, VERMONT 05055

(802) 649-2001

E-MAIL: boburveys@gmail.com THIS PLAT MEETS THE REQUIREMENTS OF 27 VSA § 1403 ORIGINAL INKED PLAT PRODUCED BY: FARNSWORTH SURVEYS - P.O. BOX 68, BROWNVILLE, VERMONT 05077

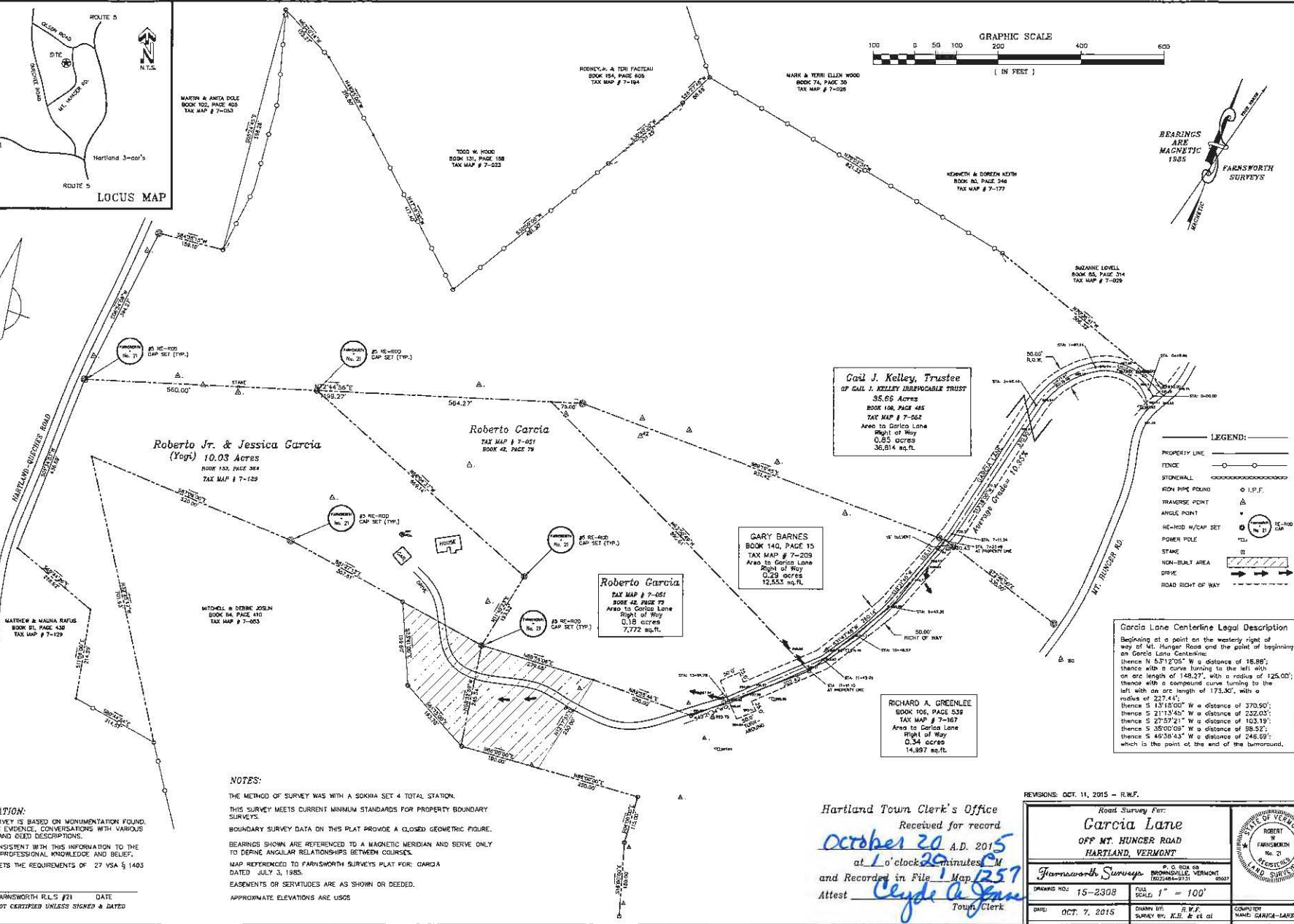
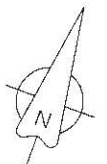
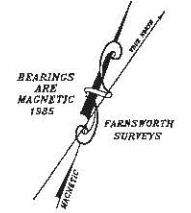
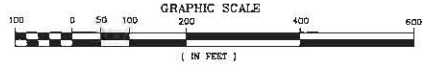
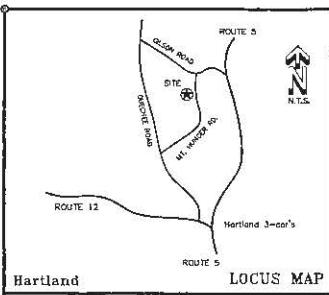

- LEGEND:**
- PROPERTY LINE: ————
 - FENCE: —○—○—
 - STONE WALL: ————
 - RON PIPE FOUND: ○ I.P.F.
 - TRANSVERSE POINT: △
 - ANGLE POINT: ∠
 - NE-HOD W/CAP SET: (N) (E) (H) (O) (D) (C) (A) (P) (S) (E) (T)
 - POWER POLE: T
 - STAKE: ▬
 - NON-BUILT AREA: ▨
 - DRIVE: ————
 - ROAD RIGHT OF WAY: ————

Garcia Lane Centerline Legal Description
 Beginning at a point on the westerly right of way of Mt. Hunger Road and the point of beginning on Garcia Lane Centerline:
 thence N 53°12'05" W a distance of 16.89';
 thence with a curve turning to the left with an arc length of 148.27', with a radius of 125.00';
 thence with a compound curve turning to the left with an arc length of 173.30', with a radius of 227.44';
 thence S 13°15'00" W a distance of 370.90';
 thence S 21°13'45" W a distance of 232.05';
 thence S 27°32'11" W a distance of 103.19';
 thence S 35°00'09" W a distance of 88.52';
 thence S 49°38'43" W a distance of 246.09';
 which is the point of the end of the bypassed.

NOTES:
 THE METHOD OF SURVEY WAS WITH A SOKKIA SET 4 TOTAL STATION.
 THIS SURVEY MEETS CURRENT MINIMUM STANDARDS FOR PROPERTY BOUNDARY SURVEYS.
 BOUNDARY SURVEY DATA ON THIS PLAT PROVIDE A CLOSED GEOMETRIC FIGURE.
 BEARINGS SHOWN ARE REFERENCED TO A MAGNETIC MERIDIAN AND SERVE ONLY TO DEFINE ANGULAR RELATIONSHIPS BETWEEN COURSES.
 MAP REFERENCED TO FARNSWORTH SURVEYS PLAT FOR: GARCIA DATED: JULY 31, 1985.
 EASEMENTS OR SERVITUDES ARE AS SHOWN OR DEEDED.
 APPROXIMATE ELEVATIONS ARE USGS.

CERTIFICATION:
 THIS SURVEY IS BASED ON MONUMENTATION FOUND, TOPOGRAPHIC EVIDENCE, CONVERSATIONS WITH VARIOUS INDIVIDUALS AND USED DESCRIPTIONS.
 IT IS CONSISTENT WITH THIS INFORMATION TO THE BEST OF MY PROFESSIONAL KNOWLEDGE AND BELIEF.
 THIS PLAT MEETS THE REQUIREMENTS OF 27 VSA § 1403

ROBERT W. FARNSWORTH R.L.S. #21 DATE _____
 COPIES ARE NOT CERTIFIED UNLESS SIGNED & DATED

Hartland Town Clerk's Office
 Received for record
 October 20 A.D. 2015
 at 1 o'clock 20 minutes P.M.
 and Recorded in File 1 Map 257
 Attest *Clyde A. Jones*
 Town Clerk

REVISIONS: OCT. 11, 2015 - R.W.F.

Road Survey for: Garcia Lane OFF MT. HUNGER ROAD HARTLAND, VERMONT		STATE OF VERMONT ROBERT W. FARNSWORTH No. 21 LAND SURVEYOR
Farnsworth Surveys P.O. BOX 68 BROWNVILLE, VERMONT (802) 484-2131 05077		
DRAWING NO.: 15-2308	FULL SCALE: 1" = 100'	COMPUTED BY: GARCIA-LANES.DWG
DATE: OCT. 7, 2015	DRAWN BY: R.W.F. SURVEY BY: K.E. & E.L.	