

**CERTIFICATE OF HIGHWAY MILEAGE**

**YEAR ENDING FEBRUARY 10, 2005**

Fill out form, make and file copy with the Town Clerk, and mail ORIGINAL, before February 20, 2005 to: VT Agency of Transportation, Program Development Division, Drawer 33, Montpelier, VT 05633.

We, the Selectmen or Aldermen or Trustees of **CHESTER** in **WINDSOR** County

on an oath state that the mileage of highways, according to Title 19, V.S.A, Sec #305, added 1985, is as follows:

**PART I - CHANGES TOTALS - Please fill in and calculate totals.**

| Town Highways  | Previous Mileage | Added Mileage           | Subtracted Mileage | Total                     | Scenic Highways |
|----------------|------------------|-------------------------|--------------------|---------------------------|-----------------|
| Class 1        | 2.500            |                         |                    |                           | 0.000           |
| * Class 1 Lane | 0.000            |                         |                    |                           |                 |
| Class 2        | 12.609           |                         |                    |                           | 0.000           |
| Class 3        | 74.790           | 0.46<br><del>2.83</del> |                    | 75.25<br><del>77.62</del> | 0.000           |
| State Highway  | 19.107           |                         |                    |                           | 0.000           |
| * Class 4      | 7.110            |                         |                    |                           | 0.000           |
| <b>Total</b>   | <b>109.006</b>   |                         |                    | <b>109.466</b>            | <b>0.000</b>    |

\* Class 1 Lane Mileage and Class 4 is NOT included in total. Adjustments by S. Moulton 3/31/05

**PART II - INFORMATION AND DESCRIPTION OF CHANGES SHOWN ABOVE.** See attached correspondence

- NEW HIGHWAYS:** Please attach Selectmen's "Certificate of Completion and Opening".  
 CL 3 TH-130 Dian Cir 0.15      CL 3 TH-132 Regina Ln 0.16  
 CL 3 TH-131 Pleasantview Ln 0.15      Notes by S. Moulton 3/31/05
- DISCONTINUED:** Please attach SIGNED copy of proceedings (minutes of meeting).

3. **RECLASSIFIED/REMEASURED:** Please attach SIGNED copy of proceedings (minutes of meeting).

4. **SCENIC HIGHWAYS:** Please attach a copy of order designating/discontinuing Scenic Highways.

IF THERE ARE NO CHANGES IN MILEAGE: Check box and sign below. [ ]

**PART III - SIGNATURES - PLEASE SIGN.**

Selectmen/ Aldermen/ Trustees Signatures:

*William L. Lindsay*  
*Richard D. Jewett*  
*Seelye W. Morton*  
*Garth P. Stubbins*

Clerk Signature:

*Sandra K. Washburn* Date Filed: **02.02.05**

Please sign ORIGINAL and return it for Transportation signature.

**AGENCY OF TRANSPORTATION APPROVAL:**

Signed copy will be returned to T/C/V Clerk.

APPROVED:

*Michael Dubois*  
 Representative, Agency of Transportation

DATE:

May 20, 2005

- Layers**
- allrds2\_g - rdsmall\_arc
  - E911 rds arc (Mar\_15\_2005)
  - lrs2004.twnmilept Events
  - lrs2004 route.twn
  - hwydist
  - Surface Water - Arcs
  - Surface Water - Polygons
  - Index polygon
  - bndhash region.towns
  - NAIP Color Imagery - 2003
  - Orthophotos

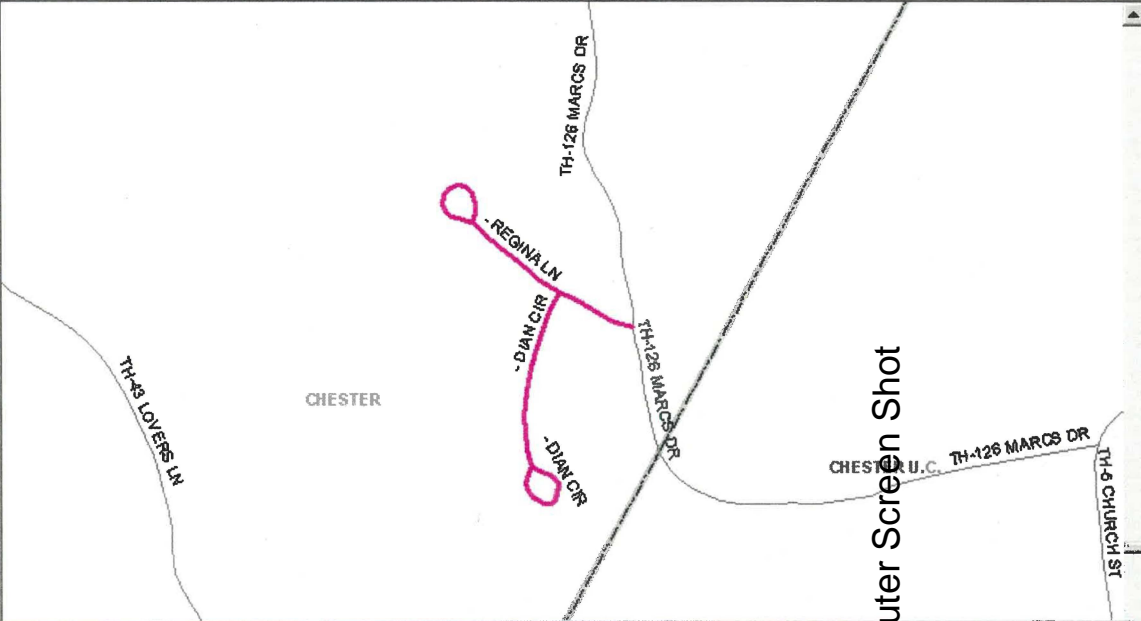

Selected Attributes of allrds2\_g - rdsmall\_arc

| RTNAME | RTNO | HWYSN | CL | SURF | FC | NHS | SC | LRID | CTCODE | UA | RDNAME | RDFNAME   | AOTCLASS | AOTMILES | ARCMILES |
|--------|------|-------|----|------|----|-----|----|------|--------|----|--------|-----------|----------|----------|----------|
| -      | -    | -     | 9  | 3    | 0  | 0   | 0  | 1407 | 1407   | 0  | 545133 | REGINA LN | 8        | 0        | 0.058000 |
| -      | -    | -     | 9  | 3    | 0  | 0   | 0  | 1407 | 1407   | 0  | 545133 | REGINA LN | 8        | 0        | 0.059000 |
| -      | -    | -     | 9  | 3    | 0  | 0   | 0  | 1407 | 1407   | 0  | 545133 | REGINA LN | 8        | 0        | 0.042000 |
| -      | -    | -     | 9  | 3    | 0  | 0   | 0  | 1407 | 1407   | 0  | 545134 | DIAN CIR  | 8        | 0        | 0.093000 |
| -      | -    | -     | 9  | 3    | 0  | 0   | 0  | 1407 | 1407   | 0  | 545134 | DIAN CIR  | 8        | 0        | 0.057000 |

VTrans Computer Screen Shot

sarawork.mxd - ArcMap - ArcInfo

File Edit View Insert Selection Tools Window Help

1:3,612

Spatial Adjustment

100%

**Layers**

- allrds2\_g - rdsmall\_arc
- E911 rds arc (Mar\_15\_2005)
- lrs2004.twnmilept Events
- lrs2004.route.twn
- hwydist
- Surface Water - Arcs
- Surface Water - Polygons
- Index polygon
- bndhash region.towns
- NAIP Color Imagery - 2003
- Orthophotos

**Selected Attributes of allrds2\_g - rdsmall\_arc**

| RTNAME | RTNO | HWYSN | CL | SURF | FC | NHS | SC | LRID | CTCODE | UA     | RDNAME          | RDFLNAME | AOTCLASS | AOTMILES | ARCMILES |
|--------|------|-------|----|------|----|-----|----|------|--------|--------|-----------------|----------|----------|----------|----------|
|        |      |       | 8  | 9    | 0  | 0   | 0  | 1407 | 0      | 545144 | PLEASANTVIEW LN |          | 0        | 0.148000 |          |

Record: 0 | Show: All Selected, Records (1 out of \*2000 Selected.) | Options

Start | Inbox - Micro... | sarawork.m... | Rockingham... | mileage05 : ... | [4] 00:33 - C... | THDATA1\_form | 10:32 AM

VTtrans Computer Screen Shot

**CERTIFICATE OF COMPLETION AND OPENING**  
**OF A HIGHWAY FOR PUBLIC TRAVEL**

\_\_\_\_\_ Sandra K. Walker \_\_\_\_\_, Town Clerk of the Town of Chester, Vermont.

Pursuant to Title 19, V.S.A., this is to certify that the following described section of Class 3 Highway in the Town of Chester was COMPLETED AND OPENED FOR PUBLIC TRAVEL on \_\_\_\_\_ June 17 \_\_\_\_\_, 2004 \_\_\_\_\_.

DESCRIPTION OF RIGHT-OF-WAY: Beginning at Dodge Road and running easterly 480 feet to a cul-de-sac and as shown on a Survey entitled "Pleasant View Ridge," dated March 4, 1988, and recording in land survey File 2, Slot 325.

Name of said road is Pleasant View Lane

*Notes by S. Moulton*

*Existing private road Pleasantview Lane*

*480 ft = 0.091 mi*

*Orthophoto distance = 0.15 mi*

Dated at Chester, County of Windsor, and State of Vermont, this \_\_\_\_\_ 2nd \_\_\_\_\_ day of \_\_\_\_\_ February \_\_\_\_\_, A.D., \_\_\_\_\_ 2005 \_\_\_\_\_.

William L. Lindsay  
Richard D. Jewett ✓  
Seely W. Morton  
Amelia Stoddard

\_\_\_\_\_  
Chester Board of Selectmen

**CERTIFICATE OF COMPLETION AND OPENING**  
**OF A HIGHWAY FOR PUBLIC TRAVEL**

\_\_\_\_\_ Sandra K. Walker \_\_\_\_\_, Town Clerk of the Town of Chester, Vermont.

Pursuant to Title 19, V.S.A., this is to certify that the following described section of Class 3 Highway in the Town of Chester was COMPLETED AND OPENED FOR PUBLIC TRAVEL on October 1, 2003.

DESCRIPTION OF RIGHT-OF-WAY: Beginning at Regina Lane and running 531 feet to a cul-de-sac and as shown on a Survey entitled "Rolling Acres," Chester, VT, dated November 1969, and on Town of Chester Tax Map 54.

Name of said road is Dian Circle

*Existing private road*

*531 ft = 0.101 mi cul-de-sac 0.057*

*Orthophoto distance 0.15 mi*

*Notes by S. Moulton*

Dated at Chester, County of Windsor, and State of Vermont, this 2nd day of February, A.D., 2005.

*William L. LeBoeuf*  
*Richard D. Jewett*  
*Seeley W. Moulton*  
*David R. Stedman*

\_\_\_\_\_  
Chester Board of Selectmen

**CERTIFICATE OF COMPLETION AND OPENING**  
**OF A HIGHWAY FOR PUBLIC TRAVEL**

Sandra K. Walker, Town Clerk of the Town of Chester, Vermont.

Pursuant to Title 19, V.S.A., this is to certify that the following described section of Class 3 Highway in the Town of Chester was COMPLETED AND OPENED FOR PUBLIC TRAVEL on October 1, 2003.

DESCRIPTION OF RIGHT-OF-WAY: Beginning at Marc's Drive and running in a <sup>north westerly</sup> southerly direction 534 feet to a cul-de-sac and as shown on a Survey entitled "Rolling Acres," Chester, VT, dated November 1969, and on Town of Chester Tax Map 54.

Name of said road is Regina Lane

*Existing private road*

*534 ft = 0.101 mi      cul-de-sac 0.058*

*Orthophoto distance 0.16 mi*

*Notes by S. Moulton*

Dated at Chester, County of Windsor, and State of Vermont, this 2nd day of February, A.D., 2005.

William L. Linsday  
Richard D. Jewett

Amelia K. Stubbins  
Seeley W. Morton  
Chester Board of Selectmen

# TOWN OF CHESTER

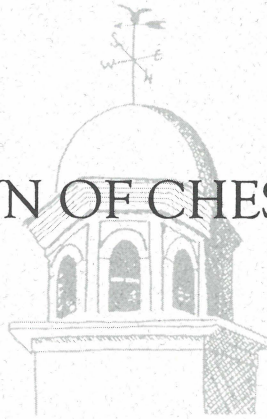

556 Elm Street  
P.O. Box 370  
Chester, VT 05143

(802) 875-2173  
Fax (802) 875-2237

March 25, 2005

Ms. Sara Moulton  
State of Vermont - Agency of Transportation  
National Life Building Drawer 33  
Montpelier, VT 05633-5001

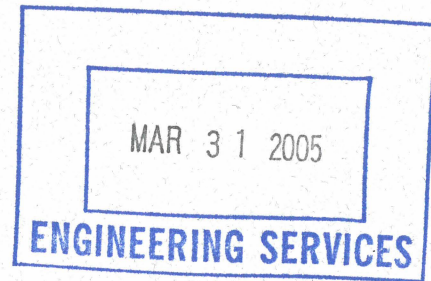

Dear Ms. Moulton:

Your assumption concerning the cul-de-sacs are correct, but we do want to include the mileage.

I will accept your figure with regard for Pleasantview Road rather than our Public Works Director. We frequently tease him because he gets distances wrong only to discover his wheel healy was calibrated poorly.

Sincerely,

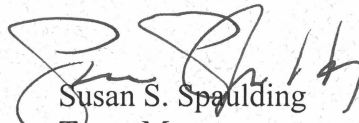
  
Susan S. Spaulding  
Town Manager

SSS:dlc



State of Vermont  
 Agency of Transportation  
 National Life Building  
 Drawer 33  
 Montpelier, VT  
 05633-5001

# VTTrans *Working to Get You There*

Town Clerk  
 Town of Chester  
 PO Box 370  
 Chester, VT 05143

March 11, 2005

Dear Town Clerk:

In reviewing your 2005 Certificate of Highway Mileage, I calculated different mileage amounts for the roads you are adding. There are two levels of questions. One, is that the total mileage I've calculated, based on the Certificates of Completion and Opening of a Highway for Public Travel, is different than the total amount submitted on the Certificate. I calculated a total of 0.293 miles being added to Class 3. You submitted a total of 2.83.

The other question I have, is that there is a noticeable difference between the road distances stated on the Certificates of Opening and the distances in our mapping system based on orthophotos. I've enclosed orthophoto maps of these roads. I'm not sure where the discrepancy for Pleasantview Road is coming from. The differences for Dian Circle and Regina Lane are probably coming from the mileage in the cul-de-sacs. I wanted to double-check that you do not want to include the cul-de-sac areas in the mileage counts.

Reclassified from Private to Class 3

|                   | Distance Listed<br>in Opening<br>Certificate | Feet Distance<br>Converted<br>to Miles | Distance<br>Calculated from<br>Orthophoto |      |
|-------------------|--|--|---|------|
| Pleasantview Road | 480 feet                                     | 0.091 miles                            | 0.148 miles                               | 0.15 |
| Dian Circle       | 531 feet                                     | 0.101 miles                            | 0.150 miles                               | 0.15 |
| Regina Lane       | 534 feet                                     | 0.101 miles                            | 0.159 miles                               | 0.16 |
| Total:            |  | 0.293 miles                            | 0.457 miles                               |      |

*Rounded by  
S. Moulton 3/31/05*

Please let me know if you have any questions.

Sincerely,

*Sara Moulton*

Sara Moulton  
 Mapping & GIS Specialist  
 Program Development Services - Mapping Unit  
 Agency of Transportation  
 Tel: 802-828-2109

www.aot.state.vt.us  
 Telecommunications Relay Service 1-800-253-0191

*Vermont is an Equal Opportunity Employer*



Identify Results

Layers: <Top-most layer>

allroads arc

Location: (491878.737416 84202.405291)

| Field       | Value                          |
|-------------|--------------------------------|
| RTNM        | -                              |
| NO          | -                              |
| HWYSN       | -                              |
| CL          | 8                              |
| ACL         | 8                              |
| SURF        | 9                              |
| FC          | 0                              |
| NHS         | 0                              |
| SC          | 0                              |
| LRID        |                                |
| CTC         | 1407                           |
| UA          | 0                              |
| RD          | 545144                         |
| RDF         | PLEASANTVIEW LN                |
| LM          | 9                              |
| SO          | 24                             |
| FIPS8       | 50027035                       |
| AID         | 450                            |
| UPD         |                                |
| RDM         | 0.148 ← mileage off orthophoto |
| AOTM        | 0                              |
| LADF        | 0                              |
| LADT        | 0                              |
| RADF        | 0                              |
| RADT        | 0                              |
| COMPARE     | 0                              |
| ORIG_ARCID  | 0                              |
| INT_ARCID   | 0                              |
| UPFLAG      |                                |
| RDS_ORIG#   | 408                            |
| NEARDIST    | 0.006447                       |
| COMP        | 0                              |
| INREC#      | 408                            |
| AOTSURFCL   | 89                             |
| LR_ETE_TYP  |                                |
| LR_ETE_NUM  |                                |
| LR_ETE_MOD  |                                |
| LR_ETE_DIR  |                                |
| LR_ETE_SUBT |                                |
| LR_ETE_NID  |                                |
| LR_ETE_AID  |                                |
| FAID        | 50027035 450                   |
| FIPS6       | 027035                         |

Topology: [Tools]

Task: Create New Feature Target: [Tools]

1611869.51 276012.45 Feet

Pleasantview Lane

- transtruc point
- transtruc point - filtered
- BridgeLRS PRIM Events
- BridgeLRS SEC Events
- allroads arc
  - <all other values>
  - SURF
  - 2
  - 3
  - 6
- Highway
- E911\_rds arc

Selected Attributes of allroads arc \_ | B | X

|   | RTNM | NO | HWYSN | CL | ACL | SURF | FC | NHS | SC | LRID | CTC | UA     | RD        | RDF | LM | SO | FIPS8    | AID | UPD | RDM   |
|---|------|----|-------|----|-----|------|----|-----|----|------|-----|--------|-----------|-----|----|----|----------|-----|-----|-------|
| ▶ | -    | -  | -     | 9  | 8   | 3    | 0  | 0   | 0  | 1407 | 0   | 545133 | REGINA LN |     | 1  | 1  | 50027035 | 113 |     | 0.058 |
| - | -    | -  | -     | 9  | 8   | 3    | 0  | 0   | 0  | 1407 | 0   | 545133 | REGINA LN |     | 1  | 1  | 50027035 | 115 |     | 0.059 |
| - | -    | -  | -     | 9  | 8   | 3    | 0  | 0   | 0  | 1407 | 0   | 545133 | REGINA LN |     | 1  | 1  | 50027035 | 117 |     | 0.042 |
| - | -    | -  | -     | 9  | 8   | 3    | 0  | 0   | 0  | 1407 | 0   | 545134 | DIAN CIR  |     | 1  | 1  | 50027035 | 122 |     | 0.093 |
| - | -    | -  | -     | 9  | 8   | 3    | 0  | 0   | 0  | 1407 | 0   | 545134 | DIAN CIR  |     | 1  | 1  | 50027035 | 123 |     | 0.057 |

**Moulton, Sara**

---

**From:** Moulton, Sara  
**Sent:** Thursday, February 17, 2005 12:34 PM  
**To:** 'Susan Spaulding'  
**Subject:** RE: Chester - Attn: Town Clerk

Thank you for your quick response.

Sara Moulton

-----Original Message-----

**From:** Susan Spaulding [mailto:scubed@vermontel.net]  
**Sent:** Thursday, February 17, 2005 12:06 PM  
**To:** Moulton, Sara  
**Subject:** Re: Chester - Attn: Town Clerk

Pleasantview is correct. When I got out my map I found you are right, it does run northwesterly. My perception driving it is that Marc's drive went west but it does not, so you are correct on all counts.

Thanks for your help

----- Original Message -----

**From:** Moulton, Sara  
**To:** 'scubed@vermontel.com'  
**Sent:** Thursday, February 17, 2005 11:27 AM  
**Subject:** Chester - Attn: Town Clerk

We received your completed Certificate of Highway Mileage which included 2.83 miles of added mileage for three Class 3 roads. We also received the Certificates of Completion and Opening of a Highway for Public Travel for these roads.

I have a question about one road which you said was named: Pleasant View Lane. According to E911, it is named Pleasantview Lane. I wanted to double-check which name is the correct one, so we can update our records accordingly.

Also, on your Certificate of Completion for Regina Lane, it states that it begins at Marc's Drive and runs in a southerly direction. In looking on our road centerline and orthophoto information, it looks like it actually runs northwesterly. I am looking in the Marc's Drive - Regina Lane - Dian Circle area. Please let me know if I think our information is incorrect.

Thank you.

*Sara Moulton  
Mapping & GIS Specialist  
Program Development Services - Mapping Unit  
Agency of Transportation  
Tel: 802-828-2109*

- transtruc point
- transtruc point - filtered
- BridgeLRS PRIM Events
- BridgeLRS SEC Events
- VHD-Surface Water - Arcs
- SW
- NHD Reach
- rail\_lrs arc
- allroads arc
  - <all other values>
  - SURF
    - 2
    - 3
    - 6
- Highway
- E911\_rds arc



Selected Attributes of allroads arc

| NO | HWYSN | CL | ACL | SURF | FC | NHS | SC | LRID | CTC | UA     | RD        | RDF                 | LM | SO | FIPS8    | AID | UPD |
|----|-------|----|-----|------|----|-----|----|------|-----|--------|-----------|---------------------|----|----|----------|-----|-----|
|    |       | 9  | 8   | 3    | 0  | 0   | 0  | 1407 | 0   | 545133 | REGINA LN | } ARCMILES<br>0.159 | 1  | 1  | 50027035 | 113 |     |
|    |       | 9  | 8   | 3    | 0  | 0   | 0  | 1407 | 0   | 545133 | REGINA LN |                     | 1  | 1  | 50027035 | 115 |     |
|    |       | 9  | 8   | 3    | 0  | 0   | 0  | 1407 | 0   | 545133 | REGINA LN |                     | 1  | 1  | 50027035 | 117 |     |
|    |       | 9  | 8   | 3    | 0  | 0   | 0  | 1407 | 0   | 545134 | DIAN CIR  | } 0.15              | 1  | 1  | 50027035 | 122 |     |
|    |       | 9  | 8   | 3    | 0  | 0   | 0  | 1407 | 0   | 545134 | DIAN CIR  |                     | 1  | 1  | 50027035 | 123 |     |

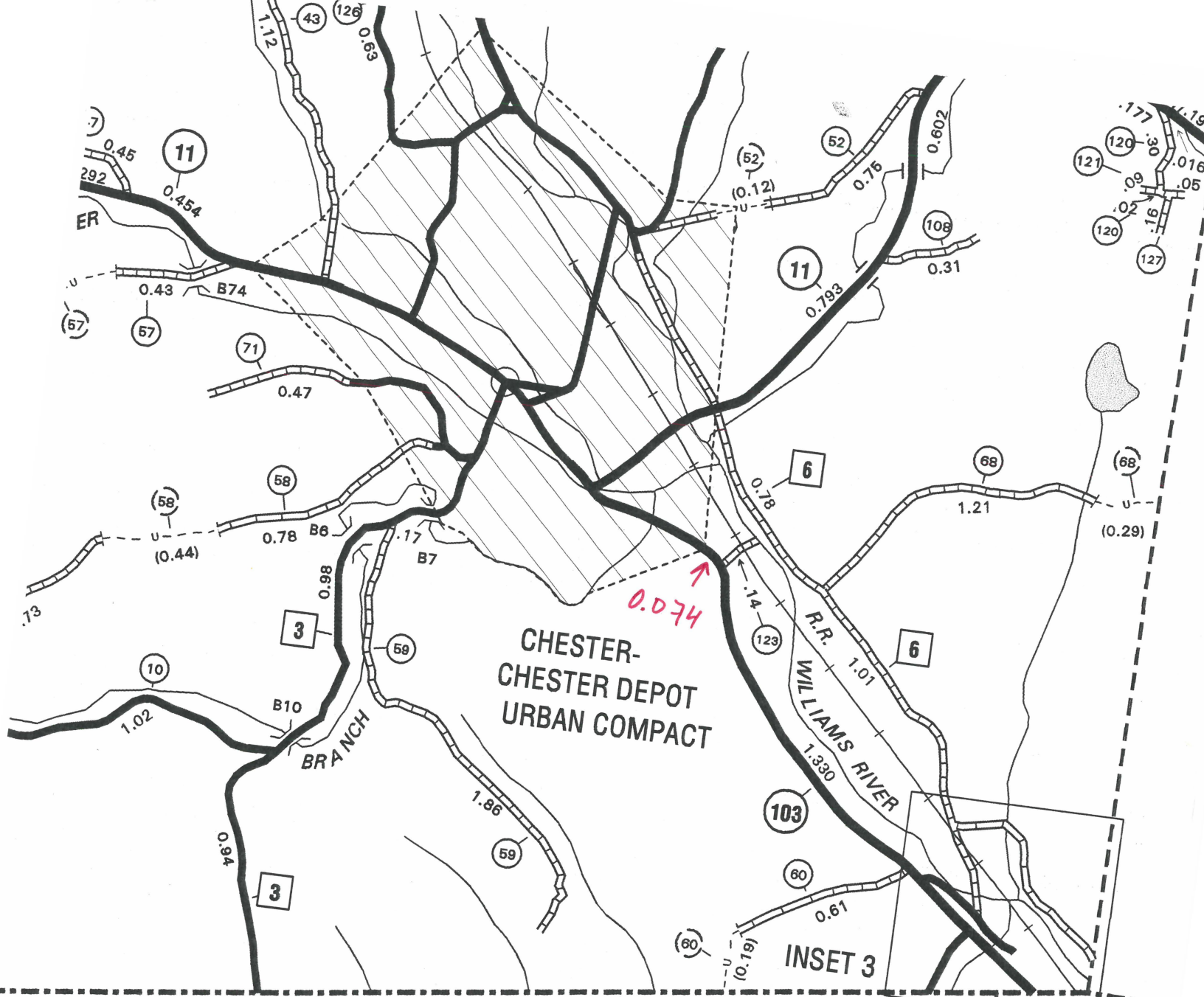

GRAFTON

ROCKING

WINDHAM COUNTY

