

District 3, 4
Certcode 1405-0

**CERTIFICATE OF HIGHWAY MILEAGE
YEAR ENDING FEBRUARY 10, 2019**

Fill out form, make and file copy with the Town Clerk, and mail ORIGINAL, before February 20, 2019 to:
Vermont Agency of Transportation, Division of Policy, Planning and Intermodal Development, Mapping Section
One National Life Drive, Montpelier, VT 05633.

We, the members of the legislative body of BRIDGEWATER in WINDSOR County
on an oath state that the mileage of highways, according to Vermont Statutes Annotated, Title 19, Section 305,
added 1985, is as follows:

PART I - CHANGES TOTALS - Please fill in and calculate totals.

Town Highways	Previous Mileage	Added Mileage	Subtracted Mileage	Total	Scenic Highways
Class 1	0.000				0.000
Class 2	8.610				0.000
Class 3	36.70				0.000
State Highway	10.689				0.000
Total	55.999				0.000
* Class 1 Lane	0.000				
* Class 4	10.36		0.50	9.86	0.000
* Legal Trail	1.22				

* Mileage for Class 1 Lane, Class 4, and Legal Trail classifications are NOT included in total.

PART II - INFORMATION AND DESCRIPTION OF CHANGES SHOWN ABOVE.

1. NEW HIGHWAYS: Please attach Selectmen's "Certificate of Completion and Opening".
2. DISCONTINUED: Please attach SIGNED copy of proceedings (minutes of meeting).
3. RECLASSIFIED/REMEASURED: Please attach SIGNED copy of proceedings (minutes of meeting).
4. SCENIC HIGHWAYS: Please attach a copy of order designating/discontinuing Scenic Highways.

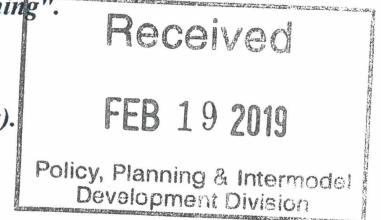

IF THERE ARE NO CHANGES IN MILEAGE: Check box and sign below. []

PART III - SIGNATURES - PLEASE SIGN.

Selectmen/ Aldermen/ Trustees Signatures:

Lynne Bentham
Morna March II
Mary Odenburg

T/C/V Clerk Signature:

Kerrey Johnson

Date Filed:

Feb 12, 2019

Please sign ORIGINAL and return it for Transportation signature.

AGENCY OF TRANSPORTATION APPROVAL:

Signed copy will be returned to T/C/V Clerk.

APPROVED:

Representative, Agency of Transportation

DATE:

4/18/2019

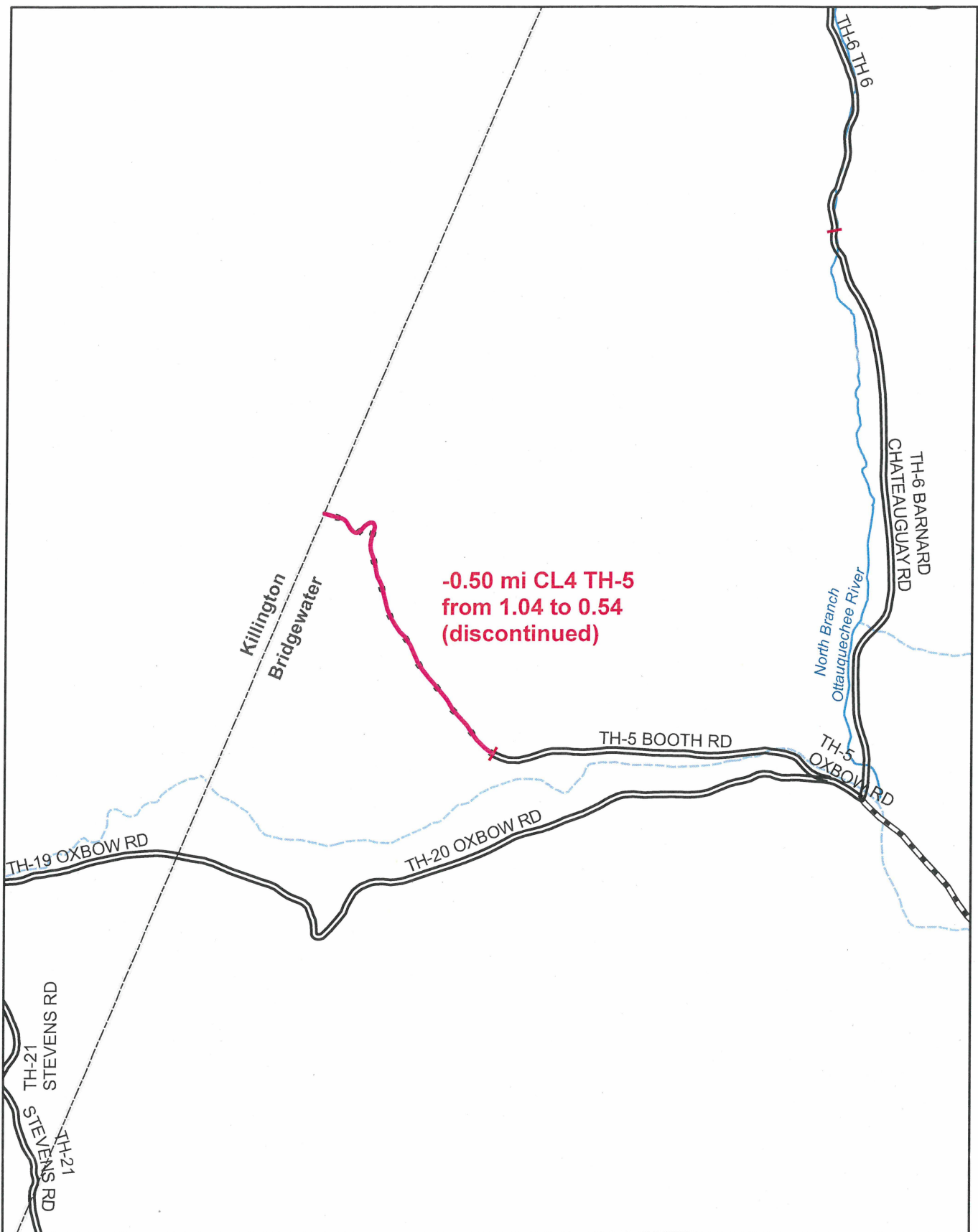

**Mileage Certificate Change 2019
BRIDGEWATER**

(CTUA: 1405-0)

Mapping Section
 Division of Policy, Planning and Intermodal Development
 Vermont Agency of Transportation - February 2019

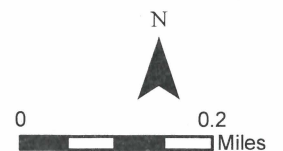

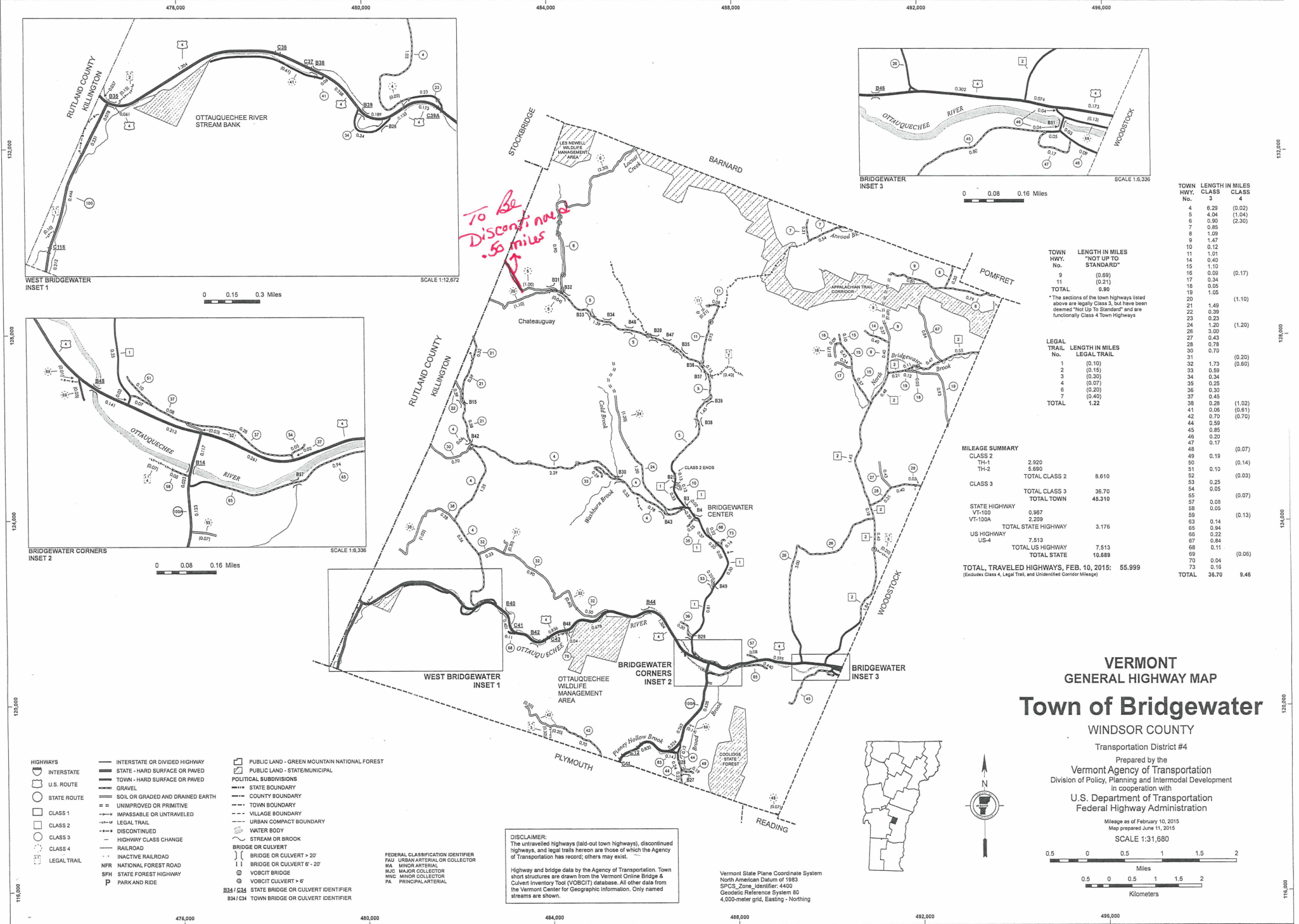

- HIGHWAYS**
- INTERSTATE OR DIVIDED HIGHWAY
 - INTERSTATE
 - U.S. ROUTE
 - STATE ROUTE
 - CLASS 1
 - CLASS 2
 - CLASS 3
 - CLASS 4
 - LEGAL TRAIL
 - DISCONTINUED
 - HIGHWAY CLASS CHANGE
 - RAILROAD
 - INACTIVE RAILROAD
 - NFR NATIONAL FOREST ROAD
 - SFH STATE FOREST HIGHWAY
 - P PARK AND RIDE
- BRIDGE OR CULVERT**
- BRIDGE OR CULVERT > 20'
 - BRIDGE OR CULVERT 6' - 20'
 - VOBICIT BRIDGE
 - VOBICIT CULVERT > 6'
- PUBLIC LAND - GREEN MOUNTAIN NATIONAL FOREST**
- PUBLIC LAND - STATE/MUNICIPAL
- POLITICAL SUBDIVISIONS**
- STATE BOUNDARY
 - COUNTY BOUNDARY
 - TOWN BOUNDARY
 - VILLAGE BOUNDARY
 - URBAN COMPACT BOUNDARY
- FEDERAL CLASSIFICATION IDENTIFIER**
- FAJ URBAN ARTERIAL OR COLLECTOR
 - MA MINOR ARTERIAL
 - M2C MAJOR COLLECTOR
 - M2C MINOR COLLECTOR
 - PA PRINCIPAL ARTERIAL
- BRIDGE OR CULVERT IDENTIFIER**
- B34/B24 STATE BRIDGE OR CULVERT IDENTIFIER
 - B34/C24 TOWN BRIDGE OR CULVERT IDENTIFIER

DISCLAIMER:
 The untraveled highways (old-out town highways), discontinued highways, and legal trails herein are those of which the Agency of Transportation has record; others may exist.
 Highway and bridge data by the Agency of Transportation, Town short structures are drawn from the Vermont Online Bridge & Culvert Inventory Tool (VOBCIT) database. All other data from the Vermont Center for Geographic Information. Only named streams are shown.

Vermont State Plane Coordinate System
 North American Datum of 1983
 SPCS_Zone_Identifier: 4400
 Geodetic Reference System: 80
 4,000-meter grid, Easting - Northing

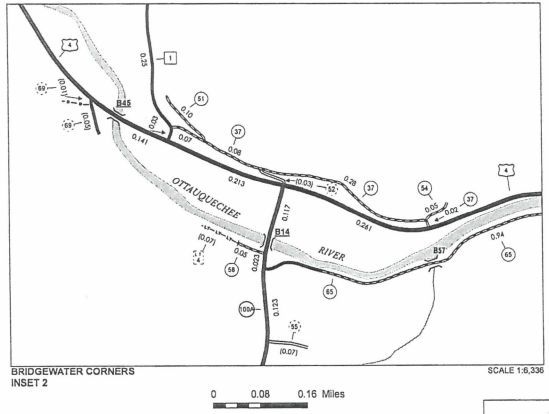
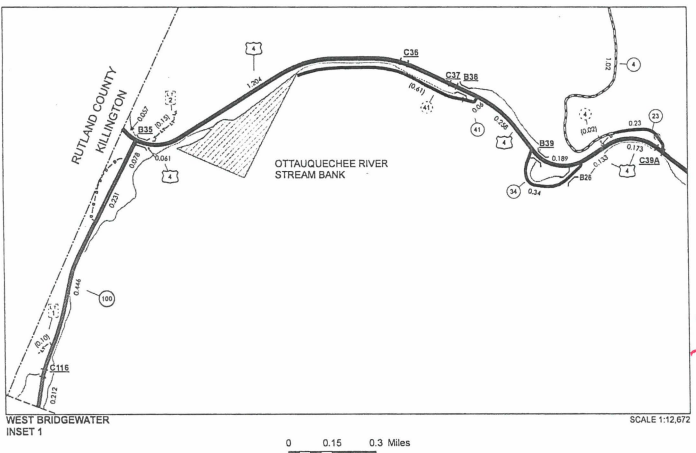
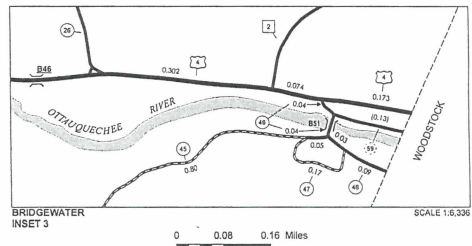

TOWN HWY. No.	LENGTH IN MILES CLASS 3	LENGTH IN MILES CLASS 4
4	8.29	(0.02)
5	4.04	(1.04)
7	0.90	(2.30)
8	0.85	
8	1.09	
9	1.47	
10	1.12	
11	1.01	
14	0.40	
15	1.10	
9	0.69	(0.17)
11	0.21	
18	0.05	
19	1.05	
21	1.49	(1.10)
22	0.39	
23	0.23	
24	1.20	(1.20)
26	3.00	
27	0.43	
28	0.78	
30	0.70	
31	1.73	(0.20)
32	1.10	(0.60)
33	0.59	
34	0.34	
4	0.07	
6	0.20	
37	0.45	
38	0.28	(1.02)
41	0.05	(0.61)
42	0.70	(0.70)
44	0.59	
45	0.85	
46	0.20	
47	0.17	
48	0.19	(0.07)
50	0.10	(0.14)
51	0.10	(0.03)
52	0.25	
53	0.25	
54	0.05	(0.07)
55	0.08	
57	0.08	
58	0.05	
63	0.14	(0.13)
65	0.94	
66	0.22	
67	0.84	
68	0.11	(0.06)
69	0.04	
70	0.04	
73	0.15	
TOTAL	36.70	9.46

TOWN	LENGTH IN MILES
3	0.90
9	0.69
11	0.21
TOTAL	1.80

* The sections of the town highways listed above are legally Class 3, but have been deemed "Not Up To Standard" and are functionally Class 4 Town Highways

MILEAGE SUMMARY

CLASS 2	CLASS 2	CLASS 2	CLASS 2
TH-1	2,920		
TH-2	5,690		
TOTAL CLASS 2	8,610		
TOTAL CLASS 3	36.70		
TOTAL TOWN	45.310		
STATE HIGHWAY			
VT-100	0.967		
VT-100A	2,209		
TOTAL STATE HIGHWAY	3,176		
US HIGHWAY			
US-4	7,513		
TOTAL US HIGHWAY	7,513		
TOTAL STATE	10,689		
TOTAL TRAVELED HIGHWAYS, FEB. 10, 2015:	55,999		
(Excludes Class 4, Legal Trail, and Undeveloped Corridor Mileage)			

VERMONT GENERAL HIGHWAY MAP
Town of Bridgewater

WINDSOR COUNTY
 Transportation District #4

Prepared by the
 Vermont Agency of Transportation
 Division of Policy, Planning and Intermodal Development
 in cooperation with
 U.S. Department of Transportation
 Federal Highway Administration

Map prepared June 11, 2015

SCALE 1:31,680

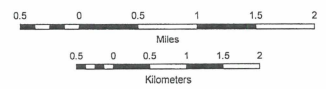

Town Highway/Legal Trails Addition/Reclassification/Discontinuance Checklist

The following includes a checklist of the documentation to be supplied to the Vermont Agency of Transportation (VTrans) when adding / reclassifying / discontinuing highways and trails. The documentation is subject to verification by VTrans.

Check the box if the information is included as part of the documentation submitted.

- A description of the affected highway or trail
Vt. Stat. Ann. tit. 19, § 305(e)
 - A current town highway map with the requested deletions and additions sketched on it
Vt. Stat. Ann. tit. 19, § 305(e)
 - Minutes of meetings at which the legislative body took action with respect to the changes (include copies of the meeting minutes) Vt. Stat. Ann. tit. 19, § 305(e)
 - Evidence of written notice to adjoining landowners (include a copy of the newspaper notice and a copy of the letter sent to adjoining landowners)
Vt. Stat. Ann. tit. 19, § 709
 - A copy of any surveys of the affected highway or trail
Vt. Stat. Ann. tit. 19, § 305(e) Vt. Stat. Ann. tit. 19, § 704
-
- For Class 3 or Class 4 town highway additions
A Certificate of Completion and Opening
While not required by statute, a Certificate of Completion and Opening form is a helpful document for the record.

All records filed with the agency are subject to verification in accordance with 19 V.S.A. § 305 (a) and 19 V.S.A. § 305 (e).

Vermont Agency of Transportation
Division of Policy, Planning and Intermodal Development, Mapping Section
1 National Life Drive, Montpelier, VT 05633-5001

BRIDGEWATER TOWN CLERK'S OFFICE

TOWN OF BRIDGEWATER
CHATEAUGUAY ROAD PORTION OF
CLASS 4 DISCONTINUANCE
OCTOBER 30, 2018

Res'd for Record Dec 3 2018 A.D.
At 11 o'clock 00 minutes A M.
Recorded in Book 97 Page 15-17
Attest: Nancy Robinson Town Clerk

Draft

4:00 pm Site Visit to Chateauguay Road, Class 4 section at the property line of Theodore Schulze and James & Lisa Blanchard. Present were Lynne Bertram, Mary Oldenburg, Randy Kennedy, Nancy Robinson, James Blanchard, Theo, Danielle and William Schulze.

Road hearing was called to order at 5:00 PM by Mary Oldenburg, Vice Chair
Present: Lynne Bertram, Randy Kennedy and Nancy Robinson, Theodore Schulze and Bruce Maxham

The Selectboard initiated this process per 19 V.S.A. 708(a) after discussions of road maintenance of the class 4 portion of the road. The total Class 4 mileage is 1.04 miles and approx. .50 miles of this road travels through the land of Theo Schulze. Mr. Schulze would like to maintain the one-half mile that his property abuts and be able to install a gate at his property line. (see attached map)

A site visit and hearing were scheduled for October 30, 2018 at 4:00 pm and 5:00 pm respectively. Notice of hearing was sent to the four property owners that abut the road (Theodore Schulze, James & Lisa Blanchard, Warren & Marjorie Blanchard and Ronald & Deborah Morse) by certified mail on September 29, 2018 per 19 V.S.A. 709. Notices were posted at the Town Office, Bridgewater Corners Post Office and Bridgewater Post Office and sent to the Municipal Planning Commission Chair and State of Vermont Parks and Recreation Department on September 29, 2018. Notice was also published in the VT Standard on October 18, 2018. Notice was also sent to the Town of Killington for informational purposes as Mr. Schulze owns property in Killington, although the road does not extend into Killington.

James Blanchard did not attend the hearing but had expressed concerns at the site visit about the turn around and location of the gate as he feels that the current proposed site may be on his property. Mr. Blanchard is in hopes of having his property surveyed in the spring to determine his west property line which will assist Mr. Schulze with the location of the placement of the gate. Mr. Blanchard would like a written agreement/easement regarding the turnaround site stating that it will always remain at the fork in the road and any expansion will be on the south side (Schulze property) not on the north side (Blanchard property). Town will also need this turn around area if road is discontinued for any future Class 4 work done on the road. Town Attorney Barlow will be asked to prepare an easement from Mr. Schulze to the Town for the turnaround area. Also discussed was the placement of signs, "Dead End Road" installed at beginning of road, "Turn Around Here" at gate and "Gate Ahead-Private Road". Mr. Schulze was agreeable to these terms.

Being no further comments, Mary moved to close the hearing at 5:15 pm. Lynne seconded the motion and motion carried. Members present were informed that the board would enter into deliberative session to make its decision based on the evidence provided and will issue a written decision with findings as required by 19 V.S.A. 711 (a).

Board members entered into deliberative session at 5:16 pm. Returned to open meeting at 5:20 pm. Requested that Nancy send information to Attorney Barlow for formal written decision.

Hearing adjourned at 5:20 pm.

Respectfully submitted,
Nancy Robinson, Clerk

Nancy Robinson

**TOWN OF BRIDGEWATER, VERMONT
ORDER OF DISCONTINUANCE OF A PORTION OF
CHATEAUGUAY ROAD (T.H. 5)**

WHEREAS, on September 25, 2018, the Town of Bridgewater Selectboard, on its own motion, initiated proceedings to consider discontinuing approximately one-half mile of Chateaugay Road (T.H. 5), beginning at the boundary between the lands of James and Lisa Blanchard and Theodore M. Schulz and continuing to the end of Chateaugay Road at the Killington town line; and,

WHEREAS, notices of the time and date for examining the premises and hearing persons interested were sent in accordance with 19 V.S.A. §§709 and 775, namely by mailing notice via certified mail to each interested person at least thirty days in advance, by giving notice to the Bridgewater Planning Commission and the Vermont Department of Forests, Parks, and Recreation, by posting a copy of the notice in the office of the Bridgewater Town Clerk, and by causing a copy of the notice to be published in The Vermont Standard, a local newspaper of general circulation in the area, not less than ten days before the time set for the hearing; and,

WHEREAS, on October 30, 2018, the Selectboard conducted its examination of the premises and the hearing and took testimony regarding whether the discontinuance would serve the public good, necessity, and convenience of the inhabitants of the Town of Bridgewater;

NOW, THEREFORE, based upon the inspection and the evidence presented at the hearing, the Bridgewater Selectboard makes the following findings of fact:

1. The Class 4 section of Chateaugay Road (T.H. 5) begins at the intersection of Oxbow Road (T.H. 20), and proceeds in a westerly and northwesterly direction approximately 1.04 miles to the Killington town line, as depicted on the plan titled "Vermont General Highway Map Town of Bridgewater," prepared by the Vermont Agency of Transportation and dated June 11, 2015.

2. The portion of Chateaugay Road considered by the Selectboard for discontinuation is that section of the Class 4 section beginning at the boundary between the lands of James Blanchard and Lisa Blanchard and Theodore M. Schulze and continuing to the end of Chateaugay Road at the Killington town line. Reference is hereby made to the following in aid of the location of the boundary between the lands of James Blanchard and Lisa Blanchard and Theodore M. Schulze:

(a) Warranty Deed from Warren J. Blanchard, Jr. and Marjorie E. Blanchard to James Blanchard and Lisa Blanchard, husband and wife, dated August 20, 2015, and recorded at Book 92, Page 41 of the Bridgewater Land Records.

(b) Warranty Deed from Mary A. Blanchard to James Blanchard and Lisa Blanchard, husband and wife, dated August 20, 2015, and recorded at Book 92, Page 45 of the Bridgewater Land Records.

(c) Warranty Deed of Mary B. Jenne, Trustee of the 2000 Inter Vivos Trust Agreement of Mary B. Jenne U.T.A. January 19, 2000 and Warren N. Jenne and Michael Mongulla, Co-Trustees of the 1996 Inter Vivos Trust Agreement of Harlan H. Booth, U.T.A. June 6, 1996 to Theodore M. Schulze dated October 26, 2015 and recored at Book 92, Pages 320-323 of Bridgewater Land Records.

3. This section of Chateaugay Road is abutted on both sides by property owned by Theodore M. Schulze. The road ends at the Killington town line and does not connect with any roads in Killington.

4. As a Class 4 town highway, this section of Chateauguay Road receives minimal maintenance and is not plowed by the Town in the winter; because it serves only one property and ends at the Killington town line, this section of Chateauguay Road is minimally travelled.

5. There are no bridges on this section of Chateauguay Road and no other infrastructure (e.g., retaining walls, box culverts) in which the Town has made any significant investment of public funds. No public resources or assets (e.g., state-owned land or town forest) are served by this section of Chateauguay Road.

6. Discontinuing this section of Chateauguay Road will relieve the Town of any future obligation to maintain or upgrade the road, thereby reducing the burden on taxpayers.

7. Mr. Schulze supports discontinuance of this section of Chateauguay Road and is willing to provide the Town an easement for a vehicle turn-around area on his property.

8. Neither the Bridgewater Planning Commission, nor the Vermont Department of Forest, Parks, and Recreation has objected to the proposed discontinuance.

9. No party will be entitled to damages as a result of the discontinuance. Damages are not available in the case of a discontinuance because the abutting property owners are not relinquishing or being deprived of property rights.

WHEREFORE, based on these findings, and pursuant to 19 V.S.A. §710, the Selectboard orders that the portion of the Class 4 section of Chateauguay Road beginning at the boundary between the lands of James Blanchard and Lisa Blanchard and Theodore M. Schulze and continuing from that point to the end of Chateauguay Road at the Killington town line is hereby discontinued.

This Order and its incorporated findings, together with a copy of the minutes of the Selectboard's October 30, 2018, hearing, shall be filed with the Bridgewater Town Clerk for recording. A copy of this Order shall also be mailed, via first class mail, to each person who received written notice of the Selectboard's October 30, 2018, examination and hearing.

DATED at Bridgewater, Vermont this 28 day of November, 2018.

TOWN OF BRIDGEWATER
SELECTBOARD

By: Norman Martin II
Norman Martin II, Chair

By: Mary Oldenburg
Mary Oldenburg, Vice Chair

By: Lynne Bertram
Lynne Bertram



TOWN OF BRIDGEWATER

7335 US ROUTE 4
BRIDGEWATER, VERMONT 05034
802 672-3334 FAX: 802 672-5395

September 27, 2018

The Town of Bridgewater Selectboard has voted to hold a public hearing and site visit pertaining to the discontinuance of a portion of the Class 4 section of the Chateaugay Road. The discontinued section of road is approx one half mile in length, where the road crosses the boundary between the properties of Theodore Schulze and James and Lisa Blanchard continuing west to the end of the road.

The site visit will take place on Tuesday, October 30, 2018 at 4:00 pm and the hearing will follow at approx. 5:00 pm. (see attached notice)

Please contact the Town Office at the above number should you have any questions or concerns.

Regards,

Nancy Robinson
Administrative Assistant

VERMONT STANDARD—WOODSTOCK VERMONT

THURSDAY OCTOBER 18 2018

TOWN OF BRIDGEWATER

NOTICE OF PUBLIC HEARING FOR THE PURPOSE OF DISCONTINUING A SECTION OF THE CLASS 4 PORTION OF TOWN HIGHWAY #5, KNOWN AS CHATEAUGUAY ROAD

Notice is hereby given that the Bridgewater Selectboard will hold a public hearing and conduct a site visit on October 30, 2018 for the purpose of inspecting lands and hearing testimony and comment on the discontinuance of a section of the Class 4 portion of Chateauguay Road known as TH # 5 and being approx. one-half mile in length where the road crosses the boundary between the properties of Theodore Schulze and James and Lisa Blanchard continuing west to the end of the road.

Site inspection will take place at 4:00 PM and hearing will immediately follow at approx. 5:00 PM at the Bridgewater Town Office.

Dated: September 25, 2018

Bridgewater Selectboard:

Norman Martin II. Chairman

Mary Oldenburg

Lynne Bertram

June 28, 2018