

**CERTIFICATE OF HIGHWAY MILEAGE  
YEAR ENDING FEBRUARY 10, 2016**

Fill out form, make and file copy with the Town Clerk, and mail ORIGINAL, before February 20, 2016 to:  
Vermont Agency of Transportation, Division of Policy, Planning and Intermodal Development, Mapping Section  
One National Life Drive, Montpelier, VT 05633.

We, the members of the legislative body of **MARLBORO** in **WINDHAM** County  
on an oath state that the mileage of highways, according to Vermont Statutes Annotated, Title 19, Section 305,  
added 1985, is as follows:

**PART I - CHANGES TOTALS - Please fill in and calculate totals.**

Town Highways	Previous Mileage	Added Mileage	Subtracted Mileage	Total	Scenic Highways
Class 1	0.000				0.000
Class 2	14.950				0.000
Class 3	39.56	0.17		39.73	0.000
State Highway	8.304				0.000
<b>Total</b>	<b>62.814</b>			<b>62.984</b>	<b>0.000</b>
* Class 1 Lane	0.000				
* Class 4	1.54				0.000
* Legal Trail	0.84				

\* Mileage for Class 1 Lane, Class 4, and Legal Trail classifications are NOT included in total.

**PART II - INFORMATION AND DESCRIPTION OF CHANGES SHOWN ABOVE.**

Notes by:  
S. Moulton  
2/10/2016

- NEW HIGHWAYS:** Please attach Selectmen's "Certificate of Completion and Opening".
- DISCONTINUED:** Please attach SIGNED copy of proceedings (minutes of meeting).
- RECLASSIFIED/REMEASURED:** Please attach SIGNED copy of proceedings (minutes of meeting).  
enclosed + 0.17 CL3 TH-51 Gilbert Rd
- SCENIC HIGHWAYS:** Please attach a copy of order designating/discontinuing Scenic Highways.

IF THERE ARE NO CHANGES IN MILEAGE: Check box and sign below. [ ]

**PART III - SIGNATURES - PLEASE SIGN.**

Selectmen/ Aldermen/ Trustees Signatures:

*Andy Reichsman*  
Andy Reichsman, Chair  
*Tyler Gibbons*  
Tyler Gibbons  
*Pieter van Loon*  
Pieter van Loon  
*Tjep Jellema*  
Tjep Jellema

T/C/V Clerk Signature:

*[Signature]*

Date Filed: February 1, 2016

Please sign ORIGINAL and return it for Transportation signature.

**AGENCY OF TRANSPORTATION APPROVAL:** Signed copy will be returned to T/C/V Clerk.

APPROVED:

*[Signature]*  
Representative, Agency of Transportation

DATE:

5/12/2016

**Received**

**FEB 04 2016**

**Policy, Planning & Intermodal  
Development Division**

**Vermont Statutes Annotated**

**19 V.S.A. § 305. Measurement and inspection**

**§ 305. Measurement and inspection**

(a) After reasonable notice to the selectboard, a representative of the agency may measure and inspect the class 1, 2, and 3 town highways in each town to verify the accuracy of the records on file with the agency. Upon request, the selectboard or their designee shall be permitted to accompany the representative of the agency during the measurement and inspection. The agency shall notify the town when any highway, or portion of a highway, does not meet the standards for its assigned class. If the town fails, within one year, to restore the highway or portion of the highway to the accepted standard, or to reclassify, or to discontinue, or develop an acceptable schedule for restoring to the accepted standards, the agency for purposes of apportionment under section 306 of this title shall deduct the affected mileage from that assigned to the town for the particular class of the road in question.

(b) Annually, on or before February 10, the selectboard shall file with the town clerk a sworn statement of the description and measurements of all class 1, 2, 3, and 4 town highways and trails then in existence, including any special designation such as a throughway or scenic highway. When class 1, 2, 3, or 4 town highways, trails, or unidentified corridors are accepted, discontinued, or reclassified, a copy of the proceedings shall be filed in the town clerk's office and a copy shall be forwarded to the agency.

(c) All class 1, 2, 3, and 4 town highways and trails shall appear on the town highway maps by July 1, 2015.

(d) At least 45 days prior to first including a town highway or trail that is not clearly observable by physical evidence of its use as a highway or trail and that is legally established prior to February 10, 2006 in the sworn statement required under subsection (b) of this section, the legislative body of the municipality shall provide written notice and an opportunity to be heard at a duly warned meeting of the legislative body to persons owning lands through which a highway or trail passes or abuts.

(e) The agency shall not accept any change in mileage until the records required to be filed in the town clerk's office by this section are received by the agency. A request by a municipality to the agency for a change in mileage shall include a description of the affected highway or trail, a copy of any surveys of the affected highway or trail, minutes of meetings at which the legislative body took action with respect to the changes, and a current town highway map with the requested deletions and additions sketched on it. A survey shall not be required for class 4 town highways that are legally established prior to February 10, 2006. All records filed with the agency are subject to verification in accordance with subsection (a) of this section.

(f) The selectboard of any town who are aggrieved by a finding of the agency concerning the measurement, description, or classification of a town highway may appeal to the transportation board by filing a notice of appeal with the executive secretary of the transportation board.

(g) The agency shall provide each town with a map of all of the highways in that town together with the mileage of each class 1, 2, 3, and 4 highway, as well as each trail, and such other information as the agency deems appropriate

Excerpt of 19 V.S.A. § 305 - *Measurement and inspection* from Vermont Statutes Online located at – <http://legislature.vermont.gov/statutes/section/19/003/00305>

December 2015

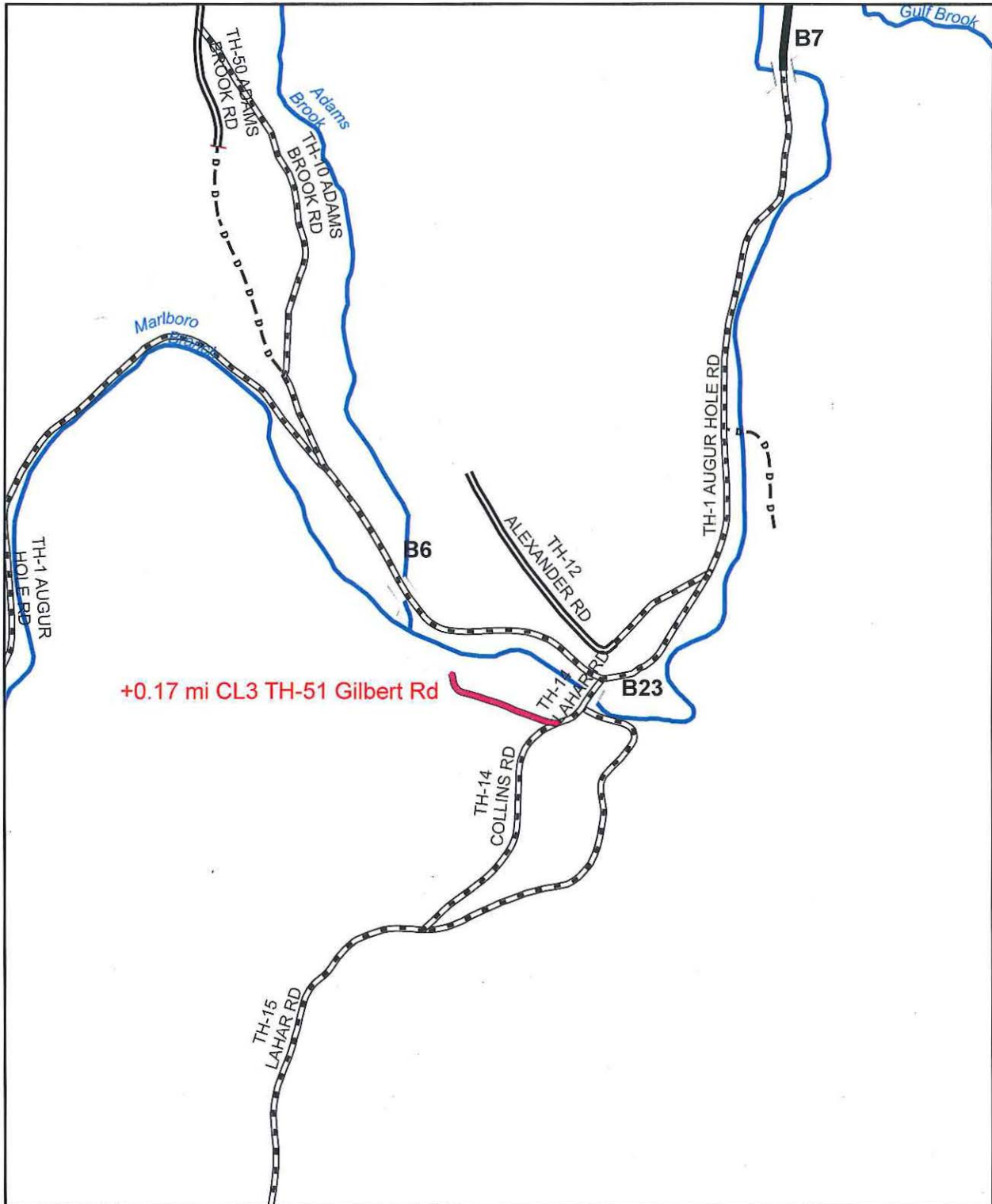

+0.17 mi CL3 TH-51 Gilbert Rd

### Mileage Certificate Change MARLBORO

(CTCODE: 1311)

Mapping Section  
 Division of Policy, Planning and Intermodal Development  
 Vermont Agency of Transportation - February 2016

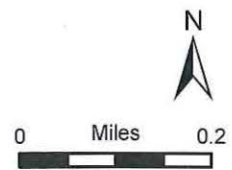

TOWN OF MARLBORO  
Select Board Report  
Decision to Reclassify a Section of Gilbert Road  
November 19, 2015

At 3:00 PM. on October 8, 2015, the Select Board held a site inspection, and at 4:30 PM. convened a hearing at the Marlboro Town Office for the purpose of taking testimony on whether the public good, necessity and convenience of the inhabitants of Marlboro require the reclassification of a private portion of Gilbert Road.

Present at the site inspection were Select Board members Andy Reichsman, chair; Tyler Gibbons and Pieter van Loon. Also present were abutting landowners Bob LeBlond, Bob Gilbert and Peggy Tiffany. Also present were David Elliott, Road Foreman and Marcia Hamilton, Select Board Assistant. Present at the hearing were Select Board members Andy Reichsman, chair; Tyler Gibbons and Pieter van Loon. Also present were abutting landowner Bob Gilbert, David Elliott, Road Foreman and Marcia Hamilton, Select Board Assistant.

History: The road was originally laid out May 9, 1791 (Vol. 1, Town Records) and was part of the original Augur Hole Road that coursed north to the Newfane Town Line. On January 26, 1971 (almost 200 years later) the Select Board requested the State add the Gilbert road portion to the Certificate of Highway Mileage and official Town map. A letter from the State indicates not all provisions were met and the road was not added. Somehow the action was not pursued by the Select Board. However, the Town highway department, not realizing the provisions were not met, maintained the road as intended as though it had been added to the Town highway system. In the recent past, Gilbert Road was discontinued automatically by the Ancient Roads legislation. When the discrepancy was brought to light in 2015, the Select Board initiated this action to bring a specific portion of Gilbert road into the Town highway system.

The Select Board gave more than thirty days' notice, by certified mail, to persons owning or interested in lands abutting Gilbert Road. It also gave notice to the Town Planning Commission and Town Road Foreman; posted copies of the notice inside and outside of the Town Clerk's office and on the Town Web Site; and caused a notice to be published in the *Brattleboro Reformer*, on Tuesday, September 29, 2015, which, as required, is not less than ten days before the time set for the hearing on October 8, 2015.

During the hearing the intent of the action to reclassify a portion of Gilbert Road was restated. Throughout the process all parties were in agreement to bring the section of road into the Town highway system. Over the last 44 years since 1971 various Select Board members and Town highway personnel accepted the specific section of Gilbert Road as already a Town highway. At the hearing, the board voted to hire a surveyor to survey the road from the fork at Collins Road to the turn-around used by the Town highway vehicles, a distance of approximately 898.58 feet.

As discontinuance does not allow compensation, only the question of whether the public good, necessity, and convenience of the inhabitants was addressed.

The surveyor met with the Select Board at a regularly scheduled meeting and his survey proposal was accepted by the board. The surveyor met with the Road Foreman on site to review the beginning and end points. The surveyor then surveyed the road and presented the board with the survey and description. The board reviewed and voted to accept the survey plat and description on December 3, 2015

Based on the evidence presented at the hearing, the Board makes the following findings and decision:

1. The road has been maintained for more than 44 years under the assumption that it was already a Town road.
2. All participants at the site inspection and hearing were in favor of adding the approximately 898.58 feet of Gilbert Road to the Town highway system. There are five abutters and there was no opposition to the proposed action orally or in writing.
3. Bob Gilbert stated the road was originally owned by the Gilbert Family and they wish to turn the road over to the Town.

It is the decision of the Select Board to reclassify the approximately 898.58 feet to Class 3, as it already meets the standards and has been maintained as a Class 3 road for more than 44 years. The board concludes that the public good, necessity, and convenience of the inhabitants will be served by adding this section of road to the Town Highway system.

As those portions of Gilbert Road that are the subject of this action by the Marlboro Select Board are public rights-of-way by action of dedication and acceptance, the Select Board awards no compensation for any changes to the status, character, or classification of the road.

Any interested person affected by this decision may be entitled to appeal this decision in writing within 30 days of the date it is signed to the Windham Unit of the Civil Division of the Vermont Superior Court, upon payment of a fee, through V.R.C.P. 74 or 75.

Dated: December 3, 2015 at Marlboro, Vermont.

TOWN OF MARLBORO SELECT BOARD

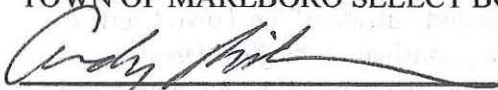
  
Andy Reichsman, Chair

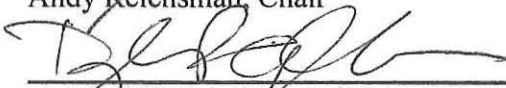
  
Tyler Gibbons

  
Pieter van Loon

TOWN OF MARLBORO  
Select Board Hearing, Gilbert Road  
Thursday, October 8, 2015

ATTENDANCE

(At the Hearing) Present were select board members Andy Reichsman, Tyler Gibbons and Pieter van Loon. Also present were David Elliott, Road Foreman; Bob Gilbert, resident on Gilbert Road; and Marcia Hamilton, Select Board Assistant.

(At the Site Inspection): All of the above were present at the Site Inspection. Also present were Bob LaBlond and Peggy Tiffany, abutting landowners.

The hearing was called to order at 4:34 PM to receive testimony and hear all persons interested in bringing a specific portion of Gilbert road into the Town highway system. The road site inspection was held this day at 3:00 PM.

Andy Reichsman, chair, administered the oath to all persons present who affirmed that the evidence given relative to the cause now under consideration shall be the whole truth and nothing but the truth, under the pains and penalties of perjury.

David Elliott stated the Highway Department has been maintaining the road at least since 1991, when he was appointed Road Foreman. During that time he thought the road was a Town road because it was maintained by the Town under the leadership of the previous Road Foreman. He feels the Town should continue to maintain the road. He measured the portion of the road under consideration to be approximately 824 feet

Bob Gilbert stated the road was originally owned by Gilberts (his father before him) and they turned over the road to the town. He thinks the proposed Town portion of the road benefits the Town.

Andy Reichsman stated that there is no opposition to approximately 824 feet of this road coming under the Town Highway system, based on comments made throughout the process.

There was no additional testimony.

The board will deliberate the matter and render a decision within 60 days, likely sooner.

The hearing closed at 4:40 PM.

Respectfully submitted,  
Marcia L. Hamilton, Select Board Assistant

## NOTICE OF ROAD SITE INSPECTION AND HEARING

NOTICE IS HEREBY GIVEN that the Select Board of the Town of Marlboro, pursuant to Title 19, VSA Chapter 7, proposes to survey Gilbert Road and classify it as a Class 3 Town highway.

History: The road was originally laid out May 9, 1791 (Vol. 1, Town Records) and was part of the original Augur Hole Road that coursed north to the Newfane Town Line. On January 26, 1971 the select board requested the State to add the Gilbert road portion to the official Town map. However, not all provisions were met and the road was not added. However, the Town highway department maintained the road as intended as though it had been added to the Town highway system. In the recent past, Gilbert Road was discontinued in the Ancient Roads legislation because it had not been mapped. When the discrepancy of not having been mapped was brought to light the select board initiated this action to bring a specific portion of Gilbert road into the Town highway system. The specific portion will be determined in this process.

Pursuant to Title 19, Chapter 7, you are hereby notified that a site inspection will be held **Thursday, October 8, 2015 at 3:00 PM** on Gilbert Road. Meet at Augur Hole Road @ Collins Road for more convenient parking. No testimony will be taken at the site visit.

**A hearing will be held after the site inspection at 4:30 PM at the Marlboro Town Office** to receive testimony and hear all persons interested in said highway. As discontinuance does not allow compensation, only the question of whether the public good, necessity, and convenience of the inhabitants will be addressed. A decision will follow shortly after the hearing.

As required by law, notice of this site inspection and hearing is being provided by certified mail to each of the persons owning or interested in lands through which the highway passes, listed below, as well as the Marlboro Planning Commission. A copy is to be posted in the Town Clerk's office and published in the Brattleboro Reformer, a local newspaper of general circulation in the area, not less than 10 days before the time set for the hearing.

The following persons are being notified of the site inspection and hearing: Jamshid A. and Nazly A. Afnan; Margaret Tiffany; Robert A. and Arlene Gilbert; Robert and Janet LeBlond; Mohammad Vaziri and Zhra Taghval; David Elliott, Road Foreman; FairPoint Communications; Green Mountain Power; Marlboro Planning Commission.

Dated at Marlboro, Vermont, this 2nd day of September, 2015

TOWN OF MARLBORO SELECT BOARD

Andy Reichsman, Chair

Tyler Gibbons

Pieter van Loon

NEWFANE

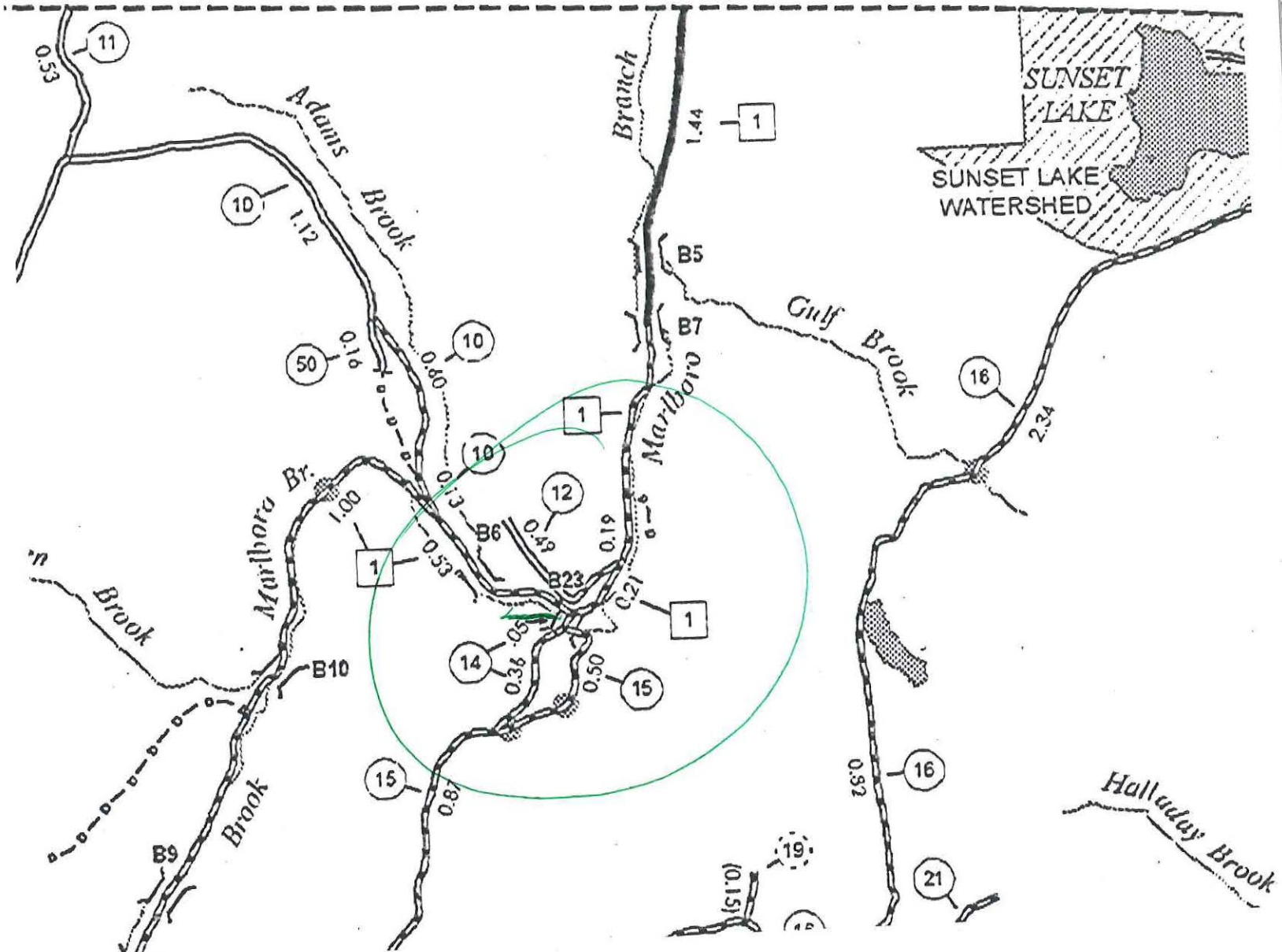



# LEGAL DESCRIPTION

For The

Gilbert Road Right-of-Way

(Marlboro Town Highway 25)

Beginning at a centerline point of the herein described Right-Of-Way centerline designated station 10+00, said point lying in the centerline of Collins Road and being (South 33°32'20" West a distance of 96.98 feet; South 52°43'00" West 131.38 feet; South 71°53'40" West 21.59 feet) from the centerline of the North face of the concrete beam seat at the South side of the bridge crossing Marlboro Branch;

THENCE North 87°56'50" West 4.40 feet to Station 10+04.40 witnessed by an iron pin with cap set at the Northerly Right-of-Way of Collins Road and the Northerly Right-of-Way of Gilbert Road 24.75 feet from the centerline of both roads;

THENCE North 87°56'50" West 65.86 feet along the centerline of said Gilbert Road to the Northerly Right-of-Way of said Collins Road at station 10+70.26; thence North 87°56'50" West 12.62 feet to a point of curve in the centerline of said Gilbert Road at station 10+82.88;

THENCE with a curve turning to the right with an arc length of 29.67 feet, and a radius of 214.34 feet to a Point on Curve at station 11+12.55 witnessed by an iron pin with cap set in the Northerly Right-of-Way of said Collins Road 24.75 feet from the centerline thereof;

THENCE with a curve turning to the right with an arc length of 44.58 feet, and a radius of 214.34 feet to the Point of Tangent of said centerline at station 11+57.15;

THENCE North 68°06'00" West along the centerline of said Gilbert Road 132.40 feet to a point at station 12+89.53 witnessed by a 5/8" iron pipe in the Southerly Right-of-Way of Gilbert Road 24.75 feet from the centerline;

THENCE North 68°06'00" West along the centerline of said Gilbert Road 19.57 feet to a point at station 13+09.10 at a point in the northerly Right-of-Way at a stone wall;

THENCE North 68°06'00" West along the centerline of said Gilbert Road 204.39 feet to a point at station 15+13.49 witnessed by a 5/8 inch iron pin in the southerly Right-of-Way 24.75 feet from the centerline;

THENCE North 68°06'00" West along the centerline of said Gilbert Road 57.73 feet to a point of curve at station 15+71.22;

THENCE with a curve turning to the left with an arc length of 69.85 feet, and a radius of 440.16 feet along the centerline to a point of tangent at station 16+41.07;

THENCE North 77°11'40" West along the centerline 84.50 feet to a point of curve at station 17+25.57;

THENCE with a curve turning to the right with an arc length of 60.27 feet and a radius of 69.45 feet to a point of tangent at station 17+85.84;

THENCE North 27°28'30" along the centerline 38.66 feet to station 18+24.50 witnessed by a 5/8" iron pin with cap at 24.75 feet in the northerly Right-of-Way and a 2<sup>nd</sup> 5/8" iron pin with cap in the limits of the expanded Right-of-Way 40.00 feet from the centerline;

THENCE North 27°28'30" along the centerline 49.50 feet to station 18+74.00 witnessed by a 5/8" iron pin with cap at 40.00 feet in the expanded northerly Right-of-Way and a 2<sup>nd</sup> 5/8" iron pin with cap in the limits of the Northerly Right-of-Way 24.75 feet from the centerline;

THENCE North 27°28'30" along the centerline 24.58 feet to station 18+98.58 witnessed by 5/8" iron pins with caps in the Northerly Right-of-Way and in the Southerly Right-of-Way 24.75 feet from the centerline of said Gilbert Road at the terminus of said road.

(All pins noted above are at 90 degrees to the centerline of Gilbert Road at the station indicated.)

Gilbert Road is a 49.50 feet (3 rods) Right-of-Way width based upon the centerline length of 898.58 feet. Gilbert Road contains 0.93 acres of land, more or less,

N/F  
Margaret Tiffany  
Book 32, Page 182  
9/27/1991; 10/02/1991  
Parcel ID# 03 - 00 - 071.0

Note: Reference to the Right-Of-Way shown hereon is made in Book 32, Page 182, Book 28, Pages 200-202 and Book 23, Page 142 and is more fully described as to location and width pursuant to a Stipulation and Order of the Windham Superior Court in the matter of George F. Smith and Wendy Kerlin v. Wayne E Rathbun and Theresa A. Rathbun Docket No. 5440-89Wmc dated August 23, 1991 (as to the Order), recorded in Book 32, Pages 166-168.

Reference is made to a plat by Southern Vermont Engineering, Inc., entitled "Land of ALONZO and NANCY GILBERT, Marlboro, Vermont", plan dated December, 1971 & last revision dated 5/5/1980. Filed in the Marlboro Land Records on slide #279.

Reference is made to a plat by Malcolm Moore, L.S.#582, entitled "Property Belonging to WARREN J. BRUCE and GLADYS C. BRUCE, Marlboro, Vermont", plan dated May, 1986, File No. 831. Filed in the Marlboro Land Records on slide #198.

Bearings shown hereon are referenced to Apparent True North as determined Magnetically in 2015.

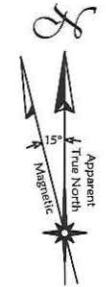

Ending Point of Town Highway Centerline @ Station 18 + 98.58

**Road Note:**

In the Marlboro "Town Records Book 1", Page 143, dated May 5, 1791, a highway was "Laid Out" which appears to be "Gilbert Road". During the period of the "Unidentified Corridors" legislation, Act 178 of 2006 - 19 V.S.A. §305 (C), timeframe this road was probably discontinued due to non-inclusion on the "official" town highway mapping.

The layout shown hereon describes a \* 3 rod road width \* generally following the present (2015) roadway, but not necessarily following the 1791 road layout.

This plat is compiled from a field survey performed with a Nikon DTM 332 electronic "total station". The 95% positional certainty of the points and monumentation of this survey are better than 0.25 feet (3 inches) as determined through a "least squares" analysis and the unbalanced survey field work has an apparent error-of-closure better than 1:14,900. The information shown hereon is based upon the balanced survey field work.

N/F  
Robert & Ariene Gilbert  
Book 28, Page 200  
10/21/1986; 10/28/1986  
Parcel ID# 03 - 00 - 070.1

N/F  
Warren J. & Gladys C. Bruce  
and Robert F. & Janet L. LeBlond  
Book 30, Page 205  
7/11/1989; 7/12/1989  
Parcel ID# 03 - 00 - 072.0

Reference Point - Centerline of Lahar Road @ the North Face of the Concrete Beam Seat @ the South side of Bridge

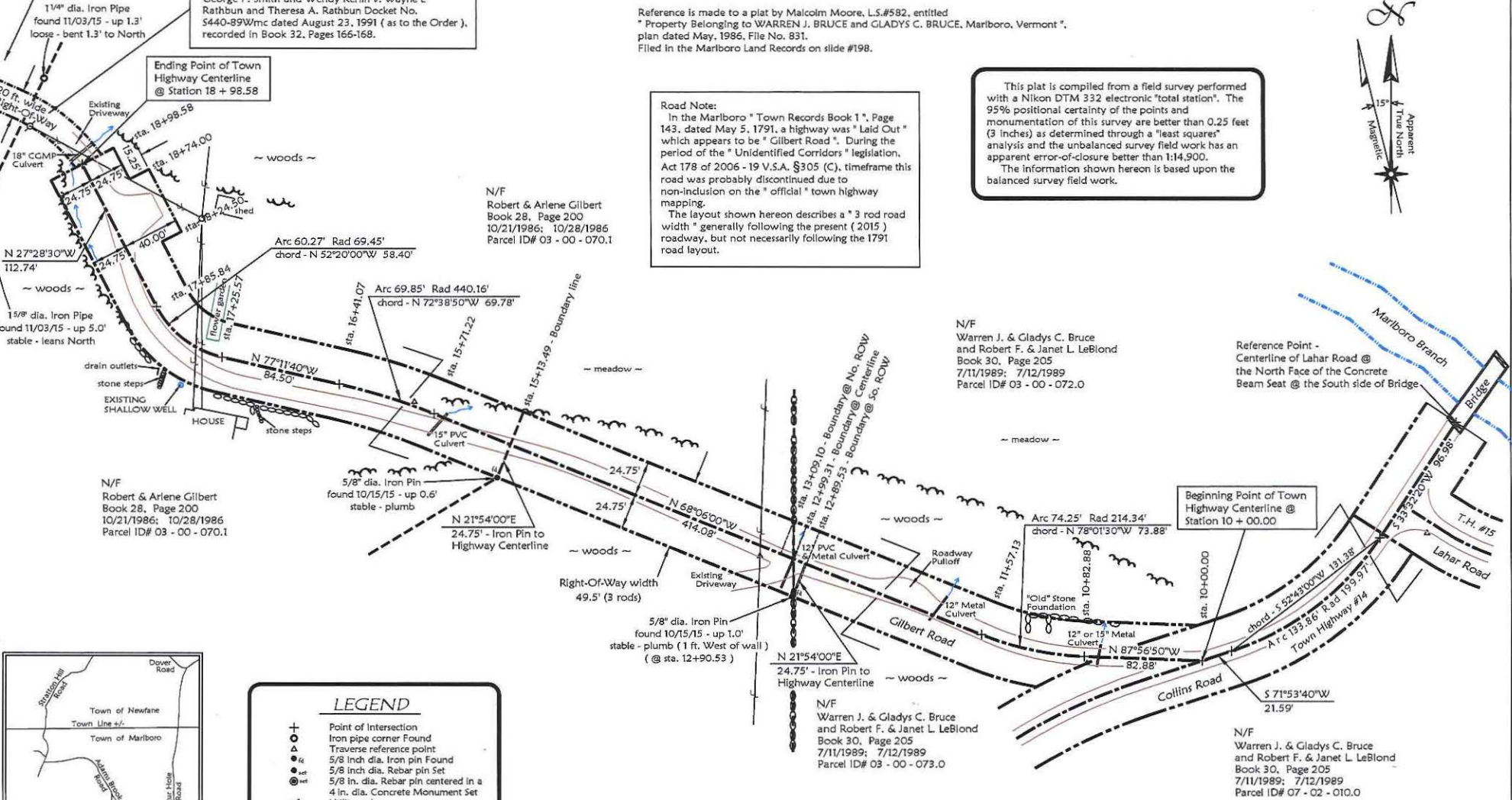

N/F  
Robert & Ariene Gilbert  
Book 28, Page 200  
10/21/1986; 10/28/1986  
Parcel ID# 03 - 00 - 070.1

N/F  
Warren J. & Gladys C. Bruce  
and Robert F. & Janet L. LeBlond  
Book 30, Page 205  
7/11/1989; 7/12/1989  
Parcel ID# 03 - 00 - 073.0

N/F  
Warren J. & Gladys C. Bruce  
and Robert F. & Janet L. LeBlond  
Book 30, Page 205  
7/11/1989; 7/12/1989  
Parcel ID# 07 - 02 - 010.0

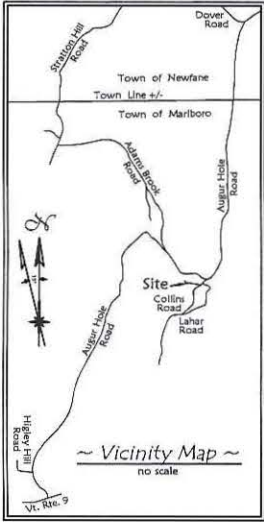

**LEGEND**

- + Point of Intersection
- Iron pipe corner Found
- △ Traverse reference point
- 5/8 inch dia. Iron pin Found
- 5/8 inch dia. Rebar pin Set
- 5/8 in. dia. Rebar pin centered in a 4 in. dia. Concrete Monument Set
- Utility pole
- Utility lines
- Highway Right-of-way
- Highway Centerline
- - - Approximate Boundary Line
- Edge of gravel traveled way
- Stonewall
- Runoff Ditch
- Edge of Woods
- Edge of Brook (+/-)

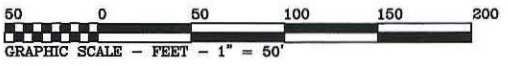

**CERTIFICATION**

I hereby certify that the information shown hereon is based on an actual field survey done by me, or at my direction and that the pipes, pins, and other monumentation shown were found or have been set and that this survey is correct to the best of my knowledge.

L.S. #121

Prepared by:  
Brad Lackey  
For:  
Merrill A. Mundell, Jr.  
**PRELIMINARY**  
P.E. & L.S.

**Roadway Survey Plat**

For: **TOWN OF MARLBORO**  
GILBERT ROAD  
(FORMER TOWN HIGHWAY #25)  
MARLBORO, VERMONT

Scale: 1" = 50'; Plan Date: Nov. 03, 2015

by: **Merrill A. Mundell, Jr., P.E.**  
P.O. Box 866/20 Gallup Pitch Road  
Wilmington, Vermont 05363-0866  
Tele. 802/464-2042 - email: mundsam@sover.net

N/F  
Margaret Tiffany  
Book 32, Page 182  
9/27/1991; 10/02/1991  
Parcel ID# 03 - 00 - 071.0

Note: Reference to the Right-Of-Way shown hereon is made in Book 32, Page 182, Book 28, Pages 200-202 and Book 23, Page 142 and is more fully described as to location and width pursuant to a Stipulation and Order of the Windham Superior Court in the matter of George F. Smith and Wendy Kerlin v. Wayne E Rathbun and Theresa A. Rathbun Docket No. S440-89Wmc dated August 23, 1991 (as to the Order), recorded in Book 32, Pages 166-168.

Reference is made to a plat by Southern Vermont Engineering, Inc., entitled "Land of ALONZO and NANCY GILBERT, Marlboro, Vermont", plan dated December, 1971 & last revision dated 5/5/1980. Filed in the Marlboro Land Records on slide #279.

Reference is made to a plat by Malcolm Moore, L.S.#582, entitled "Property Belonging to WARREN J. BRUCE and GLADYS C. BRUCE, Marlboro, Vermont", plan dated May, 1986, File No. 831. Filed in the Marlboro Land Records on slide #198.

Bearings shown hereon are referenced to Apparent True North as determined Magnetically in 2015.

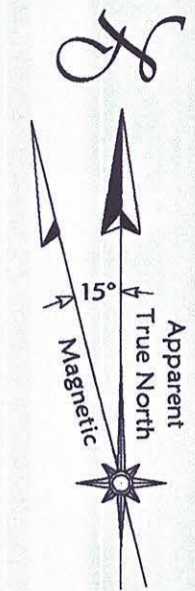

This plat is compiled from a field survey performed with a Nikon DTM 332 electronic "total station". The 95% positional certainty of the points and monumentation of this survey are better than 0.25 feet (3 inches) as determined through a "least squares" analysis and the unbalanced survey field work has an apparent error-of-closure better than 1:14,900. The information shown hereon is based upon the balanced survey field work.

**Road Note:**  
In the Marlboro "Town Records Book 1", Page 143, dated May 5, 1791, a highway was "Laid Out" which appears to be "Gilbert Road". During the period of the "Unidentified Corridors" legislation, Act 178 of 2006 - 19 V.S.A. §305 (C), timeframe this road was probably discontinued due to non-inclusion on the "official" town highway mapping. The layout shown hereon describes a "3 rod road width" generally following the present (2015) roadway, but not necessarily following the 1791 road layout.

N/F  
Robert & Arlene Gilbert  
Book 28, Page 200  
10/21/1986; 10/28/1986  
Parcel ID# 03 - 00 - 070.1

N/F  
Warren J. & Gladys C. Bruce  
and Robert F. & Janet L. LeBlond  
Book 30, Page 205  
7/11/1989; 7/12/1989  
Parcel ID# 03 - 00 - 072.0

Reference Point -  
Centerline of Lahar Road @  
the North Face of the Concrete  
Beam Seat @ the South side of Bridge

N/F  
Robert & Arlene Gilbert  
Book 28, Page 200  
10/21/1986; 10/28/1986  
Parcel ID# 03 - 00 - 070.1

N/F  
Warren J. & Gladys C. Bruce  
and Robert F. & Janet L. LeBlond  
Book 30, Page 205  
7/11/1989; 7/12/1989  
Parcel ID# 03 - 00 - 073.0

N/F  
Warren J. & Gladys C. Bruce  
and Robert F. & Janet L. LeBlond  
Book 30, Page 205  
7/11/1989; 7/12/1989  
Parcel ID# 07 - 02 - 010.0

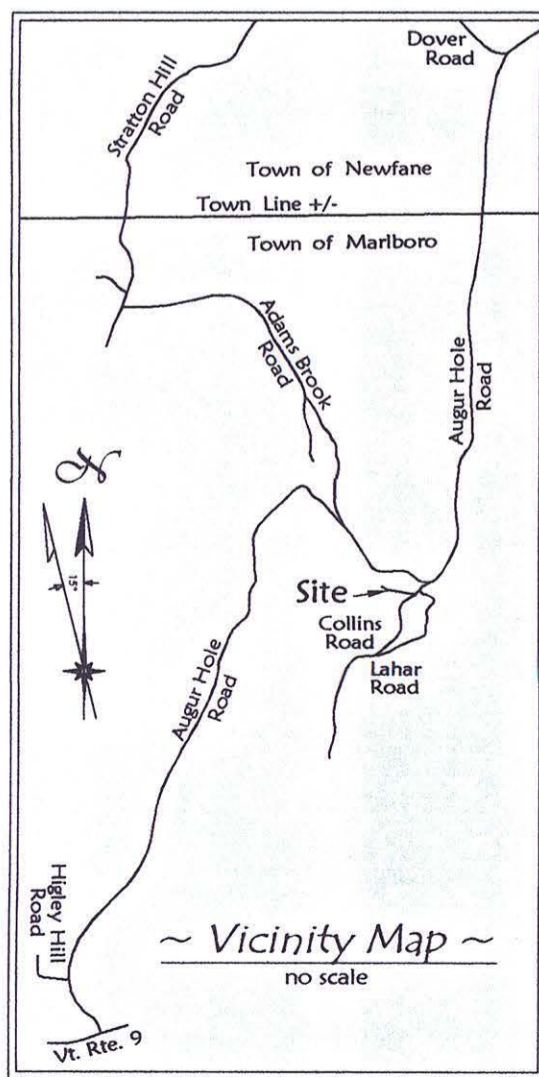

**LEGEND**

- + Point of Intersection
- Iron pipe corner Found
- △ Traverse reference point
- 5/8 inch dia. Iron pin Found
- 5/8 inch dia. Rebar pin Set
- 5/8 in. dia. Rebar pin centered in a 4 in. dia. Concrete Monument Set
- Utility pole
- Utility lines
- Highway Right-of-way
- Highway Centerline
- Approximate Boundary Line
- Edge of gravel traveled way
- Stonewall
- Runoff Ditch
- Edge of Woods
- Edge of Brook (+/-)

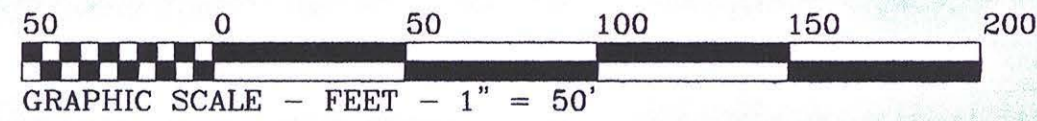

**CERTIFICATION**

I hereby certify that the information shown hereon is based on an actual field survey done by me, or at my direction and that the pipes, pins, and other monumentation shown were found or have been set and that this survey is correct to the best of my knowledge.

*Merrill A. Mundell, Jr.* L.S. #121

Prepared by:  
Brad Lackey  
For:  
Merrill A. Mundell, Jr.  
*Merrill A. Mundell, Jr.*  
P.E. & L.S.

**Roadway Survey Plat**  
For: **TOWN OF MARLBORO**  
GILBERT ROAD  
(FORMER TOWN HIGHWAY #25)  
MARLBORO, VERMONT  
Scale: 1" = 50'; Plan Date: Nov. 25, 2015  
by: **Merrill A. Mundell, Jr., P.E.**  
P.O. Box 866/20 Gallup Pitch Road  
Wilmington, Vermont 05363-0866  
Tele. 802/464-2042 ~ email: mundsam@sover.net

## Alley, Kerry

---

**From:** Marcia Hamilton <m8rcia@gmail.com>  
**Sent:** Sunday, June 14, 2015 4:43 PM  
**To:** Croft, Johnathan  
**Cc:** Marlboro Select Board; Moulton, Sara; Alley, Kerry  
**Subject:** Re: Marlboro Town Highway 25

Thank you Johnathan. I'll be in touch.

Marcia

On Fri, Jun 5, 2015 at 1:58 PM, Croft, Johnathan <[Johnathan.Croft@state.vt.us](mailto:Johnathan.Croft@state.vt.us)> wrote:

Good afternoon Marcia,

For the addition of a highway to the Mileage Certificate, the Town will need to supply documentation regarding the legal establishment of highway pursuant to the provisions defined in Act 178 of 2006 and articulated in the attached "Ancient Road Practicum" and checklist. If the roads have been maintained by the Town for over 44 years, there should be some precedent for "dedication and acceptance" and the Selectboard would need to provided documentation to this affect.

The Mileage Certificate process for 2015 is closed and any changes will need to be submitted with the 2016 Certificates, expected to be sent out to Towns the first week in January of 2016.

Please feel free to contact me with any questions or comments regarding the addition of highways to the Mileage Certificates or mapping in general.

Johnathan Croft  
VTrans Mapping Section

(802) 828-2600

**From:** Marcia Hamilton [mailto:[m8rcia@gmail.com](mailto:m8rcia@gmail.com)]  
**Sent:** Friday, June 05, 2015 1:40 PM  
**To:** Croft, Johnathan  
**Cc:** Marlboro Select Board; Marcia Hamilton  
**Subject:** Marlboro Town Highway 25

Hello Johnathan,

Attached is a letter from the state to the Marlboro Select Board dated January 26, 1971. Something undone has come back to visit us. We have an issue about a driveway permit. Driveway permits are required for access to town roads. We realize that a road that we have been maintaining for more than 44 years is not actually in the town highway system.

Apparently in 1970 or 1971 the select board intended to take parts of old roads into the town highway system. To satisfy that requirement, the January, 1971 letter states "Before including these mileages in your town highway system may we ask that you submit a certificate, signed by the selectmen, that these roads are considered and have been maintained by the town as public highways for "x" number of years"

Apparently the requirement was never satisfied by the select board but the town continued to maintain the road. The margin note shows "None [certificate] received 3/23/71." We are asking now whether the Marlboro select board can still submit a certificate as mentioned, and meet the requirements intended. In the meantime, we will see if we can determine the status of T 35 as well. Right now we are just concerned with T 25.

Thank you for your opinion.

Marcia Hamilton

Select Board Assistant

OFFICE OF THE  
COMMISSIONER



STATE OF VERMONT  
DEPARTMENT OF HIGHWAYS  
MONTPELIER  
05602

*Gilbert  
#25*

January 26, 1971

Chairman, Board of Selectmen  
Town of Marlboro  
Marlboro, Vermont 05344

Gentlemen:

In accordance with Title 19, V.S.A., Section 15, as amended, all the traveled highways in your town were measured in 1970 by Mr. Davison and Mr. Elliott, Selectmen, with Mr. Chabot of this office.

The resulting changes in highway mileage are indicated on the enclosed map and are explained on the attached breakdown sheet.

It appeared to Mr. Chabot that the length of T 12 should be reduced from 0.88 mile to 0.58 mile because there was a locked gate at that point. Would you please advise us whether or not this gate has since been removed.

*alexander*

*Gilbert*

Mr. Davison and Mr. Elliott indicated that 0.07 mile of T 25 (prov.) and 0.36 mile of T 35 (prov.) are old town highways. Before including these mileages in your town highway system may we ask that you submit a certificate, signed by the Selectmen, that these roads are considered and have been maintained by the town as public highways for "x" number of years.

In order to accept T 30 (prov.) as a new addition of 0.20 mile, it will be necessary that you furnish this agency a copy of the right-of-way and a Certificate of Completion and Opening of this road to public travel.

For your convenience we have entered on the enclosed Certificates of Highway Mileage all changes which were brought to our attention during the past year, and will appreciate your indicating any other town highway changes processed in accordance with the Statutes during the past year. The enclosed form letter explains the procedures for making changes in town highway mileage.

The completed Mileage Certificates must reach this office by March 15, 1971 in order for these mileage changes to be effective at this time.

Sincerely,

R. J. Nicholls  
Highway Planning Engineer

RJN/JEA/md

Enc:

cc: District Office  
Mapping Section

*None Received  
3/23/71*

*None Received  
3/23/71*

*Mark A. ...*

1	0.24
2	0.48
3	0.72
4	0.96
5	1.20
6	1.44
7	1.68
8	1.92
9	2.16
10	2.40
11	2.64
12	2.88
13	3.12
14	3.36
15	3.60
16	3.84
17	4.08
18	4.32
19	4.56
20	4.80
21	5.04
22	5.28
23	5.52
24	5.76
25	6.00
26	6.24
27	6.48
28	6.72
29	6.96
30	7.20
31	7.44
32	7.68
33	7.92
34	8.16
35	8.40
36	8.64
37	8.88
38	9.12
39	9.36
40	9.60
41	9.84
42	10.08
43	10.32
44	10.56
45	10.80
46	11.04
47	11.28
48	11.52
49	11.76
50	12.00
51	12.24
52	12.48
53	12.72
54	12.96
55	13.20
56	13.44
57	13.68
58	13.92
59	14.16
60	14.40
61	14.64
62	14.88
63	15.12
64	15.36
65	15.60
66	15.84
67	16.08
68	16.32
69	16.56
70	16.80
71	17.04
72	17.28
73	17.52
74	17.76
75	18.00
76	18.24
77	18.48
78	18.72
79	18.96
80	19.20
81	19.44
82	19.68
83	19.92
84	20.16
85	20.40
86	20.64
87	20.88
88	21.12
89	21.36
90	21.60
91	21.84
92	22.08
93	22.32
94	22.56
95	22.80
96	23.04
97	23.28
98	23.52
99	23.76
100	24.00

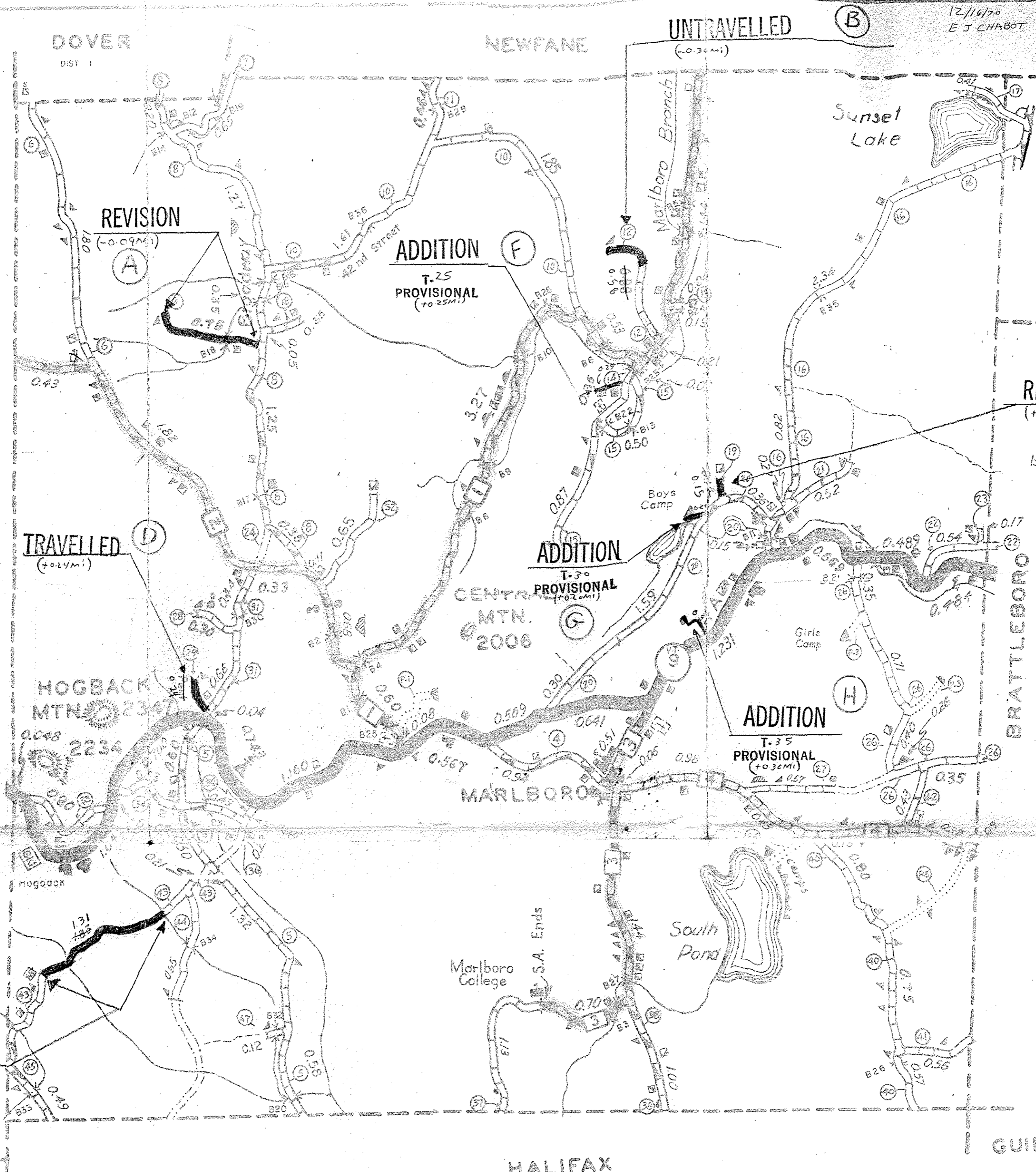

**LEGEND**

	U.S. NUMBERED ROUTE		PAVED ROAD
	STATE HIGHWAY		SURFACE TREATED ROAD
	NUMBERED STATE AID HWY.		GRAVEL ROAD
	STATE AID HWY. WITH SELECTED TOWN NO.		SOIL SURFACE ROAD (2nd CLASS GRAVEL)
	FEDERAL AID HIGHWAY		GRADED & DRAINED ROAD
	TOWN HIGHWAY		UNIMPROVED ROAD
	FARM UNIT		PRIMITIVE ROAD
	DWELLING (OTHER THAN FARM)		UNTRAVELED ROAD
	SCHOOL		SEASONAL DWELLING
	BUSINESS		CEMETERY
	PRIVATE ROAD		CHURCH
	TRAIL		BRIDGES:
	PRIVATE ROAD		4' THRU 20'
	PRIVATE ROAD		OVER 20'

TOWN HIGHWAY	40.55	MILE
STATE AID HWY. NO. 1	6.32	"
STATE AID HWY. NO. 2	3.37	"
STATE AID HWY. NO. 3	2.71	"
STATE AID HWY. NO. 4	2.55	"
TOTAL STATE AID	14.95	"
STATE HIGHWAY NO. 9	8.383	"
STATE HIGHWAY NO.		"
STATE HIGHWAY NO.		"
TOTAL STATE HWY.	8.383	"
TOTAL ALL SYSTEMS	63.883	MILES

NOTE: THE MILEAGES SHOWN ON THIS MAP ARE CORRECT TO MARCH 15, 1970

1 MI.

TOWN HIGHWAY ~~40.55~~ MILE

STATE AID HWY. NO. 1 6.32 "

STATE AID HWY. NO. 2 3.37 "

STATE AID HWY. NO. 3 2.71 "

STATE AID HWY. NO. 4 2.55 "

TOTAL STATE AID..... 14.95 "

STATE HIGHWAY NO. 9 8.383 "

STATE HIGHWAY NO. " "

STATE HIGHWAY NO. " "

TOTAL STATE HWY. 8.383 "

TOTAL ALL SYSTEMS ~~63.883~~ MILES

NOTE: THE MILEAGES SHOWN ON THIS MAP ARE CORRECT TO MARCH 15, 1970

19

6/51 ML 6/54 JF 4/59 JYM 5/68 RJN 4/69 SM  
3/52 JF 3-55-C.O. 5/60 JYM  
4/56 CP 6/61 JYM  
4/53 ml 4/57 W 3/70 BQ

WINDHAM COUNTY