

CERTIFICATE OF HIGHWAY MILEAGE

YEAR ENDING FEBRUARY 10, 2001

Fill out form, make and file copy with the Town Clerk, and mail ORIGINAL, before February 20, 2001 to: VT Agency of Transportation, Technical Services Division, Drawer 33, Montpelier, VT 05633.

We, the Selectman or Trustee or Alderman of JAMAICA in WINDHAM County

on an oath state that the mileage of highways, according to Title 19, V.S.A, Sec #305, added 1985, is as follows

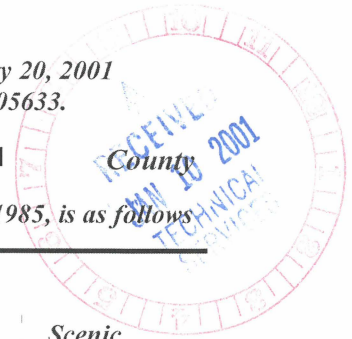

PART I - CHANGES TOTALS - Please fill in and calculate totals.

Town Highways	Previous Mileage	Added Mileage	Subtracted Mileage	Total	Scenic Highways
Class 1	0.000			0.000	0.000
* Class 1 Lane	0.000			0.000	
Class 2	6.440			6.440	0.000
Class 3	43.350			43.350	0.000
State Highway	14.675			14.675	0.000
* Class 4	2.880			2.880	0.000
<b>Total</b>	<b>64.465</b>			<b>64.465</b>	<b>0.000</b>

\* Class 1 Lane Mileage and Class 4 is NOT included in total.

PART II - INFORMATION AND DESCRIPTION OF CHANGES SHOWN ABOVE.

1. NEW HIGHWAYS: Please attach Selectman's "Certificate of Completion and Opening".

None

2. DISCONTINUED: Please attach SIGNED copy of proceedings (minutes of meeting).

None

3. RECLASSIFIED/REMEASURED: Please attach SIGNED copy of proceedings (minutes of meeting).

None

4. SCENIC HIGHWAYS: Please attach a copy of order designating/discontinuing Scenic Highways.

None

IF THERE ARE NO CHANGES IN MILEAGE: Check box and sign below. [X]

PART III - SIGNATURES - PLEASE SIGN.

Selectman/ Alderman/ Trustees Signatures

Bruce Chapin, Ben Williams, Clara Robinson, David Hamilton, Joel Beavin

Clerk Signagture: Bonnie West

Date Filed: 1-8-01

Please sign ORIGINAL and return it for Transportation signature.

AGENCY OF TRANSPORTATION APPROVAL:

Signed copy will be returned to T/C/V Clerk.

APPROVED:

John A. Park

Representative, Agency of Transportation

DATE:

17 JAN 01