

CERTIFICATE OF HIGHWAY MILEAGE
YEAR ENDING FEBRUARY 10, 2016

Fill out form, make and file copy with the Town Clerk, and mail ORIGINAL, before February 20, 2016 to: Vermont Agency of Transportation, Division of Policy, Planning and Intermodal Development, Mapping Section One National Life Drive, Montpelier, VT 05633.

We, the members of the legislative body of GRAFTON in WINDHAM County on an oath state that the mileage of highways, according to Vermont Statutes Annotated, Title 19, Section 305, added 1985, is as follows:

PART I - CHANGES TOTALS - Please fill in and calculate totals.

Table with columns: Town Highways, Previous Mileage, Added Mileage, Subtracted Mileage, Total, Scenic Highways. Rows include Class 1, Class 2, Class 3, State Highway, Total, Class 1 Lane, Class 4, and Legal Trail.

* Mileage for Class 1 Lane, Class 4, and Legal Trail classifications are NOT included in total.

PART II - INFORMATION AND DESCRIPTION OF CHANGES SHOWN ABOVE. Adjustments by

- 1. NEW HIGHWAYS: Please attach Selectmen's "Certificate of Completion and Opening". S. Moulton 4/22/2016
2. DISCONTINUED: Please attach SIGNED copy of proceedings (minutes of meeting).
3. RECLASSIFIED/REMEASURED: Please attach SIGNED copy of proceedings (minutes of meeting): +0.55 mi. CL4 TH-37 +0.75 mi LT-3 +0.34 mi. LT-6 +0.51 m. CL4 TH-44 +0.70 m. LT-5
4. SCENIC HIGHWAYS: Please attach a copy of order designating/discontinuing Scenic Highways.

IF THERE ARE NO CHANGES IN MILEAGE: Check box and sign below. []

PART III - SIGNATURES - PLEASE SIGN.

Selectmen/ Aldermen/ Trustees Signatures:

Handwritten signatures of selectmen/aldermen/trustees.

T/C/V Clerk Signature:

Date Filed:

Please sign ORIGINAL and return it for Transportation signature.

AGENCY OF TRANSPORTATION APPROVAL: Signed copy will be returned to T/C/V Clerk.

APPROVED:

Representative, Agency of Transportation

DATE:

5/12/2014

Received

JAN 27 2016

Policy, Planning & Intermodal
Development Division

Vermont Statutes Annotated

19 V.S.A. § 305. Measurement and inspection

§ 305. Measurement and inspection

(a) After reasonable notice to the selectboard, a representative of the agency may measure and inspect the class 1, 2, and 3 town highways in each town to verify the accuracy of the records on file with the agency. Upon request, the selectboard or their designee shall be permitted to accompany the representative of the agency during the measurement and inspection. The agency shall notify the town when any highway, or portion of a highway, does not meet the standards for its assigned class. If the town fails, within one year, to restore the highway or portion of the highway to the accepted standard, or to reclassify, or to discontinue, or develop an acceptable schedule for restoring to the accepted standards, the agency for purposes of apportionment under section 306 of this title shall deduct the affected mileage from that assigned to the town for the particular class of the road in question.

(b) Annually, on or before February 10, the selectboard shall file with the town clerk a sworn statement of the description and measurements of all class 1, 2, 3, and 4 town highways and trails then in existence, including any special designation such as a throughway or scenic highway. When class 1, 2, 3, or 4 town highways, trails, or unidentified corridors are accepted, discontinued, or reclassified, a copy of the proceedings shall be filed in the town clerk's office and a copy shall be forwarded to the agency.

(c) All class 1, 2, 3, and 4 town highways and trails shall appear on the town highway maps by July 1, 2015.

(d) At least 45 days prior to first including a town highway or trail that is not clearly observable by physical evidence of its use as a highway or trail and that is legally established prior to February 10, 2006 in the sworn statement required under subsection (b) of this section, the legislative body of the municipality shall provide written notice and an opportunity to be heard at a duly warned meeting of the legislative body to persons owning lands through which a highway or trail passes or abuts.

(e) The agency shall not accept any change in mileage until the records required to be filed in the town clerk's office by this section are received by the agency. A request by a municipality to the agency for a change in mileage shall include a description of the affected highway or trail, a copy of any surveys of the affected highway or trail, minutes of meetings at which the legislative body took action with respect to the changes, and a current town highway map with the requested deletions and additions sketched on it. A survey shall not be required for class 4 town highways that are legally established prior to February 10, 2006. All records filed with the agency are subject to verification in accordance with subsection (a) of this section.

(f) The selectboard of any town who are aggrieved by a finding of the agency concerning the measurement, description, or classification of a town highway may appeal to the transportation board by filing a notice of appeal with the executive secretary of the transportation board.

(g) The agency shall provide each town with a map of all of the highways in that town together with the mileage of each class 1, 2, 3, and 4 highway, as well as each trail, and such other information as the agency deems appropriate

Excerpt of *19 V.S.A. § 305 - Measurement and inspection* from Vermont Statutes Online located at –
<http://legislature.vermont.gov/statutes/section/19/003/00305>

December 2015



State of Vermont
 Division of Policy, Planning and Intermodal Development - Mapping Section
 1 National Life Drive
 Montpelier, VT 05633-5001
<http://vtrans.vermont.gov/>

Agency of Transportation

Telephone: 802-828-2600
 Fax: 802-828-2334
 Email: johnathan.croft@vermont.gov

May 4, 2016

Emily Huff
 Town Administrator
 Town of Grafton
 PO Box 180
 Grafton, VT 05146

Dear Ms. Huff,

The VTrans Mapping Section has completed the review of Grafton's 2016 Certificate of Highway Mileage, and we are unfortunately unable to implement all the changes requested this year. There have been some difficulties in matching the documentation sent with the Certificate with the changes requested, and lack of clarity to what the changes are. Due to the complexity of some of the changes and the need to complete the all the Mileage Certificates by April 15th we were unable to process all the changes.

Some of the changes noted on the Mileage Certificate and attached documentation were implemented and are reflected in the following listing:

Change requested by Town	As added by VTrans	Class 4 Addition	Legal Trail Addition
TH-37 1.06 miles Class 4	TH-37 Bell Rd TH-44 Anderson Rd	0.55 0.51	
LT-3 0.75 miles Legal Trail	LT-3		0.75
LT-5 0.70 miles Legal Trail	LT-5		0.70
LT-6 0.34 miles Legal Trail	LT-6		0.34
TOTAL		1.06	1.79

Unfortunately, the following changes were not implemented this year, and I request that the Town of Grafton continue to work to provide clarity and documentation so these changes can be reflected on the 2017 Grafton Certificate of Highway Mileage.

Class 3 addition	Mileage	Documentation Note
TH-44	0.75	source of the additional mileage is unclear
Class 4 additions		
TH-15	0.09	not sure what the change is

TH-42	0.05	not sure of the change as there isn't enough mileage unless Class 3 section is reclassified
TH-43	1.10	clarity in the documentation is needed
Legal Trail additions		
LT-2	1.09	can't read the surveys (copies are too out of focus)
LT-4	0.59	no documentation
LT-7	0.54	Petition was provided, not lay out documentation or survey
LT-8	0.15	Petition was provided, not lay out documentation or survey
LT-9	0.59	no documentation

A significant amount of effort was put into deciphering the notes of the maps, mark-ups, and associated surveys to understand what the mileage totals on the Certificate related to. There are also many other changes noted that were not included on the Certificate, requiring us to sift through to understand the changes. The town highway and legal trail updates that were requested but not accepted may still be resubmitted, but please provide clarity to the documentation, and each change individually, which will allow for use to better process the changes.

Regarding each of the changes that was not accepted, I would like to articulate what the deficiency was and how this could be potentially corrected.

- TH-44 addition of 0.75 miles of class 4 town highway – The section of highway to be added was already part of the TH-37 update, so it is not clear where this additional mileage needs to be placed. It seems that this change is redundant with TH-37, but clarity on this from the Town is necessary on where this section is located and the appropriate documentation showing legal establishment.
- There is not enough information regarding the changes to TH-15 to make any updates. Please provide clarification on the change to TH-15 and the appropriate documentation to go with the change.
- The TH-42 change needs to be clarified, as there is not enough mileage in the section to accommodate the new mileage, unless a reclassification was performed. Clarification and documentation of this change is needed.
- The addition of 1.10 miles of TH-43 was not done, as there needs to be clarity in the laying out documentation. It should also be noted that TH-43 already defines a section of town highway and new number should be assigned to the section of road being added between the existing TH-43 and TH-1.

- The survey descriptions related to LT-2 were not legible and we were unable to generate a traverse which we use to assess the length and alignments. Please provide clear copies of the survey descriptions that pertain to the legal establishment of this trail, including 1B 133 (1803).
- No documentation was provided showing the legal establishment of LT-4. Please provide any survey descriptions or other documentation showing the legal establishment of LT-4.
- A petition for the laying out was provided for LT-7 and LT-8, but a petition does not constitute the laying out, as the Selectboard could have not accepted the petition or acted on it. If there is further documentation regarding the laying out of these two trails, please provide this information for reconsideration of the addition.
- It appears for the information provided that LT-9 was reclassified from class 4 town highway TH-23 to legal trail. There is no documentation provided that details this reclassification or any information showing the process in 19 V.S.A. Title 19 was followed. Please provide documentation regarding the reclassification of the 0.59 miles of class 4 to legal trail.

We would like to continue the dialog with the Town of Grafton regarding these changes and what is needed to make updates to the Mileage Certificate. Over the remainder of the next year, we would like to add clarity to the changes and have any issues ready for next year's Mileage Certificate.

Please feel free to contact me with any questions or comments regarding the notations above, the Mileage Certificate process, or mapping in general.

Sincerely,

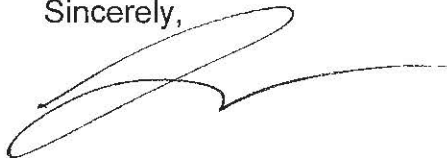

Johnathan Croft
AOT GIS Database Administrator
VTrans Mapping Section

JFC/jfc

Enclosures

cc: Tammy Ellis – District Transportation Administrator – District 2
Marc Pickering – District Project Manager – District 2

CERTIFICATE OF HIGHWAY MILEAGE
YEAR ENDING FEBRUARY 10, 2016

Fill out form, make and file copy with the Town Clerk, and mail ORIGINAL, before February 20, 2016 to: Vermont Agency of Transportation, Division of Policy, Planning and Intermodal Development, Mapping Section One National Life Drive, Montpelier, VT 05633.

We, the members of the legislative body of GRAFTON in WINDHAM County on an oath state that the mileage of highways, according to Vermont Statutes Annotated, Title 19, Section 305, added 1985, is as follows:

PART I - CHANGES TOTALS - Please fill in and calculate totals.

Table with columns: Town Highways, Previous Mileage, Added Mileage, Subtracted Mileage, Total, Scenic Highways. Rows include Class 1, Class 2, Class 3, State Highway, Total, Class 1 Lane, Class 4, and Legal Trail.

* Mileage for Class 1 Lane, Class 4, and Legal Trail classifications are NOT included in total.

PART II - INFORMATION AND DESCRIPTION OF CHANGES SHOWN ABOVE. Adjustments by

- 1. NEW HIGHWAYS: Please attach Selectmen's "Certificate of Completion and Opening": S. Moulton 4/22/2016
2. DISCONTINUED: Please attach SIGNED copy of proceedings (minutes of meeting).
3. RECLASSIFIED/REMEASURED: Please attach SIGNED copy of proceedings (minutes of meeting): +0.55 mi. CL4 TH-37 +0.75 mi LT-3 +0.34 mi. LT-6 +0.51 mi. CL4 TH-44 +0.70 mi. LT-5
4. SCENIC HIGHWAYS: Please attach a copy of order designating/discontinuing Scenic Highways.

IF THERE ARE NO CHANGES IN MILEAGE: Check box and sign below. []

PART III - SIGNATURES - PLEASE SIGN.

Selectmen/ Aldermen/ Trustees Signatures:

Handwritten signatures of selectmen/aldermen/trustees.

T/C/V Clerk Signature:

Date Filed:

Please sign ORIGINAL and return it for Transportation signature.

AGENCY OF TRANSPORTATION APPROVAL: Signed copy will be returned to T/C/V Clerk.

APPROVED: Representative, Agency of Transportation

DATE:

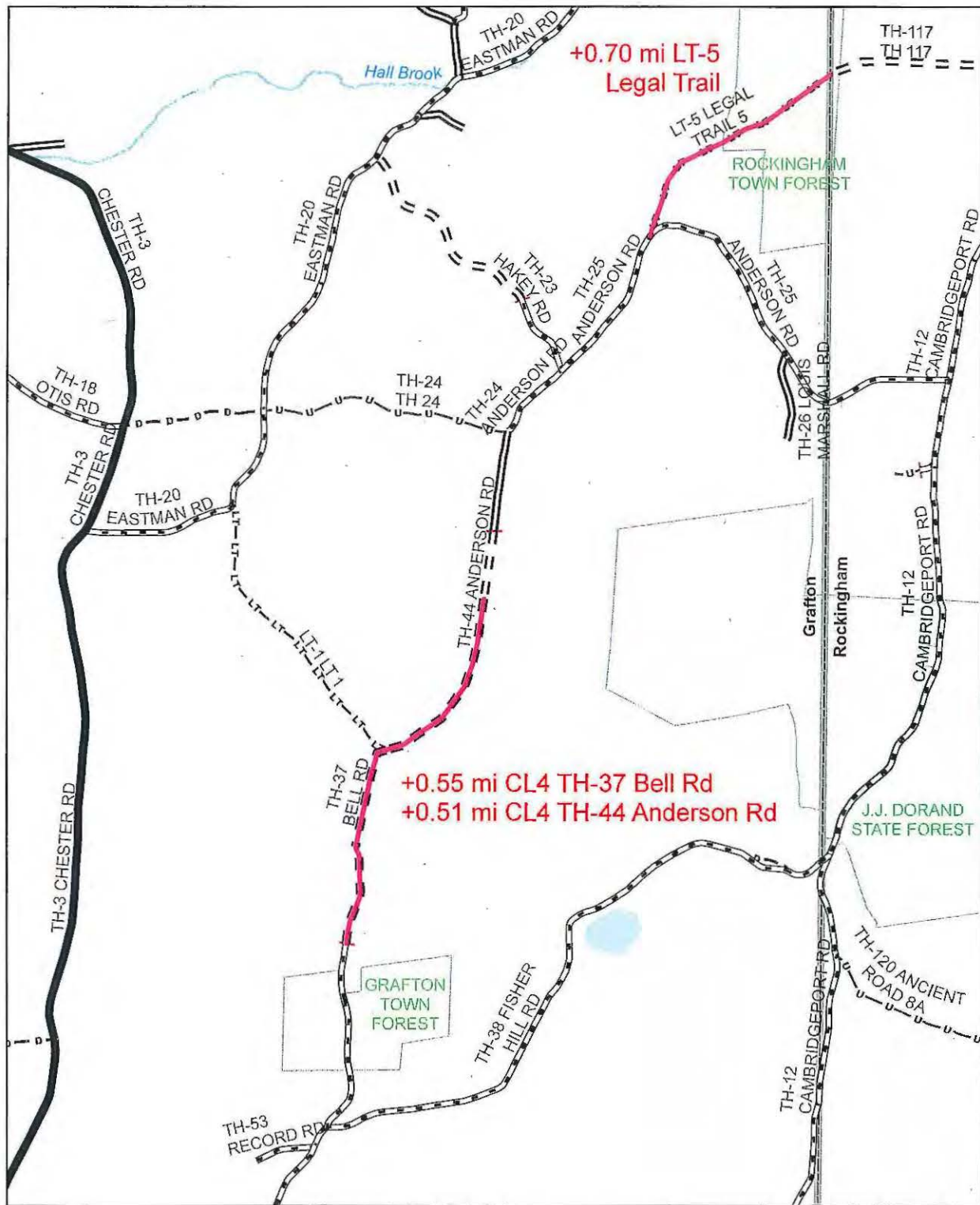

Mileage Certificate Change 2016

GRAFTON

(CTCODE: 1306)

Mapping Section
 Division of Policy, Planning and Intermodal Development
 Vermont Agency of Transportation - April 2016

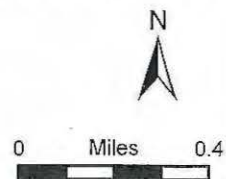

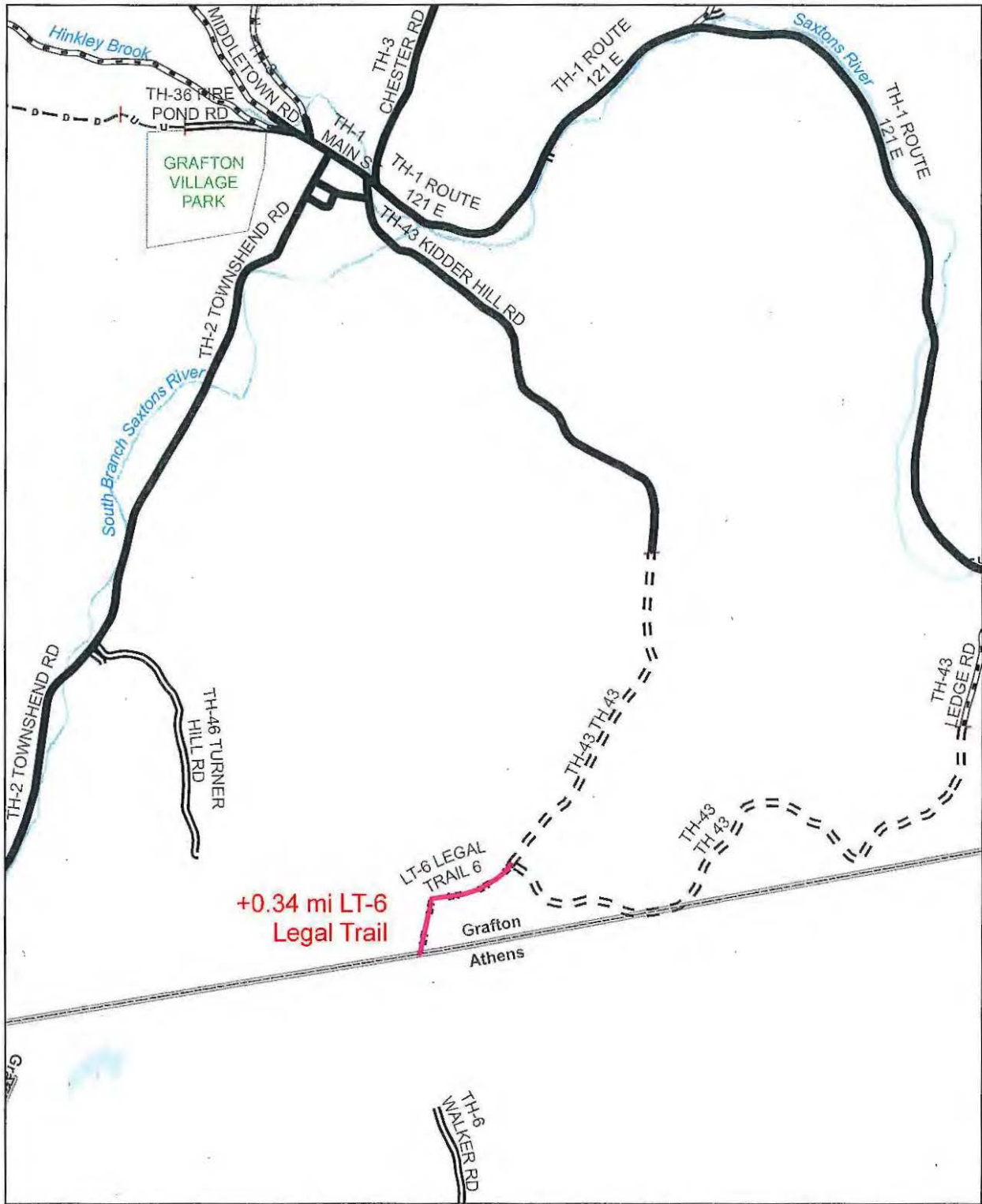

Mileage Certificate Change 2016

GRAFTON

(CTCODE: 1306)

Mapping Section
 Division of Policy, Planning and Intermodal Development
 Vermont Agency of Transportation - April 2016

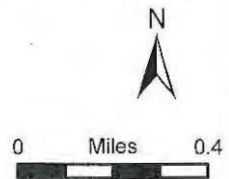

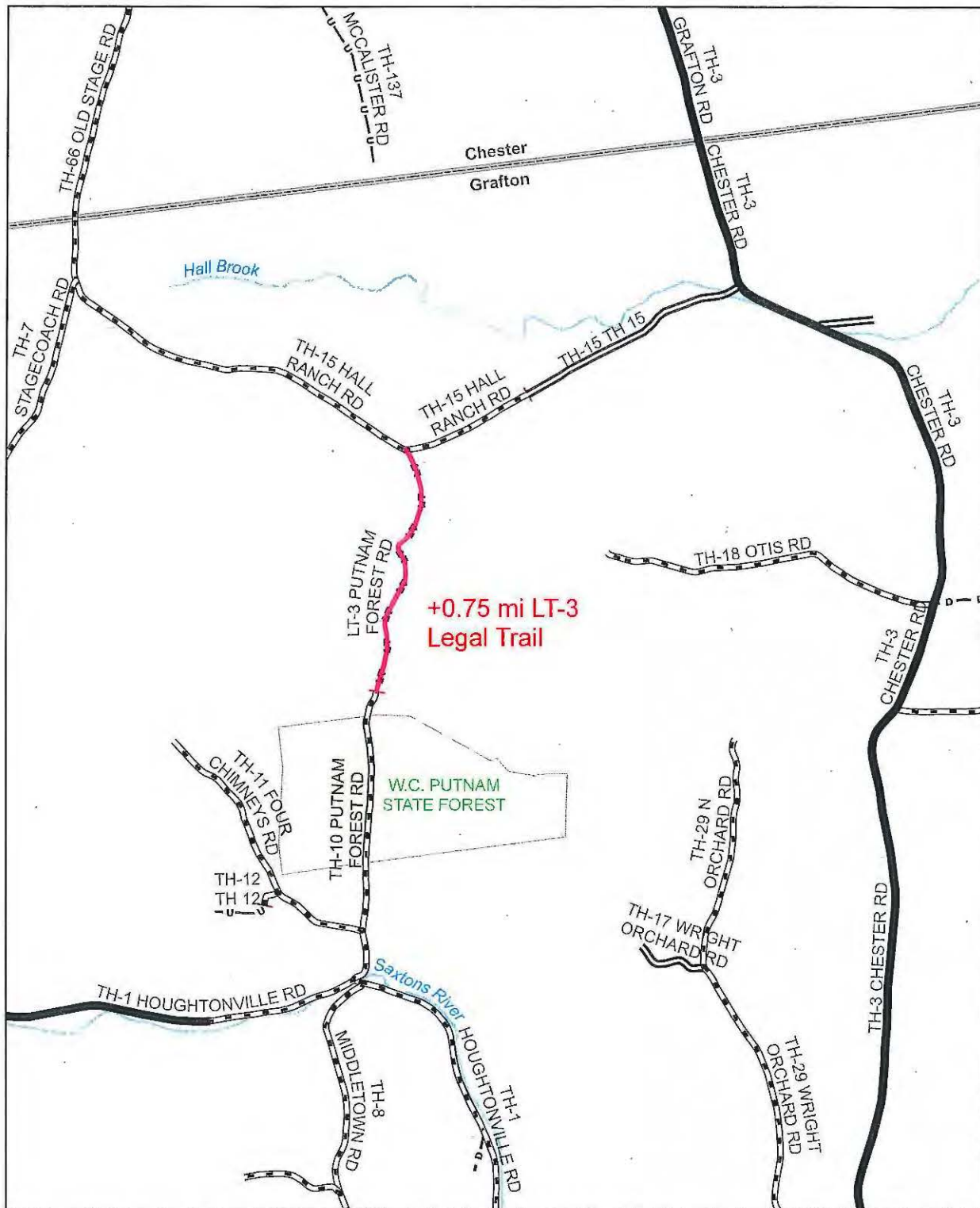

Mileage Certificate Change 2016

GRAFTON

(CTCODE: 1306)

Mapping Section
 Division of Policy, Planning and Intermodal Development
 Vermont Agency of Transportation - April 2016

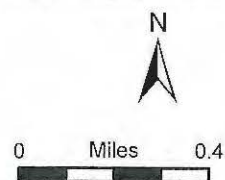

GRAFTON Mileage Certificate Processing Notes 2016	Town Highway or Trail Number	Former Mileage	New Mileage	Length Change	Comment	Documentaiton
<u>Class 4 Mileage Changes</u>						
Need info from Town	TH-15	0.54	0.63	0.09		Not sure the change
Need info from Town	TH-23	0.59	0	-0.59	Reclassified to Legal Trail - LT-4 (Hakey Rd)	No documentation
Need info from Town	TH-24	0.59	0	-0.59	Reclassified to Legal Trail - LT-9	No documentation
Ok to map - in Pending	TH-37	0	1.06	1.06	Old road addition	Survey BOL 109 1820 fits
Need info from Town	TH-42	0.62	0.67	0.05	Remeasurement??	Not sure the change as there isn't enough mileage unless class 3 section reclassified
	TH-43	2.82	3.92	1.10	Old road addition - 1(B) 150-1 1825	Needs different number

1.12

Legal Trail Additions

Need clear copy of BOL 94	LT-2	0	1.09	1.09	Old road addition	Can't read surveys and one cut off, so can't plot
Ok to map	LT-3	0	0.75	0.75	Old road addition	Survey BOL 23 1788 fits
Need info from Town	LT-4	0	0.59	0.59	Reclassified from CL 4 TH-24	No documentation
Ok to map - in Pending	LT-5	0	0.7	0.70	Old road addition	Survey BOL 23 1788 fits
Ok to map - in Pending	LT-6	0	0.34	0.34	Old road addition	
	LT-7	0	0.54	0.54	Old road addition	
	LT-8	0	0.15	0.15	Old road addition	
Need info from Town	LT-9	0	0.59	0.59	Reclassified from CL 4 TH-23	No documentation

4.75

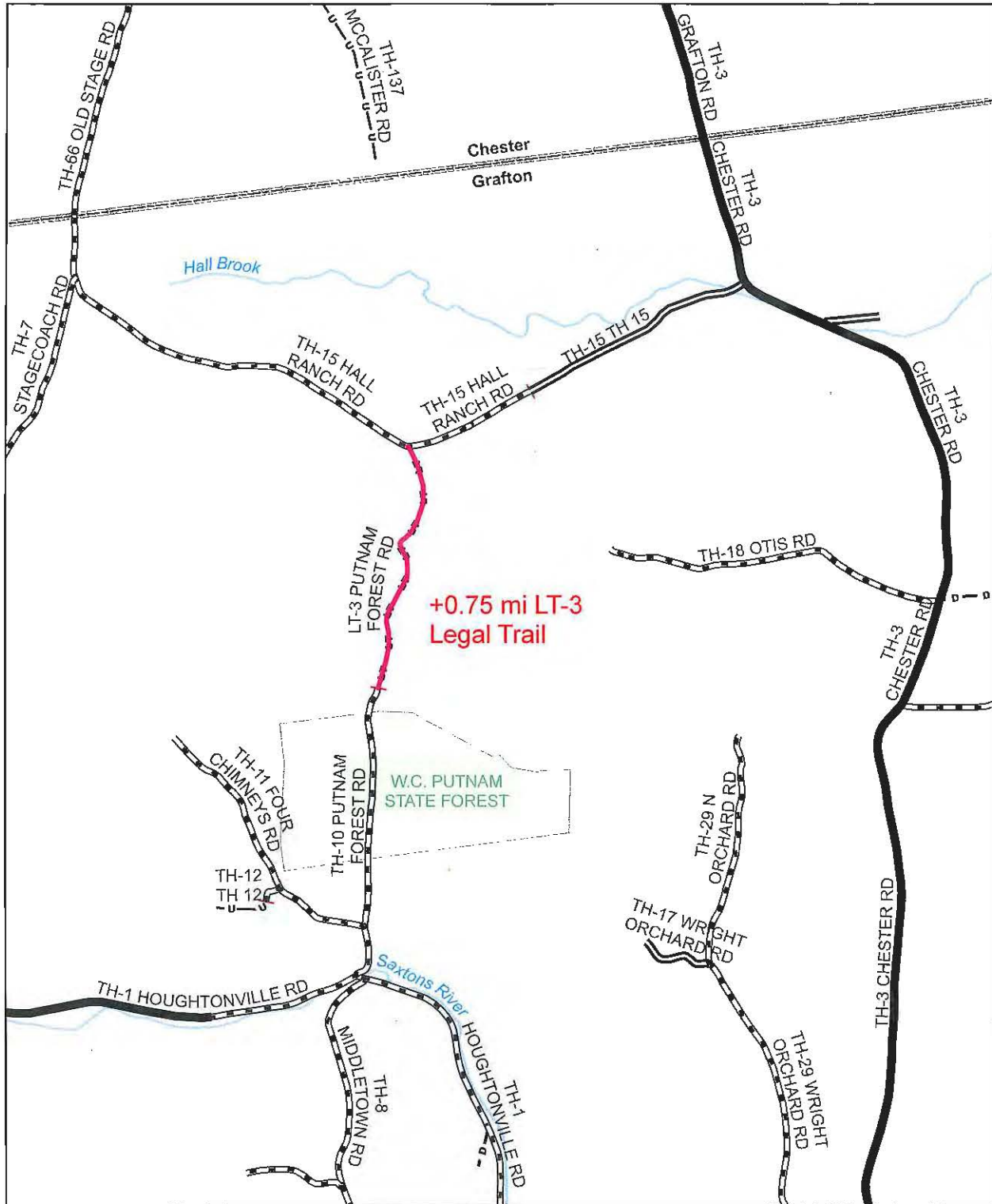

Mileage Certificate Change 2016

GRAFTON

(CTCODE: 1306)

Mapping Section
 Division of Policy, Planning and Intermodal Development
 Vermont Agency of Transportation - April 2016



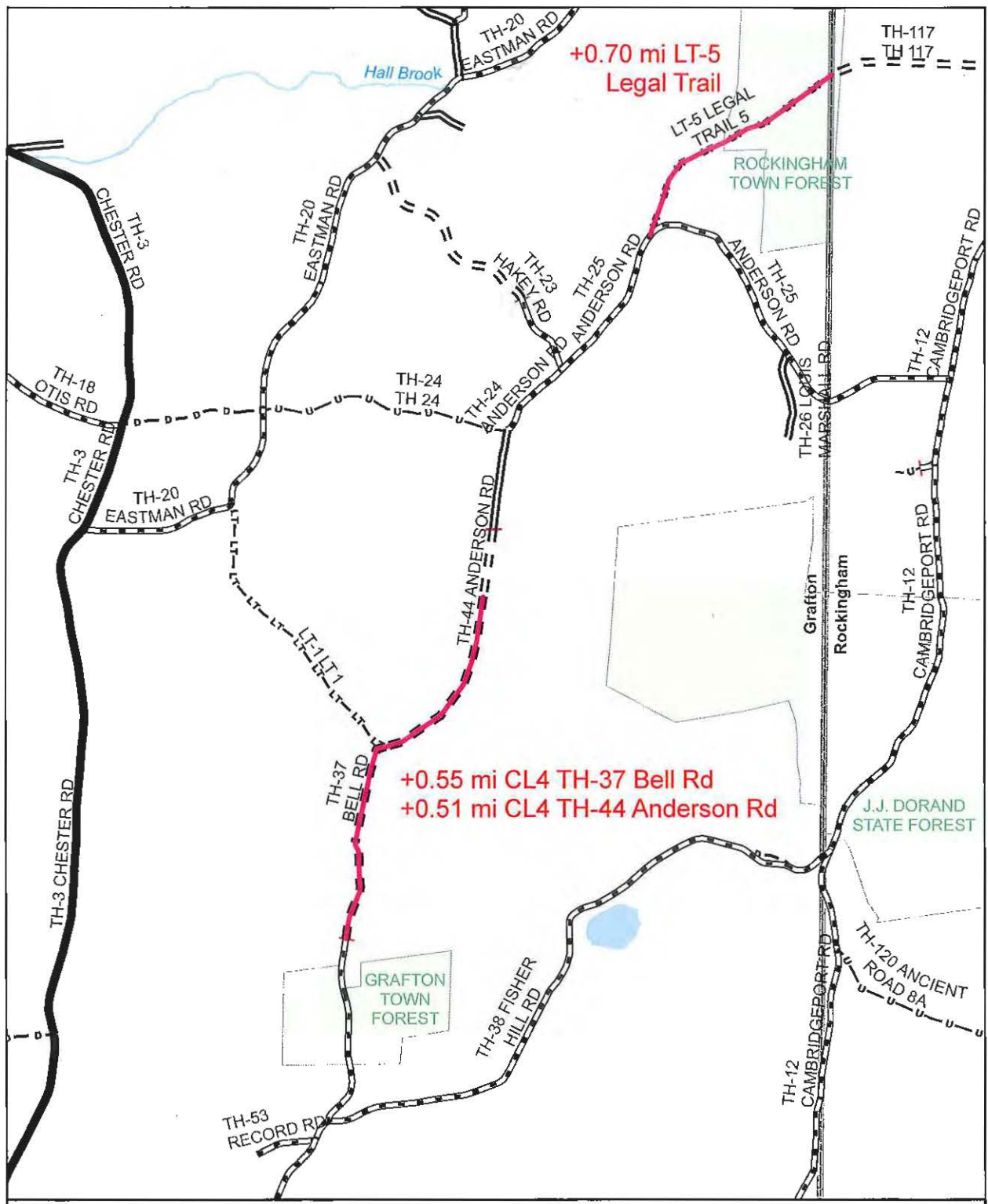

Mileage Certificate Change 2016
GRAFTON
 (CTCODE: 1306)

Mapping Section
 Division of Policy, Planning and Intermodal Development
 Vermont Agency of Transportation - April 2016

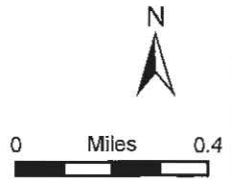

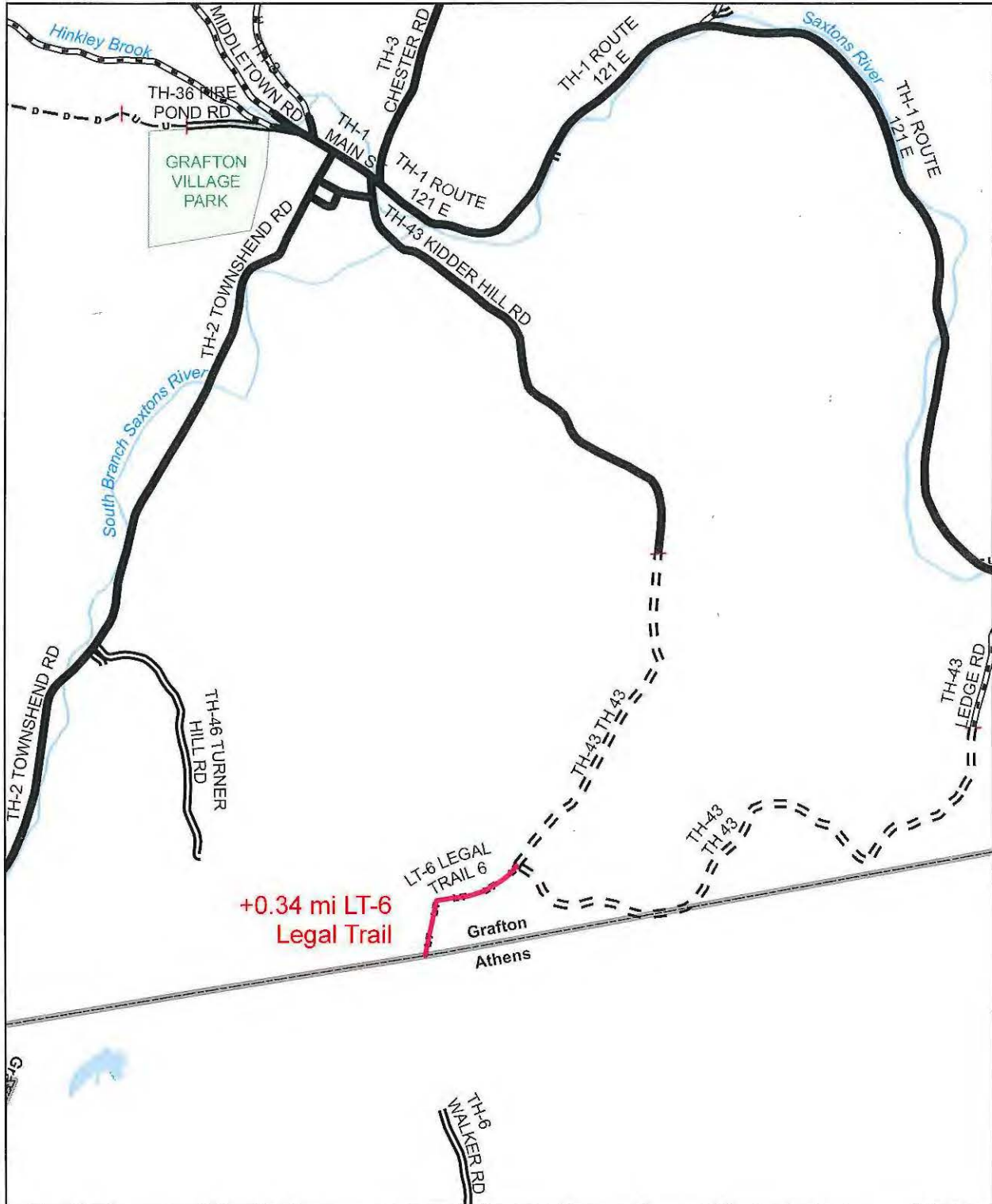

**+0.34 mi LT-6
Legal Trail**

LT-6 LEGAL
TRAIL 6

Grafton
Athens

Mileage Certificate Change 2016
GRAFTON
(CTCODE: 1306)

Mapping Section
Division of Policy, Planning and Intermodal Development
Vermont Agency of Transportation - April 2016

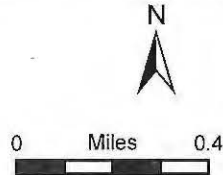

GRAFTON Mileage Certificate Processing Notes 2016	Town Highway or Trail Number	Former Mileage	New Mileage	Length Change	Comment	Documentaiton
Class 4 Mileage Changes						
Need info from Town	TH-15	0.54	0.63	0.09		Not sure the change
Need info from Town	TH-23	0.59	0	-0.59	Reclassified to Legal Trail - LT-4 (Hakey Rd)	No documentation
Need info from Town	TH-24	0.59	0	-0.59	Reclassified to Legal Trail - LT-9	No documentation
Ok to map - in Pending	TH-37	0	1.06	1.06	Old road addition	Survey BOL 109 1820 fits
Need info from Town	TH-42	0.62	0.67	0.05	Remeasurement??	Not sure the change as there isn't enough mileage unless class 3 section reclassified
	TH-43	2.82	3.92	1.10	Old road addition - 1(B) 150-1 1825	Needs different number

1.12

Legal Trail Additions						
Need clear copy of BOL 94	LT-2	0	1.09	1.09	Old road addition	Can't read surveys and one cut off, so can't plot
Ok to map	LT-3	0	0.75	0.75	Old road addition	Survey BOL 23 1788 fits
Need info from Town	LT-4	0	0.59	0.59	Reclassified from CL 4 TH-24	No documentation
Ok to map - in Pending	LT-5	0	0.7	0.70	Old road addition	Survey BOL 23 1788 fits
Ok to map - in Pending	LT-6	0	0.34	0.34	Old road addition	
	LT-7	0	0.54	0.54	Old road addition	
	LT-8	0	0.15	0.15	Old road addition	
Need info from Town	LT-9	0	0.59	0.59	Reclassified from CL 4 TH-23	No documentation

4.75

CL4
+1.06

LT
.75
.7
+.34
+1.79

Town Highway/Legal Trails Addition/Reclassification/Discontinuance Checklist

The following includes a checklist of the documentation to be supplied to VTrans when adding / reclassifying / discontinuing highways and trails. The documentation is subject to verification by VTrans.

Check the box if the information is included as part of the documentation submitted.

- A description of the affected highway or trail
Vt. Stat. Ann. tit. 19, § 305(e)
- Minutes of meetings at which the legislative body took action with respect to the changes
(include copies of the meeting minutes) Vt. Stat. Ann. tit. 19, § 305(e)
- A current town highway map with the requested deletions and additions sketched on it
Vt. Stat. Ann. tit. 19, § 305(e)
- Evidence of written notice to adjoining landowners
(include a copy of the newspaper notice and a copy of the letter sent to adjoining landowners)
Vt. Stat. Ann. tit. 19, § 709
- A copy of any surveys of the affected highway or trail*
Vt. Stat. Ann. tit. 19, § 305(e) Vt. Stat. Ann. tit. 19, § 704

*Note: A survey shall not be required for class 4 town highways that are legally established prior to February 10, 2006 // and a survey is not needed for Discontinuances.

For Class 3 or Class 4 town highway additions

- A Certificate of Completion and Opening
While not required by statute, a Certificate of Completion and Opening form is a helpful document for the record.

All records filed with the agency are subject to verification in accordance with 19 V.S.A. § 305 (a) and 19 V.S.A. § 305 (e).



State of Vermont
Division of Policy, Planning & Intermodal Development
Mapping Section
1 National Life Drive
Montpelier, VT 05633-5001
<http://vtrans.vermont.gov>

Agency of Transportation

Telephone: 802-828-2600
Fax: 802-828-2334
Email: johnathan.croft@state.vt.us

July 1, 2015

Lawrence (Skip) Lisle, Selectboard Chair
Town of Grafton, c/o Town Clerk
PO Box 180
Grafton, VT 05146

Dear Mr. Lisle,

The VTrans Mapping Section has not accepted Grafton's 2015 Certificate of Highway Mileage due to the lack of documentation and clarity showing the legal establishment of these highways through the formal laying out process or "dedication and acceptance".

VTrans sent a letter on March 4, 2015 to the Town of Grafton requesting documentation regarding the establishment of these highways and no documents have been received to date. The Vermont Supreme Court decision, *Austin v. Town of Middlesex*, 2009 VT 102 (Oct. 27, 2009) has reaffirmed the need for documentation showing the legal establishment of town highways. A copy of this decision can be found at the following link –

<http://info.libraries.vermont.gov/supct/current/eo2008-428.html>

The changes that were listed on the 2015 Certificate of Highway Mileage may be re-submitted on the 2016 Certificate with documentation as evidence of legal establishment for review and the potential inclusion on the 2016 Town Highway Map.

Please feel free to contact me with any questions or comments related to this letter, or mapping in general.

Sincerely,

A handwritten signature in black ink, appearing to read "Johnathan Croft".

Johnathan Croft
AOT GIS Database Administrator
VTrans Mapping Section

JFC/jfc

Enclosures

cc: Michele Boomhower, Director of the VTrans Policy, Planning & Intermodal Development Division
John Dunleavy, Assistant Attorney General
Tammy Ellis, District Transportation Administrator
Jackie Cassino, VTrans Transportation Planning Coordinator

**CERTIFICATE OF HIGHWAY MILEAGE
YEAR ENDING FEBRUARY 10, 2015**

Fill out form, make and file copy with the Town Clerk, and mail ORIGINAL, before February 20, 2015 to:
Vermont Agency of Transportation, Division of Policy, Planning and Intermodal Development,
One National Life Drive, Montpelier, VT 05633.

We, the members of the legislative body of **GRAFTON** in **WINDHAM** County
on an oath state that the mileage of highways, according to Vermont Statutes Annotated, Title 19, Section 305,
added 1985, is as follows:

PART I - CHANGES TOTALS - Please fill in and calculate totals.

Town Highways	Previous Mileage	Added Mileage	Subtracted Mileage	Total	Scenic Highways
Class 1	0.000			0.000	0.000
Class 2	18.300			18.300	0.000
Class 3	30.67	.41		31.080	0.000
State Highway	0.000			0.000	0.000
Total	48.970			49.380	0.000
* Class 1 Lane	0.000			0.000	
* Class 4	8.36	1.120		9.480	0.000
* Legal Trail	0.81	4.750		5.560	
* Unidentified Corridor	0.00			0.00	

* Mileage for Class 1 Lane, Class 4, Legal Trail, and Unidentified Corridor classifications are NOT included in total.

PART II - INFORMATION AND DESCRIPTION OF CHANGES SHOWN ABOVE.

- NEW HIGHWAYS:** Please attach Selectmen's "Certificate of Completion and Opening".
- DISCONTINUED:** Please attach SIGNED copy of proceedings (minutes of meeting).
- RECLASSIFIED/REMEASURED:** Please attach SIGNED copy of proceedings (minutes of meeting).
- SCENIC HIGHWAYS:** Please attach a copy of order designating/discontinuing Scenic Highways.

IF THERE ARE NO CHANGES IN MILEAGE: Check box and sign below. []

PART III - SIGNATURES - PLEASE SIGN.

Selectmen/ Aldermen/ Trustees Signatures:

[Handwritten signatures]

T/C/V Clerk Signature: *[Handwritten Signature]*

Date Filed: 2/17/15

Please sign ORIGINAL and return it for Transportation signature.

AGENCY OF TRANSPORTATION APPROVAL: Signed copy will be returned to T/C/V Clerk.

APPROVED: _____
Representative, Agency of Transportation

DATE: _____

TOWN	LENGTH IN MILES	HWY. CLASS	CLASS
No.	3	4	
6	2.86		
7	2.19		
8	2.13		
9	0.62		
10	0.65		
11	0.03		
12	0.05	(2.14)	
13		(2.02)	
14	0.15		
15	1.42	(2.54)	
16	0.20		
17	0.95		
18	0.03		
19	0.03		
20	2.85		
21	0.31	(2.19)	
22	0.14		
23	0.22	(2.29)	
24	0.21	(0.58)	
25	1.17		
26	0.20		
27	0.86		
28	0.02		
29	0.27		
30	0.08	(0.28)	
31	0.36	(0.44)	
32	0.03	(0.14)	
33	0.51		
34	0.30		
35	0.03	(0.14)	
36	0.03		
37	0.51		
38	0.90		
39	0.77		
40	0.88	(0.45)	
41	0.88	(0.52)	
42	2.03	(2.22)	
43	0.27	(0.18)	
44	0.18	(0.62)	
45	0.71		
46	0.15		
47	0.11		
48	0.05		
49	0.05		
50	0.05		
51	0.05		
52	0.03		
53	0.16		
54	0.15		
TOTAL	30.87	8.36	

LEGAL TRAIL	LENGTH IN MILES	LEGAL TRAIL
No.		
1	0.37	
TOTAL	0.37	

MILEAGE SUMMARY	
CLASS 2	
TH-1	8,770
TH-2	3,730
TH-3	4,540
TH-4	0,290
TOTAL CLASS 2	18,330
CLASS 3	
TOTAL CLASS 3	33.67
TOTAL TOWN	48,970
TOTAL STATE	0,680

TOTAL TRAVELED HIGHWAYS, FEB. 10, 2015: 48,970
 (Excludes Class 4, Legal Trail, and Undersigned County Mileage.)

- HIGHWAYS**
- INTERSTATE
- U.S. ROUTE
- STATE ROUTE
- CLASS 1
- CLASS 2
- CLASS 3
- CLASS 4
- LEGAL TRAIL
- INTERSTATE OR DIVIDED HIGHWAY
- STATE-PAVED SURFACE OR PAVED DRIVE-PAVED SURFACE OR PAVED GRAVEL
- SOIL OR GRADED AND DRAINED EARTH
- UNIMPROVED OR PRIMITIVE
- IMPASSABLE OR UNTRAVELED
- LEGAL TRAIL
- DISCONTINUED
- HIGHWAY CLASS CHANGE
- RAILROAD
- PASSIVE RAILROAD
- NATIONAL FOREST ROAD
- STATE FOREST HIGHWAY
- PARK AND RIDE
- PUBLIC LAND - GREEN MOUNTAIN NATIONAL FOREST
- PUBLIC LAND - STATE/MUNICIPAL
- POLITICAL SUBDIVISIONS
- STATE BOUNDARY
- COUNTY BOUNDARY
- SOIL OR GRADED AND DRAINED EARTH
- TOWN BOUNDARY
- VILLAGE BOUNDARY
- URBAN CONCEPT BOUNDARY
- LEGAL TRAIL
- WATER BODY
- NEEDHAM OR PLYMOUTH BRIDGE OR CULVERT
- BRIDGE OR CULVERT - 0'
- BRIDGE OR CULVERT 0' - 25'
- VORBIT BRIDGES
- VORBIT CULVERT - 0'
- STATE BRIDGE OR CULVERT IDENTIFIER
- TOWN BRIDGE OR CULVERT IDENTIFIER
- FEDERAL CLASSIFICATION IDENTIFIER
- FAU - FEDERAL ARTERIAL OR COLLECTOR
- BA - BRIDGE ARTERIAL
- MAC - MAJOR COLLECTOR
- MC - MINOR COLLECTOR
- PA - PRINCIPAL ARTERIAL

DISCLAIMER:
 The unimproved roads (to 2-foot down 19' up) roads, discontinued highways, and local roads shown on this map are those of which the Agency of Transportation has records; others may exist.
 Highway and bridge data by the Agency of Transportation. Town street structures are drawn from the Vermont Online Slope & Culvert Inventory Tool (VOCISIT) database. All other data from the Vermont Center for Geographic Information. Only named streams are shown.

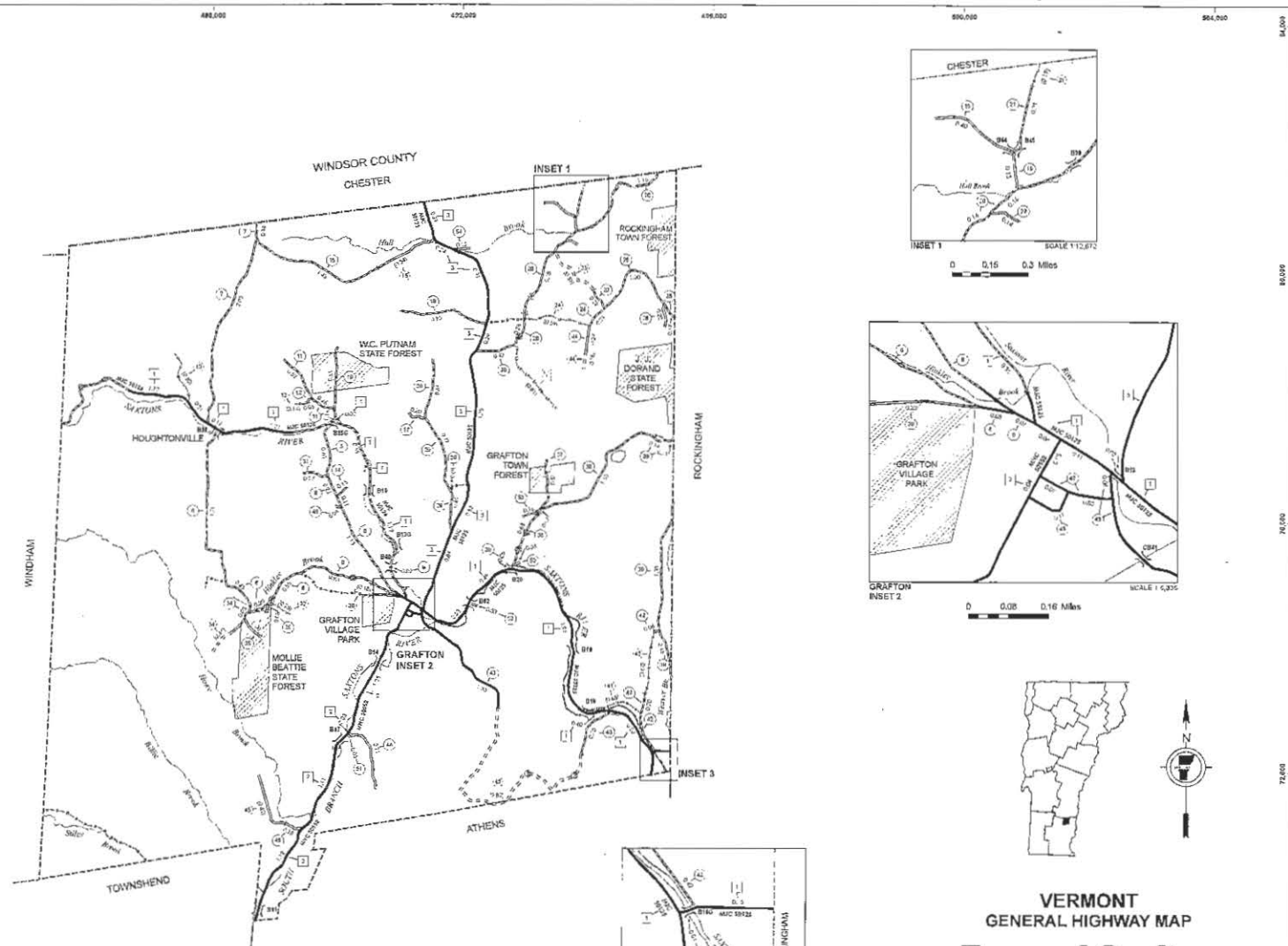

VERMONT
GENERAL HIGHWAY MAP
Town of Grafton
 WINDHAM COUNTY

Transportation District #2
 Prepared by the
 Vermont Agency of Transportation
 Division of Policy Planning and Intermodal Development
 in cooperation with
 U.S. Department of Transportation
 Federal Highway Administration

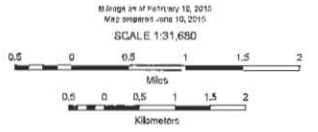

sent to vitrans
2/17/15 m

TOWN HWY. No.	LENGTH IN MILES		ADDITIONS/INCREASES	
	CLASS 3	CLASS 4	HWY NO.	CLASS
6	3.96			
7	2.19			
8	2.13			
9	0.02			
10	0.65			
11	0.93			
12	0.06	(0.14)		
13		(0.50)		
14	0.15			
15	1.43	(0.54)	15	(.63)
17	0.20			
18	0.95			
19	0.53			
20	2.95			
21	0.31	(0.19)		
22	0.14			
23	0.22	(0.58)		
24	0.21	(0.58)		
25	1.17			
26	0.20			
29	1.80			
30	0.05			
31	0.27			
32		(0.28)		
34	0.08	(0.46)		
35	0.38			
36	0.23	(0.18)		
37	0.51		37	(1.00)
38	2.50			
39	1.77			
41		(0.65)		
42	0.68	(0.82)	42	(.67)
43	2.08	(2.82)	43	(3.92)
44	0.27	(0.18)	44	
45	0.18	(0.62)		.48
46	0.71			
47	0.15			
48	0.11			
49	0.06			
50	0.05			
51	0.05			
52	0.03			
53	0.16			
54	0.15			
TOTAL	30.67	8.38		
	31.08	9.48		

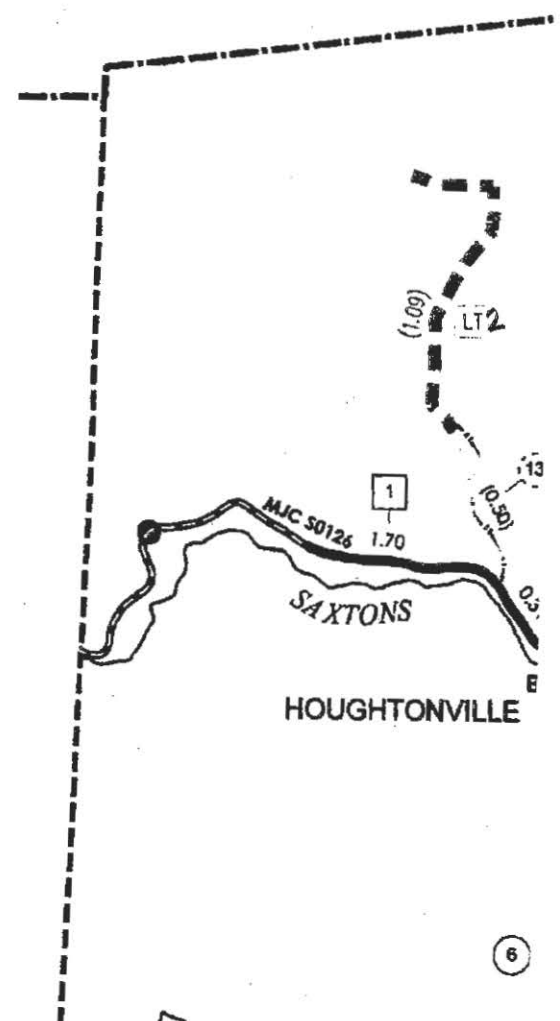

LEGAL TRAIL No.	LENGTH IN MILES LEGAL TRAIL
1	(0.81)
TOTAL	0.81 5.56

ADDITIONS/INCREASES

HWY NO	LEGAL TRAIL IN MILES
LT 2	1.09
LT 3	.75
LT 4	.59
LT 5	.70
LT 6	.84
LT 7	.64
LT 8	.15
LT 9	.59

MILEAGE SUMMARY

CLASS 2		
TH-1	9.770	
TH-2	3.730	
TH-3	4.540	
TH-4	0.260	
TOTAL CLASS 2	18.300	
CLASS 3		
TOTAL CLASS 3	30.07 31.08	
TOTAL TOWN	48.970	
TOTAL STATE	0.000	

TOTAL, TRAVELED HIGHWAYS, FEB. 10, 2015 ~~48.970~~
 (Excludes Class 4, Legal Trail, and Unidentified Corridor Mileage) 49.38

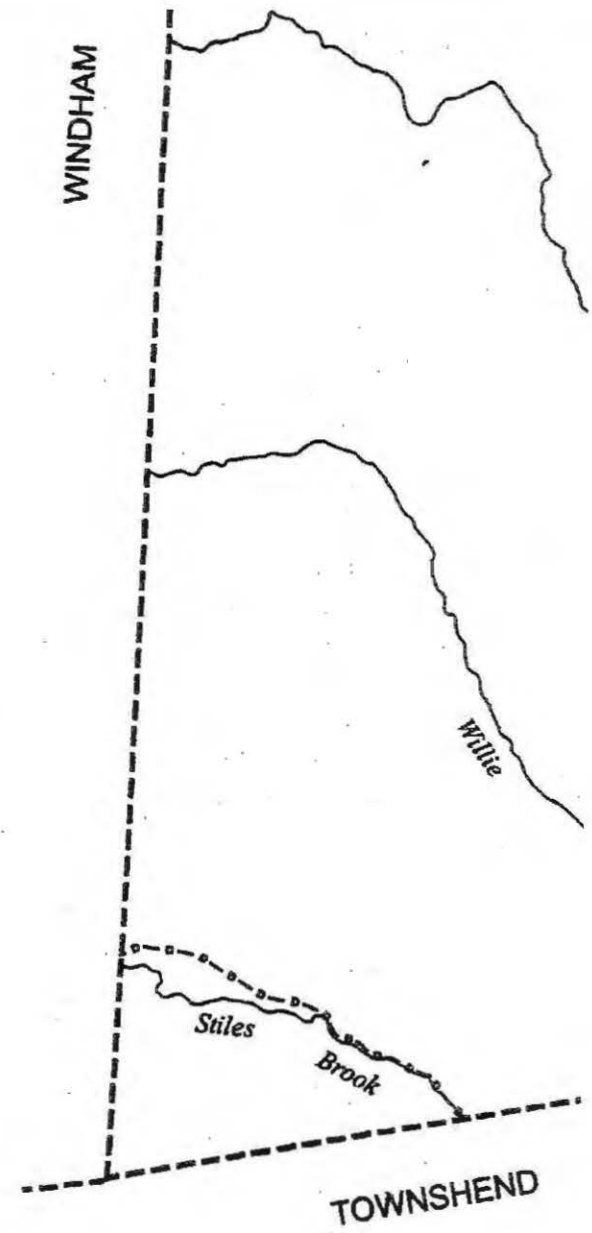

WINDSOR COUNTY
CHESTER

INSET 1

ROCKINGHAM
TOWN FOREST
LTS

J.J.
DORAND
STATE FOREST

GRAFTON
TOWN FOREST

ROCKINGHAM

W.C. PUTNAM
STATE FOREST

MOLLIE BEATTIE
STATE FOREST

GRAFTON
VILLAGE PARK

GRAFTON
INSET 2

INSET 3

ATHENS

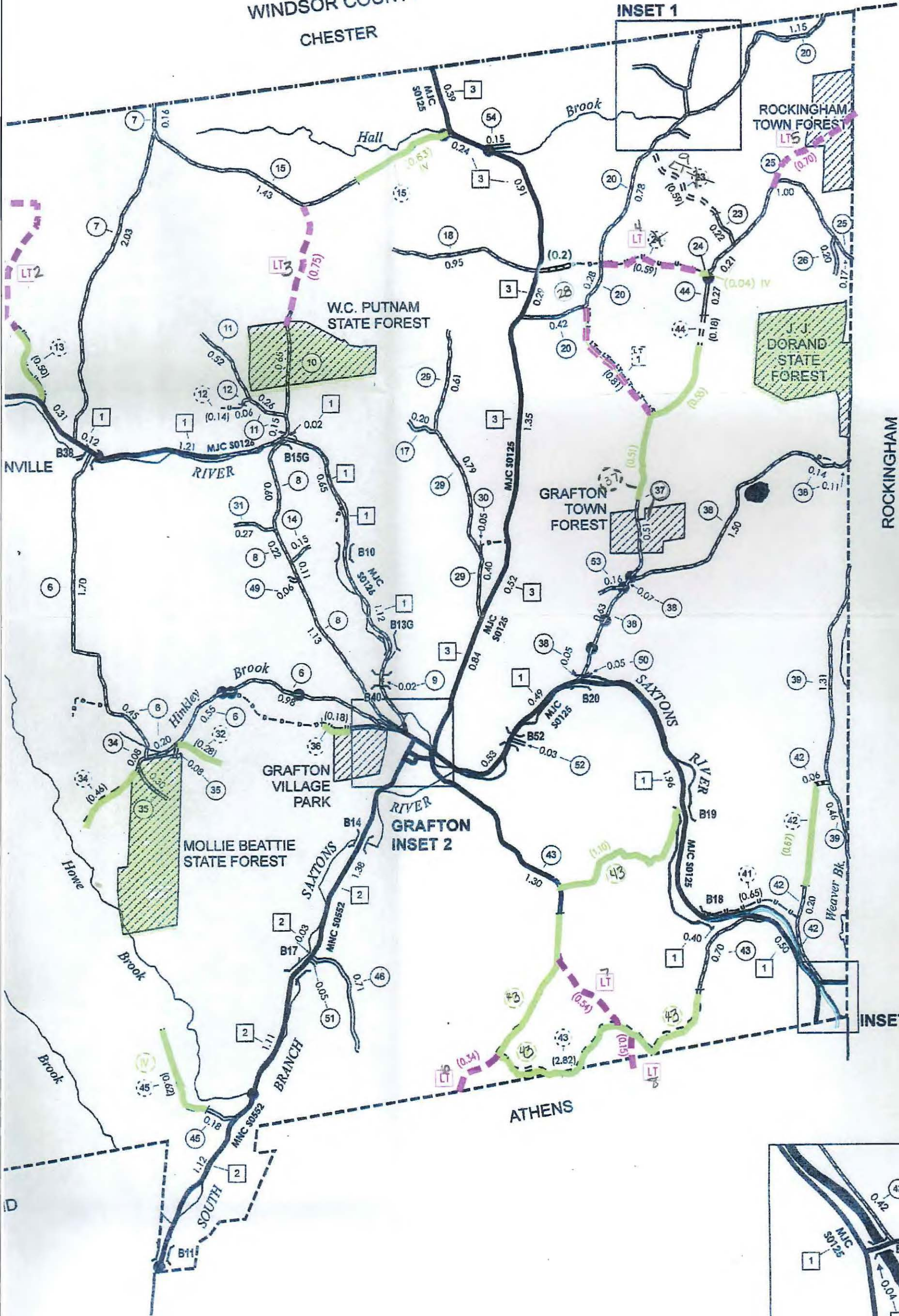
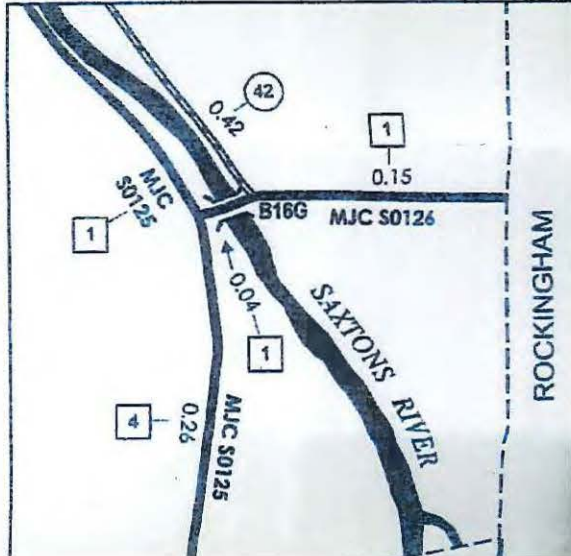

WINDSOR COUNTY
CHESTER

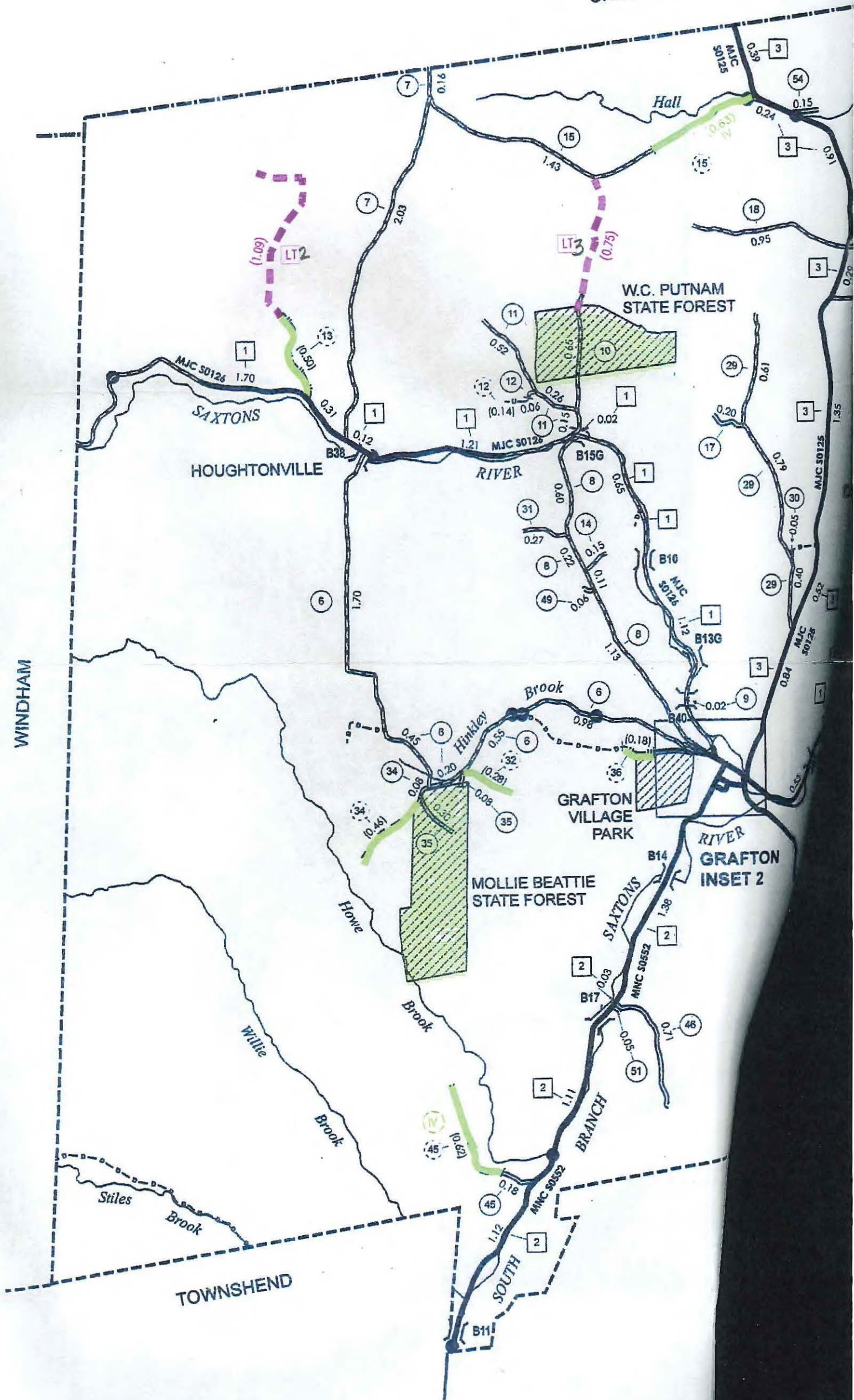

480,000

484,000

84,000

80,000

76,000

72,000

TOWN HWY. No.	LENGTH IN MILES		ADDITIONS/INCREASES	
	CLASS 3	CLASS 4	HWY NO.	CLASS
6	3.96		28	.20
7	2.19			
8	2.13			
9	0.02			
10	0.65			
11	0.93			
12	0.06	(0.14)		
13		(0.50)		
14	0.15			
15	1.43	(0.54)	15	(.03)
17	0.20			
18	0.95			
19	0.53			
20	2.95			
21	0.31	(0.19)		
22	0.14			
23	0.22	(0.59)		
24	0.21	(0.59)		
25	1.17			
26	0.20			
29	1.80			
30	0.05			
31	0.27			
32		(0.28)		
34	0.08	(0.46)		
35	0.38			
36	0.23	(0.18)		
37	0.51		37	(1.00)
38	2.50			
39	1.77			
41		(0.65)		
42	0.68	(0.02)	42	(.167)
43	2.08	(2.82)	43	(3.92)
44	0.27	(0.18)	44	.48
45	0.18	(0.62)		
46	0.71			
47	0.15			
48	0.11			
49	0.06			
50	0.05			
51	0.05			
52	0.03			
53	0.16			
54	0.15			
TOTAL	30.67 31.08	8.36 9.48		

LEGAL TRAIL No.	LENGTH IN MILES		ADDITIONS/INCREASES	
	LEGAL TRAIL		HWY NO.	LENGTH IN MILES
1	(0.81)		LT 2	1.09
			LT 3	.75
			LT 4	.59
			LT 5	.70
			LT 6	.34
			LT 7	.54
			LT 8	.15
			LT 9	.59
TOTAL	0.81 5.56			

MILEAGE SUMMARY

CLASS 2		
TH-1	9.770	
TH-2	3.730	
TH-3	4.540	
TH-4	0.260	
TOTAL CLASS 2	18.300	
CLASS 3		
TOTAL CLASS 3	30.67 31.08	
TOTAL TOWN	48.970	
TOTAL STATE	0.000	

TOTAL, TRAVELED HIGHWAYS, FEB. 10, 2015: 48.970
 (Excludes Class 4, Legal Trail, and Unidentified Corridor Mileage) 49.38

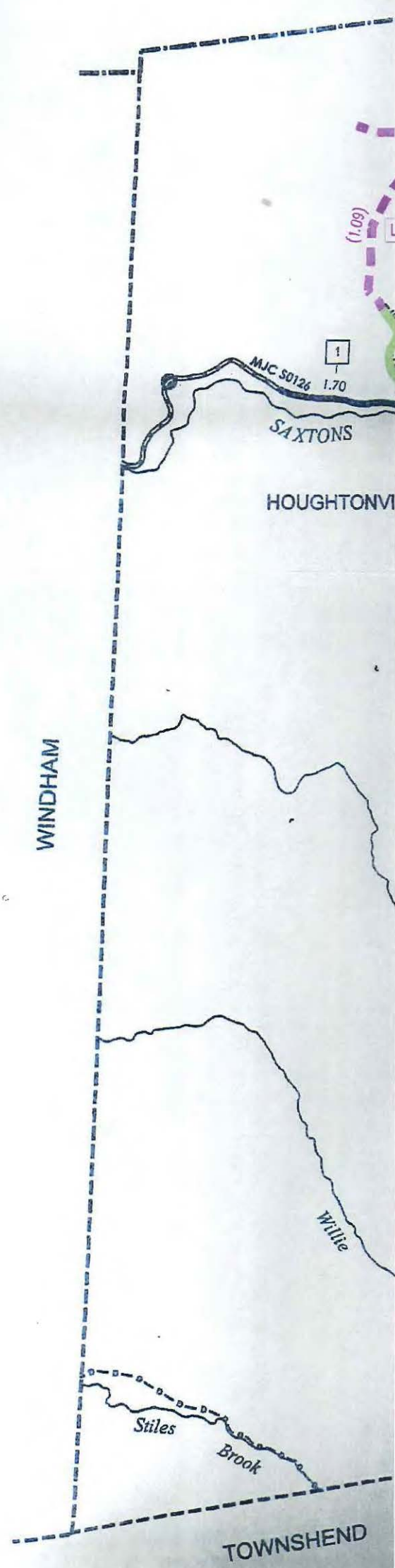

Handwritten signatures and initials at the bottom of the page.

Grafton Board of Selectmen, Grafton VT

Minutes

Date: Monday, February 16, 2015

Selectmen Present: Skip Lisle, Noralee Hall, Sam Battaglino, Peter Jeziorski, Gus Plummer.

Selectmen Absent: None.

Community Members Present: Kim Record, Joan Lake, Cynthia Gibbs, Fred Duplessis, Wendy Martin, Eric Stevens, Al Sands, Pat Mack, Stan Mack, Dick Warren, Rex James, Rachel Williams (Minute Taker).

Convened: 6:00 PM

Adjourned: 7:05 PM

Motions Underlined, Votes CAPS.

Public Comment:

Red Pine Sale – Gus Plummer stated that he has attempted to contact the Forrester, in which he has not yet received a response.

Town Hall Repairs – Gus Plummer left a message with Cenate and Sons for an approximation of when the repairs would begin. Rachel Williams then spoke with the owner, Darlton Cenate, and was told that repairs would begin shortly. The delay is due to weather related issues. He will contact her next week.

Town Reports – Kim Record stated that the Town Report proof copy was correct when submitted to her for approval, but was printed without the first and last two pages. The missing pages were copied and inserted into the Town Reports. In recent years it seems that the books are increasing in size. The Town's portion only makes up the first half of book with the School taking up the remainder. It will be looked into where we can make some cuts to reduce the size and cost of printing. This year's Town Reports cost \$1,900 plus the cost of mailing is approximately \$3.50 for each report. To reduce the cost, the Town Hall employees are trying to pass out as many as possible before the February 20 mailing deadline.

Agenda: Motion to approve agenda with no changes. (Skip Lisle) PASSED.

Town Audit (Fred Duplessis) – Fred Duplessis, Professional Auditor, gave an overview of the Town's 2013-2014 final audit. This year, there were no changes in the accounting principles, but next year the Town's VMERS retirement contributions will be added. The Town has collected all funds awarded from FEMA, due to TS Irene in 2011, and we no longer have any funds outstanding. The last 2 pages of the audit are the report on Internal Controls and compliance. The Town has received a clean report. He praised the Town Hall staff for doing a fantastic job this past year and for being well prepared for the audit, but he would like to see some internal control documentation in place for next year's audit. The audit is available on the Town's web-page, graftonvt.org, for viewing and download.

Minutes: Motion to adopt minutes of January 19, 2015 with no changes. (Skip Lisle) PASSED.

Warrants: Payroll and Accounts Payable – Pending Completion.

Highway Report – Rachel Williams, Town Administrator on behalf of Danny Taylor, Forman.

- a. **Work Schedule** – Weather Related.
- b. **Town Garage Update** – Construction is due to start April 1, 2015.
- c. **Other Highway Issues** – We are currently over budget by approximately \$6,000 for salt. We are within budget for sand.

Delinquent Taxes Update – Delinquent Tax Collector, Jan Atwood, was unable to attend tonight. Peter Jeziorski has found an attorney who will do a single delinquent tax sale and has asked Rachel Williams send the information to Jan Atwood. Kim Record asked him if he had discussed the amount and situation of this particular delinquency with the attorney. She also stated that the Town Attorney usually handles all tax sales. Cynthia Gibbs suggested taking the matter to the small claims court instead of a tax sale to save money.

No-Suit Pending Form – Nancy Merrill, Lister, has submitted the annual No-Suit Pending Form for the Select Board’s approval. The Selectboard signed it and it was submitted to the Town Clerk.

Act 148 – Skip Lisle discussed the State adopted Solid Waste Management Act. The purpose of this act is to reduce the amount of recyclables, food scraps and organic waste from going into the landfills. Handouts are available in the Selectman’s office or by contacting Rachel Williams, Town Administrator.

Windham Foundation Pedestrian Bridge – Karl Lauren spoke with Rachel Williams last week and stated that the Windham Foundation has received \$40,000 in grant funds, with the additional \$50,000, they will be able to complete the pedestrian bridge. Construction should begin this spring. If there are any questions about the bridge, please contact the Windham Foundation.

Town Garage Well Drilling Bids – Noralee Hall opened and read aloud each bid.

Cushing & Sons	Cost per drilling foot	\$10.90
	Cost per casing and grouting foot	\$25.00
	General equipment price estimate	\$2,485.00
Wragg Brothers	Cost per drilling foot	\$11.00
	Cost per casing and grouting foot	\$18.00
	General equipment price estimate	\$3450.00
Lynde Well Drilling	Cost per drilling foot	\$10.00
	Cost per casing foot	\$16.00
	Grouting cost (Flat fee)	\$500.00

	General equipment price estimate	\$4,175.00
Green Mountain Well Co.	Cost per drilling foot	\$10.00
	Cost per casing and grouting per foot	\$14.70
	General equipment price estimate	\$2,794.95

The Town Garage Committee will review the bids and award the bid at their discretion. Rachel Williams will contact all bidders.

High Meadows Funding Grant Update – Due to a lack of Multi-Municipal interest, we will not be eligible to pursue this funding opportunity at this time. Information and updates will be submitted to the Select Board and will potentially be reviewed again at a later date.

Town Roads and Bridge Standards Certificate – The annual certificate was signed by the Select Board.

Municipal Excess Weight Permit – This permit was requested by Newport Sand & Gravel and Carroll Concrete. There are no weight restrictions notated. Skip Lisle signed.

Highway Mileage Certificate – The changes to the Town Highway Mileage was read aloud by Skip Lisle. The Class 3, from 2014, was 30.6 miles and is now 31.08, Class 4 was 8.36 and is now 9.48, and the legal trails were .81 and are now 5.56. Only the Class 2 and Class 3 roads receive state funding. Motion to approve the updated map and the Highway Mileage Certificate (Sam Battaglino) PASSED. The Select Board signed the certificate and initialed the map. Rachel Williams will submit both to VTRANS tomorrow.

Ancient Roads Update – Thank you to all of those who assisted in the completion of the Ancient Roads process and mapping.

FEMA Re-Use Grant Update– The FEMA Buy-OUT Re-Use Grant application has been submitted. The grants should be awarded in the spring.

Other Business:

Rachel Williams received a request to use the Town as the setting in a trilogy of fictional books. A letter will be sent to the author granting approval and stating that if any privately owned locations are used, the author must also seek approval from the owner. Another request was received, from a student from NYU who is shooting her thesis film, asking permission to use a location in Grafton for a scene. She would like to utilize a VAST trail bridge off of Route 121. Rachel Williams contacted Ivor Stevens, the Grafton VAST representative, for VAST approval. Motion to grant permission for the author, LaToya Savage, and the film student, Poulia Alexa St. John, to use the Town of Grafton as the setting in the book and film. (Skip Lisle) PASSED.

Village Store – Rex James would like to bring to the attention of the community that the Grafton Store is an important asset to the Town and some steps should be made to ensure their success. He made a suggestion of subsidizing or waiving the property taxes, or something of

that nature, to help support the store and he also encourages the community to utilize the store more frequently. Sam Battaglino mentioned this to VLCT and was told that due to the private ownership, it is not a Town matter. As for waiving the store's property taxes, the building is owned by the Windham Foundation which is then rented to the store owner.

Next Meeting Date:

- School Board, Pre-Town Meeting and Candidate Forum – Tuesday February 24, 2015 at Grafton Elementary School, 6:30 PM.
- Regular Select Board Meeting - Monday, March 2, 2015 at Grafton Elementary School, 6PM.
- Town Meeting - Tuesday, March 3, 2015 at Grafton Elementary School, 10AM.

Adjourn: Motion to Adjourn. (Skip Lisle) PASSED.

Office of
BOARD OF SELECTMEN



TOWN OF GRAFTON

P.O. Box 180
Grafton, Vermont 05146

To Whom It May Concern,

During the Ancient Roads unidentified corridors process, we discovered a mileage discrepancy on the mileage certificate on two Class 3 portions. We are requesting that these errors be corrected. I have submitted a map with the correct mileage and any updates due to the ancient roads process. Please contact me with any inquiries.

Sincerely,

A handwritten signature in cursive script that reads "rwilliams".

Rachel Williams
Town Administrator

Office of
BOARD OF SELECTMEN



P.O. Box 180
Grafton, Vermont 05146

TOWN OF GRAFTON

April 5, 2012

To Whom It May Concern,

On behalf of the Ancient Road's Committee, we would like to notify you that there will be a site visit to an Ancient Road which runs through your property. It is a requirement of ACT 178 to notify property owners of such visits fourteen days prior to the visit to determine if the road falls into the unidentified corridor category or, based upon physical evidence, could be classified as a Class 4 road or a trail. The site visit will take place between the 19th and 30th of April.

Sincerely,

Jackie LeBlanc
Town Administrator

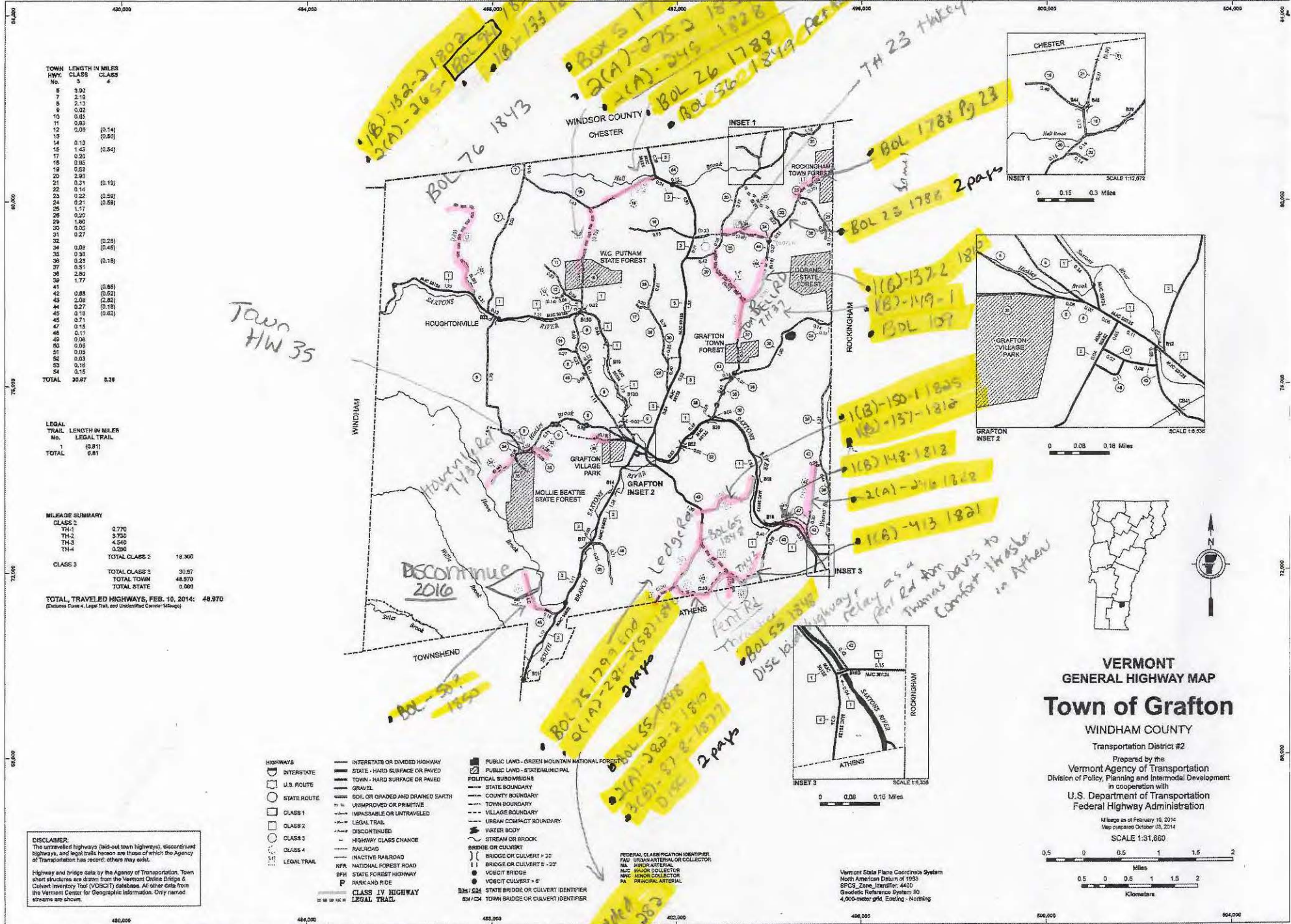

TOWN HWY No.	CLASS 3	CLASS 4
1	3.90	
7	2.10	
8	2.13	
9	0.02	
10	0.65	
11	0.83	(0.14)
12	0.08	(0.80)
13		
14	0.18	
15	1.43	(0.54)
17	0.30	
18	0.85	
19	0.55	
20	2.95	
21	0.31	(0.15)
22	0.14	
23	0.22	(0.59)
24	0.21	(0.59)
25	1.17	
26	0.20	
28	1.90	
30	0.02	
31	0.27	
32		(0.28)
34	0.08	(0.45)
35	0.38	
36	0.23	(0.18)
37	0.51	
38	0.20	
39	1.77	
41	0.88	(0.85)
42	2.08	(0.82)
44	0.27	(0.18)
46	0.18	(0.82)
45	0.71	
47	0.15	
48	0.11	
50	0.06	
51	0.06	
52	0.03	
53	0.18	
54	0.16	
TOTAL	20.87	8.38

LEGAL TRAIL No.	LENGTH IN MILES
1	(0.81)
TOTAL	0.81

MILEAGE SUMMARY	
CLASS 2	
TN-1	0.770
TN-2	5.722
TN-3	4.640
TN-4	0.290
TOTAL CLASS 2	11.422
CLASS 3	
TOTAL CLASS 3	30.87
TOTAL TOWN	48.979
TOTAL STATE	0.868

TOTAL TRAVELED HIGHWAYS, FEB. 10, 2014: 48.970
 (Distance Class 4 Legal Trails and Unimproved Center Islands)

DISCLAIMER:
 The untraveled highway (dashed town highways), discontinued highways, and legal trails herein are those of which the Agency of Transportation has record; others may exist.
 Highway and bridge data by the Agency of Transportation, Town short structures are drawn from the Vermont Online Bridge & Culvert Inventory Tool (VOCBIT) database. All other data from the Vermont Center for Geographic Information. Only named streams are shown.

- HIGHWAYS**
 - INTERSTATE
 - U.S. ROUTE
 - STATE ROUTE
 - CLASS 1
 - CLASS 2
 - CLASS 3
 - CLASS 4
 - LEGAL TRAIL
- INTERSTATE OR DIVIDED HIGHWAY**
- STATE - HARD SURFACE OR PAVED**
- TOWN - HARD SURFACE OR PAVED**
- GRAVEL**
- SOIL OR GRADED AND DRAINED SMART**
- UNIMPROVED OR PRIMITIVE**
- IMPASSABLE OR UNTRAVELED**
- LEGAL TRAIL**
- DISCONTINUED**
- HIGHWAY CLASS CHANGE**
- RAILROADS**
- REACTIVE RAILROAD**
- NFR NATIONAL FOREST ROAD**
- DFH STATE FOREST HIGHWAY**
- PARK AND RIDE**
- CLASS IV HIGHWAY**
- LEGAL TRAIL**

- PUBLIC LAND - GREEN MOUNTAIN NATIONAL FOREST**
- PUBLIC LAND - STATE/MUNICIPAL**
- POLITICAL SUBDIVISIONS**
- STATE BOUNDARY**
- COUNTY BOUNDARY**
- TOWN BOUNDARY**
- VILLAGE BOUNDARY**
- URBAN COMPACT BOUNDARY**
- WATER BODY**
- STREAM OR BROOK**
- BRIDGE OR CULVERT**
- BRIDGE OR CULVERT - 20'**
- BRIDGE OR CULVERT - 20'**
- VORBIT BRIDGE**
- VORBIT CULVERT - 6'**
- STATE BRIDGE OR CULVERT IDENTIFIER**
- TOWN BRIDGE OR CULVERT IDENTIFIER**

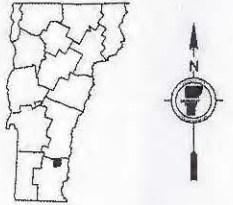
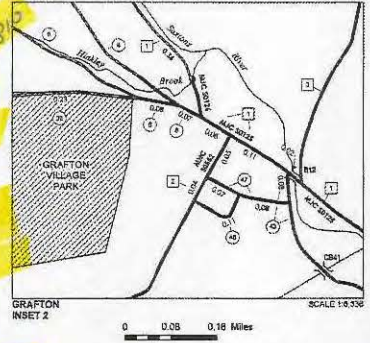
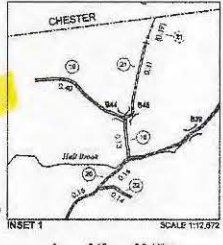
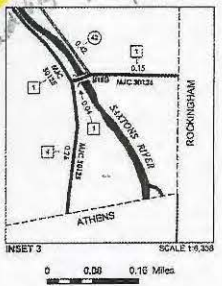

VERMONT GENERAL HIGHWAY MAP
Town of Grafton
 WINDHAM COUNTY
 Transportation District #2
 Prepared by the Vermont Agency of Transportation
 Division of Policy, Planning and Intermodal Development
 in cooperation with
 U.S. Department of Transportation
 Federal Highway Administration
 Mileage as of February 10, 2014
 Map prepared October 03, 2014
 SCALE 1:31,860

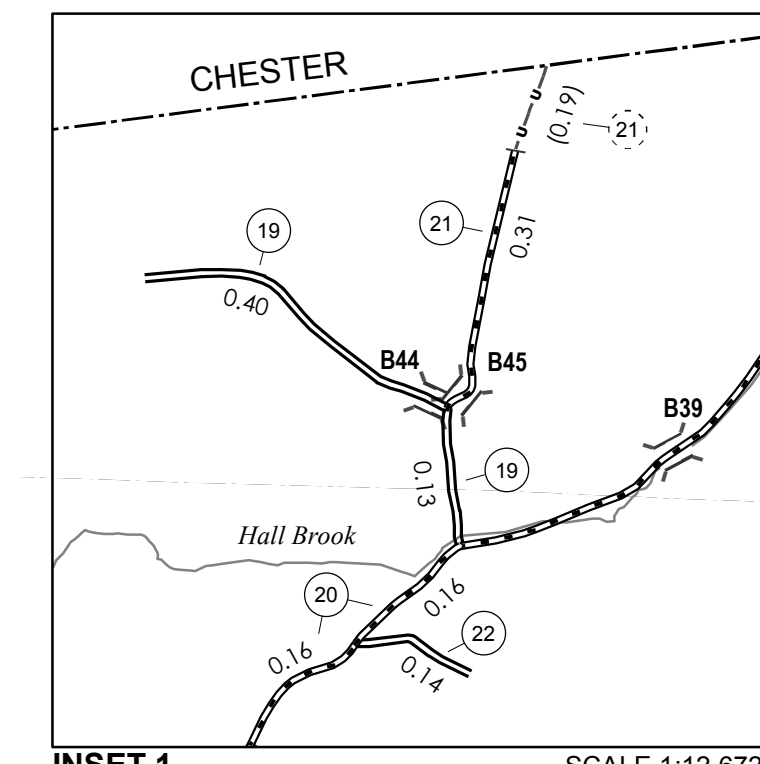
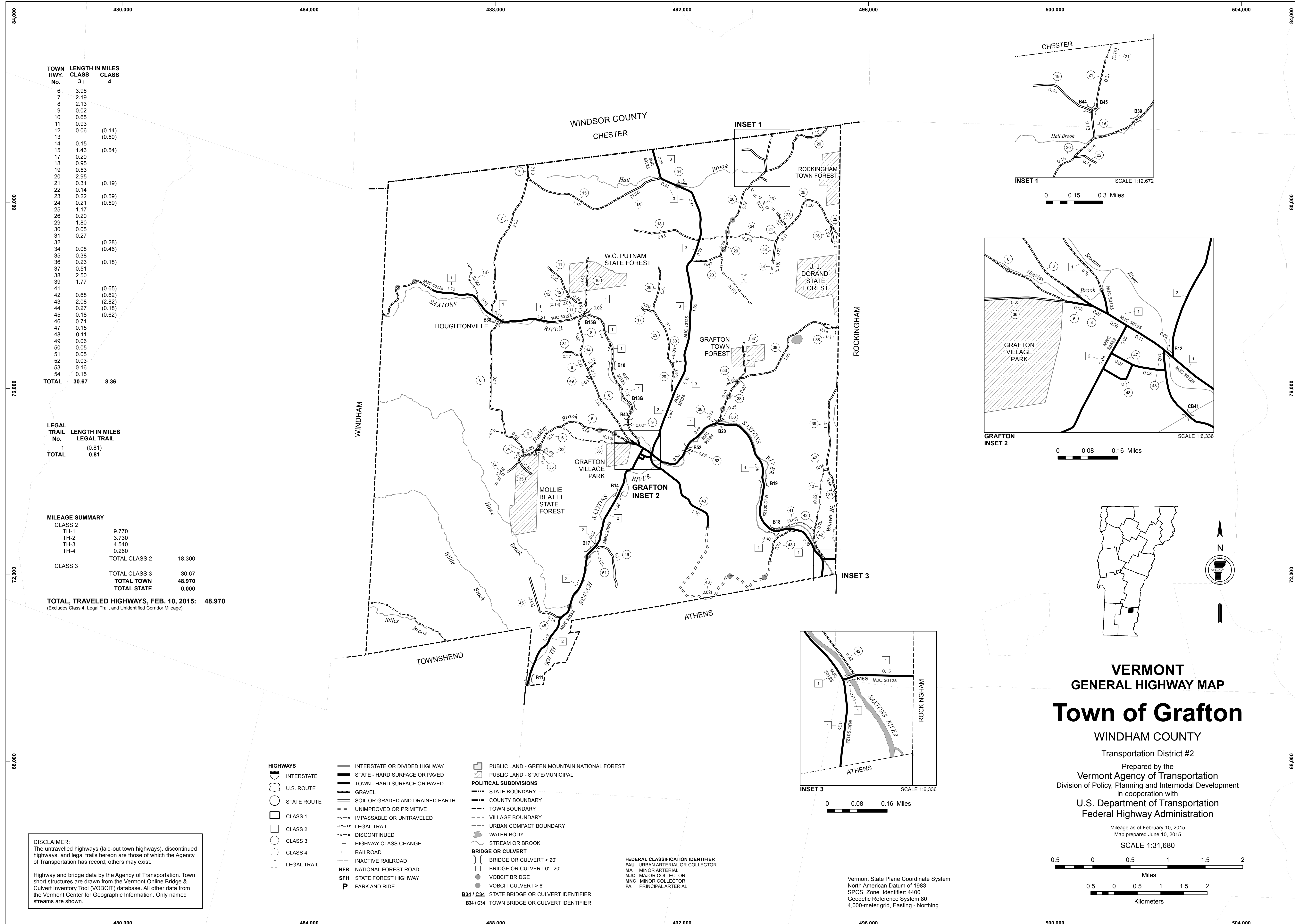

INSET 1 SCALE 1:12,672

0 0.15 0.3 Miles

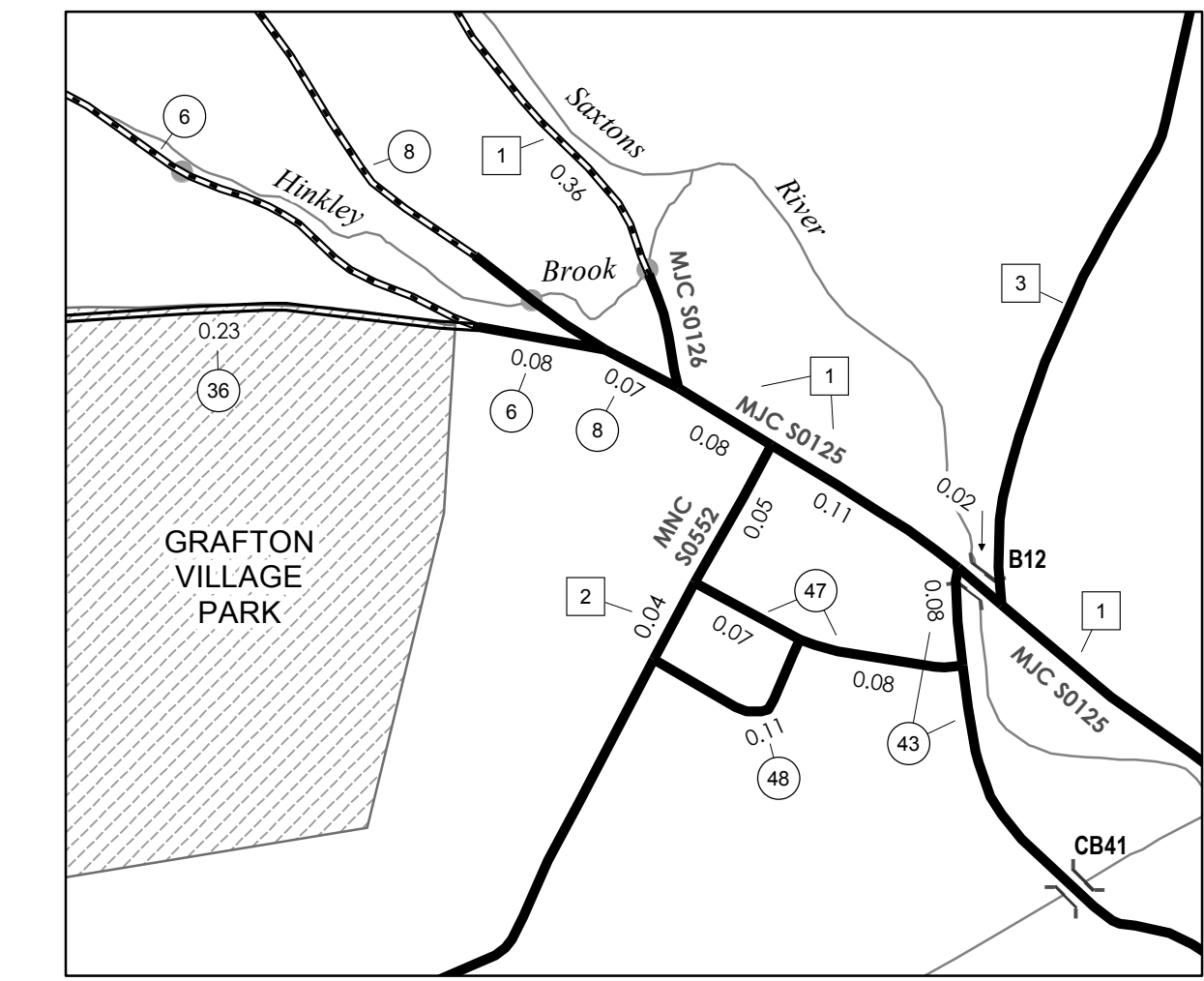

GRAFTON INSET 2 SCALE 1:6,336

0 0.08 0.16 Miles

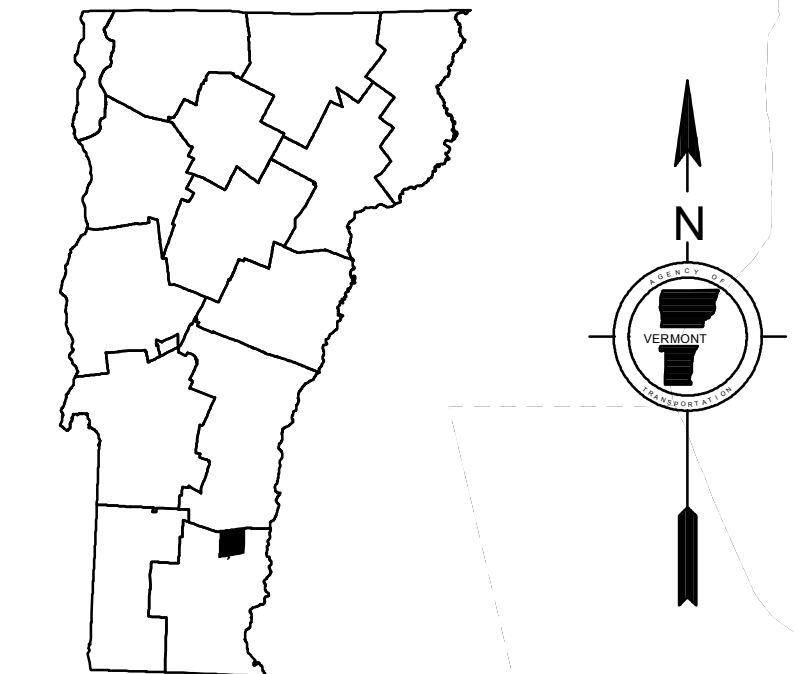

**VERMONT
GENERAL HIGHWAY MAP**

Town of Grafton

WINDHAM COUNTY

Transportation District #2

Prepared by the
Vermont Agency of Transportation
Division of Policy, Planning and Intermodal Development
in cooperation with

U.S. Department of Transportation
Federal Highway Administration

Mileage as of February 10, 2015
Map prepared June 10, 2015

SCALE 1:31,680

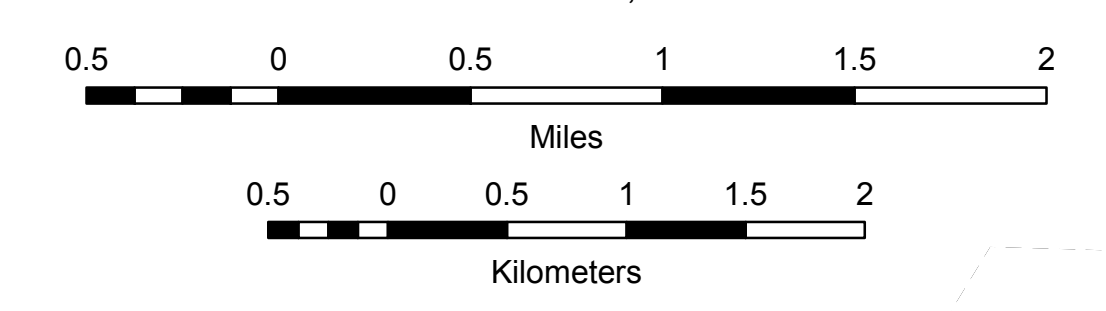

TOWN HWY. No.	LENGTH IN MILES CLASS 3	LENGTH IN MILES CLASS 4
6	3.96	
7	2.19	
8	2.13	
9	0.02	
10	0.65	
11	0.93	
12	0.06	(0.14)
13		(0.50)
14	0.15	
15	1.43	(0.54)
17	0.20	
18	0.95	
19	0.53	
20	2.95	
21	0.31	(0.19)
22	0.14	
23	0.22	(0.59)
24	0.21	(0.59)
25	1.17	
26	0.20	
29	1.80	
30	0.05	
31	0.27	
32		(0.28)
34	0.08	(0.46)
35	0.38	
36	0.23	(0.18)
37	0.51	
38	2.50	
39	1.77	
41		(0.65)
42	0.68	(0.62)
43	2.08	(2.82)
44	0.27	(0.18)
45	0.18	(0.62)
46	0.71	
47	0.15	
48	0.11	
49	0.06	
50	0.05	
51	0.05	
52	0.03	
53	0.16	
54	0.15	
TOTAL	30.67	8.36

LEGAL TRAIL No.	LENGTH IN MILES LEGAL TRAIL
1	(0.81)
TOTAL	0.81

MILEAGE SUMMARY		
CLASS 2		
TH-1	9.770	
TH-2	3.730	
TH-3	4.540	
TH-4	0.260	
TOTAL CLASS 2	18.300	
CLASS 3		
TOTAL CLASS 3	30.67	
TOTAL TOWN	48.970	
TOTAL STATE	0.000	

TOTAL, TRAVELED HIGHWAYS, FEB. 10, 2015: 48.970
(Excludes Class 4, Legal Trail, and Unidentified Corridor Mileage)

- HIGHWAYS**
- INTERSTATE
 - U.S. ROUTE
 - STATE ROUTE
 - CLASS 1
 - CLASS 2
 - CLASS 3
 - CLASS 4
 - LEGAL TRAIL
- INTERSTATE OR DIVIDED HIGHWAY**
- STATE - HARD SURFACE OR PAVED
 - TOWN - HARD SURFACE OR PAVED
 - GRAVEL
 - SOIL OR GRADED AND DRAINED EARTH
 - UNIMPROVED OR PRIMITIVE
 - IMPASSABLE OR UNTRAVELED
 - LEGAL TRAIL
 - DISCONTINUED
 - HIGHWAY CLASS CHANGE
 - RAILROAD
 - INACTIVE RAILROAD
 - NATIONAL FOREST ROAD
 - STATE FOREST HIGHWAY
 - PARK AND RIDE
- PUBLIC LAND - GREEN MOUNTAIN NATIONAL FOREST**
- PUBLIC LAND - STATE/MUNICIPAL
- POLITICAL SUBDIVISIONS**
- STATE BOUNDARY
 - COUNTY BOUNDARY
 - TOWN BOUNDARY
 - VILLAGE BOUNDARY
 - URBAN COMPACT BOUNDARY
 - WATER BODY
 - STREAM OR BROOK
- BRIDGE OR CULVERT**
- BRIDGE OR CULVERT > 20'
 - BRIDGE OR CULVERT 6' - 20'
 - VOBICIT BRIDGE
 - VOBICIT CULVERT > 6'
 - STATE BRIDGE OR CULVERT IDENTIFIER
 - TOWN BRIDGE OR CULVERT IDENTIFIER
- FEDERAL CLASSIFICATION IDENTIFIER**
- FAU URBAN ARTERIAL OR COLLECTOR
 - MA MINOR ARTERIAL
 - MJC MAJOR COLLECTOR
 - MNC MINOR COLLECTOR
 - PA PRINCIPAL ARTERIAL

DISCLAIMER:
The untraveled highways (laid-out town highways), discontinued highways, and legal trails hereon are those of which the Agency of Transportation has record; others may exist.

Highway and bridge data by the Agency of Transportation. Town short structures are drawn from the Vermont Online Bridge & Culvert Inventory Tool (VOBCIT) database. All other data from the Vermont Center for Geographic Information. Only named streams are shown.

CAMBRIDGEPORT

Towns of Grafton & Buckingham.
Scale 40 Rods to the Inch.

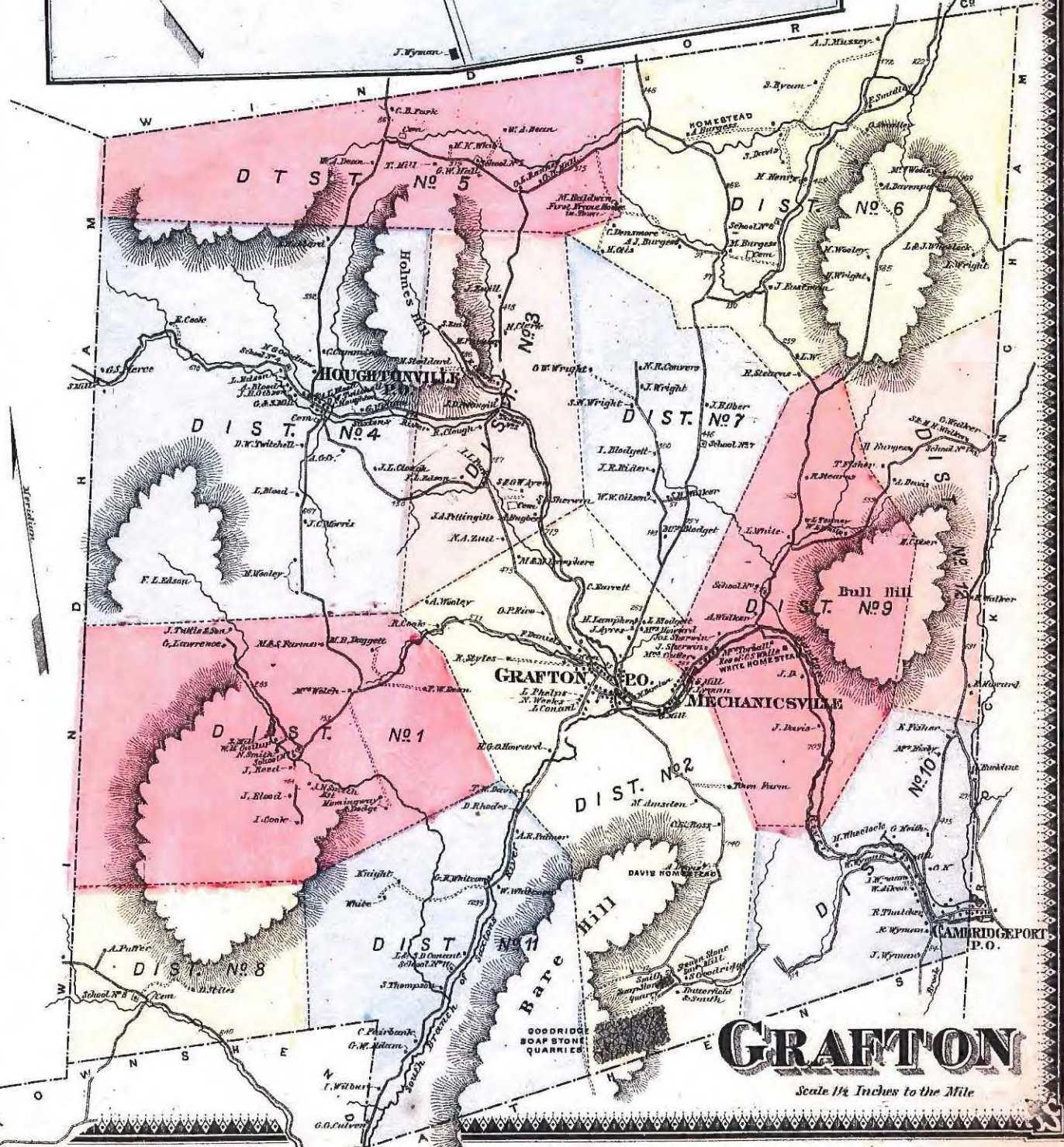
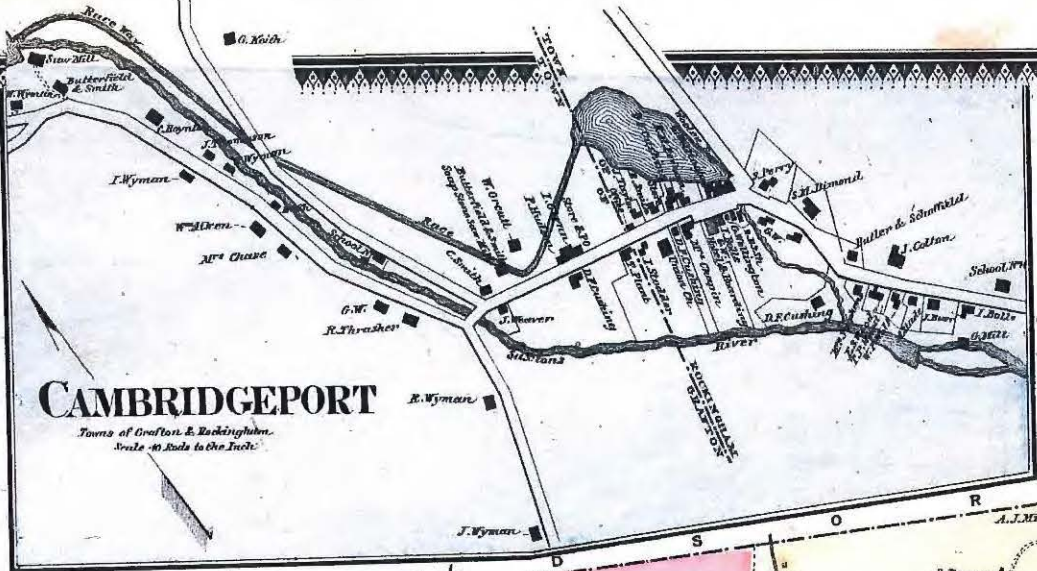

GRAFTON

Scale 1/4 Inches to the Mile

to Japheth Fishers Beginning at the intersec-
tion of roads near S. Hales thence South 15
Degrees West 149 rods thence South 16 D West
59 rods thence South 38 Degrees West 34 rods
thence South 68 Degrees West 28 rods
South 60 Degrees West 28 rods
75 Degrees West 28 rods
Degrees West 22 rods
West 60 rods thence South
28 rods thence South
thence South 27 Degrees
South 18 Degrees West
1 Degree East 38 rods
West 48 rods thence South 31 Deg West
39 rods thence South 2 Deg West 10 rods
thence South 21 Deg West 40 rods thence
South 50 ~~D~~ Deg West 40 rods thence South
30 Deg West 32 rods thence South 31 Deg
West 16 rods thence South 25 Deg West
18 rods - Grafton

TM-37-
BOL 109 FITS

August 23. 1820

Richard Lewis } Surveyor
Sherburne Hale }
Benj. Willey }
Select Men

to Joseph Fishers Beginning at the entrance
 of roads near at. thence thence South 15
 Degrees West 149 rods thence South 16 D West
 59 rods thence South 38 Degrees West 34 rods
 thence South 68 Degrees West 20 rods thence
 South 60 Degrees West 20 rods thence South
 75 Degrees West 28 rods thence South 28
 Degrees West 22 rods thence South 17 Degrees
 West 60 rods thence South 2 Degrees West
 28 rods thence South 8 Degrees East 12 rods
 thence South 27 Degrees West 20 rods thence
 South 18 Degrees West 40 rods thence South
 1 Degree East 38 rods thence South 7 Deg
 West 48 rods thence South 31 Deg West
 39 rods thence South 2 Deg West 10 rods
 thence South 21 Deg West 40 rods thence
 South 50 ~~D~~ Deg West 40 rods thence South
 30 Deg West 32 rods thence South 31 Deg
 West 16 rods thence South 25 Deg West
 18 rods - Grafton

Richard Lovell } Surveyor

August 23. 1820

Sherrill Hale } Select
 Benj. Wilby } Men
 27 fellow

June 23rd 1811
Grafton June 23rd 1811
Surveyed by
Recorded by me
Peter Whitcomb Town Clerk

Elmer Burger } Surveyor
Peter Whitcomb } Selectman
Wm Stickney Jr }
Benja Desmell }

A description of a road beginning at a maple stump on the line of
lots between nos 2 in the 8th range and over in the 9th range at the corner
of the road that lead to Philip's corner from Beneth Stales four lead there is
wide on the west side of the line of said road S. 10° E 40 ft S 80° W 10 ft
S. 13° W. 64 ft N. S. 65° W. 18 ft S. 36° W. 20 ft S. 85° W. 48 ft to the road that
lead from John Chapman to Benja Chapmans - Grafton June 23rd 1811

Surveyed by Elmer Burger } Surveyor
Peter Whitcomb } Selectman
Wm Stickney Jr }
Benja Desmell }

Grafton Feb^{ry} 26th 1811 then recorded the above
Peter Whitcomb Town Clerk

A description of a Road leading from Daniel Bakers to the center of
the town, laid three rods wide on the east of the line beginning four
rod and ten links east of Mr. Daniel Bakers new kitchen door from
thence north 14° E 63 rods or 3° E 26 rods - N 12° E 23 rods - or 20° E 20 rods to
west - thence or 27° E 20 rods - or 11° E 246 rods - or 14 rods a line north of Capt John
then thence - or 4° N 64 rods - or 2° E 12 rods - or 22° E 12 rods - or 40° E 227 rods - or 52°
E 15 rods - or 37° E 214 rods - or 27° E 33 rods - or 26° E 245 rods - or 42° E 247 rods
or 25° E 114 rods - or 34° E 220 rods - or 49° E 239 rods - or 52° E 273 rods - or 11°
W 21 rods to a large ash in front of the meeting house

Grafton May 30th 1811

Surveyed by Bart Fuller } Surveyor
Peter Whitcomb } Selectman
Benja Desmell }

Grafton Feb^{ry} 13th 1812 then recorded the above
Peter Whitcomb Town Clerk

1810
Sept 22 1810
Grafton June 23 1810
Surveyed by
Witnessed by me
Peter Whitcomb Town Clerk

Chas. Burge }
Peter Whitcomb } Selectman
Wm. Stickney Jr. }
Benja. Desmull }

A description of a road beginning at a maple stump on the line of
lots between W. & E. on the 8th range and goes in the 9th range at the corner
of the road that leads to Philip's corner from North States farm laid there on
side on the west side of the line of said road S. 10° E. 45 P. 50° W. 20 P.
S. 13° W. 64 P. S. 58° W. 18 P. S. 36° W. 50 P. S. 33° W. 48 P. to the road that
leads from John's corner to Benja. Chapmans - Grafton June 23 1810

Surveyed by

Chas. Burge } Surveyor
Peter Whitcomb } Selectman
Wm. Stickney Jr. }
Benja. Desmull }

Grafton Feb. 26th 1811 then awarded to above
Peter Whitcomb Town Clerk

A description of a road leading from Daniel Bakers to the Centre of
the town laid there side on the east of the line beginning four
rod and ten links east of Mr. Daniel Bakers new kitchen door from
thence north 14 1/2 East 65 rods or 3° E. 26° W. or 12° E. 23° W. or 25° E. 20° W. to a
rod - thence or 27° E. 20° W. or 11° E. 24° W. or 14° rods a little north of Capt. John
thence or 4° W. 64° N. or 2° E. 12° W. or 22° E. 12° W. or 40° E. 27° W. or 52° E.
21° W. or 37° E. 14° W. or 27° E. 33° W. or 26° E. 40° W. or 42° E. 47° W.
or 25° E. 14° W. or 34° E. 20° W. or 49° E. 39° W. or 32° E. 73° W. or 14° E.
or 21° W. to a large rock in front of the Meeting house

Grafton May 30th 1811

Surveyed by

Wm. Fuller } Surveyor
Peter Whitcomb } Selectman
Benja. Desmull }

Grafton Feb. 13th 1812 then awarded the above
Peter Whitcomb

14 holes more
 South 16 Do. West 29 rods
 14 rods thence South 28 Degrees West 20 rods thence South 75 Degrees West
 10 Degrees West 28 rods thence South 22 rods thence South
 12 Degrees West 50 rods thence South 22 Degrees West
 28 rods thence South 12 Degrees West 19 rods thence South
 24 Degrees West 20 rods thence South 1 Degree East 36
 rods thence South 7 Degrees West 48 rods thence South
 31 Degrees West 39 rods thence South 2 Degrees West
 rods thence South 21 Degrees West 40 rods thence South
 50 Degrees West 40 rods thence South 30 Degrees West
 32 rods thence South 31 Degrees West 16 rods thence
 South 25 Degrees West 10 rods

Grafton August 25. 1820. Willard Lovell Surveyor

The above is a true copy of the original (Sherman Hale)
 of David Bamcott of Grafton (George Willey) of Grafton
 and Willard Lovell (John)

Description of a road surveyed and laid out by the undersigned
 June 12th 1821 as follows beginning at a stake and stones on
 east side of the
 road leading from Oliver Gilson's to John Parker in
 Grafton and running north ten degrees east for
 four rods to a stake and stones. thence north four
 degrees east thirty rods to a stake and stones by
 the road easterly of Daniel Wright's building
 said road to be three rods in width extending
 one and a half rods...

... road to the southwest then
... intersection of roads
... that leads to the

Nathan Wheeler
John Plover

The foregoing is a true copy of the original
received for July 15th 1825

West of Spring Brook

A survey of a road — Beginning near
the house where David Smalley lives on
Guthrie's land on the old road running
out 15 degrees 47 rods then west 8 degrees south
15 rods to the old road leading by the farm
owned by Mrs Henry's farm also beginning
at the west part of the Mrs Henry farm
and thence running south 20 degrees west
34 rods on the land owned by W Dutton
thence running south 18 degrees west 24
rods thence running south 14 to intersect
with the road near the school house near
W Dutton said road surveyed by the select-
men Grafton Oct. 5 1825

Nathan Wheeler Surveyor

The foregoing is a true copy of the orig-
inal surveying record for record December

to state and
1199-16 Nov 1803
the meeting House to Oliver Garrison
Grafton June 22 1803
in presence of

Amos Tucker
Joseph Pettit
John

Surveyed by John B Wheeler
Grafton Feb 29 1803 recorded the above
with Amos Tucker & Clerk

A description of a road beginning
between John Peterson & Henry
South 6° west 34 rods then South 11°
5° west 30 rods then South 25°
west 24 rods to the intersection of
North of the bridge below David
branch of Jeter & Nison
Grafton April 19th 1805

L-2
Bad Copies
and 13 133 1803
is Coroll - 1st Survey
on page right be good

Surveyed by John B Wheeler
Grafton April 19th 1805 then recorded the above
with Amos Tucker & Clerk
Dated October
John Wheeler

A description of an alteration of a road beginning
at a Buck barn south of Mahan's house
Section of road west of the school house then road laid
out the east side laid then road wide - running North
from a point 10° east - 63 rods then North 47° east 28
rods then north 38° degrees East 19 rods between 2 Large
West of Rufus Hand's house - at Grafton May 31th 1805
Surveyed by John B Wheeler
Surveyor

Laid out by
John B Wheeler

1950 16 Nov 1802 8⁰⁰ 2400
the meeting House to Oliver Garrison
Grafton June 22. 1803
in presence of

Amos Fisher }
Joseph Pettit }
John

Survey of John B Wheeler
Grafton Feb 29 1803 recorded the above
description of a road beginning at a State and stone
between John Putnam & Alexander M. Lavel and running
South 6⁰ West 34 rods then South 11⁰ West 63 rods then South
5⁰ West 34 rods then South 25⁰ West 5 rods then South 29⁰
West 27 rods to the intersection of road from id Putnam
North of the bridge below David Strickland which crosses the
branch of Sixty 3 Acres.
Grafton April 19th 1806

Surveyed by John B Wheeler -
David Putnam } selectmen
John Kelder }

Grafton April 19th 1805 then recorded the above
Deed of John B Wheeler & Clerk

A description of an attraction of a road beginning
at a back back gate of Maher's school house at the inter
section of road west of the school house then road laid
out the east side laid three rods wide - running North
from point 10⁰ East - 63 rods then North 47⁰ East 28
rods then North 38⁰ degrees East 19 rods between 2 Large
West of Maher's school house - at Grafton May 30th 1805
Surveyed by John B Wheeler Surveyor

Laid out by
John B Wheeler

76th 15th Sept 1802 Road from Boston by Mr. Wheeler with 5th East 20 rods then
then south 5th East 50 rods East of James Adams house

Laid out by John B. Wheeler
James Adams
Peter Adams

Grants May the 12th 1802 then recorded the above road

Wheeler
John B. Wheeler & Clerk

A description of a road from the building owned by P. Adams Gibbon
beginning 5 rods South of said Kings house running East 15 rods
90 rods then East 50 rods then South 5 rods East 25 rods then South 2 rods
9 rods then South 5 rods East 5 rods then South 40 rods East 100 rods then South
30 rods East 26 rods about 4 rods to the corner of said Gibbon's house

Grants July 3rd 1802 Surveyed by John B. Wheeler
Laid out by

John B. Wheeler
Peter Adams

Grants July 10th 1802 then recorded the above road

Wheeler
John B. Wheeler & Clerk

A description of a road beginning at the King's house
about 1/2 mile King's house running South 35 rods East 100 rods then
South 90 rods East 20 rods then North 22 rods then North 36 rods
then North 26 rods East 22 rods then North 25 rods East 4 rods then
West 24 rods then West 15 rods South 32 rods East 30 rods then
the road from Col's hole to Levi Walker's

Grants August 14th 1802 Surveyed by John B. Wheeler
Laid out by John B. Wheeler
James Adams
Peter Adams

A description of a public road beginning in the
 William Confield corner of the N. W. 34th and 10th
 A survey of a road beginning at an apple
 tree near Mr. Davis house
 N. 19. E. 42 rods
 A. 61. E. 10 rods to a
 stone wall near Haughton
 A. 56. E. 12 rods
 A. 3. E. 14 rods to the
 river road
 A. 13. E. 20 rods
 A. 44. E. 30 rods
 A. 17. E. 7 rods
 A. 27. E. 2 rods
 A. 43. E. 10 rods
 A. 22. E. 13 rods
 A. 16. E. 36 rods
 A. 11. N. 20 rods
 thence between Mr. Davis
 stone wall and a house
 to strike the river road
 on apple tree & other

The A Survey on N. W. by Birch road
 on the N. W. 34th and 10th
 beginning at the bridge
 running N. 17. E. 27 rods
 N. 56. E. 12 rods

Bar^t Hutton Surveyor

The above described road being a public road
 from Wm Stearns to Selas Davis. thence to the
 Haughton School house or open road this road
 in weath - we hereby establish and hand over
 for record

Wm Palmer
 Geo. Bunker Sibley
 Engraving

Paid out a road

Tombinson may 29: 1788
Five rods wide South & e
Lines Beginning at at a
Northampton line running
to Athens North line

LT-5
Could Be Section
and
LT-3
Works ok

Running west 11 Dy N 23 rods
W 11 Dy S 16 rods S 66 Dy W 29
S 70 Dy W 27 rods S 42 Dy W 17
26 Dy W 26 rods S 37 Dy W 18
58 Dy W 10 rods S 36 Dy W 10 rods 40 Dy W
W 8 rods S 51 Dy W 9 rods S 37 Dy W ~~5~~ 20 rods S 31 W
32 rods S 46 Dy W 10 rods S 23 W 10 rods S 52 Dy W 12 rods
S 69 Dy W 9 rods S 77 Dy W 12 rods S 82 Dy W 14 rods S 72 W
24 rods W 3 Dy N 7 rods N 30 Dy W 14 rods N 69 Dy W 16 rods
N 77 Dy W 10 rods W 4 Dy S 8 rods W 7 Dy N 19 rods N 31 Dy
W 11 rods N 46 Dy W 14 rods N 69 Dy W 12 rods W 1 Dy N
7 rods S 72 Dy W 11 rods S 57 Dy W 16 rods S 76 Dy W S 78
Dy W 9 rods W 5 Dy S 9 rods S 90 Dy W 7 rods S 68 Dy W 7 rods
S 79 Dy W 8 rods N 76 Dy W 11 rods N 79 Dy W 10 rods N 45 Dy W
18 rods S 74 W 22 rods N 63 Dy W 17 rods N 83 Dy W 10 rods S 62
W 15 rods W 3 Dy N 12 rods N 77 Dy W 10 rods W 1 Dy N 30 rods S 81 Dy
W 12 rods N 38 Dy W 11 rods N 79 Dy W 10 rods N 66 Dy W 34 rods N 55
Dy W 30 rods N 34 Dy W 10 rods N 5 Dy W 12 rods N 34 Dy W 14 rods N
9 Dy W 13 rods N 23 Dy W 10 rods N 27 Dy W 22 rods N 30 Dy W 14 rods
N 40 Dy W 30 rods S 50 Dy W 20 rods S 60 Dy W 17 rods S 64 Dy W
12 rods S 85 Dy W 18 rods S 81 Dy W 42 rods S 64 Dy W 10 rods S 70
Dy W 21 rods N 41 Dy W 11 rods N 61 W 18 rods S 53 Dy W 11 rods S 75 Dy
W 22 rods S 77 Dy W 18 rods S 22 Dy W 14 rods S 15 Dy W 30 rods S 40
Dy W 11 rods S 49 Dy W 19 rods S 28 Dy W 19 rods S 20 Dy W 10 rods S 14 Dy W

Townshon may 29: 1788 Thru. laid out a road
 three rods wide South & east of a line of marks
 trees beginning at a Stake and Stones on
 Macbrideham line running through a Town
 to Athens North line as follows

Running west 11 Dy N 23 rods W 7 Dy N 30 rods
 W 11 Dy S 16 rods S 66 Dy W 22 rods S 72 Dy W 15 rods
 S 70 Dy W 27 rods S 42 Dy W 17 rods S 24 Dy W 20 rods S
 26 Dy W 26 rods S 37 Dy W 18 rods S 47 Dy W 10 rods S
 58 Dy W 10 rods S 36 Dy W 10 rods 40 Dy W 8 rods S 35 Dy
 W 8 rods S 51 Dy W 9 rods S 37 Dy W ~~6~~ 20 rods S 31 W
 32 rods S 46 Dy W 10 rods S 23 W 10 rods S 52 Dy W 12 rods
 S 69 Dy W 9 rods S 77 Dy W 12 rods S 82 Dy W 14 rods S 72 W
 24 rods W 3 Dy N 7 rods N 30 Dy W 14 rods N 69 Dy W 16 rods
 N 77 Dy W 10 rods W 4 Dy S 8 rods W 7 Dy N 19 rods N 61 Dy
 W 11 rods N 46 Dy W 14 rods N 69 Dy W 12 rods W 1 Dy N
 7 rods S 72 Dy W 11 rods S 59 Dy W 16 rods S 76 Dy W 7 rods
 Dy W 9 rods W 5 Dy S 9 rods S 90 Dy W 7 rods S 68 Dy W 7 rods
 S 79 Dy W 8 rods N 76 Dy W 11 rods N 79 Dy W 10 rods N 45 Dy W
 18 rods S 74 W 22 rods N 63 Dy W 17 rods N 83 Dy W 10 rods S 62
 W 15 rods W 3 Dy N 12 rods N 77 Dy W 10 rods W 1 Dy N 30 rods S 81 Dy
 W 12 rods N 78 Dy W 11 rods N 79 Dy W 10 rods N 66 Dy W 34 rods N 75
 Dy W 30 rods N 34 Dy W 10 rods N 5 Dy W 12 rods N 34 Dy W 14 rods N
 9 Dy W 13 rods N 23 Dy W 10 rods N 27 Dy W 22 rods N 30 Dy W 14 rods
 N 40 Dy W 30 rods N 50 Dy W 20 rods S 60 Dy W 17 rods S 64 Dy W
 12 rods S 85 Dy W 18 rods S 81 Dy W 42 rods S 64 Dy W 10 rods S 70
 Dy W 21 rods N 41 Dy W 11 rods N 61 W 18 rods S 53 Dy W 11 rods S 75 Dy
 W 22 rods S 77 Dy W 18 rods S 22 Dy W 14 rods S 15 Dy W 30 rods S 40
 Dy W 11 rods S 49 Dy W 19 rods S 28 Dy W 19 rods S 20 Dy W 10 rods S 14 Dy W

14 rods S 19 29 13 27 rods S 20 29 14 rods S 21 29 15 rods S 22 29 16 rods S 23 29 17 rods S 24 29 18 rods S 25 29 19 rods S 26 29 20 rods S 27 29 21 rods S 28 29 22 rods S 29 29 23 rods S 30 29 24 rods S 31 29 25 rods S 32 29 26 rods S 33 29 27 rods S 34 29 28 rods S 35 29 29 rods S 36 29 30 rods S 37 29 31 rods S 38 29 32 rods S 39 29 33 rods S 40 29 34 rods S 41 29 35 rods S 42 29 36 rods S 43 29 37 rods S 44 29 38 rods S 45 29 39 rods S 46 29 40 rods S 47 29 41 rods S 48 29 42 rods S 49 29 43 rods S 50 29 44 rods S 51 29 45 rods S 52 29 46 rods S 53 29 47 rods S 54 29 48 rods S 55 29 49 rods S 56 29 50 rods S 57 29 51 rods S 58 29 52 rods S 59 29 53 rods S 60 29 54 rods S 61 29 55 rods S 62 29 56 rods S 63 29 57 rods S 64 29 58 rods S 65 29 59 rods S 66 29 60 rods S 67 29 61 rods S 68 29 62 rods S 69 29 63 rods S 70 29 64 rods S 71 29 65 rods S 72 29 66 rods S 73 29 67 rods S 74 29 68 rods S 75 29 69 rods S 76 29 70 rods S 77 29 71 rods S 78 29 72 rods S 79 29 73 rods S 80 29 74 rods S 81 29 75 rods S 82 29 76 rods S 83 29 77 rods S 84 29 78 rods S 85 29 79 rods S 86 29 80 rods S 87 29 81 rods S 88 29 82 rods S 89 29 83 rods S 90 29 84 rods S 91 29 85 rods S 92 29 86 rods S 93 29 87 rods S 94 29 88 rods S 95 29 89 rods S 96 29 90 rods S 97 29 91 rods S 98 29 92 rods S 99 29 100 rods S 100 29

The above land is owned by the
 heirs of the late John D. ...
 and is being sold by me
 the undersigned
 J. D. ...
 J. D. ...
 J. D. ...

January 1, 1897 ...
 1 1/2 rods S 29 13 27 rods S 20 29 14 rods S 21 29 15 rods S 22 29 16 rods S 23 29 17 rods S 24 29 18 rods S 25 29 19 rods S 26 29 20 rods S 27 29 21 rods S 28 29 22 rods S 29 29 23 rods S 30 29 24 rods S 31 29 25 rods S 32 29 26 rods S 33 29 27 rods S 34 29 28 rods S 35 29 29 rods S 36 29 30 rods S 37 29 31 rods S 38 29 32 rods S 39 29 33 rods S 40 29 34 rods S 41 29 35 rods S 42 29 36 rods S 43 29 37 rods S 44 29 38 rods S 45 29 39 rods S 46 29 40 rods S 47 29 41 rods S 48 29 42 rods S 49 29 43 rods S 50 29 44 rods S 51 29 45 rods S 52 29 46 rods S 53 29 47 rods S 54 29 48 rods S 55 29 49 rods S 56 29 50 rods S 57 29 51 rods S 58 29 52 rods S 59 29 53 rods S 60 29 54 rods S 61 29 55 rods S 62 29 56 rods S 63 29 57 rods S 64 29 58 rods S 65 29 59 rods S 66 29 60 rods S 67 29 61 rods S 68 29 62 rods S 69 29 63 rods S 70 29 64 rods S 71 29 65 rods S 72 29 66 rods S 73 29 67 rods S 74 29 68 rods S 75 29 69 rods S 76 29 70 rods S 77 29 71 rods S 78 29 72 rods S 79 29 73 rods S 80 29 74 rods S 81 29 75 rods S 82 29 76 rods S 83 29 77 rods S 84 29 78 rods S 85 29 79 rods S 86 29 80 rods S 87 29 81 rods S 88 29 82 rods S 89 29 83 rods S 90 29 84 rods S 91 29 85 rods S 92 29 86 rods S 93 29 87 rods S 94 29 88 rods S 95 29 89 rods S 96 29 90 rods S 97 29 91 rods S 98 29 92 rods S 99 29 100 rods S 100 29

Grafton June 27 1838

Olin Covis } Selectmen
Wm Polner } Men

True Copy of the original surveys

B. H. Bridgman Town Clerk

of a description from John Eastman's intestate the road leading from Grafton Village to Chester

Beginning at the old road north of John Eastman's run
the Brook by S 53° W 8 rods - S 18° W 17 rods W 7 S 8°
W 3° S 12 rods N 14° S 61 rods 11 links 8 6/12 rods on
Eastman's W 12° N 34 rods W 7° N 10.18 links
W 3° N 8 rods N 13° S 14 rods 6 3/4 on Burys

Carriage to Burys \$39.00

Bot Fuller Surveyor

per order of Wm Sampson

Olin Covis } Selectmen
Wm Polner }

A true copy of the survey returned for record at 2318

attest B. H. Bridgman

No 30

No 31

Grafton June 12. 1849

herely request the selectmen of the
town, to remove they shall accept of the
land from the schoolhouse in District
road, hitherto owned by Marshall Spring
rights, to discontinue, at the same time
leading from said Wright to the inter-
road, leading from said Springs to
road, about forty one rods as being un-
the public or private travel.

Daniel Wright

Jesse R. Rubin

Hubard Blodgett

J. J. Smith

D. P. Hadley

George M. Barrett

John W. Hammett

To the Selectmen of Chatham.

LT-7 & LT-8
Petition and Notice,
NOT LOG OUT

herby present our petition
sideration the subject of
concerning in the old
Farm-house these names
~~John Kinder~~ and said
Ledge Road so called in the
and from thence ~~to~~
or nearly so of the diselle
Shushon in said Athens' - to view the premises
and lay and establish ~~the~~ ^{road} ~~as~~ soon as may be
according to Law -

- Grafton April 18th 1848.
- B. H. Kingman
- L. C. Spinks
- Calvin D. Hinds
- Stephen Wall or
- William Brown
- Oscar Briggs
- Gideon Palmer

To the Selectmen of Grafton.

We the undersigned hereby present our petition, that you take into consideration the subject of laying out a new road commencing in the old road near Thomas Davis Farm-house thence running southerly across lands of ~~John~~ John Shickler and said Davis to intersect with the Stage Road so called, in the most reasonable place and from thence ~~thence~~ to Athens line in a direction or nearly so of the dwelling house of Comfort Shooker in said Athens — to view the premises and lay and establish ^{road} the said, as soon as may be according to Law.

Grafton April 18th 1848.

B. H. Bingham

J. C. Spinks

Calvin D. Hinds

Stephens Waller

Abner Brown

Oscar Briggs

Gideon Palmer

Gave the petitioners of those owning land verbal notice of
the time & place ~~for on the 16 of June examined the~~
when we would attend to the within petition
on the 16 of June presided to examine the principles
& laid out & surveyed the South End of the road
petitioned for

Harvey Stoddard }
John J. Pettengill } Selectmen
& B. Campbell }

1848

One sphere of a sand lay out from the North line
 of motion, beginning out a round which is all of the
 chaff in house the sand being soft, and meeting the
 round line. North 10° East the Red is a hundred and
 from there. Except 25° North of Red to a dry tree trunk - 2
 South 8° North of 20 a rock on line. This is a glass

John Piddler's Journal

- 1th N. 29° East 29 Red
- 2th N. 46° East 50 D.
- 3th N. 60° East 19 D.
- 4th N. 90° East 14 D.
- 5th N. 91° East 50 D.
- 6th N. 28° East 16 D.
- 7th N. 21° East 29 D.
- 8th N. 19° East 29 D.

to the road now traveled from Calcutta

John Piddler

Sunday Nov 27 1799

J. Piddler

150 Concerning at the stone bridge over the stream
 showing stream running due West, 16 rods to the
 due North 20 rods - thence West, 38 rods North 10 rods to
 the old road on land owned by Benjamin Smith 2 rods
 thence allowed Samuel Spring #3 West.
 signed by John Whitcomb

Crofton February 24th 1840.

John Whitcomb
 George Palmer
 Royal Knight
 W. H. Brigham Town Clerk

48 The following is a survey of a parcel of land
 in the Town of Crafton, County of Windham State of
 Vermont, laid out by the selectmen as committee
 appointed by the Honorable County Court, for
 the County of Windham at their Sept. Term 1839
 on the petition of Benjamin Smith an attorney
 surveyed by us this 14th day of March 1841
 Beginning on the south line of said Crafton near
 the said Benjamin Smith's soapstone ledge
 at a point, N 12° W 10 rods from the southeast
 corner of the said Benj- Smith's Place in Athens
 thence N 10° E, 24 rods to Spruce Tree, thence
 N 12° E, 14 rods, thence N 34° E 10 rods, thence N 21°
 E, 16 rods, thence N 30° E, 22 rods, thence N 21°
 E, 10 rods to the old road; thence N 6° W 8 rods
 crossing the old road; thence N 24° E, 9 rods, thence
 N 49° E, 8 rods, thence N 65° E 8 rods to a large
 Maple Tree; thence N 55° E 26 rods crossing the

to show
Shew N. 40° E. 16 rods to the
Wickets. All stations and objects are in the center
of said road which is laid three rods wider except
the first point, which is four rods wide.

Peter D. Swift,
November 11th 1839 Nelson Cayer
Oliver Huntington
Committee.

Copies from the minutes of the original Survey -
D. H. Baird Surveyor Town Clerk

57 This survey certify that the new road surveyed
and laid out by Courts Committee in 1837 through
the lands of Henry G Gooderow & Letitia Wyman
is this day completed and is now opened for
public benefit & travel

Grafton Nov 7, 1840 Wm Whitcomb
Gideon Palmer } Selectmen
Jehiel Wright }

Copies from original certificate revised for road
Nov 9, 1840 D. H. Baird Surveyor Town Clerk

60 A Survey of a Road in the town of Grafton begin-
ning on the west side of the road leading from Cam-
bridge Port to Grafton 148 rods from Benjamin Smiths
Soap Stone Saw Mill and on the line between Josiah Stead-
ford and Wm S. Berry then running as follows viz -

- | | | | |
|-----------|----------------------|----------------|------------------------------|
| N. 68° W. | 33 rods to a stake | S. 83° W. | 8 rods to Paul Chas J's land |
| N. 60° W. | 11 " " " do | S " " " | 2 " |
| N. 77° W. | 20 " to the woods | S 43° W. 22 " | |
| S. 74° W. | 6 1/2 " to Hunt tree | S. 37° W. 11 " | |
| S. 70° W. | 7 " " " do | | |

1828

Henry Parks
Peter N. Gott
Thomas White

Commissioners

A true copy of the original survey well received for record October 30th A.D. 1828

Wm. Spring Town Clerk

The following is a survey of the road laid out and established by the road Commissioners within and for the county of Mendham on the 24th day of Oct. 1828 in the town of Grafton on the petition of Barrelet Burgess and others (first) Beginning in the centre of the road on the south line of Chester and on the north line of Grafton near the said Burgess dwelling house thence from thence -

- S 9° W 144 rods thence
- S 21° W 82 do
- S 30° 38' 23 do
- S 20° W 13 do to an oak tree
- S 44° W 18 do
- S 38° W 36 1/2 do
- S 12° W 11 do
- S 25° W 24 do
- S 33 1/2° W 144 do to the centre of the old road

All stations and objects are in the centre of said road which is laid three rods wide - and it is further adjudged and decreed that the aforesaid road be made and opened for public travel within two years from the first

(Sealed copy)
 Charles Huntington } Committee
 John H. Stoddard }
 Called from the Survey which was first made Feb 17 1838
 by the Birmingham Land Co.

Grafton February 22 1837

14 The survey which was made in an execution thirty eight years ago
 and was a survey of debt by 1835 commencing on the town
 and running through the house running through his door yard
 by 57° 34' 1" east - 435 ft 7 rods - 52° 20' 4" east to station stone
 at which the road is now running
 William Palmer }
 John Giam }
 John White }

Recalled from the original Survey Book
 B H Birmingham Land Co.

15 Survey of a Road from Henry Goodmass's
 A survey of a Road laid out in a town of Grafton in the County
 of Washington on the eighth day of May 1837 by the subscribers a committee
 appointed by the Superior Court on the petition of Benjamin Burges & others
 Benjamin Burges or an Elm tree on the east side of the road leading from
 Grafton near to Benjamin Burges in Grafton in the County of Washington
 about six rods from Henry G. Goodmass's dwelling house then running
 north 52° east 14 rods to an apple tree in said Goodmass's garden, thence
 north 44° east 9 rods to a stake thence north 16° east 12 rods thence north
 9 rods 24 rods thence north 2° east 13 rods on land of said Goodmass to the
 north line of said Wyman's land thence on said Wyman's land north 9 rods
 23 rods to the old road - the points mentioned the center of the road; and we
 call to Henry G. Goodmass as his damage for his land for said road \$186.00
 23.00

April 29 1788 then laid out a row
 of rods wide beginning at the
 South line on the north line of the
 Seventh lot in the Twelfth range
 running as follows viz ^{road on the} South ^{side of the main} ^{road}
 South 10 rods West 6 rods S 52 E 54 rods
 S 62 D 26 rods S 70 D 10 rods S 74
 D 14 rods S 78 D 15 rods S 81 D 12
 rods S 81 D 13 rods E 4 D 9 rods S 65
 D 17 rods S 47 D 17 rods S 54 D 23 D
 rods S 49 D 11 rods S 35 D 15 rods S 59 D
 25 rods S 72 D 20 rods S 40 D 11 rods
 S 15 D 43 rods ^{to} ^{the} main road that leads
 from the center of P Town to ^{from} Hooking

Ebenezer Burgess Surveyor

Stephen Hayward }
 David Palmer }
 Henry Bond }

In the town the select men of Grafton
the undersigned inhabitants of Grafton and vicinity, believing the
highway from the west part of Grafton to
and the town, will should follow the valley of the
brook running nearly parallel with the
line of said town, of the nature and extent
was required by the public for reaching the
road than is now provided

We therefore request your orders to
the premises concerning at or near the intersection
of the road leading west from town with the
road running from the Burgess to the
and following as near a direct course as possible
to the fork of the road near the same name
be known as Phillips - Grafton - and by a road
from Grafton

- Henry G. ...
- Stephen ...
- John ...
- Isaac Gibson
- John R. Gibson
- Henry A. Gibson
- Joseph Phelps
- George H. Gibson
- Thomas A. Knight
- John ...
- Salva H. Burton
- Edward ...
- David ...

Wendell

John Gibson

Calvin Houghton

Chas. Wainwright

Joseph Tustin

Thomas Hobbie

Isaac Sumner

• Daniel Banton

(Milton)

J. W. Emery

Samuel Jackson

(B. Emery)

John W. Brown

Stanley Burr

Salmon H. Hurlbut

R. G. Hayward

W. H. Hymon

Adam Sedle

L. Wood

S. H. Emery

Charles Madell

E. Maley

John M. Mearns

Chas. Mearns

To the Selectmen of Grafton

The subscribers freeholders in said Grafton herewith present their petition and request that you will raise in the route for a highway and lay out or cause the same to be duly opened as soon as may be for a public road viz: Commencing at the house of Joseph Jacobs in said Grafton then following in the vicinity of a small brook running southeasterly of said Jacobs house till it comes on to the flat on land owned by Bearrilla Harris then down the Spaulding brook so called till it comes to the road leading from Grafton to Townsend and near Ephraim Smiths Bridge

Chas. Crispin

H. O. Conant

George W. Pease

David Stearns

Ernest J. Parker

John Reed

Charles A. Cooney

William Whitcomb

Chalson C. Finlank

Amos B. Palmer

Joseph Jacobs

The above Request not granted

Henry Stoddard

Cha. Conant

Henry Palmer

Set out 2000

have this 27th day of January, 1877, delineated and the following described highways in the town of Grafton to wit:

First Commencing at the gate on land of Samuel Phelps on the east side of the highway leading from Grafton Village to Gough, thence and passing through the pasture of said Samuel Phelps to a Gate on the dividing line between said Phelps meadow and pasture land.

Second Commencing on the west side of the highway between the dwelling house of S. B. Johnson and the Pettengill bridge, so called and leading past the dwelling house on the farm owned by Riley Stearns to the burial ground at the center of the town.

Third The highway leading from the school house in school District No 6 to the cemetery near the dwelling house occupied by Maria Johnson.

Fourth The highway at a point near the school house in school district No 6 and leading to the dwelling house of Hiram Trevelyan.

Fifth The highway leading from the dwelling house of Austin Lakeport north of the highway leading from Grafton to Barton Hill.

Sixth To old highway leading from the dwelling house of Abel J. Otis to the dwelling house of Newton R. Lawrence.

occupied by her

Eight The highway leading from the Goodridge
Limestone Quarry west to the old road leading
from Grafton to Athol

ninth The road leading from the dwelling house
occupied by John Pettengill south to
where said road intersects with the road
leading from R. M. Cooks to the Edward
Spicer farm owned by A. G. Burgess

Tenth The highway leading from the western line
of G. S. Edson's land past the Daniel Boston
farm to where it intersects with the road
leading from North Tom Hill to the dwelling
house of Charles Stone a few rods east of the
Union Store

Eleventh The highway leading from the land
known as the William Boynton place now
owned by the town of Grafton to the
dwelling house of David Stiles Also this
road that intersects said road said road
at a point near the top of the hill west
of the Boynton place so called and leading
past the Skinner place is called Windmill
hill

Twelfth

The highway leading from where the
dwelling house of David Baker formerly
stood west to the dwelling house owned by
Peter W. Bean occupied by E. J. Pallard
Also the road leading from the spot
where said D. Baker

cardinalis - Queen Anne
29th day of October 1828

Henry Clarke }
Peter K. Staff }
Thomas White }
Noval
Commissioner

True copy of the original survey of the road
for record December of the A. 1828

Wm. St. Spring Town (Clerk)

November 11th 1828 Grafton

A description of a road beginning at Peter Tenney's door yard
S. 15. W. 63 rods through up S. 21. E. 12.5
S. 13. W. 54.5
N. 31. W. 49.5
S. 17. W. 38.5
S. 1. E. 61.5
S. 11. W. 48.5
S. 5. W. 27
of the road leading from
the part of the village to Grafton
Bark Fuller Surveyor
A true copy of the survey

Wm. St. Spring Town (Clerk)

Grafton December 11th 1826

A road from Peter Tenney's house to the house
the house is at the gate -
N. 42. S. 20.5
N. 41. S. 38.5
N. 44. S. 44.5
N. 2. S. 12
N. 24. S. 26 to the house
A true middle road from the gate at the house
to the west part S. 17. E. 108
S. 22.5
S. 23. W. 22.5
S. 19. E. . . .

A survey of a road beginning
 at an apple tree near
 Davis house, viz
 of 19 deg E 42 rods
 to 61 " E. 10 " and Davis
 and 12 rods on Houghton
 S. 66 deg E. 12 rods
 S. 3 " E " 24 to the
 River Road.

S. 15 E 25
 S. 49 E 30
 S. 47 E 7
 S. 27 E 5
 S. 43 E 12
 S. 20 E 23
 S. 12 E 36
 S. 11 W 20

Thence between Capt Davis
 stone wall and his house
 to strike the other end of
 an apple tree cross

Also a survey of the Finchy Brook Road on
 the Wd Butterfield Land beginning at the River
 running West 12 deg N. 8 rods
 W. 66 S. 12 "

The above described road ^{at the top of the page} being a bridge road from
 Wm Stearns to Silas Davis thence to the Houghton
 school house an open road three rods in width
 we hereby establish and hand over for record

Wm Pollock
 Jno Barrett
 Charles Buzard

A true Copy of the original survey
 for record March 26 1833

Wm Stearns
 Silas Davis
 Houghton
 School House

Survey of a road beginning at
 an apple tree near the
 Davis house, viz
 to 17 deg E 112 rods
 to 61 " E. 110 " on Davis
 and 12 rods on Haughton
 to 56 " E. 12 " "
 to 3 " E. 24 to the
 River Road.

S. 16 E 25
 S. 44 E 30
 S. 87 E 7
 S. 27 E 8
 S. 43 E 11
 S. 20 E 23
 S. 12 E 35
 S. 11 W 10

Thence between apple trees
 stone wall and his house
 to strike the other end of
 an apple tree & road.

Also a survey of the Hinchy Brook Road on
 the Wd Butterfield Land beginning at the Buisson
 running West 12 " N. 8 p rods
 W. 56 S. 12 "

The above described road ^{at the top of the page} being a bridge road from
 Wm Stearns to Silas Davis - thence to the Haughton
 school house an open road three rods in width
 we hereby establish and hand over for record

Ben Little Surveyor
 Geo Barrett
 Ernest B. Bunch

A true Copy of the original survey
 for record March 25 1833
 D. L. Bingham Surveyor

A road beginning on lot No. 1 range 1st. on
Rockingham line below v. Cherry tree

1/2 W. 20'	N. 10'
W. 20'	S. 12 rods across the bridge
W. 20'	S. 21 rods
W. 16'	S. 56 rods
N. 11'	30 W. 30 rods
N. 10'	16 W. 30 rods
W. 29'	11 S. 29 rods to the bridge

(This is a true copy of the original Survey Bill
 Bar C. J. Fuller Surveyor,
 J. Taylor,
 John Barret, Justice of the Peace,
 Town Clerk, Cale Hall

Survey Bill of a road as described
 as follows, with gates or bars beginning on
 the road 10 rods north east of a cherry tree on lot
 No. 3. in the 11 range.

Running North 75 deg. South	20
" S. 60 "	N. 10
" N. 79 "	S. 26
" S. 50 "	S. 6' 6" running

between the bar in corner between
 Shoc. H. Palmer Esqr. to the other road
 Ebenezer Burgess Surveyor
 Thos. S. Taylor, Justice of the Peace

of the State of New York
 1 day of September 1820. — We the undersigned
 committee therein appointed to lay out
 way & alter the road leading from Bellows Falls
 in Rockingham through Westminster & Saxton
 River Village to the lower Village in Grafton
 having given notice to the Inhabitants living in
 the several Towns through which said Road is
 out by publishing in the Newspaper printed at
 Bellows Falls two weeks successively the terms
 Committee would attend to lay out said Road.

And have in pursuance of said notice met at the
 dwelling house of George Willson in Saxton River
 Village on Monday the 20th day of August 1820 — & there
 proceeded to view & examine said Road to Bellows Falls
 there we commenced the survey of said Road as follows
 Beginning at the northwest corner of the Block
 occupied by Bill's Black Cr. — at Bellows Falls —
 following the center of the old Road as now trod south by one
 hundred & thirty six rods to the top of the Flap on the
 so called then south sixty degrees west fourteen rods then
 south eighty nine degrees west thirty eight rods to the
 old Road as now trod then south by in the water
 said Road one hundred forty rods to the foot of the same
 Flap so called then south forty degrees west twenty
 then south twenty degrees west fifty two rods then south
 twenty two degrees west two hundred rods to the point of the
 Flap then north eighty degrees west seven rods then
 north fifty degrees west twelve rods then south

Town of ... 1791 5
 then laid out a road three rods
 wide by a line marked trees on
 the left side of D road
 beginning at a small Hemlock Tree
 on the line between 10 & 11 ~~lots~~^{the 11th range}
 on the 12th lot and running as follows
 S 51 D 9 W 18 rods then S 47 D W 10
 rods then S 37 D W 24 rods S 20 D W 64
 rods then S 26 D W 19 rods S 2 D W 12 rods
~~S 9 D E 10 D W 12 rods S 8 D W~~
 10 rods S 4 D E 14 rods S 8 D W 34 rods
 S 31 D W 17 rods S 26 D W 16 rods then
 on the left side of the line between
 the 12 & 13 lots in the 9th range 74 rods
 then S 38 D W 10 rods S 6 D E 15 rods S 15
 rods S 8 D W 7 rods to Hemlock Tree to the
 road that leads from the center of the town
 to London Derry - the above road laid out
 by order of the prefects of the election

Thomas Burgess Surveyor

GRAFTON ANCIENT ROADS REPORT

Book	Page	Date	No on page	Box of Deeds No.	From	To	Plotted	Placed on plan	Lot	Range
		1/1/1833		091	Agreement between Silas Davis and Town of Grafton to construct new road		n	n		
		1/1/1833		092	Agreement between Sam Kidder and Town of Grafton to construct new road.		n	n		
		6/9/1831		095	Assessment of damage Awards to Samuel Wooley, Hyman Burgess, Gideon Palmer					
				096	NO PAGE 96		N	N		
		6/5/1799		097-1	Hwy leading from west side of Saxtons River before the sawmill and passes Louise? Parks dwelling house		Y	N		
		6/5/1799		097-2	Beg at the bridge below Joseph Whitcomb and running on the road west of Peter Whitcombs					
		6/6/1894		099-1	DISC of Road from dwelling house of the Davenport Place to the Brook Road leading to Chester		n	n		
		6/30/1894		099-2	DISC of Road Beg on north side of Chester Brook Road a few rods sly of the dwelling house of ? Christy to the house formerly owned by Silas S. Davis		n	n		
		12/25/1888		100	WINTER ROAD LAYOUT For removal of wood by Henry Wooley through lands of Barton Aldrich beg on the line of Barton Upham and Launian Upham can be used from 15th day of N		n	n		
				102	NO PAGE 102		N	N		
				101	NO PAGE 101					
		9/1/1821		104	Layout of Route 121 from Bellows Falls to Grafton		n	n		
		6/7/1806		105A	Request to alter part of the road from Rockingham Line to Grafton Meeting House		n	n		
		6/29/1806		105	Layout of hwy beg abt 2R south of Thomas K. Park southeast corner bet him and William Stickney layout or alter on Butterfield land		Y	Y	07	10
				110	NO PG 110					
				111	NO PG 111					
		1/1/1833		113	John Wier contract to build road					
		1/1/1833		115	John Wier contract to build road					
		3/20/1846		116	PETITION FOR LAYOUT NOT GRANTED					
3 (B)-125	125	8/22/1889			Disc of hwy beg at hwy lding fr Houghtonville to Windham at pt a short dist east of the mill site occ by Geo S. Pierce and lding across brk nr sd hwy in a sly dir to the site of the dwellin		n	n		
3(B)-126	126	12/25/1888			Winter road from Across land of Barton or Bolton C. Aldrich at common line of Lawrence & Upham , also 32R on road formerly owned by Henry Wooley To the edge of timber unsure		n	n		
3(B)-127	127	8/22/1889			Same as 3(B)-125					
3(B)-128	128	12/25/1888			Same as 3(B)-126					
3 (B)-051-2	051	11/20/1867	2		Disc of public road from Russell Stiles to it's intersection with Hinckley Brook near the dwelling house of RM Cook					
3(B)-101	101	6/12/1883			Req for layout fr the southern terminus of the hwy laid out by the selectmen of Grafton on Dec. 7, 1881 thru lands of Martin A. Daggett and run in a sly dir to the new brn on HB Carpernt		y	y	11	04
3(B)-101-102	101-102	7/11/1883			Laid out 3(B)-101					
3 (B)-092	092	11/28/1881			Petition to layout 3(B)-91-92					
3 (B)-96	096	8/15/1882			Beg near Crumb Bridge th..Entrance to Turner Hill Road		y	y		
3 (B)-103-104	103-104	11/10/1883			Turner Hill Road from the end of layout 3 (B)-96 to Turner Property		y	y		
4(C)-107	107	7/30/1935			Disc Hwy Stiles Brook or South Windham Road - Southwest corner of Grafton and Fisher Road from Stiles Brook Road to Jordan Hill Road in Townshend		y	y		
3(B)-177	177	6/13/1899			Discontinue road from a point 9 rods from the bridge on William H. Gallup's land To the Windham Line		y	y	14,15 &	05
4(C)-124		9/12/1936		124	Discontinue highway 250 northerly of the Residence of H.N. Repp to a point 550 feet south of sd Repp Residence		y	y		
5(D)-66	66	5/2/1970			Discontinue highway at Gibb Lockerby To David Lockerby		y	y		