

CERTIFICATE OF HIGHWAY MILEAGE

FOR YEAR ENDING FEBRUARY 10, 1969

Fill out in triplicate and file with your Town Clerk on or before February 10, 1969

(Note sections of Vermont Statutes Annotated on reverse side of this sheet)

We, the Selectmen of the town of Brookline, on oath state that we have carefully measured all the traveled highways in this town and find that the total mileage of traveled highways according to Title 19, V.S.A. Sec. 18, amended 1961, Act No. 23, not including pent roads and trails, in this town for the year ending February 10, 1969, is as follows:

	MILEAGE IN TOWN (Outside of villages Incorporated for highways)			MILEAGE IN VILLAGE (Incorporated for highways)			Total All Systems
	BROOKLINE						
	Town Highways	State Aid Highways	State Highways	Town Highways	State Aid Highways	State Highways	
PREVIOUS MILEAGE as shown March 15, 1968	13.08	4.950	---				18.030
HIGHWAYS ADDED Since March 15, 1968, ac- cording to statute. Explain under paragraph 1 below.	.11	---					
SUB-TOTAL							
HIGHWAYS SUBTRACTED Since March 15, 1968, Those becoming untraveled, discon- tinued, legal trails or pent roads. Explain under para- graphs 2 and 3 below.	---	---					
TOTAL TRAVELED HIGHWAYS Feb. 10, 1969.	<u>13.08</u>	<u>4.950</u>					<u>18.030</u>

1. We hereby certify that the following new highways, as substantiated by the attached "Selectmen's Certificate of Completion", have been added since March 15, 1968:

None

2. We hereby certify that the following highways have been discontinued, or changed to trails or pent roads according to statute, since March 15, 1968, as substantiated by the attached copy of the proceedings:

None

3. We hereby certify that the following roads have become untraveled since March 15, 1968:

None

SELECTMEN:

Lester V. Allbee
Lester E. Rink
Henry E. Bush

At Brookline in the county of Windsor
the 30 day of January, 1969 personally appeared Lester V. Allbee
Lester E. Rink and Henry E. Bush
Selectmen of Brookline
and made oath to the truth of the foregoing affidavit by them subscribed.

Before me,

Minnie H. Marsh
Notary Public
(Write official title, as Notary Public)

(Town Clerk should fill out following and mail one white and one yellow copy to the Commissioner of Highways, Montpelier, Vermont, on or before March 15th.)

I, Minnie H. Marsh, Clerk of the Town of Brookline
hereby certify that the foregoing is a true copy of record of the certificate of the Selectmen of Brookline
relating to highway mileage, filed and recorded at this office January 30,

Attest

Minnie H. Marsh
Town Clerk

570' 11 mile

Suggested Selectmen's Certificate of Completion
for New Highways built or Highways added

CERTIFICATE OF COMPLETING AND OPENING
HIGHWAY FOR PUBLIC TRAVEL

Minnie A. Marsh, Town (City) Clerk
Town (City) of Brookline
Windham County, Vermont

Pursuant to Title 19, V.S.A. Section 15, this is to certify that the following described section (sections) of highway in the Town (City) of Brookline, off Highway Route Number 1 is completed and OPEN FOR PUBLIC TRAVEL.

Section I. (If only one section, omit words "Section I")

Beginning (description)
.07 Mile from Town Line newface Brookline 570' Long BlackTOP
going N. E. direction
and as shown on a Highway Map of the Town (City) of Brookline, dated March 14, 1969, and filed in Brookline of the Land Records of the Town (City) of Brookline by the Town (City) Clerk of said Town (City), incorporated herein by reference, and attested to on said map by said Town (City) Clerk.

Dated at Brookline, County of Windham, and State of Vermont, this 14th day of March A.D., 1969.

Lester V. Albee Board
Henry E. Bush of
Lester E. Rink Selectmen
(Aldermen)

(and the Mayor of the City of _____)
Brookline, Vermont
March 14th, 1969

The above is a true copy of description of a section (s) of highway, completed and OPENED FOR PUBLIC TRAVEL, recorded in Book 12 on Page 381 of Land Records of the Town (City) of Brookline on the 14th day of March, 1969, at 8 o'clock 4:5 P.M.

Highways described on this certificate must have been added according to Title 19, V. S. A., Sections 1, 296 & 349.

Attest: Minnie A. Marsh
Town (City) Clerk of Brookline Vt.

Before me: Minnie A. Marsh

File

all 196

Pl
as
H
S
C
U
F
T
O

VEL)

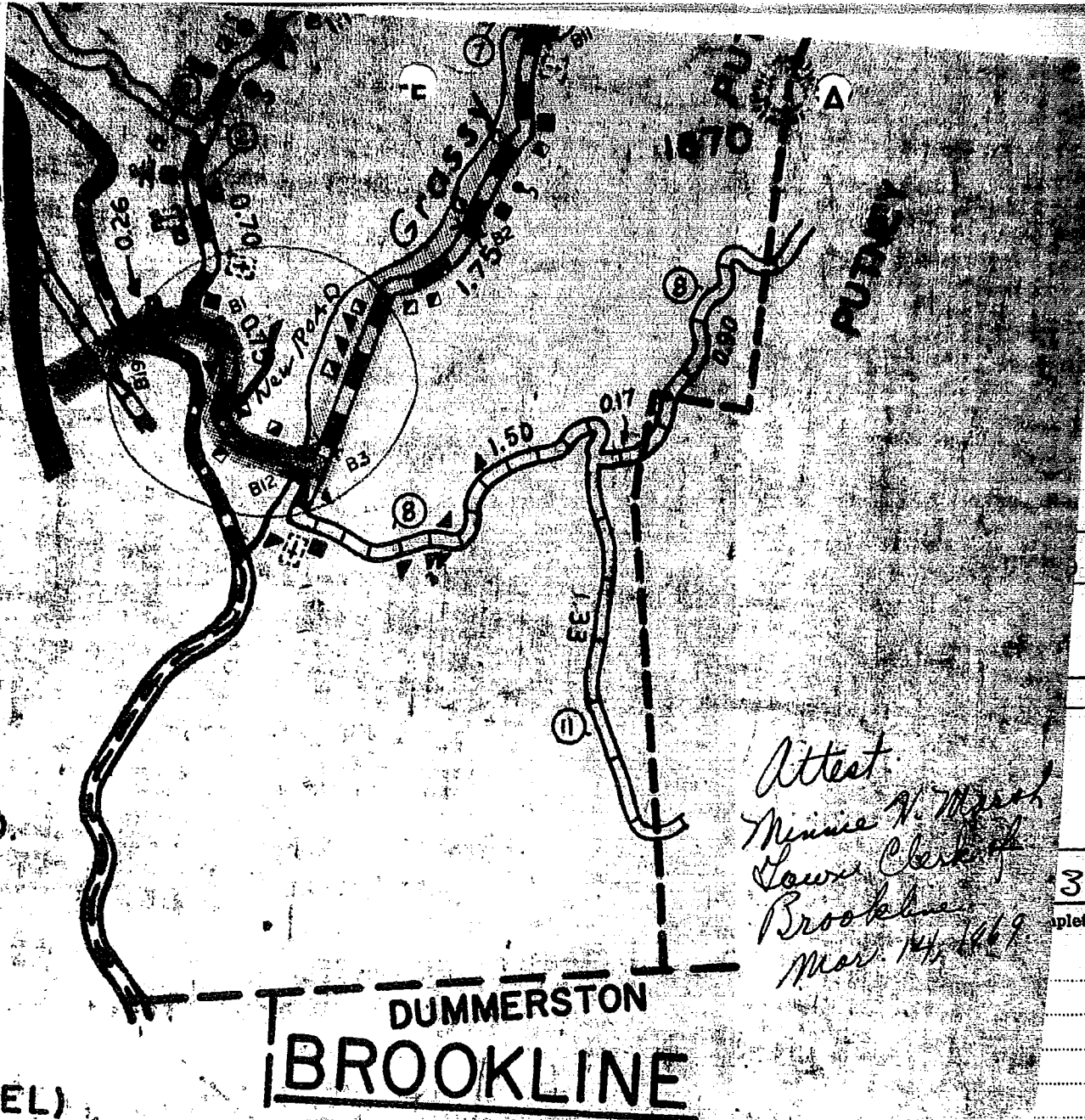

Attest
 Minnie V. Marsh
 Town Clerk
 Brookline
 Mar. 14, 1969

30
 completion"

to statute,

3. We hereby certify that the following roads have become untraveled since March 15, 1967:

SELECTMEN:

Lester V. Albee
 Henry E. Bush
 Lester E. Rink

At Brookline

in the county of Windham

the 29th day of January, 1968 personally appeared Lester V. Albee,
 Henry E. Bush and Lester E. Rink
 Selectmen of Brookline

and made oath to the truth of the foregoing affidavit by them subscribed.

Before me, M. J. [Signature]

CERTIFICATE OF HIGHWAY MILEAGE

FOR YEAR ENDING FEBRUARY 10, 1968

Fill out in triplicate and file with your Town Clerk on or before February 10, 1968

(Note sections of Vermont Statutes Annotated on reverse side of this sheet)

We, the Selectmen of the town of Brookline, on oath state that we have carefully measured all the traveled highways in this town and find that the total mileage of traveled highways according to Title 19, V.S.A. Sec. 15, amended 1961, Act No. 28, not including pent roads and trails, in this town for the year ending February 10, 1968, is as follows:

	MILEAGE IN TOWN (Outside of villages incorporated for highways)			MILEAGE IN VILLAGE (Incorporated for highways)			Total All Systems
	BROOKLINE						
	Town Highways	State Aid Highways	State Highways	Town Highways	State Aid Highways	State Highways	
PREVIOUS MILEAGE as shown March 15, 1967	13.08	4.950	---				18.030
HIGHWAYS ADDED Since March 15, 1967, ac- cording to statute. Explain under paragraph 1 below.							
SUB-TOTAL							
HIGHWAYS SUBTRACTED Since March 15, 1967. Those becoming untraveled, discon- tinued, legal trails or pent roads. Explain under para- graphs 2 and 3 below.							
TOTAL TRAVELED HIGHWAYS Feb. 10, 1968.	13.08	4.950					18.030

1. We hereby certify that the following new highways, as substantiated by the attached "Selectmen's Certificate of Completion", have been added since March 15, 1967:

2. We hereby certify that the following highways have been discontinued, or changed to trails or pent roads according to statute, since March 15, 1967, as substantiated by the attached copy of the proceedings:

3. We hereby certify that the following roads have become untraveled since March 15, 1967:

SELECTMEN:

Lester V. Albee
Henry E. Budge
Lester E. Bink

At Brookline in the county of Windsor
the 29th day of January, 1968 personally appeared Lester V. Albee
Henry E. Budge and Lester E. Bink
Selectmen of Brookline
and made oath to the truth of the foregoing affidavit by them subscribed.

Before me,

Minnie H. Marsh
Notary Public
(Write official title, as Notary Public)

(Town Clerk should fill out following and mail one white and one yellow copy to the Commissioner of Highways, State of Vermont on or before March 15th.)

I, Minnie H. Marsh, Clerk of the Town of Brookline
herely certify that the foregoing is a true copy of record of the certificate of the Selectmen of Brookline
relating to highway mileage, filed and recorded at this office February 5,

Attest Minnie H. Marsh
Town Clerk

CERTIFICATE OF HIGHWAY MILEAGE

FOR YEAR ENDING FEBRUARY 10, 1967

Fill out in triplicate and file with your Town Clerk on or before February 10, 1967

(Note sections of Vermont Statutes Annotated on reverse side of this sheet)

We, the Selectmen of the town of Brookline, on oath state that we have carefully measured all the traveled highways in this town and find that the total mileage of traveled highways according to Title 19, V.S.A. Sec. 15, amended 1961, Act No. 28, not including pent roads and trails, in this town for the year ending February 10, 1967, is as follows:

	MILEAGE IN TOWN (Outside of villages Incorporated for highways)			MILEAGE IN VILLAGE (Incorporated for highways)			Total All Systems
	BROOKLINE						
	Town Highways	State Aid Highways	State Highways	Town Highways	State Aid Highways	State Highways	
PREVIOUS MILEAGE as shown March 15, 1966	13.08	4.950	--				18.030
HIGHWAYS ADDED Since March 15, 1966, ac- cording to statute. Explain under paragraph 1 below.							
SUB-TOTAL							
HIGHWAYS SUBTRACTED Since March 15, 1966. Those becoming untraveled, discon- tinued, legal trails or pent roads. Explain under para- graphs 2 and 3 below.							
TOTAL TRAVELED HIGHWAYS Feb. 10, 1967	13.08	4.950	—				18.030

1. We hereby certify that the following new highways, as substantiated by the attached "Selectmen's Certificate of Completion", have been added since March 15, 1966:

2. We hereby certify that the following highways have been discontinued, or changed to trails or pent roads according to statute, since March 15, 1966, as substantiated by the attached copy of the proceedings:

3. We hereby certify that the following roads have become untraveled since March 15, 1966:

SELECTMEN: *Lester V. Allbee*
Henry E. Bush
Lester E. Rink

At Brookline in the county of Windham
the 8th day of February, 1967 personally appeared Lester V. Allbee
Henry E. Bush and Lester E. Rink
Selectmen of Brookline
and made oath to the truth of the foregoing affidavit by them subscribed.

Before me,
Miriam J. Marsh
Notary Public
(Write official title, appropriate Public)

(Town Clerk should fill out following and mail one white and one yellow copy to the Commissioner of Highways, Department of Transportation, Vermont, on or before March 15th.)
I, Miriam J. Marsh, Clerk of the Town of Brookline
hereby certify that the foregoing is a true copy of record of the certificate of the Selectmen of Brookline
relating to highway mileage, filed and recorded at this office February 3,
Attest: Miriam J. Marsh
Town Clerk

CERTIFICATE OF HIGHWAY MILEAGE

FOR YEAR ENDING FEBRUARY 10, 1966

Fill out in triplicate and file with your Town Clerk on or before February 10, 1966

(Note sections of Vermont Statutes Annotated on reverse side of this sheet)

We, the Selectmen of the town of Brookline, on oath state that we have carefully measured all the traveled highways in this town and find that the total mileage of traveled highways according to Title 19, V.S.A. Sec. 15, amended 1961, Act No. 28, not including pent roads and trails, in this town for the year ending February 10, 1966, is as follows:

	MILEAGE IN TOWN (Outside of villages incorporated for highways)			MILEAGE IN VILLAGE (Incorporated for highways)			Total All Systems	
	BROOKLINE							
	Town Highways	State Aid Highways	State Highways	Town Highways	State Aid Highways	State Highways		
PREVIOUS MILEAGE as shown March 15, 1965	13.08	4.950	--				18.030	
HIGHWAYS ADDED Since March 15, 1965, ac- cording to statute. Explain under paragraph 1 below.	—	—						
SUB-TOTAL								
HIGHWAYS SUBTRACTED Since March 15, 1965. Those becoming untraveled, discon- tinued, legal trails or pent roads. Explain under para- graphs 2 and 3 below.	—	—						
TOTAL TRAVELED HIGHWAYS Feb. 10, 1966	13.08	4.950					18.030	

1. We hereby certify that the following new highways, as substantiated by the attached "Selectmen's Certificate of Completion", have been added since March 15, 1965:

None

2. We hereby certify that the following highways have been discontinued, or changed to trails or pent roads according to statute, since March 15, 1965, as substantiated by the attached copy of the proceedings:

None

3. We hereby certify that the following roads have become untraveled since March 15, 1965:

None

SELECTSMEN: { *Lester J. Allbee*
Lester E. Bush
Henry E. Bush

At Brookline in the county of Windham
the 26 day of January, 1966 personally appeared Lester J. Allbee
Lester E. Bush and Henry E. Bush
Selectmen of Brookline
and made oath to the truth of the foregoing affidavit by them subscribed.

Before me,
Minnie H. Marsh
Notary Public
(Write official title, as Notary Public)

(Town Clerk should fill out following and mail one white and one yellow copy to the Commissioner of Highways, Montpelier, Vermont, on or before March 15th.)

I, Minnie H. Marsh, Clerk of the Town of Brookline
hereby certify that the foregoing is a true copy of record of the certificate of the Selectmen of Brookline
relating to highway mileage, filed and recorded at this office January 26,

Attest Minnie H. Marsh
Town Clerk

CERTIFICATE OF HIGHWAY MILEAGE

FOR YEAR ENDING FEBRUARY 10, 1965

Fill out in triplicate and file with your Town Clerk on or before February 10, 1965

(Note sections of Vermont Statutes Annotated on reverse side of this sheet)

We, the Selectmen of the town of Brookline, on oath state that we have carefully measured all the traveled highways in this town and find that the total mileage of traveled highways according to Title 19, V.S.A. Sec. 15, amended 1961, Act No. 28, not including pent roads and trails, in this town for the year ending February 10, 1965, is as follows:

	MILEAGE IN TOWN (Outside of villages incorporated for highways)			MILEAGE IN VILLAGE (Incorporated for highways)			Total All Systems
	BROOKLINE						
	Town Highways	State Aid Highways	State Highways	Town Highways	State Aid Highways	State Highways	
PREVIOUS MILEAGE as shown March 15, 1964	13.08	4.950	--				18.030
HIGHWAYS ADDED Since March 15, 1964, ac- cording to statute. Explain under paragraph 1 below.	<i>none</i>						
SUB-TOTAL							
HIGHWAYS SUBTRACTED Since March 15, 1964. Those becoming untraveled, discon- tinued, legal trails or pent roads. Explain under para- graphs 2 and 3 below.	<i>none</i>						
TOTAL TRAVELED HIGHWAYS Feb. 10, 1965	13.08	4.950					18.030

1. We hereby certify that the following new highways, as substantiated by the attached "Selectmen's Certificate of Completion," have been added since March 15, 1964:

none

2. We hereby certify that the following highways have been discontinued, or changed to trails or pent roads according to statute, since March 15, 1964, as substantiated by the attached copy of the proceedings:

none

3. We hereby certify that the following roads have become untraveled since March 15, 1964:

none

SELECTMEN:

*Jesse V. Albee
Lester E. Rank
Henry E. Bush*

At Brookline

in the county of Windsor

the 10th day of February, 1965 personally appeared Jesse V. Albee
Lester E. Rank
Henry E. Bush
Selectmen of Brookline
and made oath to the truth of the foregoing affidavit by them subscribed.

Before me,

Minnie H. Marsh
Notary Public
(Write official title as Notary Public)

(Town Clerk should fill out following and mail one white and one yellow copy to the Commissioner of Highways, Montpelier, Vermont, on or before March 15th.)

I, Minnie H. Marsh, Clerk of the Town of Brookline
hereby certify that the foregoing is a true copy of record of the certificate of the Selectmen of Brookline
relating to highway mileage, filed and recorded at this office Feb. 10, 1965

Attest

Minnie H. Marsh
Town Clerk

Highway Planning Division

March 2, 1964

**Board of Selectmen
Brookline, Vermont**

Attention of Chairman

Gentlemen:

Thank you for the submission of the survey which shows the Bennett Road is in the town of Brookline.

We are adding the 1.33 miles to your Town Highway mileage for the present and sometime this spring or summer will have a field party measure the highway to check the accuracy of the additional mileage.

Some adjustment may or may not be in order at that time but will not be reflected until the 1965 mileage certificates are ready.

Thank you again for your cooperation.

Yours very truly,

**H.F. Farrington
Highway Planning Engineer**

**By: V.N. Therrien
Administrative Assistant**

HFF/VNT/mjs

and made oath to the truth of the foregoing affidavit by them subscribed.

Before me,

Marion J. March

CERTIFICATE OF HIGHWAY MILEAGE

FOR YEAR ENDING FEBRUARY 10, 1964

Fill out in triplicate and file with your Town Clerk on or before February 10, 1964

(Note sections of Vermont Statutes Annotated on reverse side of this sheet)

We, the Selectmen of the town of Brookline, on oath state that we have carefully measured all the traveled highways in this town and find that the total mileage of traveled highways according to Title 19, V.S.A. Sec. 11, amended 1961, Act No. 28, not including pent roads and trails, in this town for the year ending February 10, 1964, is as follows:

	MILEAGE IN TOWN (Outside of villages incorporated for highways)			MILEAGE IN VILLAGE (Incorporated for highways)			Total All Systems
	BROOKLINE						
	Town Highways	State Aid Highways	State Highways	Town Highways	State Aid Highways	State Highways	
PREVIOUS MILEAGE as shown March 15, 1963	11.75	4.950	--				16.700
HIGHWAYS ADDED Since March 15, 1963, according to statute. Explain under paragraph 1 below.	1.33						
SUB-TOTAL	13.08	4.950					18.030
HIGHWAYS SUBTRACTED Since March 15, 1963. Those becoming untraveled, discontinued, legal trails or pent roads. Explain under paragraphs 2 and 3 below.				CHANGE IN TOWN HWY. ACCEPTED SUBJECT TO 1964 FIELD CHECK			
TOTAL TRAVELED HIGHWAYS Feb. 10, 1964	13.08	4.950					18.030

1. We hereby certify that the following new highways, as substantiated by the attached "Selectmen's Certificate of Completion," have been added since March 15, 1963:

*KNOWN as the Bennett Road Taken over from a recent
survey between the Town of Putney and Brookline 1.33*

2. We hereby certify that the following highways have been discontinued, or changed to trails or pent roads according to statute, since March 15, 1963, as substantiated by the attached copy of the proceedings:

none

3. We hereby certify that the following roads have become untraveled since March 15, 1963:

none

SELECTMEN:

*Lester V. Allbee
Lester E. Rink
Henry E. Bush*

At Brookline in the county of Windsor
the 24th day of January, 1964 personally appeared Lester V. Allbee,
Lester E. Rink and Henry E. Bush
Selectmen of Brookline
and made oath to the truth of the foregoing affidavit by them subscribed.

Before me,

*Merine W. Marsh
Notary Public*
(Write official title, as Notary Public)

(Town Clerk should fill out following and mail one white and one yellow copy to the Commissioner of Highways, Montpelier, Vermont, on or before March 15th.)

I, Merine W. Marsh, Clerk of the Town of Brookline
hereby certify that the foregoing is a true copy of record of the certificate of the Selectmen of Brookline
relating to highway mileage, filed and recorded at this office January 24th, 1964.

Attest Merine W. Marsh
Town Clerk

RUSSELL A. HOLDEN
COMMISSIONER OF HIGHWAYS



STATE OF VERMONT
DEPARTMENT OF HIGHWAYS
MONTPELIER
05502
Highway Planning Division

February 5, 1964

Board of Selectmen
Brookline, Vermont

Attention of Chairman

Gentlemen:

Thank you for the prompt submission of your Highway Mileage Certificates.

However, the mileage for "Bennett Road" is not acceptable as an addition, at this time, for the following reasons.

This same mileage was proposed as an addition last year and was turned down because no supporting data had been forwarded to this office along with the Highway Mileage Certificate. A further study at that time revealed there was some question about the location of the Brookline/Putney Town Line and it was agreed that when the matter was settled we would be notified and would then field check the road in question.

No such notification was received by this office and as far as we know the situation remains unchanged from last year.

The paper signed by the Selectmen and forwarded to this office with your mileage certificates this year, which we are returning to you, contains neither a description of the highway as shown in the Town records, nor the record of

Herby

the laying out of the highway, both as required by the statutes. Such information would be necessary before the road could be added to your Town Highway mileage even after you had submitted documented evidence of a final decision between the towns on the location of the Town Line.

If all this can be accomplished and returned to this office prior to March 15, 1964, the mileage could still be included in our submission to the Auditor of Accounts this year.

If you have any further questions, regarding this proposed addition, your District Highway Engineer has a copy of this letter and will be glad to assist you.

Yours very truly,

H. F. Farrington
Highway Planning Engineer

HFF/VMT/baw
Encs.



STATE OF VERMONT
DEPARTMENT OF HIGHWAYS
MONTPELIER
Highway Planning Division

April 3, 1963

Board of Selectmen
Brookline, Vermont

Attention of Chairman

Gentlemen:

Thank you for the submission of your Highway Mileage Certificates.

However, as we have received no reply to our letter requesting a Selectmen's Certificate of Completion and Opening to Public Travel for the Bennett Road, we are unable to include the 1.33 miles for this road in your Town Highway mileage at this time.

Perhaps the provisions of the statutes may be complied with in time for our submission in 1964 to the Auditor of Accounts.

For this year your highway mileages are as follows:

Town Highways	11.75 miles
State Aid Highways	4.950 "
Total Highways	16.700 miles

This is the mileage submitted to the Auditor and your records should be changed accordingly.

Thank you for your cooperation.

Yours very truly,

H. F. Farrington
Highway Planning Engineer

By: Vincent N. Therrien
Administrative Assistant

HFF/VNT/ENA

RUSSELL A. HOLDEN
COMMISSIONER OF HIGHWAYS



STATE OF VERMONT
DEPARTMENT OF HIGHWAYS
MONTPELIER
Highway Planning Division

February 14, 1963

Board of Selectmen
Brookline, Vermont

Attention of Chairman

Gentlemen:

Thank you for the prompt submission of your Highway Mileage Certificates.

However, even though it seems all right to put back on Town Highway the 0.33 mile for Town Highway No. 8, subtracted in 1961, it is still necessary that a Selectman's Certificate of Completion and Opening to Public Travel be furnished for the Bennett Road before it can be added to your mileage.

Such a certificate should contain a description of the highway as shown in the Town Records as well as the laying out of this highway.

If records cannot be found for this highway you may wish to lay it out, according to the statutes, and add it to your mileage next year.

In any event please notify us as soon as possible in order that we may know what mileage should be submitted to the Auditor of Accounts.

Yours very truly,

H. F. Farrington
Highway Planning Engineer

By: Vincent N. Therrien
Administrative Assistant

HFF/VNT/gfs

Minnie Hallmark
Notary Public

CERTIFICATE OF HIGHWAY MILEAGE

FOR YEAR ENDING FEBRUARY 10, 1963

Fill out in triplicate and file with your Town Clerk on or before February 10, 1963

(Note sections of Vermont Statutes Annotated on reverse side of this sheet)

We, the Selectmen of the town of Brookline, on oath state that we have carefully measured all the traveled highways in this town and find that the total mileage of traveled highways according to Title 19 V.S.A. Sec. 15, amended 1961, Act No. 28, nor including pent roads and trails, in this town for the year ending February 10, 1963, is as follows:

	MILEAGE IN TOWN (Outside of villages incorporated for highways)			MILEAGE IN VILLAGE (Incorporated for highways)			Total All Systems
	Brookline						
	Town Highways	State Aid Highways	State Highways	Town Highways	State Aid Highways	State Highways	
PREVIOUS MILEAGE as shown March 15, 1962	11.42	4,950	---				16,370
HIGHWAYS ADDED Since March 15, 1962, ac- cording to statute. Explain under paragraph 1 below.	0.33 11.75						
SUB-TOTAL	11.75 11.75	4,950					16,700 18,030
HIGHWAYS SUBTRACTED Since March 15, 1962. Those becoming untraveled, discon- tinued, legal trails or pent roads. Explain under para- graphs 2 and 3 below.				Proposed addition of 1.33 for Bennett Road not substantiated. Other change is ok. TNT			
TOTAL TRAVELED HIGHWAYS Feb. 10, 1963	11.75 11.75	4,950	--				18,030 16,700

1. We hereby certify that the following new highways, as substantiated by the attached "Selectmen's Certificate of Completion," have been added since March 15, 1962: *We would like to have added the 0.33 in Town Highway # 2 (that was subtracted in 1961), also the Bennett Road in District Mt. of 1.33 miles. We feel these should be added due to the New Pathway Brookline Town line surveyed last year.*

2. We hereby certify that the following highways have been discontinued, or changed to trails or pent roads according to statute, since March 15, 1962, as substantiated by the attached copy of the proceedings:

3. We hereby certify that the following roads have become untraveled since March 15, 1962:

SELECTMEN:

Geo. E. Ware
Lester V. Albee
Lester E. Rink

At Brookline in the county of Windsor
the 4th day of February, 1963 personally appeared Geo. E. Ware,
Lester V. Albee and Lester E. Rink
Selectmen of Brookline
and made oath to the truth of the foregoing affidavit by them subscribed.

Before me,

Minnie H. Marsh
Notary Public
(Write official title, as Notary Public)

(Town Clerk should fill out following and mail one white and one yellow copy to the Commissioner of Highways, Montpelier, Vermont, on or before March 15th.)

I, Minnie H. Marsh, Clerk of the Town of Brookline
hereby certify that the foregoing is a true copy of record of the certificate of the Selectmen of Brookline
relating to highway mileage, filed and recorded at this office February 5, 1963

Attest Minnie H. Marsh
Town Clerk

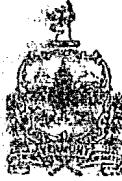

STATE OF VERMONT
DEPARTMENT OF HIGHWAYS
MONTPELIER

Highway Planning Division

February 20, 1962

Mem. Minnie Marsh
Town Clerk
Brookline, Vermont

Dear Mrs. Marsh:

We are enclosing for your records a map of the Town of Brookline, as approved by the Commissioner of Highways on February 2, 1962. Also included is an extra copy for your use.

The revalidation certificates for the town records will be delivered to your office by the district highway engineer.

This is in accordance with Title 19, V.S.A., Sections 1 and 13, which states that "When an addition or deletion is made to state-aid highways, the board shall make maps showing the highways which are added and/or deleted . . . It shall also file a copy of the map of such highways in the office of the clerk of the town wherein said highways be. When such maps are so filed, the revalidation of such highways shall be deemed to have taken place . . . A review and revalidation of the state-aid highway mileage shall be made by the town and the district highway engineer at least once in every 10-year period commencing in the year 1960."

When the map has been filed, would you please fill out ^{complete} and sign the enclosed forms and return to this office.

Very truly yours,

N. F. Farrington
Highway Planning Engineer

WFP/UNK/Am
Encs.

Subscribed and made oath to the truth of the foregoing affidavit by them subscribed.

Before me,

Minnie H. Marsh
Minnie H. Marsh

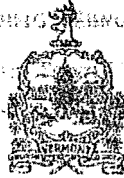

STATE OF VERMONT
DEPARTMENT OF HIGHWAYS
MONTPELIER
Highway Planning Division

February 19, 1962

R. O. Egan
District Highway Engineer
Brattleboro, Vermont

Dear Sirs

Enclosed for your records are copies of the state-aid reselection certificates and accompanying maps for the towns of Brookline, Wariboro and Westfaster, as approved by the Commissioner of Highways on February 2, 1962. Extra maps are included for your own use.

Signed maps for the town records have been forwarded directly to the town clerk. For your information, we enclose a copy of the letter of transmittal to the clerk of each town.

In addition to the reselection certificates for your files, we enclose the certificates for the town records.

The reselections are in accordance with Title 19, V.S.A., Sections 1 and 13.

Very truly yours,

H. F. Farrington
Highway Planning Engineer

HFF/VMT/ass
Enc.

Subscribed and made oath to the truth of the foregoing affidavit by them subscribed.

Before me,

Merwin G. Marsh
Notary Public

CERTIFICATE OF HIGHWAY MILEAGE

FOR YEAR ENDING FEBRUARY 10, 1962

Fill out in triplicate and file with your Town Clerk on or before February 10, 1962

(Note sections of Vermont Statutes Annotated on reverse side of this sheet)

We, the Selectmen of the town of Brookline, on oath state that we have carefully measured all the traveled highways in this town and find that the total mileage of traveled highways according to Title 19 V.S.A. Sec. 13, amended 1961, Act No. 20, not including pent roads and trails, in this town for the year ending February 10, 1962, is as follows:

	MILEAGE IN TOWN <small>(Outside of villages incorporated for highways)</small>			MILEAGE IN VILLAGE <small>(Incorporated for highways)</small>			Total All Systems
	Brookline						
	Town Highways	State Aid Highways	State Highways	Town Highways	State Aid Highways	State Highways	
PREVIOUS MILEAGE as shown March 15, 1961	8.78	7.590	--				16.370
HIGHWAYS ADDED Since March 15, 1961, according to statute. Explain under paragraph 1 below.	2.64						
SUB-TOTAL	11.42	7.590					
HIGHWAYS SUBTRACTED Since March 15, 1961. Those becoming untraveled, discontinued, legal trails or pent roads. Explain under paragraphs 2 and 3 below.		2.640		mileage changes due entirely to 15-year reselection VMT			
TOTAL TRAVELED HIGHWAYS Feb. 10, 1962	11.42	4.950					16.370

1. We hereby certify that the following new highways, as substantiated by the attached "Selectmen's Certificate of Completion," have been added since March 15, 1961: none

2. We hereby certify that the following highways have been discontinued, or changed to trails or pent roads according to statute, since March 15, 1961, as substantiated by the attached copy of the proceedings: none

3. We hereby certify that the following roads have become untraveled since March 15, 1961: none

SELECTMEN: { Henry E. Bush
Geo. C. Ware
Lester V. Allbee

At Brookline in the county of Windsor
the 10th day of February, 1962 personally appeared Henry E. Bush
Geo. C. Ware and Lester V. Allbee
Selectmen of Brookline
and made oath to the truth of the foregoing affidavit by them subscribed.

Before me, Minnie H. Marsh
Notary Public
(Write official title, as Notary Public)

(Town Clerk should fill out following and mail one white and one yellow copy to the Commissioner of Highways, Montpelier, Vermont, on or before March 15th.)

I, Minnie H. Marsh, Clerk of the Town of Brookline, hereby certify that the foregoing is a true copy of record of the certificate of the Selectmen of Brookline relating to highway mileage, filed and recorded at this office February 10th, 1962.

Attest: Minnie H. Marsh
Town Clerk

SECTION OF STATE AID HIGHWAY

Town of Brookline

County of Windham

Vt. Hwy. Dist. No. 2

Total S.A. Mileage 4.95

Important town highways as required by Title 19, V.S.A., Sections 1 & 13:

No. 1 4.95 miles.

Beginning at Nowfane T/L

extending (Give direction) Northerly

ending at Intersection TH.#3

No. 2 miles.

Beginning at

extending (Give direction)

ending at

No. 3 miles.

Beginning at

extending (Give direction)

ending at

No. 4 miles.

Beginning at

extending (Give direction)

ending at

No. 5 miles.

Beginning at

extending (Give direction)

ending at

No. 6 miles.

Beginning at

extending (Give direction)

ending at

No. 7 miles.

Beginning at

extending (Give direction)

ending at

No. 8 miles.

Beginning at

extending (Give direction)

ending at

No. 9 miles.

Beginning at

extending (Give direction)

ending at

No. 10 miles.

Beginning at

extending (Give direction)

ending at

No. 11 miles.

Beginning at

extending (Give direction)

ending at

We have this 30th day of November, 1961, made the above

selection which is to supersede and replace any and all selections made prior to this time.

Henry E. Bush /s/

Geo. C. Ware /s/

Lester V. Allbee /s/

Selectmen

of the

Town of

Brookline

Effective March 15th 1962

Approved:

November 30, 1961

R. G. Kinn /s/
District Highway Engineer

DEC 29 1961

18

STATE HIGHWAY BOARD

Commissioner of Highways

EDWIN W. CULVER
Brattleboro, Vt.

September 1961

George L. Daley, Clerk
Windham County Court
230 Main Street
Brattleboro, Vermont

Re: - Brookline - Putney Town Line

Dear Sir:

After a careful search in the records of the three towns involved the following survey was made by us with Henry Bush and Lester Allbee, both Selectmen of Brookline, and William Lyons, Selectman of Putney, who, accompanied us on the entire survey.

A description of the survey is as follows:-

Beginning at the Southwest corner of the Town of Westminster, on the North line of the Town of Putney, said point being an angle in the stone walls on the East side of the Ridge Road, so-called, formerly known as the Bunting Road, said Ridge Road connects the County Road, so-called, with the Windmill Hill Road at the former site of Charles Holden's Windmill; thence prolonging the North Line of Putney, North 70 deg. West, a distance of 726.0 feet to an iron set in the ground; thence South 25 deg. 15' West, a distance of 934.0 feet to an iron set in the ground; thence South 55 deg. 15' West a distance of 528.0 feet to an iron set in the ground; thence South 35 deg. 15' West, a distance of 940.5 feet, to an iron set in the ground; thence South 28 deg. 15' West, a distance of 3720.2 feet, crossing the above-mentioned County Road, to an iron set in the ground on the North Line of Lot 8 of the 14th Range; thence North 70 deg. West, a distance of 1741.5 feet along

the North Line of Lot 8, and crossing the abovementioned County Road, to an iron pin set in the ground on the North Line of said Lot 8; thence South 28 deg. 15' West, a distance of 1690.0 feet, crossing said County Road to an iron set in the ground at the Southwest corner of said Lot 8, and on the Range Line between Ranges 14 and 15, thence South 16 deg. 15' West, a distance of 6600.0 feet, along said Range Line and on a stone wall to the North Line of the Town of Dummerston at a stone wall, where an iron is placed marking the Southwest corner of Putney and the Southeast corner of Brookline.

Respectfully submitted,

Edwin W. Culver

COPY

XXXXXXXXXX
XXXXXXXXXX



STATE OF VERMONT
DEPARTMENT OF HIGHWAYS
MONTPELIER
Highway Planning Division

February 17, 1960

Board of Selectmen
Brookline, Vermont

Attention of Chairman

Gentlemen:

With regard to the completion of the enclosed Highway Mileage Certificate, all the travelled highways in your town were measured in 1960 by Mr. Marion L. Allbee, Road Commissioner, with Mr. Cookson of this office, in accordance with Title 19, V. S. A., Section 15.

The only change as a result of these measurements was a reduction in mileage on Town Highway No. 8, and this has been indicated on the enclosed map and explained on the attached breakdown sheet. Would you please note the 0.33 mile as subtracted from Town Highways on the mileage certificate.

Very truly yours,

H. F. Farrington
Highway Planning Engineer

HFF/VHX/bje

Encs.

BREAKDOWN OF
1960 ROAD MEASUREMENT CHANGES

Total
Qty.
Miles

Miles
Added

Miles
Subtracted

Explanation

8

= 0.33

Remeasurement to Putney Town Line as
agreed to by officials of both towns.

= 0.33