

CERTIFICATE OF HIGHWAY MILEAGE  
YEAR ENDING FEBRUARY 10, 2006

Fill out form, make and file copy with the Town Clerk, and mail ORIGINAL, before February 20, 2006 to: VT Agency of Transportation, Program Development Division, Drawer 33, Montpelier, VT 05633.

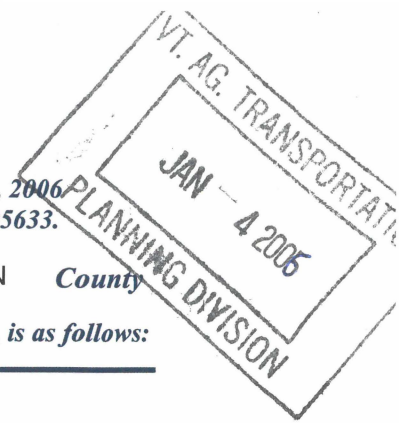

We, the Selectmen or Aldermen or Trustees of WOODBURY in WASHINGTON County on an oath state that the mileage of highways, according to Title 19, V.S.A, Sec #305, added 1985, is as follows:

PART I - CHANGES TOTALS - Please fill in and calculate totals.

Town Highways	Previous Mileage	Added Mileage	Subtracted Mileage	Total	Scenic Highways
Class 1	0.000				0.000
* Class 1 Lane	0.000				
Class 2	5.050				0.000
Class 3	31.820				0.000
State Highway	7.691				0.000
* Class 4	26.290	0.14		26.43	0.000
<b>Total</b>	<b>44.561</b>			<b>44.561</b>	<b>0.000</b>

\* Class 1 Lane Mileage and Class 4 is NOT included in total. Adjustments by S. Moulton

PART II - INFORMATION AND DESCRIPTION OF CHANGES SHOWN ABOVE.

3/31/06

1. NEW HIGHWAYS: Please attach Selectmen's "Certificate of Completion and Opening".

2. DISCONTINUED: Please attach SIGNED copy of proceedings (minutes of meeting).

3. RECLASSIFIED/REMEASURED: Please attach SIGNED copy of proceedings (minutes of meeting).

Change not completed during 2005 process, see 2005 Certificate Remeasured (1987) TH-39 Class 4 0.12 mi to 0.26 mi Notes by

4. SCENIC HIGHWAYS: Please attach a copy of order designating/discontinuing Scenic Highways. S. Moulton

3/31/06

IF THERE ARE NO CHANGES IN MILEAGE: Check box and sign below. [ ]

PART III - SIGNATURES - PLEASE SIGN.

Selectmen/ Aldermen/ Trustees Signatures:

*John P. [Signature]*  
*Brian Shatney*  
*Steve [Signature]*

Clerk Signature: Marcia Malyon Date Filed: 12.27.05

Please sign ORIGINAL and return it for Transportation signature.

AGENCY OF TRANSPORTATION APPROVAL: Signed copy will be returned to T/C/V Clerk.

APPROVED: Jonathan Croft DATE: 4/11/2006  
Representative, Agency of Transportation

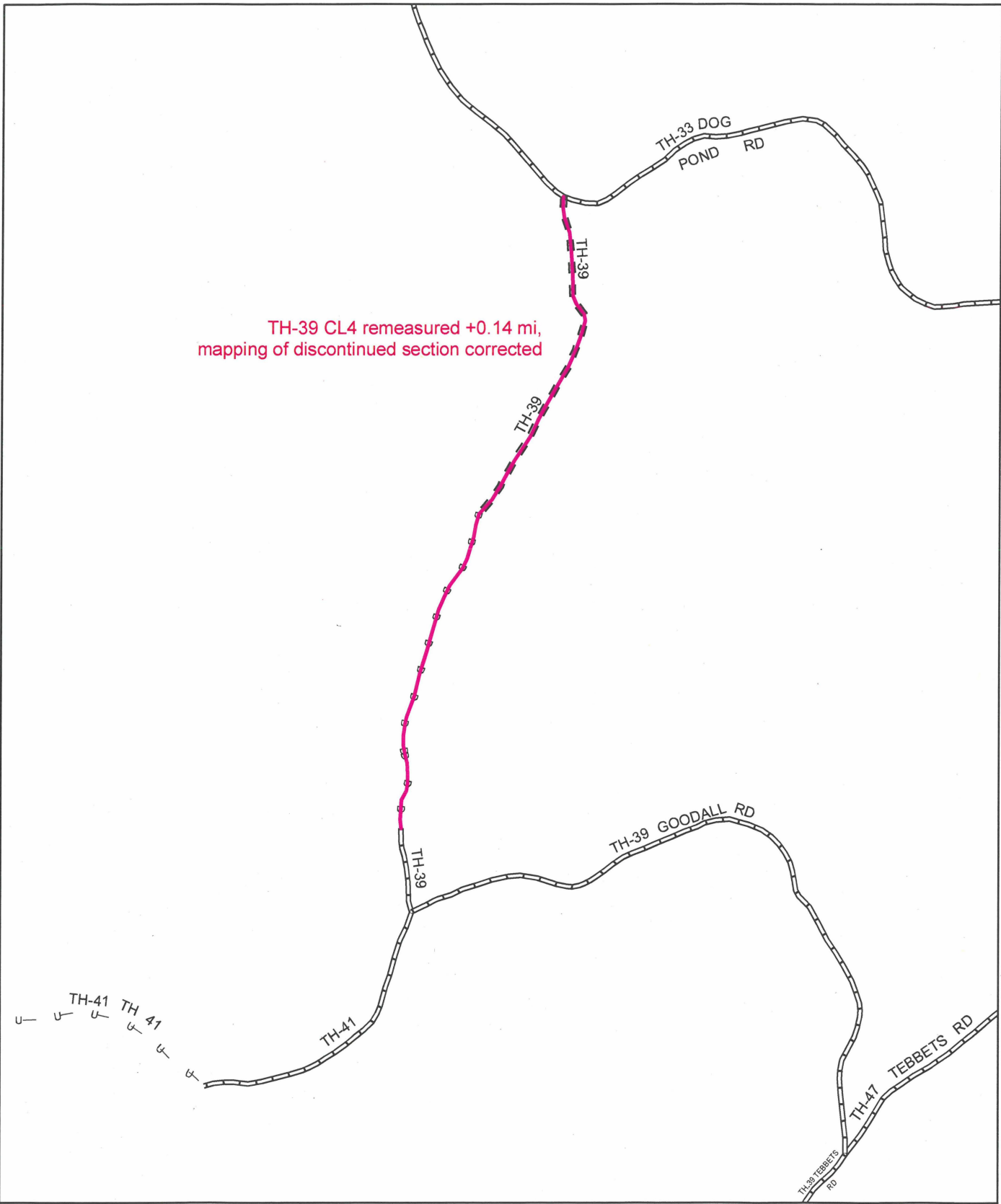

TH-39 CL4 remeasured +0.14 mi,  
mapping of discontinued section corrected

**Mileage Certificate Change 2006 -- WOODBURY**

Mapping Unit  
Policy & Planning Division  
Vermont Agency of Transportation -- March 2006

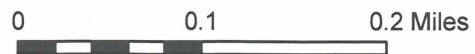

# TOWN OF WOODBURY

P.O. BOX 10

WOODBURY, VERMONT 05681

802-456-7051 email address: [towoodbury@adelphia.net](mailto:towoodbury@adelphia.net) fax: 802-456-8834

---

Marcia McGlynn

Town Clerk and Treasurer



TO: Johnathan Croft

FROM: Marcia McGlynn

DATE: 3/9/06

RE: Certificate of Highway Mileage

On 12/27/05, I sent back the 2006 certificate of mileage. Enclosed is a copy.

If you have any questions, please contact me.

Thanks.

file

**CERTIFICATE OF HIGHWAY MILEAGE**

1/3/06

**YEAR ENDING FEBRUARY 10, 2006**

Fill out form, make and file copy with the Town Clerk, and mail ORIGINAL, before February 20, 2006 to: VT Agency of Transportation, Program Development Division, Drawer 33, Montpelier, VT 05633.

We, the Selectmen or Aldermen or Trustees of **WOODBURY** in **WASHINGTON** County on an oath state that the mileage of highways, according to Title 19, V.S.A, Sec #305, added 1985, is as follows:

**PART I - CHANGES TOTALS - Please fill in and calculate totals.**

Town Highways	Previous Mileage	Added Mileage	Subtracted Mileage	Total	Scenic Highways
Class 1	0.000				0.000
* Class 1 Lane	0.000				
Class 2	5.050				0.000
Class 3	31.820				0.000
State Highway	7.691				0.000
* Class 4	26.290				0.000
<b>Total</b>	<b>44.561</b>				<b>0.000</b>

\* Class 1 Lane Mileage and Class 4 is NOT included in total.

**PART II - INFORMATION AND DESCRIPTION OF CHANGES SHOWN ABOVE.**

- NEW HIGHWAYS:** Please attach Selectmen's "Certificate of Completion and Opening".
- DISCONTINUED:** Please attach SIGNED copy of proceedings (minutes of meeting).
- RECLASSIFIED/REMEASURED:** Please attach SIGNED copy of proceedings (minutes of meeting).
- SCENIC HIGHWAYS:** Please attach a copy of order designating/discontinuing Scenic Highways.

IF THERE ARE NO CHANGES IN MILEAGE: Check box and sign below. [ ]

**PART III - SIGNATURES - PLEASE SIGN.**

Selectmen/ Aldermen/ Trustees Signatures:

*Signature: Brian Shalmei*  
*Signature: Steve [unclear]*

Clerk Signature: Marisa Malby Date Filed: 12.27.05

Please sign ORIGINAL and return it for Transportation signature.

AGENCY OF TRANSPORTATION APPROVAL: Signed copy will be returned to T/C/V Clerk.

APPROVED: \_\_\_\_\_ DATE: \_\_\_\_\_  
Representative, Agency of Transportation



State of Vermont  
Policy & Planning Division-Mapping Unit  
1 National Life Drive, Drawer 33  
Montpelier, VT 05633-5001  
<http://www.aot.state.vt.us>

*Agency of Transportation*

Telephone: 802-828-2600  
Fax: 802-828-2334

March 8, 2006

Chairperson, Board of Selectmen  
Woodbury  
c/o Town Clerk  
PO Box 123  
Woodbury, VT 05681

TO: TOWN CLERK and SELECTBOARD

In early January, the Vermont Agency of Transportation mailed the annual Certificate of Highway Mileage to you for completion and return. To date, your town's certificate has not been received. We use this certificate to confirm highway mileage for the purpose of allocating state aid for town roads. If we do not receive a completed mileage certificate from you by March 17, we will assume there are no changes from last year's certificate and state aid will be based on those mileages.

The completed mileage certificate should be returned to:  
Vermont Agency of Transportation  
Program Development Division - Mapping Unit  
1 National Life Drive, Drawer 33  
Montpelier, VT 05633-5001

Please feel free to contact me with any questions or comments regarding the Mileage Certificates or the process. I can be reached via telephone at (802) 828-2600 or via email at [johnathan.croft@state.vt.us](mailto:johnathan.croft@state.vt.us)

Sincerely,

A handwritten signature in black ink, appearing to read "Johnathan Croft".

Johnathan Croft  
AOT GIS Database Administrator

JFC/sem

Enclosures

cc: Mileage Certificate File



# TOWN OF WOODBURY

P.O. BOX 10

WOODBURY, VERMONT 05681

802-456-7051 email address: towoodbury@adelphia.net fax: 802-456-8834



---

Marcia McGlynn

Town Clerk and Treasurer

June 13, 2005

Mr. Jonathan Craft  
Agency of Transportation  
Drawer 33  
Montpelier, Vermont 05633-5001

Dear Mr. Craft:

The Town of Woodbury requests a correction on 2006 highway certificate regarding class 4 and discontinued sections of Town Highway 39.

Please see the enclosed map.

Thank you.

Sincerely yours,

Woodbury Selectmen

Brian Shames  
[Signature]

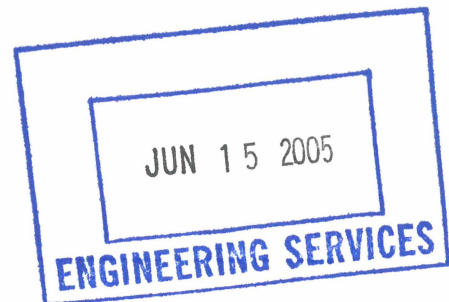

10-42  
9.4 A  
ERIKSON  
Erickson

10-40  
11.1 A  
BECKET  
WHEELER  
POND

118.1 A  
139 A.

FRATT  
D

10-43  
22.2 A  
O'NEILL

10-41  
17.4 A  
WELLS  
Livingston

10-39  
10.1 A  
FROST

TH 39 Cl. 4  
1350' = ~~256~~ Mi.  
0.26

10-37  
~~48.4 A~~ 47.1 A  
GARBECK

10-26  
72 170.6 A  
Motyckia  
(Stuart)

### WOODBURY Taxmap ⑧

Showing discontinued and Cl. 4 portions of Town Highway 39

Class 3

Class 4

Scale 1:5000

Disc. 1987  
1480'  
1200' = 223 Mi.  
3/11/87 Selectmens Hearing

10-25  
2.0 A  
SCHWARTZMANN

10-23  
17.1 A  
CORLISS

10-24  
1.4 A  
PHILLIPS

David Sawyer  
Lister  
6/10/05

Dwl. →  
210' Cl. 3  
0.08 mi

10-27, 10  
5.7 A  
GAYER

TH 39 Cl. 3  
1.210 Mi.  
# (no change)

Submitted by Town with 2005 Mileage Certificate.

ROAD DISCONTINUANCE NOTICE

Pursuant to Title 19, Sections 342a and 531 of the Vermont Statutes Annotated, we, the duly elected and authorized Selectmen for the Town of Woodbury, County of Washington and State of Vermont, hereby give notice that, pursuant to Section 341 of said statutes, said Selectmen have been petitioned in writing to discontinue the following Town Roads, or portions thereof, as public roads, as shown on the revised 1986 Vermont Highway District No. 6 road survey map for the Town of Woodbury:

Town Highway 53 - in its entirety, beginning at its junction with Town Highway 33, thence westerly an estimated distance of .10 miles, to its end point easterly of Town Highway 6, said Highway 53 being bordered on both sides by Carol G. Handy only.

Town Highway 39 - (which is not recognized by the Selectmen as a Town Highway but is being noticed for discontinuance hereunder pursuant to landowner petition rights and to legally clarify the status of said road) - a portion thereof; commencing at a point along the westerly side of said road where dwelling buildings owned by and located on lands of Peter and Lynn Stuart are currently erected; thence northeasterly along the general contour of said road a distance of 1200 feet, or an estimated .23 miles, to a point on said road, which extends to the northerly boundary of the said Stuart land.

Further notice is hereby given that on the 11th day of March, 1987 we shall examine the aforesaid premises through which said roads pass and at 7:00 p.m. of said day at the Town Clerk's office in said Town, shall hear all parties interested on the question of the public necessity or convenience for the discontinuance of said roads, or portions thereof.

DATED at Woodbury this 11 day of <sup>February</sup> ~~January~~, 1987.

Maria K. Peduzzi  
R. J. King  
V. L. P. Smith



## REPORT AND ORDER OF ROAD DISCONTINUANCES

We, the undersigned Selectmen for the Town of Woodbury, County of Washington and State of Vermont, pursuant to 19 VSA Section 344, having conducted a hearing this date, at 7:00 p.m. at the Town Clerk's office in Woodbury, Vermont, after due notice to all parties entitled to be heard thereon, and after hearing and giving due consideration to the statements of all parties who appeared, including a letter request by the Vermont Department of Forest, Parks and Recreation requesting designation of that portion of Town Highway #39 being discontinued to TRAIL status, hereby issue the following report and order concerning the following Town Roads:

**Town Highway 53** - in its entirety, beginning at its junction with Town Highway 33, thence westerly an estimated distance of .10 miles, to its end point easterly of Town Highway 6, said Highway 53 being bordered on both sides by Carol G. Handy only.

**Town Highway 39** - (which is not recognized by the Selectmen as a Town Highway but is being noticed for discontinuance hereunder pursuant to land owner petition rights and to legally clarify the status of said road) - a portion thereof; commencing at a point along the westerly side of said road where dwelling buildings owned by and located on lands of Peter and Lynn Stuart are currently erected; thence northeasterly along the general contour of said road a distance of 1200 feet, or an estimated .23 miles, to a point on said road, which extends to the northerly boundary of said Stuart land.

WHEREAS, we, the said Selectmen:

1. were properly petitioned to discontinue the aforesaid Town Roads, pursuant to 19 VSA Section 341;
2. served proper and timely notice of said petition and a hearing date thereon, pursuant to 19 VSA Section 342a, to all interested parties, by posting copies of said notice in two public places, sending copies of said notice by certified mail to the Woodbury Town Clerk, The Woodbury Planning Commission, the Vermont Board of Recreation, all adjacent land owners, and published a copy of said notice in the Times-Argus, a local paper generally circulating in the area;
3. and, examined said roads and held hearings on the discontinuance thereof in accordance with the provisions of 19 VSA Section 342a and 343.

WHEREFORE, being of the opinion that the discontinuance of the aforesaid roads is in the interest of the public good, necessity and convenience and that no damages have been incurred by any party for said discontinuance, it is hereby ordered that the above described roads, or portions thereof, shall and

are hereby discontinued, with title to all lands encompassed thereby to hereby pass by quitclaim only to the parties bordering the same, pursuant to 19 VSA Section 535.

DATED at Woodbury this 11th day of March, 1987.

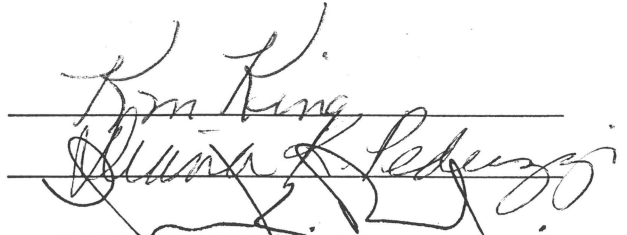
  
\_\_\_\_\_  
\_\_\_\_\_  
Selectmen for Town of Woodbury

Woodbury Town Clerk's Office received the foregoing for record March 11, 1987, at 7:45 p.m.

ATTEST:   
Town Clerk