

District 5

CERTIFICATE OF HIGHWAY MILEAGE

Received

Certcode 1217-0

YEAR ENDING FEBRUARY 10, 2026

1/20/2026

VTrans Mapping Section

Fill out form, make and file a copy with the Town Clerk, and submit the Mileage Certificate on or before February 20, 2026 to: Vermont Agency of Transportation, Division of Policy, Planning and Intermodal Development, Mapping Section via email to: aot.mileagecertificates@vermont.gov or if necessary via mail to: VTrans PPAID - Mapping Section, 219 North Main Street, Barre VT 05641.

We, the members of the legislative body of WARREN in WASHINGTON County on an oath state that the mileage of highways, according to Vermont Statutes Annotated, Title 19, Section 305, added 1985, is as follows:

PART I - CHANGES TOTALS - Please fill in and calculate totals.

Town Highways	Previous Mileage	Added Mileage	Subtracted Mileage	Total	Scenic Highways
Class 1	0.000			0	0.000
Class 2	20.220			20.220	0.000
Class 3	23.94	0.02		23.96	0.000
State Highway	6.348			6.348	0.000
Total	50.508			50.528	0.000
* Class 1 Lane	0.000			0	
* Class 4	6.29			6.29	0.000
* Legal Trail	1.97			1.97	

* Mileage for Class 1 Lane, Class 4, and Legal Trail classifications are NOT included in total.

Initial PD

CL3 added mileage and totals entered by P. DeAndrea, VTrans, per email 1/21/2026

PART II - INFORMATION AND DESCRIPTION OF CHANGES SHOWN ABOVE.

1. **NEW HIGHWAYS:** Please attach Selectmen's "Certificate of Completion and Opening".

2. **DISCONTINUED:** Please attach SIGNED copy of proceedings (minutes of meeting).

3. **RECLASSIFIED/REMEASURED:** Please attach SIGNED copy of proceedings (minutes of meeting).
 +0.02 mi CL3 TH-36 (Fuller Farm Rd) added previously unmapped approach

4. **SCENIC HIGHWAYS:** Please attach a copy of order designating/discontinuing Scenic Highways.

IF THERE ARE NO CHANGES RECORDED THIS YEAR: Place an X in the box and sign below.

Removed "X" for no changes P. DeAndrea, VTrans 1/21/2026

PART III - SIGNATURES - PLEASE SIGN.

Signatures of Selectmen/ Aldermen/ Trustees:

Handwritten signatures of Selectmen/Aldermen/Trustees

Signature of T/C/V Clerk: [Handwritten Signature]

Date Filed: 1/20/2026

Please sign ORIGINAL and return it for Transportation signature.

AGENCY OF TRANSPORTATION APPROVAL: Signed copy will be returned to T/C/V Clerk.

APPROVED:

Johnathan Croft Representative, Agency of Transportation

DATE: 1/21/2026

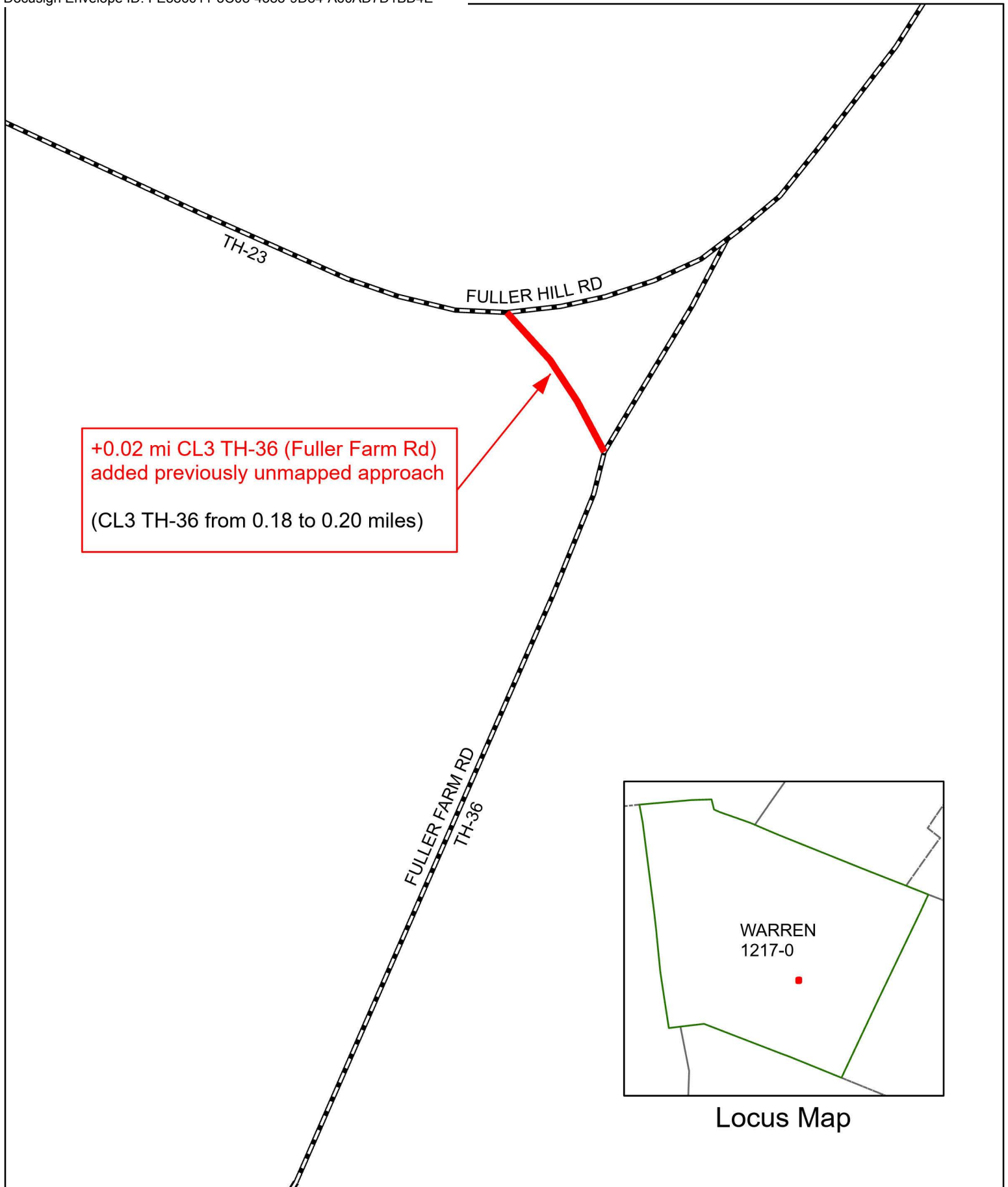

Mileage Certificate Changes 2026

WARREN TH-36

(CTUA:1217-0)
(CERTCODE:1217-0)

Mapping Section
Highway Division
Vermont Agency of Transportation -- December 29, 2025

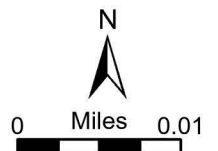

DeAndrea, Pam

From: Rebecca Campbell <rcampbell@warrenvt.org>
Sent: Wednesday, January 21, 2026 10:57 AM
To: AOT - Mileage Certificates
Cc: clerk@warrenvt.org
Subject: Re: WARREN - 2026 Mileage Certificate attached

EXTERNAL SENDER: Do not open attachments or click on links unless you recognize and trust the sender.

I do remember you sending that memo back in November. If you could fill out part I for us that would be great.

Thank you!

On Wed, Jan 21, 2026 at 10:40 AM AOT - Mileage Certificates <AOT.MileageCertificates@vermont.gov> wrote:

Good morning Rebecca,

No need to apologize for sending at night. We get the emails when we are back in the office.

I noticed that you checked the “no changes” box and did not fill out Part 1. We did pre-load a change for a simple addition of an approach on TH-36 (Fuller Farm Rd). See the highlighted text in the image below. We can fill out Part I for you but just want to make sure the Town is aware of this change. I did email back in November (see attached) to alert you of this change.

3. RECLASSIFIED/REMEASURED: Please attach SIGNED copy of proceedings (minutes of meeting).

+0.02 mi CL3 TH-36 (Fuller Farm Rd) added previously unmapped approach

4. SCENIC HIGHWAYS: Please attach a copy of order designating/discontinuing Scenic Highways.

IF THERE ARE NO CHANGES RECORDED THIS YEAR: Place an X in the box and sign below.

PART III - SIGNATURES - PLEASE SIGN. 

Thank you,

Pam

Pamela DeAndrea (she/her) | AOT GIS Professional III

Policy, Planning & Research Bureau / Mapping Section

Policy, Planning & Intermodal Development Division

Vermont Agency of Transportation

219 N. Main Street | Barre, VT 05641

802-793-7555 cell | pam.deandrea@vermont.gov

<https://vtrans.vermont.gov/>

From: Rebecca Campbell <rcampbell@warrenvt.org>

Sent: Tuesday, January 20, 2026 9:43 PM

To: AOT - Mileage Certificates <AOT.MileageCertificates@vermont.gov>

Cc: clerk@warrenvt.org

Subject: Re: WARREN - 2026 Mileage Certificate attached

EXTERNAL SENDER: Do not open attachments or click on links unless you recognize and trust the sender.

Please find attached the Town of Warren's 2026 Highway Mileage Certificate.

I apologize for the late submittal this evening. Our Selectboard signed the document during their meeting tonight, allowing us to submit it by the January 20th deadline.

Rebecca

On Tue, Jan 6, 2026 at 7:24 PM AOT - Mileage Certificates <AOT.MileageCertificates@vermont.gov> wrote:

Greetings from the VTrans Mapping Section,

Please find the 2026 Mileage Certificate for Warren attached to this email.

This Certificate must be completed in order to determine your town's share of state aid for town highways for Fiscal Year 2027, and to ensure that your Town Highway Map remains current. Please note that 19 V.S.A. § 305(c) states that as of 2015, all class 1, 2, 3, and 4 town highways and trails shall appear on the town highway maps.

Any changes in mileage or highway classification, such as additions, alterations, or discontinuances made by your selectboard this past year should be entered on this certificate. If there are changes that occurred before this past year that are not shown on the Town Highway Map, please let us know so we can update the maps.

In filling out the Mileage Certificate, it is important to:

- >> Enter mileage and classification changes on PART I and PART II of the Certificate.
- >> Provide supporting documentation sufficient for the Mapping Section to:
 - Map the change
 - Verify the mileage
 - Demonstrate the change was made according to State statute by providing required documentation
- >> If you have no changes, you may simply check the box in PART II of the Certificate.
- >> The Town Clerk and Selectboard MUST sign PART III of the Certificate.

A Mileage Certificate 'How To' video:

<https://youtube/IQSTsmSYoL4>

Additional resources, including the Cert_Guidelines document and Cert_DocumentationChecklist, are available from the Mileage Certificate page on our website:

<https://vtransmaps.vermont.gov/Maps/Publications/MileageCertificates>

Direct link(s) to the current Warren Town Highway Map(s):

https://maps.vtrans.vermont.gov/Maps/TownMapSeries/Washington_Co/WARREN/WARREN_MILEAGE_2025.pdf

2016 - 2025 archived Mileage Certificates are available from the Mileage Certificate Lookup page of our website:

<https://vtrans.vermont.gov/planning/maps/mileage-certificates/lookup>

To effectively process all the mileage certificates in a timely manner and to assure the completion of the mileage summaries, it is important that towns submit the certificates on time.

Certificates must be postmarked on or before February 20, 2026.

Certificates that are postmarked after February 20, 2026 may not be processed.

After the Agency has approved and signed the certificate, we will send you a copy. Please contact us at aot.mileagecertificates@vermont.gov if have any questions.

Please feel free to reach out to the Mileage Certificate Specialists (Kerry Alley and Pam DeAndrea) if you have any questions or need printed copies of the certificate.

Sincerely,
Kerry Alley

Kerry Alley | GIS Professional III
Policy, Planning & Research Bureau - Mapping Section
Policy, Planning & Intermodal Development Division
Vermont Agency of Transportation
219 North Main Street | Barre, VT 05641
802-917-2621 (cell) | Kerry.Alley@vermont.gov
<https://vtrans.vermont.gov/planning/maps>

--

Rebecca Campbell

Town Administrator

42 Cemetery Road

PO Box 337

Warren, VT 05674

office: 802-496-5240

cell:802-595-2044

www.warrenvt.org

--

Rebecca Campbell
Town Administrator
42 Cemetery Road
PO Box 337
Warren, VT 05674
office: 802-496-5240
cell:802-595-2044
www.warrenvt.org

From: [DeAndrea, Pam](#)
To: [Goss, Reta](#); "[Rebecca Campbell](#)"
Subject: Warren - Update to TH-36 (Fuller Farm Rd)
Date: Tuesday, November 25, 2025 3:30:00 PM
Attachments: [image001.png](#)

Good afternoon,

We wanted to let you know that we have updated our road data for TH-36 (Fuller Farm Rd) to include the approach to TH-23 (Fuller Hill Rd) as highlighted in yellow in the image below. We will update the AOT miles for this road and can preload the 2026 Mileage Certificate before we send it to you in the new year as follows:

+0.02 mi CL3 TH-36 (Fuller Farm Rd) added previously unmapped approach

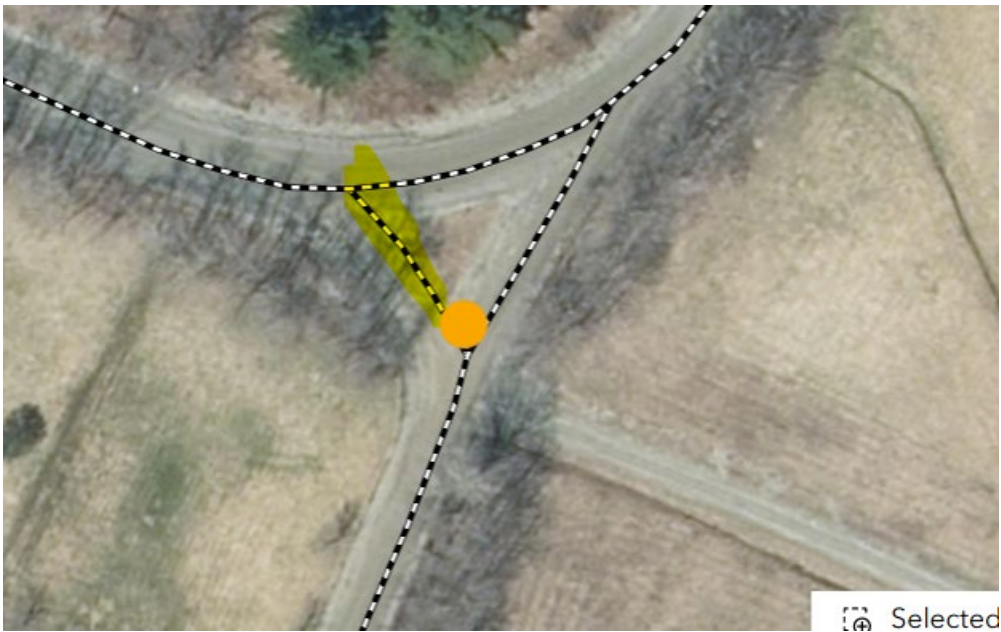

Thank you and let us know if you have any questions,

Pam

Pamela DeAndrea (she/her) | AOT GIS Professional III
Policy, Planning & Research Bureau / Mapping Section
Policy, Planning & Intermodal Development Division
Vermont Agency of Transportation
219 N. Main Street | Barre, VT 05641
802-793-7555 cell | pam.deandrea@vermont.gov
<https://vtrans.vermont.gov/>