

CERTIFICATE OF HIGHWAY MILEAGE

FOR YEAR ENDING FEBRUARY 10, 1960

Village

Fill out in triplicate and file with your Town Clerk on or before February 10, 1960

(Note sections of Vermont Statutes Annotated on reverse side of this sheet)

We, the Trustees of the Town of Orleans, Village of Orleans, do hereby certify that we have carefully measured all the traveled highways in this town and find that the total mileage of traveled highways according to Title 18, V.S.A. Sec. 18, amended 1957, Act No. 88, not including post roads and trails, in this town for the year ending February 10, 1960 is as follows:

	MILEAGE IN TOWN (Outside of village incorporated for highways)			MILEAGE IN VILLAGE (Incorporated for highways)			Total All Highways
	ORLEANS						
	Town Highways	State Aid Highways	State Highways	Town Highways	State Aid Highways	State Highways	
PREVIOUS MILEAGE as shown March 15, 1959				2.94	1.925	0.651	6.516
HIGHWAYS ADDED Since March 15, 1959, ac- cording to statute. Explain under paragraph 1 below.				.04			0.04
SUB-TOTAL				3.02	1.925	0.651	6.556
HIGHWAYS SUBTRACTED Since March 15, 1959. Those becoming untraveled, discon- tinued, legal trails or post roads. Explain under para- graphs 2 and 3 below.				3.90			
TOTAL TRAVELED HIGHWAYS Feb 10, 1960				-3.90	1.925	0.651	6.556

1. We hereby certify that the following new highways, as substantiated by the attached "Informant's Certificate of Completion", have been added since March 15, 1959:

Candler Avenue Extension #2 R108 .04

2. We hereby certify that the following highways have been discontinued, or changed to trails or post roads, according to statute, since March 15, 1959, as substantiated by the attached copy of the proceedings:

3. We hereby certify that the following roads have become untraveled since March 15, 1959:

TRUSTEES
MEMBERS

Alvin M. Clark
Geo. H. Leland
 in the county of Orleans
 1960 personally appeared Geo. H. Leland

At Orleans
 this 5th day of March
 1960 Alvin M. Clark
Trustee Orleans Village
 and made oath to the truth of the foregoing affidavit by me subscribed.
 Before me:

Fredella R. Carl
Notary Public
 (With official seal in County Office)

I, Fredella R. Carl, Notary Public for the State of Vermont, do hereby certify that the foregoing is a true and correct copy of the original as the same appears to Highway Records, filed and recorded at this office.

OF A HIGHWAY FOR PUBLIC TRAVEL

Priscilla A. Carl, Village Clerk of the Incorporated Village
of Orleans, Vermont.

Pursuant to Title 19, V.S.A., Section 15, as amended, this is to certify
that the following described section(s) of highway in the Village
of Orleans, Route Number County Rd. 101-2 was
COMPLETED AND OPEN FOR PUBLIC TRAVEL on August 1st, 1968.

DESCRIPTION OF RIGHT-OF-WAY: Beginning

Description enclosed

and as shown on a Highway Map of the Village of Orleans
dated May 29, 1968, and filed in Book 55 on Page 160 of the
Records of the Town of Barton by the Town
Clerk of said Barton incorporated herein by reference
and attested to on said map by said Town Clerk.

Dated at Orleans, County of Orleans and
State of Vermont, this 5th day of March, A.D. 1969

Allen W. Clark Board

G. J. Ireland of

Selectman
(Alderman)
(Trustee)

(and the Mayor of the City of ✓).

Orleans, Vermont
Mar. 5, 1969.

THE ABOVE IS A TRUE COPY OF DESCRIPTION OF SECTION(S) OF HIGHWAY COMPLETED
AND OPENED FOR PUBLIC TRAVEL, RECORDED IN BOOK 55 ON PAGE 160
OF Barton TOWN RECORDS OF THE Town OF Barton
ON THE 1st DAY OF September, 1968, AT 12:00 O'CLOCK, A. M.

ATTEST: Priscilla A. Carl
Village Clerk of Orleans VERMONT

Incorporated Village of Orleans, Vermont
OFFICE OF TRUSTEES

Chandler Ave. Extension #2

Starting at the westerly corner of lot No. 2 owned by C. Moquin, thence South 43° 55' West 27.70 feet to a pipe, thence South 41° 59' East 100.30 feet to a pipe, thence South 35° 21' East 58.90 feet to a pipe, thence South 48° 01' East 94.06 feet to a pipe, thence North 43° 45' East 143.30 feet to a corner, thence North 58° 20' East 178 feet, more or less, to a point on the line which is an extension of the Daignault lot, thence North 57° 21' West 52.5 feet, more or less, to the southeasterly corner of the Daignault lot, thence North 67° 21' West 9.00 feet to the southeast corner of lot No. 4, thence South 58° 20' West 132.15 feet to a corner, thence South 43° 45' West 100.00 feet to a corner, thence North 47° 40' West 200.00 feet to a corner which is the point of start. Meaning to convey a strip of land for highway purposes, to the Village of Orleans.

Book 55- Page 160 Barton Land Records

210 ft of this in use, balance undeveloped

Accounting, surveys, staked, legal trails or post roads. Explain under paragraphs 2 and 3 below.							
TOTAL TRAVELED HIGHWAYS Feb. 10, 1962			3.94				6.94
			3.86	1.925	0.651		6.436

1. We hereby certify that the following new highways, as substantiated by the attached "Selectman's Certificate of Disposition", have been added since March 15, 1957:

Street #7	0.057	1966 Remasurments not Substantiated in 1966 R.O.W received 1/12/60 1/25/60 Cert. of Comp & Open received 1/25/60
Street #8	0.03	
Chandler Avenue Ext.	0.023	

2. We hereby certify that the following highways have been discontinued, or changed to trails or post roads according to statute, since March 15, 1957, as substantiated by the attached copy of the proceedings:

3. We hereby certify that the following roads have become untraveled since March 15, 1957:

TRUSTEES

*Charles L. Deschamps
 Allen W. Hillyer
 George H. Ireland*

in the town of Orleans

E.S. Alexander,

At Orleans
 the 9th day of January 1962
 A.K. Clark, and G.H. Ireland, Trustees

Witness of the Inc. Village of Orleans, Vt.
 and made oath to the truth of the foregoing affidavit by them subscribed

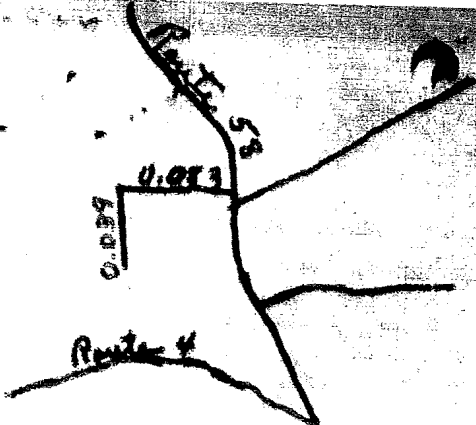

STATE OF HIGHWAY MILEAGE

YEAR ENDING FEBRUARY 10, 1968

MADE AND CLERK on or before February 10, 1968
and Statutes Annotated on reverse side of this sheet

Orleans ... as each state that are being reported ... as the total mileage of reported highways according to Title 24, § 24-20, Stat. Vt., and file, in this town for the year ending February 10, 1968, is as follows:

M IN TOWN		MILEAGE BY VILLAGE			Total M Mileage
1 of Villages		Orleans			
1 for Highways		Orleans			
To Aid Streets	State Highways	Town Highways	State Aid Highways	State Highways	
		3.76	1.925	0.651	6.336
		0.08 0.08 0.02			0.18
		3.86	1.925	0.651	6.436
		3.94			6.516
TOTAL TRAVELED HIGHWAYS Feb. 10, 1968.		3.86	1.925	0.651	6.436

lined, legal trails or post roads. Explain under paragraphs 2 and 3 below.

1. We hereby certify that the following new highways, as substantiated by the attached "Selectman's Certificate of Change" have been added since March 15, 1967:

Street #F 0.05 }
 Street #B 0.03 } 1966 Remasurments not Substantiated in 1961
 Chandler Avenue Ext. 0.025 }
 P.O. received 1/12/68
 1/27/68 Cert. of Comp. & Open. received 1/24/68

2. We hereby certify that the following highways have been discontinued, or changed to trails or post roads according to since March 15, 1967, as substantiated by the attached copy of the proceedings:

3. We hereby certify that the following roads have become untraveled since March 15, 1967:

TRUSTEES

Charles L. ...
Allen ...
George ...

At Orleans
 on 9th day of January, 1968 personally appeared E.S. Alexander,
 A.W. Clark, and G.H. Leland, Trustees
 of the Inc. Village of Orleans, Vt.

CERTIFICATE OF HIGHWAY MILEAGE

FOR YEAR ENDING FEBRUARY 10, 1968

Village

Fill out in triplicate and file with your ~~Town~~ Clerk on or before February 10, 1968

(Note sections of Vermont Statutes Annotated on reverse side of this sheet)

Trustees Village

Orleans

We, the ~~Trustees~~ of the ~~Town~~ of Orleans, on each state that we have carefully examined all the traveled highways in this town and find that the total mileage of traveled highways according to Title 14, V.S.A. Sec. 14, amended 1961, Act No. 26, and including post roads and trails, in this town for the year ending February 10, 1968, is as follows:

	MILEAGE IN TOWN (Excludes of villages incorporated for highways)			MILEAGE ON VILLAGES (Incorporated for highways)			Total All Highways
	ORLEANS						
	Town Highways	State Aid Highways	State Highways	Town Highways	State Aid Highways	State Highways	
PREVIOUS MILEAGE as shown March 15, 1967				3.76	1.925	0.651	6.336
HIGHWAYS ADDED since March 15, 1967, as required by statute. Explain under paragraph 1 below.				0.08 0.08 0.023			0.103
SUB-TOTAL				3.863	1.925	0.651	6.439
HIGHWAYS SUBTRACTED since March 15, 1967. Those becoming untraveled, discor- porated, legal trails or post roads. Explain under para- graphs 2 and 3 below.				3.94			6.516
TOTAL TRAVELED HIGHWAYS Feb. 10, 1968.				3.863	1.925	0.651	6.439

1. We hereby certify that the following new highways, as substantiated by the attached "Selectmen's Certificate of Incorporation", have been added since March 15, 1967:

Street #P	0.05	1966 Re-measurements not substantiated in 1966 P.O. received 11/2/68 Cert. of Comp. & Open. received 1/27/68
Street #R	0.03	
Chandler Avenue Ext.	0.023	

2. We hereby certify that the following highways have been discontinued, or changed to trails or post roads according to statute, since March 15, 1967, as substantiated by the attached copy of the proceedings:

3. We hereby certify that the following roads have become untraveled since March 15, 1967:

TRUSTEES

Ernest L. Desjardins
Allen M. Clark
George H. Ireland
 in the name of Orleans

At Orleans
 the 9th day of January, 1968 personally approved *E.S. Alexander,*
 A.M. Clark, and G.H. Ireland, Trustees

Witness my hand and seal of the Village of Orleans, Vt.
 and under seal to the clerk of the foregoing officials by them authorized.

Notary

Raymond A. Cook
 Notary Public

Village

Notary Public for the State of Vermont, my commission expires on the 10th day of February, 1968.

Raymond A. Cook
 Notary Public



STATE OF VERMONT
DEPARTMENT OF HIGHWAYS
MONTPELIER
VERMONT

Highway Planning Division

January 2, 1968

Board of Trustees
Village of Orleans
Orleans, Vermont 05860

Attention of Chairman

Gentlemen:

In 1966, all the traveled highways in your village were re-measured, resulting in an additional 0.90 mile of Town Highway.

Because the Highway Mileage Certificates for your village were not returned in 1967, the indicated re-measurement changes could not be effected at that time.

We have entered this change on the enclosed 1968 Highway Mileage Certificates for your convenience. We will appreciate your entering any other Town Highway changes processed in accordance with the Statutes during the past year.

Please return the signed Certificates prior to March 15, 1968.

Sincerely yours,

E. J. Nicholls
Highway Planning Engineer

RJM/BBB/sla
Enc.

CERTIFICATE OF COMPLETION AND OPENING

A DESCRIPTION OF A 50 FOOT RIGHT-OF-WAY
ON CHANDLER AVENUE EXTENSION (VILLAGE OF ORLEANS)

Starting at a pipe which may be located as follows: It is 45.9 feet from the east corner of No. 10, 33.0 feet from the south corner of No. 10, 57.1 feet from the west corner of No. 10, and 39.5 feet from the north corner of No. 9, and 23.2 feet from the west corner of No. 9, and 57.1 feet from the south corner of No. 9 Chandler Avenue. Thence S 43° 45' W 121.7 feet to a pipe; said line being the center line of a 50 foot right-of-way.

*Recorded 1/24/68
Book 53
Page 312
Town of Orleans
Vermont*

State of Vermont, this 21st day of January, A.D. 1968.

Edward S. Alexander Board

Robert M. Clark of

Geo. H. Land _____

Mayor of the City of _____

_____ Vermont

_____ 1968

The above is a true copy of description of section(s) of highway, COMPLETED AND OPENED FOR PUBLIC TRAVEL, recorded in Book 53 on Page 312 of 1968 Records of the Town of Orleans of the County of Orleans, 1968, at 11:30 o'clock A.M.

Attest: Franklin A. Carl

Village Clerk of Orleans, Vermont

CERTIFICATE OF COMPLETION AND OPENING
OF A HIGHWAY FOR PUBLIC TRAVEL

Priscilla A. Carl, Village Clerk of the Inc. Village
of Orleans, Vermont

Pursuant to Title 19, V.S.A., Section 15, as amended, this is to certify
that the following described section(s) of highway in the Inc. Village
of Orleans, Vt., Route Number Chandler Ave. Ext., was
COMPLETED AND OPEN FOR PUBLIC TRAVEL, on April 24, 1967.

Description of Right-of-Way: Beginning

Description enclosed

and as shown on a Highway Map of the Inc. Village of Orleans, Vt.,
dated April 15, 1967, and filed in Book 53 on Page 318 of the Land
Records of the Town of Barton by the Town
Clerk of said Town of Barton, incorporated herein by reference
and attested to on said map by said Town Clerk.

Dated at Orleans, County of Orleans, and
State of Vermont, this 9th day of January, A.D. 1968.

Edward A. Alexander Board

Allen M. Clark of

Geo. H. Leard

(3 voters)

Mayor of the City of _____

Orleans, Vermont

January 9, 1968

The above is a true copy of description of section(s) of highway,
COMPLETED AND OPENED FOR PUBLIC TRAVEL, recorded in Book 53 on Page 318
of Barton Land Records of the Town of Barton
on the 24th day of April, 1967, at 3:30 o'clock P.M.

Attest:

Priscilla A. Carl

Village Clerk of Orleans, Vermont

A DESCRIPTION OF STREET NUMBER E

IN THE VILLAGE OF ORLEANS

Starting at an iron pin on the southerly side of Maple Street,
 and S 67° 06' W 43.6 feet from the north corner of house No. 48, and
 S 85° 13' W 45.8 feet from the west corner of house No. 48, and N 77°
 30' W 78.8 feet from the south corner of house No. 48, and is N 13°
 55' E 38.0 feet from the north corner of house No. 34, and N 25°
 40' E 64.0 feet from the west corner of house No. 32. Thence S 46°
 45' E 160.7 feet to an iron pin which is N 13° 10' W 102.0 feet
 from the southwesterly corner of house No. 42, and N 50° 20' W
 72.1 feet from the north corner of house No. 42, and N 51° 15' W
 98.4 feet from the easterly corner of house No. 42. Said pin is
 also on the boundary line parallel to the picket fence. The
 described line is the center line of said right-of-way.

150-118

Recorded 4/23/67
 Book 53
 Page 316
 of Hand Records
 in the Town
 of Orleans

Orleans, Vermont
January 19, 1968

The above is a true copy of description of sectional of highway,
 COMPLETED AND OPENED FOR PUBLIC TRAVEL, recorded in Book 53 on Page 316
 of Hand Records of the Town of Orleans
 on the 16 day of April, 1967, at 2:00 o'clock P.M.

Attest: Priscilla A. Cook
 Village Clerk of Orleans

CERTIFICATE OF COMPLETION AND OPENING
OF A HIGHWAY FOR PUBLIC TRAVEL

Priscilla A. Carl Village Clerk of the Incorporated Village
of Arleans, Vermont

Pursuant to Title 19, V.S.A., Section 15, as amended, this is to certify
that the following described section(s) of highway in the Village
of Arleans, Inc., Route Number Street E, was
COMPLETED AND OPEN FOR PUBLIC TRAVEL, on April 19th, 1967.

Description of Right-of-Way: Beginning

previously sent

and as shown on a Highway Map of the Inc. Village of Arleans
dated April 26, 1967, and filed in Book 53 on Page 316 of the Land
Records of the Town of Barton by the Town
Clerk of said Barton, incorporated herein by refer-
ence and attested to on said map by said said Clerk.

Dated at Arleans, County of Arleans, and
State of Vermont, this 19th day of January, A.D. 1968

Edward L. Newbender Clerk

Allen M. Clark of

George H. Leland Secretary
(Arleans)
(Trustees)

and the Mayor of the City of _____)

Arleans, Vermont
January 19, 1968

The above is a true copy of description of section(s) of highway,
COMPLETED AND OPENED FOR PUBLIC TRAVEL, recorded in Book 53 on Page 316
of the Land Records of the Town of Barton
on the 26 day of April, 1967, at Arleans of Arleans.

Attest: Priscilla A. Carl
Village Clerk of Arleans, Vermont

A DESCRIPTION OF STREET NUMBER F

1966 Reincorporation

IN THE VILLAGE OF ORLEANS

Starting at an iron pin which may be located as follows: It is 12.2 feet from an iron pipe on the northerly side of Maple Street, and it is S 71° 55' W 15.9 feet from a hydrant, and S 5° E 79.4 feet from the west corner of house No. 59, and S 11° 30' W 61.0 feet from the south corner of house No. 59. Thence N 45° W 222.0 feet to an iron pin which is located N 14° 48' E 84.1 feet from the east corner of house No. 45, and N 59° 55' E 50.9 feet from the northeast corner of house No. 49, and is 47.4 feet from the west corner of house No. 53. Said described line being the center line of the street.

(cont.)

and as shown on a Highway Map of the Inc. Village of Orleans dated May 8, 1967, and filed in Book 579 on Page 332 of the Land Records of the Town of Barton by the Town Clerk of said Barton, incorporated herein by reference and attested to on said map by said said Clerk.

Dated at Orleans, County of Orleans, and State of Vermont, this 19th day of January, A.D. 1968.

Edward R. Kephart Board
Allen M. Clark of
George H. Island (Trustee)

the Mayor of the City of _____)

Orleans, Vermont

January 19, 1968

The above is a true copy of description of section(s) of highway, COMPLETED AND OPENED FOR PUBLIC TRAVEL, recorded in Book 579 on Page 332 of the Town Records of the Town of Barton on the 8th day of May, 1967, at 11:00 o'clock A.M.

Attest: Priscilla A. Carl

Village Clerk of Orleans

REC'D
1968
JAN 22
TOWN CLERK
of Barton

CERTIFICATE OF COMPLETION AND OPENING
OF A HIGHWAY FOR PUBLIC TRAVEL.

Priscilla A. Carl, Village Clerk of the Incorporated Village
of Arleans, Vermont

Pursuant to Title 19, V.T.A., Section 15, as amended, this is to certify
that the following described section(s) of highway in the Village
of Arleans Inc., Route Highway Street, was
COMPLETED AND OPEN FOR PUBLIC TRAVEL, on March 9, 1967.

Description of Right-of-Way: Beginning

previously sent

and as shown on a Highway Map of Inc. Village of Arleans
dated March 8, 1967, and filed in Book 513 on Page 332 of the Land
Records of the Town of Barton by the Town
Clerk of said Barton, incorporated herein by reference
and attested to on said map by said said Clerk.

Dated at Arleans, County of Arleans, and
State of Vermont, this 19th day of January, A.D. 1968.

Edward D. Knepper Mayor

Allen M. Clark of

George H. Land (Trustees)

the Mayor of the City of _____)

Arleans, Vermont

January 19, 1968

The above is a true copy of description of section(s) of highway,
COMPLETED AND OPENED FOR PUBLIC TRAVEL, recorded in Book 513 on Page 332
of the Land Records of the Town of Barton
on the 9th day of May, 1967, at 9:00 o'clock A.M.

Attest: Priscilla A. Carl
Village Clerk of Arleans, Vermont



STATE OF VERMONT
DEPARTMENT OF HIGHWAYS
MONTPELIER
05602
Highway Planning Division

January 19, 1968

Board of Trustees
Village of Orleans
Orleans, Vermont 05860

Attention of Chairman

Gentlemen:

We have received the Highway Mileage Certificates which you recently signed and wish to thank you for your cooperation.

We note that you have indicated a desire to add Street "E" and Street "F", totaling .08 mile, to your Town Highway mileage. These two streets were part of the additions you requested during the 1966 remeasurement of all Village Street Highways.

We have checked the copies of the rights-of-way which you submitted and find them in order. However, before incorporating these streets into your Village Mileage, we shall need Certificates of Completion and Opening of the roads to public travel.

For your convenience, there are enclosed two blank Certificates which we will appreciate your completing and returning at your earliest convenience.

Sincerely yours,

R. J. Michelle
Highway Planning Engineer

A handwritten signature in cursive script that reads "James E. Bisson".

By: James E. Bisson
Administrative Assistant

EJW/JKB/sls
Enc.

Received 1/25/68

RUSSELL A. GOLDEN
COMMISSIONER OF HIGHWAYS

CERTIFICATE OF HIGHWAY MILEAGE

File



STATE OF VERMONT
DEPARTMENT OF HIGHWAYS
MONTPELIER VERMONT

Highway Planning Division

April 7, 1967

Board of Trustees
Village of Orleans
Orleans, Vermont

Attention of Chairman

Gentlemen:

Because the signed Highway Mileage Certificates for your village were not returned by March 15, 1967, the town highway remeasurement changes indicated could not be effected at this time.

We have, therefore, reported your highway mileage to the State Treasurer the same as in 1966.

- 1. Town Highways 3.76 miles
- 2. State Aid Highways 1.925 miles
- 3. State Highways 0.651 miles
- 4. Total All Systems 6.336 miles

We have changed our records to agree with these figures and request you do the same.

Very truly yours,

R. J. Nicholls
Highway Planning Engineer

By: James E. Dixon
Administrative Assistant

CERTIFICATE OF HIGHWAY MILEAGE

FOR YEAR ENDING FEBRUARY 15, 1967

Village

Fill out in triplicate and file with your Town Clerk on or before February 15, 1967

(New sections of Vermont Statutes Annotated on reverse side of this sheet)

We, the Town of Oleans, Village of Oleans, do hereby certify that we have carefully measured all the traveled highways in this town and find that the total mileage of traveled highways according to Title 10, V.S.A. Sec. 22, amended 1961, Act No. 24 not including post roads and trails, by the date for the year ending February 15, 1967, is as follows:

	MILEAGE IN TOWN (Mileage of villages incorporated for highways)			MILEAGE IN VILLAGE (Incorporated for highways)			Total All Towns
	Town Highways	State Aid Highways	State Highways	Town Highways	State Aid Highways	State Highways	
PREVIOUS MILEAGE as shown March 15, 1966				1.76	1.915	0.431	4.106
HIGHWAYS ADDED Since March 15, 1966, according to Article 10, Chapter 1 of the Statutes under paragraph 1 below:							
CUSTOMER							
HIGHWAYS DEDUCTED Since March 15, 1966, those becoming unimproved, changed, legal trails or post roads, trails, under paragraph 1 and 2 below.							
TOTAL TRAVELLED HIGHWAYS FEB. 15, 1967							

1. We hereby certify that the following new highways, as substantiated by the attached "Statement of Construction", have been added since March 15, 1966:

No signed Mileage Certificate returned by the State since 1966
figures including TH. Re-measurements

2. We hereby certify that the following highways have been discontinued, or changed to trails or post roads according to statute, since March 15, 1966, as substantiated by the attached copy of the proceedings:

3. We hereby certify that the following roads have become unimproved since March 15, 1966:

TOWNSHIP
INCORPORATED

At _____ in the county of _____
 this _____ day of _____, 1967 personally appeared _____
 Supervisor of _____
 and made oath to the truth of the foregoing and that he is duly authorized by the Board of Selectmen.

(Print official title, as before stated)

These facts should be and following and will not be valid until the same have been filed in the Commission of Highways, Montpelier, Vermont, on or before March 15, 1967.

Check on the Town of _____
 hereby certify that the foregoing is a true and correct copy of the contents of the statement of _____
 submitted to the Commission of Highways, filed and recorded at the office _____

RUSSELL A. HOLDEN
COMMISSIONER OF HIGHWAYS



STATE OF VERMONT
DEPARTMENT OF HIGHWAYS
MONTPELIER

04404
Highway Planning Division

December 15, 1966

Board of Trustees
Village of Orleans
Orleans, Vermont

Attention of Chairman

Gentlemen:

In accordance with Title 19, V.S.A., Section 13, as amended, all the traveled highways in your village were measured in 1966 by Allen W. Clark, Village Manager with Mr. Harvey of this office.

The resulting changes in highway mileage are indicated on the enclosed map and are explained on the attached breakdown sheets.

You will note that the second sheet contains a list of highways for which we will need copies of the Rights of Way and Certificate of Completion and Opening before they can be added to your Village Highway Mileage.

In addition, we shall need a copy of the formal proceedings of discontinuance before we can list as discontinued the section of Cliff Street identified by the letter "B" on the map. However, because this road was previously untraveled, no mileage changes will result.

For your convenience, we have entered the changes in Village Highway Mileage on the enclosed Highway Mileage Certificate and would appreciate your entering any other Village Highway changes processed in accordance with the Statutes this past year.

Very truly yours,

A. J. Nicholls
Highway Planning Engineer

AJN/JEB/dbe
Enc.

CERTIFICATE OF HIGHWAY MILEAGE

FOR YEAR ENDING FEBRUARY 10, 1966

Fill out in triplicate and file with your Town Clerk on or before February 10, 1966

(Note sections of Vermont Statutes Annotated on reverse side of this sheet)

OR 16

We, the Selectmen of the town of Village of Orleans, on oath state that we have carefully measured all the traveled highways in this town and find that the total mileage of traveled highways according to Title 10, V.S.A. Sec. 23, amended 1961, Act No. 28, not including pent roads and trails, in this town for the year ending February 10, 1966, is as follows:

	MILEAGE IN TOWN (Outside of villages incorporated for highways)			MILEAGE IN VILLAGE (Incorporated for highways)			Total All Systems
	Town Highways	State Aid Highways	State Highways	Town Highways	State Aid Highways	State Highways	
Highways Added as shown March 15, 1965				3.76	1.925	0.651	6.336
Highways Added Since March 15, 1965, ac- cording to statute. Explain under paragraph 1 below.							
SUB-TOTAL							
Highways Discontinued Since March 15, 1965. Those becoming untraveled, discon- tinued, legal trails or pent roads. Explain under para- graphs 2 and 3 below.							
TOTAL TRAVELED HIGHWAYS Feb. 10, 1966							

1. We hereby certify that the following new highways, as substantiated by the attached "Selectmen's Certificate of Completion", have been added since March 15, 1965:

2. We hereby certify that the following highways have been discontinued, or changed to trails or pent roads according to statute, since March 15, 1965, as substantiated by the attached copy of the proceedings:

3. We hereby certify that the following roads have become untraveled since March 15, 1965:

SELECTMEN:

At _____ in the county of _____
the _____ day of _____, 1966 personally appeared

Selectmen of _____
and made oath to the truth of the foregoing affidavit by their authorized

Signature and

(Write official title, as Selectmen)

(Town Clerk should fill out following and mail one white and one yellow copy to the Commissioner of Highways, Montpelier, Vermont, on or before March 10th.)

I, _____
do hereby certify that the foregoing is a true and correct copy of the certificate of the selectmen of _____
relating to highway mileage, and was recorded on _____

Highway Planning Division

March 10, 1964

Board of Trustees
Village of Orleans
Vermont

Attention of Chairman

Gentlemen:

Thank you for the prompt submission of the back-up data on Cottage Street.

This is to inform you that your Village Highway Mileage total should now be 3.76 miles and the total of all systems in the Village should be 6.336 miles.

Thank you for your cooperation.

Yours very truly,

H. F. Farrington
Highway Planning Engineer

Evt V. H. Therrien
Administrative Assistant

HFF/VHE/gfe

Incorporated Village of Orleans, Vermont
OFFICE OF TRUSTEES

March 2, 1964

Department of Highways
Highway Planning Division
Montpelier, Vermont
Gentlemen:

The Incorporated Village of Orleans, through its' Trustees, extended Cottage Street in an easterly direction, a distance of 200ft. The land was acquired from Lawrence C. Thompson and Eleanor J. Thompson, and Ida M. Poirier and Gerard Poirier and Edmund MacLeod and Verna MacLeod by warranty deeds as described in the Barton Town land records.

This section of road is completed and open to public travel.

Very truly yours,

Inc. Village of Orleans

BY

George A. Thad
Richard J. Alexander
Allen M. Clark

Trustees of the Inc.
Village of Orleans, Vt.

Highway Planning Division

February 27, 1964

**Board of Trustees
Village of Orleans
Vermont**

Attention of Chairman

Gentlemen:

Thank you for the prompt issuance of your Highway Mileage Certificates.

However, there is one point on which we would like more information.

A notation under item one says that 200 feet had been added to the easterly end of Cottage Street but no mileage entry for this addition was shown in the mileage column at the top of the sheet.

Of course, as you are aware, no mileage can be accepted for an addition of this kind without a Selectmen's Certificate of Completion and Opening to Public Travel.

This certificate is quite simple, consisting of a copy of the description of the addition as it appears in the Village records and incorporating in that description the information on the laying out of

this new section. Then a simple statement by the Trustees that this section has the required Right-of-Way and is complete and open to public travel.

If this information can be forwarded to this office prior to March 15, 1964, the 0.04 mile, for the 200 feet way still be added to your mileage before we make our submission to the Auditor of Accounts very soon after March 15th.

If you have any further questions on this matter, your District Highway Engineer has a copy of this letter and will be glad to assist you.

Yours very truly,

M. F. Farrington
Highway Planning Engineer

By: Vincent H. Therrien
Administrative Assistant

KFF/VFT/ma

CERTIFICATE OF HIGHWAY MILEAGE

FOR YEAR ENDING FEBRUARY 10, 1964

Fill out in triplicate and file with your Town Clerk on or before February 10, 1964

(Note sections of Vermont Statutes Annotated on reverse side of this sheet)

We, the Trustees of the Village of Orleans, on each side that we have carefully measured all the traveled highways in this town and find that the total mileage of traveled highways according to Title 19, V.S.A. Sec. 11, amended 1961, Act No. 28, not including post roads and trails, in this town for the year ending February 10, 1964, is as follows:

	MILEAGE IN TOWN <small>(Outside of village incorporated for highways)</small>			MILEAGE IN VILLAGE <small>(Incorporated for highways)</small>			Total All Systems
	ORLEANS VILLAGE						
	Town Highways	State Aid Highways	State Highways	Town Highways	State Aid Highways	State Highways	
PREVIOUS MILEAGE as shown March 15, 1963				3.72	1.925	0.314	5.969
HIGHWAYS ADDED Since March 15, 1963, according to statute. Explain under paragraph 1 below.				0.04		0.317	6.336
SUB-TOTAL							
HIGHWAYS SUBTRACTED Since March 15, 1963. Those becoming untraveled, discontinued, legal trails or post roads. Explain under paragraphs 2 and 3 below.				CHANGE IN THIS LINE DUE TO CHANGE IN VILLAGE LINE WHERE IT CROSSES BY THE CHANGE IN TOWN LINE ENTERED IN OTHER ACTS. TOTALS SHOWN IN OTHER PARTS OF THIS FORM.			
TOTAL TRAVELED HIGHWAYS Feb. 10, 1964				3.76	1.925	0.651	6.336

1. We hereby certify that the following new highways, as substantiated by the attached "Suburban's Certificate of Completion" have been added since March 15, 1963:

200 ft added to existing road Cottage Street

2. We hereby certify that the following highways have been discontinued, or changed to trails or post roads according to statute, since March 15, 1963, as substantiated by the attached copy of the proceedings:

3. We hereby certify that the following roads have become untraveled since March 15, 1963:

TRUSTEES
HEREBY:

George H. Leland
Edward L. Alexander
Allan M. Clark

in the county of Orleans

George H. Leland

At Orleans this 29th day of January 1964 personally appeared Edward L. Alexander and Allan M. Clark Trustees of Orleans Village of Orleans and made oath to the truth of the foregoing within by them submitted.

Richard A. Carl
Village Clerk

(Town Clerk should fill out following and mail one white and one yellow copy to the Commissioner of Highways, Montpelier, Vermont, on or before March 15th.)

I, Marion G. Redfield, Clerk of the Town of Orleans Village hereby certify that the foregoing is a true copy of record of the contents of the original certificate of highway mileage filed and recorded in this office.



STATE OF VERMONT
DEPARTMENT OF HIGHWAYS
MONTPELIER
ORANGE
Highway Planning Division

January 16, 1964

Board of Trustees
Village of Orleans
Vermont

Attention of Chairman

Gentlemen:

With regard to the completion of the enclosed Highway Mileage Certificates, we wish to call your attention to a change in State Highway mileage in your village.

Due to the change in the Village limits, the State Highway mileage for Route Vt. 58, in Orleans Village, has changed from 0.324 to 0.651 mile, an increase of 0.327 mile. This information was obtained by our field crew this past summer.

We have entered the change in State Highway mileage on the enclosed certificates for your convenience and would appreciate your noting of any change that may have taken place on Village Streets during the past year.

If you have any questions regarding the completion of the enclosed mileage certificates, your District Highway Engineer has a copy of this letter and will be glad to assist you.

Yours very truly,

H. F. Farrington
Highway Planning Engineer

RSF/RSF/mw
Ror 7.

CERTIFICATE OF HIGHWAY MILEAGE

FOR YEAR ENDING FEBRUARY 10, 1963

Fill out in triplicate and file with your Town Clerk on or before February 10, 1963

(Note sections of Vermont Statutes Annotated on reverse side of this sheet)

We, the Selectmen of the Orleans Village of Orleans, do hereby certify that we have carefully measured all the traveled highways in this town and find that the total mileage of traveled highways according to Title 19 V.S.A. Sec. 15, amended 1961, Act No. 28, not including post roads and trails, in this town for the year ending February 10, 1963, is as follows:

	MILEAGE BY TOWN <small>(Sum of all miles measured for highways)</small>			MILEAGE IN VILLAGE <small>(throughout its highways)</small>			Total All Systems
	Town Highways	State Aid Highways	State Highways	Orleans Village			
				Town Highways	State Aid Highways	State Highways	
PREVIOUS MILEAGE as shown March 15, 1962				3.37	1.925	0.324	5.619
HIGHWAYS ADDED Since March 15, 1962, as shown in Material Exhibit under paragraph 1 below.				0.35			
SUB-TOTAL				3.72	1.925	0.324	5.969
HIGHWAYS SUBTRACTED Since March 15, 1962, those becoming untraveled, discon- tinued, legal trails or post roads. Exhibit under para- graphs 2 and 3 below.							
TOTAL TRAVELED HIGHWAYS Feb. 10, 1963				3.72	1.925	0.324	5.969

1. We hereby certify that the following new highways, as substantiated by the attached "Selectmen's Certificate of Completion," have been added since March 15, 1962:

Town highway in Orleans Village known as Water Street
from former village line to north side of Folsom woods.

2. We hereby certify that the following highways have been discontinued, or changed to trails or post roads according to statute, since March 15, 1962, as substantiated by the attached copy of the proceedings:

3. We hereby certify that the following roads have become untraveled since March 15, 1962:

SELECTMEN:

[Handwritten signatures of Selectmen]

At Barren in the county of Orleans
the 10th day of February, 1963 personally appeared G. E. Amis,
E. J. Brown and K. E. Dudley

Members of the Town of Barren, Vermont,
and made oath to the truth of the foregoing affidavits by their subscription.

Before me,

[Signature of Notary Public]
Notary Public
(When called upon, a Notary Public)

(Town Clerk should fill out following and mail one white and one yellow copy to the Commissioner of Highways, Department of Transportation, on or before March 15th)

Barren Clerk of the Town of Barren

and hereby certify that the foregoing is a true copy of record of the proceedings of the Selectmen of Barren in relation to highway mileage, filed and recorded as above.

HIGHWAY DEPARTMENT

OFFICE MEMORANDUM
ORLEANS VILLAGE

ST. MARY

TO: VINCE THERRIEN

FROM: DON HARVEY

DATE: 11/6/63

SUBJECT: CHANGE ON VT-58 DUE TO TOWN LINE CHANGE

① ORLEANS VILLAGE WILL PICK UP TO-327
DUE TO VILLAGE LINE CHANGE ON VT-58.

1962

115-204 100-2-62

HIGHWAYS Feb. 10, 1962

0.527 5.619

1 We hereby certify that the following new highways, as substantiated by the attached "Selectmen's Certificate of Completion," have been added since March 15, 1961:

2 We hereby certify that the following highways have been discontinued, or changed to trails or pent roads according to statute, since March 15, 1961, as substantiated by the attached copy of the proceedings:

3 We hereby certify that the following roads have become untraveled since March 15, 1961:

SELECTMEN:

[Handwritten signatures]

At _____
the _____ day of _____
1962, _____

in the county of Orleans
, 1962 personally appeared _____

Selectmen of the Town of Bartons
in the presence of the undersigned and by them subscribed

CERTIFICATE OF HIGHWAY MILEAGE

FOR YEAR ENDING FEBRUARY 10, 1967

Fill out in triplicate and file with your Town Clerk on or before February 10, 1967

(Note sections of Vermont Statutes Annotated on reverse side of this sheet)

We, the Selectmen of the Village of Orleans, do hereby certify that we have carefully measured all the traveled highways in this town and find that the total mileage of traveled highways according to Title 19 V.S.A. Sec. 12, as amended 1961, Act No. 22, and including post roads and trails, in this town for the year ending February 10, 1967, is as follows:

	MILEAGE IN TOWN <small>(Sum of miles measured for highways)</small>			MILEAGE IN VILLAGE <small>(Measured for highways)</small>			Total All Systems
	Town Highways	State Aid Highways	State Highways	Orleans			
				Town Highways	State Aid Highways	State Highways	
PREVIOUS MILEAGE as shown March 15, 1961				3.37	1,925	0.324	5,619
HIGHWAYS ADDED Since March 15, 1961, ac- cording to statute. Explain under paragraph 1 below							
SUB-TOTAL							
HIGHWAYS SUBTRACTED Since March 15, 1961. Those becoming untraveled dis- continued, legal trails or post roads. Explain under paragraphs 2 and 3 below							
TOTAL TRAVELED HIGHWAYS Feb. 10, 1967				3.37	1,925	0.324	5,619

1. We hereby certify that the following new highways, as substantiated by the attached "Selectmen's Certificate of Completion," have been added since March 15, 1961:

2. We hereby certify that the following highways have been discontinued, or changed to trails or post roads according to statute, since March 15, 1961, as substantiated by the attached copy of the proceedings:

3. We hereby certify that the following roads have become untraveled since March 15, 1961:

SELECTSMEN

[Handwritten signatures of Selectmen]

At Town of Orleans in the county of Orleans
 this 10 day of February, 1967 personally appeared H. B. Gentry
S. M. Brown & G. R. Amis
 Selectmen of the Town of Orleans
 and subscribe and to the truth of the foregoing affidavit by them subscribed.

Before me,

[Handwritten signature of Notary Public]
 Notary Public

Town Clerk should fill out following and send one white and one yellow copy to the Commissioner of Highways, Montpelier, Vermont, on or before March 15th.

1. S. M. Brown Clerk of the Town of Orleans
 before sending this to the Commissioner is a true copy of record of the proceedings of the Selectmen of the Town of Orleans relating to highway mileage. Filed and recorded in this office.

[Handwritten signature]
 Notary Public

WILLIAM POEYER
COMMISSIONER OF HIGHWAYS

REPUBLIC OF VERMONT
DIVISION OF STATE AID HIGHWAYS



STATE OF VERMONT
DEPARTMENT OF HIGHWAYS
MONTPELIER
Highway Planning Division

January 15, 1962

Donald R. Gray, Chairman
Board of Trustees
Orleans Village, Vermont

Dear Sir:

We are enclosing for your records a copy of the state-aid reselection certificate for the Village of Orleans, as approved by the Commissioner of Highways on December 29, 1961.

This is in connection with the 10-Year Reselection of State-Aid Highways. There has been no change in mileage.

Very truly yours,

H. F. Farrington
Highway Planning Engineer

HFF/VHT/mm

Brownington hamlet.

ending at northerly village line.

No. 4 0.27 miles

Beginning at intersection of Route 30 on Main Street

extending (Over direction) southerly along Barton Road

ending at southerly village line.

No. 5 miles

Beginning at

extending (Over direction)

SECTION OF STATE AID HIGHWAY

file

Town of Village of Orleans

County of Orleans

Vl. Hwy. Dist. No 12

Total S.A. Mileage 1.925

COPY

Important town highways as required by Title 19, V.S.A., Sections 1 & 13:

No. 1 0.763 miles

Beginning at Orleans Village on Route 58 at Chandler Avenue

extending (Give direction) easterly through Orleans Village along Route 58

ending at intersection of School Street, being SACL on Route 58

No. 2 0.510 miles

Beginning at the center of Orleans Village at the intersection of Route 58

extending (Give direction) northerly along Maple Street

ending at northerly village line.

No. 3 0.278 miles

Beginning at S. A. #1 on Willoughby Ave., Route 58

extending (Give direction) northeasterly along East Street, the road to Brownington hamlet.

ending at northerly village line.

No. 4 0.274 miles

Beginning at intersection of Route 58 on Main Street

extending (Give direction) southerly along Barton Road

ending at southerly village line.

No. 5 miles

Beginning at

extending (Give direction)

ending at

No. 6 miles

Beginning at

extending (Give direction)

ending at

No. 7 miles

beginning at

extending (Give direction)

ending at

No. 8 miles

beginning at

extending (Give direction)

ending at

No. 9 miles

beginning at

extending (Give direction)

ending at

No. 10 miles

beginning at

extending (Give direction)

ending at

No. 11 miles

beginning at

extending (Give direction)

ending at

We have this 2nd day of November 1911 made the above selection which is to supersede and replace any and all selections made prior to this time.

S/ Donald A. Gray	}	Trustees
S/ Allen H. Clark		of the
S/ George H. Island		Village of
		Delaware

Approved:

Director Highway Department

Dec 1st 1911

September 24, 1957

Joseph L. Boulanger, Chairman
Board of Trustees
Village of Orleans
Vermont

Dear Sir:

Attached is a map signed by the Commissioner showing the section of highway which has been transferred from the State Aid system to the State Highway system, together with an extra copy of the revised map for use by the Village.

The map signed by the Commissioner should be filed and recorded in your Village records.

This is in accordance with Section 14 of Act 250 of 1957 which requires that, "When an addition or deletion is made to State Aid highways, the board shall make maps showing the highways which are added and/or deleted, and file a copy thereof in the office of the Secretary of State. It shall also file a copy of the map of such highways in the office of the clerk of the town wherein said highways lie. When such maps are so filed, the redesignation of such highways shall be deemed to have taken place."

When the maps have been filed, would you please fill out and sign the enclosed form, and return to us for our records.

Very truly yours,

H. F. Farrington, Mgr.
Highway Planning Bureau

OFF:abj

cc: A. A. Dow

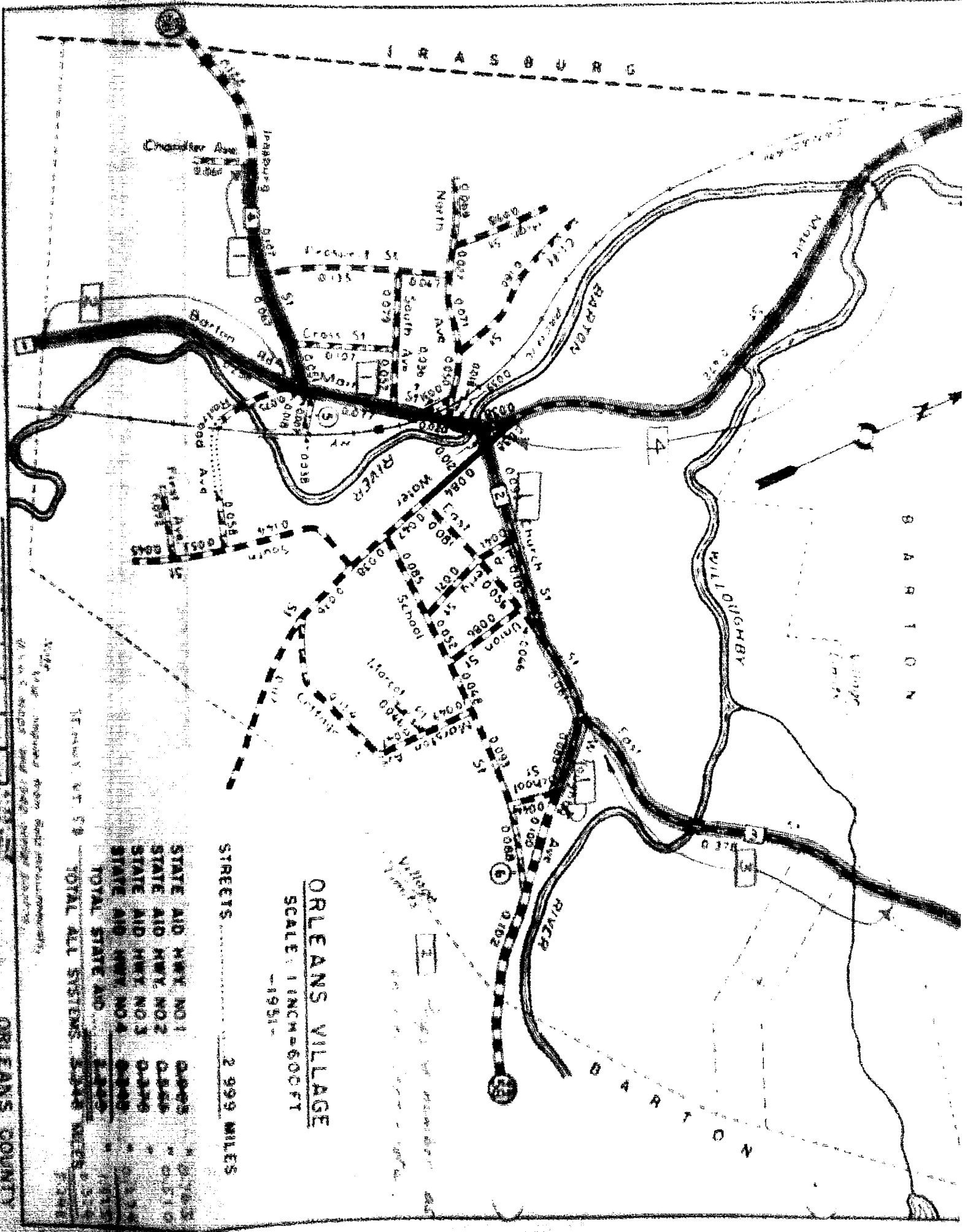

ORLEANS VILLAGE

SCALE: 1 INCH=600 FT

-1951-

STREETS 2.999 MILES

STATE AID HWY NO. 1	0.0000
STATE AID HWY NO. 2	0.0000
STATE AID HWY NO. 3	0.0000
STATE AID HWY NO. 4	0.0000
TOTAL STATE AID	0.0000

TOTAL ALL SYSTEMS 2.999 MILES

ORLEANS COUNTY

Notes: 1. All measurements from State headquarters.
2. All measurements from State headquarters.

HIGHWAY DEPARTMENT

OFFICE MEMORANDUM

TO: H. E. Sargent, Chief Engineer
FROM: H. F. Farrington, Mgr., Highway Planning Survey
DATE: September 20, 1957
SUBJECT:

Attached herewith for the Commissioner's signature are maps of Orleans Village for filing with Secretary of State, Village of Orleans, and Central Files. Shows thereon are sections deleted from State Aid Highway and sections added to State Highway System.

The resolution showing this change was signed by the Commissioner on September 17, 1957.

HD-200 ISN-0-50

We are enclosing for your review a copy of the State Aid highways in the Village of Orleans as approved by the Commissioner of Highways on September 17, 1957.

Very truly yours,

H. F. Farrington, Mgr.
Highway Planning Survey

HFF:hl

cc: A. A. Doe

STATE OF VERMONT

Department of Highways

100 North Main Street, Montpelier, Vermont 05602

September 18, 1957

Enclosed for the Board of Trustees of the Village of Orleans is a copy of the selection of State Aid highways in the Village of Orleans as approved by the Commissioner of Highways on September 17, 1957.

Joseph L. Boulanger
Chairman, Board of Trustees
Village of Orleans
Vermont

Dear Sir:

We are enclosing for your records a copy of the selection of State Aid highways in the Village of Orleans as approved by the Commissioner of Highways on September 17, 1957.

Very truly yours,

H. F. Farrington, Mgr.
Highway Planning Survey

HFF:tbl

cc: A. A. Don

HIGHWAY DEPARTMENT

OFFICE MEMORANDUM

TO: H. E. Sargent, Chief Engineer
FROM: H. F. Farrington, Mgr., Highway Planning Survey
DATE: September 16, 1957
SUBJECT:

Attached herewith for Mr. Foster's signature are State Aid Selection Certificates for Orleans Village, reflecting the change in state aid mileage as a result of the addition of S.A.#1 (from Irasburg Town Line to Chandler Ave.) and S.A.#2 (from School Street to the Barton Town Line) to the State Highway System.

W B 194 75M-2-44

ending at Northerly Village Line.

No. 3 0.378 miles.

Beginning at S. A. #1 on Willoughby Ave., Route 58

extending (Give direction) northeasterly along East Street, the road to Brownington hamlet.

ending at northerly village line.

No. 4 0.274 miles.

Beginning at Intersection of Route 58 on Main Street.

extending (Give direction) southerly along Barton Road.

ending at southerly Village Line.

No. 5 miles.

Beginning at

extending (Give direction)

SELECTION OF STATE AID HIGHWAYS

Village of

Orleans

County of Orleans

Village Dist. No. 12

Total S. A. Mileage 1.295

Important town highways as required by Sections 4903, 4918 and 4921 of the Vermont Statutes, Revision of 1947:

No. 1 0.763 miles.

Beginning at Orleans Village on Route 58 at Chandler Avenue

extending (Give direction) easterly through Orleans Village along Route 58

ending at intersection of School Street being SACL on Route 58

No. 2 0.510 miles.

Beginning at the center of Orleans Village at the intersection of Route 58

extending (Give direction) northerly along the Barton River Road.

ending at Northerly Village Line.

No. 3 0.378 miles.

Beginning at S. A. #1 on Willoughby Ave., Route 58

extending (Give direction) northeasterly along East Street, the road to Brownington hamlet.

ending at northerly village line.

No. 4 0.274 miles.

Beginning at intersection of Route 58 on Main Street

extending (Give direction) southerly along Barton Road

ending at southerly Village Line.

No. 5 miles.

Beginning at

extending (Give direction)

ending at

No. 6 miles.

Beginning at

extending (Give direction)

ending at

No. 7 _____ miles.

Beginning at _____

extending (Give direction) _____

ending at _____

No. 8 _____ miles.

Beginning at _____

extending (Give direction) _____

ending at _____

No. 9 _____ miles.

Beginning at _____

extending (Give direction) _____

ending at _____

We have this _____ day of _____, 19____, made the above

selection which is to supersede and replace any and all selections made prior to this time.

Road Commissioner

Donald R. Gray
Allen W. Clark

Justices
of the
Town of

Village of Pelham, N.C.

Approved:

_____, 1957

W. A. Goe
District Engineer

STATE HIGHWAY BOARD

Mona O. A. ...
Commissioner of Highways

RECEIVED
OCT 18 1957
STATE HIGHWAY DEPARTMENT



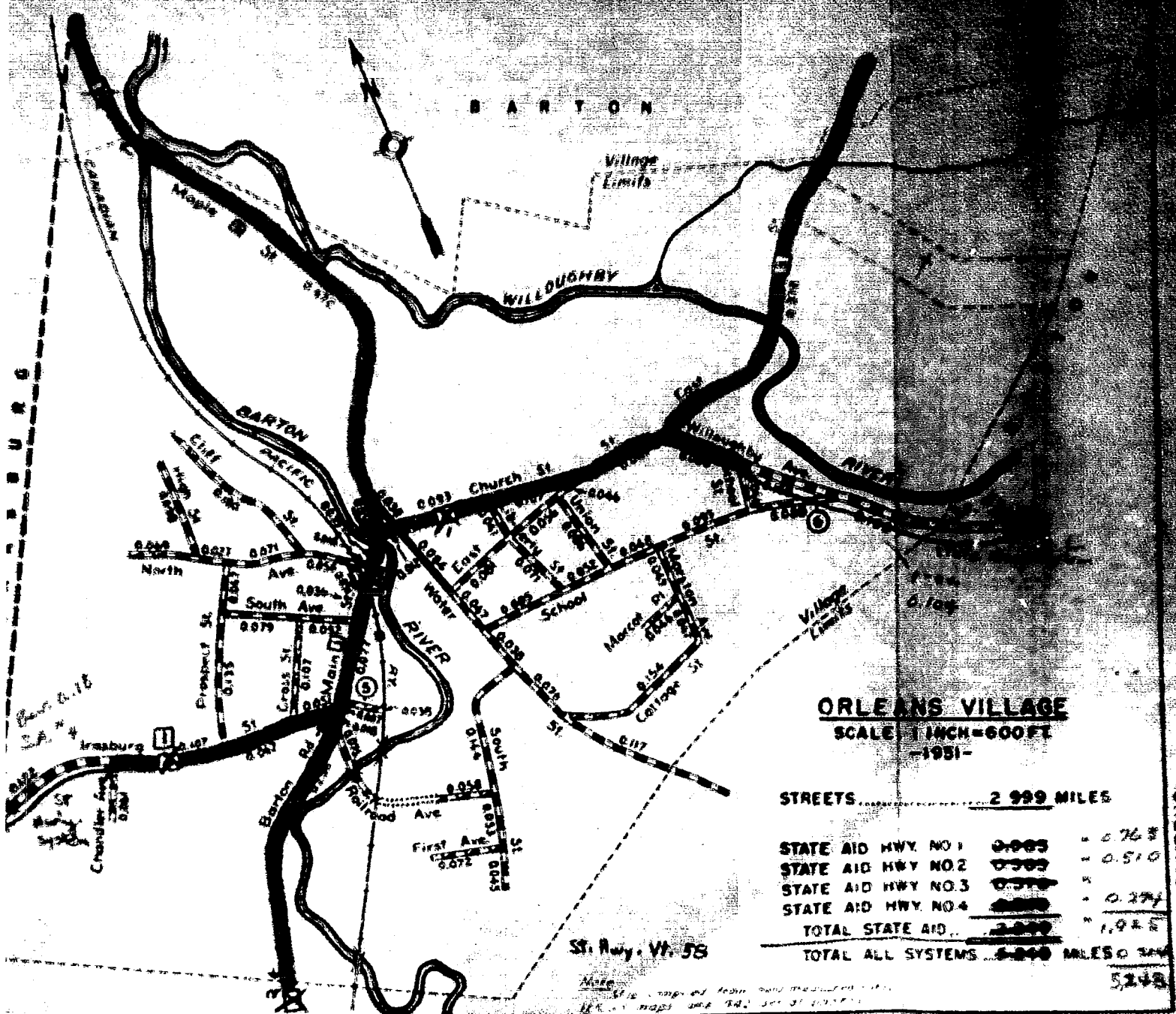

BARTON

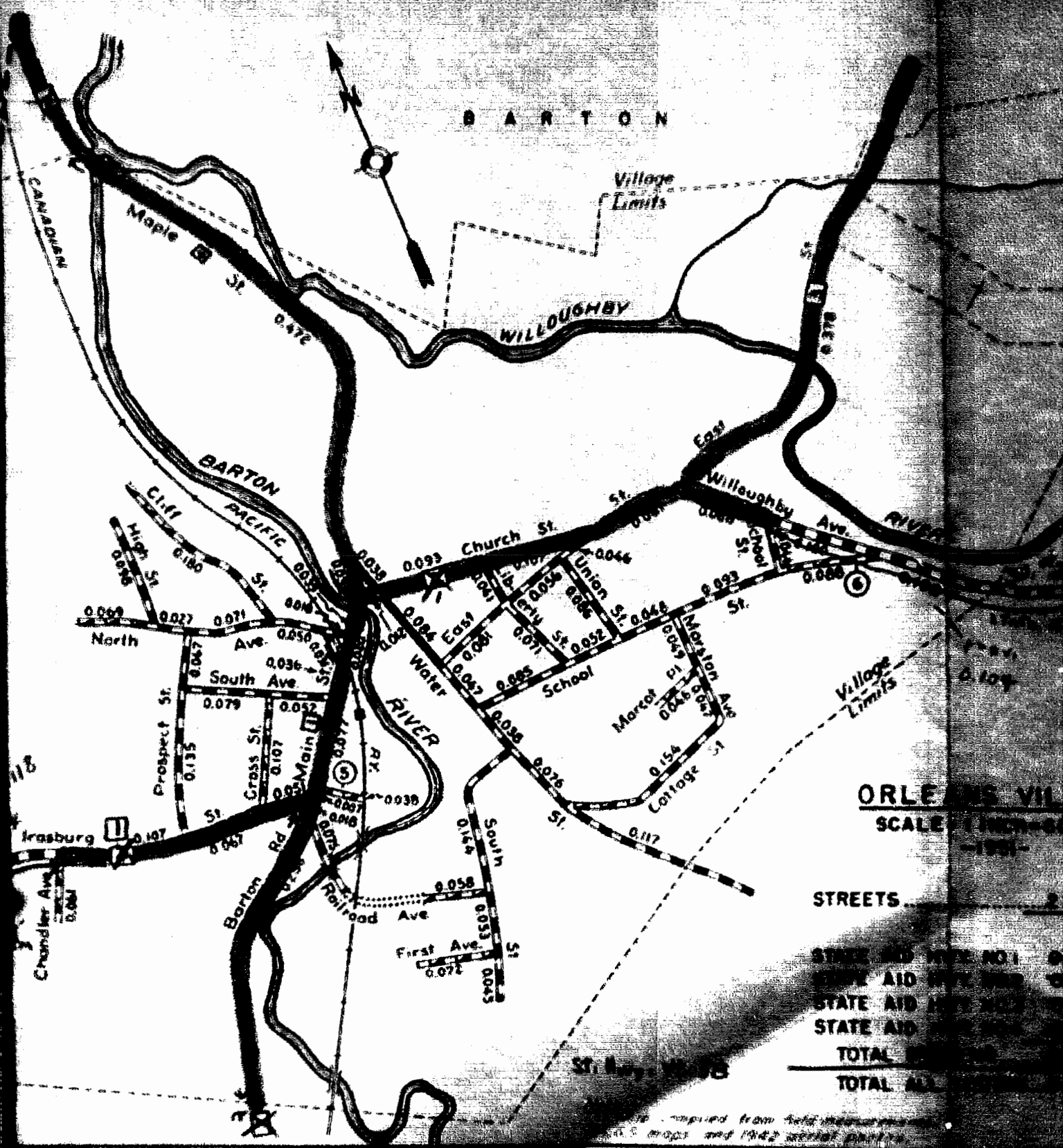

ORLEANS VII

SCALE 1 INCH = 1 MILE

STREETS	STATE AID	TOTAL
STREET AID	NO. 1	
STATE AID	NO. 2	
STATE AID	NO. 3	
STATE AID	NO. 4	
TOTAL		
TOTAL ALL		

Map compiled from field measurements and 1942 aerial photos.

HIGHWAY DISTRICT NO. 12

BARTON

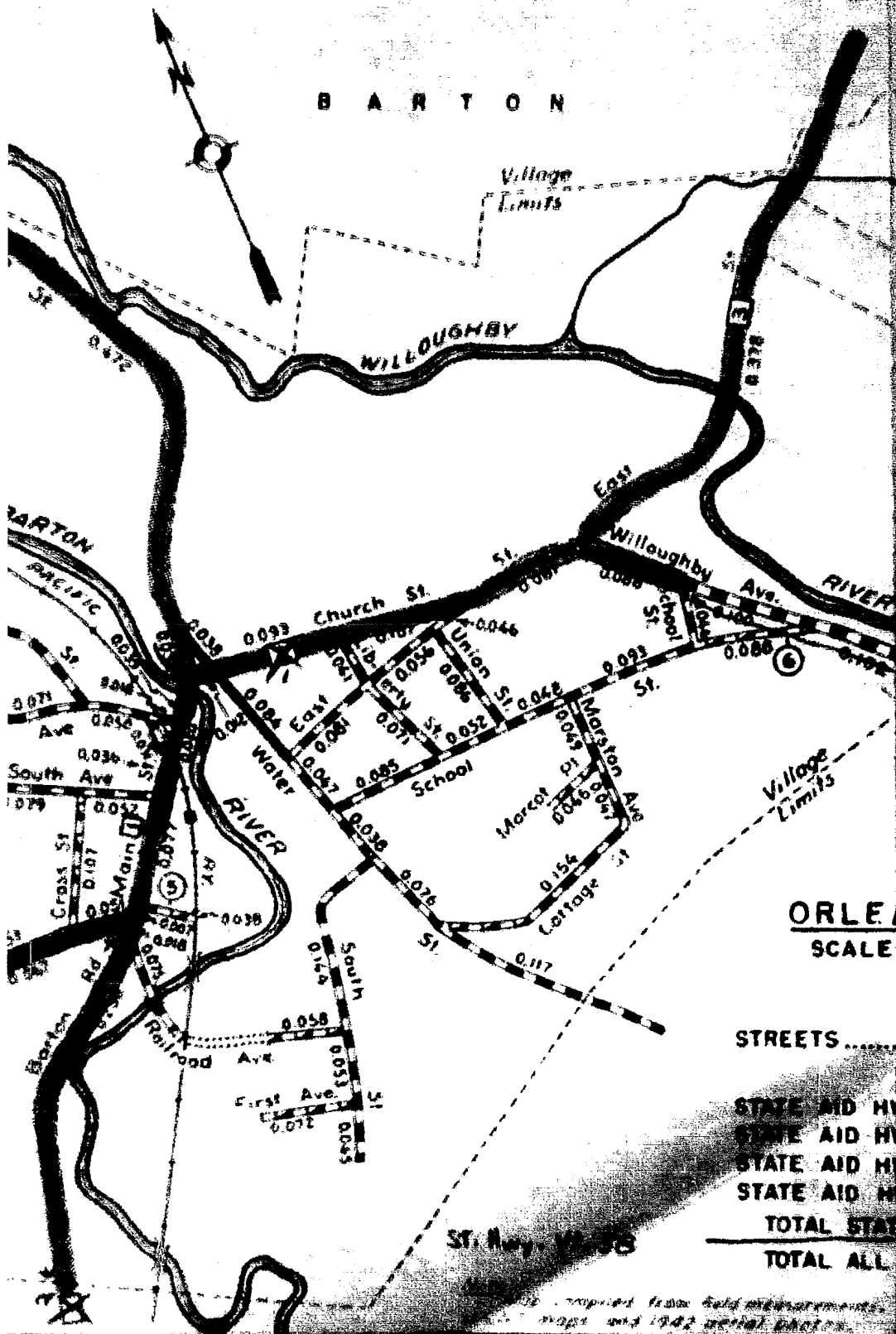

ORLEANS VILLAGE

SCALE 1 INCH=600 FEET
-1951-

STREETS 2.999 Miles

STATE AID HWY NO. 1 0.000

STATE AID HWY NO. 2 0.000

STATE AID HWY NO. 3 0.000

STATE AID HWY NO. 4 0.000

TOTAL STATE AID 0.000

TOTAL ALL OTHERS 0.000

ST. Hwy. 1958

*Map prepared from field measurements
using 1942 aerial photos.*

Highway Planning Survey

August 26, 1971

A. A. Doe, District Highway Engineer
Newport
Vermont

Dear Sir:

Regarding your letter of July 22 about the Orleans Village State Aid roads, we submit the following explanation of the mileage:

Much of the confusion is due to re-description of the state aid roads to what we intended to be a more logical order following Route 58 becoming State Highway.

Please refer to the attached map, which shows the former State Aid numbers as well as the new ones which are marked in red.

New State Aid No. 1, which begins at Chandler Avenue and extends easterly along Irasburg Street and Willoughby Avenue, was formerly a combination of S.A. No. 4, S.A. No. 1 and S.A. No. 2.

New State Aid No. 2, which is Barton Road, was formerly a section of S.A. No. 1.

New State Aid No. 3, which is East Street beyond Willoughby Avenue, is the same as before.

New State Aid No. 4, which is Maple Street to the village line, was formerly a section of S.A. No. 1.

The overall difference in mileage is actually 0.324 miles, and is due to the fact that Irasburg Street (from Chandler Ave. to Irasburg Town Line) and Willoughby Ave. (School Street to the Barton Town Line), have become part of the State Highway System.

We trust that the above information will help to explain the apparent differences in mileage.

Very truly yours,

E. F. Farrington, Mgr.
Highway Planning Survey



STATE OF VERMONT
DEPARTMENT OF HIGHWAYS
ALTON A. DOE
DISTRICT ENGINEER
NEWPORT

July 22, 1957

H. F. Farrington, Manager
Highway Planning Survey
Montpelier, Vermont

Dear Sir:

The new Selection of State Aid highways in the Village of Orleans has not been signed as yet due to the fact that we cannot reconcile the differences.

On State Aid #1 the former mileage was 0.965 and the new figure is 0.763. As this is on Route 58 we can understand this change.

On State #2 you give a mileage of 0.510. The old mileage was 0.565. Number 3 is O.K. On #4 the old mileage was 0.343 and you have 0.274. You give a total mileage now of 1.925, where the old mileage was 2.249. Deducting 0.2 for Route 58 the correct mileage should be 2.049.

This figure of 2.249 has been used for many years and the Village authorities claim they have made no reduction on routes 2 and 4.

Very truly yours

A. A. Doe
A. A. Doe
District Engineer

AAD:1