

District 9

CERTIFICATE OF HIGHWAY MILEAGE

3/4/2026

Certcode 1015-0

YEAR ENDING FEBRUARY 10, 2026

VTrans Mapping Section

Fill out form, make and file a copy with the Town Clerk, and submit the Mileage Certificate on or before February 20, 2026 to: Vermont Agency of Transportation, Division of Policy, Planning and Intermodal Development, Mapping Section via email to: aot.mileagecertificates@vermont.gov or if necessary via mail to: VTrans PPAID - Mapping Section, 219 North Main Street, Barre VT 05641.

We, the members of the legislative body of NEWPORT CITY in ORLEANS County on an oath state that the mileage of highways, according to Vermont Statutes Annotated, Title 19, Section 305, added 1985, is as follows:

PART I - CHANGES TOTALS - Please fill in and calculate totals.

Table with 6 columns: Town Highways, Previous Mileage, Added Mileage, Subtracted Mileage, Total, Scenic Highways. Rows include Class 1, Class 2, Class 3, State Highway, Total, Class 1 Lane, Class 4, and Legal Trail.

* Mileage for Class 1 Lane, Class 4, and Legal Trail classifications are NOT included in total.

PART II - INFORMATION AND DESCRIPTION OF CHANGES SHOWN ABOVE.

1. NEW HIGHWAYS: Please attach Selectmen's "Certificate of Completion and Opening"

Class 4/NUTS mileage total adjusted and "No Changes" box unchecked by K.Alley (VTrans) as per attached email dated 4/3/2026

2. DISCONTINUED: Please attach SIGNED copy of proceedings (minutes of meeting).

Handwritten signature with DS stamp

3. RECLASSIFIED/REMEASURED: Please attach SIGNED copy of proceedings (minutes of meeting).

Handwritten notes: .02 mi CL3 TH-150 (Industrial Dr.) designated not up to standard (NUTS); .078 mi CL2 TH-11 (Railroad Sq.) previously unmapped - remeasured

4. SCENIC HIGHWAYS: Please attach a copy of order designating/discontinuing Scenic Highways.

IF THERE ARE NO CHANGES RECORDED THIS YEAR: Place an X in the box and sign below.



PART III - SIGNATURES - PLEASE SIGN.

Signatures of Selectmen/ Aldermen/ Trustees:

Handwritten signatures of town officials

Signature of T/CV Clerk: James Johnson

Date Filed: 3/2/2026

Please sign ORIGINAL and return it for Transportation signature.

AGENCY OF TRANSPORTATION APPROVAL: Signed copy will be returned to T/CV Clerk.

APPROVED: Representative, Agency of Transportation

DATE: 4/14/2026

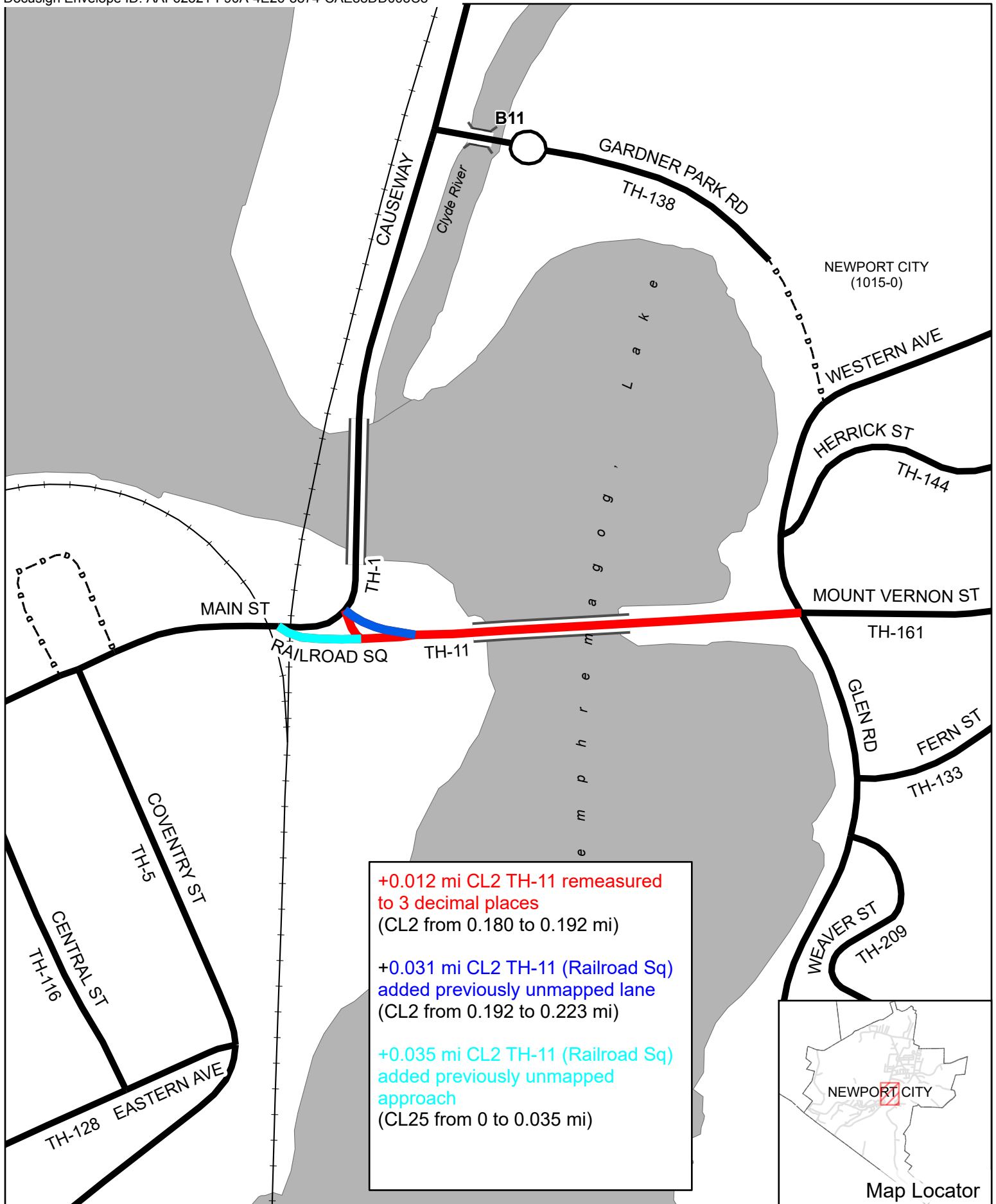

**Mileage Certificate Changes 2026
NEWPORT CITY**

(CTUA:1015-0)
(CERTCODE:1015-0)

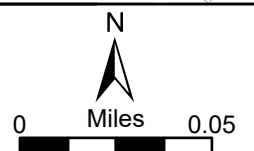

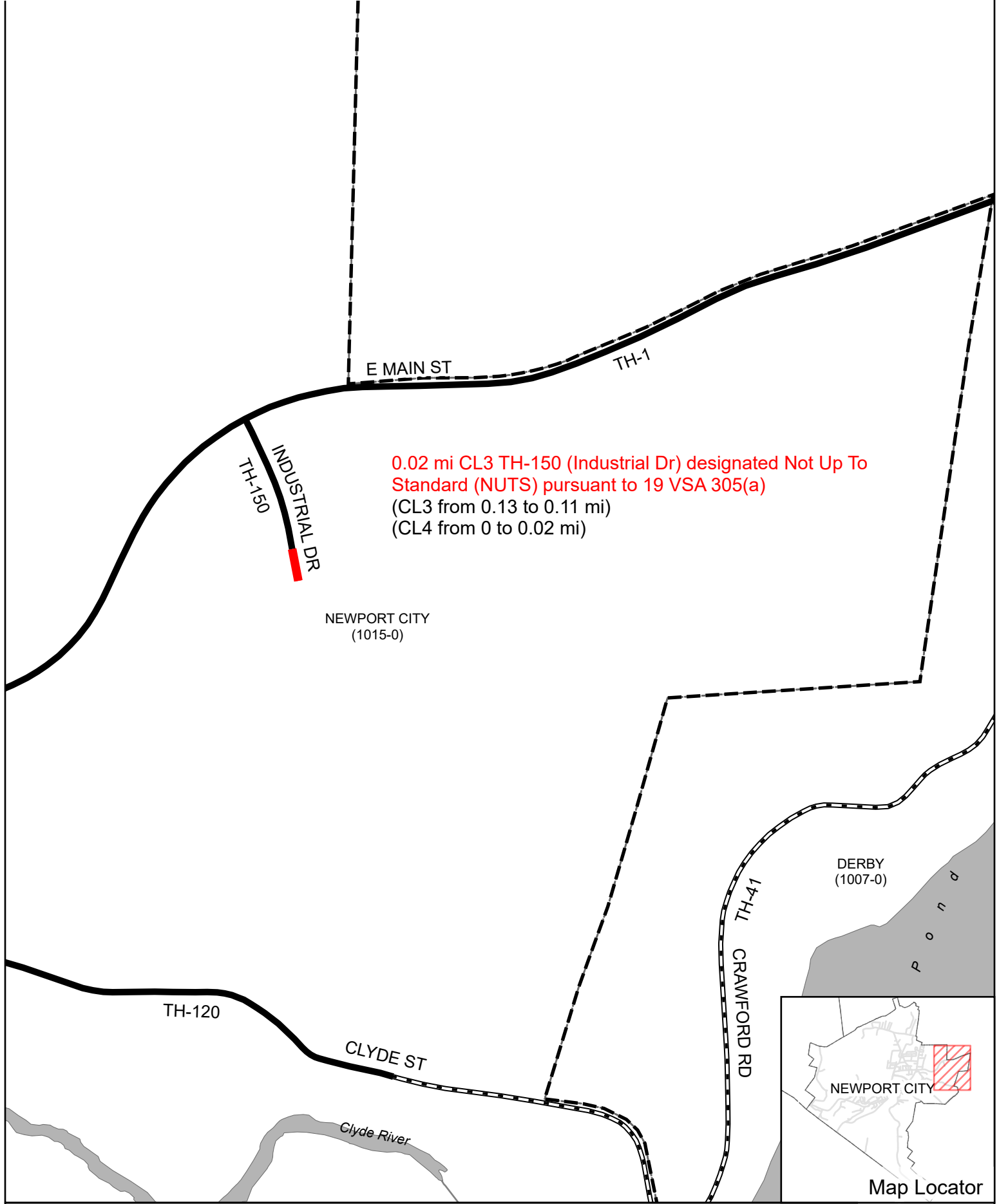

0.02 mi CL3 TH-150 (Industrial Dr) designated Not Up To Standard (NUTS) pursuant to 19 VSA 305(a)
 (CL3 from 0.13 to 0.11 mi)
 (CL4 from 0 to 0.02 mi)

NEWPORT CITY
 (1015-0)

DERBY
 (1007-0)

NEWPORT CITY

Map Locator

Mileage Certificate Changes 2026
NEWPORT CITY

(CTUA:1015-0)
 (CERTCODE:1015-0)

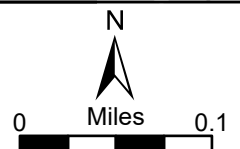

Alley, Kerry

From: Alley, Kerry
Sent: Friday, April 3, 2026 5:09 PM
To: 'Thomas Bernier'
Subject: RE: Industrial Drive

Hi Thomas,

I just realized that the NUTS designation of 0.02 mi of TH-15 is only partially reflected in Part I of the Certificate. The designation essentially involves moving 0.02 mi from the class 3 mileage total to the class 4 mileage total, so wrote the addition of 0.02 mi class 4 in Part I of the Certificate. I also unchecked the "No Changes" box at the bottom because there are changes written on this Certificate, and wrote an explanatory note on the Certificate referring to this correspondence. I've provided a screen capture of Certificate with the adjustments highlighted below.

Let me know if you have any questions or concerns,

Kerry

District 9
 Certificate 1025-0

Received
3/4/2026

CERTIFICATE OF HIGHWAY MILEAGE
 YEAR ENDING FEBRUARY 16, 2026

Fill out form, make and file a copy with the Town Clerk, and submit the Mileage Certificate on or before February 28, 2026 to: Vermont Agency of Transportation, Division of Policy, Planning and Intermodal Development, Mapping Section via email to: am.mileagecert@dot.vermont.gov or if necessary via mail to: VTroad PP&D - Mapping Section, 219 North Main Street, Room 17 #1641.

We, the members of the legislative body of NEWPORT CITY in ORLEANS County on an oath state that the mileage of highways, according to Vermont Statutes Annotated, Title 19, Section 785, added 2985, is as follows:

Class	Previous Mileage	Added Mileage	Subtracted Mileage	Total Mileage	Service Highway
Class 1	6.637			6.637	0.800
Class 2	7.820	0.028		7.998	0.800
Class 3	21.87		0.02	21.65	0.800
State Highway	5.352			1,705.22	0.800
Total	37.879			37,637	0.800

** Class 1 Lane 0.280
 ** Class 4 0.02
 ** Legal Trail 0.00

* Mileage for Class 1 Lane, Class 4, and Legal Trail classifications are NOT included in total.

PART II - INFORMATION AND DESCRIPTION OF CHANGES SHOWN ABOVE:

- NEW HIGHWAYS:** Please attach Selection's "Certificate of Completion and Opening"
- DISCONTINUED:** Please attach SIGNED copy of proceedings (minutes of meetings)
- RECLASSIFIED/REMEASURED:** Please attach SIGNED copy of proceedings (minutes of meetings)
 0.02 mi CL3 TH-15 (Industrial Dr) original set up to Single-lane (2025)
 0.028 mi CL2 TH-11 (Railroad St) previously categorized - Remasured
- SCENIC HIGHWAYS:** Please attach a copy of order designating/reclassifying Scenic Highways.

IF THERE ARE NO CHANGES RECORDED THIS YEAR: Place an X in the box and sign below.

PART III - SIGNATURES - PLEASE SIGN

Signatures of Selectmen/ Aldermen/ Trustees: *[Signatures]*

Signature of TCV Clerk: *[Signature]* Date Filed: 3/2/2026

Please sign ORIGINAL and file in the Transportation signature

AGENCY OF TRANSPORTATION APPROVAL: Signed copy will be returned to TCV Clerk.

APPROVED: _____ DATE: _____
Representative, Agency of Transportation

From: Alley, Kerry
Sent: Tuesday, January 20, 2026 2:13 PM
To: Thomas Bernier <thomas.bernier@newportvermont.org>
Subject: RE: Industrial Drive

Hi Tom,

Everything seems to be consistent with the images you sent me and the transition in surface type that we already had mapped for Industrial Dr (see image below). The length of the solid black line (our symbology for a paved road) corresponds to 0.11 mi, which matches your wheel's measure of 569 ft. We can designate the remaining 0.02 mi as Not Up To Standard (NUTS) in our records, which means that the mileage would be included in Newport City's class 4 mileage totals instead of the class 3 mileage totals. "NUTS" is a VTrans designation that does not affect the legal status of the road, but it does clarify for anyone using VTrans data that the segment isn't maintained to class 3 standards year round. If hopes to extend the road are eventually abandoned, then it would be more appropriate to formally reclassify or discontinue the segment.

This change can be added to the "Reclassified/Remeasured" section in "PART II" of the Mileage Certificate as:

0.02 mi CL3 TH-150 (Industrial Dr) designated Not Up To Standard (NUTS) pursuant to 19 VSA 305(a)

Industrial Drive (TH-15) road centerline data (solid line is paved, = = = = line is unimproved) and town parcel data (yellow).



I also updated our road centerline data to reflect the details of the intersection of class 2 (CL2) TH-11 (Railroad Sq) and Main St (see image below), and also remeasured all of TH-11 to the nearest 0.001 mile because we're gradually updating our records to measure CL2 Fed Aid highways with 3 decimal places of accuracy instead of only two). I've attached an image showing the new mileage of each segment of TH-11, which now totals 0.258 mi instead of only 0.18 mi.

These adjustments can be added to the Certificate in the "New Highways" section of PART II of the Certificate:

+0.014 mi CL2 TH-11 (Railroad Sq) added previously unmapped approach

+0.057 mi CL2 TH-11 (Railroad Sq) added previously unmapped approach

...and in the "Reclassified/Remeasured" section:

+0.007 mi CL2 TH-11 remeasured to 3 decimal places

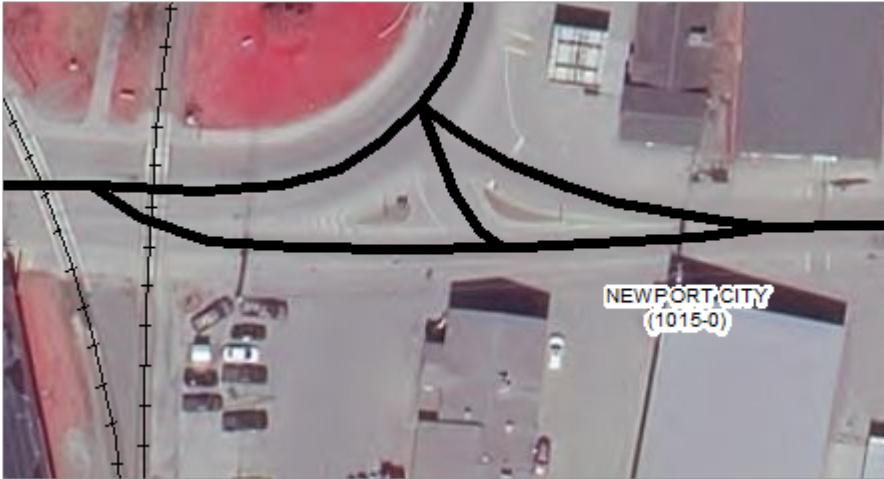

You will also need to include the net changes for each highway class to PART I of the certificate, also taking into account any additional changes you might have.

Let me know if you have any questions!!

Kerry

From: Alley, Kerry
Sent: Monday, January 12, 2026 11:53 AM
To: 'Thomas Bernier' <thomas.bernier@newportvermont.org>
Subject: RE: Industrial Drive

Thanks Tom!

The 3rd image didn't come through... I was a Google Drive link that I don't have permission to view.

Kerry

From: Thomas Bernier <thomas.bernier@newportvermont.org>
Sent: Friday, January 9, 2026 3:10 PM
To: Alley, Kerry <Kerry.Alley@vermont.gov>
Subject: Industrial Drive

You don't often get email from thomas.bernier@newportvermont.org. [Learn why this is important](#)

EXTERNAL SENDER: Do not open attachments or click on links unless you recognize and trust the sender.

Hi Kerry,

I have attached three photos showing where we currently end the plowing. It appears to be approximately 100 feet less than what is indicated on the map.

Due to the existing snow pile, I wasn't entirely certain if I reached the very end of the paving, but I am confident it is very close to the limit.

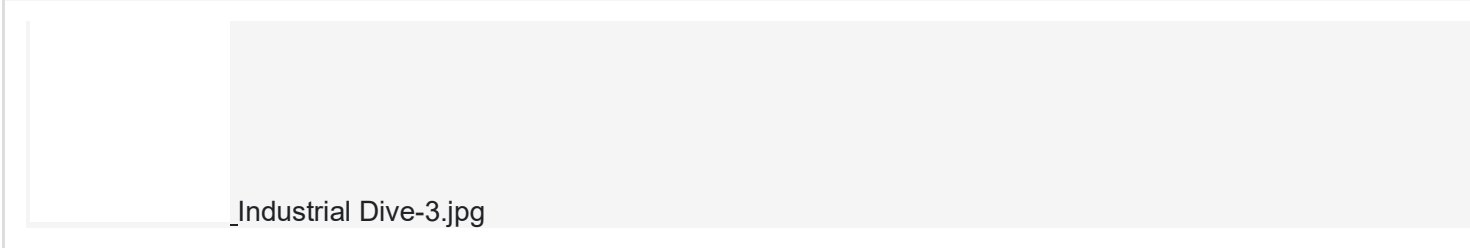

_Industrial Dive-3.jpg

Tom

Thomas L. Bernier
Director of Public Works
City of Newport, VT
222 Main Street
Newport, VT 05855
(802) 334-2124
thomas.bernier@newportvermont.org



FEET 7 IN. 1

0.5695

KESON
MAKE YOUR MARK RRT12



ASPHALTIC PLUG JOINT
 STA. 83+92.31, LT-RT (RR)
 STA. 84+75.81, LT-RT (RR)
 STA. 86+80.24, LT-RT (BR 175)

REHAB DIS, CBS OR MHS, CLASS 1 OR II
 STA. 83+57, LT
 STA. 83+86, RT
 STA. 86+48, LT

CHANGING ELEVATION OF SEWER MANHOLES
 STA. 82+83, RT
 STA. 83+73, RT
 STA. 84+94, RT

VERTICAL GRANITE CURB
 STA. 82+92, LT

CAST-IN-PLACE CONCRETE CURB, TYPE B
 STA. 82+92, LT

REMOVING AND RESETTING CURB
 STA. 83+28, LT

REMOVAL OF EXISTING CURB
 STA. 82+92, LT

PORTLAND CEMENT CONCRETE SIDEWALK, 5 INCH
 STA. 82+52 TO 82+58, LT
 STA. 82+58 TO 82+63, RT
 STA. 82+80 TO 82+97, LT
 STA. 82+97 TO 83+03, RT
 STA. 83+23 TO 83+45, LT
 STA. 86+30 TO 86+42, LT

DETECTABLE WARNING SURFACE
 STA. 82+55, LT
 STA. 82+60, RT
 STA. 82+92, LT
 STA. 83+01, RT
 STA. 83+28, LT
 STA. 86+36, LT

ADJUST ELEVATION OF VALVE BOX
 STA. 85+28, RT
 STA. 85+57, LT

DURABLE 4 INCH WHITE LINE
 (ALL LINES WILL INCLUDE EDGE LINE BREAKS AND RADI FOR SIDE ROADS)
 STA. 82+50 TO 87+50, SOLID LT & RT
 STA. 82+50 TO 83+90, SOLID LT (LANE LINE)
 STA. 82+50 TO 85+75, SOLID RT (LANE LINE)
 STA. 83+61 TO 83+94, RT (DIAGONALS)
 STA. 83+90 TO 84+78, DOTTED LT
 STA. 85+75 TO 86+32, DOTTED RT
 STA. 85+93, RT (EDGE LINES, RAILROAD SQUARE & SLIP RAMP)

DURABLE 4 INCH YELLOW LINE
 (ALL LINES WILL INCLUDE C BREAKS FOR SIDE ROADS)
 STA. 82+57 TO 84+04, SOLID LT & RT
 STA. 84+04 TO 85+76, DOUBLE SOLID LT (ISLAND LT)
 STA. 84+04 TO 85+76, DOUBLE SOLID LT (ISLAND RT)
 STA. 85+76 TO 87+50, SOLID LT & RT
 STA. 85+93, DOUBLE SOLID RT (RAILROAD SQUARE & SLIP RAMP)

DURABLE 8 INCH WHITE LINE
 STA. 85+03 TO 85+23, LT (HYDRANT)
 STA. 85+22 TO 85+44, RT (CHEVRONS)
 STA. 86+30 TO 86+39, RT (NO PARKING)

DURABLE 8 INCH YELLOW LINE
 STA. 84+29 TO 85+53, LT (DIAGONALS)
 STA. 85+93, RT (RAILROAD SQUARE)

DURABLE 24 INCH STOP BAR
 STA. 83+84, RT
 STA. 84+89, LT
 STA. 85+93, RT

DURABLE LETTER OR SYMBOL
 STA. 82+70, C ARROW
 STA. 82+70, RT ARROW
 STA. 83+16, LT "ONLY"
 STA. 83+22, C "ONLY"
 STA. 83+75, C ARROW
 STA. 83+75, RT ARROW
 STA. 83+86, LT ARROW
 STA. 85+93, RT "STOP"

DURABLE CROSSWALK MARKING
 STA. 82+50, RT TO 82+55, LT
 STA. 82+95 TO 83+25, LT
 STA. 86+36, LT - RT

DURABLE RAILROAD CROSSING SYMBOL
 STA. 86+73, LT

TEMPORARY 4 INCH WHITE LINE, PAINT
 (ALL LINES WILL INCLUDE EDGE LINE BREAKS AND RADI FOR SIDE ROADS)
 STA. 82+50 TO 87+50, SOLID LT & RT
 STA. 82+50 TO 83+90, SOLID LT (LANE LINE)
 STA. 82+50 TO 85+75, SOLID RT (LANE LINE)
 STA. 83+61 TO 83+94, RT (DIAGONALS)
 STA. 83+90 TO 84+78, DOTTED LT
 STA. 85+75 TO 86+32, DOTTED RT
 STA. 85+93, RT (EDGE LINES, RAILROAD SQUARE & SLIP RAMP)

TEMPORARY 4 INCH YELLOW LINE, PAINT
 (ALL LINES WILL INCLUDE C BREAKS FOR SIDE ROADS)
 STA. 82+57 TO 84+04, SOLID LT & RT
 STA. 84+04 TO 85+76, DOUBLE SOLID LT (ISLAND LT)
 STA. 84+04 TO 85+76, DOUBLE SOLID LT (ISLAND RT)
 STA. 85+76 TO 87+50, SOLID LT & RT
 STA. 85+93, DOUBLE SOLID RT (RAILROAD SQUARE & SLIP RAMP)

TEMPORARY 8 INCH WHITE LINE, PAINT
 STA. 85+03 TO 85+23, LT (HYDRANT)
 STA. 85+22 TO 85+44, RT (CHEVRONS)
 STA. 86+30 TO 86+39, RT (NO PARKING)

TEMPORARY 8 INCH YELLOW LINE, PAINT
 STA. 84+29 TO 85+53, LT (DIAGONALS)
 STA. 85+93, RT (RAILROAD SQUARE)

TEMPORARY 24 INCH STOP BAR, PAINT
 STA. 83+84, RT
 STA. 84+89, LT
 STA. 85+93, RT

TEMPORARY LETTER OR SYMBOL, PAINT
 STA. 82+70, C ARROW
 STA. 82+70, RT ARROW
 STA. 83+16, LT "ONLY"
 STA. 83+22, C "ONLY"
 STA. 83+75, C ARROW
 STA. 83+75, RT ARROW
 STA. 83+86, LT ARROW
 STA. 85+93, RT "STOP"

TEMPORARY CROSSWALK MARKING, PAINT
 STA. 82+50, RT TO 82+55, LT
 STA. 82+95 TO 83+25, LT
 STA. 86+36, LT - RT

TEMPORARY RAILROAD CROSSING SYMBOL, PAINT
 STA. 86+73, LT

PAINTED CURB
 STA. 85+42 TO 85+67, RT
 STA. 85+83 TO 85+93, RT

REMOVING SIGNS AS SHOWN - 24

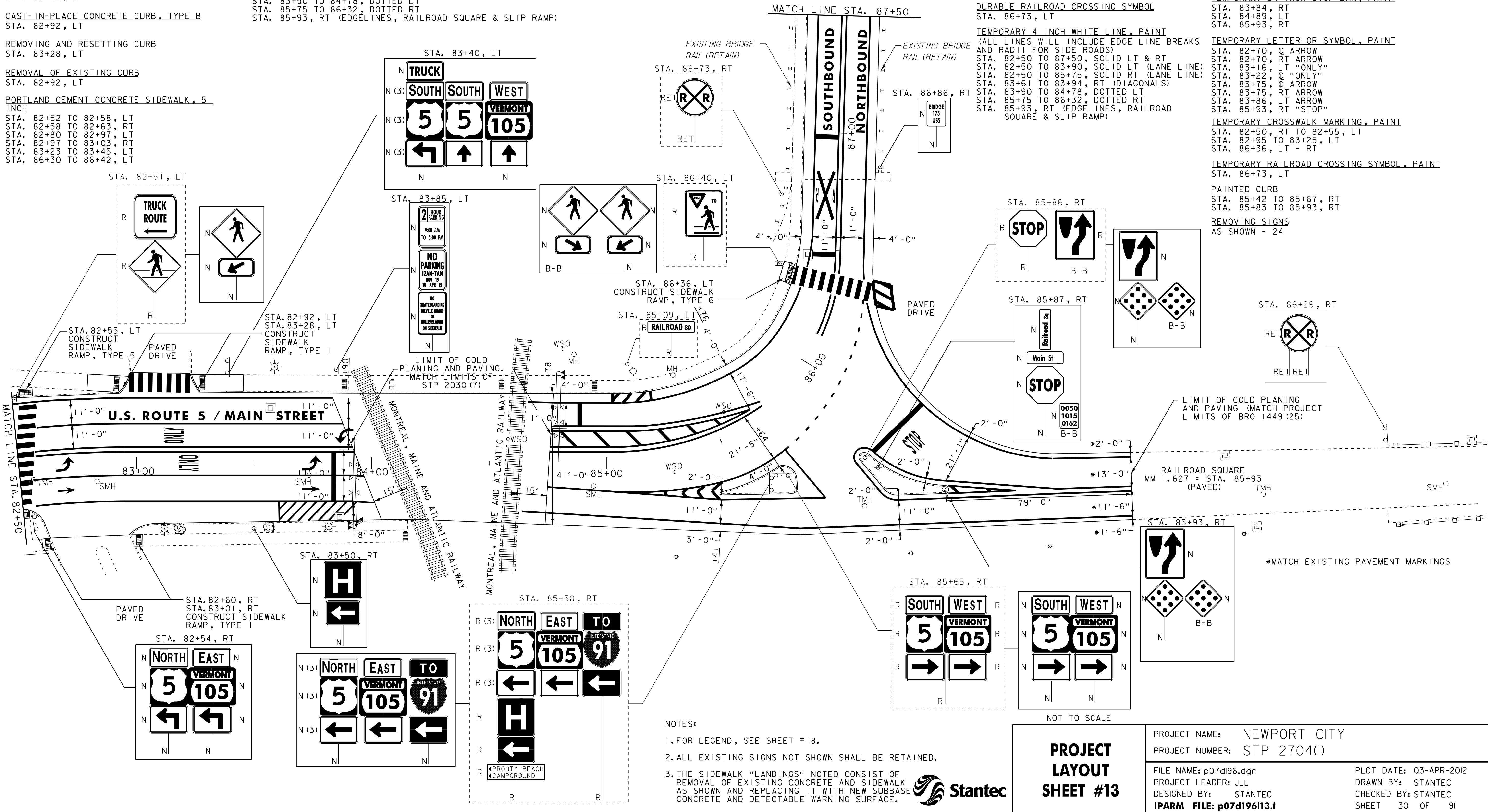

NOTES:

- FOR LEGEND, SEE SHEET #18.
- ALL EXISTING SIGNS NOT SHOWN SHALL BE RETAINED.
- THE SIDEWALK "LANDINGS" NOTED CONSIST OF REMOVAL OF EXISTING CONCRETE AND SIDEWALK AS SHOWN AND REPLACING IT WITH NEW SUBBASE CONCRETE AND DETECTABLE WARNING SURFACE.



PROJECT LAYOUT SHEET #13	PROJECT NAME: NEWPORT CITY	PLOT DATE: 03-APR-2012
	PROJECT NUMBER: STP 2704(I)	DRAWN BY: STANTEC
	FILE NAME: p07d196.dgn	CHECKED BY: STANTEC
	PROJECT LEADER: JLL	SHEET 30 OF 91
	DESIGNED BY: STANTEC	
	IPARM FILE: p07d19613.i	