

1968 REASSESSMENT  
SECTION OF STATE AID HIGHWAYS

Town of Williamstown

County of Orange

Vt. Hwy. Dist. No. 6

Total S.A. Mileage 13.200

Impoverished areas highways as required by Title 19, V.S.A., Sections 1 & 11.

No. 1 3.960 miles

Beginning at VT 14 on Meadow Street in Williamstown Village

extending (Give direction) northeasterly along Meadow Street, by Martin School, via  
Coldspring Corner and Foxville

ending at the Barra Town Line north of Foxville.

No. 2 4.350 miles

Beginning at VT 14 in Williamstown on the Northfield road

extending (Give direction) westerly along the Northfield Road

ending at the Northfield Town Line (also known as the Whitcomb Road).

No. 3 0.870 miles

Beginning at the Northfield Town Line on the Berlin Corner Road

extending (Give direction) northerly along the Berlin Corner Road

ending at the Northfield Town Line.

No. 4 4.020 miles

Beginning at VT 14 on the Chelsea Road

extending (Give direction) southeasterly along the Chelsea Road via Jackson's Corner

ending at Washington Town Line.

No. 5

Beginning at

extending (Give direction)

ending at

No. 6

Beginning at

extending (Give direction)

ending at

No. 7 miles

Beginning at

extending (Give direction)

ending at

No. 8 miles

Beginning at

extending (Give direction)

ending at

No. 9 miles

Beginning at

extending (Give direction)

ending at

No. 10 miles

Beginning at

extending (Give direction)

ending at

No. 11 miles

Beginning at

extending (Give direction)

ending at



We have this day of 19

wherein which is an improvement on replace use and all selections made prior to this date

Marye J. Martin  
Joseph S. Carter

(S) Harry Laflair

Signature  
of the  
Forest of

Witness March 13th 1961

Approved

Dec 5 1961

R. A. [Signature]  
Director, National Bureau of Land Management

No. 7

miles

Beginning at

extending (Give direction)

ending at

No. 8

miles

Beginning at

extending (Give direction)

ending at

No. 9

miles

Beginning at

extending (Give direction)

ending at

No. 10

miles

Beginning at

extending (Give direction)

ending at

No. 11

miles

Beginning at

extending (Give direction)

ending at



We have this

copy of

12

make the above

subject which is so important and replace any and all references made prior to this date

*Mayne J. Martin*  
*Ralph S. Carter*  
 (S) Harry L. Waller

Reference  
 of the  
 Bureau of

Approved:

Dec 5 1961

*R. J. Miller*  
 Director, National Bureau

*[Handwritten initials]*

# CERTIFICATE OF HIGHWAY MILEAGE

FOR YEAR ENDING FEBRUARY 15, 1968

Fill out in triplicate and file with your Town Clerk on or before February 15, 1968

(Note sections of Vermont Statutes Annotated on reverse side of this sheet)

We, the Selectmen of the town of Williamstown, do hereby certify that we have carefully measured all the traveled highways in this town and find that the total mileage of traveled highways according to Title 26, V.A.A. Sec. 26, amended 1961, Act No. 20, not including post roads and trails, in this town for the year ending February 15, 1968, is as follows:

	MILEAGE IN TOWN (Outside of villages incorporated for highways)			MILEAGE IN VILLAGES (Incorporated for Highways)			Total All Systems
	WILLIAMSTOWN						
	Town Highways	State Aid Highways	State Highways	Town Highways	State Aid Highways	State Highways	
PREVIOUS MILEAGE as shown March 15, 1968	66.82	13,290	6,833				86,943
HIGHWAYS ADDED Since March 15, 1968, ac- cording to statute. Explain under PARAGRAPH 1 below.	0.04 0.31 <del>- 6.09</del>						
SUB-TOTAL	66.86	13,290	6,833				89,063
HIGHWAYS SUBTRACTED Since March 15, 1968. Those becoming untraveled, discon- tinued, legal trails or post roads. Explain under para- graphs 2 and 3 below.	1.71 1.88	0,090					1,970
TOTAL TRAVELED HIGHWAYS Feb. 15, 1968	65.08 <del>67.99</del>	13,200	6,833				85,718 <del>87,093</del>

1. We hereby certify that the following new highways, as substantiated by the attached "Selectmen's Certificate of Completion", have been added since March 15, 1968:

Highway C-C	( T-12A ) <sup>.03</sup>	Measured by Highway Dept.	
Highway B-E	( T-26A ) <sup>.26</sup>	Measured by Highway Dept.	} .72
Highway D-D	( T-25A ) <sup>.03</sup>	Measured by Highway Dept.	
Highway F-F	( T-24B )	0.04 mi. ZZO	

2. We hereby certify that the following highways have been discontinued, or changed to trails or post roads according to statute, since March 15, 1968, as substantiated by the attached copy of the proceedings:

T 16 .72  
T 35 .30  
T 50 .69

3. We hereby certify that the following roads have become untraveled since March 15, 1968:

SELECTMEN: *Murray G. Martin*  
*Ralph S. Cathers*

At Williamstown in the county of Orleans

the 10th day of February, 1968 personally appeared

Murray G. Martin and Ralph S. Cathers

Selectmen of the Town of Williamstown  
and made oath to the truth of the foregoing affidavit by them subscribed.

Notary Public: *Allen F. Murray*  
*Ray Allen*

(Town Clerk should fill out following and mail one white and one yellow copy to the Commissioner of Highways, Montpelier, Vermont, on or before March 15th.)

I, Allen F. Murray, Clerk of the Town of Williamstown

hereby certify that the foregoing is a true copy of record of the certificate of the Selectmen of Williamstown

relating to highway mileage. Said copy recorded at this date.

Notary Public: *Allen F. Murray*

# CERTIFICATE OF HIGHWAY MILEAGE

FOR YEAR ENDING FEBRUARY 10, 1969

Fill out in triplicate and file with your Town Clerk on or before February 10, 1969

(Note sections of Vermont Statutes Annotated on reverse side of this sheet)

We, the Selectmen of the town of WILLIAMSTOWN, on each state that we have carefully measured all the traveled highways in this town and find that the total mileage of traveled highways according to Title 19, V.S.A. Sec. 18, amended 1961, Act No. 24, not including post roads and trails, in this town for the year ending February 10, 1969, is as follows:

	MILEAGE IN TOWN (Outside of villages incorporated for highways)			MILEAGE IN VILLAGES (Incorporated for highways)			Total All Systems
	WILLIAMSTOWN						
	Town Highways	State Aid Highways	State Highways	Town Highways	State Aid Highways	State Highways	
PREVIOUS MILEAGE as shown March 15, 1968	66.82	13.290	6.833				86.943
HIGHWAYS ADDED since March 15, 1968, ac- cording to statute Chapter under paragraph 1 below	0.04 0.33 <del>0.01</del> - 2.09 -						
SUB-TOTAL	68.77	13.290	6.833				89.063
HIGHWAYS SUBTRACTED since March 15, 1968. Those consisting of untraveled, discon- tinued, legal trails or post roads. Explain under para- graphs 2 and 3 below	1.71 1.88	0.090					1.970
TOTAL TRAVELED HIGHWAYS Feb. 10, 1969	65.66 <del>67.00</del>	13.200	6.833				85.713 <del>87.000</del>

1 We hereby certify that the following new highways, as substantiated by the attached "Selectmen's Certificate of Completion", have been added since March 15, 1968:

- Highway C-C ( T-100 )<sup>03</sup> Measured by Highway Dept.
- Highway B-E ( T-200 )<sup>2b</sup> Measured by Highway Dept.
- Highway D-D ( T-261 )<sup>03</sup> Measured by Highway Dept.
- Highway E-E ( T-262 ) 0.04 mi. 220

2 We hereby certify that the following highways have been discontinued, or changed to trails or post roads according to statute, since March 15, 1968, as substantiated by the attached copy of the proceedings:

- T 16 72
- T 25 30
- T 50 69

3 We hereby certify that the following roads have become untraveled since March 15, 1968

SELECTMEN

*Malcolm Martin*  
*Richard Ketchum*

At \_\_\_\_\_ in the county of Orange

the \_\_\_\_\_ day of \_\_\_\_\_, 1969 personally appeared \_\_\_\_\_

\_\_\_\_\_ of \_\_\_\_\_

Selectmen of \_\_\_\_\_ of the town of Williamstown

and roads back to the books of the foregoing within by them subscribed

Witness my hand and seal this \_\_\_\_\_ day of \_\_\_\_\_, 1969

*Allen J. Murray*  
*Henry P. Butler*

Town Clerk should fill out following and mail one white and one yellow copy to the Commissioner of Highways, Montpelier, Vermont, on or before March 15th

1 \_\_\_\_\_

\_\_\_\_\_ Check of the town of \_\_\_\_\_

\_\_\_\_\_

*Allen J. Murray*

TOWN OF WILLIAMSTOWN

WILLIAMSTOWN, VERMONT

"Town of State Williamstown Act"

February 24, 1969

We, the Selectmen of the Town of Williamstown, after legal hearings certify that 0.72 mi. of T.H. 16 and 0.30 mi. of T.H. 35 were turned into trails October, 1965. Also that 0.69 mi. of T.H. 50 was turned into a trail August 1965.

Wayne Martin

Ralph S. Cushman

SELECTMEN

Attest: Delbert F. Murray  
Town Clerk

3/6/69 RIN says ok to accept as legal proof



**"Map of Some Williamstown Rd"**

February 17, 1969

**To Whom It May Concern:**

We, the undersigned Selectmen for the Town of Williamstown, Vermont certify that the following highways as shown on the road map of the Village of Williamstown, Vermont, as measured in 1968, were opened to public travel and have been maintained by the Town of Williamstown.

Highway	C*6	(T-12A)	0.03	1940
Highway	E-E	(T-26A)	0.03	1950
Highway	D-D	(T-24A)	0.26	1902

Wayne J. Martin  
Ralph S. Cochran

SELECTMEN

Attest: Helen F. Murray  
Town Clerk

3/6/69 RAN says ok to accept as legal proof

CERTIFICATE OF COMPLETION AND OPENING  
OF A HIGHWAY FOR PUBLIC TRAVEL

Helen F. Murray, Clerk of the Town  
of Williamstown, Vermont.

Pursuant to Title 19, V.S.A., Section 15, as amended, this is to certify  
that the following described section(s) of highway in the Town  
of Williamstown, Route Number T-248  
COMPLETED AND OPEN FOR PUBLIC TRAVEL on January, 1969.

**DESCRIPTION OF RIGHT-OF-WAY:** Beginning at a point on the north line  
of Construction Hill Road thence turning and running N 8°-57.5' E  
a distance one hundred three (103) feet to a stake; thence turning  
and running N 25°-47.5' E, a distance of one hundred twenty-six and  
seventy-four hundredths (126.74) feet to a point in the drive of the  
Raymond Duff house; thence turning and running S 64°-12.5' E a  
distance of fifty (50.0) feet to a stone bound at the northwest  
corner of lot #2 belonging to Francis Duff; thence turning and  
running S 25° - 47.5' W along Lot #2 a distance of one hundred  
and nineteen and thirty-four hundredths (119.34) feet to a stone  
bound at the South west corner of Lot #2; thence turning and  
running S 8°-57.5' a distance of one hundred seven (107) feet  
to a point on the north line of Construction Hill Road; thence  
turning and running westerly along said north line a distance  
of fifty-one and two tenths (51.2) feet to the point of begin-  
ning.

State of Vermont, this 10th day of February, A.D. 1969.

s/ Wayne G. Martin Board

s/ Ralph S. Cathrew of

Selection  
(Signature)  
(Address)

(and the Mayor of the City of \_\_\_\_\_).

Williamstown, Vermont

February 10, 1969.

THE ABOVE IS A TRUE COPY OF DESCRIPTION OF SECTION(S) OF HIGHWAY COMPLETED  
AND OPENED FOR PUBLIC TRAVEL, RECORDED IN BOOK 47 ON PAGE \_\_\_\_\_  
OF Land RECORDS OF THE Town OF Williamstown  
ON THE 9th DAY OF January, 1969 AT 4:05 O'CLOCK, P. M.

ATTEST: Helen F. Murray  
Clerk of Williamstown



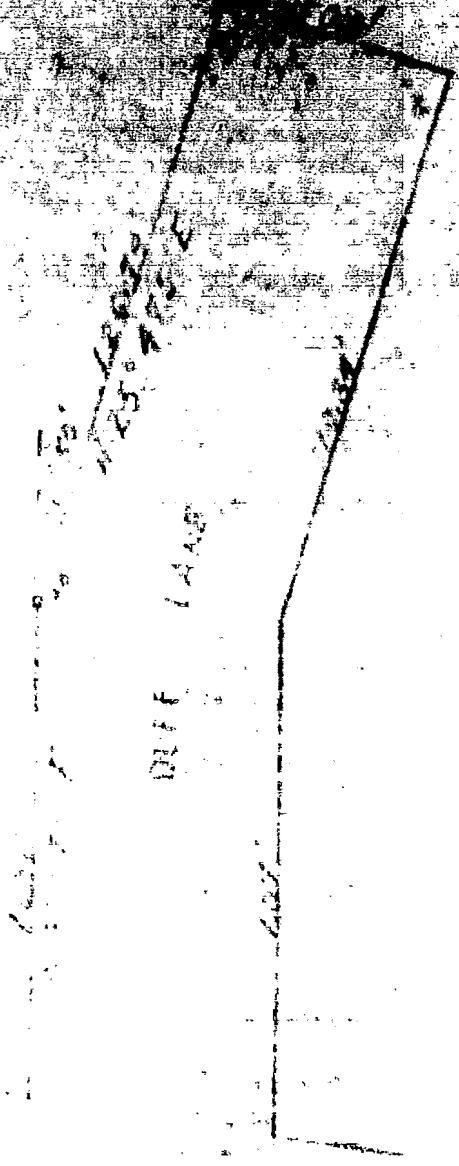

N/R

1078 DUFF LANE

1078 DUFF LANE 1078

1078 DUFF LANE, VT. Jan. 1989

1078

1078 DUFF LANE, VT. Jan. 1989

1078

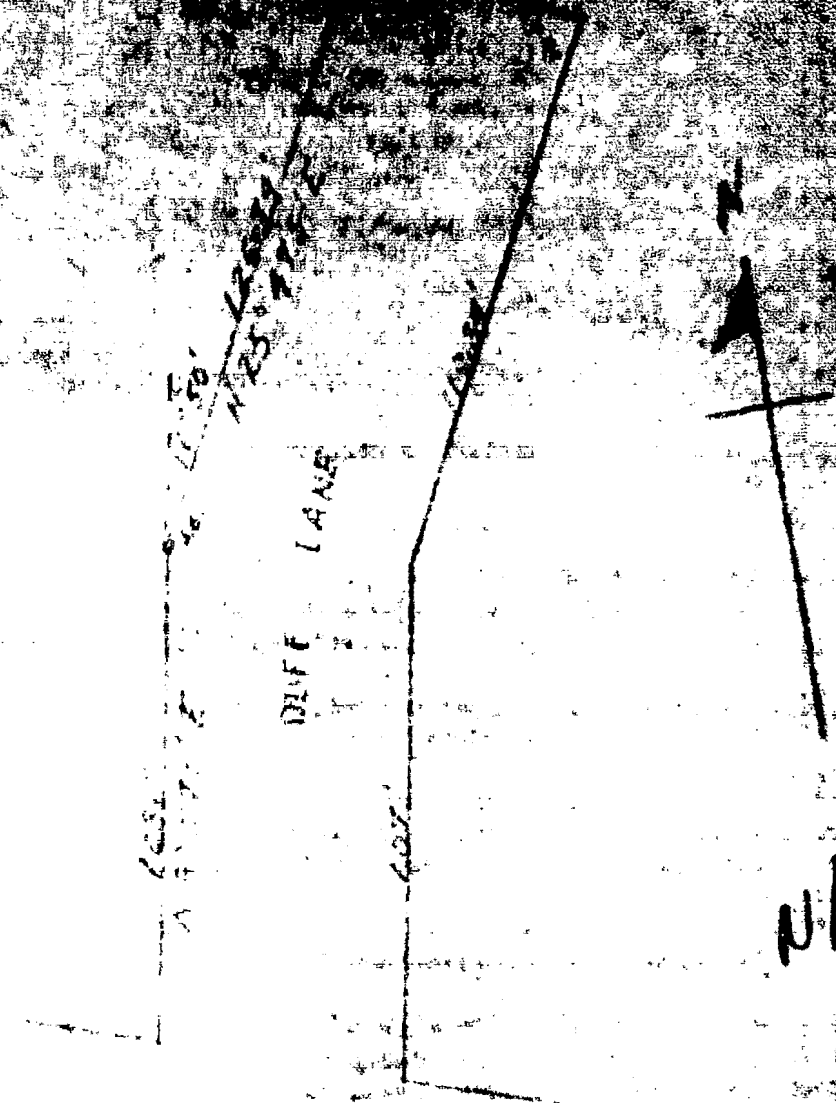

N/R

CONSTRUCTION HILL RD.

PLAN OF DUFF LANE

1040 HILL

WILLIAMSTOWN, VT. JAN. 1969

SCALE 1"=40'

~~Land owned or owned to the Town of...~~

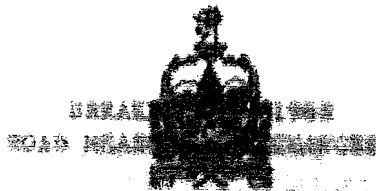

STATE OF VERMONT  
DEPARTMENT OF HIGHWAYS

MONTPELIER

Miles 0000 Miles

Highway Planning Division

Map  
Date  
Project

Town  
Rte.  
Mile

Application

January 29, 1969

Board of Selectmen  
Town of Williamstown  
Williamstown, Vermont 05679

Attention of Chairman

Gentlemen:

In accordance with Title 19, V.S.A., Section 13, as amended, all the traveled highways in your town were measured in 1968 by F. Tucker, Town Manager, with Mr. Otis of this office.

The resulting changes in highway mileage are indicated on the enclosed map and are explained on the attached breakdown sheet.

The second breakdown sheet indicates those roads for which we will require copies of the rights-of-way and Certificates of Completion and Opening before they can be added to your Town Highway mileage.

Also, due to remeasurement, SA 1 was reduced 0.060 mile in length, SA 2 was increased 0.030 mile and SA 3 was decreased 0.080 mile.

Before we can accept as trails 0.72 mile of T 16, 0.30 mile of T 15, 0.69 mile of T 30 and a presently untraveled portion of T 30, it will be necessary that you submit to this agency copies of the formal Notices of Discontinuance of these roads as public highways.

For your convenience we have entered the changes in Town Highway mileage on the enclosed Highway Mileage Certificate and would appreciate your entering any other Town Highway changes processed in accordance with the Statutes during the past year.

The completed Mileage Certificates must reach this office by March 15, 1969 in order for these mileage changes to be effective at this time.

Very truly yours,

R. J. Nicholls  
Highway Planning Engineer

RJN/SSB/cls  
Enc.

**BREAKDOWN OF 1968  
 ROAD MEASUREMENT CHANGES**  
 ROAD MEASUREMENT CHANGES  
 (Continued)

<u>Map Ident. Letter</u>	<u>Town Hwy. No.</u>	<u>Miles Added</u>	<u>Miles Subtracted</u>	<u>Explanation</u>
A	7	0.31		Remeasurement
B	10	0.04		Remeasurement
C	11	0.04		Remeasurement
E	18	0.02	0.05	Remeasurement
F	19	0.03		Addition
G	23	1.00	0.81	Untraveled beyond 0.50 mile
H	25	0.21	0.03	Remeasurement
I	27		0.52	Untraveled
J	28	0.05		Remeasurement
K	29	0.05		Now open to travel
L	30	0.15		Remeasurement
M	35	0.10		Now open to travel
O	36		0.04	Untraveled beyond 0.16 mile
P	38	0.09		Remeasurement
Q	46		0.12	Untraveled beyond 1.28 mile
R	46	0.75		Now open to travel
V	52	0.06		Remeasurement
W	58	0.03		Remeasurement
X	59	0.21		Now open to travel
Y	61		0.23	Untraveled
Z	68		0.04	Remeasurement

(Continued)

**BREAKDOWN OF 1968**  
**ROAD MEASUREMENT CHANGES**  
 (Continued)  
 AND OPENING OF ROAD TO PUBLIC TRAVEL.

<u>Map</u> <u>Ident.</u> <u>Letter</u>	<u>Town</u> <u> Hwy.</u> <u>No.</u>	<u>Miles</u> <u>Added</u>	<u>Miles</u> <u>Subtracted</u>	<u>Explanation</u>
AA	79 10A	0.06	0.03	Re-measurement
BB	79 24A		0.03	0.03 Re-measurement
FF	46A 20A	0.08	0.24	Addition
	<b>Totals:</b>	<b>2.09</b>	<b>0.30</b>	<b>1.86</b>
	<b>Net Change:</b>	<b>0.21</b>		



Town of Williston

# HIGHWAY MILEAGE

**Breakdown of 1968 Road Measurement on Town Highways**  
**requiring copy of RIGHT-OF-WAY and CERTIFICATE OF COMPLETION**  
**AND OPENING OF ROAD TO PUBLIC TRAVEL.**

<u>Map Ident. Letter</u>	<u>Town Hwy. No.</u>	<u>Mileage</u>	<u>Explanation</u>
CC	12A	0.03	New Addition
DD	24A	0.03	New Addition
EE	26A	0.26	New Addition
<b>Total:</b>		<b>0.32</b>	

**F. HIGHWAY MILEAGE**

TO: *Mike*  
FROM: *Jim*  
DATE: *3/6/69*

DURING FEBRUARY 10, 1968  
on or before February 10, 1968  
(to be annotated on reverse side of this sheet)

- ACTION**
- Note & File
  - Note & Return to Me
  - Return with More Details
  - Note & See Me About This
  - Please Answer
  - For Your Approval
  - Per Our Conversation
  - Prepare Reply for My Signature
  - Take Appropriate Action
  - Per Your Request
  - Sign & Mail
  - Sign & Return
  - For Your Information
  - Investigate & Report

Each town, on each state that we have currently measured mileage of traveled highways according to Title 10, V.S.A. Sec. 20, presented us for the year ending February 10, 1968, is as follows:

Route Mileage	MILEAGE IN VILLAGE (Incorporated for Highways)			Total All Routes
	Town Highways	State Aid Highways	State Highways	
333				88.233
13				86.943 <del>82.923</del>

**COMMENTS:**

*Can we accept these  
as legal proof?*

*OK  
R.J.N.*

HD 34 404 10-68

as listed by the attached "Selectmen's Certificate of Completion".

2. We hereby certify that the following highways have been discontinued, or changed to trails or park roads according to statute, since March 15, 1967, as substantiated by the attached copy of the proceedings:

*part of #56; part of Town Highway #9.*

3. We hereby certify that the following roads have become untraveled since March 15, 1967:

SELECTSMEN: *Wayne G. Martin*  
*Ralph S. Colburn*

At the Town of Williamstown, Vt. in the county of Orange

the first day of March

1968 personally appeared before me,

*Melvin B. Winter*

Selectsmen of Town of Williamstown, Vermont  
and made oath to the truth of the foregoing affidavit by their subscription.

# CERTIFICATE OF HIGHWAY MILEAGE

FOR YEAR ENDING FEBRUARY 10, 1968

Fill out in triplicate and file with your Town Clerk on or before February 10, 1968

(Note sections of Vermont Statutes Annotated on reverse side of this sheet)

We, the Selectmen of the town of Williamstown, on oath state that we have carefully measured all the traveled highways in this town and find that the total mileage of traveled highways according to Title 19, V.A.A. Sec. 22, amended 1961, Act No. 28, not including post roads and trails, in this town for the year ending February 10, 1968, is as follows:

	MILEAGE IN TOWN (Outside of villages incorporated for highways) <b>WILLIAMSTOWN</b>			MILEAGE IN VILLAGE (Incorporated for highways)			Total All Highways
	Town Highways	State Aid Highways	State Highways	Town Highways	State Aid Highways	State Highways	
	<b>PREVIOUS MILEAGE</b> as shown March 15, 1967	68.11	13.290	6.833			
<b>HIGHWAYS ADDED</b> Since March 15, 1967, according to statute. Explain under paragraph 1 below.							
<b>SUB-TOTAL</b>							
<b>HIGHWAYS SUBTRACTED</b> Since March 15, 1967. Those becoming untraveled, discontinued, legal trails or post roads. Explain under paragraphs 2 and 3 below.	1.29 <del>1.29</del>						
<b>TOTAL TRAVELED HIGHWAYS</b> Feb. 10, 1968.	66.82 <del>67.8</del>	13.290	6.833				<b>86.943</b> <del>86.943</del>

1. We hereby certify that the following new highways, as substantiated by the attached "Selectmen's Certificate of Completion", have been added since March 15, 1967:

2. We hereby certify that the following highways have been discontinued, or changed to trails or post roads according to statute, since March 15, 1967, as substantiated by the attached copy of the proceedings:

part of #36; part of Town Highway #9.

3. We hereby certify that the following roads have become untraveled since March 15, 1967:

SELECTMEN:

*Wayne J. Martin*  
*Joseph S. Carter*

At Town of Williamstown, Vt.

in the county of Orange

the first day of March

1968 personally appeared before me,

*Melvin B. Winter*

Selectmen of Town of Williamstown, Vermont  
and made oath to the truth of the foregoing affidavit by their subscription.

# CERTIFICATE OF HIGHWAY MILEAGE

FOR YEAR ENDING FEBRUARY 10, 1968

Fill out in triplicate and file with your Town Clerk on or before February 10, 1968

(Note sections of Vermont Statutes Annotated on reverse side of this sheet)

We, the Selectmen of the town of **Williamstown**, in said State do hereby certify that we have carefully examined all the traveled highways in this town and find that the total mileage of traveled highways according to Title 15, V.T.A. Sec. 15, amended 1967, Act No. 28, not including post roads and trails, in this town for the year ending February 10, 1968 is as follows:

	MILEAGE IN TOWN (Outside of villages incorporated in highways)			MILEAGE IN VILLAGES (Incorporated in highways)			Total Mileage
	WILLIAMSTOWN						
	Town Highways	State Aid Highways	State Highways	Town Highways	State Aid Highways	State Highways	
<b>PREVIOUS MILEAGE</b> as shown March 15, 1967	68.11	13.290	6.833				88.233
<b>HIGHWAYS ADDED</b> Since March 15, 1967, as provided in statute. Explain under paragraph 1 below							
SUB-TOTAL							
<b>HIGHWAYS SUBTRACTED</b> Since March 15, 1967. Those becoming untraveled, discon- tinued, legal trails or post roads. Explain under para- graphs 2 and 3 below	1.79 3.73						
<b>TOTAL TRAVELED HIGHWAYS Feb 10, 1968</b>	66.32 64.58	13.290	6.833				86.943 87.633

1. We hereby certify that the following new highways, as substantiated by the attached "Selectmen's Certificate of Completion", have been added since March 15, 1967:

2. We hereby certify that the following highways have been discontinued, or changed to trails or post roads according to statute, since March 15, 1967, as substantiated by the attached copy of the proceedings:

Part of E of part of Town Highway #9.

We hereby certify that the following roads have become untraveled since March 15, 1967:

SELECTMEN: *Wayne J. Martin*  
*Ralph S. Coe*

At Town of Williamstown, Vt. in the county of Orange  
the 1st day of March, 1968 personally appeared before me,

*Malcolm B. Winter*

Selectman of Town of Williamstown, Vermont,  
and whose name is on the list of the town's officers as thus substantiated.

Before me:  
*Malcolm B. Winter*  
*Notary Public*

(Town Clerk should fill out following and mail one white and two yellow copies to the Commissioner of Highways, Montpelier, Vermont, on or before March 10, 1968.)

I, *Malcolm B. Winter*, Clerk of the Town of Williamstown, Vermont, hereby certify that the foregoing is a true copy of record of the certificate of the Selectmen of Town of Williamstown, Vermont, regarding highway mileage, that are recorded in the town records.

Date: *March 1, 1968*  
*Malcolm B. Winter*  
Town Clerk

# TOWN of WILLIAMSTOWN

## MUNICIPAL OFFICES

Williamstown, Vermont

"Home of Scenic Williamstown Golf"

### NOTICE

#### DISCONTINUANCE OF A HIGHWAY

At a Hearing legally and duly warned and held November 6, 1967, we heard interested parties and then unanimously decided to discontinue the following described section of Highway #56 in the Town of Williamstown, Vermont, vis.:-

Beginning at a point where the northerly line of Town Highway #74 would extend across said Town Highway #56; thence northwesterly and northeasterly a distance of approximately three thousand one hundred (3100) feet to a point one hundred (100) feet southerly from the L. & T. Knowles-C. Sironi boundary.

The land occupied by said discontinued highway is to revert to the existing abutting property owners in accordance with Title 19, Chapter 7, Section 535 V.S.A.

S/ Harvey Lacillade

Attested

S/ Wayne Martin

Milo B. Winters

S/ Ralph Cathrew

Town Clerk

*[Faint, illegible text and signatures at the bottom of the page]*



# TOWN of WILLIAMSTOWN

## MUNICIPAL OFFICES

Williamstown, Vermont

"Home of scenic Williamstown Golf"

September 20, 1967

### DISCONTINUANCE OF A HIGHWAY

At a hearing legally warned and held September 18, 1967 at 7:00 P.M., we the Board of Selectmen for the Town of Williamstown, Vermont unanimously voted to discontinue the following described highway within the Town of Williamstown, vis:-

Being that portion of Town Highway #9 beginning with its intersection with the easterly line of Town Highway #8 and extending approximately seven (.7) tenths miles easterly to its intersection with the westerly line of Town Highway #10 extended across said Town Highway #9.

The land occupied by said discontinued highway is to revert to the existing abutting property owners in accordance with Title 19, Chapter 7, Section 535 V.S.A.

S/ Harvey Lacillade

S/ Wayne Martin

S/ Ralph Cathrew

*[Handwritten signature]*

*[Faint, illegible text at the bottom of the page]*

# CERTIFICATE OF HIGHWAY MILEAGE

FOR YEAR ENDING FEBRUARY 28, 1967

Fill out in triplicate and file with your Town Clerk before February 28, 1967

Note: Copies of Vermont State Highway Maps are available on request from the State Highway Department.

**R. J. N.**

We the Board of Selectmen of the Town of **WILLIAMSTOWN** State of **VERMONT** do hereby certify that the above stated mileage was computed and verified by the State Highway Department on **March 11, 1968** and that the same is correct according to the State Highway Department's records for the year ending February 28, 1967.

ISSUED BY TOWN **WILLIAMSTOWN**  
Department of Highways  
**Highway Planning Division**

Town Highways	State and Highways	State Highways	Total Highways	Date Issued
68.11	13.270	6.833		March 11, 1968

**Board of Selectmen  
Town of Williamstown  
Williamstown, Vermont 05679**

Attest: **Milo B. Winters  
Town Clerk**

Gentlemen:

I am herewith returning one (1) copy of the Highway Mileage Certificate which you recently submitted.

This copy is for your records and should be retained in your files.

Sincerely yours,

**R. J. Nicholls  
Highway Planning Engineer**

By: **James E. Sisco  
Administrative Assistant**

**RJN/JES/ela  
Enc.**

RECEIVED

*Williamstown*  
*as a copy of same*  
*sent to the State Highway Department*

*Donald B. McArthur*  
is the sign of *Donald B. McArthur*  
1967 Vermont Highway Department

Before me,

*Donald B. McArthur*  
*Notary Public*

These Check Sheets are not valid unless and until one shall and one shall sign to the Commissioner of Highways, Department of Highways, State of Vermont, before February 28, 1967.

I hereby certify that the foregoing is a true and correct copy of record of the contents of the documents of the Board of Selectmen of Williamstown, Vermont, relating to highway mileage, that was received at the State Highway Department on **February 28, 1967**.

Attest:

*Donald B. McArthur*  
*Notary Public*

# CERTIFICATE OF HIGHWAY MILEAGE

FOR YEAR ENDING FEBRUARY 10, 1967

Fill out in triplicate and file with your Town Clerk on or before February 10, 1967

(Note sections of Vermont Statutes Annotated on reverse side of this sheet)

We, the selectmen of the town of **Williamstown**, do hereby certify that we have carefully examined all the traveled highways in this town and find that the total mileage of traveled highways according to Title 25, V.S.A. Sec. 25, amended (1961), Act No. 10, not including post roads and trails, in this town for the year ending February 10, 1967, is as follows:

	MILEAGE IN TOWN (Outside of village incorporated for highways)			MILEAGE IN VILLAGE (Incorporated for highways)			Total All Systems
	WILLIAMSTOWN						
	Town Highways	State Aid Highways	State Highways	Town Highways	State Aid Highways	State Highways	
PREVIOUS MILEAGE as shown March 15, 1966	60.11	13.290	6.833				80.233
HIGHWAYS ADDED Since March 15, 1966, ac- cording to statute. Explain under paragraph 1 below.							
SUB-TOTAL							
HIGHWAYS SUBTRACTED Since March 15, 1966. Those becoming untraveled, discon- tinued, legal trails or post roads. Explain under para- graphs 2 and 3 below.							
TOTAL TRAVELED HIGHWAYS Feb. 10, 1967							

1. We hereby certify that the following new highways, as substantiated by the attached "Selectmen's Certificate of Completion", have been added since March 15, 1966:

2. We hereby certify that the following highways have been discontinued, or changed to trails or post roads according to statute, since March 15, 1966, as substantiated by the attached copy of the proceedings:

3. We hereby certify that the following roads have become untraveled since March 15, 1966:

SELECTMEN:

*Robert P. Cochran*  
*James S. ...*  
*Wayne ...*

In the office of *...*

I hereby approved *Robert Cochran*

*Williamstown*  
by *Harvey ...*  
Selectmen of *...*

Return to:

*Donald ...*  
*...*

(Town Clerk should fill out following and mail one whole and two copies only to the Commissioner of Natural Resources, Montpelier, on or before March 15, 1967.)

I, *Donald ...*, Clerk of the Town of *Williamstown*, hereby certify that the foregoing is a true copy of record of the records of the selectmen of *Williamstown* relating to highway mileage that was recorded at this date.

# CERTIFICATE OF HIGHWAY MILEAGE

FOR YEAR ENDING FEBRUARY 10, 1966

Fill out in triplicate and file with your Town Clerk on or before February 10, 1966

(Note sections of Vermont Statutes Annotated on reverse side of this sheet)

We, the Selectmen of the town of **Williamstown**, on oath state that we have carefully examined all the traveled highways in this town and find that the total mileage of traveled highways according to Title 19, V.S.A. Sec. 20, amended 1961, Act No. 28, not including pent roads and trails, in this town for the year ending February 10, 1966 is as follows:

	MILEAGE IN TOWN (Outside of villages incorporated for highways)			MILEAGE IN VILLAGE (Incorporated for highways)			Total All Systems
	<b>WILLIAMSTOWN</b>						
	Town Highways	State Aid Highways	State Highways	Town Highways	State Aid Highways	State Highways	
PREVIOUS MILEAGE as shown March 15, 1965	67.61	19.290	6.833				87.733
HIGHWAYS ADDED Since March 15, 1965, ac- cording to statute. Explain under paragraph 1 below.	.50						
SUB-TOTAL							
HIGHWAYS SUBTRACTED Since March 15, 1965. Those becoming untraveled, discon- tinued, legal trails or pent roads. Explain under para- graphs 2 and 3 below.							
TOTAL TRAVELED HIGHWAYS Feb. 10, 1966	68.11	19.290	6.833				88.233

1. We hereby certify that the following new highways, as substantiated by the attached "Selectmen's Certificate of Construction", have been added since March 15, 1965:

- .30 Extension highway # 24 (Construction Hill) northerly
- .20 New construction from junction of Town highway # 13 easterly

2. We hereby certify that the following highways have been discontinued, or changed to trails or pent roads according to statute, since March 15, 1965, as substantiated by the attached copy of the proceedings:

3. We hereby certify that the following roads have become untraveled since March 15, 1965:

SELECTMEN:

*Leon M. Mrazek*  
*Ralph S. Cather*  
*David H. Mrazek*

At Williamstown in the county of Franklin  
 the 16 day of February, 1966 personally appeared Leon M. Mrazek,  
Ralph S. Cather and David H. Mrazek  
 Selectmen of the town of Williamstown  
 and make oath to the truth of the foregoing as shown by their signatures.

Before me,  
*Ronald C. [Signature]*  
 Notary Public

This Check should fill out following and send one white and one yellow copy to the Commissioner of Highways, State of Vermont, on or before March 15, 1966.

I, Ronald C. [Signature] Clerk of the Town of Williamstown  
 hereby certify that the foregoing is a true and correct copy of the certificate of the selectmen as  
 selected as highway mileage, filed and recorded on this date.

Suggest Selectmen's Certificate of Completion  
for New Highways built or added

CERTIFICATE OF COMPLETING AND OPENING  
HIGHWAY FOR PUBLIC TRAVEL

Williamstown, Town (City) Clerk  
Town (City) of \_\_\_\_\_  
\_\_\_\_\_, Vermont

Pursuant to Title 19, V.S.A. Section 15, this is to certify that the following described section (sections) of highway in the Town (City) of \_\_\_\_\_  
Williamstown, on Rtes. 24 & 13 Route Number \_\_\_\_\_  
is completed and OPEN FOR PUBLIC TRAVEL.

Section I. (If only one section, omit words "Section I")

T.H.# 24 Beginning (description)  
(construction hill northerly .30 mile  
T.H. 13. easterly .20 "

and as shown on a Highway Map of the Town (City) of Williamstown, dated \_\_\_\_\_, 19 \_\_\_\_, and filed in \_\_\_\_\_ of the \_\_\_\_\_ Records of the Town (City) of \_\_\_\_\_ by the Town (City) Clerk of said Town (City), incorporated herein by reference, and attested to on said map by said Town (City) Clerk.

Dated at \_\_\_\_\_, County of \_\_\_\_\_, and State of Vermont, this \_\_\_\_\_, day of \_\_\_\_\_ A. D., 19 \_\_\_\_.

Leon M. Ward Board

Joseph S. Bethew

David Weston Selectmen  
(Alderman)

(and the Mayor of the City of \_\_\_\_\_)

Williamstown, Vermont  
February 16, 19 46

The above is a true copy of description of a section (s) of highway, completed and OPENED FOR PUBLIC TRAVEL, recorded in Book 9 on Page 177 of \_\_\_\_\_ Records of the Town (City) of Williamstown on the 16 day of February, 19 46, at 2:10 o'clock P. M.

Attest: Ronald A. Merrill  
Town (City) Clerk of \_\_\_\_\_, Vt.



Suggen Selectmen's Certificate of Completion  
for New Highways built or added

CERTIFICATE OF COMPLETING AND OPENING  
HIGHWAY FOR PUBLIC TRAVEL

Williamstown, Town (City) Clerk  
Town (City) of \_\_\_\_\_  
\_\_\_\_\_, Vermont

Pursuant to Title 19, V.S.A. Section 15, this is to certify that the following described section (sections) of highway in the Town (City) of \_\_\_\_\_  
Williamstown, on State 24 & 13 Route Number \_\_\_\_\_  
is completed and OPEN FOR PUBLIC TRAVEL.

Section I. (If only one section, omit words "Section I")

T.H.# 24	Beginning (description)	
	(construction hill	northerly .30 mile
T.H. 13		easterly .20 "

and as shown on a Highway Map of the Town (City) of Williamstown, dated \_\_\_\_\_, 19 \_\_\_\_, and filed in \_\_\_\_\_ of the \_\_\_\_\_ Records of the Town (City) of \_\_\_\_\_ by the Town (City) Clerk of said Town (City), incorporated herein by reference, and attested to on said map by said Town (City) Clerk.

Dated at \_\_\_\_\_, County of \_\_\_\_\_, and State of Vermont, this \_\_\_\_\_, day of \_\_\_\_\_ A. D., 19 \_\_\_\_.

Leon Menard Board

Ralph Catthouse

Wendell Winter Selectmen  
(Aldermen)

(and the Mayor of the City of \_\_\_\_\_)

Williamstown, Vermont  
February 16, 19 66

The above is a true copy of description of a section (s) of highway, completed and OPENED FOR PUBLIC TRAVEL, recorded in Book 9 on Page 177 of Town Records of the Town (City) of Williamstown on the 16 day of February, 19 66, at 2:10 o'clock P. M.

Attest: Donald P. MacCall  
Town (City) Clerk of \_\_\_\_\_ Vt.

# CERTIFICATE OF HIGHWAY MILEAGE

FOR YEAR ENDING FEBRUARY 10, 1965

Fill out in triplicate and file with your Town Clerk on or before February 10, 1965

(Note sections of Vermont Statutes Annotated on reverse side of this sheet)

We, the Selectmen of the town of Williamstown, do hereby certify that we have carefully examined all the traveled highways in this town and find that the total mileage of traveled highways according to Title 10, V.S.A. Sec. 10, amended 1961, Act No. 22, not including post roads and trails, in this town for the year ending February 10, 1965, is as follows:

	MILEAGE IN TOWN (Outside of village incorporated for highways)			MILEAGE IN VILLAGE (Incorporated for highways)			Total All Systems
	WILLIAMSTOWN						
	Town Highways	State Aid Highways	State Highways	Town Highways	State Aid Highways	State Highways	
PREVIOUS MILEAGE as shown March 15, 1964	67.61	13,290	6,533				87,733
ROADWAYS ADDED Since March 15, 1964, ac- cording to statute. Explain under paragraph 1 below.							
SUB-TOTAL							
ROADWAYS SUBTRACTED Since March 15, 1964. Those becoming untraveled, discon- tinued, legal trails or post roads. Explain under para- graphs 2 and 3 below.							
TOTAL TRAVELED ROADWAYS Feb. 10, 1965							87,733

1. We hereby certify that the following new highways, as substantiated by the attached "Selectmen's Certificate of Completion," have been added since March 15, 1964:

2. We hereby certify that the following highways have been discontinued, or changed to trails or post roads according to statute, since March 15, 1964, as substantiated by the attached copy of the proceedings:

3. We hereby certify that the following roads have become untraveled since March 15, 1964:

SELECTMEN:

*George J. Royal*  
*Leon Marshall*  
*Ralph Arthur*

In the county of Orange  
1965 personally approved *George J. Royal*

At Williamstown

the 27<sup>th</sup> day of January

Signature of Leon Marshall and Ralph Arthur  
and other members in the presence of the foregoing witnesses by them subscribed.

Before me,

*Donald P. McNeill*  
*Notary Public*

(Town Clerk should fill out following and mail one white and one yellow copy to the Commissioner of State, 100 State Street, Montpelier, Vermont, on or before February 10, 1965.)

I, Donald P. McNeill, Clerk of the Town of Williamstown, hereby certify that the foregoing is a true and correct copy of the original of the Selectmen's Certificate of Highway Mileage, filed with me on the date above stated.

# CERTIFICATE OF HIGHWAY MILEAGE

FOR YEAR ENDING FEBRUARY 10, 1964

Fill out in triplicate and file with your Town Clerk on or before February 10, 1964

State sections of Vermont Statutes Annexed on reverse side of this sheet

We, the Selectmen of the town of Williamstown, on each year that we have carefully examined all the traveled Highways in this town and find that the total mileage of traveled Highways according to Title 12, V.S.A., Sec. 12, amended 1961, Act No. 18, not including post roads and trails, in this town for the year ending February 10, 1964, is as follows:

	MILEAGE IN TOWN <small>(Outside of village incorporated for highways)</small>			MILEAGE IN VILLAGES <small>(Incorporated for highways)</small>			Total All Highways
	WILLIAMSTOWN						
	Town Highways	State Aid Highways	State Highways	Town Highways	State Aid Highways	State Highways	
PREVIOUS MILEAGE as shown March 15, 1963	67.61	13.290	6.833				87.733
HIGHWAYS ADDED Since March 15, 1963, ac- cording to statute. Explain under paragraph 1 below.							
SUB-TOTAL							
HIGHWAYS SUBTRACTED Since March 15, 1963. These becoming untraveled, discon- tinued, legal trails or post roads. Explain under para- graphs 2 and 3 below.							
TOTAL TRAVELED HIGHWAYS Feb. 10, 1964	67.61	13.290	6.833				87.733

1. We hereby certify that the following new highways, as substantiated by the attached "Selectmen's Certificate of Completion," have been added since March 15, 1963:

2. We hereby certify that the following highways have been discontinued, or changed to trails or post roads according to statute, since March 15, 1963, as substantiated by the attached copy of the proceedings:

3. We hereby certify that the following roads have become untraveled since March 15, 1963:

SELECTMEN:

*George T. McCall*  
*George Joynt*  
*Leah Mustard*

At

Williamstown

in the county of

Craig

the

14 day of February

1964 personally appeared

George T. McCall, George Joynt and Leah Mustard

Selectmen of

and made such to the truth of the foregoing affidavit by them subscribed.

Witness my

*George T. McCall*  
*George Joynt*  
*Leah Mustard*

(Town Clerk should fill out following and mail one white and one yellow copy to the Commissioner of Vermont, on or before March 15, 1964.)

I hereby certify that the foregoing is a true copy of record of the proceedings of the Selectmen of the town of Williamstown relating to highway mileage, filed and recorded in the records of the town of Williamstown.

# CERTIFICATE OF HIGHWAY MILEAGE

FOR YEAR ENDING FEBRUARY 10, 1963

Fill out in triplicate and file with your Town Clerk on or before February 10, 1963

(Note sections of Vermont Statutes Annotated on reverse side of this sheet)

We, the Selectmen of the town of Williamstown do hereby certify that we have carefully examined all the traveled highways in this town and find that the total mileage of traveled highways according to Title 19 V.S.A. Sec. 15, amended 1961, Act No. 78, not including post roads and trails, in this town for the year ending February 10, 1963, is as follows:

	MILEAGE IN TOWN <small>(Outside of villages incorporated for highways)</small>			MILEAGE IN VILLAGE <small>(Incorporated for highways)</small>			Total All Systems
	Williamstown						
	Town Highways	State Aid Highways	State Highways	Town Highways	State Aid Highways	State Highways	
PREVIOUS MILEAGE as shown March 15, 1961	67.61	13,290	6,833				87,733
HIGHWAYS ADDED Since March 15, 1961, ac- cording to statute. Explain under paragraph 1 below.							
SUB-TOTAL							
HIGHWAYS SUBTRACTED Since March 15, 1961. These including untraveled, discon- tinued, legal trails or post roads. Explain under para- graphs 2 and 3 below.							
TOTAL TRAVELED HIGHWAYS Feb. 10, 1963	67.61	13,290	6,833				87,733

1. We hereby certify that the following new highways, as substantiated by the attached "Selectmen's Certificate of Completion," have been added since March 15, 1962:

2. We hereby certify that the following highways have been discontinued, or changed to trails or post roads according to statute, since March 15, 1962, as substantiated by the attached copy of the proceedings:

3. We hereby certify that the following roads have become untraveled since March 15, 1962:

SELECTMEN: *Stanley MacKenzie*  
*George J. Kelly*  
*George J. Kelly*  
in the county of Orange

At Williamstown on the 30<sup>th</sup> day of January, 1963 personally appeared  
*Stanley MacKenzie, W. S. Kelly and George J. Kelly*  
Selectmen of Williamstown  
and made oath to the truth of the foregoing affidavits by them subscribed.

Before me, *Ronald P. [Signature]*  
Notary Public  
(My Comm. Exp. [Date])

(Town Clerk should fill out following and mail one white and one yellow copy to the Commissioner of Highways, Montpelier, Vermont, on or before March 15th.)

I, *Ronald P. [Signature]*, Clerk of the Town of Williamstown, hereby certify true and correct in a true copy of record of the proceedings of the Selectmen of Williamstown relating to highway mileage, filed and recorded as this date.

WILLIAM PORTER  
COMMISSIONER OF HIGHWAYS

Title 19, V.S.A., Sections 1 and 13  
SECTION OF STATE AND HIGHWAY



STATE OF VERMONT  
DEPARTMENT OF HIGHWAYS  
MONTPELIER

Highway Planning Division

March 7, 1962

Robert R. MacAkill  
Town Clerk  
Williamstown, Vermont

Dear Sirs:

We are enclosing for your records a map of the Town of Williamstown, as approved by the Commissioner of Highways on February 2, 1962. Also included is an extra map for your use.

The reselection certificate for the town records will be delivered to your office by the district highway engineer.

This is in accordance with Title 19, V.S.A., Sections 1 and 13 which states that "When an addition or deletion is made to state-aid highways, the Board shall make maps showing the highways which are added and/or deleted . . . . It shall also file a copy of the map of such highways in the office of the clerk of the town wherein said highways be. When such maps are so filed, the redesignation of such highways shall be deemed to have taken place . . . . A review and reselection of the state-aid highway mileage shall be made by the towns and the district highway engineer at least once in every 10-year period commencing in the year 1960."

When the map has been filed, would you please fill out and sign the enclosed forms, and return to this office.

Very truly yours,

H. F. Farrington  
Highway Planning Engineer

HFF/TWT/asm  
Encs.



C O P Y

Town of Williamstown

County of Orange

Vt. Hwy. Dist. No. 9

Total S.A. Mileage 13.29

Reelection & Re-measurement  
due to construction

Important town highways as required by Title 19, V.S.A., Sections 1 & 13:

No. 1 4.01 miles.

Beginning at Route 14 on Meadow Street in Williamstown Village  
extending (Give direction) northeasterly along Meadow Street, by Martin School,  
via Coldspring Corner and Foxville.  
ending at the Barra town line north of Foxville.

No. 2 4.30 miles.

Beginning at Route 14 in Williamstown on the Northfield Road  
extending (Give direction) westerly along the Northfield Road.  
ending at the Northfield town line; also known as the Whitcomb Road.

No. 3 0.95 miles.

Beginning at the Northfield town line on the Berlin Corner road  
extending (Give direction) northerly along the Berlin Corner road.  
ending at the Northfield town line.

No. 4 4.02 miles.

Beginning at Route 14 on the Chelsea Road  
extending (Give direction) southeasterly along the Chelsea road via Jackson's  
corner.  
ending at the Washington town line.

No. 5 miles.

Beginning at  
extending (Give direction)  
ending at

No. 6 miles.

Beginning at  
extending (Give direction)  
ending at

No. 7 miles

Beginning at

extending (Give direction)

ending at

No. 8 miles

Beginning at

extending (Give direction)

ending at

No. 9 miles

Beginning at

extending (Give direction)

ending at

No. 10 miles

Beginning at

extending (Give direction)

ending at

No. 11 miles

Beginning at

extending (Give direction)

ending at

We have this 12th day of January 1962 made the above

statement which is to supersede and replace any and all statements made prior to this date.

S/ George J. Jozal

S/ Finley MacKenzie

S/ George T. McHenry

Witness

at the

Place of

Business

Witness Name and Title

Approved

Jan 15 1962

Director, Fisheries Division

Jan 15 1962

Director, Fisheries Division

# CERTIFICATE OF HIGHWAY MILEAGE

FOR YEAR ENDING FEBRUARY 10, 1962

Fill out in triplicate and file with your Town Clerk on or before February 10, 1962

(Note sections of Vermont Statutes Annotated on reverse side of this sheet)

We, the Selectmen of the town of Williamstown, on each side state that we have carefully measured all the traveled highways in this town and find that the total mileage of traveled highways according to Title 19 V.S.A. Sec. 15, amended 1961, Act No. 28, but including pent roads and trails, in this town for the year ending February 10, 1962, is as follows:

	MILEAGE IN TOWN <small>(includes all roads designated for highways)</small>			MILEAGE IN VILLAGE <small>(designated as highways)</small>			Total AS System
	Williamstown						
	Town Highways	State Aid Highways	State Highways	Town Highways	State Aid Highways	State Highways	
<b>PREVIOUS MILEAGE</b> as shown March 15, 1961	66.66	14.320	6.833				87.813
<b>HIGHWAYS ADDED</b> Since March 15, 1961, according to statute. Explain under paragraph 1 below.	0.95						
<b>SUB-TOTAL</b>							
<b>HIGHWAYS SUBTRACTED</b> Since March 15, 1961. Those becoming untraveled, discontinued, legal trails or pent roads. Explain under paragraphs 2 and 3 below.		1.030		0.95 change in St Aid & Town Highway mileage due to 10-yr reselection. Balance of change in St Aid due to construction on SR-4			VNT
<b>TOTAL TRAVELED HIGHWAYS</b> Feb. 10, 1962	67.61	13.290	6.833				87.733

1. We hereby certify that the following new highways, as substantiated by the attached "Selectmen's Certificate of Completion" have been added since March 15, 1961:

2. We hereby certify that the following highways have been discontinued, or changed to trails or pent roads according to statute since March 15, 1961, as substantiated by the attached copy of the proceedings:

3. We hereby certify that the following roads have become untraveled since March 15, 1961:

SELECTSMEN

*Fredley MacKinnon*  
*George J. Carthy*  
*George J. Carthy*

in the county of Franklin  
personally appeared George J. Carthy

At Williamstown this 15th day of March 1962.

Subscribed and sworn to in the presence of the foregoing officers by them authorized.

Before me:

*Ronald G. [Signature]*

(When official use is required)

1. One copy of this sheet shall be sent following and shall be white and one yellow copy to the Commissioner of Vermont on or before March 15th.

2. *Ronald G. [Signature]* Clerk of the Town of Williamstown hereby certifies that the foregoing is a true copy of records of the committee of selectmen of this town relating to highway mileage. This was recorded at this date.

OFFICE OF THE  
COMMISSIONER



STATE OF VERMONT  
DEPARTMENT OF HIGHWAYS  
MONTPELIER  
Highway Planning Division

January 16, 1961

Board of Selectmen  
Williamstown, Vermont

Attention of Chairman

Gentlemen:

With regard to the completion of the enclosed Highway Mileage Certificates, all the travelled highways in your town were measured in 1959 by Mr. Guy Weaver, Agent authorized by Mr. George McCarthy, Selectman, with Mr. Cookson of this office, in accordance with Title 19, V. S. A., Section 15.

The resulting additions, subtractions and revisions are indicated on the enclosed map and explained on the attached breakdown sheets.

This information was forwarded to you in 1960, but when the Highway Mileage Certificates were received by this office it was necessary to send them back to the town for clarification and revision because the entries seemed to be at variance with the remeasurement figures forwarded to you. As they were never returned to the Highway Department, the changes in Highway Mileage have not become effective.

REVISION OF 1959 ROAD REASSESSMENT CHANGES

Would you please enter the amounts, to be added or subtracted, as

well as noting any other change that may have occurred on Town Highways during the past year.

- 0.30

Portion not travelled between Elm and North 1/2.

Very truly yours,

- 0.40

Portion not travelled between 2nd and 3rd from Northfield.

- 0.20

H. F. Farrington, untravelled between 2nd Highway Planning Engineers.

HFF/VNT/asm  
Encs.

- 0.60

Portion not travelled.

- 0.10

Portion not travelled beyond Realey under place.

untravelled between S.A. 2 and 1-50.

- 0.20

Portion not travelled between 1-50 and Northfield 1/2.

- 0.10

Portion untravelled from garage owned by Mrs. Henry Leland House.

untravelled portion now being travelled from 1st and Road place to camp.

Change request to travel 1/2 as agreed to by officials of both towns.

- 0.10

Portion not travelled between Mitchell and New House and old Fox Farm.

Change request to be as at end.

old road to be road between 1-50 and 2nd part under place.

old to be town road from St. 11 to old Fox Farm.

old to be town road between St. 11 and 1, and road between camp and Charles Road.

BREAKDOWN OF  
1959 ROAD MEASUREMENT CHANGES

<u>Map</u> <u>Sheet</u> <u>Section</u>	<u>Town</u> <u>Highway</u> <u>No.</u>	<u>Miles</u> <u>Added</u>	<u>Miles</u> <u>Subtracted</u>	<u>Explanation</u>
A	6		- 0.30	Portion now untraveled between farm and Berlin T/L.
C	15		- 0.87	Portion now untraveled between T-14 and DeFrance hayfield.
E	23		- 0.29	Portion now untraveled between T-4 and old Fred George place.
F	34		- 0.40	Road now untraveled.
G	35		- 0.17	Portion now untraveled beyond Wesley Rutledge place.
I	38	+ 0.08		Remasurement between S.A. 2 and T-50.
M	50		- 0.75	Portion now untraveled between T-56 and Northfield T/L.
N	51		- 0.16	Portion untraveled from gate to unused Vern Savary tenant house.
O	56	+ 0.20		Untraveled portion now being traveled from Albert Sneed place to camp.
P	57	+ 0.09		Remasurement to Brookfield T/L as agreed to by officials of both towns.
Q	59		- 0.32	Portion now untraveled between Mitchell's green house and old Fox Farm.
R	67	+ 0.05		Remasurement to house at end.
S	57A	+ 0.15		Said to be town road between T-56 and T-57 past Elaine place.
T	59A	+ 0.10		Said to be town road from Rt. 14 to old Fox farm.
U	60A	+ 0.10		Said to be town road between Rt. 14 and S. A. 5 past Gayette camp on Staples Pond.



EXPLANATIONS OF  
1959 ROAD MEASUREMENT CHANGES

<u>Map Sheet Letter</u>	<u>Town No.</u>	<u>Miles Added</u>	<u>Miles Subtracted</u>	<u>Explanation</u>
A	6		- 0.30	Portion now untravelled between farm and Berlin T/L.
C	15		- 0.87	Portion now untravelled between F-14 and DeFrance hayfield.
E	23		- 0.29	Portion now untravelled between T-6 and old Fred George place.
	34		- 0.40	Road now untravelled.
G	35		- 0.17	Portion now untravelled beyond Wesley Rutledge place.
I	38	✓ 0.08		Re-measurement between S.A. 2 and T-40.
M	50		- 0.75	Portion now untravelled between T-56 and Northfield T/L.
N	51		- 0.16	Portion untravelled from gate to unused Fern Savary tenant house.
O	56	✓ 0.10		Untravelled portion now being travelled from Albert Broad place to camp.
P	57	✓ 0.09		Re-measurement to Brookfield T/L as agreed to by officials of both towns.
	59		- 0.32	Portion now untravelled between Mitchell's green house and old Fox Farm.
R	67	✓ 0.05		Re-measurement to house at end.
S	57A	✓ 0.15		Said to be town road between T-56 and T-57 past Elaine place.
T	59A	✓ 0.10		Said to be town road from Ft. 14 to old Fox Farm.
	60A	✓ 0.10		Said to be town road between Ft. 14 and S. A. 5 past Corlette camp on Staples Road.

<u>Item</u> <u>Letter</u>	<u>Town</u> <u>Hwy.</u> <u>No.</u>	<u>Miles</u> <u>Added</u>	<u>Miles</u> <u>Substituted</u>	<u>Ex. Location</u>
1	Rowe St.	✓ 0.04		Said to be town road of W. Sawyer.
2	Elm St.	✓ 0.12		Said to be town road by W. Sawyer.
3	30		- 0.12	Re-measurement to Washington V/L, as agreed to by officials of both towns.
4	21	✓ 0.04		Re-measurement to Washington V/L, as agreed to by officials of both towns.
		✓ 0.87	- 3.38	

**NOTE:** If desired, a copy of this sheet may be attached to your mileage report in place of filling in Items 1, 2 and 3. If this is done, the copy should be signed by the Selectman and notarized, with reference to attached copy indicated under Items 1, 2 and 3. However, such a copy does not constitute a substitution for the Certificate of Completion and Opening to Public Travel required for new highways added.

STATE HIGHWAY BOARD

STATE OF VERMONT

CLYDE A. BEEBING, CHAIRMAN  
NUTLAND  
PORTER J. MOORE  
NEWBERRY  
FRANK B. HOWE, II  
BRANFORDTON



COMMISSIONER OF HIGHWAYS  
WILLIAM FOSTER  
EDWARD C. BROWN  
ROBERT C. BROWN  
ASSISTANT TO THE COMMISSIONER  
100 STATE ST.  
MONTPELIER, VERMONT

DEPARTMENT OF HIGHWAYS  
MONTPELIER

Highway Planning Division

April 29, 1960

Mr. Leon Howard  
Chairman, Board of Selectmen  
Williamstown, Vermont

Dear Sir:

Several weeks ago we returned your 1960 Road Mileage Certificates to you for review and possible change, but as they were never returned to this office, this is to inform you that your last years' mileage was used in our submission to the State Auditor.

These mileages are as follows:

Town Highways	69.17
State Aid Highways	14,580
State Highways	<u>6,515</u>
Total All Systems	90,312

Very truly yours,

H. F. Farrington  
Highway Planning Division

RFH/TRE/30

STATE HIGHWAY BOARD

CLEON A. PERRINE, CHAIRMAN  
RUTLAND  
PORTER J. MOORE  
NEWPORT  
FRANK E. HOWE, II  
BENNINGTON

STATE OF VERMONT



DEPARTMENT OF HIGHWAYS  
MONTPELIER

COMMISSIONER OF HIGHWAYS  
WILLIAM FOSTER  
CHIEF ENGINEER  
ROBERT E. BARRETT  
ASSISTANTS TO THE COMMISSIONER  
E. BEACH BLY  
WINDY P. BERRON

Highway Planning Division

March 30, 1960

Mr. Leon Howard  
Chairman, Board of Selectmen  
Williamstown, Vermont

Dear Sir:

Thank you for the prompt submission of your 1960 Road Mileage Certificates.

However, the entry on these certificates seems to be at variance with the remeasurement figures forwarded to you with our previous letter.

We are enclosing a "Sample Copy" of a Road Mileage Certificate, indicating the manner in which the entries should be made on the basis of the 1959 Remeasurement with Mr. Guy Seaver, Agent authorized by Mr. George McCarthy, Selectman.

Title 19, V.S.A., Section 15, states, in part, "The Selectmen of each town, with the assistance of a representative of the State Highway Board shall measure the travelled highways defined in Section 1 of this title, at least once every ten years, not including pent roads and trails. Annually, on or before March 15, the Selectmen shall file with the Town Clerk a sworn statement of the description and measurement of all highways including all new highways built and all highways discontinued, during the year previous thereto, not including pent roads and trails."

This measurement was done the 20th, 21st and 22nd of July 1959, by Mr. Guy Seaver, with Mr. Cookson of this office, as the attached photocopy will verify.

ALLEN A. FERRINE, CHAIRMAN  
 RUTLAND  
 ROBERT J. MOORE  
 WASHINGTON  
 FRANK E. HUBBARD  
 BURLINGTON



COMMISSIONER OF HIGHWAYS  
 WILLIAM FOSTER  
 LURET E. HENNING  
 ROBERT E. BARNETT  
 ASSISTANTS TO THE COMMISSIONER  
 E. BEACH RAY  
 WILSON C. BURNHAM

DEPARTMENT OF HIGHWAYS  
 MONTPELIER

Highway Planning Division

March 30, 1960

Mr. Leon Howard  
 Chairman, Board of Selectmen  
 Williamstown, Vermont

Dear Sir:

Thank you for the prompt submission of your 1960 Road Mileage Certificates.

However, the entry on these certificates seems to be at variance with the measurement figures forwarded to you with our previous letter.

We are enclosing a "Sample Copy" of a Road Mileage Certificate, indicating the manner in which the entries should be made on the basis of the 1959 measurement with Mr. Guy Beaver, Agent authorized by Mr. George McCarthy, Selectman.

Title 19, V.S.A., Section 15, states, in part, "The Selectmen of each Town, with the assistance of a representative of the State Highway Board shall measure the travelled highways defined in Section 1 of this title, at least once every ten years, not including pent roads and trails. Annually, on or before March 15, the Selectmen shall file with the Town Clerk a sworn statement of the description and measurement of all highways including all new highways built and all highways discontinued, during the year previous thereto, not including pent roads and trails."

This measurement was done the 20th, 21st and 22nd of July 1959, by Mr. Guy Beaver, with Mr. Jackson of this office, as the attached photocopy will verify.

- 2 -

Perhaps you do not desire to make any other additions to your town mileage other than those supported by Affidavits or Certificates, and we respect your wishes in this matter. However, in any event, the 3.26 miles of roads listed as not travelled, on the accompanying "breakdown sheet of reassessment changes," should be deducted from your Town Highway mileage.

We would appreciate clarification of the entry of 0.18 mile made for Howe Street and Elm Street, as the Affidavits accompanying the mileage certificates figure out to 0.08 mile for Howe Street and 0.10 mile for Elm Street, for a total of 0.18 mile.

We have entered these streets as 0.14 mile on the "Sample Copy", but have made no totals, noting that these entries are subject to review and possible change when making out your mileage certificates.

As our deadline of April 1st is very near, we respectfully urge that this matter be given prompt attention and as your original submission was received prior to April 1st, we can allow you until the 5th of April for the return of these papers. After that date it will be necessary to use your previous mileage.

Very truly yours,

M. F. Farrington  
Highway Planning Engineer

RFF/WPC/jh

Encs.



STATE HIGHWAY BOARD

CLEON A. PERKINS, Chairman  
NUTLAND  
MONTGOMERY J. LADD, Secretary  
FRANK E. HOWE, D.  
State Representative

STATE OF VERMONT



COMMISSIONER OF HIGHWAYS  
WILLIAM FOSTER  
EDWARD W. WATSON  
ROBERT E. BARNETT  
ASSISTANT TO THE COMMISSIONER  
E. BRADY BLY  
WILSON OR MANAGER

DEPARTMENT OF HIGHWAYS  
MONTPELIER

March 10, 1960

George T. McCarthy, Chairman  
Board of Selectmen  
Williamstown, Vermont

Dear Sirs:

We are enclosing for your records a selection of state-aid highways in the town of Williamstown, as approved by the Commissioner of Highways on March 4, 1960.

Very truly yours,

H. F. Farrington  
Highway Planning Engineer

HFF:ML:th

the Northfield town line.

1.02

miles

Route 77, 1/4 on the Chelsea road

southeasterly along the Chelsea road via Jackson's Corner

Washington town line.

0.95

miles

Route 77, 1/4 at Dr. Martin's corner

southeasterly along the north side of Staples Pond,

STATE HIGHWAY BOARD

STATE OF VERMONT

CLEGG A. PERKINS, CHAIRMAN  
RUTLAND  
PORTER J. MOORE  
NEWFANE  
FRANK E. HOWE, II  
BENNINGTON



COMMISSIONER OF HIGHWAYS  
WILLIAM FORTEN  
CHIEF ENGINEER  
ROBERT S. GARDNER  
ASSISTANTS TO THE COMMISSIONER  
R. DEAN DILL  
GREGG A. SHERIDAN

DEPARTMENT OF HIGHWAYS  
MONTPELIER

March 10, 1960

R. F. Taylor  
District Engineer  
Montpelier, Vermont

Dear Sir:

We are enclosing for your records a selection of state-aid highways in the Town of Williamstown, as approved by the Commissioner of Highways on March 4, 1960.

This is in connection with re-measurement due to 1959 construction.

Also enclosed is a letter of transmittal to the Chairman of the Board of Selectmen.

Very truly yours,

W. B. [Signature]

HFF:HL:th

ending at the Northfield town line.

to 4.02 miles

beginning at Route Vt. 14 on the Chelsea road

extending (over direction) southeasterly along the Chelsea road via Jackson's Corner

ending at Washington town line.

to 0.95 miles

beginning at Route Vt. 14 at Mr. Martin's corner

extending (over direction) southeasterly along the north side of Staples Road,

*228*  
HIGHWAY DEPARTMENT

OFFICE MEMORANDUM

TO: A. D. Bishop, Chief Engineer  
FROM: H. P. Farrington, Highway Planning Engineer  
DATE: February 24, 1940  
SUBJECT:

The attached selection certificates, for your approval, reflect changes in State Aid mileage due to 1939 construction in the Towns of Williston and Rutland.

HFF/VHC/bjf

Attach.

RD-298 808-7-39

ending at the Northfield town line; also known as the Whitecomb Road.

No. 3 0.95 miles.

Beginning at the Northfield town line on the Berlin Corner road  
extending (Give direction) northerly along the Berlin Corner road

ending at the Northfield town line.

No. 4 4.02 miles.

Beginning at Route Vt. 14 on the Chelsea road  
extending (Give direction) southeasterly along the Chelsea road via Jackson's Corner

ending at Washington town line.

No. 5 0.95 miles.

Beginning at Route Vt. 14 at Dr. Martin's corner  
extending (Give direction) southwesterly along the north side of Staples Pond.

HIGHWAY DEPARTMENT

OFFICE MEMORANDUM

TO: A. D. Bishop, Chief Engineer

FROM: W. F. Farrington, Highway Planning Engineer

DATE: February 24, 1960

SUBJECT:

The attached selection certificates, for your approval, reflect changes in State Aid mileage due to 1959 construction in the Towns of Williston and Rutland.

HFF/VHF/bjE

Attach.

RD 234 SON 7.59

ending at the Northfield town line; also known as the Whiteoak Road,

to 0.95 miles.

Beginning at the Northfield town line on the Berlin Corner road

extending (Give direction) northerly along the Berlin Corner road

ending at the Northfield town line.

to 6.02 miles

Beginning at Route Vt. 14 on the Chelsea road

extending (Give direction) southeasterly along the Chelsea road via Jackson's Corner

ending at Washington town line.

to 0.96 miles

Beginning at Route Vt. 14 at Dr. Martin's corner

extending (Give direction) southeasterly along the north side of Staples Road,

TO: R. F. Taylor, District Engineer  
FROM: H. F. Farrington, Highway Planning Engineer  
DATE: February 15, 1960  
SUBJECT:

The attached selection certificates for the town of Williamstown, reflect a change in mileage on SA-4, due to 1959 construction.

It is important that we receive these as soon as possible to be included with the March Report.

HFY/VMT/jh

HD-296 SCH-7-59

ending at the Northfield town line; also known as the Whitcomb Road.

No. 3 0.95 miles.

Beginning at (the Northfield town line on the Berlin Corner road

extending (Give direction) northerly along the Berlin Corner road

ending at the Northfield town line.

No. 4 4.02 miles.

Beginning at Route Vt. 14 on the Chelsea road

extending (Give direction) southeasterly along the Chelsea road via Jackson's Corner

ending at Washington town line.

No. 5 0.95 miles.

Beginning at Route Vt. 14 at Dr. Martin's corner

extending (Give direction) southeasterly along the north side of Douglas Road,

SELECTION OF STATE AID HIGHWAYS

Town of **Williamstown**  
 County of **Orange**  
 Vt. Hwy. Dist. No. **9**  
 Total S. A. Mileage **14.24**

(Measurement due to 1959 construction)

Impassable town highways as reported by Sections 4903, 4916 and 4921 of the Vermont Statutes, Revision of 1947.

No. 1 **4.08** miles

Beginning at **Route Vt. 14 on Hoador Street in Williamstown Village**  
 extending (Give direction) **northeasterly along Hoador Street, by Martin School, via Goldspring Corner and Foxville.**  
 ending at **the Barre town line north of Foxville.**

No. 2 **4.30** miles

Beginning at **Route Vt. 14 in Williamstown on the Northfield Road**  
 extending (Give direction) **westerly along the Northfield Road,**  
 ending at **the Northfield town line; also known as the Whitcomb Road.**

No. 3 **0.95** miles

Beginning at **the Northfield town line on the Berlin Corner road**  
 extending (Give direction) **northerly along the Berlin Corner road**  
 ending at **the Northfield town line.**

No. 4 **4.02** miles

Beginning at **Route Vt. 14 on the Chelsea road**  
 extending (Give direction) **southeasterly along the Chelsea road via Jackson's Corner**  
 ending at **Washington town line.**

No. 5 **0.95** miles

Beginning at **Route Vt. 14 at Dr. Martin's corner**  
 extending (Give direction) **southeasterly along the north side of Stephen Road,**  
 ending at **Route Vt. 14, near the north end of Williamstown Hill.**

No. 6 **0.00** miles

Beginning at  
 extending (Give direction)

ending at



No. 7 miles

Beginning at

extending (Give direction)

ending at

No. 8 miles

Beginning at

extending (Give direction)

ending at

No. 9 miles

Beginning at

extending (Give direction)

ending at

We have this 18th day of February, 1960, made the above

selection which is to supersede and replace any and all selections made prior to this time.

Clifton Howard  
Road Commissioner

George T. McCarty

Leon Howard

J. E. Bruce

Selectmen  
of the  
Town of

Williamstown, Vermont

Effective April 2, 1960  
By authority of Highway  
Board Policy dated  
April 11, 1958.

Approved:

February 19, 1960

R. F. Taylor

District Highway Engineer

March 1, 1960

STATE HIGHWAY BOARD

William Foster  
Commissioner of Highways

SELECTION OF STATE AID HIGHWAY

Town of Williamstown

County of GREEN

Vt. Hwy. Dist. No. 9

Total S. A. Mileage 14.24

(Re-measurement due to 1959 construction.)

Important town highways as required by Sections 490, 491B and 492I of the Vermont Statutes, Revision of 1947.

No. 1 5.02 miles

Beginning at Route Vt. 14 on Meadow Street in Williamstown Village

extending (Give direction) northeasterly along Meadow Street, by Martin School, via

Collispring Corner and Foxville.

ending at the Ferris town line north of Foxville.

No. 2 1.30 miles

Beginning at Route Vt. 14 in Williamstown on the Northfield Road

extending (Give direction) westerly along the Northfield Road,

ending at the Northfield town line; also known as the Whitcomb Road.

No. 3 0.95 miles

Beginning at the Northfield town line on the Berlin Corner road

extending (Give direction) northerly along the Berlin Corner road

ending at the Northfield town line.

No. 4 4.02 miles

Beginning at Route Vt. 14 on the Chelsea road

extending (Give direction) southeasterly along the Chelsea road via Jackson's Corner

ending at Washington town line.

No. 5 0.75 miles

Beginning at Route Vt. 14 at Dr. Martin's corner

extending (Give direction) southeasterly along the north side of Staples Road,

ending at Route Vt. 14, near the north end of Williamstown Golf.

No. 6

Beginning at

extending (Give direction)

ending at

SELECTION OF STATE AID HIGHWAY

Town of Williamstown

County of Orange

Vt. Hwy. Dist. No. 2

Total E. A. Mileage 14.24

(Re-measurement due to 1959 construction.)

Important town highways as required by Sections 4903, 4915 and 4921 of the Vermont Statutes, Revision of 1947:

No. 1 4.02 miles

Beginning at Route Vt. 14 on Meadow Street in Williamstown Village  
 extending (Give direction) northeasterly along Meadow Street, by Martin School, via  
 Coldspring Corner and Foxville.  
 ending at the Barre town line north of Foxville.

No. 2 4.30 miles

Beginning at Route Vt. 14 in Williamstown on the Northfield Road  
 extending (Give direction) westerly along the Northfield Road,  
 ending at the Northfield town line; also known as the Whitcomb Road.

No. 3 0.95 miles

Beginning at the Northfield town line on the Berlin Corner road  
 extending (Give direction) northerly along the Berlin Corner road  
 ending at the Northfield town line.

No. 4 4.02 miles

Beginning at Route Vt. 14 on the Chelsea road  
 extending (Give direction) southeasterly along the Chelsea road via Jackson's Corner  
 ending at Washington town line.

No. 5 0.95 miles

Beginning at Route Vt. 14 at Dr. Martin's corner  
 extending (Give direction) southwesterly along the north side of Staples Pond,  
 ending at Route Vt. 14, near the south end of Williamstown Hill.

No. 6

Beginning at  
 extending (Give direction)

ending at

No. 7 ..... miles.

Beginning at .....

extending (Give direction) .....

ending at .....

No. 8 ..... miles.

Beginning at .....

extending (Give direction) .....

ending at .....

No. 9 ..... miles.

Beginning at .....

extending (Give direction) .....

ending at .....

We have this 18th day of February, 1960, made the above

selection which is to supersede and replace any and all selections made prior to this time.

Clifton Hazard  
Road Commissioner

George T. McDarty

Leon Hazard

J. R. Bruce

Members  
of the  
Town of

Williamstown, Vermont

Effective April 1, 1960  
by authority of Highway  
Board Policy dated  
April 11, 1958.

Approved:

February 19, 1960

E. P. Taylor

District Highway Engineer

March 4, 1960

STATE HIGHWAY BOARD

William Foster  
Commissioner of Highways

STATE HIGHWAY BOARD

STATE OF VERMONT

COMMISSIONER OF HIGHWAYS

CLEON A. PERKINS, CHAIRMAN

WILLIAM POTTER

RYLAND

CHIEF ENGINEER

PORTER J. MOORE

HUBERT E. ADAMS

NEWPORT

ASSISTANTS TO THE COMMISSIONER

FRANK BROWN

E. BEACH

REEDINGTON

WINGNA D. BISHOP

DEPARTMENT OF HIGHWAYS

MONTPELIER

Highway Planning Division

February 16, 1960

Highway Planning Engineer

Board of Selectmen  
Williston, Vermont

Attention of Chairman

Gentlemen:

With regard to the completion of the enclosed Road Mileage Certificates, all the travelled highways in your town were measured in 1959 by Mr. Guy Sawyer, Agent authorized by George McCarthy, Selectman, with Mr. Cookson of this office, in accordance with Title 19, V.S.A., Section 15.

The resulting additions, subtractions and revisions are indicated on the enclosed map and explained on the attached breakdown sheets.

In order that highways 57A, 59A and 60A may be added to your Town mileage, it is necessary that we have Certificates of Completion and Opening to Public Travel, and we have enclosed suggested forms of this certificate for your convenience.

To substantiate the addition of Town Highways Home Street and Elm Street to your Town mileage, it will be necessary that the enclosed affidavits be completed and returned with your Road Mileage Certificates.

February 16, 1960

We have noted the change in State Aid Mileage on the enclosed certificates for your convenience. Would you please enter the amounts, to be added or subtracted, from your Town mileage, on your mileage certificates.

Very truly yours,

H. F. Ferrington  
Highway Planning Engineer

HFF/VNT/ccs

Encls.

1		
2		
3		
4		
5		
6		
7		
8		
9		
10		
11		
12		
13		
14		
15	1.10	
16		
17	3.75	
18		
19		
20		
21		
22		
23		
24		
25		
26		
27		
28		
29		
30		
31		
32		
33		
34		
35		
36		
37		
38		
39		
40		
41		
42		
43		
44		
45		
46		
47		
48		
49		
50		
51		
52		
53		
54		
55		
56		
57		
58		
59		
60		
61		
62		
63		
64		
65		
66		
67		
68		
69		
70		
71		
72		
73		
74		
75		
76		
77		
78		
79		
80		
81		
82		
83		
84		
85		
86		
87		
88		
89		
90		
91		
92		
93		
94		
95		
96		
97		
98		
99		
100		



BREAKDOWN OF  
1959 ROAD MEASUREMENT CHANGES

State Aid Rwy. No.	Miles Added	Miles Subtracted	Explanation
6		- 0.08	Due to construction and relocation between Route Vt. 14 and Town Highway 22.
Town Rwy. No.	Miles Added	Miles Subtracted	Explanation
6		- 0.30	Portion now untravelled between farm and Berlin T/L.
15		- 0.87	Portion now untravelled between T-14 and Dafrean hayfield.
23		- 0.29	Portion now untravelled between T-6 and old Fred George place.
34		- 0.40	Road now untravelled.
35		- 0.17	Portion now untravelled beyond Wesley Rutledge place.
38	+ 0.08		Re-measurement between 34-2 and T-30.
48		- 0.23	Re-measurement between 34-2 and T-57.
50		- 0.75	Portion now untravelled between T-56 and Northfield T/L.
51		- 0.16	Portion untravelled from gate to unused Vern Severy tenant house.
56	+ 0.10		Untravelled portion now being travelled from Albert Snow place to camp.
57	+ 0.09		Re-measurement to Brookfield T/L as agreed to by officials of both towns.
58		- 0.32	Portion now untravelled between Mitchell's Greenhouse and old Fox farm.
59	+ 0.35		Re-measurement to house at end.
59a	+ 0.19		Said to be Town road between T-56 and T-57 past Blaine place.

RECORDS OF  
1950 ROAD REPAIRS CLASSIC

Item No.	Amount	Description	Remarks
19A	+ 0.10		Said to be from road from St. 14 to old farm.
20A	+ 0.10		Said to be from road between St. 14 and St. 15 post Office camp on Staples Road.
21A	+ 0.04		Said to be from road by Mr. Sawyer.
21B	+ 0.10		Said to be from road by Mr. Sawyer.
22	- 0.10		Reimbursement to Washington T/A as agreed to by officials of both towns.
23	+ 0.06		Reimbursement to Washington T/A as agreed to by officials of both towns.
	+ 0.07	- 3.01	

RECAPITULATION OF  
1939 ROAD MEASUREMENT CLASSERS

Town High. No.	Miles Added	Miles Subtracted	Explanation
59A	+ 0.10		Said to be Town road from Vt. 14 to old Fox farm.
60A	+ 0.10		Said to be Town road between Vt. 14 and SA-5 past Coyette camp on Staples Road.
Howe Street	+ 0.04		Said to be Town road by Mr. Sawyer.
Kim Street	+ 0.12		Said to be Town road by Mr. Sawyer.
20		- 0.12	Measurement to Washington T/L. as agreed to by officials of both towns.
21	+ 0.04		Measurement to Washington T/L. as agreed to by officials of both towns.
	+ 0.87	- 3.01	