

CERTIFICATE OF HIGHWAY MILEAGE  
YEAR ENDING FEBRUARY 10, 2016

Fill out form, make and file copy with the Town Clerk, and mail ORIGINAL, before February 20, 2016 to:  
Vermont Agency of Transportation, Division of Policy, Planning and Intermodal Development, Mapping Section  
One National Life Drive, Montpelier, VT 05633.

We, the members of the legislative body of THETFORD in ORANGE County  
on an oath state that the mileage of highways, according to Vermont Statutes Annotated, Title 19, Section 305,  
added 1985, is as follows:

PART I - CHANGES TOTALS - Please fill in and calculate totals.

Town Highways	Previous Mileage	Added Mileage	Subtracted Mileage	Total	Scenic Highways
Class 1	0.000			0.000	0.000
Class 2	14.230			14.230	0.000
Class 3	48.91			48.91	0.000
State Highway	26.335			26.335	0.000
<b>Total</b>	<b>89.475</b>			<b>89.475</b>	<b>0.000</b>
* Class 1 Lane	0.000				
* Class 4	9.91		.50	9.41	0.000
* Legal Trail	0.00				

\* Mileage for Class 1 Lane, Class 4, and Legal Trail classifications are NOT included in total.

PART II - INFORMATION AND DESCRIPTION OF CHANGES SHOWN ABOVE.

1. NEW HIGHWAYS: Please attach Selectmen's "Certificate of Completion and Opening".
2. DISCONTINUED: Please attach SIGNED copy of proceedings (minutes of meeting).  
0.50 mi CL4 TH-80 Discontinued  
Documentation sent with 2015 certification.
3. RECLASSIFIED/REMEASURED: Please attach SIGNED copy of proceedings (minutes of meeting).
4. SCENIC HIGHWAYS: Please attach a copy of order designating/discontinuing Scenic Highways.

IF THERE ARE NO CHANGES IN MILEAGE: Check box and sign below. [ ]

PART III - SIGNATURES - PLEASE SIGN.

Selectmen/ Aldermen/ Trustees Signatures:

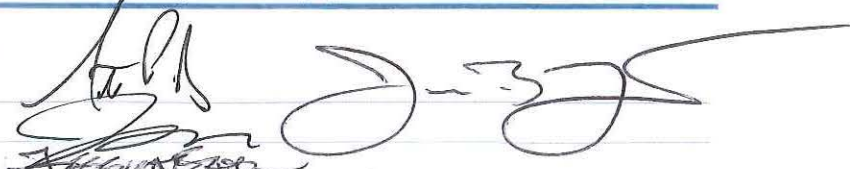

T/C/V Clerk Signature:

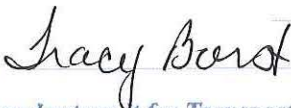

Date Filed:

2/17/16

Please sign ORIGINAL and return it for Transportation signature.

AGENCY OF TRANSPORTATION APPROVAL: Signed copy will be returned to T/C/V Clerk.

APPROVED:

  
Representative, Agency of Transportation

DATE:

5/12/2016

**Received**

**FEB 19 2016**

**Policy, Planning & Intermodal  
Development Division**

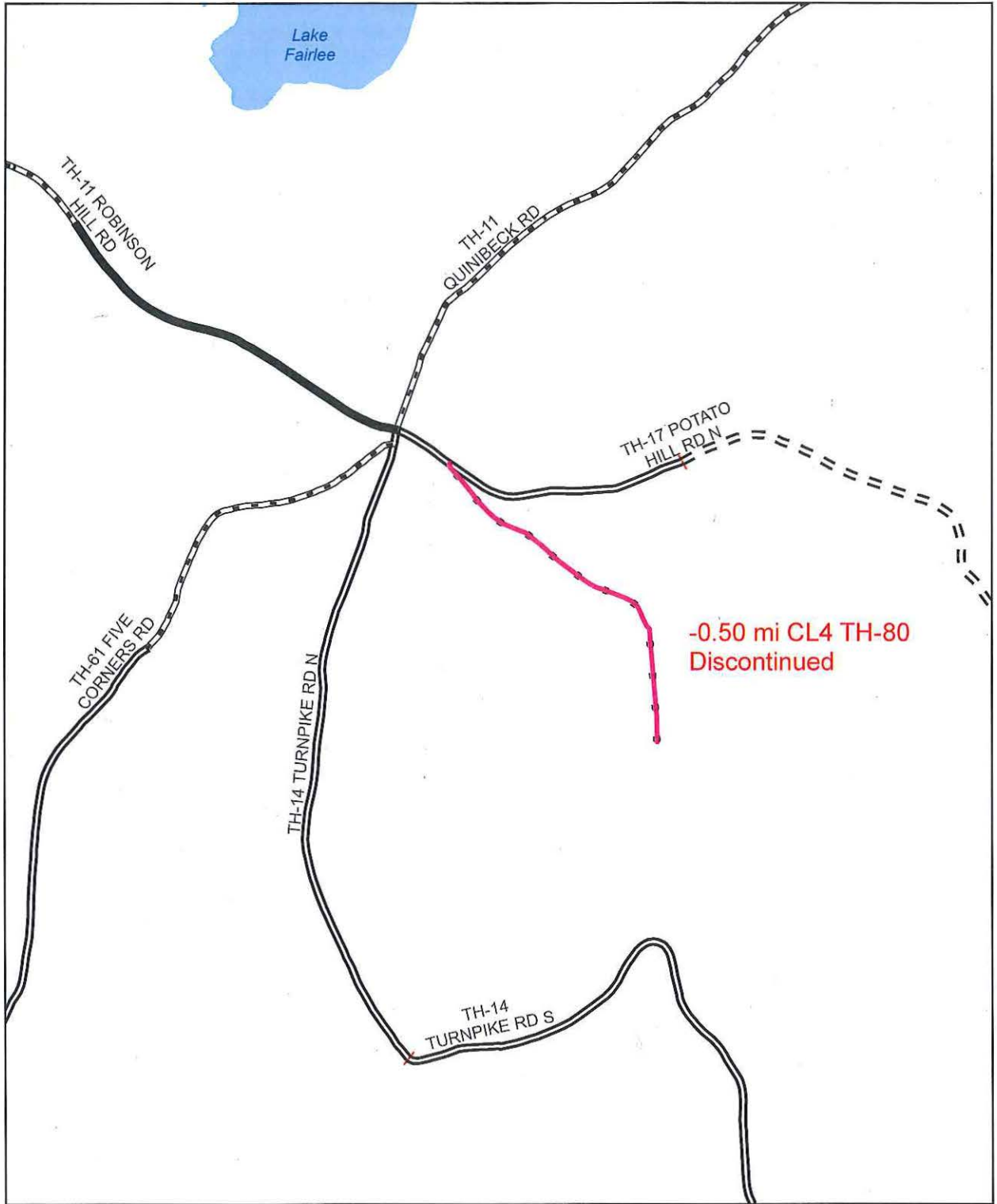

**Mileage Certificate Change 2016**  
**THETFORD**  
 (CTCODE: 0911)

Mapping Section  
 Division of Policy, Planning and Intermodal Development  
 Vermont Agency of Transportation - March 2016

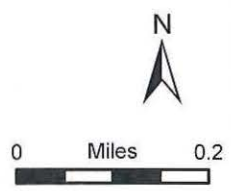





State of Vermont  
Division of Policy, Planning & Intermodal Development  
Mapping Section  
1 National Life Drive  
Montpelier, VT 05633-5001  
<http://vtrans.vermont.gov>

*Agency of Transportation*

Telephone: 802-828-2600  
Fax: 802-828-2334  
Email: [johnathan.croft@state.vt.us](mailto:johnathan.croft@state.vt.us)

July 1, 2015

Stuart Rogers, Selectboard Chair  
Town of Thetford, c/o Town Clerk  
PO Box 126  
Thetford Center, VT 05075

Dear Mr. Rogers,

The VTrans Mapping Section has not accepted some of the changes submitted on Thetford's 2015 Certificate of Highway Mileage, due in part to a lack of documentation of evidence of legal establishment.

VTrans sent a letter on March 5, 2015 to the Town of Thetford requesting documentation regarding the establishment and no documents have been received to date. The Vermont Supreme Court decision, *Austin v. Town of Middlesex*, 2009 VT 102 (Oct. 27, 2009) has reaffirmed the need for documentation showing the legal establishment of town highways. A copy of this decision can be found at the following link –

<http://info.libraries.vermont.gov/supct/current/eo2008-428.html>

The additions and changes noted on the Mileage Certificate that were not accepted are as follows:

**TH-88 Phelps Rd**

**Connector for Whipoorwill TH-28 and Poor Farm Rd North TH-24**

These two roads were not added due to the lack of documentation showing the legal establishment of these highways through the formal laying out process or "dedication and acceptance".

**TH-49 Old Stone Rd**

For reasons explained in the March 5<sup>th</sup> letter, we did not process the renumbering of TH-7 to TH-49.

**TH-80 Ware Rd**

Due to an oversight by the Mapping Section, the discontinuance of TH-80 Ware Rd was not processed and incorporated into the 2015 Town Highway Map. We will include it in the 2016 Mileage Certificate.

The changes that were listed on the 2015 Certificate of Highway Mileage may be re-submitted on the 2016 Certificate with documentation as evidence of legal establishment for review and the potential inclusion on the 2016 Town Highway Map.

Please feel free to contact me with any questions or comments related to this letter, or mapping in general.

Sincerely,



Johnathan Croft  
AOT GIS Database Administrator  
VTrans Mapping Section

JFC/jfc

Enclosures

cc: Michele Boomhower, Director of the VTrans Policy, Planning & Intermodal Development Division  
John Dunleavy, Assistant Attorney General  
Tammy Ellis, District Transportation Administrator  
Jackie Cassino, VTrans Transportation Planning Coordinator

Entered on Cert 11/18/2015



State of Vermont  
Division of Policy, Planning & Intermodal Development  
Mapping Section  
1 National Life Drive  
Montpelier, VT 05633-5001  
<http://vtrans.vermont.gov>

Agency of Transportation

Telephone: 802-828-2600  
Fax: 802-828-2334  
Email: [johnathan.croft@state.vt.us](mailto:johnathan.croft@state.vt.us)

July 1, 2015

CTCODE 0911

Stuart Rogers, Selectboard Chair  
Town of Thetford, c/o Town Clerk  
PO Box 126  
Thetford Center, VT 05075

Dear Mr. Rogers,

The VTrans Mapping Section has not accepted some of the changes submitted on Thetford's 2015 Certificate of Highway Mileage, due in part to a lack of documentation of evidence of legal establishment.

VTrans sent a letter on March 5, 2015 to the Town of Thetford requesting documentation regarding the establishment and no documents have been received to date. The Vermont Supreme Court decision, *Austin v. Town of Middlesex*, 2009 VT 102 (Oct. 27, 2009) has reaffirmed the need for documentation showing the legal establishment of town highways. A copy of this decision can be found at the following link –

<http://info.libraries.vermont.gov/supct/current/eo2008-428.html>

The additions and changes noted on the Mileage Certificate that were not accepted are as follows:

**TH-88 Phelps Rd**

**Connector for Whipoorwill TH-28 and Poor Farm Rd North TH-24**

These two roads were not added due to the lack of documentation showing the legal establishment of these highways through the formal laying out process or "dedication and acceptance".

**TH-49 Old Stone Rd**

For reasons explained in the March 5<sup>th</sup> letter, we did not process the renumbering of TH-7 to TH-49.

**TH-80 Ware Rd**

Due to an oversight by the Mapping Section, the discontinuance of TH-80 Ware Rd was not processed and incorporated into the 2015 Town Highway Map. We will include it in the 2016 Mileage Certificate.

0.50 miles CLASS = 4

The changes that were listed on the 2015 Certificate of Highway Mileage may be re-submitted on the 2016 Certificate with documentation as evidence of legal establishment for review and the potential inclusion on the 2016 Town Highway Map.



Doc ID: 000288740004 Type: LAN  
BK 151 PG 758-761

Received for Record at Thetford, VT  
On 10/15/2014 At 8:00:00 am

Town of Thetford Selectboard

*Lacey Bonet*

NOTICE OF DECISION  
DISCONTINUANCE OF WARE ROAD

**INTRODUCTION AND PROCEDURAL HISTORY**

1. This proceeding involves review of a proposal by the Selectboard to discontinue Ware Road and Trail in its entirety after residents living on that road questioned prior proceeding and the current status of the section of Ware Road that extended beyond the Northeastern corner of the Eaton Property.
2. On September 17, 2014 the Notice of Public Hearing was published in the Bradford Journal Opinion newspaper. (19 V.S.A. §709)
3. On September 17, 2014 a copy of a Notice of Public Hearing was posted in the Office of the Town Clerk and given to the Municipal Planning Commission. (19 V.S.A. §709)
4. On August 28, 2014 a copy of a Notice of Public Hearing was mailed to the following owners of properties adjoining the property subject to the application (19 V.S.A. §709) :  
  
Richard & Roberta Howard, Jeffrey & Leslie Fifield, Christopher & Jaqueline Wren, Jessica Eaton, Janice & Kenneth Robinson, J. Eaton, N. Byron & Etals, Wayne Parks, Ellen & Mark Helijas.
5. The proposal was considered by the Selectboard at a public site visit and hearing held on September 29, 2014. (19 V.S.A. §709)
6. Selectboard Members in attendance at the September 29, 2014 hearing included: Jessica Eaton, Stuart Rogers, John Bacon, Mike Pomeroy, and Donn Downey.
7. At the outset of the hearing an attendance sheet for interested parties was circulated and the following were in attendance: Rick Howard and Wayne Parks.
8. During the course of the hearings the following documents were submitted:
  - Notice of Public Hearing to Discontinue Ware Road and Trail in its Entirety

This exhibit is available in Thetford Zoning office. The Abutters Report and Map are attached.

**FINDINGS OF FACT**

1. The Town of Thetford owns .5 miles of a Class 4 Road known as Ware Road (TH#80) some of which is untraveled or impassable. Ware Road begins at an intersection off Potato Hill Road North and continues for .5 mile easterly as shown on the *Vermont General Highway Map for the Town of Thetford, prepared by the Vermont Agency of Transportation, Division of Policy, Planning and Intermodal Development, in Cooperation with the U.S. Department of Transportation and the Federal Highway Administration, mileage as of February 10, 2013, Map Prepared October 15, 2013.*
2. The ancient roads committee established that the "old" Ware Road extended approximately .50 mile from the end of Class 4 road as shown on the above mentioned map across the Howard Property to a point of intersection on the Parks property where it connects to Turnpike Road. This portion of Ware Road has not been maintained and is considered a legal trail by the Town of Thetford.
3. The Town of Thetford proposes to discontinue Ware Road and Trail in its entirety.

4. There were previous discussions at Selectboard Meetings as to the fate of Ware Road but there was no final decision filed in the Town Land Records that clearly identified the status of the roadway. Any previous decisions were determined to be null and void prior to warning for this discontinuance.
5. The Class 4 section of Ware Road is not regularly maintained by the Town of Thetford. Residents, specifically the Fifields, have had to repair the roadway many times due to storm events and because the road is owned by the Town and not them as individuals the work performed by them was not covered by their home owners insurance.
6. "Discontinued" means a previously designated town highway which through the process of discontinuance all public rights are reconveyed to the adjoining landowners. (19 V.S.A. §701)
7. There was no public comment by the interested parties in attendance.

**CONCLUSIONS AND DECISION**



After a site inspection and hearing no objection by the interested parties, the Selectboard finds that the public good, necessity, and convenience of the inhabitants of the municipality require that Ware Road and Trail be discontinued in its entirety with a complete description of the highway as follows:

The Class 4 road known as TH#80 or Ware Road, beginning at its intersection with Potato Hill Road South and traveling .5 miles to the southeast, as shown on the *Vermont General Highway Map for the Town of Thetford, prepared by the Vermont Agency of Transportation, Division of Policy, Planning and Intermodal Development, in Cooperation with the U.S. Department of Transportation and the Federal Highway Administration, mileage as of February 10, 2013, Map Prepared October 15, 2013* as well as the Trail portion of Ware Road between the point shown as the end of the Class 4 Section of Ware Road on the above mentioned map to the point it intersects Turnpike Road.

In accordance with 19 V.S.A §717, A person whose sole means of access to a parcel of land or portion thereof owned by that person is by way of a town highway or unidentified corridor that is subsequently discontinued shall retain a private right-of-way over the former town highway or unidentified corridor for any necessary access to the parcel of land or portion thereof and maintenance of his or her right-of-way.

Any person interested who objects may appeal pursuant to 19 V.S.A. § 740 and Rule 74 of the Vermont Rules of Civil Procedure to the Vermont Superior Court, Orange Unit, Civil Division within 30 days of the recording of this Order.

DATED at Thetford, Vermont, this 6 day of OCTOBER, 2014.

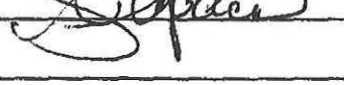
  
  
  
\_\_\_\_\_  
\_\_\_\_\_  
\_\_\_\_\_





# Find Results Report

Thetford, VT  
October 15, 2014

---

Parcel Number:	02-00-47	Mailing Address:	HOWARD RICHARD C & ROBERTA C
CAMA Number:	02-00-47		PO BOX 63
Property Address:	POTATO HILL RD N		NORTH THETFORD, VT 05054-0057

---

Parcel Number:	02-00-49	Mailing Address:	FIFIELD JEFFREY E & LESLIE D
CAMA Number:	02-00-49		PO BOX 87
Property Address:	WARE RD 386		POST MILLS, VT 05058

---

Parcel Number:	02-00-50	Mailing Address:	WREN CHRISTOPHER S WREN
CAMA Number:	02-00-50		JAQUELINE M B
Property Address:	QUINIBECK RD		26 QUINIBECK RD
			FAIRLEE, VT 05045

---

Parcel Number:	02-00-51	Mailing Address:	WREN CHRISTOPHER S WREN
CAMA Number:	02-00-51		JAQUELINE M B
Property Address:	QUINIBECK RD		26 QUINIBECK RD
			FAIRLEE, VT 05045

---

Parcel Number:	02-00-52.01	Mailing Address:	EATON J, BYRON N & ETALS
CAMA Number:	02-00-52.01		ROBINSON KENNETH B AND JANICE G
Property Address:	TURNPIKE RD N 367		329 TURNPIKE ROAD NORTH
			FAIRLEE, VT 05045

---

Parcel Number:	06-02-09	Mailing Address:	HELIJAS MARK A & ELLEN L H
CAMA Number:	06-02-09		PO BOX 663
Property Address:	TURNPIKE RD S 2296		HANOVER, NH 03755

---

Parcel Number:	06-02-11	Mailing Address:	PARKS WAYNE R
CAMA Number:	06-02-11		895 TURNPIKE ROAD NORTH
Property Address:	TURNPIKE RD N		FAIRLEE, VT 05055

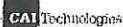

www.cai-tech.com

Data shown on this report is provided for planning and informational purposes only. The municipality and CAI Technologies are not responsible for any use for other purposes or misuse

10/15/2014

Page 1 of 1

Find Results Report - Thetford, VT

