

District 8  
 Certcode 0805-0

**CERTIFICATE OF HIGHWAY MILEAGE  
 YEAR ENDING FEBRUARY 10, 2020**

Fill out form, make and file copy with the Town Clerk, and mail ORIGINAL, before February 20, 2020 to:  
 Vermont Agency of Transportation, Division of Policy, Planning and Intermodal Development, Mapping Section  
 219 N. Main Street, Barre, VT 05641.

We, the members of the legislative body of **HYDE PARK** in **LAMOILLE** County  
 on an oath state that the mileage of highways, according to Vermont Statutes Annotated, Title 19, Section 305,  
 added 1985, is as follows:

**PART I - CHANGES TOTALS - Please fill in and calculate totals.**

Town Highways	Previous Mileage	Added Mileage	Subtracted Mileage	Total	Scenic Highways
Class 1	0.000	—	—	—	0.000
Class 2	13.830	—	—	13.830	0.000
Class 3	50.06	<del>+0.27</del> +0.19	<del>0.150</del>	<del>50.28</del> 50.26	0.000
State Highway	9.602	—	—	9.602	0.000
<b>Total</b>	<b>73.492</b>			<b>73.692</b>	<b>0.000</b>

S.M.

* Class 1 Lane	0.000	—	—	—	0.000
* Class 4	8.14	<del>+0.09</del>	<del>-0.05</del>	<del>0.05</del> 7.22	0.000
* Legal Trail	1.96	<del>+0.83</del> 0.85	—	<del>2.81</del> 2.79	0.000

K.A.

\* Mileage for Class 1 Lane, Class 4, and Legal Trail classifications are NOT included in total. Mileage totals + adjustments by K. Alley (VTrans)

**PART II - INFORMATION AND DESCRIPTION OF CHANGES SHOWN ABOVE.** See Attached Spread Sheet for mileage change details + descriptions.

- NEW HIGHWAYS:** Please attach Selectmen's "Certificate of Completion and Opening".  
 Attached for new Crabapple Rd and extension of TH08 Sterling View Rd
- DISCONTINUED:** Please attach SIGNED copy of proceedings (minutes of meeting).  
 See Order and Selectboard minutes
- RECLASSIFIED/REMEASURED:** Please attach SIGNED copy of proceedings (minutes of meeting).  
 See order and Selectboard minutes
- SCENIC HIGHWAYS:** Please attach a copy of order designating/discontinuing Scenic Highways.  
 N/A

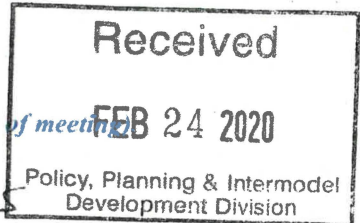

IF THERE ARE NO CHANGES IN MILEAGE: Check box and sign below. [ ]

**PART III - SIGNATURES - PLEASE SIGN.**

Selectmen/ Aldermen/ Trustees Signatures: Susan Bartlett, Carol Haque, Paul Bowen, Roger Avelle

T/C/V Clerk Signature: Kimberly Moulton Date Filed: 2/18/2020

Please sign ORIGINAL and return it for Transportation signature.

AGENCY OF TRANSPORTATION APPROVAL: Signed copy will be returned to T/C/V Clerk.

## Vermont Statutes Annotated

### 19 V.S.A. § 305. Measurement and inspection

#### § 305. Measurement and inspection

(a) After reasonable notice to the selectboard, a representative of the agency may measure and inspect the class 1, 2, and 3 town highways in each town to verify the accuracy of the records on file with the agency. Upon request, the selectboard or their designee shall be permitted to accompany the representative of the agency during the measurement and inspection. The agency shall notify the town when any highway, or portion of a highway, does not meet the standards for its assigned class. If the town fails, within one year, to restore the highway or portion of the highway to the accepted standard, or to reclassify, or to discontinue, or develop an acceptable schedule for restoring to the accepted standards, the agency for purposes of apportionment under section 306 of this title shall deduct the affected mileage from that assigned to the town for the particular class of the road in question.

(b) Annually, on or before February 10, the selectboard shall file with the town clerk a sworn statement of the description and measurements of all class 1, 2, 3, and 4 town highways and trails then in existence, including any special designation such as a throughway or scenic highway. When class 1, 2, 3, or 4 town highways, trails, or unidentified corridors are accepted, discontinued, or reclassified, a copy of the proceedings shall be filed in the town clerk's office and a copy shall be forwarded to the agency.

(c) All class 1, 2, 3, and 4 town highways and trails shall appear on the town highway maps by July 1, 2015.

(d) At least 45 days prior to first including a town highway or trail that is not clearly observable by physical evidence of its use as a highway or trail and that is legally established prior to February 10, 2006 in the sworn statement required under subsection (b) of this section, the legislative body of the municipality shall provide written notice and an opportunity to be heard at a duly warned meeting of the legislative body to persons owning lands through which a highway or trail passes or abuts.

(e) The agency shall not accept any change in mileage until the records required to be filed in the town clerk's office by this section are received by the agency. A request by a municipality to the agency for a change in mileage shall include a description of the affected highway or trail, a copy of any surveys of the affected highway or trail, minutes of meetings at which the legislative body took action with respect to the changes, and a current town highway map with the requested deletions and additions sketched on it. A survey shall not be required for class 4 town highways that are legally established prior to February 10, 2006. All records filed with the agency are subject to verification in accordance with subsection (a) of this section.

(f) The selectboard of any town who are aggrieved by a finding of the agency concerning the measurement, description, or classification of a town highway may appeal to the transportation board by filing a notice of appeal with the executive secretary of the transportation board.

(g) The agency shall provide each town with a map of all of the highways in that town together with the mileage of each class 1, 2, 3, and 4 highway, as well as each trail, and such other information as the agency deems appropriate.

Excerpt of 19 V.S.A. § 305 - *Measurement and inspection* from Vermont Statutes Online located at – <https://legislature.vermont.gov/statutes/section/19/003/00305>

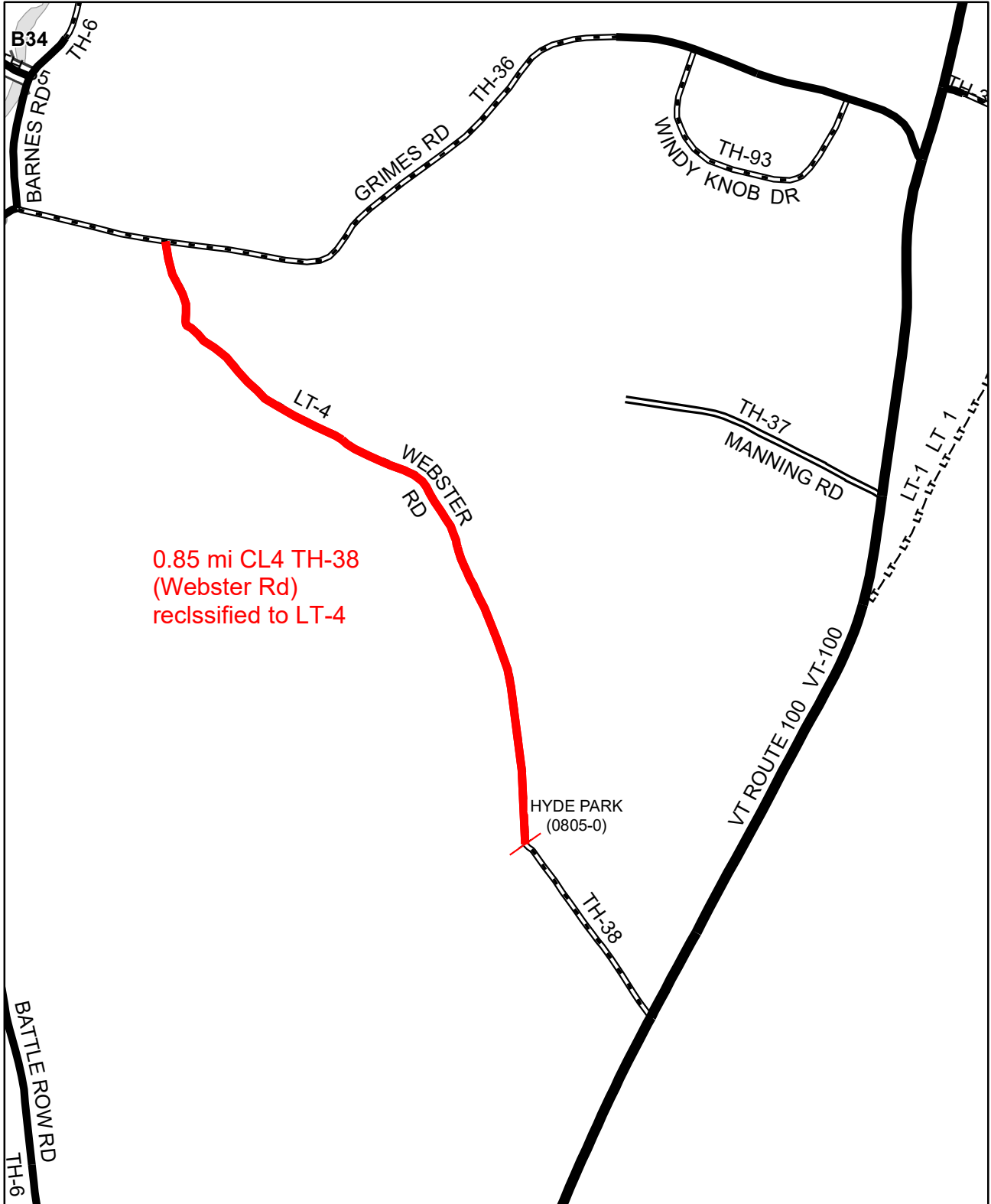

0.85 mi CL4 TH-38  
(Webster Rd)  
reclassified to LT-4

**Mileage Certificate Changes**  
**HYDE PARK**  
(CTUA: 0805-0)

Mapping Section  
Division of Policy and Planning  
Vermont Agency of Transportation -- April 27, 2020

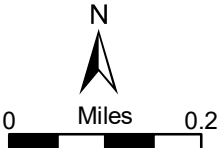

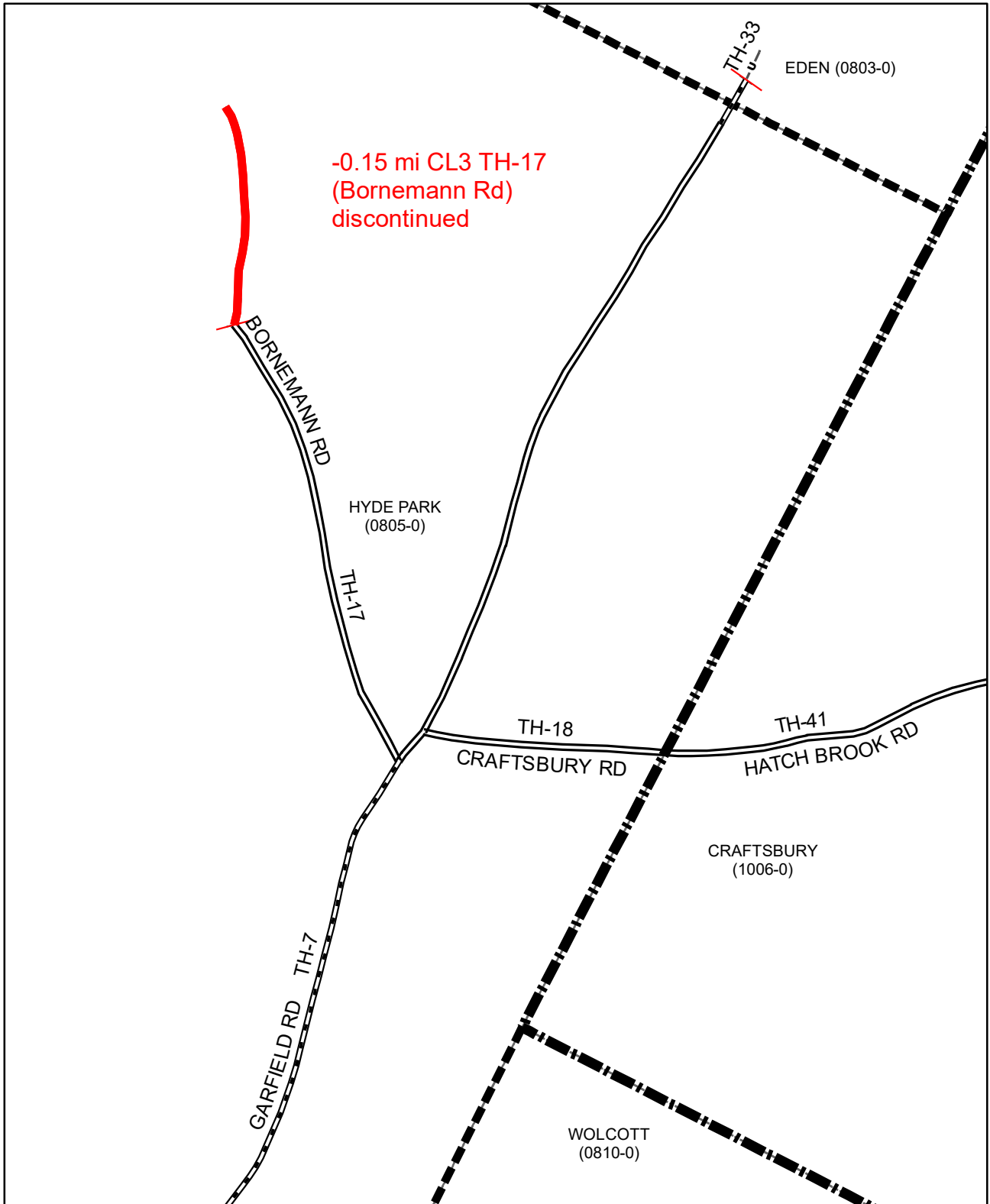

**Mileage Certificate Changes**  
**HYDE PARK**  
 (CTUA: 0805-0)

Mapping Section  
 Division of Policy and Planning  
 Vermont Agency of Transportation -- October 9, 2020



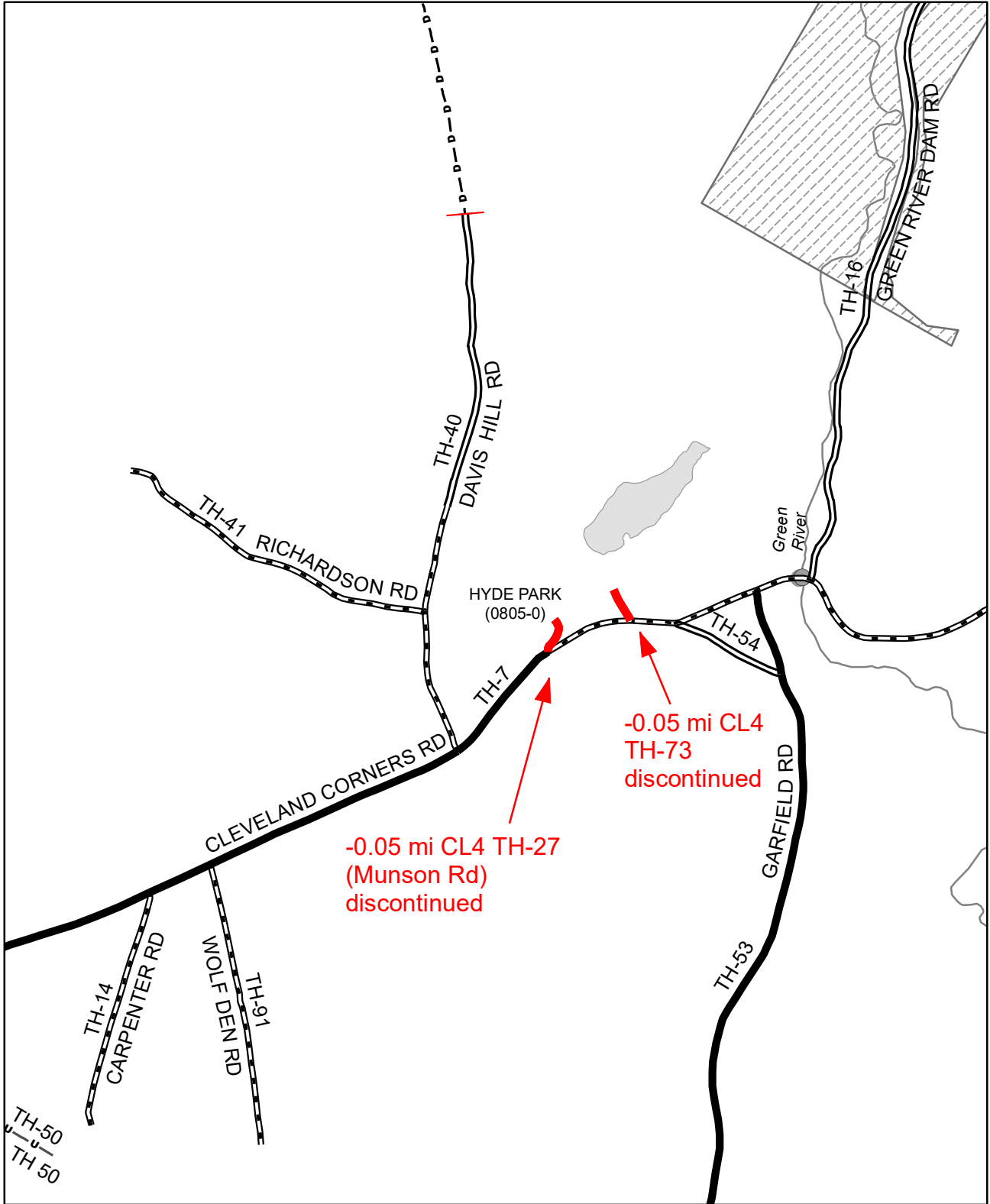

**Mileage Certificate Changes**  
**HYDE PARK**  
 (CTUA: 0805-0)

Mapping Section  
 Division of Policy and Planning  
 Vermont Agency of Transportation -- April 27, 2020

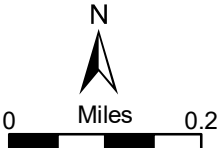

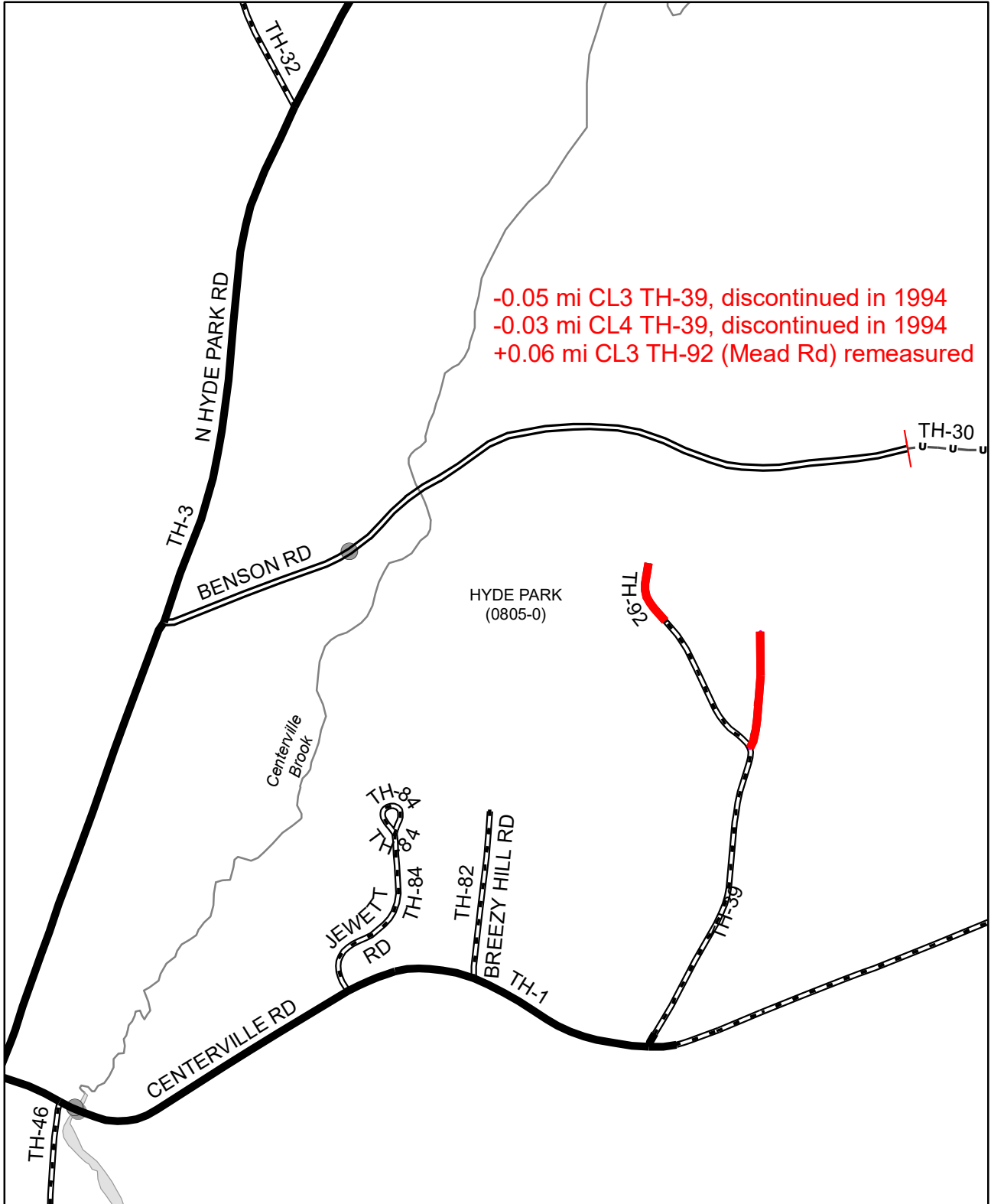

**Mileage Certificate Changes**  
**HYDE PARK**  
 (CTUA: 0805-0)

Mapping Section  
 Division of Policy and Planning  
 Vermont Agency of Transportation -- April 15, 2020

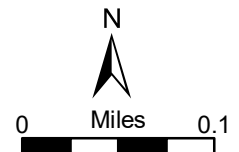

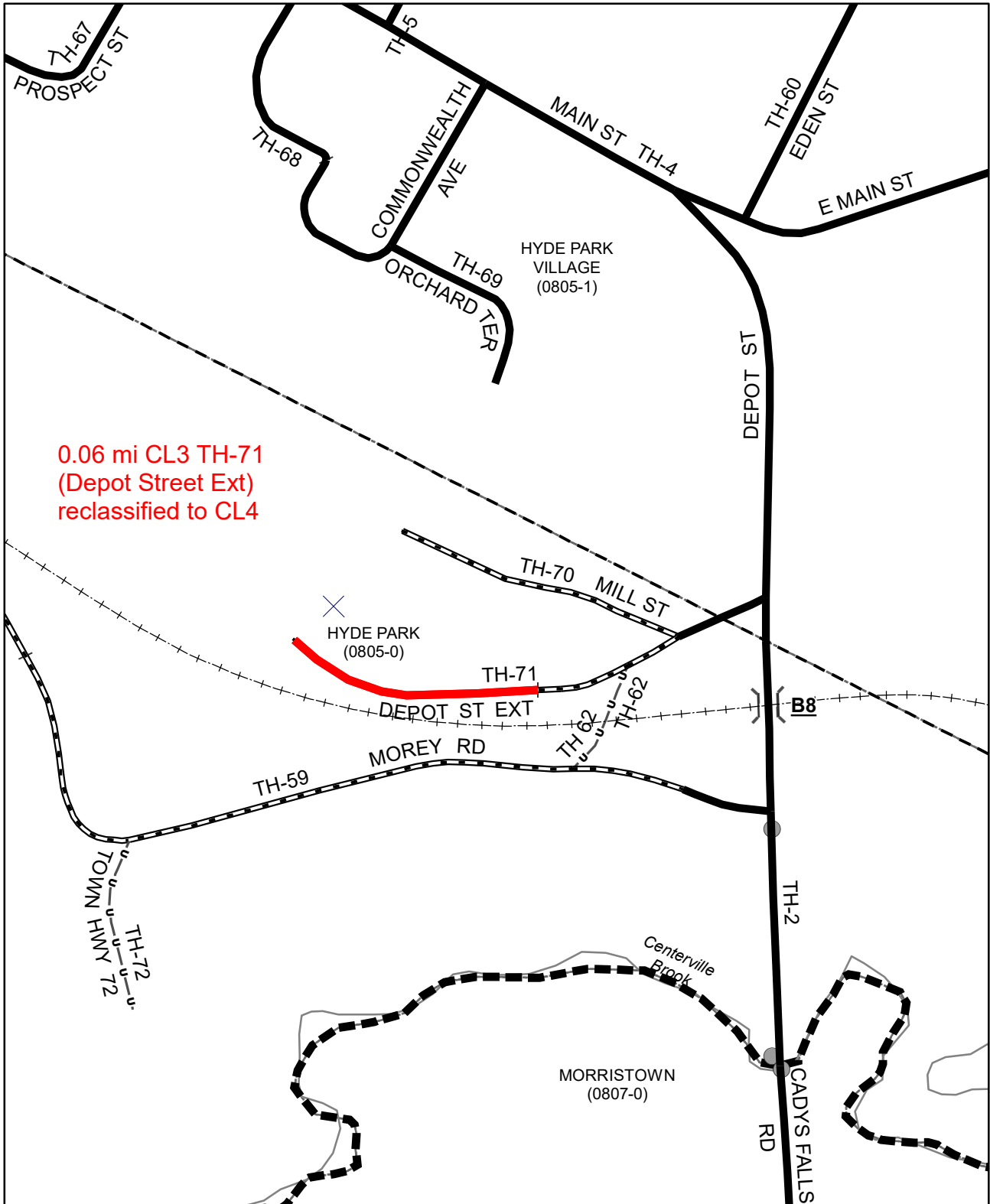

**Mileage Certificate Changes**  
**HYDE PARK**  
(CTUA: 0805-0)

Mapping Section  
Division of Policy and Planning  
Vermont Agency of Transportation -- April 13, 2020

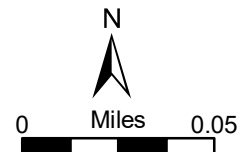

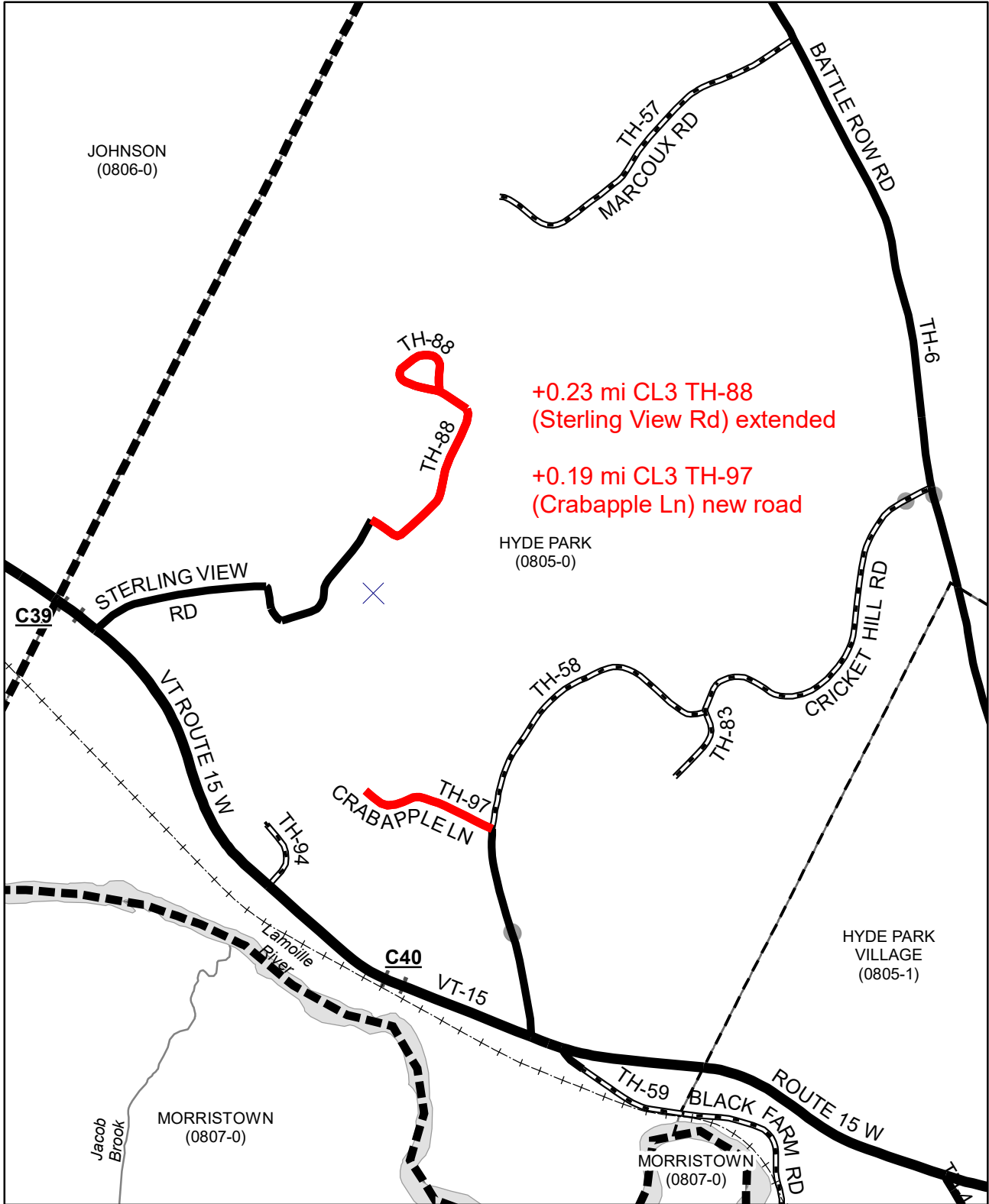

+0.23 mi CL3 TH-88  
(Sterling View Rd) extended

+0.19 mi CL3 TH-97  
(Crabapple Ln) new road

**Mileage Certificate Changes**  
**HYDE PARK**  
(CTUA: 0805-0)

Mapping Section  
Division of Policy and Planning  
Vermont Agency of Transportation -- April 13, 2020

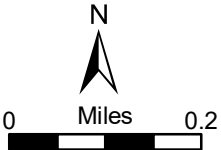



HYDE PARK  
 2020 Mileage Certificate Changes  
 VTrans Mapping Section Summary Worksheet

3/2/2020 Updated 4/2/2020 ~~10/07/2020~~

HydePark\_2020\_changeList.xlsx  
 Hyde Park - 2020 - mileageChangeDetail - Table.pdf

50.06 0.02 8.12 1.96 <- Last year's Totals

Hyde Park Change			CLASS 3		CLASS 4		LEGAL TRAIL		
Number	Highway	Name	Add	Subtract	Add	Subtract	Add	Subtract	
4	TH-17	Bornemann Rd		0.17					Discontinued (800 ft = 0.15 mi) and -0.02 mi remeasure
1	TH-27	Munson Rd				0.05			Discontinued
5	TH-38	Webster Rd				0.85	0.85		Reclassified from CL4 to Legal Trail
A	TH-39	TH-39		0.05		0.03			Discontinued 1994
	TH-41	Richardson Rd							No change
8	TH-71	Depot St Ext		0.06	0.06				Reclassified from CL3 to CL4
2	TH-73	(unnamed)				0.05			Discontinued
7	TH-88	Sterling View Rd	0.23						Add loop, total mileage goes from 0.73 to 0.96
B	TH-92	Mead Rd	0.06						remeasured
9	TH-97	Crabapple Ln	0.19						New road
		Sum:	0.48	0.28	0.06	0.98	0.85	0	
		Net Change:	0.2		-0.92		0.85		
		New Total:	50.26		7.22		2.81		

NOTES:

TH-88 Original mileage from 1992 change should have been ~0.70 mi (not 0.73)  
 The extension ROW, according to survey provided, overlaps the end of the original ROW by ~208', albeit with a slight shift in alignment. Although the extension survey indicates 1586.95' (0.30 mi), we should only add the mileage that extends beyond the original right of way (0.26 mi). Additionally, the original mileage of TH-88, according to the survey map, should have been 0.70 mi instead of 0.73 mi, so we've processed the extension of TH-88 as +0.23 mi CL3 TH-88, reflecting only the portion beyond the original right of way and adjusting the measure of the original right of way.

## Alley, Kerry

---

**From:** Ron Rodjenski <Ron@hydeparkvt.com>  
**Sent:** Tuesday, April 14, 2020 9:17 AM  
**To:** Alley, Kerry  
**Cc:** Moulton, Sara  
**Subject:** Re: Hyde Park Mileage Certificate

**EXTERNAL SENDER: Do not open attachments or click on links unless you recognize and trust the sender.**

Responses in **RED** - good to be working with you on this stuff - one of my long-term projects is to clear mileage data, so appreciate your time on this and into the future! So, no worries on when changes go in. Excel looks good.

Let me know if I missed anything!

Ron  
Ronald Rodjenski  
Town Administrator  
Zoning Administrator  
802-888-2300 x2  
<http://www.hydeparkvt.com>

Have you signed up with Front Porch Forum? Sign up today at [FrontPorchForum.com](http://FrontPorchForum.com). Hyde Park neighbors are joining daily. -Find a plumber or electrician. - Recommend a babysitter. - Sell a bike or canoe.

*NOTICE: Under Vermont's public records law, documents - including e-mail - in the possession of public officials are public records. This means if anyone asks to see it, we are, in most situations, required to provide it. We welcome citizen comments but please keep in mind that what you write in an e-mail is not private.*

---

**From:** Alley, Kerry <Kerry.Alley@vermont.gov>  
**Sent:** Monday, April 6, 2020 11:22 AM  
**To:** Ron Rodjenski <Ron@hydeparkvt.com>  
**Cc:** Moulton, Sara <Sara.Moulton@vermont.gov>  
**Subject:** RE: Hyde Park Mileage Certificate

Attached: HydePark\_2020\_changeList.xlsx

Hi Ron,

I have to close out the Mileage Certificate changes, so I made a few assumptions and guesses while processing those changes. Can you review my list of adjustments below and see if any are incorrect? I need to know sooner rather than later so that I can clearly document what might need to be added to next year's certificate while it's still fresh in my mind. I've also attached an Excel Table that summarizes the mileage added and subtracted for each TH with changes, with the before and after totals that will be shown on the Mileage Certificate. I believe all of the changes I haven't discussed below were processed without any adjustments.

Also, can you confirm that you've received this information and know that these updates are being added to the 2020 Certificate, and note whether any of my assumptions are incorrect so that they can be addressed on next year's

Certificate? Feel free to email or call me if you have any questions (but please note that my phone number has changed again)

Thanks!

Kerry

#### TH-17

From the Selectboard's Return documentation, I see that TH-17 now ends at a plow turnaround near Sighs Dr. I've pasted an image of that intersection below, and indicated with a red arrow what I think might be a plow turnaround area, and a red line where the road now ends. The measure to that location is 0.33 mi as described in the Selectboard's Return document, but I'd like to verify the location with a landmark too. Can you confirm that this is where TH-17 now ends?

**CORRECT - that is the turnaround area (to the northeast).**

The TH-17 mileage we had on record was 0.50 mi instead of the measured length of 0.48 mi. In order to have the remaining TH-17 measure 0.33 mi, we will need to subtract 0.17 mi from the mileage total instead of 0.15 mi (800 ft) as described in the Selectboard's Return. We're not saying that more than 0.15 mi was discontinued, but that we need to subtract 0.17 in order to accurately represent the remaining roadway, which would make this year's change a combination of the discontinuance and a remeasurement. Therefore I think the change for TH-17 should be:

*-0.17 mi CL3 TH-17 (Bornemann Rd) discontinuance and remeasurement*

**AGREE - working with the old mileages from the old process of drive by so please make the corrections that match aerial/landmarks.**

#### TH-88

I also realized that the previous VTrans mileage for TH-88 was probably incorrect. The survey map that was provided with this year's certificate indicates where TH-88 ended previously, as well as the layout of the new extension. My inference from that survey is that the previous mileage should have been ~0.70 mi instead of 0.73 mi. I can't confirm this because the survey you provided only has two pages: the first and last sections of TH-88. Also, the survey of the new loop indicates that a small portion of essentially overlaps the pre-existing right of way (by ~208' or 0.04 mi). Based on map measures, the new total comes out to be 0.96 mi. Does that sound right to you? For now I'm going to assume that, and we can undo any errors I might have made on the next Certificate.

**Yes, 0.96 miles if the entire TH88 and once around the loop (5,065 feet or 0.958mi).**

When all is said and done, we had 0.73 mi assigned to TH-88, and it currently appears to be 0.96 mi, so I think the appropriate change should be:

*+0.23 mi CL3 TH-88 (Sterling View Rd) extended and remeasured*

#### TH39 and TH-92

I added these changes to the Certificate, as described in my email to you on March 12.

*-0.05 mi CL3 TH-39, discontinued in 1994*

*-0.03 mi CL4 TH-39, discontinued in 1994*

*+0.06 mi CL3 TH-39 (Mead Rd) remeasured*



#### TH-71

I strictly assumed 450' of Depot St to be class 3, even though that appears to be in the middle of the parking area. We only had a total of 0.14 mi (including the Village mileage) associated with TH-71 before the discontinuance, so even if 0.09 mi was actually reclassified, I will only be transferring 0.06 mi from class 3 to class 4 to ensure that the class 3 mileage matches the value you gave me. It's the class 3 mileage that is most important, which is why I used that

measure, though I think there is a possibility that both the class 3 and class 4 measures are off. We can confer about how to fix this later. The change on the Certificate is therefore written:

*0.06 mi CL3 TH-71 (Depot Street Ext) reclassified to CL4*

I apologize for not getting this information to you sooner! It has been a rather chaotic month.

Thank you, and stay safe!

Kerry

End of TH-17?



---

Kerry Alley | GIS Professional III  
Vermont Agency of Transportation  
219 North Main Street | Barre, VT 05641  
802-917-2621 | [Kerry.Aleley@vermont.gov](mailto:Kerry.Aleley@vermont.gov)  
<http://vtrans.vermont.gov/planning/maps>  
(NOTE: new phone number and address)

**From:** Alley, Kerry  
**Sent:** Tuesday, March 31, 2020 11:05 AM  
**To:** Rodjenski, Ronald <ron@hydeparkvt.com>  
**Cc:** Moulton, Sara <Sara.Moulton@vermont.gov>  
**Subject:** Hyde Park Mileage Certificate

Attached: HydePark\_TH71\_2020.pdf

Hi Ron,

I'm finally getting back to the Hyde Park Certificate, and I do have some questions about Depot Street Extension (TH-71):

The part that will remain class 3 is described as being (to paraphrase) the first 450' starting from TH-2. You also describe the class 4 section as beginning at the parking lot for the Lamoille Valley Rail Trail. Given that the measures on the most recent Town Highway Map are not very precise, I wanted to make sure I was pinpointing the location where TH-71 changes from class 3 to class 4.

First, I want to clarify some "internal" mileage adjustments that I made to more proportionately allocate the existing 0.14 mi in our records for TH-71 across the segments:

The most recent (2017) Town highway map ("BEFORE", see excerpt below) had 0.03 mi in the Village (in red) and 0.11 mi in the Town. Because the two are not incorporated separately for highways, I shifted 0.01 mi from the Village and added it to the Town segment between TH-70 and TH-71 (highlighted in the BEFORE excerpt). Now that segment has a 0.02 mi label, as it had 0.01 mi associated with it when mapped in 2017 (even though it didn't have its own mileage label, because the 0.01 was included in the 0.10 mileage label. In other words, TH-71 should have had two labels on the 2017 map (0.09 mi and 0.01 mi) west of its intersection with TH-90 on the 2017 map, and my recent re-allocation of mileage shifted 0.01 mi from the Village to the segment between TH-70 and TH-70. If that doesn't make sense, feel free to give me a call (but note that my number has changed again).

Another measurement issue is that the entire length of TH-71, based on our road centerline data extending to the property line of 184 Depot Street Extension, is actually closer to 0.17 mi instead of 0.14 mi. Does that mean we've had the incorrect mileage for this road, or that it previously ended before the property line? Our 1985 inventory mentions that it ends at 0.15 mi at the warehouse (the stone foundation on the VTrans survey of the Depot), just to add another possibility.

BEFORE: From 2017 map:

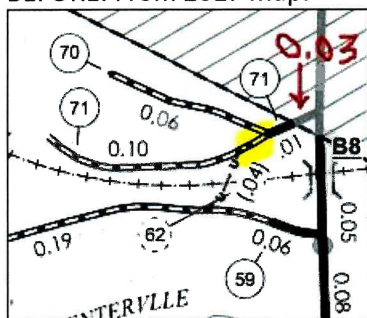

NOW: In our data before processing this year's changes:

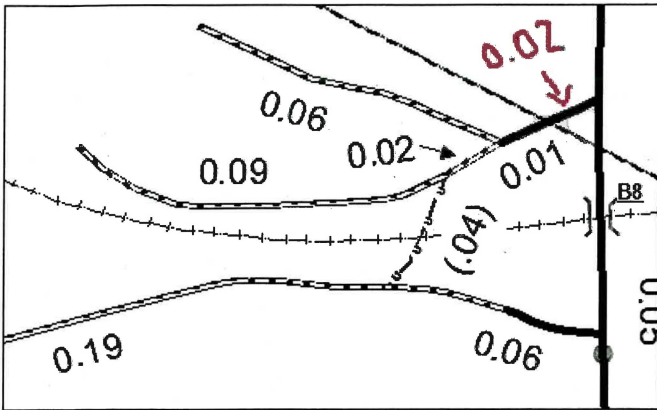

Now, regarding pinpointing the class 3-4 transition:

If you refer to the attached map, I've added a black arrow indicating the point along TH-71 that is approximately 450' from the centerline of TH-2. Given that 450' = 0.085 mi, and if we round to the nearest 0.01 mi to make it 0.09 mi class 3, then there is only 0.05 mi remaining to change to class 4 in our records. So, I'm looking to you to help me understand which measures and locations are most certain before figuring out how to handle this.

Again, please let me know if you have any questions,

Kerry

---

**Kerry Alley** | GIS Professional III  
 Vermont Agency of Transportation  
 219 North Main Street | Barre, VT 05641  
 802-917-2621 | [Kerry.Alley@vermont.gov](mailto:Kerry.Alley@vermont.gov)  
<http://vtrans.vermont.gov/planning/maps>  
 (NOTE: new phone number and address)

---

**From:** Alley, Kerry  
**Sent:** Thursday, March 12, 2020 7:28 PM  
**To:** Ron Rodjenski <[Ron@hydeparkvt.com](mailto:Ron@hydeparkvt.com)>  
**Subject:** RE: Hyde Park Mead Road TH39

My colleague Sara has looked at the other changes, and has some questions regarding the measure details, but I haven't had a chance to look at them yet... I think they will be cleared up with a few surveys I came across when we were looking into Depot Rd Ext a couple years ago. Hopefully I'll look into this tomorrow!

Kerry

---

**From:** Ron Rodjenski <[Ron@hydeparkvt.com](mailto:Ron@hydeparkvt.com)>  
**Sent:** Thursday, March 12, 2020 7:20 PM  
**To:** Alley, Kerry <[Kerry.Alley@vermont.gov](mailto:Kerry.Alley@vermont.gov)>  
**Subject:** Re: Hyde Park Mead Road TH39

**EXTERNAL SENDER: Do not open attachments or click on links unless you recognize and trust the sender.**  
 Yes 0.37 mi - yeah!

Anything else from us at this time?

Ron

Sent from my iPhone

On Mar 12, 2020, at 6:01 PM, Alley, Kerry <[Kerry.Alley@vermont.gov](mailto:Kerry.Alley@vermont.gov)> wrote:

Attached:HydePark\_TH39\_TH92\_2020.pdf

Hi Ron,

Wow, that Selectboard's Return you sent today is *THE* missing link! It describes the discontinuance (TH-39), and it clarifies that the laying out (of TH-92) includes the entire right of way as surveyed.

So, what that means is that TH-92 should be longer than 0.09 mi as I suspected... A "remeasurement" will bring it up to 0.15 mi. Then the combined length of TH-39 and TH-92 will be 0.37 mi as you expected.

In other words, after everything with Mead Rd is "fixed" ...  
0.22 mi TH-39 + 0.15 mi TH-92 = 0.37 mi Mead Rd

The "fix" is therefore...

*-0.05 mi CL3 TH-39, discontinued in 1994*  
*-0.03 mi CL4 TH-39, discontinued in 1994*  
*+0.06 mi CL3 TH-39 (Mead Rd) remeasured*

You can see these changes in red on the attached map. And keeping both numbers 39 and 92 will make it a lot easier to track changes (and corrections) back through our records.

I haven't looked at Hyde Park's Mileage Certificate yet to see whether these changes are already listed or not... but let me know if that is what you expected for those two highways, and I'll make sure they are clear on the Certificate.

Kerry

---

Original Attachment(s) of message below:

--- <<Tax Map of Mead Road Aerial Image.PDF>>  
--- <<Slide 45 - extension to new turnaround as TH92.pdf>>  
--- <<Selectboard Return Mead Road.pdf>>

**From:** Ron Rodjenski <[Ron@hydeparkvt.com](mailto:Ron@hydeparkvt.com)>

**Sent:** Thursday, March 12, 2020 1:39 PM

**To:** Alley, Kerry <[Kerry.Alley@vermont.gov](mailto:Kerry.Alley@vermont.gov)>

**Subject:** Hyde Park Mead Road TH39

**EXTERNAL SENDER: Do not open attachments or click on links unless you recognize and trust the sender.**

OK more info on this road.

Mead Road is mapped (General Highway Map) as TH39 (0.27 mi - two segments 0.22 and 0.05) and TH92 (0.09 mi) totaling 0.36 miles.

Per the attached Selectboard's Return and from Slide 45 used in the Return, Mead Road is actually 0.37 miles (1,955 feet - measured on aerial images) and The "stub" of TH39 C4 0.03 & TH39 C3 0.05 miles are both discontinued because the Selectboard described the discontinuance as beginning at the intersection of the new and old road (Mead Road extension in 1994).

Not sure why the General Highway Map was not updated in 1994 but the GHM should match the tax map (attached).

TH39 should be on the General Highway Map as TH39 being 0.37 miles in length (1,955 feet).

Keeping two numbers (39 & 92) might be necessary since deeds probably exist at this point using TH92.

Next steps?

Ron

Ronald Rodjenski  
Town Administrator  
Zoning Administrator  
802-888-2300 x2  
<http://www.hydeparkvt.com>

Have you signed up with Front Porch Forum? Sign up today at [FrontPorchForum.com](http://FrontPorchForum.com). Hyde Park neighbors are joining daily. -Find a plumber or electrician. - Recommend a babysitter. - Sell a bike or canoe.

*NOTICE: Under Vermont's public records law, documents - including e-mail - in the possession of public officials are public records. This means if anyone asks to see it, we are, in most situations, required to provide it. We welcome citizen comments but please keep in mind that what you write in an e-mail is not private.*

---

**From:** Alley, Kerry <[Kerry.Alley@vermont.gov](mailto:Kerry.Alley@vermont.gov)>  
**Sent:** Tuesday, January 14, 2020 10:54 AM  
**To:** Ron Rodjenski <[Ron@hydeparkvt.com](mailto:Ron@hydeparkvt.com)>  
**Subject:** RE: TH39 Hyde Park Mead Road

Attached:2000\_C.pdf

Hi Ron,

I've attached a scan of the 2000 Mileage Certificate (when TH-92 was added). These documents don't have any direct reference to TH-39, but the dates might help pinpoint meeting minutes from the time when action occurred on TH-92...



I also think it's odd that the mileage certificate only added 0.09 mi to TH-92 because the survey is clearly longer than that (about 0.12 mi). That might mean that there was more action regarding all of this than the mileage certificate and the certificate of opening suggest. Hopefully the answers are on your end!

Kerry

---

**From:** Ron Rodjenski <[Ron@hydeparkvt.com](mailto:Ron@hydeparkvt.com)>  
**Sent:** Tuesday, January 14, 2020 8:24 AM  
**To:** Alley, Kerry <[Kerry.Alley@vermont.gov](mailto:Kerry.Alley@vermont.gov)>  
**Subject:** Re: TH39 Hyde Park Mead Road

**EXTERNAL SENDER: Do not open attachments or click on links unless you recognize and trust the sender.**

Yes that is a good place to start - hopefully what you have mentions "and discontinue the stub"!

Ron

Sent from my iPhone

On Jan 13, 2020, at 7:07 PM, Alley, Kerry <[Kerry.Alley@vermont.gov](mailto:Kerry.Alley@vermont.gov)> wrote:

Hy Ron,

Thanks for the update on TH-39. I'll do some background research tomorrow to see what we have for documentation associated with TH-92 (which is our number for the extension part). That documentation might be relevant to TH-39 too. I have my suspicions, but not every hunch pans out.

Kerry

---

**Kerry Alley** | GIS Professional III  
Vermont Agency of Transportation  
219 North Main Street | Barre, VT 05641  
802-622-1289 | [Kerry.Alley@vermont.gov](mailto:Kerry.Alley@vermont.gov)  
<http://vtrans.vermont.gov/planning/maps>  
(NOTE: new phone number and address)

---

Original Attachment(s) of message below:

--- <<Aerial Tax Map Mead Rd TH39 and TH92.PDF>>  
--- <<Notes on next steps 2020.pdf>>  
--- <<Slide 45 - extension to new turnaround as TH92.pdf>>

---

**From:** Ron Rodjenski <[Ron@hydeparkvt.com](mailto:Ron@hydeparkvt.com)>  
**Sent:** Monday, January 13, 2020 5:23 PM  
**To:** Alley, Kerry <[Kerry.Alley@vermont.gov](mailto:Kerry.Alley@vermont.gov)>  
**Subject:** TH39 Hyde Park Mead Road

**EXTERNAL SENDER: Do not open attachments or click on links unless you recognize and trust the sender.**

Hi Kerry ~

Attached is TH39 on the 2017 current General Highway Map. I spoke with the landowner today that worked with the Selectboard in 1994 for the extension of TH39 (Mead Road).

Unfortunately, the discontinuance of a short section of TH39 (the former end of the road) was not recorded properly with VTrans (that's how it appears at this point), so as of today there still remains the "stub" off the east side of Mead Road which should not be there.

I think the only way to resolve this is to have the Selectboard re-do the formal TH discontinuance process for this stub and they would also need to confirm the existing road is within the survey that exists - via an as-built survey (the original extension from 1994 is recorded in Slide 45 - shows the extension and stub) but I have no record of the road actually being constructed within the surveyed ROW.

Do you agree or do you see another way to correct the General Highway Map to show existing conditions (where the town currently maintaining is depicted on the town tax map - attached).

Ron  
Ronald Rodjenski  
Town Administrator  
Zoning Administrator  
802-888-2300 x2  
<http://www.hydeparkvt.com>

Have you signed up with Front Porch Forum? Sign up today at [FrontPorchForum.com](http://FrontPorchForum.com). Hyde Park neighbors are joining daily. -Find a plumber or electrician. - Recommend a babysitter. - Sell a bike or canoe.

*NOTICE: Under Vermont's public records law, documents - including e-mail - in the possession of public officials are public records. This means if anyone asks to see it, we are, in most situations, required to provide it. We welcome citizen comments but please keep in mind that what you write in an e-mail is not private.*

---

**From:** Croft, Johnathan <[Johnathan.Croft@vermont.gov](mailto:Johnathan.Croft@vermont.gov)>  
**Sent:** Monday, January 13, 2020 12:38 PM  
**To:** Ron Rodjenski <[Ron@hydeparkvt.com](mailto:Ron@hydeparkvt.com)>  
**Cc:** Alley, Kerry <[Kerry.Alley@vermont.gov](mailto:Kerry.Alley@vermont.gov)>  
**Subject:** RE: Hyde Park

Good afternoon Ron,

Yes, Kerry is the best contact for this. She can be reached via email or her desk phone at (802) 622-1289.

## Johnathan

**Johnathan Croft** | Mapping Section Chief  
Vermont Agency of Transportation  
219 North Main Street | Barre, VT 05641  
[802-828-2600](tel:802-828-2600) | [johnathan.croft@vermont.gov](mailto:johnathan.croft@vermont.gov)

<image001.jpg>

---

**From:** Ron Rodjenski <[Ron@hydeparkvt.com](mailto:Ron@hydeparkvt.com)>  
**Sent:** Monday, January 13, 2020 12:24 PM  
**To:** Croft, Johnathan <[Johnathan.Croft@vermont.gov](mailto:Johnathan.Croft@vermont.gov)>  
**Cc:** Alley, Kerry <[Kerry.Alley@vermont.gov](mailto:Kerry.Alley@vermont.gov)>  
**Subject:** Re: Hyde Park

**EXTERNAL SENDER: Do not open attachments or click on links unless you recognize and trust the sender.**

I have new information on Mead Road - just wondering if Kerry is still the contact to discuss this road.

Ron

Ronald Rodjenski  
Town Administrator  
Zoning Administrator  
802-888-2300 x2  
<http://www.hydeparkvt.com>

Have you signed up with Front Porch Forum? Sign up today at [FrontPorchForum.com](http://FrontPorchForum.com). Hyde Park neighbors are joining daily. -Find a plumber or electrician. - Recommend a babysitter. - Sell a bike or canoe.

*NOTICE: Under Vermont's public records law, documents - including e-mail - in the possession of public officials are public records. This means if anyone asks to see it, we are, in most situations, required to provide it. We welcome citizen comments but please keep in mind that what you write in an e-mail is not private.*

---

**From:** Croft, Johnathan <[Johnathan.Croft@vermont.gov](mailto:Johnathan.Croft@vermont.gov)>  
**Sent:** Monday, October 30, 2017 10:28 AM  
**To:** Ron Rodjenski <[Ron@hydeparkvt.com](mailto:Ron@hydeparkvt.com)>  
**Cc:** Alley, Kerry <[Kerry.Alley@vermont.gov](mailto:Kerry.Alley@vermont.gov)>  
**Subject:** RE: Hyde Park

Good morning Ron,

I am passing this over to Kerry Alley, as she has worked on a series of Hyde Park highways in the past and can provide assistance in your questions.

Johnathan

Johnathan Croft | Mapping Section Chief  
Vermont Agency of Transportation  
1 National Life Dr | Montpelier, VT 05633  
802-828-2600 | [johnathan.croft@vermont.gov](mailto:johnathan.croft@vermont.gov)

<image001.jpg>

---

**From:** Ron Rodjenski [<mailto:Ron@hydeparkvt.com>]  
**Sent:** Monday, October 30, 2017 10:25 AM  
**To:** Croft, Johnathan <[Johnathan.Croft@vermont.gov](mailto:Johnathan.Croft@vermont.gov)>  
**Subject:** Hyde Park

Hi Johnathan ~

The Selectboard is in the process of researching a number of existing town highways and deciding which ones to discontinue, reclassify, or, if it is now privately owned but publicly maintained, deciding if the Town should accept it officially as a new town highway.

To push that effort along, they have agreed to hire a staff person to assist in the legal research. A couple of years ago, someone from your office asked about "Mead Road" and town highway #'s 39 & 92. I don't think we ever helped clarify that situation - do you still have it as an unresolved map/acceptance issue that I could spend some time on?

Also, we have a road (TH#69 - Orchard Terrace) that our recent preliminary deed & survey research is showing as a private road (no mention of public ROW or any documents laying it out as a town highway). Do you have any records on this road and when it might have been added to the General Highway Map for the Village of Hyde Park?

Thanks Johnathan,

Ron

Ronald Rodjenski  
Town Administrator  
Zoning Administrator  
802-888-2300 x2  
<http://www.hydeparkvt.com>

Have you signed up with Front Porch Forum? Sign up today at [FrontPorchForum.com](http://FrontPorchForum.com). Hyde Park neighbors are joining daily. -Find a plumber or electrician. - Recommend a babysitter. - Sell a bike or canoe.

*NOTICE: Under Vermont's public records law, documents - including e-mail - in the possession of public officials are public records. This means if anyone asks to see it, we are, in most situations, required to provide it. We welcome citizen comments but please keep in mind that what you write in an e-mail is not private.*





**TH-71**  
Class 3 vs Class 4?  
**HYDE PARK**  
(CTUA: 0805-0)

Mapping Section  
Division of Policy and Planning  
Vermont Agency of Transportation -- March 31, 2020

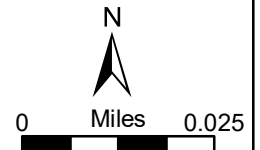

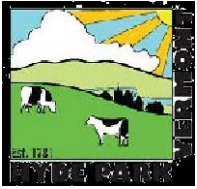

# TH39 Mead Rd - Existing Conditions 2020

Hyde Park, VT

1 inch = 268 Feet



January 13, 2020

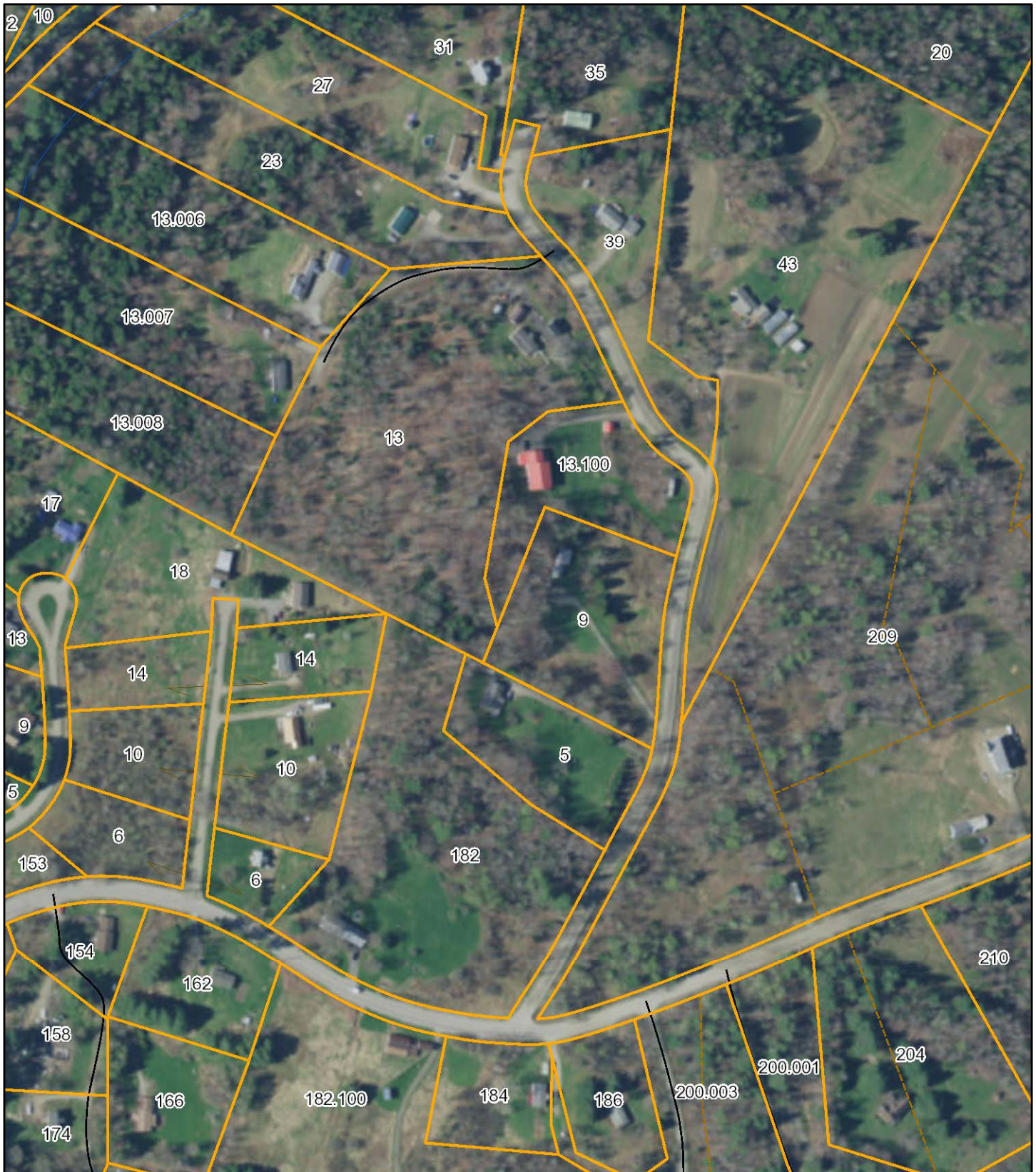

Data shown on this map is provided for planning and informational purposes only. The municipality and CAI Technologies are not responsible for any use for other purposes or misuse or misrepresentation of this map.

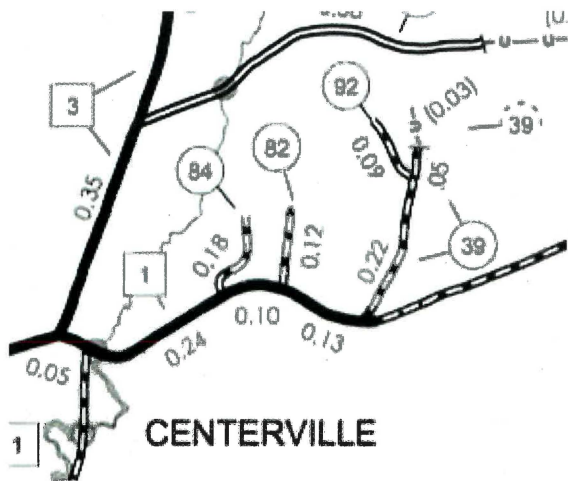

Notes on next steps 2020.pdf

Discontinue Class 4 TH39 (0.03)

Discontinue Class 3 TH39 (0.05)

Possibly change TH92 (0.09) to TH39 & the extended TH39 would be 0.31???

or leave with two #'s (Both are staying Class 3) at 0.31 miles total

One problem with mileage – tax map length is 0.40 miles – need field verification and confirmation with recorded survey (Slide 45)



STATE OF VERMONT

LAMOILLE COUNTY, SS.

TOWN OF HYDE PARK

SELECTBOARD'S RETURN

On their own motion, on July 27, 1994, the Selectboard for the Town of Hyde Park appointed September 7, 1994 at 6:30 P.M. for inspection of the site of a proposed highway and the discontinuance of a part of a highway and 7:00 P.M. at the Town Offices of the Town of Hyde Park, Vermont, as the time and place where they would hear persons interested in the laying out of a town highway and for the discontinuance of a part of Town Highway No. 39. The highway to be laid out is described as follows:

Being a part of the same land and premises conveyed to Robert W. Mead and Donna L. Mead by the warranty deed of Kenneth E. Mead and Jennie M. Mead dated February 14, 1985 and recorded in Book 51 at Pages 609-610 of the Hyde Park Land Records. Being a strip of land 50 feet in width and being 25 feet on each side of the centerline depicted on a survey map entitled "Robert and Donna Mead, 5 Lot Subdivision, Hyde Park, Vermont," dated November, 1992 and filed in Map Book 3 at Page 122 of the Hyde Park Land Records.

The part of Town Highway 39 that is to be discontinued is described as follows:

Being that part of Town Highway #39 that is northerly of the intersection with the new highway referenced above which commences at a point that is 218 feet northeasterly of the southerly corner of the property of Robert W. Mead and Donna L. Mead and the easterly corner of the Jennie Mead property as depicted on the above-referenced survey map. The part of Town Highway #37 to be discontinued is from the point referenced above to the so-called Robert and Donna Mead "Homeplace".

Notice of such hearing was given to the Planning Commission for the Town of Hyde Park, a copy was posted in the Town Offices of the Town of Hyde Park, a copy was published in the News & Citizen, a newspaper of general circulation in the area, in the August 4,

1994 issue and copies of the notice were sent to the following property owners and other interested persons in the premises over which the above-described town highway is to be laid out and the portion of Town Highway #39 is to be discontinued:

Jennie Mead  
Elizabeth Moher  
Anthony Godin  
Harold and Karen Chase  
David & Linda Potter  
Union Bank  
H.A. Manosh, Inc.  
Chittenden Bank  
Franklin Lamoille Bank  
Robert and Donna Mead

Mary Morrissette  
Anthony & Jill Trombley  
John Connell & Pam Cole  
Paul Beattie  
Andy & Stephanie Bourdeau  
Farmers Home Administration  
New England IBM Federal Credit Union  
Banknorth Mortgage Company, Inc.  
VT Dept. of Forests, Parks and  
Recreation

LAYING OUT OF A NEW TOWN HIGHWAY

At the time and place set forth in the notice, the Selectboard took testimony from Robert Mead, Donna Mead and David Potter. The property owners, other interested parties and other members of the public were given an opportunity to cross-examine the witnesses, to give testimony on their own behalf, and to present their own evidence.

After consideration of the evidence and noting that they had inspected the proposed highway, the Selectboard makes the following findings of fact:

1. The proposed highway to be laid out provides access to a 5 lot subdivision to be used for residential homes.
2. The grade of a part of the new town highway is unsatisfactory.
3. Other than the grade which needs to be improved as noted in the previous paragraph, the roadway was constructed with an adequate base.

4. The roadway was constructed with an adequate drainage system.

5. The roadway has been surveyed and the survey map has been recorded in the Hyde Park Land Records.

6. The public good, necessity and convenience of the inhabitants of the Town of Hyde Park are best served by the establishment of the proposed roadway.

It is ordered that the public good, necessity and convenience of the inhabitants of the Town of Hyde Park require that the above-described roadway be laid out in accordance with this order. It is directed that before the Town will accept the road, the grade be modified to standards acceptable to the Town. It is further ordered that the Town of Hyde Park shall have no duty to maintain or snowplow the above-described roadway until such time that three of the lots in the proposed development have three dwelling houses that are occupied as permanent residences. Until such time that three structures are completed and occupied as principal residences, Robert and Donna Mead will be solely responsible for the road maintenance and snowplowing.

DISCONTINUANCE OF A PART OF  
TOWN HIGHWAY #37

With respect to the discontinuance of a part of Town Highway #37, the Selectboard took testimony from Robert and Donna Mead. The property owners, other interested parties and other members of the public were given an opportunity to cross-examine the witnesses, to give testimony on their own behalf and to present their own witnesses.

After consideration of the evidence and noting that they had

inspected the part of Town Highway #37 to be discontinued, the Selectboard makes the following findings of fact:

1. The part of Town Highway 37 to be discontinued provides access only to one house.

2. The part of Town Highway #37 to be discontinued doesn't provide access to any other public highways.

3. The part of Town Highway 37 to be discontinued doesn't provide access to any public or private recreational areas.

4. There was no evidence presented at the hearing opposing the discontinuance of a part of Town Highway #39.

5. The public good, necessity and convenience of the inhabitants of the Town of Hyde Park requires that the portion of Town Highway #39 as described above be discontinued.

It is ordered that the portion of Town Highway #39 described above be discontinued. Stephanie Bourdeau abstained from the voting.

Dated at Hyde Park, Vermont, November 9<sup>th</sup>, 1994.

Selectboard, Hyde Park, VT

Kenneth A. Lavery  
Merill E. Locke  
Rene A. Marsden D.F.  
Robert B. Jones



CERTIFICATE OF HIGHWAY MILEAGE

YEAR ENDING FEBRUARY 10, 2000

2000-C.pdf (Scanned 2000 Cert packet)

Fill out form, make and file copy with the Town Clerk, and mail ORIGINAL, before February 20, 2000 to: VT Agency of Transportation, Technical Services Division, Drawer 33, Montpelier, VT 05633.

We, the Selectman or Trustee or Alderman of HYDE PARK in LAMOILLE County

on an oath state that the mileage of highways, according to Title 19, V.S.A, Sec #305, added 1985, is as follows:

PART I - CHANGES TOTALS - Please fill in and calculate totals.

Table with 6 columns: Town Highways, Previous Mileage, Added Mileage, Subtracted Mileage, Total, Scenic Highways. Rows include Class 1, Class 1 Lane, Class 2, Class 3, State Highway, Class 4, and Total.

\* Class 1 Lane Mileage and Class 4 is NOT included in total.

PART II - INFORMATION AND DESCRIPTION OF CHANGES SHOWN ABOVE.

- 1. NEW HIGHWAYS: Please attach Selectman's "Certificate of Completion and Opening". Please see attached Certificate of Completion and Opening and the Warranty Dee from Robert and Donna Mead to the Town of Hyde Park.
2. DISCONTINUED: Please attach SIGNED copy of proceedings (minutes of meeting). Please see a copy of the attached order discontinuing a portion of Town Highway #12, also known as Jane Anne Road.
3. RECLASSIFIED/REMEASURED: Please attach SIGNED copy of proceedings (minutes of meeting).
4. SCENIC HIGHWAYS: Please attach a copy of order designating/discontinuing Scenic Highways.

IF THERE ARE NO CHANGES IN MILEAGE: Check box and sign below. [ ]

PART III - SIGNATURES - PLEASE SIGN.

Selectman/ Alderman/ Trustees Signatures: [Signatures of Kenneth A. Lawrence, Merrill E. Locke, Stephen A. Masterson D.F., and Robert R. Jones]

Clerk Signature: [Signature of Gary Anderson] Date Filed: February 17, 2000

Please sign ORIGINAL and return it for Transportation signature.

AGENCY OF TRANSPORTATION APPROVAL: Signed copy will be returned to T/C/V Clerk. APPROVED: [Signature] DATE: 1 Mar 00 Representative, Agency of Transportation

WARRANTY DEED

KNOW ALL MEN BY THESE PRESENTS That We, ROBERT W. MEAD and DONNA L. MEAD, of Hyde Park in the County of Lamoille and State of Vermont, Grantors, in the consideration of one dollar and other good and valuable consideration paid to our full satisfaction by TOWN OF HYDE PARK, a municipal corporation having an office and principal place of business at the Hyde Park Town Clerk's Office in the Town of Hyde Park in the County of Lamoille and State of Vermont, Grantee, by these presents do freely GIVE, GRANT, SELL, CONVEY & CONFIRM unto the said Grantee, TOWN OF HYDE PARK, and its successors and assigns forever, a certain piece of land in Hyde Park in the County of Lamoille and State of Vermont, described as follows, viz:

Being a part of all and the same lands and premises as was deeded to Robert W. Mead and Donna L. Mead by the Warranty Deed of Kenneth E. Mead and Jennie M. Mead dated February 14, 1985 and recorded in Book 51, Pages 609-610 of Hyde Park Land Records; being a strip of land fifty feet in width and being twenty-five feet on each side of the following described centerline:

Beginning at the center of Town Highway #39 at a point which is 193 feet northeasterly of the southerly corner of the property of the Grantors and the easterly corner of the Jennie Mead property;

Thence N 59° W a distance of 58 feet;

Thence on a curve to the right having a radius of 104.1 feet a distance of 93.2 feet;

Thence N 8° 12' W a distance of 216 feet;

Thence on a curve to the left having a radius of 547.7 feet a distance of 198.8 feet;

Thence N 20° 54' W a distance of 50 feet;

Thence on a curve to the right having a radius of 95.4 feet a distance of 92.1 feet

Thence N 26° 26' E a distance of 60 feet to the boundary of Lot 8 in this development.

A rectangular parcel of land is also conveyed to create a turnaround area. That parcel is described as follows:

Beginning at the southerly corner of Lot #3, now owned by ~~Flowers~~ <sup>Flowers</sup>, referenced by an iron pin;

Thence N 63° 34' W a distance of 35 feet to a point referenced by an iron pin;

Thence S 26° 26' W a distance of 50 feet to a point referenced by an iron pin;

Thence S 63° 34' E a distance of 37.2 feet to a point referenced by an iron pin;

Thence N 26° 26' E a distance of 50 feet to the place of beginning.

Being a parcel of land containing .87 acres, more or less, on which is constructed a roadway.

This deed is made for the purpose of allowing the Town of Hyde Park to accept said property as a public highway which will serve five lots in the so-called Mead development, which are permitted under Subdivision Permit EC-5-2303, which lots are subject to the conditions of that permit.

Reference is hereby made to the above deed and its record and to all former deeds and their records for a more complete description of the property conveyed herein. Reference is also made to a survey map entitled "Robert & Donna Mead, 5 Lot Subdivision, Hyde Park, Vermont," dated November, 1992 and filed in Map Book 3, Page 122 of Hyde Park Map Records.

TO HAVE AND TO HOLD said granted premises, with all the privileges and appurtenances thereof, to the said Grantee, TOWN OF HYDE PARK, and its successors and assigns, to their own use and behoof forever;

And We, the said Grantors, ROBERT W. MEAD and DONNA L. MEAD, for ourselves and our heirs, executors, and administrators, do covenant with the said Grantee, TOWN OF HYDE PARK, that until the ensembling of these presents, we are the sole owners of the premises, and have good right and title to convey the same in manner aforesaid, that they are FREE FROM EVERY ENCUMBRANCE; and we hereby engage to WARRANT and DEFEND the same against all lawful claims whatever.

IN WITNESS WHEREOF, We hereunto set our hands and seals this 22 day of August, 1999.

In Presence of:

Mary E. Crawford  
Helen B. Parsons

Robert W. Mead  
ROBERT W. MEAD  
Donna L. Mead  
DONNA L. MEAD

STATE OF VERMONT  
LAMOILLE COUNTY, SS.

At Morrystown, in said County, this 22<sup>nd</sup> day of August, 1999, Robert W. Mead and Donna L. Mead personally appeared and they acknowledged this instrument, by them sealed and subscribed, to be their free acts and deeds.

Beforeme: Mary E. Crawford  
Notary Public

Vermont Property Transfer Tax  
32 V.S.A. Chap. 231  
-ACKNOWLEDGEMENT-  
Return Rec'd. - Tax Paid - Board of Health Cert. Rec'd.  
Vt. Land Use & Development Plans Act Cert. Rec'd.  
Return No. 92-99  
Signed Mary E. Crawford Clerk  
Date August 23, 1999

Hyde Park Town Clerk's Office August 23, A.D. 1999 at 1 o'clock 05 minutes P.M.  
Received for recording a deed of which the foregoing is a true record.

Attest: Mary E. Crawford Town Clerk



STATE OF VERMONT

TOWN OF HYDE PARK

LAMOILLE COUNTY, SS.

**Order Discontinuing A Portion Of Town Highway #12,  
Also Known As Jane Anne Road**

On July 14, 1999, at 6:00 PM, a duly noticed site inspection of a part of Town Highway #12 was made by the Selectboard of the Town of Hyde Park. A duly noticed public hearing was then held on July 14, 1999 at 7:00 PM at the Hyde Park Town Offices regarding the discontinuance of a part of Town Highway #12.

**Section A. Findings of Fact**

Based upon the site inspection and the evidence presented at the public hearing on July 14, 1999, the Selectboard of the Town of Hyde Park makes the following findings of fact:

1. Town Highway #12 has not been used as a public highway for many years.
2. There was no evidence presented at the hearing as to when Town Highway #12 was last used as a public highway.
3. Town Highway #12 does not provide access to any public or private recreational areas.
4. For the section of Town Highway #12 that is being discontinued by this order, there are other means of access to private parcels that abut the portion of Town Highway #12 that is being discontinued.
5. There was no evidence presented at the hearing opposing the discontinuance of Town Highway #12.
6. The public good, necessity and convenience of the inhabitants of the Town of Hyde Park

requires that a portion of Town Highway #12 as described below be discontinued.

**Section B. Method of Notifying Parties**

Notice of the hearing and site visit that were held on July 14, 1999, was given by certified mail, return receipt requested, to the following parties:

- Michael Lajoie
- Franklin Lamoille Bank
- Norman & Noreen Prive
- Vermont Department of Taxes
- Doris Palumbo
- Morrisville Water & Light Department
- Eloise McKinley
- VT Department of Forests, Parks & Recreation
- James Merikangas & Joseph Crisco III
- Lawrence, Jeannette, Marie, Gertrude & Andrew Lepine
- Thomas J. Hirchak III
- James & Kathleen Merikangas
- Hyde Park Municipal Planning Commission
- Vermont Electric Cooperative, Inc.
- Union Bank
- James & Ana Galvin
- Vermont National Bank

A copy of the notice was posted in the Town Offices, and a copy was published in the News & Citizen, a newspaper of general circulation in the area.

At the time and place set forth in the notice, the Selectboard took testimony from Frederick Woeckner, Esq. and Walter Urie. The property owners, other interested parties and other members of the public were given an opportunity to cross-examine the witnesses, to give testimony on their own behalf and to present their own witnesses.

**Section C. Order**

It is ordered that the portion of Town Highway #12 that begins at the intersection of the Doris

Palumbo property line and the Eloise McKinley property line and runs in a generally northeasterly direction to the property line of the Merikangas property that is depicted as 811 feet along Town Highway #12 and 801 feet along Town Highway #12 of a survey map entitled "Survey Plat of Doris Palumbo Prop. McKinstry Hill, Hyde Park, VT" prepared by Allen J. Newton, Registered Land Surveyor, recorded in Map Book \_\_\_\_\_ at Page \_\_\_\_\_ of the Hyde Park Land Records. This order shall not in any way affect private property rights.

Dated at Hyde Park, Vermont, this 1st day of September, 1999.

Selectboard, Hyde Park

*Russell A. Laury*  
*Merill E. Locke*  
*Stephanie A. Bourdeau*  
*Robert R. Jones*  
*Bene Macey*

CERTIFICATE OF COMPLETION AND OPENING  
OF A HIGHWAY FOR PUBLIC TRAVEL

Gary Anderson, Town Clerk of the Town  
of Hyde Park, Vermont.

Pursuant to Title 19, V.S.A., Section 15, as amended 1973, this is to certify  
that the following described section of Class 3 Highway in the Town  
of Hyde Park was COMPLETED AND OPEN FOR PUBLIC TRAVEL ON  
8/23, 1999.

DESCRIPTION OF RIGHT-OF-WAY: Beginning

Please see the attached copy of a Warranty Deed from Robert W. Mead and Donna  
L. Mead to the Town of Hyde Park dated August 22, 1999, and recorded in Book  
90, Pages 66-67 of the Hyde Park Land Records

and as shown on a ~~Highway~~ <sup>Survey</sup> Map of the Town of Hyde Park, dated November  
1992, and filed in Book 3 on page 122 of the Records of the Town  
of Hyde Park by the Town Clerk of said town  
incorporated herein by reference and attested to on said map by said Town  
Clerk.

Dated at Hyde Park, County of Lamoille and State of Vermont, this  
February, A.D., ~~XX~~2000.

*Kenneth A. Lauraf*  
*Merill E. Locke*  
*Rene C. Marcovey D.F.*  
*Walter B. Jones*

BOARD  
OF  
SELECTMEN  
ALDERMEN  
TRUSTEES

and the MAYOR of the City of \_\_\_\_\_.

\*\*\*\*\*

Hyde Park, VERMONT  
February 17, ~~XX~~2000

THE ABOVE IS A TRUE COPY OF THE DESCRIPTION OF CLASS 3 HIGHWAY COMPLETED AND  
OPENED FOR PUBLIC TRAVEL, RECORDED IN BOOK 90 ON PAGE 66 OF THE  
Land RECORDS OF THE Town OF  
Hyde Park ON THE 23rd DAY OF August, 1999, AT 1:05  
O'CLOCK, P.M.

ATTEST: *Gary Anderson*  
Town CLERK OF Hyde Park, VERMONT





**Mead Rd**  
 Remeasure TH-92, Discontinue 'Stub' of TH-39  
**HYDE PARK**  
 (CTUA: 0805-0)

Mapping Section  
 Division of Policy and Planning  
 Vermont Agency of Transportation -- March 12, 2020

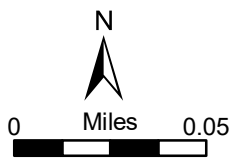

VCGI

Notes on next steps 2020.pdf

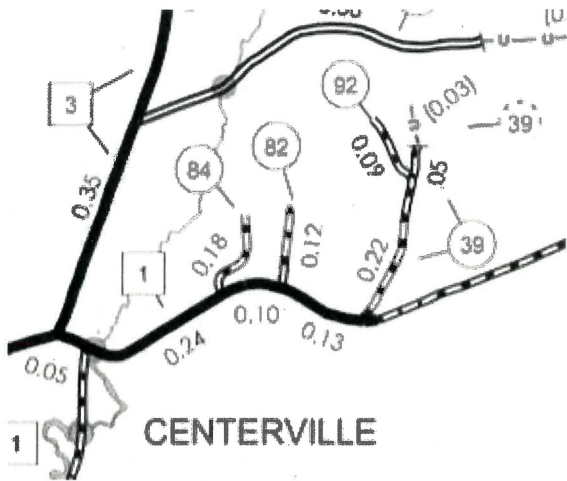

Discontinue Class 4 TH39 (0.03)

Discontinue Class 3 TH39 (0.05)

Possibly change TH92 (0.09) to TH39 & the extended TH39 would be 0.31???

or leave with two #'s (Both are staying Class 3) at 0.31 miles total

One problem with mileage – tax map length is 0.40 miles – need field verification and confirmation with recorded survey (Slide 45)



## **NOTICE OF HEARING RE: RECLASSIFICATION, DISCONTINUANCE AND ACCEPTANCE OF TOWN HIGHWAYS**

Notice is hereby given under 19 V.S.A. § 708(a) and 709, that on Thursday, October 17, 2019, commencing at 3:00 p.m. at the Hyde Park Town Clerk's Office in Hyde Park, 344 Route 15 West, a public examination of premises will occur, to be immediately followed by a public hearing conducted by the Town of Hyde Park, Vermont, on a Motion dated September 16, 2019, by the Town Selectboard to reclassify, discontinue and accept the various roads listed below, for the purpose of receiving testimony and hearing all persons interested in the matter of whether the Town of Hyde Park shall reclassify, discontinue or accept these roads. Written testimony will be accepted if received before the public examination.

Roads being considered for reclassification, discontinuance and acceptance:

- TH27 (Munson Road – entire Class 4); Discontinuance
- TH73 (Unnamed at Garfield Crossroad – entire Class 4); Discontinuance
- TH69 (Orchard Terrace – south end 130 feet Class 3); Discontinuance
- TH44 (Bornemann Road – north end 800 feet Class 3); Discontinuance
- TH38 (Webster Road – north end 0.83 miles of Class 4); Reclassify to Public Trail
- TH41 (Richardson Road – entire 0.45 miles of Class 3); Discontinuance
- TH88 (Sterling View Road – 1,100 feet of private road): Acceptance as Class 3
- TH71 (Depot Street Extension – last 0.50 miles of Class 3); Reclassify to Class 4
- NEW (Crabapple Lane – entire length of 1,000 feet); Acceptance as Class 3

If after examination of the premises and hearing any and all interested persons, the Selectboard judges that the public good, necessity and convenience of the inhabitants of the Town of Hyde Park require that said highway be reclassified, discontinued or accepted, it will be so ordered. Any claim for damages shall be heard at that time. All interested persons or the public are invited to attend.

Copies of this notice are being sent to all persons and companies interested in these roads, and the Hyde Park Town Planning Commission, and shall be posted in three public places in town and published in the News & Citizen, according to statute.

Dated at Hyde Park, Vermont, this 16th day of September 2019.

Susan Bartlett, Chair  
Hyde Park Selectboard

Received

SEP 24 2019

Policy, Planning & Intermodel  
Development Division



## CERTIFICATION

I, Ron Rodjenski, Hyde Park Town Administrator for the Town of Hyde Park, Vermont, hereby certify that on September 20, 2019, I caused the within and foregoing notice of hearing to be posted at the Town of Hyde Park Town Clerk's Office, and caused copies thereof to be mailed by certified mail, return receipt requested, to:

Albert Boyce, Lori Lathrop, Sarah Shedd & Holly Denoyers	89 Mill Street	Hyde Park, VT 05655
Alice Maguder & Carol Bradley	805 Sterling View Road	Hyde Park, VT 05655
Bank of America NA	11802 Ridge Parkway, Suite 100 HRM	Broomfield, CO 80021
Barrett Bruce & Amanda	943 Grimes Road	Hyde Park, VT 05655
Bernice, James, Brian & Scott Thayer & Linda Osgood	117 Rosewood Drive	Hyde Park, VT 05655
Boehm Reinhardt & Martina	1137 Grimes Road	Hyde Park, VT 05655
Bornemann, John F & Collette	420 Bornemann Road	Hyde Park, VT 05655
Brosseau James & Mary	P.O. Box 267	Hyde Park, VT 05655
Carol Baker	878 Sterling View Road	Hyde Park, VT 05655
Carrier Beth H.D., Trustee	1348 Grimes Road	Hyde Park, VT 05655
Chalue John & Jeanine	188 Webster Road	Hyde Park, VT 05655
Chalue John Little Fox & Dakota Running Bear	188 Webster Road	Hyde Park, VT 05655
Chalue Joseph III	174 Webster Road	Hyde Park, VT 05655
Chittenden Trust Company, dba Chittenden Bank	PO Box 820	Burlington, VT 05402
Christina Adams & Brenda Denton	898 Sterling View Road	Hyde Park, VT 05655
Consolidated Communications	30 East Main Street	Westfield, NY 14787
Consolidated Communications	30 East Main Street	Westfield, NY 14787
Cooke Jay & Anne	210 Larson Lane	Hyde Park, VT 05655
Cynthia Scott	107 Rosewood Drive	Hyde Park, VT 05655
David Ring	139 Union Street	Morrisville, VT 05661
Deanna Tripp & Dean Parker	921 Sterling View Road	Hyde Park, VT 05655
Demeritt, Everett		
Francis Sladyk & Christine Cooney	923 Grimes Road	Hyde Park, VT 05655
Gardiner Arthur Jr, & Nuse Robin May, Trustees	8 Sargent Street	Hanover, NH 03755
Gehrig Sprague	847 Sterling View Road	Hyde Park, VT 05655
Gluck, Frederick S. & Buglion, Gerette	46 Munson Road	Hyde Park, VT 05655
Grogan Richard & Hudson Suzanne	72 Larson Lane	Hyde Park, VT 05655
James Allister & Jane Arden	90 Vinet, Apt 104	Montreal, QC H3J 2C9 Canada
Janet Larson	P.O. Box 1012	Stowe, VT 05672
Janice Wells	44 Rosewood Drive	Hyde Park, VT 05655
John, Rita & Richard Lehouillier & Carol Bradley	798 Sterling View Road	Hyde Park, VT 05655
Johnson Michael & Jan R. Paul	572 Webster Road	Hyde Park, VT 05655
Kathy Alexander	55 Rosewood Drive	Hyde Park, VT 05655
Kenneth & Martha Harvey	270-2 Harrel Street	Morrisville, VT 05661
Kobus Debra & Crown Djorn	112 South Main Street #178	Stowe, VT 05672
Lague Andre	118 Quiet Lane	Hyde Park, VT 05655
Lanphear Kimberly	85 Webster Road	Hyde Park, VT 05655
Lewis Molly	P.O. Box 445	Stowe, VT 05672

Linda Hoisington	57 Rosewood Drive	Hyde Park, VT 05655
Mace Jason & Lanpher Charity	38 Haley Drive	Hyde Park, VT 05655
Margaret Brown	903 Sterling View Road	Hyde Park, VT 05655
Mary Paul Loomis	P.O. Box 129	Hyde Park, VT 05655
Matthew Andrews, Rmdr	148 Bayview Road	Colchester, VT 05446
Mona & Robert Minard	132 Rosewood Drive	Hyde Park, VT 05655
Mortgage Electronic Systems, Inc	P.O. Box 2026	Flint, MI 48501
Nancie Walsh	831 Sterling View Road	Hyde Park, VT 05655
Nate & Carol Hayden	79 Rosewood Drive	Hyde Park, VT 05655
New England Federal Credit Union	141 Harvest Lane	Williston, VT 05495
Norman & Betty Andrews, Life Estate	PO Box 158	Hyde Park, VT 05655
North Country Federal Credit Union	PO Box 64709	Burlington, VT 05406
Paul Nesky, Trustee, & Kay Snow	68 Rosewood Drive	Hyde Park, VT 05655
Peoples United Bank NA	P.O. Box 804	Brattleboro, VT 05302
Peoples United Bank NA	P.O. Box 8069	Brattleboro, VT 05302
Peter, Lillian, & Mark Kullmann, Susan Gagnon, & Lori Draper	857 Sterling View Drive	Hyde Park, VT 05655
Ray & Claudia Niles	33 Rosewood Drive	Hyde Park, VT 05655
Robert Falker	71 Orchard Terrace	Hyde Park, VT 05655
Sherri Falco & Christopher & Zachary Karpovich	65 Orchard Avenue	Rye, NY 10580
Sidney & Mariah Nichols, Trustees	7 Rosewood Drive	Hyde Park, VT 05655
Smith Maria & William	6 Peconic Avenue	Southampton, NY 11968
Spitzer Allen & Robin	1375 Grimes Road	Hyde Park, VT 05655
State of Vermont Agency of Transportation	133 State Street	Montpelier, VT 05602
Susan Deuso	867 Sterling View Road	Hyde Park, VT 05655
TD Bank NA	2035 Limestone Road	Wilmington, DE 19808
Terrier, Pierre	Devenes Chemin du Fin Derrey 11	Massongex 1869 SWITZERLAND
Thomas Williams	839 Sterling View Road	Hyde Park, VT 05655
Todoroff Farm LLC	P.O. Box 362	Hyde Park, VT 05655
Union Bank	PO Box 667	Morrisville, VT 05661
US Bank National Association	4801 Frederica Street	Owensville, KY 42301
Vermont Asbestos Group, Inc.	c/o HA Manosh, 120 Northgate Plaza	Morrisville, VT 05661
Vermont Land Trust	8 Bailey Avenue	Montpelier, VT 05602
Village of Hyde Park	P.O. Box 400	Hyde Park, VT 05655
Village of Morrisville, Inc	857 Elmore Street	Morrisville, VT 05661
VSECU	PO Box 67	Montpelier, VT 05601
Yankee Farm Credit, ACA	289 Hurricane Lane, Suite 102	Williston, VT 05495

I further certify that I caused the within and foregoing notice to be published in the September 19, 2019 issue of the News and Citizen, a newspaper circulating within the Town of Hyde Park, Vermont.

Dated at Hyde Park, Vermont this 20<sup>th</sup> day of September, 2019

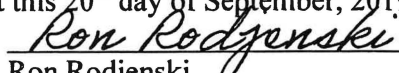
  
 Ron Rodjenski  
 Hyde Park Town Administrator

**Alley, Kerry**

---

**From:** Ron Rodjenski <Ron@hydeparkvt.com>  
**Sent:** Thursday, February 20, 2020 12:12 PM  
**To:** Alley, Kerry  
**Cc:** Croft, Johnathan  
**Subject:** Hyde Park - Annual Cert of Mileage  
**Attachments:** 1 - Filing with VTrans - Annual Cert of Mileage FINAL\_compressed.pdf

(scan of original docs sent by snail-mail)

**EXTERNAL SENDER: Do not open attachments or click on links unless you recognize and trust the sender.**

Good afternoon ~

For your review & approval.

Please let me know if you have any questions. The hard copy is in the mail.

Ron

Ronald Rodjenski  
Town Administrator  
Zoning Administrator  
802-888-2300 x2  
<http://www.hydeparkvt.com>

Have you signed up with Front Porch Forum? Sign up today at [FrontPorchForum.com](http://FrontPorchForum.com). Hyde Park neighbors are joining daily. -Find a plumber or electrician. - Recommend a babysitter. - Sell a bike or canoe.

*NOTICE: Under Vermont's public records law, documents - including e-mail - in the possession of public officials are public records. This means if anyone asks to see it, we are, in most situations, required to provide it. We welcome citizen comments but please keep in mind that what you write in an e-mail is not private.*

District 8  
Certcode 0805-0

CERTIFICATE OF HIGHWAY MILEAGE  
YEAR ENDING FEBRUARY 10, 2020

(Scanned + Printed)

Fill out form, make and file copy with the Town Clerk, and mail ORIGINAL, before February 20, 2020 to:  
Vermont Agency of Transportation, Division of Policy, Planning and Intermodal Development, Mapping Section  
219 N. Main Street. Barre. VT 05641.

1 - Filing with VTrans -  
Annual Cert of Mileage  
FINAL - compressed, pdf  
24 page scan of the  
following original docs.

active body of HYDE PARK in LAMOILLE County  
age of highways, according to Vermont Statutes Annotated, Title 19, Section 305,

TALS - Please fill in and calculate totals.

	Previous Mileage	Added Mileage	Subtracted Mileage	Total	Scenic Highways
Class 1	0.000	—	—		0.000
Class 2	13.830	—	—		0.000
Class 3	50.06	+0.27 + 0.19	- 0.150 - 0.09	= 50.28	0.000
State Highway	9.602	—	—		0.000
<b>Total</b>	<b>73.492</b>				<b>0.000</b>
* Class 1 Lane	0.000	—	—		
* Class 4	8.14	+0.09	- 0.65 - 0.05 - 0.83	= 7.30	0.000
* Legal Trail	1.96	+0.83	—		- 2.79

\* Mileage for Class 1 Lane, Class 4, and Legal Trail classifications are NOT included in total.

PART II - INFORMATION AND DESCRIPTION OF CHANGES SHOWN ABOVE.

1. NEW HIGHWAYS: Please attach Selectmen's "Certificate of Completion and Opening".

Attached For new Crabapple Rd and extension of TH88 Sterling View Rd

2. DISCONTINUED: Please attach SIGNED copy of proceedings (minutes of meeting).

See Order and Selectboard minutes

3. RECLASSIFIED/REMEASURED: Please attach SIGNED copy of proceedings (minutes of meeting).

See order and Selectboard minutes

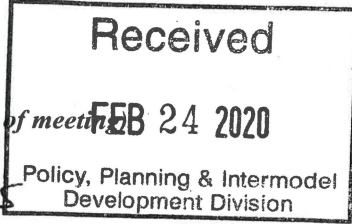

4. SCENIC HIGHWAYS: Please attach a copy of order designating/discontinuing Scenic Highways.

N/A

IF THERE ARE NO CHANGES IN MILEAGE: Check box and sign below. [ ]

PART III - SIGNATURES - PLEASE SIGN.

Selectmen/ Aldermen/ Trustees Signatures:

Susan Bartlett  
David Wagner  
Roger Azelet  
Randy Bowen

T/ CV Clerk Signature:

Kimberly Moulton

Date Filed: 2/18/2020

Please sign ORIGINAL and return it for Transportation signature.

AGENCY OF TRANSPORTATION APPROVAL: Signed copy will be returned to T/ CV Clerk.

APPROVED:

Representative, Agency of Transportation

DATE:

**2020 Town of Hyde Park Town Highway Mileage Changes - Summary**

<u>Class 3</u>	<u>Added</u>	<u>Subtracted</u>	<u>Notes</u>
<u>Special - No impact on TH Mileage but Ordered per town attorney advice</u>			
(3) Orchard Terrace TH69 - Discontinue end		0.025	discontinue "unclassified TH" being 130 feet at end & not now mapped as C3

**Class 3**

Changes that affect Certification of Highway Mileage

(4) Bornemann Road TH17 - Discontinue end		0.150	northerly of existing town highway turnaround
(7) Sterling View Road - Extension of TH#88	0.270		extend to and around loop
(8) Depot Street Extension TH71		0.090	reclass only C3 475' at end - first 450 ft from TH2 Depot St remaining Class 3
(9) Crabapple Lane - new TH#	0.190		needs new TH #
	<u>0.460</u>	<u>0.240</u>	

**Class 4**

(1) Munson Road TH27		0.050	
(2) Unnamed Class 4 TH73		0.050	
(5) Webster Road Class 4 TH38		0.830	aerial image of C4 measures but General HWY Map lists 0.83
(8) Depot Street Extension TH71	0.090		last 475 feet from trailhead reclass from C3 to C4
	<u>0.090</u>	<u>0.930</u>	

**Trail**

(5) Webster Road Class 4 to Trail	0.830		C4's existing entire length from TH38-C3's end to Grimes Road TH36
	<u>0.830</u>		

Note Change #6 was warned but no action taken by Selectboard.

**CERTIFICATE of COMPLETION and OPENING**  
**of a HIGHWAY for PUBLIC TRAVEL**

<b>VTrans Use Only</b>	
Certificate Year:	<u>2020</u>
Highway Class:	<u>3</u>
Town Highway #:	<u>88</u>
Mileage:	<u>0.26</u>

Kimberly J. Moulton, Town Clerk of the Hyde Park of  
 (Clerk's Name) (City/Town/Village) (City/Town/Village)  
 Hyde Park, Vermont.  
 (City/Town/Village Name)

Pursuant to Title 19, V.S.A., Chapter 7, this is to certify that the following described section of Class <sup>3</sup><sub>(1,2,3 or 4)</sub>  
 Highway in the Town of Hyde Park was COMPLETED AND OPENED  
 (City/Town/Village) (City/Town/Village Name)  
 FOR PUBLIC TRAVEL on 01-28, 2020.  
 (Month - Day) (Year)

DESCRIPTION OF RIGHT OF WAY:  
 (Include road name and intersecting town highway numbers)

0.27 mile extension of Sterling View Road TH#88 beginning 0.69 miles from VT Route 15

and as shown on a Highway Map of the Town of Hyde Park,  
 (City/Town/Village) (City/Town/Village Name)  
 dated 01-16, 2020, and filed in Book Slide 119 on page 742A & 742B of the Records of  
 (Month - Day) (Year) (Book #) (Page #)  
 the Town of Hyde Park by the Town Clerk of said Town  
 (City/Town/Village) (City/Town/Village Name) (City/Town/Village) (City/Town/Village)  
 incorporated herein by reference and attested to on said map by said Town Clerk.  
 (City/Town/Village)

Dated at Town of Hyde Park, County of Lamoille and State of Vermont,  
 (City/Town/Village Name) (County Name)  
 this 02 day of 18, A.D., 2020.  
 (Date - Day) (Date - Month) (Date - Year)

BOARD  
 OF  
 SELECTMEN,  
 ALDERMAN,  
 or TRUSTEES

Susan Bartlett  
 (Selectman/Alderman/Trustee Signature)  
Karen Chapman  
 (Selectman/Alderman/Trustee Signature)  
Roger Amulet  
 (Selectman/Alderman/Trustee Signature)  
Robert Bowler  
 (Manager/Mayor Signature)

\_\_\_\_\_  
 (Selectman/Alderman/Trustee Signature)  
 \_\_\_\_\_  
 (Selectman/Alderman/Trustee Signature)  
 \_\_\_\_\_  
 (Selectman/Alderman/Trustee Signature)

and the Manager/Mayor of the City/Town/Village of \_\_\_\_\_  
 (City/Town/Village Name)

\*\*\*\*\*

Hyde Park, VERMONT 02-19, 2020  
 (City/Town/Village Name) (Month - Day) (Year)

THE ABOVE IS A TRUE COPY OF THE DESCRIPTION OF CLASS <sup>3</sup><sub>(1,2,3 or 4)</sub> HIGHWAY COMPLETED AND OPENED  
 FOR PUBLIC TRAVEL, RECORDED IN BOOK Slide 119 ON PAGE 742A & 742B OF THE Land RECORDS  
 (Book #) (Page #)  
 OF THE Town OF Hyde Park ON THE 28th DAY OF January,  
 (City/Town/Village) (City/Town/Village Name) (Date - Day) (Date - Month)  
 2020, AT 9:30 O'CLOCK, A.M.  
 (Date - Year) (Time) (A or P)

ATTEST: Kimberly Moulton  
 (Clerk's Name)  
Town CLERK OF Hyde Park, VERMONT  
 (City/Town/Village) (City/Town/Village Name)

"Loop" Opened 1/28/2020

TH08 Sterling View Road - Extension

Hyde Park, VT

1 inch = 268 Feet

0 268 536 804



February 18, 2020



Data shown on this map is provided for planning and informational purposes only. The municipality and CAI Technologies are not responsible for any use for other purposes or misuse or misrepresentation of this map.

County-Town Code: 0805

TOWN HWY. No.	LENGTH IN MILES CLASS 3	CLASS 4
6	4.50	
7	7.80	
8	0.25	
9	(0.33)	
10	1.65	
11	(0.23)	
12	(0.50)	
13	2.70	
14	0.32	
15	0.22 (1.98)	
16	1.71	
17	0.50	
18	0.16	
19	0.16	
21	0.45	
22	(0.44)	
23	(0.25)	
25	0.26 (0.14)	
26	2.50	
27	(0.05)	
29	0.23 (0.07)	
30	0.58 (0.32)	
31	0.80 (0.40)	
32	0.20	
33	0.15	
34	0.09	
35	0.45	
36	1.40	
37	0.40	
38	0.35 (0.85)	
39	0.27 (0.03)	
40	0.75	
41	0.45	
42	(0.05)	
43	0.04	
44	0.70	
45	1.75 (0.10)	
47	0.15	
48	0.20	
49	1.00	
50	3.35 (0.38)	
51	0.05 (0.10)	
52	0.08	
53	1.80	
54	0.15	
55	0.32 (0.20)	
56	0.15	
57	0.50	
58	1.30	
59	0.94 (0.55)	
60	0.74	
61	0.15	
62	(0.04)	
63	0.10	
64	0.35 (0.05)	
65	0.08	
66	0.10	
67	0.20 (0.06)	
68	0.12	
69	0.09	
70	0.06	
71	0.14	
72	(0.06)	
73	(0.05)	
74	0.12 (0.54)	
75	0.55 (0.30)	
76		
77	0.21	
78	0.57 (0.11)	
79	0.36	
80	0.17	
81	0.82	
82	0.12	
83	0.11	
84	0.16	
86	0.15	
87	0.41	
88	0.73	
89	0.31	
90	0.18	
91	0.40	
92	0.09	
93	0.42	
94	0.10	
95	0.23	
96	0.12	
<b>TOTAL</b>	<b>56.06</b>	<b>8.12</b>

MILEAGE SUMMARY	
CLASS 2	
TH-1	7.350
TH-2	0.280
TH-3	4.530
TH-4	1.200
TH-5	0.300
TH-6	0.170
<b>TOTAL CLASS 2</b>	<b>13.830</b>
CLASS 3	
<b>TOTAL CLASS 3</b>	<b>50.06</b>
<b>TOTAL TOWN</b>	<b>63.890</b>
STATE HIGHWAY	
VT-15	2.955
VT-100	6.527
VT-100C	0.087
<b>TOTAL STATE HIGHWAY</b>	<b>9.569</b>
STATE HIGHWAY - Ramps	
VT-15	0.033
<b>TOTAL STATE HIGHWAY - Ramps</b>	<b>0.033</b>
<b>TOTAL STATE</b>	<b>9.602</b>
<b>TOTAL TRAVELED HIGHWAYS, FEB. 10, 2017:</b>	<b>73.492</b>
<i>(Excludes Class 4 and Large Tral Mileage)</i>	

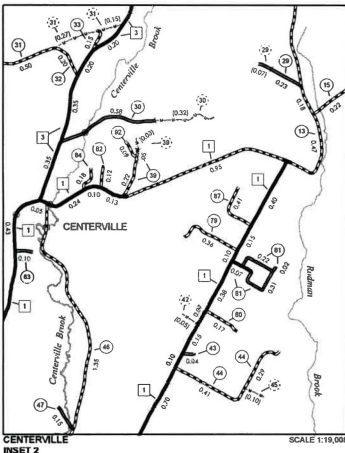

CENTERVILLE INSET 2 SCALE 1:10,000

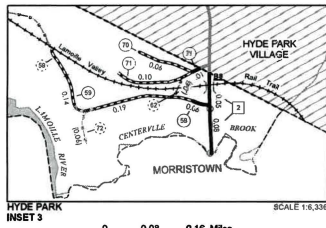

HYDE PARK INSET 3 SCALE 1:6,330

TOWN HWY. No.	LENGTH IN MILES "NOT UP TO STANDARD"
31	(0.02)
<b>TOTAL</b>	<b>0.02</b>

\*The sections of the town highways listed above are legally Class 3, but have been deemed "Not Up To Standard" and are functionally Class 4 Town Highways.

LEGAL TRAIL No.	LENGTH IN MILES LEGAL TRAIL
1	(0.07)
2	(0.30)
3	(0.30)
<b>TOTAL</b>	<b>1.96</b>

**DISCLAIMER:**  
The untraveled highways (laid-out town highways), discontinued highways, and legal trails herein are those of which the Agency of Transportation has record; others may exist.

Highway and bridge data by the Agency of Transportation. Town short structures drawn from the Vermont Online Bridge & Culvert Inventory Tool (VOBCIT) database. All other data from the Vermont Center for Geographic Information. City named streams shown.

Vermont State Plane Coordinate System  
North American Datum of 1983  
SPCS\_Zone\_Identifier: 4000  
Geoid Reference System 80  
4,000-meter grid, Existing - Northing

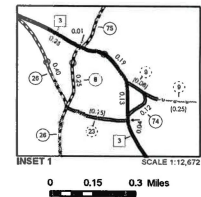
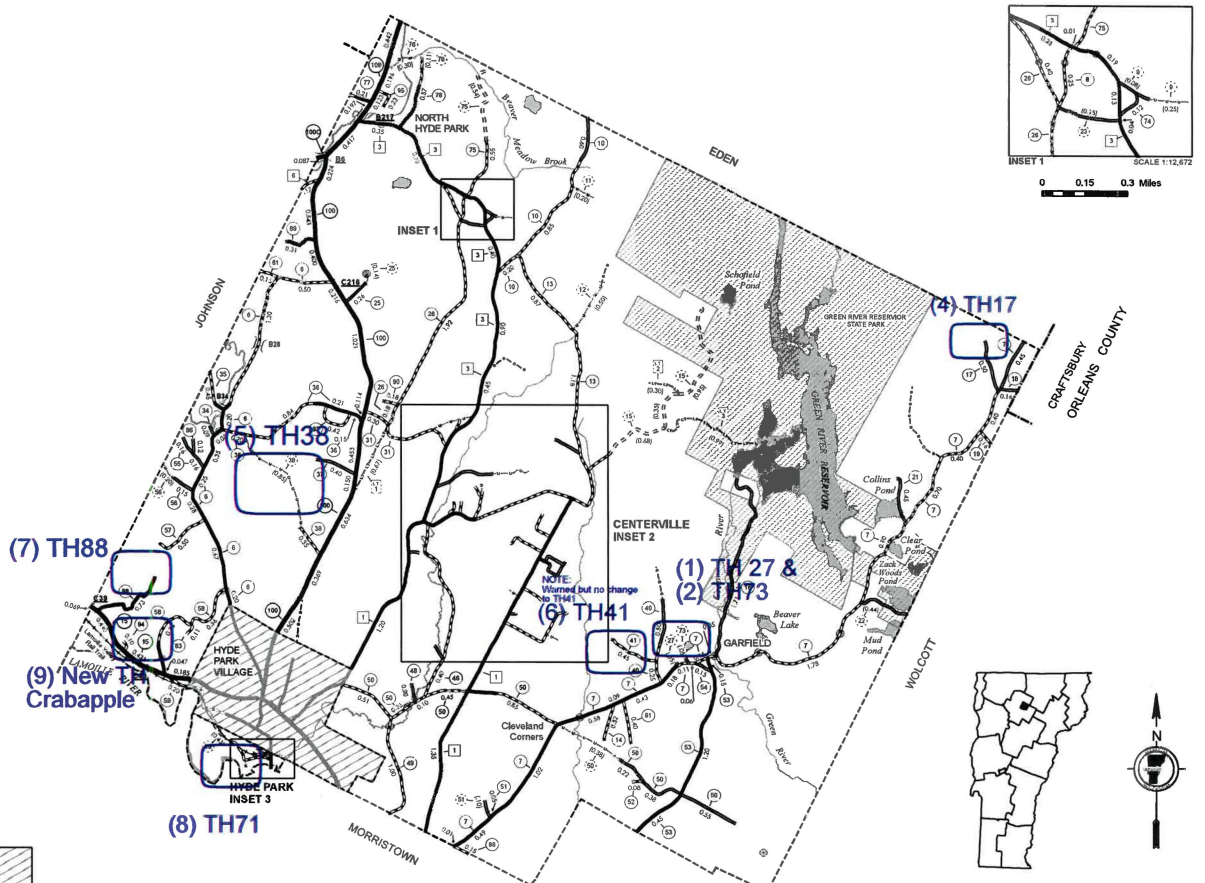

INSET 1 SCALE 1:12,672



VERMONT  
GENERAL HIGHWAY MAP  
**Town of Hyde Park**  
LAMOILLE COUNTY

Transportation District #8  
Prepared by the  
Vermont Agency of Transportation  
Division of Policy, Planning and Intermodal Development  
in cooperation with  
U.S. Department of Transportation  
Federal Highway Administration

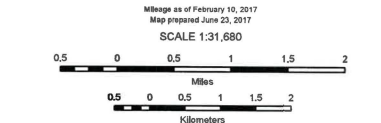

- |                                 |                                      |
|---------------------------------|--------------------------------------|
| <b>HIGHWAYS</b>                 | <b>POLITICAL SUBDIVISIONS</b>        |
| — INTERSTATE                    | — STATE BOUNDARY                     |
| — U.S. ROUTE                    | — COUNTY BOUNDARY                    |
| — STATE ROUTE                   | — TOWN BOUNDARY                      |
| — CLASS 1                       | — VILLAGE BOUNDARY                   |
| — CLASS 2                       | — URBAN COMPACT BOUNDARY             |
| — CLASS 3                       | — WATER BODY                         |
| — CLASS 4                       | — STREAM OR BROOK                    |
| — LEGAL TRAIL                   | — BRIDGE OR CULVERT                  |
| — DISCONTINUED                  | — BRIDGE OR CULVERT > 20'            |
| — HIGHWAY CLASS CHANGE          | — BRIDGE OR CULVERT 6' - 20'         |
| — RAILROAD                      | — BIKE PATH STRUCTURE                |
| — INACTIVE RAILROAD             | — VOBCT BRIDGE                       |
| — PUBLIC LAND - NATIONAL FOREST | — VOBCT CULVERT > 6'                 |
| — PUBLIC LAND - STATE/MUNICIPAL | — STATE BRIDGE OR CULVERT IDENTIFIER |
| — NATIONAL FOREST ROAD          | — TOWN BRIDGE OR CULVERT IDENTIFIER  |
| — STATE FOREST HIGHWAY          |                                      |

FEDERAL CLASSIFICATION IDENTIFIER  
MA - MAJOR ARTERIAL  
MC - MAJOR COLLECTOR  
MIC - MINOR COLLECTOR  
PA - PRINCIPAL ARTERIAL



County-Town Code 0805, Urban Area Code 1

TOWN HWY. No.	LENGTH IN MILES CLASS 3	CLASS 4	TOWN ROAD NAME
6	0.70		BATTLE ROW RD
50	0.04		NOYES FARM RD
59	0.35	(0.12)	BLACK FARM RD
59			WOODLANDS LN
60	0.25		EDEN ST
60	0.49		TITCH HILL RD
64	0.35		W MAIN ST
65	0.08		TINKLE RD
66	0.10		HILLSIDE AVE
67	0.20		PROSPECT ST
68	0.12		COMMONWEALTH AVE
68		(0.08)	COMMONWEALTH AVE
69	0.09		ORCHARD TER
71	0.03		DEPOT ST EXT
<b>TOTAL</b>	<b>2.80</b>	<b>0.20</b>	

MILEAGE SUMMARY			
<b>CLASS 2</b>			
TH-1	0.850		
TH-2	0.150		
TH-4	1.200		
TH-5	0.300		
	<b>TOTAL CLASS 2</b>	2.500	
<b>CLASS 3</b>			
	<b>TOTAL CLASS 3</b>	2.80	
	<b>TOTAL TOWN</b>	<b>5.300</b>	
<b>STATE HIGHWAY</b>			
VI-15	1.783		
VI-100	0.528		
	<b>TOTAL STATE HIGHWAY</b>	2.309	
<b>STATE HIGHWAY - Ramps</b>			
VI-15	0.033		
	<b>TOTAL STATE HIGHWAY - Ramps</b>	0.033	
	<b>TOTAL STATE</b>	<b>2.342</b>	

**TOTAL TRAVELED HIGHWAYS, FEB. 10, 2017:** 7.642  
(Excludes Class 4 and Legal Trail Mileage)

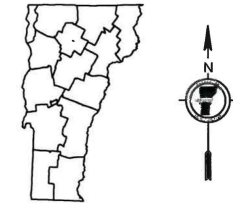

VERMONT  
GENERAL HIGHWAY MAP  
**Village of Hyde Park**

LAMOILLE COUNTY

Transportation District #8  
Prepared by the  
Vermont Agency of Transportation  
Division of Policy, Planning and Intermodal Development  
in cooperation with  
U.S. Department of Transportation  
Federal Highway Administration

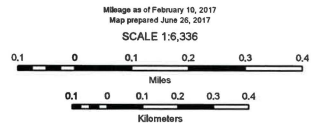

- HIGHWAYS**
- INTERSTATE
- U.S. ROUTE
- STATE ROUTE
- CLASS 1
- CLASS 2
- CLASS 3
- CLASS 4
- LEGAL TRAIL
- PARK AND RIDE
- INTERSTATE OR DIVIDED HIGHWAY
- STATE - HARD SURFACE OR PAVED
- TOWN - HARD SURFACE OR PAVED
- GRAVEL
- SOIL OR GRADED AND DRAINED EARTH
- UNIMPROVED OR PRIMITIVE
- IMPASSABLE OR UNTRAVELED
- LEGAL TRAIL
- DISCONTINUED
- HIGHWAY CLASS CHANGE
- RAILROAD
- INACTIVE RAILROAD
- PUBLIC LAND - NATIONAL FOREST
- PUBLIC LAND - STATE/MUNICIPAL
- NFR NATIONAL FOREST ROAD
- SFH STATE FOREST HIGHWAY

- POLITICAL SUBDIVISIONS**
- STATE BOUNDARY
- COUNTY BOUNDARY
- TOWN BOUNDARY
- VILLAGE BOUNDARY
- URBAN COMPACT BOUNDARY
- WATER BODY
- STREAM OR BROOK
- BRIDGE OR CULVERT
- BRIDGE OR CULVERT > 27'
- BRIDGE OR CULVERT 6' - 27'
- BIKE PATH STRUCTURE
- VOLUNT BRIDGE
- VOLUNT CULVERT > 6'
- STATE BRIDGE OR CULVERT IDENTIFIER
- TOWN BRIDGE OR CULVERT IDENTIFIER
- FEDERAL CLASSIFICATION IDENTIFIER
- MA MINOR ARTERIAL
- MAC MAJOR COLLECTOR
- MNC MINOR COLLECTOR
- PA PRINCIPAL ARTERIAL

**DISCLAIMER:**  
The untraveled highways (paid-out town highways), discontinued highways, and legal trails herein are those of which the Agency of Transportation has record; others may exist.  
Highway and bridge data by the Agency of Transportation, Town sheet structures drawn from the Vermont Online Bridge & Culvert Inventory Tool (VOCIT) database. All other data from the Vermont Center for Geographic Information. Only named streams shown.

Vermont State Plane Coordinate System  
North American Datum of 1983  
SPCS\_Zone\_Identifier: 4400  
Geoidetic Reference System 80  
2,000-meter grid, Easting - Northing

**CERTIFICATE of COMPLETION and OPENING**  
**of a HIGHWAY for PUBLIC TRAVEL**

<b>VTrans Use Only</b>	
Certificate Year:	<u>2020</u>
Highway Class:	<u>3</u>
Town Highway #:	<u>97</u>
Mileage:	<u>0.19</u>

Kimberly J Moulton, Town Clerk of the Town of Hyde Park, Vermont.

Pursuant to Title 19, V.S.A., Chapter 7, this is to certify that the following described section of Class 3 Highway in the Town of Hyde Park was COMPLETED AND OPENED FOR PUBLIC TRAVEL on 01-08, 2020.

DESCRIPTION OF RIGHT OF WAY:  
 (Include road name and intersecting town highway numbers)

Laying out 50-foot right-of-way, 0.19 miles in length to be Crabapple Lane (New TH# needed). Crabapple Lane starts 1,500 feet north of VT Route 15.

and as shown on a Highway Map of the Town of Hyde Park dated 10-01, 2018, and filed in Book Slide 119 on page 741 of the Records of the Town of Hyde Park by the Town Clerk of said Town incorporated herein by reference and attested to on said map by said Clerk.

Dated at Hyde Park, County of Lamoille and State of Vermont, this 18th day of February, A.D., 2020.

BOARD  
 OF  
 SELECTMEN,  
 ALDERMAN,  
 or TRUSTEES

Susan Bartlett  
 (Selectman/Alderman/Trustee Signature)  
David Palmer  
 (Selectman/Alderman/Trustee Signature)  
John Gaudet  
 (Selectman/Alderman/Trustee Signature)  
Robert Dorrin  
 (Manager/Mayor Signature)

\_\_\_\_\_  
 (Selectman/Alderman/Trustee Signature)  
 \_\_\_\_\_  
 (Selectman/Alderman/Trustee Signature)  
 \_\_\_\_\_  
 (Selectman/Alderman/Trustee Signature)

and the Manager/Mayor of the City/Town/Village of \_\_\_\_\_.

\*\*\*\*\*

Hyde Park, VERMONT 02-19, 2020

THE ABOVE IS A TRUE COPY OF THE DESCRIPTION OF CLASS 3 HIGHWAY COMPLETED AND OPENED FOR PUBLIC TRAVEL, RECORDED IN BOOK Slide 119 ON PAGE 741 OF THE Land RECORDS OF THE Town OF Hyde Park ON THE 19th DAY OF February, 2020, AT 10:50 O'CLOCK, A.M.

ATTEST: Kimberly Moulton  
 (Clerk's Name)  
Town CLERK OF Hyde Park, VERMONT  
 (City/Town/Village) (City/Town/Village Name)

Road Opened 1/8/2020



Crabapple Lane (in yellow) - New TH#

Hyde Park, VT

1 inch = 268 Feet



0 268 536 804

February 18, 2020



Data shown on this map is provided for planning and informational purposes only. The municipality and CAI Technologies are not responsible for any use for other purposes or misuse or misrepresentation of this map.

STATE OF VERMONT

LAMOILLE COUNTY, SS.  
TOWN OF HYDE PARKSELECTBOARD'S RETURNFOR THE:

1. Discontinuance of TH27 (Munson Road – entire Class 4);
2. Discontinuance of TH73 (Unnamed at Garfield Crossroad – entire Class 4);
3. Discontinuance of TH69 (Orchard Terrace – 130 feet of unclassified town highway);
4. Discontinuance of TH17 (Bornemann Road – approximately 800 feet of Class 3);
5. Reclassification of TH38 (Webster Road – 0.83 miles of Class 4 to Public Trail
6. Discontinuance of TH41 (Richardson Road – entire 0.45 miles of Class 3);
7. Laying out of extension of TH88 (Sterling View Road – 1,100 feet as Class 3;
8. Reclassification of TH71 (Depot Street Extension – Last 0.50 miles to Class 4;
9. Laying out of Crabapple Lane – entire length of 1,000 feet as Class 3.

On their own motion on September 16, 2019, the Selectboard for the Town of Hyde Park appointed October 17, 2019, at 3:00 P.M. at the Town Offices of the Town of Hyde Park, Vermont, as the time and place when they would hear persons interested in the laying out, reclassification and discontinuance of the above town highways. A description of each affected town highway follows:

**MUNSON ROAD TH27** description – TH27 is a Class 4 town highway commonly referred to as Munson Road in the Town of Hyde Park, located on the north side of Cleveland Corners Road TH7 approximately 0.20 miles westerly of the intersection of Garfield Crossroad TH54 and Cleveland Corners Road TH7. Munson Road TH27 is 0.05 miles in length.

**UNNAMED TH73** description – TH73 is an unnamed Class 4 town highway in the Town of Hyde Park, located on the north side of Cleveland Corners Road TH7 approximately 0.06 miles westerly of the intersection of Garfield Crossroad TH54 and Cleveland Corners Road TH7. Unnamed TH73 is 0.05 miles in length.

**ORCHARD TERRACE TH69** description – TH69 is a Class 3 town highway in the Town of Hyde Park, located on the easterly side of Commonwealth Avenue TH68. The town has maintained approximately 130 feet of private driveway extending from the end of the 0.09-mile mapped length of TH69, thus the 130 feet becoming an unclassified town highway. The entire unclassified town highway located on the lands of Robert Falker are the subject of this Order.

**BORNEMANN ROAD TH17** description – TH17 is a Class 3 town highway in the Town of Hyde Park, located on the west side of Garfield Road TH7. The last 800 feet of Bornemann Road, beginning from a town plow turnaround area near Sighs Drive and extending northerly is currently not maintained by the Town. The remainder of Bornemann Road from the TH6 (Garfield Road) to the noted plow turnaround area will remain a Class 3 and be 0.33 miles in length.

**WEBSTER ROAD TH38** description – TH38 is a Class 3 and Class 4 town highway in the Town of Hyde Park. The Class 4 portion is the subject of this Order and it begins at the intersection of a private road, Larson Lane, and extends northwesterly approximately 1.04 miles to its termination at Grimes Road TH36.

**RICHARDSON ROAD TH41** description – TH41 is a Class 3 town highway in the Town of Hyde Park, located on the west side of Davis Hill Road TH40. TH41 is approximately 0.45 miles in length.

**STERLING VIEW ROAD TH88** description – TH88 is a Class 3 town highway in the Town of Hyde Park, located on the north side of VT Route 15. The proposed laying out of an extension of TH88 begins at the current termination of TH88, which is approximately 0.74 miles from VT Route 15, ending near the private road commonly referred to as Maplewood Drive. The proposed extension is approximately 1,100 feet in length and is currently a paved private road with a loop-style turnaround, the entire length being proposed to become a Class 3. With the extension, TH88 will have a length of miles.

**Depot Street Extension TH71** description – TH71 is a Class 3 town highway in the Town of Hyde Park, located on the west side of Depot Street TH2 and extending 0.13 miles to its terminus. The beginning section of the Class 3 is 0.03 miles in length as depicted on the Village of Hyde Park General Highway Map. The Class 3 continues westerly as depicted on the Town of Hyde Park General Highway Map for 0.01 miles to TH70 (a.k.a. Mill Street) then continues 0.10 miles westerly to its terminus. The reclassification from Class 3 to Class 4 begins at the parking area for the Lamoille Valley Rail Trail, located 450 feet from the centerline of TH2, and will continue westerly as a Class 4 to the property line of N/F Lathrop at 184 Depot St Extension.

**Crabapple Lane (unclassified town highway)** description – Crabapple Lane is proposed to be a Class 3 town highway and is more particularly described in a survey map entitled “Crabapple Lane, Hyde Park, Vermont” Scale 1 inch = 100 feet, dated October 2019, prepared by Little River Survey, Inc., Patricia Kules, L.S., Registered Land Surveyor, Stowe, Vermont” to be recorded in the Hyde Park Land Records with required deeds as appropriate.

The hearing was held and completed on October 17, 2019. Notice of the October 17, 2019 hearing was given to the Hyde Park Town Planning Commission, a copy was posted at the Hyde Park Town Offices, a copy was published in the September 19, 2019 issue of the News & Citizen, a newspaper of general circulation in the Lamoille County area, and copies were sent to the following property owners and others interested in the premises over which the town highway is proposed:

Albert Boyce, Lori Lathrop, Sarah Shedd & Holly Denoyers	89 Mill Street	Hyde Park, VT 05655
Alice Maguder & Carol Bradley	805 Sterling View Road	Hyde Park, VT 05655
Bank of America NA	11802 Ridge Parkway, Suite 100 HRM	Broomfield, CO 80021
Barrett Bruce & Amanda	943 Grimes Road	Hyde Park, VT 05655
Bernice, James, Brian & Scott Thayer & Linda Osgood	117 Rosewood Drive	Hyde Park, VT 05655
Boehm Reinhardt & Martina	1137 Grimes Road	Hyde Park, VT 05655
Bornemann, John F & Collette	420 Bornemann Road	Hyde Park, VT 05655
Brosseau James & Mary	P.O. Box 267	Hyde Park, VT 05655
Carol Baker	878 Sterling View Road	Hyde Park, VT 05655
Carrier Beth H.D., Trustee	1348 Grimes Road	Hyde Park, VT 05655
Chalue John & Jeanine	188 Webster Road	Hyde Park, VT 05655
Chalue John Little Fox & Dakota Running Bear	188 Webster Road	Hyde Park, VT 05655

Chalue Joseph III	174 Webster Road	Hyde Park, VT 05655
Chittenden Trust Company, dba Chittenden Bank	PO Box 820	Burlington, VT 05402
Christina Adams & Brenda Denton	898 Sterling View Road	Hyde Park, VT 05655
Consolidated Communications	30 East Main Street	Westfield, NY 14787
Consolidated Communications	30 East Main Street	Westfield, NY 14787
Cooke Jay & Anne	210 Larson Lane	Hyde Park, VT 05655
Cynthia Scott	107 Rosewood Drive	Hyde Park, VT 05655
David Ring	139 Union Street	Morrisville, VT 05661
Deanna Tripp & Dean Parker	921 Sterling View Road	Hyde Park, VT 05655
Demeritt, Everett		
Francis Sladyk & Christine Cooney	923 Grimes Road	Hyde Park, VT 05655
Gardiner Arthur Jr, & Nuse Robin May, Trustees	8 Sargent Street	Hanover, NH 03755
Gehrig Sprague	847 Sterling View Road	Hyde Park, VT 05655
Gluck, Frederick S. & Buglion, Gerette	46 Munson Road	Hyde Park, VT 05655
Grogran Richard & Hudson Suzanne	72 Larson Lane	Hyde Park, VT 05655
James Allister & Jane Arden	90 Vinet, Apt 104	Montreal, QC H3J 2C9 Canada
Janet Larson	P.O. Box 1012	Stowe, VT 05672
Janice Wells	44 Rosewood Drive	Hyde Park, VT 05655
John, Rita & Richard Lehouillier & Carol Bradley	798 Sterling View Road	Hyde Park, VT 05655
Johnson Michael & Jan R. Paul	572 Webster Road	Hyde Park, VT 05655
Kathy Alexander	55 Rosewood Drive	Hyde Park, VT 05655
Kenneth & Martha Harvey	270-2 Harrel Street	Morrisville, VT 05661
Kobus Debra & Crown Djorn	112 South Main Street #178	Stowe, VT 05672
Lague Andre	118 Quiet Lane	Hyde Park, VT 05655
Lanphear Kimberly	85 Webster Road	Hyde Park, VT 05655
Lewis Molly	P.O. Box 445	Stowe, VT 05672
Linda Hoisington	57 Rosewood Drive	Hyde Park, VT 05655
Mace Jason & Lanpher Charity	38 Haley Drive	Hyde Park, VT 05655
Margaret Brown	903 Sterling View Road	Hyde Park, VT 05655
Mary Paul Loomis	P.O. Box 129	Hyde Park, VT 05655
Matthew Andrews, Rmdr	148 Bayview Road	Colchester, VT 05446
Mona & Robert Minard	132 Rosewood Drive	Hyde Park, VT 05655
Mortgage Electronic Systems, Inc	P.O. Box 2026	Flint, MI 48501
Nancie Walsh	831 Sterling View Road	Hyde Park, VT 05655
Nate & Carol Hayden	79 Rosewood Drive	Hyde Park, VT 05655
New England Federal Credit Union	141 Harvest Lane	Williston, VT 05495
Norman & Betty Andrews, Life Estate	PO Box 158	Hyde Park, VT 05655
North Country Federal Credit Union	PO Box 64709	Burlington, VT 05406
Paul Nesky, Trustee, & Kay Snow	68 Rosewood Drive	Hyde Park, VT 05655
Peoples United Bank NA	P.O. Box 804	Brattleboro, VT 05302
Peoples United Bank NA	P.O. Box 8069	Brattleboro, VT 05302
Peter, Lillian, & Mark Kullmann, Susan Gagnon, & Lori Draper	857 Sterling View Drive	Hyde Park, VT 05655
Ray & Claudia Niles	33 Rosewood Drive	Hyde Park, VT 05655
Robert Falker	71 Orchard Terrace	Hyde Park, VT 05655
Sherri Falco & Christopher & Zachary Karpovich	65 Orchard Avenue	Rye, NY 10580
Sidney & Mariah Nichols, Trustees	7 Rosewood Drive	Hyde Park, VT 05655
Smith Maria & William	6 Peconic Avenue	Southampton, NY 11968
Spitzer Allen & Robin	1375 Grimes Road	Hyde Park, VT 05655
State of Vermont Agency of Transportation	133 State Street	Montpelier, VT 05602
Susan Deuso	867 Sterling View Road	Hyde Park, VT 05655
TD Bank NA	2035 Limestone Road	Wilmington, DE 19808
Terrier, Pierre	Devenes Chemin du Fin Derrey 11	Massongex 1869 SWITZERLAND
Thomas Williams	839 Sterling View Road	Hyde Park, VT 05655
Todoroff Farm LLC	P.O. Box 362	Hyde Park, VT 05655

Union Bank	PO Box 667	Morrisville, VT 05661
US Bank National Association	4801 Frederica Street c/o HA Manosh, 120 Northgate Plaza	Owensville, KY 42301
Vermont Asbestos Group, Inc.	8 Bailey Avenue	Morrisville, VT 05661
Vermont Land Trust	P.O. Box 400	Montpelier, VT 05602
Village of Hyde Park	857 Elmore Street	Hyde Park, VT 05655
Village of Morrisville, Inc	PO Box 67	Morrisville, VT 05661
VSECU	289 Hurricane Lane, Suite 102	Montpelier, VT 05601
Yankee Farm Credit, ACA		Williston, VT 05495

At the time and place set forth above, the Selectboard took testimony from the property owners present, and other members of the public were invited to attend and testify at the hearing. The public was also given an opportunity to cross-examine the witnesses, to give testimony on their own behalf and to present their own witnesses.

After consideration of the evidence and noting that they had inspected the proposed highways prior or following the public hearing, the Selectboard makes the following findings of fact:

**MUNSON ROAD FINDINGS:**

1. The highway to be discontinued provides access to Cleveland Corners Road for one residential home and no public lands or services. No objection has been received following the public notice of discontinuance. The Town has no plans for public infrastructure or community services that would benefit from retaining the highway right-of-way for public use.
2. The public good, necessity and convenience of the inhabitants of the Town of Hyde Park are best served by discontinuing this Class 4 town highway.

**UNNAMED TH73 FINDINGS:**

1. The highway to be discontinued provides access to Cleveland Corners Road for one residential home and no public lands or services. The State of Vermont recommended that the Class 4 Town Highway be reclassified to a public trail to retain the public right-of-way because a large pond exists on the parcel. However, the Class 4 does not reach the pond and an additional 350-foot long easement would be required to access this 6.6-acre private pond. No other public support for a public trail nor the landowner's support for granting an easement were expressed during the public hearing. No other comments were received following the public notice of discontinuance. The Town has no plans for public infrastructure or community services that would benefit from retaining the highway right-of-way for public use.
2. The public good, necessity and convenience of the inhabitants of the Town of Hyde Park are best served by discontinuing this Class 4 town highway.

**ORCHARD TERRACE FINDINGS:**

1. The highway to be discontinued is currently not listed as a public highway but begins at the terminus of TH Orchard Terrace at the Falker/Andrews boundary line and has received public winter maintenance while serving one residential home and no public lands or services. The Town has agreed with the landowner to not plow the driveway on the N/F Falker parcel for two years. No objection has been received following the public notice of discontinuance. The Town has no plans for public infrastructure or community services that would benefit from retaining the highway right-of-way for public use.
2. The public good, necessity and convenience of the inhabitants of the Town of Hyde Park are best served by discontinuing the unclassified portion of Orchard Terrace, and if it exists, any portion of the Class 3 town highway, located on Bob Falker property.

**BORNEMANN ROAD TH17 FINDINGS:**

1. The highway to be discontinued is the northerly end of the TH only and presently serves one residential home and no public lands or services. Other users of the town highway that have a legal interest in the access to Bornemann Road will retain an easement after discontinuance, if such legal interest existed prior to discontinuance. No objection has been received following the public notice of discontinuance. The Town has no plans for public infrastructure or community services that would benefit from retaining the highway right-of-way for public use. The Class 3 ends in the middle of a large parcel and does not connect to another municipality or serve and public places or community services. The Town presently only plows to the turnaround area at Signs Drive (a private road) and has not plowed the last 800 feet of Bornemann Road recently.
2. The public good, necessity and convenience of the inhabitants of the Town of Hyde Park are best served by discontinuing the last 800 feet of TH17.

**WEBSTER ROAD TH38 FINDINGS:**

1. The Class 4 highway to be reclassified as a Public Trail provides access between the Class 3 portion of Webster Road (and to VT100) and Grimes Road TH17, a Class 3 town highway. The Class 4 portion now provides access to three residential homes and three undeveloped parcels, but no road surface is evident for most of the Class 4 length. No objection has been received following the public notice of discontinuance and letters of support for public trail status related to home owners have legal access and decreasing the use of the highway right-of-way by truck traffic that is directed to this route as it appears to be a thru road on road maps. The Town has no plans for public infrastructure or community services however, as the Class 4 presently connects two Class 3 town highways, the retainage of the public right-of-way for future use benefits the public use.





2. The public good, necessity and convenience of the inhabitants of the Town of Hyde Park are best served by reclassifying the existing Class 4 portion of Webster Road to a Public Trail.

**RICHARDSON ROAD FINDINGS:**

1. The highway proposed to be discontinued provides access to public utilities and fire service water supply sources. Landowner objections to discontinuance were received and considered by the Board. The Town has no plans for new public infrastructure or community services along this town highway but future development along the road will benefit from continued public town highway maintenance.
2. The public good, necessity and convenience of the inhabitants of the Town of Hyde Park are best served by retaining the existing Richardson Road as a Class 3 roadway.

**STERLING VIEW ROAD FINDINGS:**

1. The highway to be extended will directly serve 11 single-family homes and will provide a safe and adequate town vehicle turnaround at the end of the 0.8-mile road. The loop portion is approximately 0.20 miles, resulting in a total Class 3 road length from VT15 of 5,100 feet or 0.96 mile.
2. The Town currently has no adequate turnaround within a public right-of-way. The property owner has recently paved the loop portion and the additional roadway is in overall good condition with no major stormwater improvements or bridges.
3. The public good, necessity and convenience of the inhabitants of the Town of Hyde Park are best served by the extension of Sterling View Road to include a turnaround area for public use where none exists today.

**DEPOT STREET EXTENSION FINDINGS:**

1. The town highway Class 3 portion extends past the new Lamoille Valley Trail parking lot but the town highway maintenance now ends at the LVRT parking lot. The Class 4 portion will remain to service parcels that are westerly of the LVRT parking area.
2. The public good, necessity and convenience of the inhabitants of the Town of Hyde Park are best served by the reclassification of the end of Depot Street Extension to a Class 4 roadway.

**CRABAPPLE LANE FINDINGS:**

1. The roadway to be accepted as a public highway, Class 3, has been surveyed and the survey map will be recorded in the Hyde Park Land Records as referenced above following the issuance of this Order.
2. Crabapple Lane presently serves 13 single-family homes and has been publicly maintained by the Town of Hyde Park for over 20 years, however, no formal highway laying out process was completed.
3. The proposed town highway length is 1,000 feet with a turnaround area for public town road maintenance.



4. The public good, necessity and convenience of the inhabitants of the Town of Hyde Park are best served by the establishment of Crabapple Lane as a town highway Class 3.

Now, therefore, it is ordered that the public good, necessity and convenience of the inhabitants of the Town of Hyde Park require that:

- 1) Munson Road TH27 Class 4 be discontinued it its entirety;
- 2) Unnamed TH73 Class 4 be discontinued it is entirety;
- 3) Orchard Terrace's unclassified or classified section be discontinued where existing on lands of N/F Falker;
- 4) Bornemann Road TH17 Class 3 be partially discontinued beginning at the existing Class 3 turnaround area at the Sighs Drive and northerly;
- 5) Webster Road TH38 Class 4 be reclassified to a Public Trail;
- 6) Richardson Road TH41 Class 3 to have no change in its existing Class 3 status;
- 7) Sterling View Road TH88 Class 3 to be extended by laying out an additional 0.20 miles as Class 3 which includes a loop turnaround for highway maintenance, and that the above-described land be opened as a Class 3 Town Highway for the purposes noted in this return;
- 8) Depot Street Extension Class 3 to be partially reclassified to Class 4 from the LVRT Trailhead Parking Area and westerly to its terminus;
- 9) Crabapple Lane as described above be laid out accordingly, and that the above-described land be opened as a Class 3 Town Highway for the purposes noted in this return.

Dated at Hyde Park, Vermont, November 18, 2019

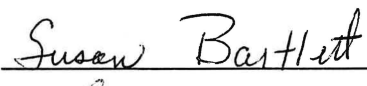
Selectboard, Town of Hyde Park:

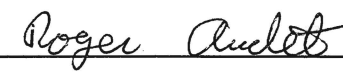
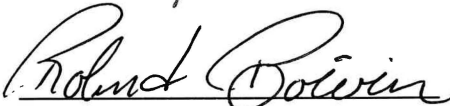
Persons interested in this decision may appeal it within 30 days of the date of this decision to the Lamoille Unit of the Civil Division of the Vermont Superior Court in writing, pursuant to V.R.C.P. 74, 75. Failure to appeal may prevent future litigation on the decision to lay out these highways.

# NEW TH Crabapple 1872

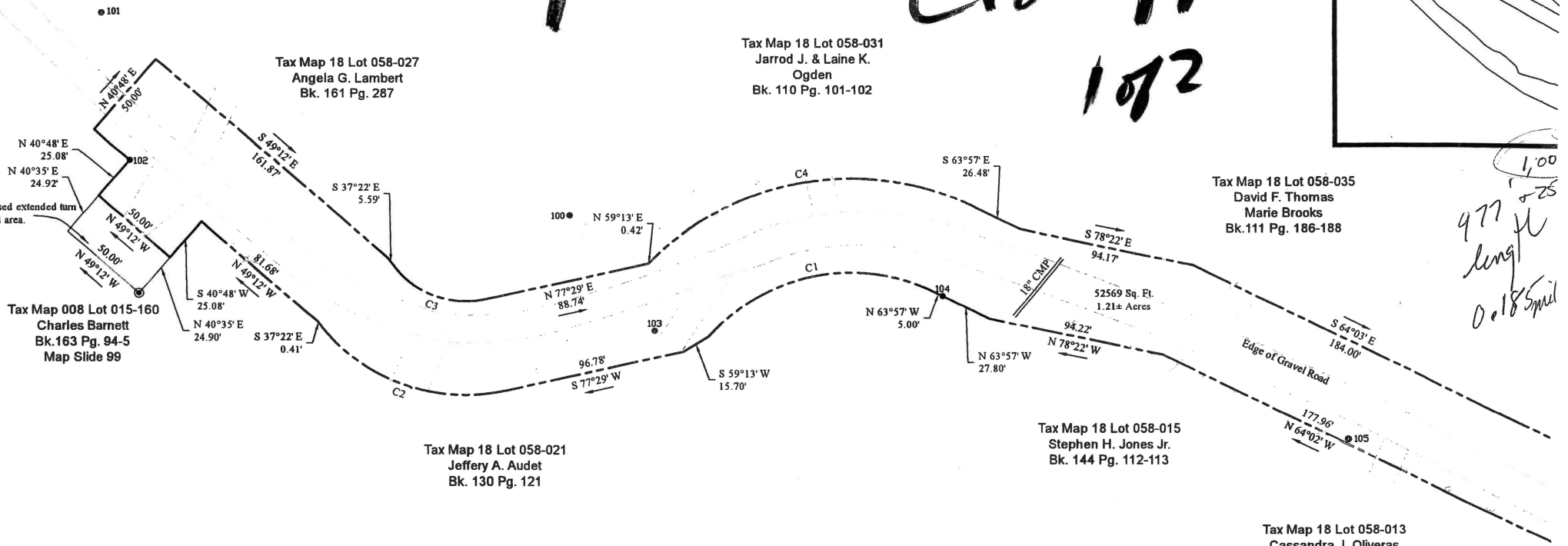
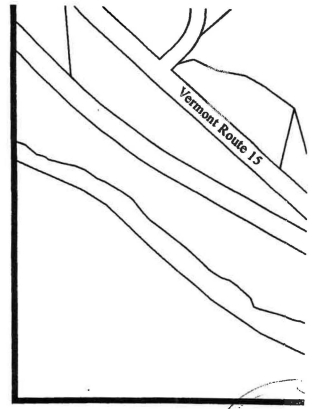

1.00  
977 ± 25  
length  
0.185 miles

**NOTES:**

1. Orientation is Vermont Grid.
2. Highway width is based on monuments found and Reference Plan 1.
3. Other easements and encumbrances, recorded and unrecorded, may exist.

**REFERENCE PLANS:**

1. "Plan of Crabapple Lane in Hyde Park, Vermont", Scale: 1 inch = 50 feet, Dated July 1988, Prepared by Spear Surveying, Inc. and on record at the Hyde Park Town Clerk's Office.
2. "Plan of Lots 7, 98 & 99 in Hyde Park, Vermont at the "Lanphear Subdivision"", Scale: 1 inch = 50 feet, Dated June, 1987, Prepared by Spear Surveying, Inc. and on record at the Hyde Park Town Clerk's Office.
3. "Plan of Land in Hyde Park, Vermont being Conveyed by H.A. Monash, Inc. to Susan A. Heiser", Scale: 1 inch = 50 feet, Dated August, 1984, Prepared by J.P.R. Surveying, and on record at the Hyde Park Town

CURVE	RADIUS	ARC LENGTH	CHORD LENGTH	CHORD BEARING	DELTA ANGLE
C1	100.00'	131.07'	121.89'	S 78°30' W	75°05'51"
C2	97.61'	111.00'	105.12'	N 69°56' W	65°09'20"
C3	47.61'	54.14'	51.27'	S 69°56' E	65°09'15"
C4	150.00'	187.78'	175.76'	N 80°12' E	71°43'36"

# NEW TH

# 2 of 2

Tax Map 18 Lot 058-039  
Julie Hill  
Bk. 70 Pg. 296

Tax Map 18 Lot 058-035  
David F. Thomas  
Marie Brooks  
Bk. 111 Pg. 186-188

Tax Map 18 Lot 058-015  
Stephen H. Jones Jr.  
Bk. 144 Pg. 112-113

Tax Map 18 Lot 058-013  
Cassandra Oliveras  
Bk. 105 P. 267

Tax Map 18 Lot 058-011  
Adrian Audette  
Michelle Lewia  
Bk. 178 Pg. 138  
Map Slide 3 Map #29

Tax Map 18 Lot 058-019  
Milton J. & Mary Lu  
Bowen  
Bk. 61 Pg. 71-72

Tax Map 18 Lot 058-021  
Adrian Audette  
Pg. 121

CURVE	RADIUS	ARC LENGTH	CHORD LENGTH	CHORD BEARING	DELTA ANGLE
C1	100.00'	131.07'	121.89'	S 78°30' W	75°05'51"
C2	97.61'	111.00'	105.12'	N 69°56' W	65°09'20"
C3	47.61'	54.14'	51.27'	S 69°56' E	65°09'15"
C4	150.00'	187.78'	175.76'	N 80°12' E	71°43'36"

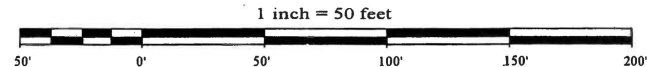

**Hyde Park, Vt. Town Clerk's Office**  
**RECEIVED FOR RECORD**  
January 8, 2020  
119  
Kimberly Newton

The recordable mylar plat conforms with 27 VSA 1403. Survey information is based on a total station and survey grade GPS survey and is consistent, except as noted, with previous surveys, field evidence, and references shown to the best of my knowledge and belief. See survey notes for additional details. Except for the recordable mylar, only copies signed in red are certified by the land surveyor.

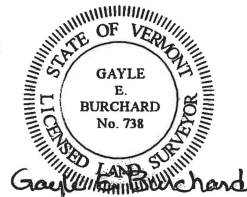

**Boundary Plan**

*Crabapple Lane*

Hyde Park, Lamoille County, Vermont

SHEET 1 OF 1	<p><b>Little River</b> <b>Survey Company, L.L.C.</b> P.O. Box 1208, 3283 Pucker Street Stowe, Vermont 05672 Tel: (802)253-8214 Fax: (802)253-2269</p>	<p>SCALE: 1"=50'</p> <p>DRAWN BY: GEB</p> <p>CHECK BY: PSK</p> <p>DATE: OCT. 2018</p> <p>JOB: 17249</p>
--------------	---	---



**TH 88**  
**1062**

Note 1: GNSS Survey of existing road centerline completed 12/24/2019.  
 Note 2: Redrawing of Bigelow Survey (Slide #40) to show placement of highway dedication.  
 Note 3: Bigelow Survey (Plot Slide #40) has minor calculated discrepancies. This redrawing of the Bigelow Survey "best fits" with the current evidence & measurements.  
 Note 4: No Attempt was Made to locate underground utilities beyond what is shown on this survey.  
 Note 5: This is NOT an engineering plan nor is it intended to be one.  
 Note 6: All Grade % are approximate.

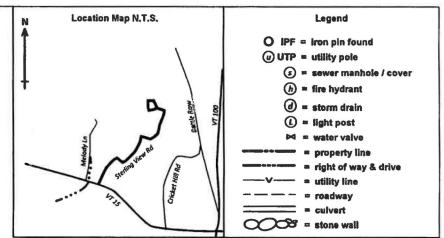

3,644.83' Current Road Surface from Edge of VT 15 West Asphalt to End of Previous Dedication  
 1,429.04' New Road Surface to Be Dedicated in this Survey  
 5,073.87' Total Road Surface of Sterling View Rd

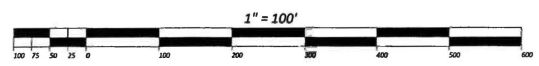
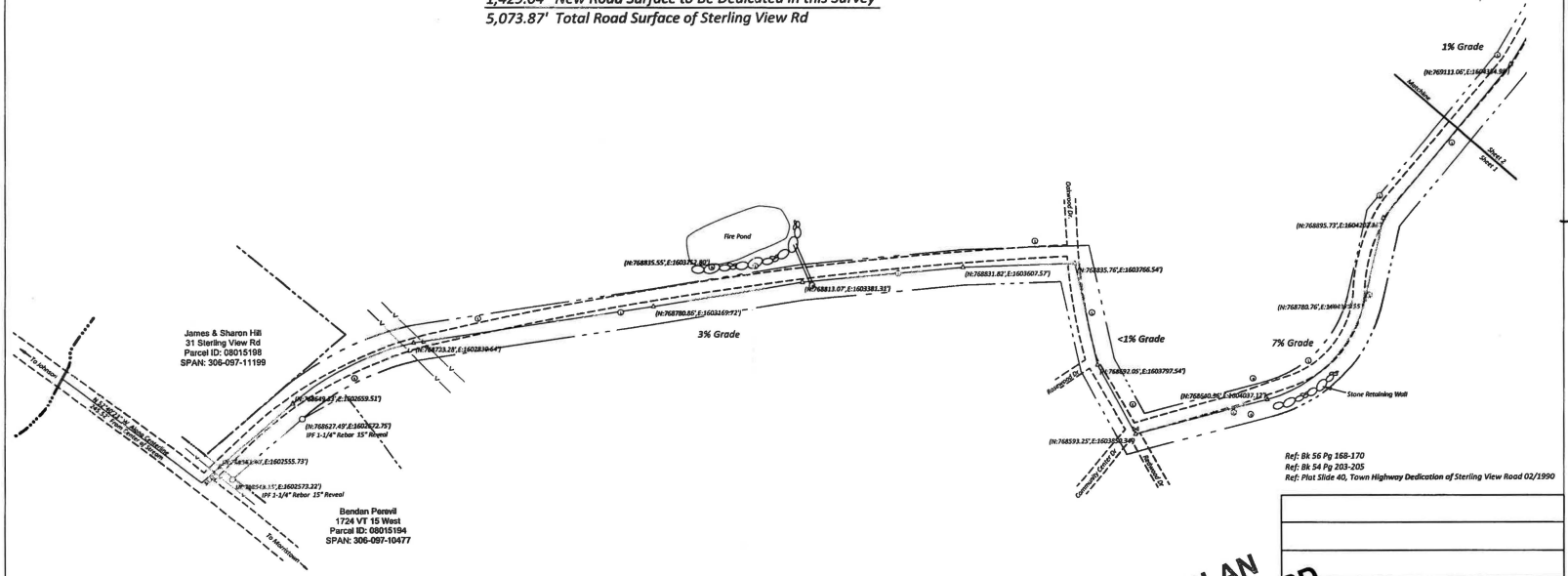

Matt Reed Land Planning Services LLC  
 112 Stone Hill Dr, Hyde Park, VT 05655  
 (802) 888-1704  
 matt.reed.1919@gmail.com

**PELIMINARY PLAN**  
**DO NOT COPY OR RECORD**  
 COPYRIGHT MATT REED  
**LAND PLANNING SERVICES LLC**

Dedication of Additional Sterling View Rd:  
**KENNETH A. & MARTHA B. HARVEY**  
 TO TOWN OF HYDE PARK  
 292 Sterling View Rd  
 Hyde Park, VT  
 Parcel ID: 08015180  
 SPAN: 306-097-10541  
 LAT: 44.60979 LON: -72.63939  
 DATE: January 16, 2019 Sheet 1 of 1

Slide 119  
 pg 741  
 on 1-08-2020

*Graboppe*  
 Also in  
 V119

To be filed  
 in  
 Slide

119  
 1/28/2020

742A, B

1 **Selectboard**  
2 **October 21, 2019**  
3 **MONTHLY MEETING**

4 *All minutes are draft until approved by the Selectboard; please check future minutes for approval of these minutes.*  
5 *Meetings may be videotaped; recordings are held by Green Mountain Access Television. GMATV info: PO Box 581, Hyde*  
6 *Park, 05655; [info@greenmountainaccess.tv](mailto:info@greenmountainaccess.tv) or 802-851-1592*

7 **Members Present:** Susan Bartlett, Chair; David Gagnier (6:56 p.m.), Vice-Chair; Roger Barry; Roger  
8 Audet and Roland Boivin

9 **Members Absent:** None

10 **Others Present:** Ron Rodjenski, Town Administrator; Town Fire Chief Ed Webster and Ryan  
11 Nolan, Hyde Park Town Fire; Carol Robertson, Village General Manager; John  
12 Bornemann; Tom Sheppard; Melissa Sheppard; Bob Falker; North Hyde  
13 Park/Eden Fire Chief John Savage; GMATV did videotape this meeting.

14 Susan opened the meeting at 6:00 p.m.

15 1. **Welcome, Changes to the Agenda and Public Comment** – Added PO# 2019-07 & Non-Employee Contract  
16 for Grange performer.

17 2. **CONTINUATION of public hearing on road laying out and reclassifications.** Motion by Roger A to open the  
18 road hearing recessed on 10-17-2019. Seconded by Roland. Voting: 4 in favor, 0 against, motion passed.  
19 Ron reported that two letters were received as part of the hearing testimony; one from Vermont FPR and  
20 one from Sterling View Co-Op, Paul Nesky. VT FPR recommends that Class 4 roads that access ponds be  
21 reclassified to public trails. The Board felt that since the TH74 length is only 225 feet, and there is not any  
22 public access to the nearby pond which is over 300 feet from the end of the Class 4, that discontinuance  
23 would not create any new access issue and Garfield Road is nearby for parking should access be granted  
24 by the landowner. Bob Falker, Orchard Terrace, asked if the 130 feet was near the hedges and Susan  
25 reported that the public road, Orchard Terrace, will end on the Andrews' parcel if the rest of the  
26 unclassified road on the Flaker parcel is discontinued and town plows will no longer travel on Falker's  
27 parcel. Motion by Roger A to close the road reclassification public hearing on the nine roads and move into  
28 deliberations. Seconded by Roland. Voting: 4 in favor, 0 against, motion passed.

29 3. **Fire Department – Stipends for Officers and Hourly Pay Schedule** – Roger Audet suggested that the  
30 officers should divide up a lump sum rather than having a fixed amount by rank. Roger A noted that the  
31 loyalty to volunteer for the Town is fading but he recognized that some compensation is good, maybe a  
32 lump sum of \$1,000. Roger noted that the Selectboard volunteers a lot without much compensation. Chief  
33 Webster suggested that \$750 annual stipend is recommended for the Chief and then reduced by officer  
34 rank, to recognize officers for additional time at the fire station and doing paperwork for required reports.  
35 Susan explained that towns are moving to paid employees gradually that are supported by volunteers.  
36 Roger A stated that all equipment is new and somewhere there could be a breaking point. Chief Webster  
37 agreed society is headed that way toward paid firefighters. Roger A said that he sees people are having  
38 trouble paying taxes. Roland suggested that the proposal could go to town meeting. Chief Savage stated  
39 that his officers are against this, but they estimate a 25 hour per week job on top of their personnel  
40 business, and he sees the required hours going up each year. Ryan Nolan noted that the responsibility for  
41 safety on the scene are also increasing for the fire officers. Chief Savage stated he sees paid firefighters in  
42 the future for many small-town fire departments. Susan asked what the best path for communities is to  
43 follow with increasing costs, such as joining departments with a full-time Chief, is that realistic to start  
44 working on now. Chief Webster noted Cambridge and Johnson had discussed it but did not pursue it. The  
45 Board agreed to continue to discuss the topic and Chief noted he is coming to the Board for his full budget  
46 presentation in December.

47 4. **NHP/Eden Fire Department** – Draft Disposition of Assets MOU, 10/03 Meeting & Vehicle Insurance. Chief  
48 Savage reported that his insurance would pay the resale value not full replacement cost. Chief Savage will  
49 be getting more information on insurance. The MOU did not have many changes from the October 3<sup>rd</sup> joint

1 meeting with Eden, it was mostly insurance clarification that is needed and adding space for all Selectboard  
2 members to sign the MOU. Chief Savage will check in with Eden to see if they have notes from the meeting.  
3 Chief Savage reported that the \$14,000 for air bottles is a best price for 16 bottles with Hyde Park's half  
4 being \$7,000 for FY2020 and there is a possibly a need for \$8,000 in FY2021 for additional air park  
5 equipment.

- 6 5. **Hyde Park Electric Rates** – Selectboard discussion on community impact of electric rate increase. Susan  
7 explained that she has gotten calls about the electric rates and agreed to put on the agenda. Carol  
8 Robertson reported that the proposed rates are going through the Public Utility Commission noting that  
9 no rate increase has occurred over 9 years, and the electric department is operating very efficiently with  
10 an excellent staff. Carol noted it was hard to compare rates because different providers have different rate  
11 structures. Rates are based on need to meet safety requirements, low staff numbers but platinum level  
12 employees like Karen and John take on the extra burden, and she predicted that the rates will move to the  
13 middle of the pack as other companies are yet to increase their rates. Carol stated that she hopes the new  
14 rates will remain stable, if possible, and the current rate increase is being reviewed by the PUC for 10-29  
15 at 6:30 p.m. in the municipal office's meeting room. Carol was confident with current solar expenses but is  
16 concerned that the State will double the Tier 2 requirements for utilities to use renewable energy which  
17 could force a second major solar field for Hyde Park Electric. Susan asked about the viability of small  
18 municipal companies and whether a coop is likely in the future. Carol agreed that reliability is key for small  
19 municipals, like Hyde Park, and having a good staff with the right equipment could result in more efficiency  
20 and continued high reliability. Carol noted that leaving VESPPA this November relieves Hyde Park electric  
21 of debt risk but still allows Hyde Park to access services for a per-use fee. A letter from Tom Sheppard was  
22 received noting that a high percentage of residents are retired, and the impact of electric rate increases is  
23 harder. Carol stated that the increases are often mandated on the department, noting that most of Hyde  
24 Park customers use 400 kW per month. Tom Sheppard confirmed that his letter was now on the record  
25 which Susan confirmed it was, noting that the Board would review it. Dave Gagnier appeared at this point.
- 26 6. **Highway Projects** – Contracting work vs. adding more “construction” to highway department. The Board  
27 agreed programming general tasks would be good to look at as an option to budgeting for individual line  
28 items. The change may not happen this year, but more use of “small road projects” seemed to be a good  
29 option so a project cost could be more easily tracked with the town accounting system. Ron will review  
30 with Finance Director Alyson Cusson.
- 31 7. **Highway Winter Plow Operators** – Ron noted three individuals are on the list for on-call consideration.  
32 Dave noted that the seasonal on-call people should be working to plow snow and not working in the garage  
33 just to get to 40 hours or more. The Board discussed when to release the 5<sup>th</sup> person during a work week  
34 and the need to manage the budget for the 5<sup>th</sup> person. The Board discussed having a 5<sup>th</sup> person year-round  
35 and Dave noted that the additional hours for the budget would come from existing labor hours for roadside  
36 mowing that still needed to be done, so no gain in work hours unless a large increase in the budget to  
37 retain the seasonal road mowing labor as is. Ron will prepare a cost estimate for having a 5<sup>th</sup> highway crew  
38 member year-round for the November board meeting, with and without using existing labor funds. Motion  
39 by Dave to approve \$17.00/hr for the three winter on-call labor rates. Seconded by Roger A. Voting: 5 in  
40 favor, 0 against, motion passed.
- 41 8. **Personnel Policy** – The Board will discuss amendments at a future work meeting.
- 42 9. **Town Listers** – Motion by Dave to accept the 2019 Grandlist Errors and Omissions Certificate for the  
43 Whitmore parcel. Seconded by Roland. Voting: 5 in favor, 0 against, motion passed.
- 44 10. **Review minutes** – Motion by Roland to approve the 9/16/2019 minutes, as written. Seconded by Roger A.  
45 Voting: 5 in favor, 0 against, motion passed.
- 46 11. **Review Town Orders** – Motion by Roger A to approve the town orders. Seconded by Dave. Voting: 5 in  
47 favor, 0 against, motion passed.
- 48



1    **12. Other Business & Notices**

2           a) Purchase Order #2019-07 – Motion by Roland to approve the town server replacement for  
3           \$9,000 with funding from three budget line items. Seconded by Dave. Discussion: Ron noted  
4           that a purchase order is required as this is an unplanned expense. Voting: 5 in favor, 0 against,  
5           motion passed.

6           b) Non-Employee Work Contract – Abby Sherman. Motion by Roland to approve the non-  
7           employee work contract which is related to Abby Sherman not maintaining workers’  
8           compensation insurance. Seconded by Roland. Voting: 5 in favor, 0 against, motion passed.

9           c) Dubois-King to extend the work contract under the Better Connections project to November  
10          22, 2019. Motion by Roland to approve the second amendment to the Dubois-King contract  
11          by extending the completion date to 11/22/2019. Seconded by Roger A. Voting: 5 in favor, 0  
12          against, motion passed.

13          d) Executive Session: Motion by Roger A. to move into executive discussion to discuss town  
14          personal matters under 1 VSA 313, a. Seconded by Roland. Voting: 5 in favor, 0 against,  
15          motion passed.

16    **13. Adjourn –** Motion by Dave to adjourn at 8:30 p.m. Seconded by Roland. Voting: 5 in favor, 0 against, motion  
17    passed.

1 **Selectboard**  
2 **October 17, 2019**  
3 **MONTHLY MEETING**

4 *All minutes are draft until approved by the Selectboard; please check future minutes for approval of these minutes.*  
5 *Meetings may be videotaped; recordings are held by Green Mountain Access Television. GMATV info: PO Box 581, Hyde*  
6 *Park, 05655; [info@greenmountainaccess.tv](mailto:info@greenmountainaccess.tv) or 802-851-1592*

7 **Members Present:** Susan Bartlett, Chair; David Gagnier, Vice-Chair; Roger Audet and Roland Boivin

8 **Members Absent:** Roger Barry

9 **Others Present:** Ron Rodjenski, Town Administrator; John Bornemann; GMATV did not  
10 videotape this meeting.

---

11 Susan opened the meeting at 6:00 p.m.

- 12 1. **Public Hearing – Road Classifications** The Board discussed the nine roads being considered for  
13 acceptance, reclassification or discontinuance. Written testimony was accepted into the record.  
14 Board members agreed that the roads were familiar to them from prior site visits or would visit  
15 them following this hearing. Motion by Roland to continue the public hearing to 10-21-2019 at  
16 6:00 p.m. Seconded by Dave. Voting: 4 in favor, 0 against, motion passed.
- 17 2. **Adjourn –** Motion by Dave to adjourn at 9:19 p.m. Seconded by Roland. Voting: 4 in favor, 0  
18 against, motion passed.



Coordinates & Elevations are in U.S. Feet  
 Vermont State Plane Coordinate System NAD 83 (2011)  
 Real Time Correction Based on VTRANS CORS site VJSC on 12/24/2019

Northing	Easting	Notes
700	768561.40022	1602555.73405, R.O.W. CL
701	768649.32990	1602659.51051, R.O.W. CL
703	768733.28279	1602830.64451, R.O.W. CL
704	768780.86215	1603169.72056, R.O.W. CL
705	768813.06772	1603381.31365, R.O.W. CL
706	768831.81895	1603607.56977, R.O.W. CL
707	768835.76237	1603766.54314, R.O.W. CL
708	768692.04637	1603797.53940, R.O.W. CL
709	768593.25363	1603850.33627, R.O.W. CL
710	768640.35991	1604037.12493, R.O.W. CL
711	768780.75583	1604175.55337, R.O.W. CL
712	768895.73130	1604202.82928, R.O.W. CL
713	769111.05966	1604384.98302, R.O.W. CL
714	769327.07138	1604512.87981, R.O.W. CL
715	769292.31158	1604575.94493, R.O.W. CL
716	769220.01818	1604672.42097, R.O.W. CL
717	769228.44433	1604741.16926, R.O.W. CL
718	769361.76997	1604849.82580, R.O.W. CL
719	769417.08184	1604926.77172, R.O.W. CL
720	769486.45519	1604993.98518, R.O.W. CL
721	769732.16043	1605046.11875, R.O.W. CL
722	769873.90047	1605115.70926, R.O.W. CL
723	770028.11176	1605191.42281, R.O.W. CL
724	770161.84899	1605153.00407, R.O.W. CL
725	770249.05900	1605009.77600, R.O.W. CL
726	770311.10800	1604784.63100, R.O.W. CL
727	770337.05700	1604735.44800, R.O.W. CL
728	770423.05511	1604727.48236, R.O.W. CL
729	770491.91391	1604814.36020, R.O.W. CL
730	770512.08900	1604946.87600, R.O.W. CL
731	770504.86942	1604965.59874, R.O.W. CL
732	770448.00800	1605001.74400, R.O.W. CL
733	770359.38500	1604995.75000, R.O.W. CL
734	770296.52200	1604993.79100, R.O.W. CL

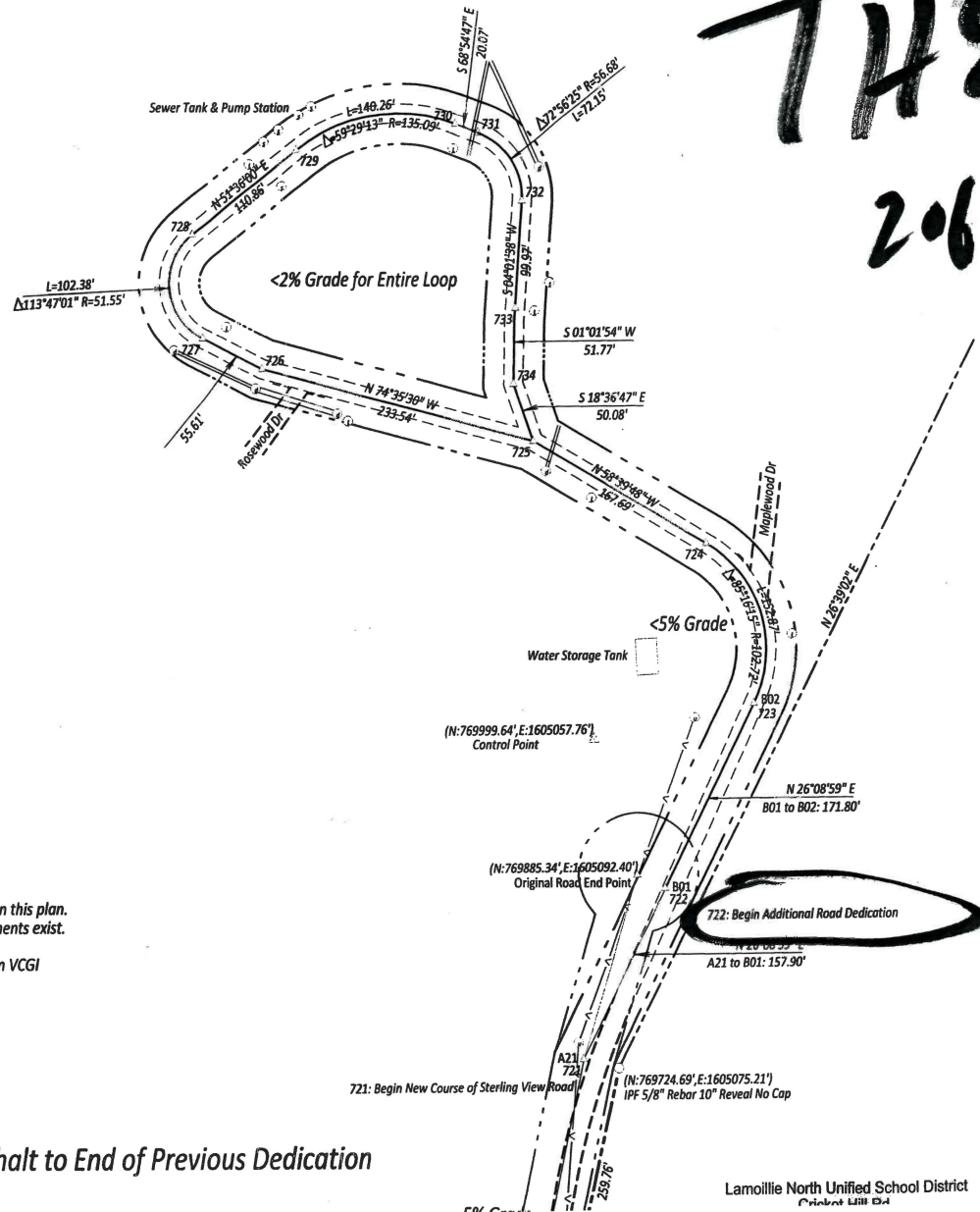

**TH88**  
**2062**

Location Map N.T.S.

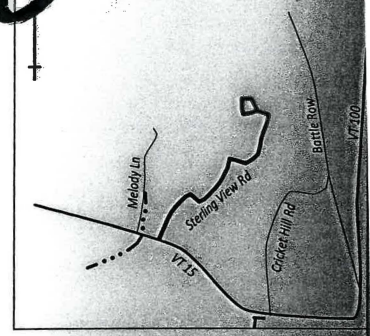

tes:  
 igs reference VT State Plane Grid North unless otherwise noted.  
 pt has been made to locate or identify any easements or R.O.W. unless otherwise shown on this plan.  
 is subject to utility easements recorded or unrecorded. Presence of utilities indicates easements exist.  
 Property Owners are Now or Formerly.  
 owners depicted outside of / adjacent to this parcel are approximate with references from VCGI  
 id are for INFORMATIONAL PURPOSES ONLY.  
 und utilities & structures are approximate.  
 ence to slope or grade % is approximate.  
 tions reference the R.O.W., NOT the centerline unless otherwise shown  
 may be subject to encumbrances outside of the scope and authority of this project.

- Note 1: GNSS Survey of existing road centerline
- Note 2: Redrawing of Bigelow Survey (Side #40) highway dedication.
- Note 3: Bigelow Survey (Plot Side #40) has minor errors. This redrawing of the Bigelow Survey "best fits" monuments.
- Note 4: No Attempt was Made to locate underground utilities shown on this survey.
- Note 5: This is NOT an engineering plan not to be used for construction.
- Note 6: All Grade % are approximate.
- Note 7: Sterling View Rd established as 50' wide.

**urrent Road Surface from Edge of VT 15 West Asphalt to End of Previous Dedication**  
**ew Road Surface to Be Dedicated in this Survey**

Lamoille North Unified School District  
 October 14th, 2014

## Alley, Kerry

---

**From:** Alley, Kerry  
**Sent:** Friday, December 21, 2018 12:37 PM  
**To:** 'Ron Rodjenski'; Hermanson, Tyler; Croft, Johnathan; Moulton, Sara; Grimaldi, Kevan  
**Subject:** RE: Public road issue Webster Rd/Quiet Ln Hyde Park

Hi Ron,

Thanks for your clarification, and especially for including us in the loop!

This case is my new "Poster Example" illustrating why research has to be done before updating our road centerline data to match other sources of information. I've reverted our centerline position back to the CL4 ROW you highlighted in yellow, and will show it like that until we hear about any official changes from you.

Thanks again, and Happy Holidays!

Kerry

---

**From:** Ron Rodjenski <Ron@hydeparkvt.com>  
**Sent:** Friday, December 21, 2018 11:35 AM  
**To:** Alley, Kerry <Kerry.Alley@vermont.gov>; Hermanson, Tyler <Tyler.Hermanson@vermont.gov>; Croft, Johnathan <Johnathan.Croft@vermont.gov>; Moulton, Sara <Sara.Moulton@vermont.gov>; Grimaldi, Kevan <Kevan.Grimaldi@vermont.gov>  
**Subject:** Re: Public road issue Webster Rd/Quiet Ln Hyde Park

Hi Kerry

We have a request to discontinue and a request to reclassify portions of TH38, but any action was deferred by the Selectboard until warmer weather in 2019. Prior requests were rejected to maintain the Class 4. This could affect the classification of TH38 from Grimes Road to the Larson Lane/Webster Road intersection.

A subdivision application produced a new survey for TH38 which differs from the current VTrans information. The below image shows the surveyed TH38 in the yellow highlight alignment. I'll send the survey to you after the holiday break. The yellow highlight has no roadway improvements at the current time - your blue line from the two ends of my yellow highlight is a maintained private road to two homes and is located within in a private 50-foot easement. Larson Lane is a private road.

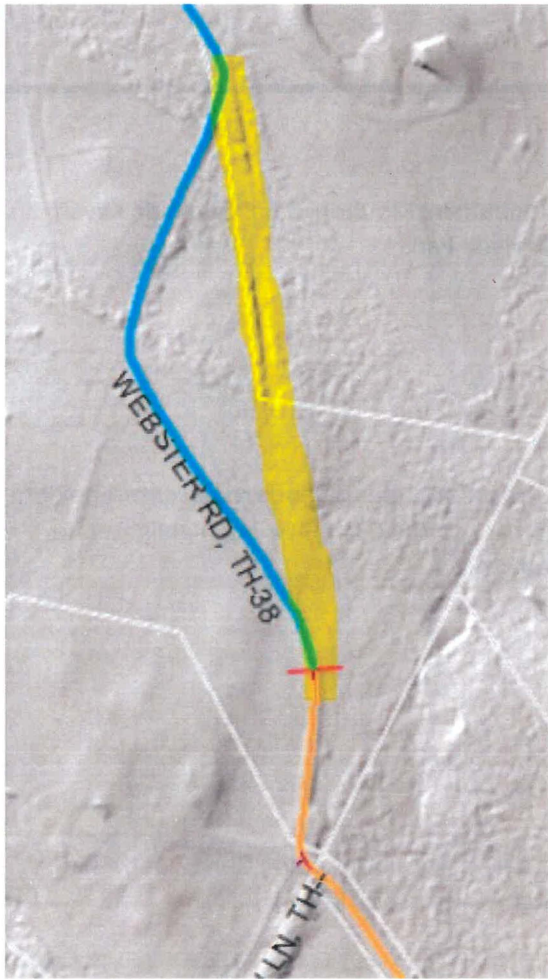

Ron

Ronald Rodjenski  
Town Administrator  
Zoning Administrator  
802-888-2300 x2  
<http://www.hydeparkvt.com>

Have you signed up with Front Porch Forum? Sign up today at [FrontPorchForum.com](http://FrontPorchForum.com). Hyde Park neighbors are joining daily. -Find a plumber or electrician. - Recommend a babysitter. - Sell a bike or canoe.

*NOTICE: Under Vermont's public records law, documents - including e-mail - in the possession of public officials are public records. This means if anyone asks to see it, we are, in most situations, required to provide it. We welcome citizen comments but please keep in mind that what you write in an e-mail is not private.*

**From:** Alley, Kerry <[Kerry.Alley@vermont.gov](mailto:Kerry.Alley@vermont.gov)>  
**Sent:** Friday, December 21, 2018 11:25 AM  
**To:** Hermanson, Tyler; Croft, Johnathan; Moulton, Sara; Grimaldi, Kevan; Ron Rodjenski  
**Subject:** RE: Public road issue Webster Rd/Quiet Ln Hyde Park

Thanks Tyler and Ron!

Question for Ron: Does the Town have plans to make any changes to the CL4 ROW?

And thanks again for pointing this out to us. Our linework reflected the correct layout for the class 4 ROW \*until\* this year (see image from 2017 Town Highway Map below), so we were able to correct the mistake before producing a new Town Highway Map! This was an oversight, as we generally research such changes to avoid exactly this kind of error... and it serves as a good example/reminder of why! The Lidar data is also revealing (see image below)

From 2017 Town Highway Map:



Lidar data with incorrect CL4 ROW representation:

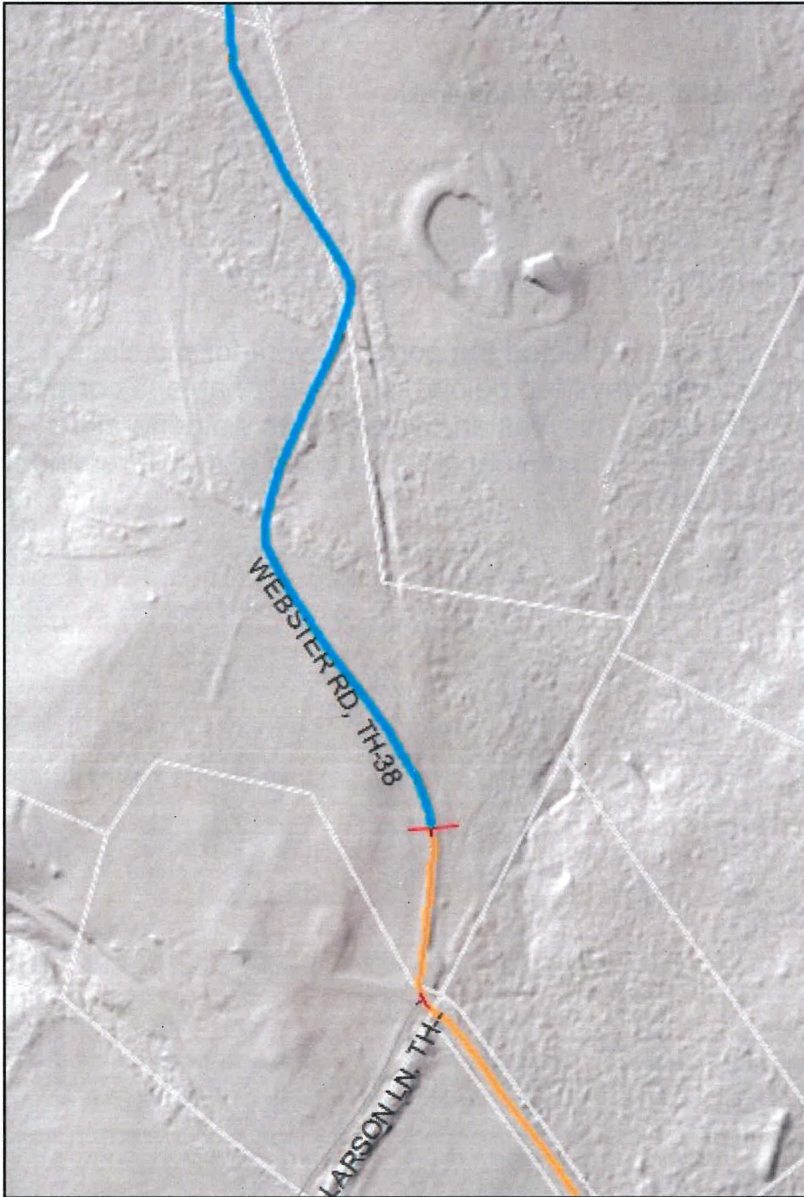

---

Kerry Alley | GIS Professional III  
Vermont Agency of Transportation  
1 National Life Dr | Montpelier, VT 05633  
802-828-3666 | [Kerry.Aleley@vermont.gov](mailto:Kerry.Aleley@vermont.gov)  
<http://vtrans.vermont.gov/planning/maps>

**From:** Hermanson, Tyler <[Tyler.Hermanson@vermont.gov](mailto:Tyler.Hermanson@vermont.gov)>  
**Sent:** Thursday, December 20, 2018 11:15 AM  
**To:** Croft, Johnathan <[Johnathan.Croft@vermont.gov](mailto:Johnathan.Croft@vermont.gov)>; Moulton, Sara <[Sara.Moulton@vermont.gov](mailto:Sara.Moulton@vermont.gov)>; Grimaldi, Kevan <[Kevan.Grimaldi@vermont.gov](mailto:Kevan.Grimaldi@vermont.gov)>; Alley, Kerry <[Kerry.Aleley@vermont.gov](mailto:Kerry.Aleley@vermont.gov)>  
**Cc:** Ron Rodjenski <[Ron@hydeparkvt.com](mailto:Ron@hydeparkvt.com)>  
**Subject:** FW: Public road issue Webster Rd/Quiet Ln Hyde Park

Hi John,



Very interesting issue just came up on a call from Hyde Park. See his screenshot at the bottom of the email in which they had just done a survey due to recent construction and they found out that the road (AOT Class 4) is in the wrong spot and that the road is not the Right of Way. The ROW is not being used and there is a private section of road. At some point, he will send you guys the survey that was done but wanted to tie AOT into this issue.

For 911 it's a bit weird, but I drew it in as Class 3 to then private to then class 4 to indicate the true road location that is being used. This is one of those scenarios where we won't add the ROW class 4 as that would certainly confuse 911 call takers or those who use our maps. This Class 4 section also has the same HWY # and it's not clear where Webster Rd becomes Quiet Lane so I picked the Westerly most Tree/Meadow line for now until that becomes clearer.

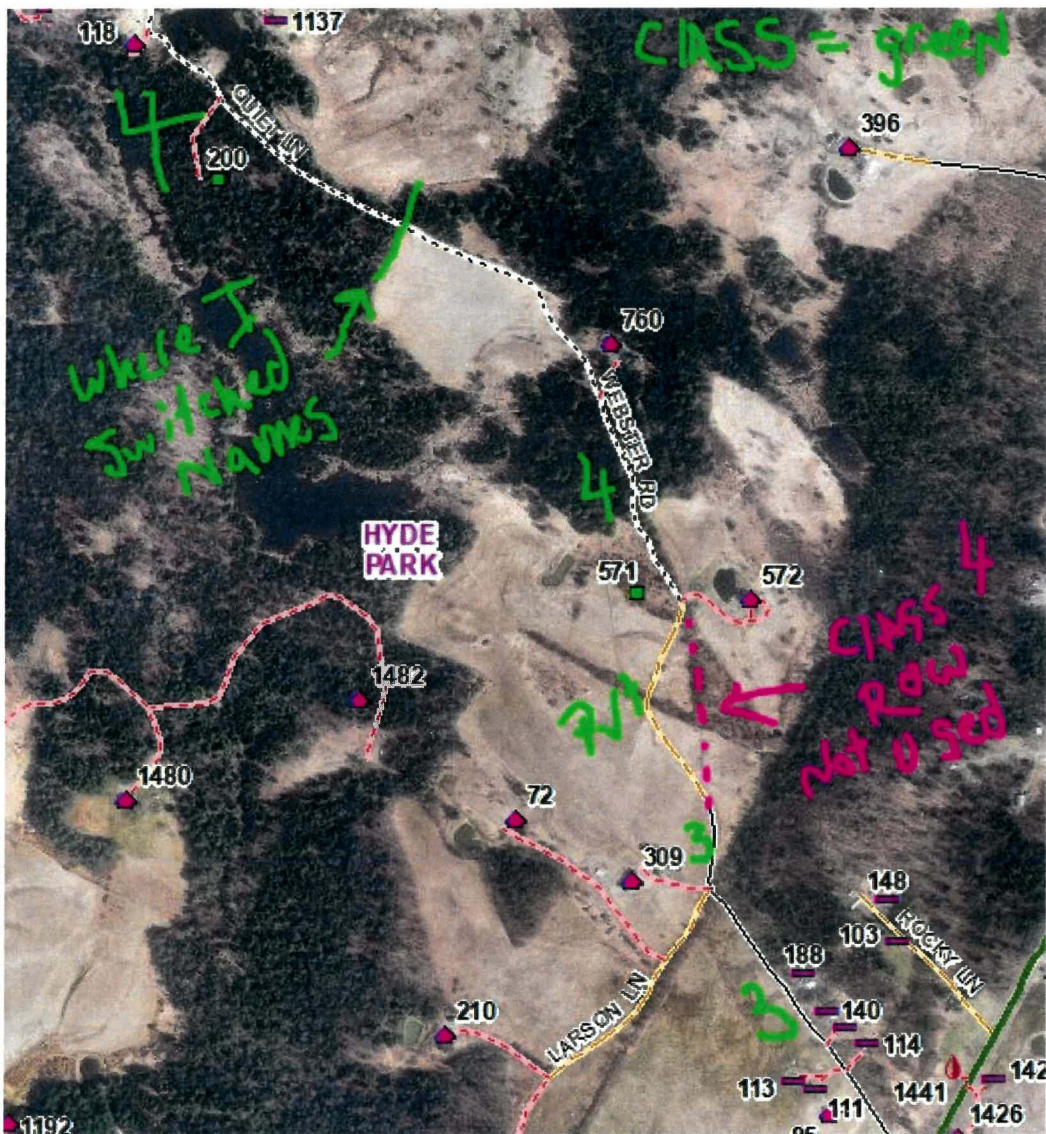

Blue portions on this photo essentially are Class 4 roads that are "not used" and not really a thing on the ground.

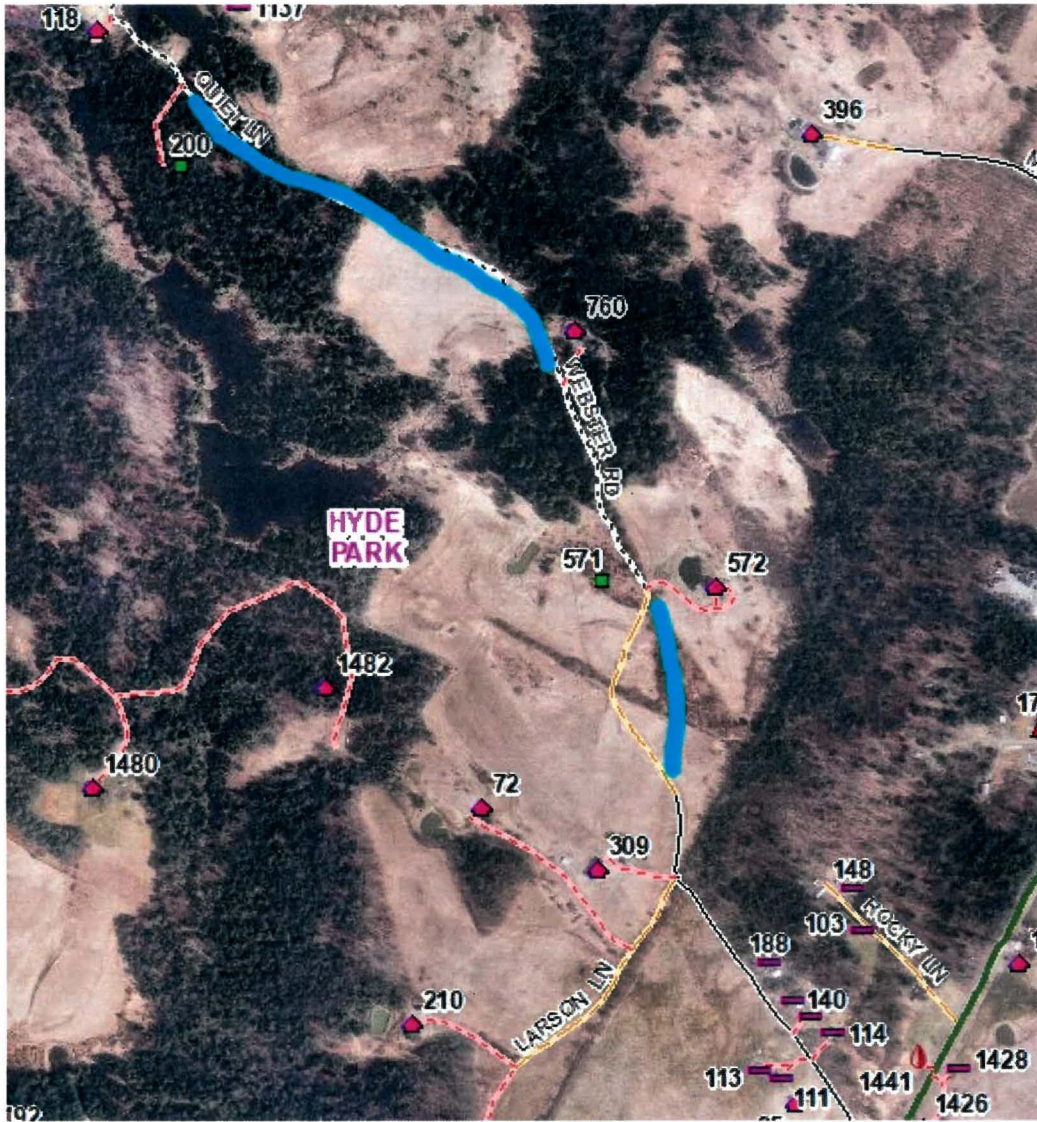

Blank Photo showing how it will look on 911's side:



*Tyler Hermanson*

GIS Specialist - Vermont Enhanced 9-1-1 Board  
100 State St, Montpelier, VT 05620-6501

E: [tyler.hermanson@vermont.gov](mailto:tyler.hermanson@vermont.gov) Work: 802-828-4092 | Cell: 802-380-4499 | Fax: 802-828-4109 | **Tue - Fri** : 7-5:30

**From:** Ron Rodjenski <[Ron@hydeparkvt.com](mailto:Ron@hydeparkvt.com)>  
**Sent:** Thursday, December 20, 2018 10:28 AM  
**To:** Hermanson, Tyler <[Tyler.Hermanson@vermont.gov](mailto:Tyler.Hermanson@vermont.gov)>  
**Subject:** Re: Public road issue

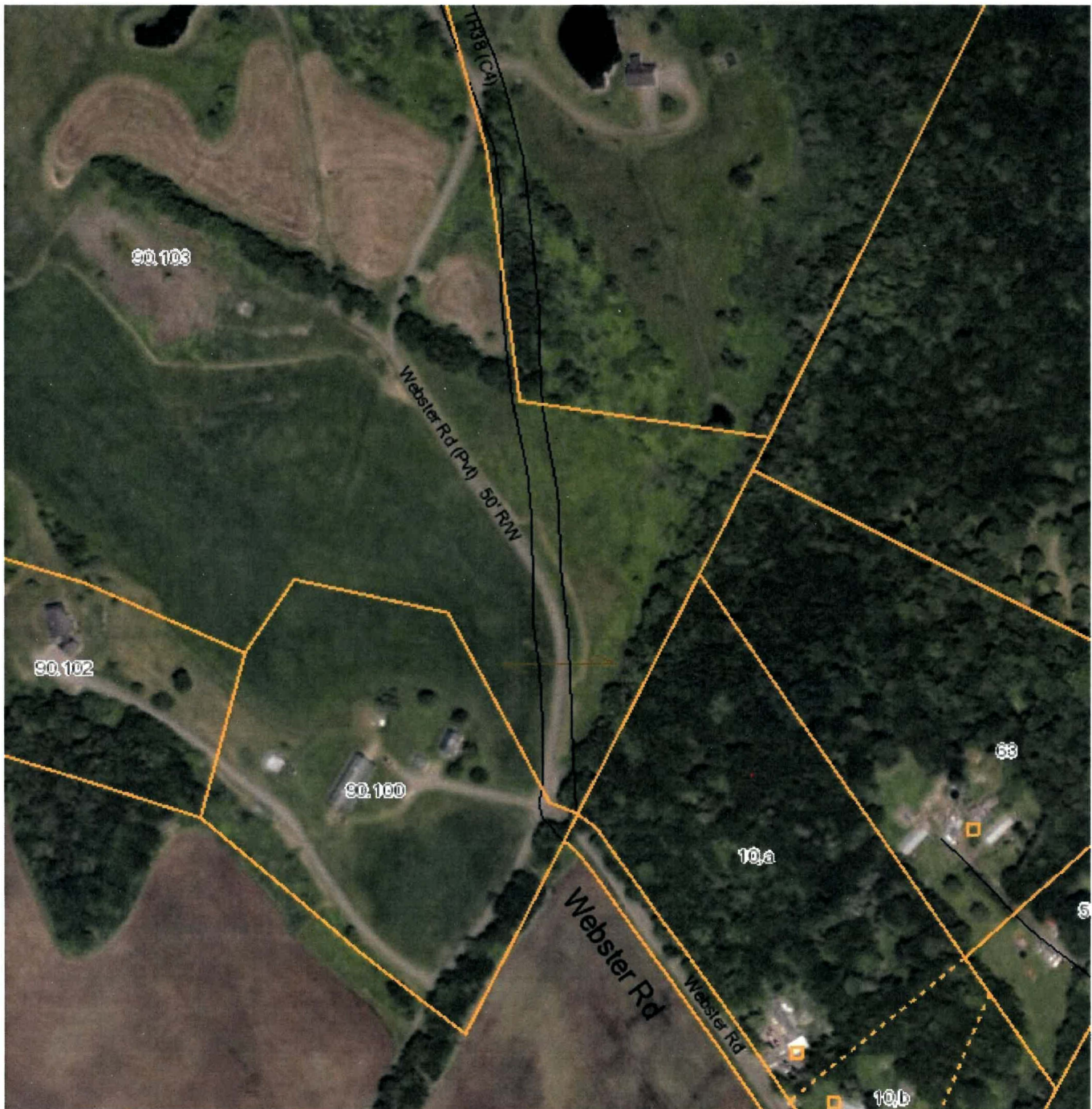

Ronald Rodjenski  
Town Administrator  
Zoning Administrator  
802-888-2300 x2  
<http://www.hydeparkvt.com>

Have you signed up with Front Porch Forum? Sign up today at [FrontPorchForum.com](http://FrontPorchForum.com). Hyde Park neighbors are joining daily. -Find a plumber or electrician. - Recommend a babysitter. - Sell a bike or canoe.  
*NOTICE: Under Vermont's public records law, documents - including e-mail - in the possession of public officials are public records. This means if anyone asks to see it, we are, in most situations, required to provide it. We welcome citizen comments but please keep in mind that what you write in an e-mail is not private.*