

District 1

CERTIFICATE OF HIGHWAY MILEAGE
YEAR ENDING FEBRUARY 10, 2014



Fill out form, make and file copy with the Town Clerk, and mail ORIGINAL, before February 20, 2014 to:
Vermont Agency of Transportation, Division of Policy, Planning and Intermodal Development,
One National Life Drive, Montpelier, VT 05633.

We, the members of the legislative body of DORSET in BENNINGTON County
on an oath state that the mileage of highways, according to Vermont Statutes Annotated, Title 19, Section 305,
added 1985, is as follows:

PART I - CHANGES TOTALS - Please fill in and calculate totals.

Town Highways	Previous Mileage	Added Mileage	Subtracted Mileage	Total	Scenic Highways
Class 1	0.000	0	0	0	0.000
Class 2	13.850	0	0	13.850	0.000
Class 3	24.86	0.02	0.23	24.65	0.000
State Highway	13.671	0	0	13.671	0.000
Total	52.381			52.171	0.000
* Class 1 Lane	0.000	0	0	0	0.000
* Class 4	0.55	0	0	0.55	
* Legal Trail	8.04	0	0	8.04	
* Unidentified Corridor	0.00	0	0	0	

* Mileage for Class 1 Lane, Class 4, Legal Trail, and Unidentified Corridor classifications are NOT included in total.

PART II - INFORMATION AND DESCRIPTION OF CHANGES SHOWN ABOVE.

1. NEW HIGHWAYS: Please attach Selectmen's "Certificate of Completion and Opening".

Done All
4/10/2014

2. DISCONTINUED: Please attach SIGNED copy of proceedings (minutes of meeting).

PROVIDED

3. RECLASSIFIED/REMEASURED: Please attach SIGNED copy of proceedings (minutes of meeting).

4. SCENIC HIGHWAYS: Please attach a copy of order designating/discontinuing Scenic Highways.

IF THERE ARE NO CHANGES IN MILEAGE: Check box and sign below. []

PART III - SIGNATURES - PLEASE SIGN.

Selectmen/ Aldermen/ Trustees Signatures: [Signature], Town Manager
For Chris Brooks, Chair

T/C/V Clerk Signature: [Signature] Date Filed: 2/19/2014

Please sign ORIGINAL and return it for Transportation signature.

AGENCY OF TRANSPORTATION APPROVAL: Signed copy will be returned to T/C/V Clerk.

APPROVED: [Signature]
Representative, Agency of Transportation

DATE: 5/29/2014

Jonathan Croft

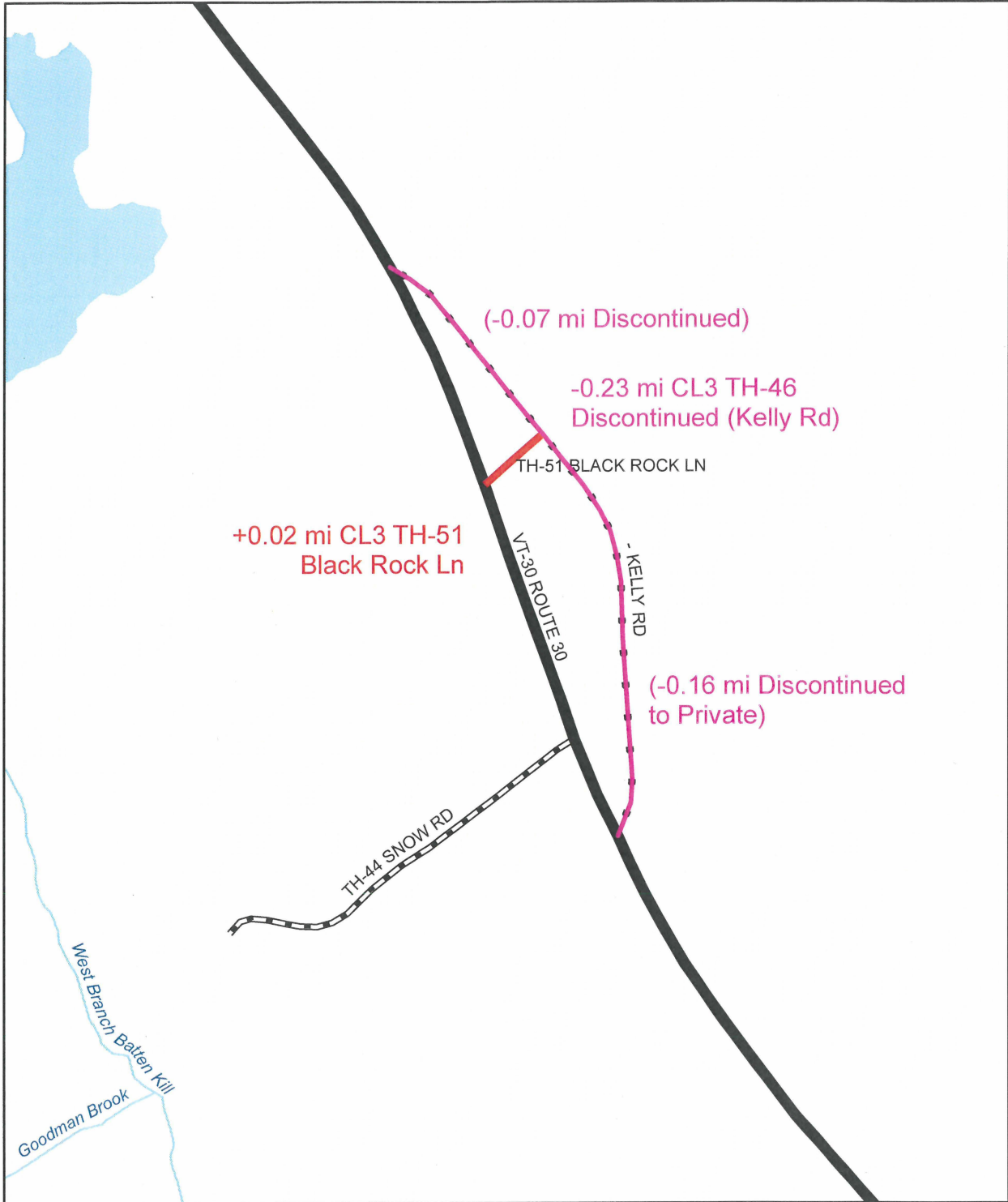

**Mileage Certificate Change 2014
DORSET**

Mapping Unit
 Division of Policy and Planning
 Vermont Agency of Transportation - August 2014

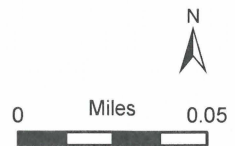

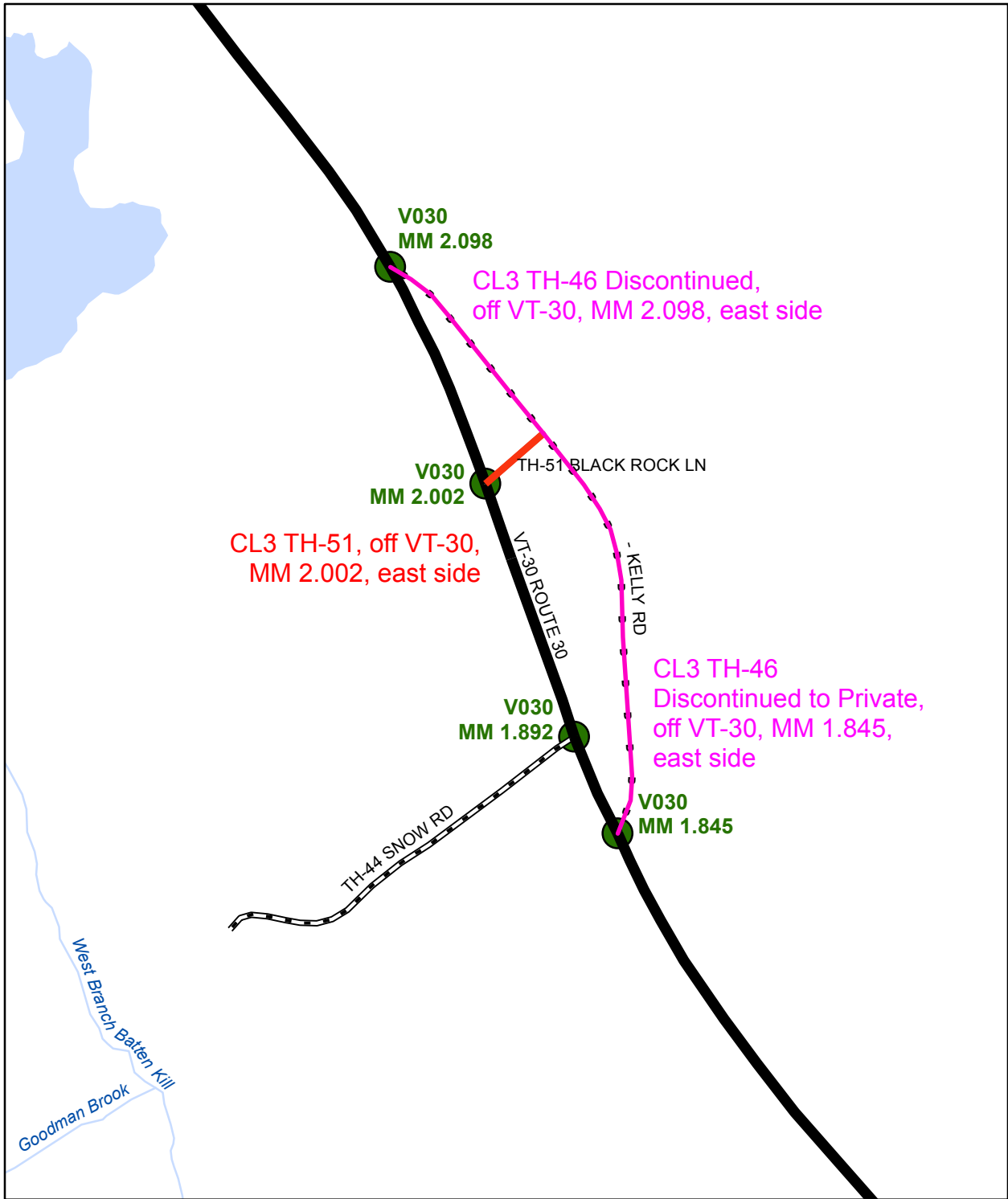

CL3 TH-51, off VT-30,
MM 2.002, east side

CL3 TH-46 Discontinued,
off VT-30, MM 2.098, east side

CL3 TH-46
Discontinued to Private,
off VT-30, MM 1.845,
east side

Mileage Certificate Change 2014 DORSET

Mapping Unit
Division of Policy and Planning
Vermont Agency of Transportation - August 2014



Town of Dorset, Vermont

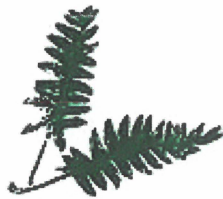

Chartered 1761

Dorset Town Offices:

PO Box 715
112 Mad Tom Road
East Dorset, VT 05253

Dorset Town Manager's Office:

Phone: 802-362-4571 x 3
Fax: 802-362-5156
Email: townmanager@gmail.com
Website: www.dorsetvt.org

February 18, 2014

Gary Smith
Agency of Transportation
Division of Policy, Planning & Intermodal Dev. –Mapping Unit
1 National Life Drive
Montpelier, VT 05633

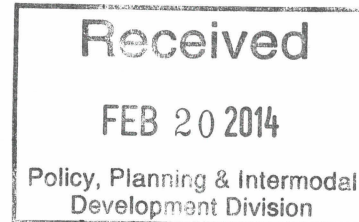

Dear Gary,

Attached please find the updated mileage certificate filled out as outlined in your recent letter to the Town. We also would like to confirm that your mapping of the work done to TH#46 is correct (based on the map you provided). Please let us know if you require additional information, thanks very much for your help!

Sincerely,

Rob Gaiotti
Town Manager

DORSET

Issue:

Discontinue TH-46, Kelly Rd. Layout Black Rock Extension and assign new TH number.

Action needed:

Waiting for a reply to my letters. Copies in the packet

**CERTIFICATE OF HIGHWAY MILEAGE
YEAR ENDING FEBRUARY 10, 2014**

Fill out form, make and file copy with the Town Clerk, and mail ORIGINAL, before February 20, 2014 to:
Vermont Agency of Transportation, Division of Policy, Planning and Intermodal Development,
One National Life Drive, Montpelier, VT 05633.

We, the members of the legislative body of **DORSET** in **BENNINGTON** County
on an oath state that the mileage of highways, according to Vermont Statutes Annotated, Title 19, Section 305,
added 1985, is as follows:

PART I - CHANGES TOTALS - Please fill in and calculate totals.

Town Highways	Previous Mileage	Added Mileage	Subtracted Mileage	Total	Scenic Highways
Class 1	0.000				0.000
Class 2	13.850			13.85	0.000
Class 3	24.86		0.19	24.67	0.000
State Highway				13.671	0.000
Total				52.191	0.000
* Class 1 Lane				0	0.000
* Class 4				0.55	
* Legal Trail				8.04	
* Unidentified Corridor	0.00			0	

Need to account for new road construction 1/29/2014 sent letter on 4 Feb Kerry spoke with Rob Garofiti on Feb 7

* Mileage for Class 1 Lane, Class 4, Legal Trail, and Unidentified Corridor classifications are NOT included in total.

PART II - INFORMATION AND DESCRIPTION OF CHANGES SHOWN ABOVE.

- NEW HIGHWAYS:** Please attach Selectmen's "Certificate of Completion and Opening".
N/A
- DISCONTINUED:** Please attach SIGNED copy of proceedings (minutes of meeting).
Southern 0.13 miles of TH #46 was discontinued
- RECLASSIFIED/REMEASURED:** Please attach SIGNED copy of proceedings (minutes of meeting).
Northern 0.06 miles of TH #46 was altered to 0.04 miles with new ADT compliant intersection.
- SCENIC HIGHWAYS:** Please attach a copy of order designating/discontinuing Scenic Highways.
N/A

IF THERE ARE NO CHANGES IN MILEAGE: Check box and sign below. []

PART III - SIGNATURES - PLEASE SIGN.

Selectmen/ Aldermen/ Trustees Signatures:

[Handwritten signatures: Brad, Michael Connor, and another signature]

T/C/V Clerk Signature:

[Handwritten signature: Sandra Linsmauer]

Date Filed:

01/22/2014

Please sign ORIGINAL and return it for Transportation signature.

AGENCY OF TRANSPORTATION APPROVAL: Signed copy will be returned to T/C/V Clerk.

APPROVED:

Representative, Agency of Transportation

DATE:

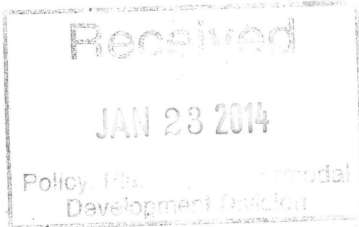

Vermont Statutes Annotated

19 V.S.A. § 305. Measurement and inspection

§ 305. Measurement and inspection

(a) After reasonable notice to the selectboard, a representative of the agency may measure and inspect the class 1, 2, and 3 town highways in each town to verify the accuracy of the records on file with the agency. Upon request, the selectboard or their designee shall be permitted to accompany the representative of the agency during the measurement and inspection. The agency shall notify the town when any highway, or portion of a highway, does not meet the standards for its assigned class. If the town fails, within one year, to restore the highway or portion of the highway to the accepted standard, or to reclassify, or to discontinue, or develop an acceptable schedule for restoring to the accepted standards, the agency for purposes of apportionment under section 306 of this title shall deduct the affected mileage from that assigned to the town for the particular class of the road in question.

(b) Annually, on or before February 10, the selectboard shall file with the town clerk a sworn statement of the description and measurements of all class 1, 2, 3, and 4 town highways and trails then in existence, including any special designation such as a throughway or scenic highway. When class 1, 2, 3, or 4 town highways, trails, or unidentified corridors are accepted, discontinued, or reclassified, a copy of the proceedings shall be filed in the town clerk's office and a copy shall be forwarded to the agency.

(c) All class 1, 2, 3, and 4 town highways and trails shall appear on the town highway maps by July 1, 2015.

(d) At least 45 days prior to first including a town highway or trail that is not clearly observable by physical evidence of its use as a highway or trail and that is legally established prior to February 10, 2006 in the sworn statement required under subsection (b) of this section, the legislative body of the municipality shall provide written notice and an opportunity to be heard at a duly warned meeting of the legislative body to persons owning lands through which a highway or trail passes or abuts.

(e) The agency shall not accept any change in mileage until the records required to be filed in the town clerk's office by this section are received by the agency. A request by a municipality to the agency for a change in mileage shall include a description of the affected highway or trail, a copy of any surveys of the affected highway or trail, minutes of meetings at which the legislative body took action with respect to the changes, and a current town highway map with the requested deletions and additions sketched on it. A survey shall not be required for class 4 town highways that are legally established prior to February 10, 2006. All records filed with the agency are subject to verification in accordance with subsection (a) of this section.

(f) The selectboard of any town who are aggrieved by a finding of the agency concerning the measurement, description, or classification of a town highway may appeal to the transportation board by filing a notice of appeal with the executive secretary of the transportation board.

(g) The agency shall provide each town with a map of all of the highways in that town together with the mileage of each class 1, 2, 3, and 4 highway, as well as each trail, and such other information as the agency deems appropriate.

Excerpt of 19 V.S.A. § 305 - *Measurement and inspection* from Vermont Statutes Online located at – <http://www.leg.state.vt.us/statutes/fullsection.cfm?Title=19&Chapter=003&Section=00305>

1/2/2014

Town Highway/Legal Trails Addition/Reclassification/Discontinuance Checklist

The following includes a checklist of the documentation to be supplied to VTrans when adding / reclassifying / discontinuing highways and trails. The documentation is subject to verification by VTrans.

Check the box if the information is included as part of the documentation submitted.

- A description of the affected highway or trail
Vt. Stat. Ann. tit. 19, § 305(e)
- Minutes of meetings at which the legislative body took action with respect to the changes (include copies of the meeting minutes) Vt. Stat. Ann. tit. 19, § 305(e)
- A current town highway map with the requested deletions and additions sketched on it
Vt. Stat. Ann. tit. 19, § 305(e)
- Evidence of written notice to adjoining landowners
(include a copy of the newspaper notice and a copy of the letter sent to adjoining landowners)
Vt. Stat. Ann. tit. 19, § 709
- A copy of any surveys of the affected highway or trail*
Vt. Stat. Ann. tit. 19, § 305(e) Vt. Stat. Ann. tit. 19, § 704

*Note: A survey shall not be required for class 4 town highways that are legally established prior to February 10, 2006 // and a survey is not needed for Discontinuances.

For Class 3 or Class 4 town highway additions

- A Certificate of Completion and Opening
While not required by statute, a Certificate of Completion and Opening form is a helpful document for the record.

- If the highway or trail to be added is “not clearly observable by physical evidence of its use as a highway or trail”, then supply the additional documentation pursuant to the following statute:

19 V.S.A. § 305(d) - At least 45 days prior to first including a town highway or trail that is not clearly observable by physical evidence of its use as a highway or trail and that is legally established prior to February 10, 2006 in the sworn statement required under subsection (b) of this section, the legislative body of the municipality shall provide written notice and an opportunity to be heard at a duly warned meeting of the legislative body to persons owning lands through which a highway or trail passes or abuts.

All records filed with the agency are subject to verification in accordance with 19 V.S.A. § 305 (a) and 19 V.S.A. § 305 (e).

Dorset, VT – TH46 changes that reduce class 3 mileage by 0.19 miles, according to the Dorset Mileage certificate
AOTMILES has TH-46 being 0.23 miles long



Smith, Gary S.

From: Alley, Kerry
Sent: Friday, February 07, 2014 2:39 PM
To: Smith, Gary S.
Subject: Dorset TH-46 phonecall

Hi Gary,

Rob Gaiotti, the Town Manager of Dorset, called to clarify the situation with TH-46.

He was under the impression that you wondered whether the private road was extended, but it wasn't.

The South part of TH-46 was discontinued (and is essentially like a parking lot now).

The North part of TH-46 was relocated to meet up with the private road, and therefore now has a different length (120'). This change involved removing 0.19 miles of roadway.

He mentioned that they would be discontinuing that remaining portion in the future.

I told him you might want to speak with him directly, because I wasn't familiar enough with the situation to know whether that clarified everything.

His phone # is:
802-362-4571 ext. 3

Kerry Alley
AOT Mapping & GIS Specialist
Vermont Agency of Transportation (VTrans)
(802) 828-3666



State of Vermont

Agency of Transportation

Division of Policy, Planning and Intermodal Development - Mapping Unit

1 National Life Drive

Montpelier, VT 05633-5001

<http://www.aot.state.vt.us>

Telephone: 802-828-3666

Fax: 802-828-2334

Email: gary.s.smith@state.vt.us

February 12, 2014

Mr. Rob Gaiotti
Town Manager
Town of Dorset
P.O. Box 715
East Dorset, VT 05253

Dear Mr. Gaiotti

Thank you for communicating with our office in response to my questions about changes precipitated by the discontinuance of TH-46, Kelly Lane, a 0.23 mile long Dorset town highway. Following another review of the materials submitted with your 2014 Mileage Certificate a much clearer understanding of the Town's action is evident. The following included materials seek to illustrate what we believe is the proper way to record changes in the official Town Highway network.

According to the "TOWN OF DORSET CERTIFICATE OF ACCOMPLISHMENT OF DISCONTINUANCE OF TOWN HIGHWAY #46 KELLY ROAD" recorded on March 13, 2013 By Sandy Pinsonnault, TH-46, a Class 3 road is discontinued. The AOT mileage for this town highway is 0.23 miles. This Class 3 mileage reduction should be entered on your 2014 Mileage Certificate (see enclosed).

In addition, recorded on the same day, by Sandy Pinsonnault was another "TOWN OF DORSET CERTIFICATE OF ACCOMPLISHMENT" for the "ALTERATION AND LAYING OUT OF TOWN HIGHWAY #46 BLACK ROCK ROAD" This action presents a couple of problems. First of all, VTrans assigns all Town Highway numbers. This is for our record keeping and is a firm requirement. Road names are assigned by the Town. Clearly, what the Town is calling Black Rock Lane Extension should be a new Class 3 highway that we will most likely designate TH-51. Records indicate that this extension is 116.39 feet or 0.02 miles long. This mileage should be added to your 2014 Mileage Certificate as additional Class 3 highway.

Since the segment of Kelly Lane to the south of the intersection with private Black Rock Lane is being transferred to private ownership, we will maintain it as a private road associated with TH-46 for record keeping purposes.

In addition to the draft Mileage Certificate I have filled out, I have included a blank copy that I would ask you to fill in, sign and return to us for final execution. I am also including a map that seeks to illustrate my understanding of the Town's actions.

Sincerely,

Gary S. Smith
Mapping & GIS Specialist

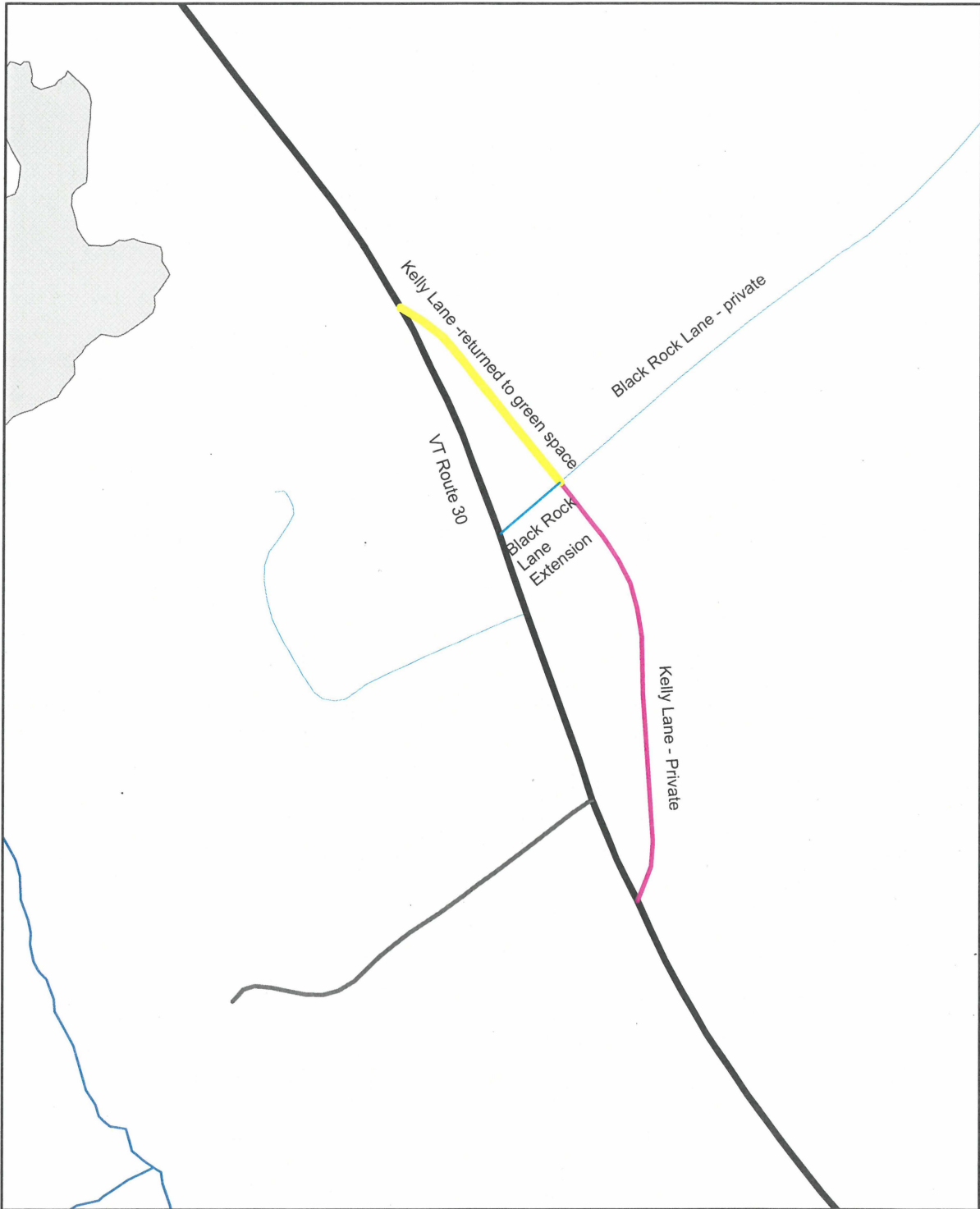

**Discontinuance of Kelly Rd, TH-46 and
The laying out of Black Rock Lane Extension, TH -51
in Dorset, VT**

Mapping Unit
Division of Policy and Planning
Vermont Agency of Transportation -- January 2014

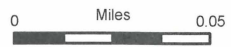

**CERTIFICATE OF HIGHWAY MILEAGE
YEAR ENDING FEBRUARY 10, 2014**

Fill out form, make and file copy with the Town Clerk, and mail ORIGINAL, before February 20, 2014 to:
Vermont Agency of Transportation, Division of Policy, Planning and Intermodal Development,
One National Life Drive, Montpelier, VT 05633.

We, the members of the legislative body of **DORSET** in **BENNINGTON** County
on an oath state that the mileage of highways, according to Vermont Statutes Annotated, Title 19, Section 305,
added 1985, is as follows:

PART I - CHANGES TOTALS - Please fill in and calculate totals.

Town Highways	Previous Mileage	Added Mileage	Subtracted Mileage	Total	Scenic Highways
Class 1	0.000				0.000
Class 2	13.850				0.000
Class 3	24.86	0.02	0.23	24.65	0.000
State Highway	13.671				0.000
Total	52.381				0.000
* Class 1 Lane	0.000				0.000
* Class 4	0.55				
* Legal Trail	8.04				
* Unidentified Corridor	0.00				

* Mileage for Class 1 Lane, Class 4, Legal Trail, and Unidentified Corridor classifications are NOT included in total.

PART II - INFORMATION AND DESCRIPTION OF CHANGES SHOWN ABOVE.

- 1. NEW HIGHWAYS:** Please attach Selectmen's "Certificate of Completion and Opening".
- 2. DISCONTINUED:** Please attach SIGNED copy of proceedings (minutes of meeting).
- 3. RECLASSIFIED/REMEASURED:** Please attach SIGNED copy of proceedings (minutes of meeting).
- 4. SCENIC HIGHWAYS:** Please attach a copy of order designating/discontinuing Scenic Highways.

IF THERE ARE NO CHANGES IN MILEAGE: Check box and sign below. []

PART III - SIGNATURES - PLEASE SIGN.

Selectmen/ Aldermen/ Trustees Signatures: _____

T/C/V Clerk Signature: _____ Date Filed: _____

Please sign ORIGINAL and return it for Transportation signature.

AGENCY OF TRANSPORTATION APPROVAL: Signed copy will be returned to T/C/V Clerk.

APPROVED: _____ **DATE:** _____
 Representative, Agency of Transportation

**CERTIFICATE OF HIGHWAY MILEAGE
YEAR ENDING FEBRUARY 10, 2014**

Fill out form, make and file copy with the Town Clerk, and mail ORIGINAL, before February 20, 2014 to:
Vermont Agency of Transportation, Division of Policy, Planning and Intermodal Development,
One National Life Drive, Montpelier, VT 05633.

We, the members of the legislative body of DORSET in BENNINGTON County
on an oath state that the mileage of highways, according to Vermont Statutes Annotated, Title 19, Section 305,
added 1985, is as follows:

PART I - CHANGES TOTALS - Please fill in and calculate totals.

Town Highways	Previous Mileage	Added Mileage	Subtracted Mileage	Total	Scenic Highways
Class 1	0.000				0.000
Class 2	13.850				0.000
Class 3	24.86				0.000
State Highway	13.671				0.000
Total	52.381				0.000
* Class 1 Lane	0.000				0.000
* Class 4	0.55				
* Legal Trail	8.04				
* Unidentified Corridor	0.00				

* Mileage for Class 1 Lane, Class 4, Legal Trail, and Unidentified Corridor classifications are NOT included in total.

PART II - INFORMATION AND DESCRIPTION OF CHANGES SHOWN ABOVE.

- NEW HIGHWAYS:** Please attach Selectmen's "Certificate of Completion and Opening".
- DISCONTINUED:** Please attach SIGNED copy of proceedings (minutes of meeting).
- RECLASSIFIED/REMEASURED:** Please attach SIGNED copy of proceedings (minutes of meeting).
- SCENIC HIGHWAYS:** Please attach a copy of order designating/discontinuing Scenic Highways.

IF THERE ARE NO CHANGES IN MILEAGE: Check box and sign below. []

PART III - SIGNATURES - PLEASE SIGN.

Selectmen/ Aldermen/ Trustees Signatures: _____

T/C/V Clerk Signature: _____ Date Filed: _____

Please sign ORIGINAL and return it for Transportation signature.

AGENCY OF TRANSPORTATION APPROVAL: Signed copy will be returned to T/C/V Clerk.

APPROVED: _____ **DATE:** _____
 Representative, Agency of Transportation



State of Vermont

Division of Policy, Planning and Intermodal Development - Mapping Unit

1 National Life Drive

Montpelier, VT 05633-5001

<http://www.aot.state.vt.us>

Telephone: 802-828-3666

Fax: 802-828-2334

Email: gary.s.smith@state.vt.us

Agency of Transportation

February 4, 2014

Chair, Selectboard
Dorset
c/o Town Clerk
P.O. Box 715
East Dorset, VT 05253

Dear Town Clerk or Selectboard Chair:

We have received your signed 2014 Mileage Certificate and I am working to properly understand your intentions for TH-46/Kelly Road. Without the local knowledge of Dorset, I need your help to complete the changes and return your ^{certificate}. My initial understanding is that Kelly Road, a Class 3 Town Highway (#46) is to be discontinued in its entirety. The south end Kelly Road is to become a parking lot, whose ownership is transferred to private entity. Access to the parking area is from the old junction of Kelly Rd. and Route 30.

The remaining segment of Kelly Rd will be returned to grass and be under Town ownership. Two driveways that emptied on to Kelly Rd have been re-routed to join Black Rock Lane, a private road. Black Rock Lane is to be extended straight ahead to join Route 30. This new section of Black Rock Lane is approximately 116.39 feet long and crosses Town Lands following the boundary line adjustment (see the map that is part of your Mileage Certificate submission).

Our mileage figure for Kelly Road is that it is 0.23 miles long. My interpretation is that all of Kelly Road would either be returned to either grass or a private parking area. Therefore, I would need to subtract 0.23 miles from your Class 3 mileage total. You have shown that we should subtract 0.19 miles.

The extension of private road, Black Rock Ln from its current end on Kelly Road to a new intersection with Route 30 is indicated to be 116.39 feet or 0.022 miles long. Since Black Rock Ln is a private road, VTrans currently does not keep track of private roads so no entry on the 2014 Mileage Certificate is to be made.

Is my interpretation correct? If not, please offer your assistance so that we can draw the next Dorset Town Map correctly.

Sincerely,

Gary S. Smith
Mapping & GIS Specialist
VTrans Mapping

Dorset Select Board
Ph: (802) 362-4571
Fax: (802) 362-5156
townmanager@gmail.com



Town Offices
112 Mad Tom Rd
PO Box 715
East Dorset, VT 05253

PUBLIC NOTICE ROAD RE-CLASSIFICATION FINDINGS:

Description of Town Highway #46 – Kelly Road discontinued pursuant to a Certificate of Accomplishment issued by the Dorset Select Board on December 19, 2012:

Being all right, title and interest of the Town in and to those lands comprising the former Kelly Road Town Highway #46 and more particularly described as follows:

Being that portion of Kelly Road south and southwest of a line described as follows: Beginning at a 5/8-inch iron rebar set with cap "On Point" LS #45814 which point is South 22° 57' 31" East a distance of 25.00' from a 1.5 inch by 12 inch iron pipe found in a stonewall marking the northwest corner of the lands now or formerly of Bruce and Janet Waite, and thence running South 66° 53' 47" West a distance of 52.94 feet to a point and continuing south and southwest of said defined line along and encompassing Kelly Road to its intersection with Vermont Route 30.

Legal description of Town Highway #46, Kelly Road as laid out by a Certificate of Accomplishment of the Town of Dorset altering and laying out Town Highway #46, Kelly Road, dated December 19, 2012:

The centerline of Kelly Road begins at a point which is 42.20 feet South 22° 57' 31" West from a marble monument found, which marble monument marks the southwesterly corner of lands now or formerly of Pamela Marron, and said beginning point is further defined as being North 22° 57' 31" West, a distance of 33.07 feet from an iron pipe found 1.5 inches by 12 inches, which iron pipe is located in a stonewall and marks the northwest corner of the lands now or formerly of Bruce and Janet Waite and running from said beginning point South 65° 30' 43" West a distance of 116.39 feet to a point in the easterly line of Vermont Route 30 which point is defined as being North 3° 47' 07" West a distance of 58.56 feet from an 5/8-inch iron rebar set with cap "On Point" LS #45814.

The above described line marks the center line of Kelly Road as laid out by the Town of Dorset Select Board on December 19, 2012:

The above referenced description was taken from a survey captioned "Boundary Line Adjustment, Lands of Town of Dorset and 1773 Dorset Marble House, LLC" dated November 1, 2012 and prepared by On Point Land Surveying, Paul Greineder, Licensed Surveyor #45814, which map is to be recorded in the Dorset Land Records.

The Dorset Select Board

*February 11, 2013: Posted at: H.N. Williams Store, Dorset Post Office, East Dorset Post Office, Jiffy-Mart, Town website.
Published in the Bennington Banner 2/14/13.*

www.dorsetvt.org

STATE OF VERMONT
BENNINGTON COUNTY, SS:

TOWN OF DORSET
CERTIFICATE OF ACCOMPLISHMENT
OF
DISCONTINUANCE OF TOWN HIGHWAY # 46
KELLY ROAD

Notice having been given to all interested parties of a hearing on the discontinuance of Town Highway # 46 KELLY ROAD from a town highway, a copy of which notice is annexed hereto and made a part hereof, and

WHEREAS, the Selectboard did examine said highway on December 17, 2012 as set forth in said notice, and

WHEREAS, the said Selectboard did hear any party with respect to the discontinuance of this highway on December 18, 2012 as set forth in said notice, and

WHEREAS, the following persons were present at the time and location appointed for said hearing:

Chris Brooks	Pam Marron
Marge Freed	Elizabeth VanDyk
Mike Connors	Richard Pistell
Michael Oltedal	Jacqueline Pistell
Steve Jones	Brent Herrmann
Rob Gaiotti	Robert Menson
Don Hayward	Joan Menson

and,

WHEREAS, the following transpired at said hearing:

SEE ANNEXED MINUTES

and,

WHEREAS, any objections were noted by the Selectboard present in the minutes.

NOW THEREFORE:

1. Based upon the undersigned Selectboard's examination of the premises and the testimony and discussion of all interested parties at the hearing on such discontinuance, it is the Selectboard's opinion that it is in the public good, necessity and convenience of the inhabitants of the

municipality of the Town of Dorset that such highway be discontinued . A description of said highway is annexed and incorporated herein by reference.

2. It is further the opinion of the Board, based upon examination of the premises and the testimony of all parties appearing at the public hearing, that no damages need be awarded to any of the interested parties.
3. It is further ordered that notice of discontinuance to be given by registered mail to the interested parties of the Selectboard's decision to discontinue said highway.

Dated at Dorset, in the County of Bennington and State of Vermont, this 11th day of March , 2013.

Michael Connors

Received for record this 13 day of March , 2013 at 10:00 o'clock in the A M and duly recorded in Book 170 at Page(s) 245-252 of the Dorset Land Records.

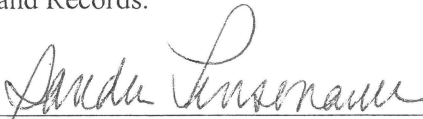
Attest: 
Sandy Pinsonnault, Town Clerk

[Description of Town Highway #46 – Kelly Road **discontinued** pursuant to a Certificate of Accomplishment issued by the Dorset Selectboard on March 11th, 2013]

Being all right, title and interest of the Town in and to those lands comprising the former Kelly Road Town Highway #46 and more particularly described as follows:

Being that portion of Kelly Road south and southwest of a line described as follows:
Beginning at a 5/8-inch iron rebar set with cap “On Point” LS #45814 which point is South 22° 57’ 31” East a distance of 25.00’ from a 1.5 inch by 12 inch iron pipe found in a stonewall marking the northwest corner of the lands now or formerly of Bruce and Janet Waite, and thence running South 66° 53’ 47” West a distance of 52.94 feet to a point and continuing south and southwest of said defined line along and encompassing Kelly Road to its intersection with Vermont Route 30.

Regular Meeting of the Dorset Select Board

December 18, 2012 ~ Minutes

Present: Chris Brooks (Chairman), Marge Freed, Mike Connors, Michael Oltedal, Steve Jones

Absent:

Also, present: R. Gaiotti (Town Manager), Don Hayward, Pam Marron, Elizabeth VanDyk, Richard Pistell, Jacqueline Pistell, Brent Herrmann, Robert Menson, Joan Menson

C. Brooks, Chairman, called the meeting to order at 7:03 p.m.

Approve Minutes of November 13, 2012

M. Oltedal moved and M. Freed seconded to approve the November 13, 2012 minutes as presented. Motion carried 5-0.

Public Hearing Road Alteration & Discontinuance: Kelly Road ~ TH #46

C. Brooks opened the Public Hearing at 7:02 p.m. and informed the audience that the Public Hearing was to listen to any comments from the audience and the SB would then make a decision or recommendations. R. Gaiotti explained the alteration and discontinuance of Kelly Road by noting that the two areas north and south of Black Rock Lane will be isolated and Black Rock Lane will continue straight out to Route 30. The northern area of approximately ¼ acre will be re-seeded and become green space owned by the Town and the southern area near the quarry will be given over to D. McDonough. There is a large ash tree which marks the stopping point for parking and this area should mitigate the current parking issues for Black Rock Lane.

D. Haywood, resident of Bolton Lane, expressed concern about the lights shining into the houses across from the altered Black Rock Lane exiting onto Route 30. He asked that the SB give consideration to landscaping which would alleviate the bright lights shining across the highway. R. Gaiotti stated that they could discuss the issue, but there are State restrictions for the right-of-way for Route 30. D. Hayward questioned why the Town did not just tow cars that violated the current parking area and R. Gaiotti replied that towing was tried, but towing vendors eventually refused to respond to calls.

M. Freed pointed out that the no parking areas on Route 30 would be extended north and south and R. Gaiotti added that it would be extended approximately ¼ mile in each direction. P. Marron questioned if it would be possible to park on the extended section of Black Rock Lane and R. Gaiotti responded that the area will be landscaped using evergreen trees on the southern edge to meet the Route 30 right-of-way. Large structures such as marble blocks will also be used to restrict parking access. J. Pistell suggested that it would be wise to have tow-away signs within the private road and also for Snow and

Bolton Lanes. Appreciation for the Select Board's efforts was voiced by J. Pistell. R. Gaiotti noted that the Beavin and Waite families were instrumental in the process as they moved their driveway to Black Rock Lane. R. Pistell also expressed his appreciation for the time and effort put into making this project happen. C. Brooks closed the Public Hearing at 7:24 p.m. M. Connors moved and M. Oltedal seconded to move forward with the alteration and discontinuance plans for Kelly Road ~ TH #46 as outlined in the Public Hearing process of December 18, 2012. Motion carried 5-0.

Public Commentown Report Preparation & Dedication

R. Gaiotti reviewed the Town Manager and the Select Board Reports for the annual Town report booklet. C. Brooks suggested placing photographs of the Emerald Lake and Dorset School playground work accomplished this year. S. Jones felt it was important that mention should be given to the many people who have contributed their efforts to keeping the Town green looking so beautiful, especially Paul who has donated and maintained the area for over 20 years. R. Gaiotti noted that a best effort is made to thank everyone and M. Freed said that it was difficult to start mentioning people by name because it would be unacceptable to forget someone.

R. Gaiotti thought it might be a good idea to solicit people's input for the Town Report dedication page. M. Freed and C. Brooks felt that this was always "under wraps" until the book was released to the public. C. Brooks noted that outside suggestions were always received, but the dedication was usually done under Executive Session. It was the consensus of the Board members to receive outside suggestions for the dedication to the Town Report, but to make the final decision in Executive Session. M. Connors moved and M. Oltedal seconded to move to Executive Session at 7:45 p.m. to discuss personnel. Motion carried 5-0. J. Menson was included in the Executive Session to discuss a Town report dedication suggestion. Executive Session ended at 8:15 p.m.

FY14 Municipal Budget Workshop (Continued)

C. Brooks asked what the timeline was for the budget and R. Gaiotti answered that a Public Hearing would need to be held on January 15th.

- Manchester Rescue Squad ~ request for an additional \$6,000 appropriation. C. Brooks noted that placing this on the ballot as an article for a floor vote gives citizens the chance to discuss the amount which can then be increased or decreased. M. Freed suggested having a representative from the Squad present to answer any questions and the SB can endorse the increase during the discussion. M. Freed moved and M. Connors seconded to place the Manchester Rescue Squad's request for an additional \$6,000 appropriation on the ballot. Motion carried 5-0.
- Grand List Preservation Project ~ C. Brooks asked if this project was absolutely necessary to do and R. Gaiotti replied that the Town Clerk would start the preservation project with the most vulnerable books first (1875-1929) which need to be done as soon as possible for a cost of \$15,000. Total estimated cost of preservation would be \$24, 895. M. Freed asked if this was in addition to the currently budgeted \$3,000 and R. Gaiotti responded yes, this was above and beyond the budgeted \$3,000. M. Oltedal asked if there was any money previously allocated to preservation as he thought this was discussed in the past and R. Gaiotti responded that it was not

done, but is now in the ledger books. M. Connors asked how many people use research these records and if the preservation could wait another year and M. Oltedal suggested spreading the preservation costs over a few years. C. Brooks commented that Mormon historians had captured the data possibly on microfiche and it may be available from them. M. Freed suggested breaking up the preservation costs into increments of \$5,000 per year for five years. M. Connors moved and S. Jones seconded to approve \$5,000 for the Town Clerk Grand List Preservation Project line item in the budget. Motion carried 5-0.

- Select Board Legal ~ It was the consensus of the Select Board to leave the line item for Select Board Legal at \$7,500.
- Planning Consultant ~ the line item for Planning Consultant is to remain at \$500.
- Outside Audit ~ the Town is still under a three-year contract with Mudgett, Jennett & Krough-Wisner which was awarded in December 2010.
- Village Speed Signs ~ R. Gaiotti noted that there was support for the speed signs from the residents of the Village and this would be another tool for speed control when the Vermont State Police were not present. S. Jones expressed that it seemed to be mostly trucks which were speeding through the Village areas. C. Brooks suggested that the Vermont State Police be instructed to issue tickets for speeders in the Village zones and M. Freed commented that she did not see the signs as a speed fix and wanted to use the Vermont State Police to the best advantage before spending money on the signs. M. Oltedal felt that it might be helpful to install the signs as it works in Stratton and this might avoid an accident. S. Jones agreed with M. Oltedal. C. Brooks recommended that a schedule be worked up for the Vermont State Police patrols in the Village areas to step up their presence and to have them issue tickets. The speed sign discussion can be re-visited in the future. S. Jones suggested that the patrol look into a large RV parked by the Dorset Inn frequently which blocks the line of sight at the corner.
- Truck Replacement ~ R. Gaiotti explained that the tandem dump/plow truck has reached the end of its useful life at 13 years. M. Connors noted that it was important to consider the emission standard regulations when trading in the truck. M. Freed asked if there was any resale value for the truck and if the amount would make a difference in the line item. R. Gaiotti responded that the anticipated cost would be \$160,000 with the trade-in.
- Dorset Library ~ R. Gaiotti informed the Board that the additional \$10,000 appropriation for the Library will be a permanent request and will be petitioned for two more years. The total appropriation will become \$20,000.
- Listers/Reappraisal & Administrative Assistant/Bookkeeper ~ will be discussed in Executive Session.

Finance Report

R. Gaiotti reported that the delinquent tax list was \$115,000 with pending payments which should bring the total down to \$65,000. The amount represents 12-18 residents. It was the consensus of the Select Board members to place an asterisk next to the names of residents who are making payments on their delinquent tax amounts. Finance discussion included: law enforcement billing, Emerald Lake bill, gravel purchases, truck tires recapped, gas and diesel increased usage, VLCT insurance payment, and

School use facility fee. R. Gaiotti informed the Board that the MEMS Youth Basketball League, which includes Dorset students, is using the Dorset School facilities and they only have portable backboards at the School which are not safe. It was suggested that safer adjustable backboards be purchased and installed at the School. C. Brooks stated that all the allocated funds from the Recreation Fund have already been given in two lump sums for the School playground. It was suggested by C. Brooks to table this discussion until January 2013 until all the bills have been received for the Emerald Lake project to make sure that another purchase would not over run the budget line item. R. Gaiotti asked about using the contingency fund and was told that the Board would not set a precedent by moving funds from one line item to another. It was the consensus of the Select Board members to support the purchase of the safer basketball backboards estimated to cost \$800 if there are funds available in the Recreation Fund after all other bills have been paid.

Manager's Report

- New entry door donated by Duane Sherman has been installed at the Town garage.
- Barlett Trees has been doing tree work around Town
- Vehicle maintenance and trucking winter sand are being done
- Sign for the trail head at Pinnacle has been installed
- Kelly Road discussion with J. O'Dea
- R. Gaiotti spoke at a Rotary Luncheon
- Monthly meeting with neighboring Town Mangers
- Town has been awarded a municipal planning grant of just under \$6,000 for a PC project for a build-out study
- S. Jones asked if R. Gaiotti has heard back from Green Mountain Power about the trees that were cut down by Transtar, LLC and R. Gaiotti replied yes, they were supposed to do a site visit of the area, but have not called back about this issue yet.

Approve Payroll and Accounts Payable for the Week of December 18, 2012

It was the consensus of the SB to approve the Payroll and Accounts Payable for the week of December 18, 2012 as presented.

Other Business

1. The equalization study has been received from the Vermont Department of Taxes and the CLA is approximately 108-109% and the COA has remained similar to the past so there is no mandatory reappraisal from the State.
2. A letter has been received from the Race Director for Tour of the Dragons race held in Dorset last year. They would like to hold the event again in May 2013 and are seeking SB approval.

M. Freed moved and M. Oltedal seconded to adjourn at 9:30 p.m. as the Select Board and convene as the Liquor Board. Motion carried 5-0.

S. Jones moved and M. Oltedal seconded to approve the liquor license for Church Street Hospitality Inc. as presented. Motion carried 5-0. C. Brooks asked R. Gaiotti to remind S. Pinsonault about an outdoor liquor consumption license for this applicant. M. Freed moved and M. Connors seconded to adjourn at 9:37 p.m. as the Liquor Board and reconvene as the Select Board. Motion carried 5-0.

M. Oltedal moved and S. Jones seconded to move to Executive Session to discuss personnel at 9:40 p.m. Motion carried 5-0. Executive Session ended at 10:45 p.m. It was the consensus of the Select Board members to raise the health insurance benefit payment for employees to 7% (seven percent).

The next Select Board meeting will be January 15th starting at 6:00 p.m.

M. Freed moved and S. Jones seconded to adjourn the meeting at 10:47 p.m. Motion carried 5-0.

Respectfully submitted,

Nancy Aversano

Town of Dorset ~ Select Board			
Date <u>12/18/12</u>			
Regular Meeting <input checked="" type="checkbox"/>			
Special Meeting <input type="checkbox"/>			
(Please Print)			
Name	Address	Representing	Testifying (Yes or No)
Dan Hayward	PO BOX 807 65 BOLTON LA	SELF	MAY BE
Paul Maron	Box 563	Self/Adcock	Maybe
John Smith/Varde	751 Park Road Town	Self/Adcock	Perhaps
Richard Pissell	PO Box 993, Dorset VT 05201	Self	No
Jacqueline Pissell	" " " "	self	Maybe
Paul Heermann	716 Mansfield Road	Self	
Paul Maron	1151 Route 30	SELF	NO
Nancy Aversano	"	"	YES

STATE OF VERMONT
BENNINGTON COUNTY, SS:

TOWN OF DORSET
CERTIFICATE OF ACCOMPLISHMENT
OF
ALTERATION AND LAYING OUT OF TOWN HIGHWAY #46
BLACK ROCK ROAD

Notice having been given to all interested parties of a hearing on the alteration and laying out of Town Highway # 46 BLACK ROCK ROAD EXTENSION, a copy of which notice is annexed hereto and made a part hereof, and

WHEREAS, the Selectboard did examine said highway on December 17, 2012 as set forth in said notice, and

WHEREAS, the said Selectboard did hear any party with respect to the alteration and laying out of this highway on December 18, 2012, the date set forth in said notice, and

WHEREAS, the following persons were present at the time and location appointed for said hearing:

Chris Brooks
Marge Freed
Mike Connors
Michael Oltedal
Steve Jones
Rob Gaiotti

Don Hayward
Pam Marron
Elizabeth VanDyk
Richard Pistell
Jacqueline Pistell
Brent Herrmann
Robert Menson
Joan Menson

and,

WHEREAS, the following transpired at said hearing:

SEE ANNEXED MINUTES

and,

WHEREAS, any objections were noted by the Selectboard present in the minutes.

NOW THEREFORE:

1. Based upon the undersigned Selectboard's examination of the premises and the testimony and discussion of all interested parties at the hearing on such alteration and laying out, it is the

Selectboard's opinion that it is in the public good, necessity and convenience of the inhabitants of the municipality of the Town of Dorset that such highway be altered and laid out and a description of said highway is annexed and incorporated herein by reference and is more particularly described on a survey captioned "Boundary Line Adjustment, Lands of Town of Dorset and 1773 Dorset Marble House, LLC" dated November 1, 2012 and prepared by On Point Land Surveying, Paul Greineder, Licensed Surveyor #45814, which map is to be recorded in the Dorset Land Records.

2. It is further the opinion of the Board, based upon examination of the premises and the testimony of all parties appearing at the public hearing, that no damages need be awarded to any of the interested parties.

3. It is further ordered that notice of the alteration and laying out be given by registered mail to the interested parties of the Selectboard's decision to alter and lay out said highway.

Dated at Dorset, in the County of Bennington and State of Vermont, this 11th day of MARCH, 2013.





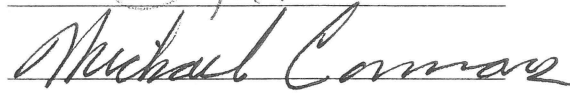

Received for record this 13 day of March, 2013 at 10:00 o'clock in the A M and duly recorded in Book 170 at Page(s) 253-260 of the Dorset Land Records.

Attest: 

Sandy Pinsonnault, Town Clerk

Legal description of Town Highway #46, Kelly Road as laid out by a Certificate of Accomplishment of the Town of Dorset altering and laying out Town Highway #46, Kelly Road, dated MARCH 11th, 2013:

The centerline of Kelly Road begins at a point which is 42.20 feet South 22° 57' 31" West from a marble monument found, which marble monument marks the southwesterly corner of lands now or formerly of Pamela Marron, and said beginning point is further defined as being North 22° 57' 31" West, a distance of 33.07 feet from an iron pipe found 1.5 inches by 12 inches, which iron pipe is located in a stonewall and marks the northwest corner of the lands now or formerly of Bruce and Janet Waite and running from said beginning point South 65° 30' 43" West a distance of 116.39 feet to a point in the easterly line of Vermont Route 30 which point is defined as being North 3° 47' 07" West a distance of 58.56 feet from an 5/8-inch iron rebar set with cap "On Point" LS #45814.

The above described line marks the center line of Kelly Road as laid out by the Town of Dorset Selectboard on MARCH 11th, 2013:

The above referenced description was taken from a survey captioned "Boundary Line Adjustment, Lands of Town of Dorset and 1773 Dorset Marble House, LLC" dated November 1, 2012 and prepared by On Point Land Surveying, Paul Greineder, Licensed Surveyor #45814, which map is to be recorded in the Dorset Land Records.

Regular Meeting of the Dorset Select Board

December 18, 2012 ~ Minutes

Present: Chris Brooks (Chairman), Marge Freed, Mike Connors, Michael Oltedal, Steve Jones

Absent:

Also, present: R. Gaiotti (Town Manager), Don Hayward, Pam Marron, Elizabeth VanDyk, Richard Pistell, Jacqueline Pistell, Brent Herrmann, Robert Menson, Joan Menson

C. Brooks, Chairman, called the meeting to order at 7:03 p.m.

Approve Minutes of November 13, 2012

M. Oltedal moved and M. Freed seconded to approve the November 13, 2012 minutes as presented. Motion carried 5-0.

Public Hearing Road Alteration & Discontinuance: Kelly Road ~ TH #46

C. Brooks opened the Public Hearing at 7:02 p.m. and informed the audience that the Public Hearing was to listen to any comments from the audience and the SB would then make a decision or recommendations. R. Gaiotti explained the alteration and discontinuance of Kelly Road by noting that the two areas north and south of Black Rock Lane will be isolated and Black Rock Lane will continue straight out to Route 30. The northern area of approximately ¼ acre will be re-seeded and become green space owned by the Town and the southern area near the quarry will be given over to D. McDonough. There is a large ash tree which marks the stopping point for parking and this area should mitigate the current parking issues for Black Rock Lane.

D. Haywood, resident of Bolton Lane, expressed concern about the lights shining into the houses across from the altered Black Rock Lane exiting onto Route 30. He asked that the SB give consideration to landscaping which would alleviate the bright lights shining across the highway. R. Gaiotti stated that they could discuss the issue, but there are State restrictions for the right-of-way for Route 30. D. Hayward questioned why the Town did not just tow cars that violated the current parking area and R. Gaiotti replied that towing was tried, but towing vendors eventually refused to respond to calls.

M. Freed pointed out that the no parking areas on Route 30 would be extended north and south and R. Gaiotti added that it would be extended approximately ¼ mile in each direction. P. Marron questioned if it would be possible to park on the extended section of Black Rock Lane and R. Gaiotti responded that the area will be landscaped using evergreen trees on the southern edge to meet the Route 30 right-of-way. Large structures such as marble blocks will also be used to restrict parking access. J. Pistell suggested that it would be wise to have tow-away signs within the private road and also for Snow and

Bolton Lanes. Appreciation for the Select Board's efforts was voiced by J. Pistell. R. Gaiotti noted that the Beavin and Waite families were instrumental in the process as they moved their driveway to Black Rock Lane. R. Pistell also expressed his appreciation for the time and effort put into making this project happen. C. Brooks closed the Public Hearing at 7:24 p.m. M. Connors moved and M. Oltedal seconded to move forward with the alteration and discontinuance plans for Kelly Road ~ TH #46 as outlined in the Public Hearing process of December 18, 2012. Motion carried 5-0.

Public Commentown Report Preparation & Dedication

R. Gaiotti reviewed the Town Manager and the Select Board Reports for the annual Town report booklet. C. Brooks suggested placing photographs of the Emerald Lake and Dorset School playground work accomplished this year. S. Jones felt it was important that mention should be given to the many people who have contributed their efforts to keeping the Town green looking so beautiful, especially Paul who has donated and maintained the area for over 20 years. R. Gaiotti noted that a best effort is made to thank everyone and M. Freed said that it was difficult to start mentioning people by name because it would be unacceptable to forget someone.

R. Gaiotti thought it might be a good idea to solicit people's input for the Town Report dedication page. M. Freed and C. Brooks felt that this was always "under wraps" until the book was released to the public. C. Brooks noted that outside suggestions were always received, but the dedication was usually done under Executive Session. It was the consensus of the Board members to receive outside suggestions for the dedication to the Town Report, but to make the final decision in Executive Session. M. Connors moved and M. Oltedal seconded to move to Executive Session at 7:45 p.m. to discuss personnel. Motion carried 5-0. J. Menson was included in the Executive Session to discuss a Town report dedication suggestion. Executive Session ended at 8:15 p.m.

FY14 Municipal Budget Workshop (Continued)

C. Brooks asked what the timeline was for the budget and R. Gaiotti answered that a Public Hearing would need to be held on January 15th.

- Manchester Rescue Squad ~ request for an additional \$6,000 appropriation. C. Brooks noted that placing this on the ballot as an article for a floor vote gives citizens the chance to discuss the amount which can then be increased or decreased. M. Freed suggested having a representative from the Squad present to answer any questions and the SB can endorse the increase during the discussion. M. Freed moved and M. Connors seconded to place the Manchester Rescue Squad's request for an additional \$6,000 appropriation on the ballot. Motion carried 5-0.
- Grand List Preservation Project ~ C. Brooks asked if this project was absolutely necessary to do and R. Gaiotti replied that the Town Clerk would start the preservation project with the most vulnerable books first (1875-1929) which need to be done as soon as possible for a cost of \$15,000. Total estimated cost of preservation would be \$24, 895. M. Freed asked if this was in addition to the currently budgeted \$3,000 and R. Gaiotti responded yes, this was above and beyond the budgeted \$3,000. M. Oltedal asked if there was any money previously allocated to preservation as he thought this was discussed in the past and R. Gaiotti responded that it was not

done, but is now in the ledger books. M. Connors asked how many people use research these records and if the preservation could wait another year and M. Oltedal suggested spreading the preservation costs over a few years. C. Brooks commented that Mormon historians had captured the data possibly on microfiche and it may be available from them. M. Freed suggested breaking up the preservation costs into increments of \$5,000 per year for five years. M. Connors moved and S. Jones seconded to approve \$5,000 for the Town Clerk Grand List Preservation Project line item in the budget. Motion carried 5-0.

- Select Board Legal ~ It was the consensus of the Select Board to leave the line item for Select Board Legal at \$7,500.
- Planning Consultant ~ the line item for Planning Consultant is to remain at \$500.
- Outside Audit ~ the Town is still under a three-year contract with Mudgett, Jennett & Krough-Wisner which was awarded in December 2010.
- Village Speed Signs ~ R. Gaiotti noted that there was support for the speed signs from the residents of the Village and this would be another tool for speed control when the Vermont State Police were not present. S. Jones expressed that it seemed to be mostly trucks which were speeding through the Village areas. C. Brooks suggested that the Vermont State Police be instructed to issue tickets for speeders in the Village zones and M. Freed commented that she did not see the signs as a speed fix and wanted to use the Vermont State Police to the best advantage before spending money on the signs. M. Oltedal felt that it might be helpful to install the signs as it works in Stratton and this might avoid an accident. S. Jones agreed with M. Oltedal. C. Brooks recommended that a schedule be worked up for the Vermont State Police patrols in the Village areas to step up their presence and to have them issue tickets. The speed sign discussion can be re-visited in the future. S. Jones suggested that the patrol look into a large RV parked by the Dorset Inn frequently which blocks the line of sight at the corner.
- Truck Replacement ~ R. Gaiotti explained that the tandem dump/plow truck has reached the end of its useful life at 13 years. M. Connors noted that it was important to consider the emission standard regulations when trading in the truck. M. Freed asked if there was any resale value for the truck and if the amount would make a difference in the line item. R. Gaiotti responded that the anticipated cost would be \$160,000 with the trade-in.
- Dorset Library ~ R. Gaiotti informed the Board that the additional \$10,000 appropriation for the Library will be a permanent request and will be petitioned for two more years. The total appropriation will become \$20,000.
- Listers/Reappraisal & Administrative Assistant/Bookkeeper ~ will be discussed in Executive Session.

Finance Report

R. Gaiotti reported that the delinquent tax list was \$115,000 with pending payments which should bring the total down to \$65,000. The amount represents 12-18 residents. It was the consensus of the Select Board members to place an asterisk next to the names of residents who are making payments on their delinquent tax amounts. Finance discussion included: law enforcement billing, Emerald Lake bill, gravel purchases, truck tires recapped, gas and diesel increased usage, VLCT insurance payment, and

School use facility fee. R. Gaiotti informed the Board that the MEMS Youth Basketball League, which includes Dorset students, is using the Dorset School facilities and they only have portable backboards at the School which are not safe. It was suggested that safer adjustable backboards be purchased and installed at the School. C. Brooks stated that all the allocated funds from the Recreation Fund have already been given in two lump sums for the School playground. It was suggested by C. Brooks to table this discussion until January 2013 until all the bills have been received for the Emerald Lake project to make sure that another purchase would not over run the budget line item. R. Gaiotti asked about using the contingency fund and was told that the Board would not set a precedent by moving funds from one line item to another. It was the consensus of the Select Board members to support the purchase of the safer basketball backboards estimated to cost \$800 if there are funds available in the Recreation Fund after all other bills have been paid.

Manager's Report

- New entry door donated by Duane Sherman has been installed at the Town garage.
- Barlett Trees has been doing tree work around Town
- Vehicle maintenance and trucking winter sand are being done
- Sign for the trail head at Pinnacle has been installed
- Kelly Road discussion with J. O'Dea
- R. Gaiotti spoke at a Rotary Luncheon
- Monthly meeting with neighboring Town Mangers
- Town has been awarded a municipal planning grant of just under \$6,000 for a PC project for a build-out study
- S. Jones asked if R. Gaiotti has heard back from Green Mountain Power about the trees that were cut down by Transtar, LLC and R. Gaiotti replied yes, they were supposed to do a site visit of the area, but have not called back about this issue yet.

Approve Payroll and Accounts Payable for the Week of December 18, 2012

It was the consensus of the SB to approve the Payroll and Accounts Payable for the week of December 18, 2012 as presented.

Other Business

1. The equalization study has been received from the Vermont Department of Taxes and the CLA is approximately 108-109% and the COA has remained similar to the past so there is no mandatory reappraisal from the State.
2. A letter has been received from the Race Director for Tour of the Dragons race held in Dorset last year. They would like to hold the event again in May 2013 and are seeking SB approval.

M. Freed moved and M. Oltedal seconded to adjourn at 9:30 p.m. as the Select Board and convene as the Liquor Board. Motion carried 5-0.

S. Jones moved and M. Oltedal seconded to approve the liquor license for Church Street Hospitality Inc. as presented. Motion carried 5-0. C. Brooks asked R. Gaiotti to remind S. Pinsonault about an outdoor liquor consumption license for this applicant. M. Freed moved and M. Connors seconded to adjourn at 9:37 p.m. as the Liquor Board and reconvene as the Select Board. Motion carried 5-0.

M. Oltedal moved and S. Jones seconded to move to Executive Session to discuss personnel at 9:40 p.m. Motion carried 5-0. Executive Session ended at 10:45 p.m. It was the consensus of the Select Board members to raise the health insurance benefit payment for employees to 7% (seven percent).

The next Select Board meeting will be January 15th starting at 6:00 p.m.

M. Freed moved and S. Jones seconded to adjourn the meeting at 10:47 p.m. Motion carried 5-0.

Respectfully submitted,

Nancy Aversano

Town of Dorset ~ Select Board

Date 12/18/12

Regular Meeting

Special Meeting

(Please Print)

Name	Address	Representing	Testifying (Yes or No)
Don Hayward	PO BOX 857 65 BOSTON LA	S/E H F	NO
Paul Marston	Box 563	Self/Deputy	Maybe
Phil Smith	751 Main St Dorset	Self/Deputy	Maybe
Robert Powell	Box 993, Dorset VT 05201	Self	No
Gregory Powell		Self	Maybe
Robert Brown		Self	
Donna		Self	
Donna			

lands prior to boundary line adjustment

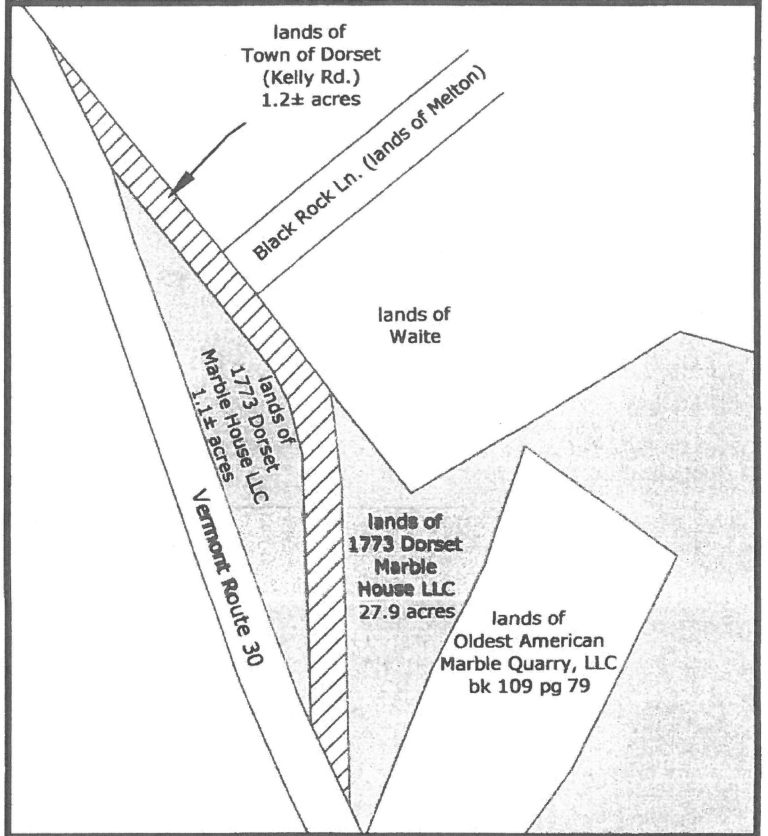

lands after boundary line adjustment

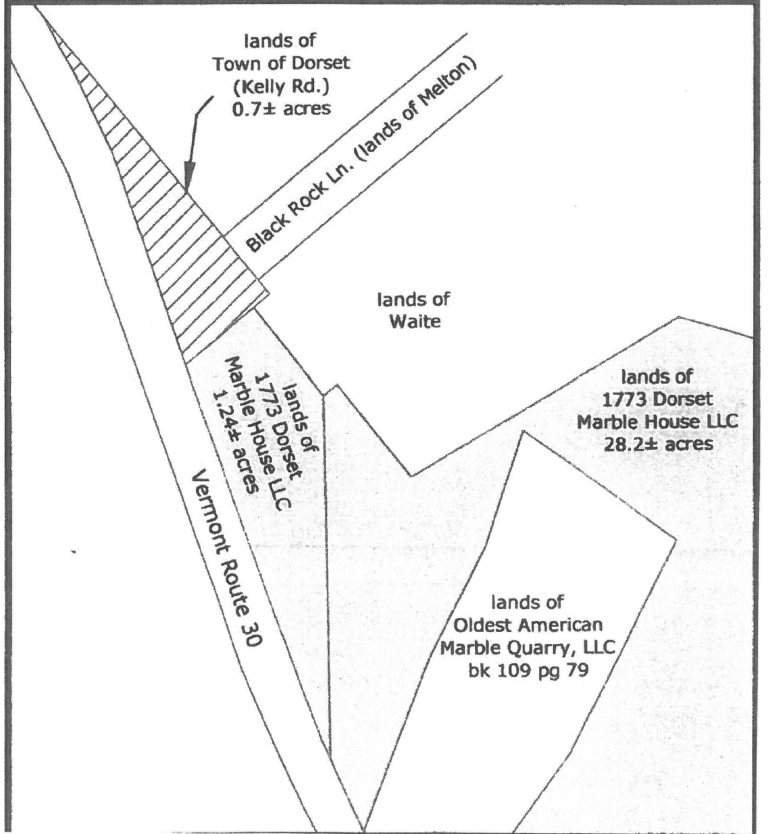

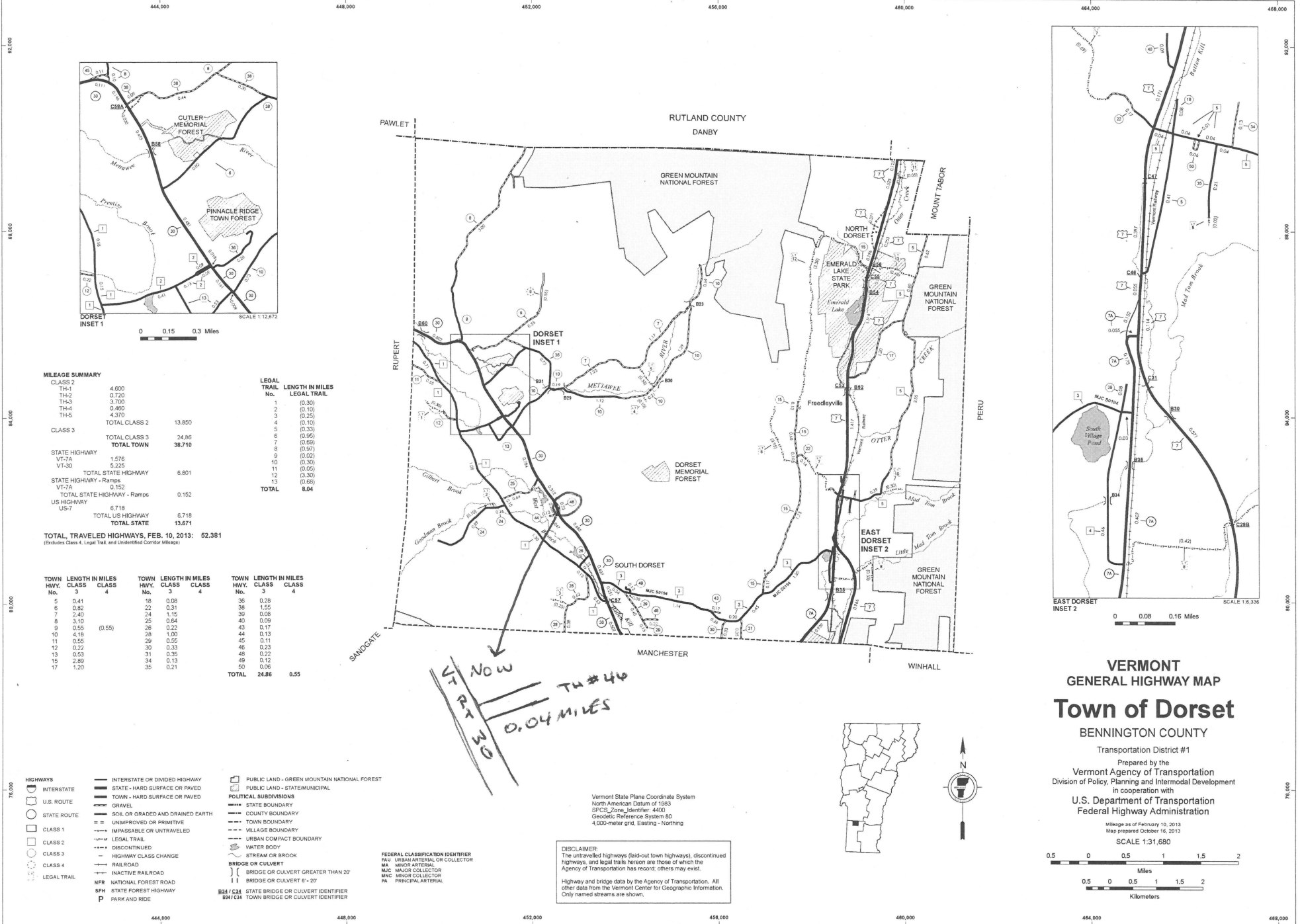

MILEAGE SUMMARY

CLASS	LENGTH IN MILES	LEGAL TRAIL No.	LENGTH IN MILES LEGAL TRAIL
CLASS 2	4.600	1	0.30
TH-2	0.720	2	0.10
TH-3	3.700	3	0.25
TH-4	0.460	4	0.10
TH-5	4.370	5	0.33
TOTAL CLASS 2	13.850	6	0.95
CLASS 3	24.86	7	0.95
TOTAL CLASS 3	24.86	8	0.97
STATE HIGHWAY	5.225	9	0.02
VT-7A	1.576	10	0.05
VT-30	3.649	11	0.05
TOTAL STATE HIGHWAY	6.801	12	0.12
STATE HIGHWAY - Ramps	0.152	13	0.65
VT-7A	0.152	14	0.65
TOTAL STATE HIGHWAY - Ramps	0.152	15	0.65
US HIGHWAY	6.718	16	0.04
US-7	6.718	17	0.04
TOTAL US HIGHWAY	6.718	18	0.04
TOTAL STATE	13.671	19	0.04
TOTAL	24.86	20	0.55

TOTAL, TRAVELED HIGHWAYS, FEB. 10, 2013: 52,381
 (Excludes Class 4, Legal Trail, and Undersized Corridor Mileage)

TOWN HWY. No.	LENGTH IN MILES CLASS 3	TOWN HWY. No.	LENGTH IN MILES CLASS 4	TOWN HWY. No.	LENGTH IN MILES CLASS 4
5	0.41	18	0.09	36	0.28
6	0.82	22	0.31	38	1.55
7	2.40	24	1.15	39	0.05
8	3.10	25	0.64	40	0.09
9	0.55 (0.55)	26	0.22	43	0.17
10	4.18	28	1.00	44	0.13
11	0.55	29	0.55	45	0.11
12	0.22	30	0.33	46	0.23
13	0.53	31	1.00	48	0.22
15	2.89	34	0.13	49	0.12
17	1.20	35	0.21	50	0.06
				TOTAL	24.86 0.55

← RT Now
 TH # 40
 0.04 MILES

DISCLAIMER:
 The untraveled highways (laid-out town highways), discontinued highways, and legal trails herein are those of which the Agency of Transportation has record; others may exist.
 Highway and bridge data by the Agency of Transportation. All other data from the Vermont Center for Geographic Information. Only named streams are shown.

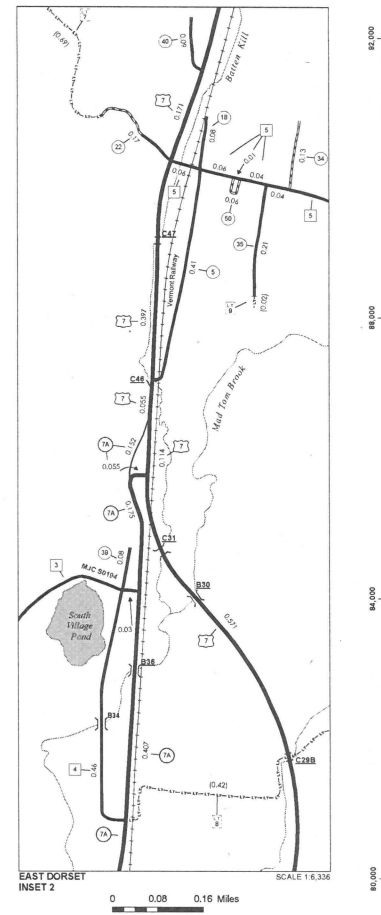

VERMONT GENERAL HIGHWAY MAP

Town of Dorset

BENNINGTON COUNTY
 Transportation District #1

Prepared by the
 Vermont Agency of Transportation
 Division of Policy, Planning and Intermodal Development
 in cooperation with
 U.S. Department of Transportation
 Federal Highway Administration

Mileage as of February 10, 2013
 Map prepared October 16, 2013
 SCALE 1:31,680

0.5 0 0.5 1 1.5 2
 Miles
 0.5 0 0.5 1 1.5 2
 Kilometers

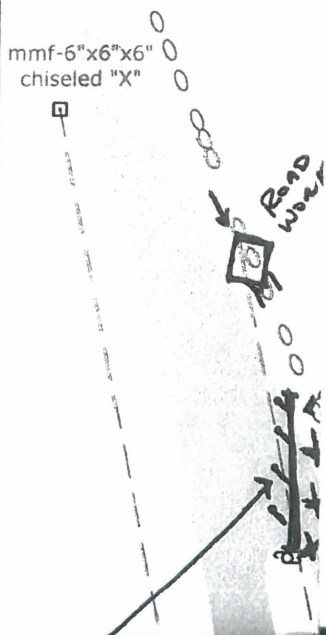
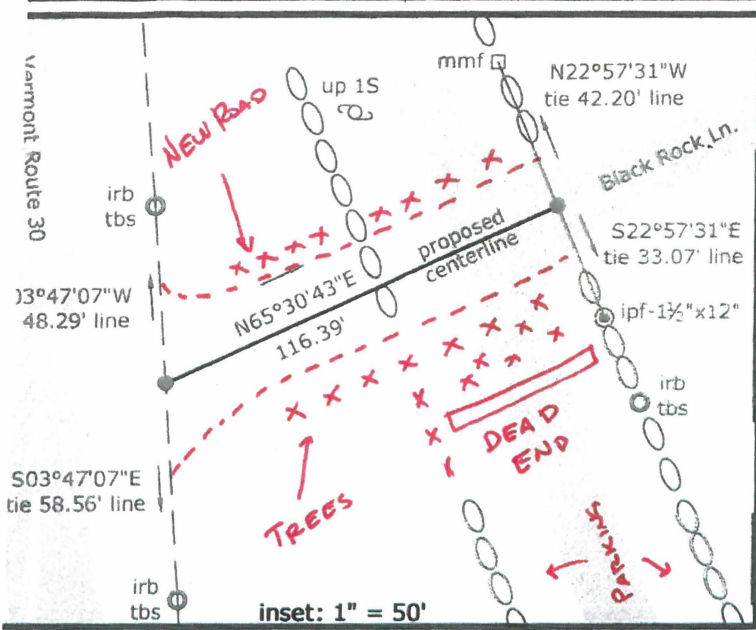
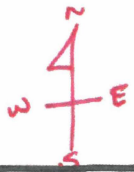

The Yankee Chef

What is a Whitpot?



I have a recipe written by my grandmother, four times removed, for Apple Whitpot. Although I have followed her recipe and loved it, I created my own adaptation which I think you will enjoy immensely, especially with the Holidays coming right up. Apparently my ancestor meant to write whitpot, missing the 'e'. This rice dish, or rather was, so-named because it was a recipe that was pure white, even when cooked in a pot, thus the name. She mentions that it was eaten while hot, with stewed wild strawberries and blackberries. In England, it is still eaten with fruit preserves mixed in for breakfast.

We here in New England, have been relishing this Holiday dessert for generations so I have "Yankee" my version of this deliciously decadent dish with candied ginger, which you can find in

any supermarket. If you are unable to find them, simply use any dried fruit or berry, such as dried cranberries.

Caramelized Apple Ginger Rice Pudding
Most rice puddings are made by slowly simmering starchy white rice in milk, sometimes on the stovetop, sometimes in the oven. But I decided to use a technique more common to risotto. The milk is added more slowly to the rice and cooked into it before more is added. Frequent stirring during this process also helps draw out more of the rice's starch, creating a thicker, creamier pudding.

- 1/2 c. brown sugar, divided
- 3 apples, peeled, cored and diced
- 1 t. cinnamon
- 1 c. arborio or short-grained rice
- 1/4 t. salt
- 1/2 c. granulated sugar
- 1/2 c. diced candied ginger
- 4 c. milk, divided

In a medium saucepan over medium-high, add 1/4 c. brown sugar and cook until melted, about 1 minute. Add the butter, apples and cinnamon. Saute until browned and caramelized, about 4-6 minutes. Add the rice and stir to coat. Add the salt, granulated sugar, ginger and 1 cup of the milk. Lower the heat to medium and cook, stirring frequently, until almost all of the milk has been absorbed. Add another cup of milk and repeat with the stirring and cooking until almost entirely absorbed. Repeat with the remaining milk, 1 cup at a time, or until the rice is cooked through and the mixture is creamy. Serve warm with remainder 1/4 c. brown sugar dabbed over the top, whipped cream or ice cream, I like mine just as it comes off the stove.

Here is Granny Charlotte Baileys recipe for Rice Pudding:
"To make Whitpot, start with a slow fire and boil 2 1/2 cups rice, use less tboh for the price is high.

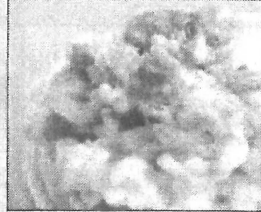

Caramelized Apple Ginger Rice Pudding

Add twice as much rich cream and the same amount in cider. When done boiling and tis thick, stir in stewed berries from out back."

Dorset Select Board
Ph: (802) 362-4571
Fax: (802) 362-5156
townmanager@gmail.com



Town Offices
112 Mad Tom Rd
PO Box 715
East Dorset, VT 05253

PUBLIC NOTICE RECLASSIFY CLASS 3 HIGHWAYS

Pursuant to the laws of the State of Vermont, all abutting landowners, persons interested in abutting lands and other persons who desire to be heard with respect to the ALTERATION OF THE CLASSIFICATION, of the sections of highway, situated in the Town of Dorset, Vermont described as follows:

- 1. Town Highway 446: (0.33 mi.) (Keller Road) Beginning at the intersection of Vermont Route 30 in Dorset, continuing in a northerly direction approximately 1.214 feet (0.23 mi.), to the northern intersection with Vermont Route 30. Adjacent property owners as of this date are: Dorset Marble House 1772, LLC, The Oldest American Marble Quarry, LLC, Bruce & Janet Waite, Pamela Marra, Black Rock Lane (subdivision of private homes).

You are hereby notified that the Dorset Select Board will examine said sections of said highway on Monday, December 17, 2012 beginning at 3:30 p.m., until the Select Board is satisfied with the examination of all highway described.

You are further notified that a public hearing will be held on Tuesday, December 18, 2012 beginning at 7:00 p.m., at the Dorset Town Offices in East Dorset to hear all parties with respect to the alteration of the classification of said highway and with respect to claims for damages from such alteration of the classification. All interested persons, including all abutting property owners or their representatives will be welcome.

All persons also are notified that a decision of the Select Board, with respect to the matter hereinbefore set forth, will thereafter be assented according to law.

Respectfully Submitted,
Rob Galois
Town Manager

Published in the Burlington Banner Nov. 8, 2012 & Manchester Journal Nov. 9, 2012.
Position: 16 W. Main St., Dorset Post Office, East Dorset Post Office, and East Dorset General Store.
Notice is given to abutting property owners.

www.dorsetvt.org

Are your teens getting enough iron?

You may not realize that teens, especially teenage girls, are at increased risk of iron deficiency. The

teenage years are a time of dynamic growth, with most teens gaining 20 percent of their adult height

and 50 percent of their adult weight. The rapid growth spurt increases the risk of developing iron deficiency anemia for both boys and girls. Girls, however, are at even higher risk due to menstruation.

Iron is an essential mineral that is part of every cell of our body. Iron in hemoglobin carries oxygen from our lungs throughout our body, and also helps muscles store and use oxygen for everyday activities as well as sports and exercise. Iron plays a role in memory, ability to concentrate, and energy levels.

According to the National Heart, Lung and Blood Institute, iron deficiency usually develops over time if you don't consume enough iron to build healthy red blood cells. Without enough iron, your body starts using the iron it has stored. After the stored iron is gone, your body makes fewer red blood cells and those red blood cells contain less hemoglobin than normal.

Iron deficiency can cause: tiredness, shortness of breath, infections, impaired growth and development in children, and difficulty concentrating. Teenage boys need 8-11 mg of iron each day; teenage

girls need 15-18 mg. Iron from animal products such as beef, dark meat chicken, sardines, clams and oysters is better absorbed than iron from plant foods such as spinach (sorry, Popeye!) and legumes (lentils, chickpeas, kidney beans). Vitamin C helps improve the absorption of iron from food. Include oranges, cantaloupe, strawberries, Brussels sprouts, red or green bell peppers, or broccoli with meals that contain iron to boost iron absorption.

Include these tips in your weekly meal planning, and your teens will benefit from increased iron:

- Increase the amount of iron in acidic foods such as tomato sauce by cooking in a cast iron skillet.
- Drink orange or grapefruit juice or add strawberries to fortified breakfast cereals to increase iron absorption.
- Choose lean cuts of red meat for good amounts of iron without excess fat.
- Tea and coffee decrease the absorption of iron. Avoid drinking these beverages when eating a meal high in iron such as fortified cereal like Total or Raisin Bran for breakfast.

LEGAL NOTICE

Pursuant to 24 VSA §4441, the Manchester Planning Commission will hold a public hearing on Monday November 19, 2012 at 7:30 PM. in the Manchester Town Hall to consider the following amendments to the Zoning Ordinance.

PURPOSES: The purpose of these amendments is to update the Zoning Ordinance to better implement the goals and policies of the Town Plan, to better satisfy current and future land use and economic development needs and opportunities, and to better ensure compatibility of land uses within the affected zoning districts.

GEOGRAPHIC AREAS AFFECTED:
The entire Town of Manchester.

Section 1, Definitions: new definition of Customary Home Occupation, how these may be permitted, and under what conditions or criteria.

Section 1, Definitions: new definition of Temporary Structures, and how these may be permitted.

Section 9.1.2. Permits: change permit lifespan from two to three years, and clarify how permit extensions will be handled. The full text may be examined during regular business hours in the Manchester Planning & Zoning Office, or on the Town's website in the Planning Commission agenda section at www.manchester-vt.gov. It is also available upon request of the Planning & Zoning Office at 802.362.1313 x3, or by email at l.krohn@manchester-vt.gov.

BIG BOY'S TOYS

Car & Truck Accessories

You Need Snow Tires NOW!

PASSENGER TIRES
Mastercraft Glacier Grip II
Arctic Claw
Cooper M&S
Firestone Winter Force

LIGHT DUTY TRUCK TIRES
Mastercraft,
MSR Courser CT

Largest selection of OEM replacement winter tire and wheel packages in the area

Authorized SnowDogg Snowplow Dealer

Visit us at BBToys.com
Route 67A, North Bennington, VT
802-447-1721 • 1-800-286-1721
Owner, Richard Boutin Fax: 802-447-8999
Mon-Fri. 8 am - 5 pm, Sat. 8 am - 2 pm

Don't Let Snow Slow You Down

TORO

www.toro.com

Heavy Duty

Power Max Starting at \$899.99

- Chute, deflector and anti-clogging system are made of a durable, rust-free sub zero material.
- Commercial-grade construction for long life.
- Ideal for large areas/heavy snowfalls
- Powerful Engines

Reliable Performance

Power Clear 418 Starting at \$399.99

- Clears snow down to pavement
- Conserves valuable storage space
- Easy for anyone to use
- Ideal for light/medium snowfall

These heavy duty machines are snow-tested in Vermont, and feature a patented anti-clogging system, easy chute control, and are made with a unique sub-zero material durable to -104° F. We offer pick-up and delivery options, knowledgeable service and a well-stocked parts department. Come see us today!

MANCHESTER POWER HOUSE
67 TACONIC BUSINESS PARK
MANCHESTER CENTER, VT
1 802-362-0230

MANCHESTER POWER HOUSE

See dealer or toro.com (toro.ca for Canadian residents) for warranty details. Product availability, pricing & special promotions are subject to dealer options.

7012 2210 0001 5698 5117

U.S. Postal Service™
CERTIFIED MAIL™ RECEIPT
(Domestic Mail Only; No Insurance Coverage Provided)

For delivery information visit our website at www.usps.com®

OFFICIAL USE

Postage	\$.45
Certified Fee	2.95
Return Receipt Fee (Endorsement Required)	2.35
Restricted Delivery Fee (Endorsement Required)	
Total Postage & Fees	\$ 5.75

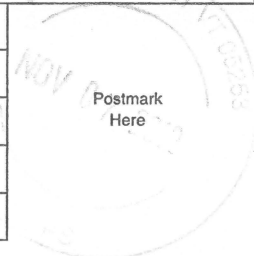

Sent To TIM & MARY BAKER
 Street, Apt. No.;
 or PO Box No. 69 SNOW ROAD
 City, State, ZIP+4 DORSET VT 05251

PS Form 3800, August 2006 See Reverse for Instructions

7012 2210 0001 5698 5117

U.S. Postal Service™
CERTIFIED MAIL™ RECEIPT
(Domestic Mail Only; No Insurance Coverage Provided)

For delivery information visit our website at www.usps.com®

OFFICIAL USE

Postage	\$.45
Certified Fee	2.95
Return Receipt Fee (Endorsement Required)	2.35
Restricted Delivery Fee (Endorsement Required)	
Total Postage & Fees	\$ 5.75

Sent To JOHN & CAROL PATTER
 Street, Apt. No.;
 or PO Box No. PO BOX 403
 City, State, ZIP+4 DORSET VT 05251

PS Form 3800, August 2006 See Reverse for Instructions

7012 2210 0001 5698 5063

U.S. Postal Service™
CERTIFIED MAIL™ RECEIPT
(Domestic Mail Only; No Insurance Coverage Provided)

For delivery information visit our website at www.usps.com®

OFFICIAL USE

Postage	\$.45
Certified Fee	2.95
Return Receipt Fee (Endorsement Required)	2.35
Restricted Delivery Fee (Endorsement Required)	
Total Postage & Fees	\$ 5.75

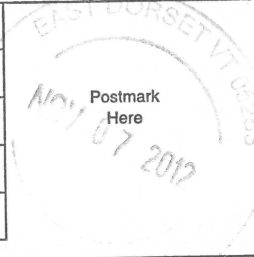

Sent To KERRY COMOLLO
 Street, Apt. No.;
 or PO Box No. 111 OWL'S HEAD HILL LN
 City, State, ZIP+4 DORSET VT 05251

PS Form 3800, August 2006 See Reverse for Instructions

7012 2210 0001 5698 5223

U.S. Postal Service™
CERTIFIED MAIL™ RECEIPT
(Domestic Mail Only; No Insurance Coverage Provided)

For delivery information visit our website at www.usps.com®

OFFICIAL USE

Postage	\$.45
Certified Fee	2.95
Return Receipt Fee (Endorsement Required)	2.35
Restricted Delivery Fee (Endorsement Required)	
Total Postage & Fees	\$ 5.75

Sent To DONALD HAYWARD
 Street, Apt. No.;
 or PO Box No. PO BOX 897
 City, State, ZIP+4 DORSET VT 05251

PS Form 3800, August 2006 See Reverse for Instructions

7012 2210 0001 5698 5353

U.S. Postal Service™
CERTIFIED MAIL™ RECEIPT
(Domestic Mail Only; No Insurance Coverage Provided)

For delivery information visit our website at www.usps.com®

OFFICIAL USE

Postage	\$.45
Certified Fee	2.95
Return Receipt Fee (Endorsement Required)	2.35
Restricted Delivery Fee (Endorsement Required)	
Total Postage & Fees	\$ 5.75



Sent To PAMELA TUTTLE TRUSTEE
 Street, Apt. No.;
 or PO Box No. 1745 N ORCHARD ISLAND CIRCLE
 City, State, ZIP+4 VEEO BEACH FL 32963

PS Form 3800, August 2006 See Reverse for Instructions

7012 2210 0001 5698 5124

U.S. Postal Service™
CERTIFIED MAIL™ RECEIPT
(Domestic Mail Only; No Insurance Coverage Provided)

For delivery information visit our website at www.usps.com®

OFFICIAL USE

Postage	\$.45
Certified Fee	2.95
Return Receipt Fee (Endorsement Required)	2.35
Restricted Delivery Fee (Endorsement Required)	
Total Postage & Fees	\$ 5.75

Sent To RUTH CLOUGH
 Street, Apt. No.;
 or PO Box No. 1837 ROUTE 30
 City, State, ZIP+4 DORSET VT 05251

PS Form 3800, August 2006 See Reverse for Instructions

PT
ge Provided)
v.usps.com®
USE
Postmark
Here
25-1
Reverse for Instructions

7012 2210 0001 5698 5230

U.S. Postal Service™
CERTIFIED MAIL™ RECEIPT
(Domestic Mail Only; No Insurance Coverage Provided)
For delivery information visit our website at www.usps.com®
OFFICIAL USE

Postage	\$.45	Postmark Here
Certified Fee	2.95	
Return Receipt Fee (Endorsement Required)	2.35	
Restricted Delivery Fee (Endorsement Required)		
Total Postage & Fees	\$ 5.75	

Sent To *H & H Humes c/o Bevan-Herndon*
Street, Apt. No.;
or PO Box No. *PO Box 604*
City, State, ZIP+4 *Winchester VT 05255*

PS Form 3800, August 2006 See Reverse for Instructions

PT
ge Provided)
v.usps.com®
USE
Postmark
Here
25-1
Reverse for Instructions

7012 2210 0001 5698 5216

U.S. Postal Service™
CERTIFIED MAIL™ RECEIPT
(Domestic Mail Only; No Insurance Coverage Provided)
For delivery information visit our website at www.usps.com®
OFFICIAL USE

Postage	\$.45	Postmark Here
Certified Fee	2.95	
Return Receipt Fee (Endorsement Required)	2.35	
Restricted Delivery Fee (Endorsement Required)		
Total Postage & Fees	\$ 5.75	

Sent To *BRUN & CONNOR BEVAN*
Street, Apt. No.;
or PO Box No. *88 Snow Rd*
City, State, ZIP+4 *Dorset VT 05251*

PS Form 3800, August 2006 See Reverse for Instructions

PT
ge Provided)
v.usps.com®
USE
Postmark
Here
25-1
Reverse for Instructions

7012 2210 0001 5698 5131

U.S. Postal Service™
CERTIFIED MAIL™ RECEIPT
(Domestic Mail Only; No Insurance Coverage Provided)
For delivery information visit our website at www.usps.com®
OFFICIAL USE

Postage	\$.45	Postmark Here
Certified Fee	2.95	
Return Receipt Fee (Endorsement Required)	2.35	
Restricted Delivery Fee (Endorsement Required)		
Total Postage & Fees	\$ 5.75	

Sent To *PETER & VICKIE HASKINS*
Street, Apt. No.;
or PO Box No. *1791 Route 30*
City, State, ZIP+4 *Dorset VT 05251*

PS Form 3800, August 2006 See Reverse for Instructions

U.S. Postal Service™
CERTIFIED MAIL™ RECEIPT
(Domestic Mail Only; No Insurance Coverage Provided)
For delivery information visit our website at www.usps.com®
OFFICIAL USE

Postage	\$ 1.10	Postmark Here
Certified Fee	2.95	
Return Receipt Fee (Endorsement Required)	2.35	
Restricted Delivery Fee (Endorsement Required)		
Total Postage & Fees	\$ 6.40	

Sent To *McDonough*
Street, Apt. No.;
or PO Box No. *31 SEARCHER DR.*
City, State, ZIP+4 *SAVANNAH, GA 31411*

PS Form 3800, August 2006 See Reverse for Instruction

U.S. Postal Service™
CERTIFIED MAIL™ RECEIPT
(Domestic Mail Only; No Insurance Coverage Provided)
For delivery information visit our website at www.usps.com®
OFFICIAL USE

Postage	\$.45	Postmark Here
Certified Fee	2.95	
Return Receipt Fee (Endorsement Required)	2.35	
Restricted Delivery Fee (Endorsement Required)		
Total Postage & Fees	\$ 5.75	

Sent To *BRUCE & JANE WHITE*
Street, Apt. No.;
or PO Box No. *88 Snow Rd*
City, State, ZIP+4 *Dorset VT 05251*

PS Form 3800, August 2006 See Reverse for Instruction

U.S. Postal Service™
CERTIFIED MAIL™ RECEIPT
(Domestic Mail Only; No Insurance Coverage Provided)
For delivery information visit our website at www.usps.com®
OFFICIAL USE

Postage	\$.45	Postmark Here
Certified Fee	2.95	
Return Receipt Fee (Endorsement Required)	2.35	
Restricted Delivery Fee (Endorsement Required)		
Total Postage & Fees	\$ 5.75	

Sent To *DAVID & RONNIE RHM*
Street, Apt. No.;
or PO Box No. *PO Box 326*
City, State, ZIP+4 *Dorset VT 05251*

PS Form 3800, August 2006 See Reverse for Instruction

Kelly Rd in Dorset



Kelly Rd in Dorset

