

CERTIFICATE OF HIGHWAY MILEAGE
YEAR ENDING FEBRUARY 10, 2016

Fill out form, make and file copy with the Town Clerk, and mail ORIGINAL, before February 20, 2016 to: Vermont Agency of Transportation, Division of Policy, Planning and Intermodal Development, Mapping Section One National Life Drive, Montpelier, VT 05633.

We, the members of the legislative body of BENNINGTON in BENNINGTON County on an oath state that the mileage of highways, according to Vermont Statutes Annotated, Title 19, Section 305, added 1985, is as follows:

PART I - CHANGES TOTALS - Please fill in and calculate totals.

Table with 6 columns: Town Highways, Previous Mileage, Added Mileage, Subtracted Mileage, Total, Scenic Highways. Rows include Class 1, Class 2, Class 3, State Highway, Total, Class 1 Lane, Class 4, and Legal Trail.

\* Mileage for Class 1 Lane, Class 4, and Legal Trail classifications are NOT included in total.

PART II - INFORMATION AND DESCRIPTION OF CHANGES SHOWN ABOVE. Adjustments by

- 1. NEW HIGHWAYS: Please attach Selectmen's "Certificate of Completion and Opening". See attached. S. Moulton 2/9/2016
2. DISCONTINUED: Please attach SIGNED copy of proceedings (minutes of meeting).
3. RECLASSIFIED/REMEASURED: Please attach SIGNED copy of proceedings (minutes of meeting).
4. SCENIC HIGHWAYS: Please attach a copy of order designating/discontinuing Scenic Highways.

IF THERE ARE NO CHANGES IN MILEAGE: Check box and sign below. [ ]

PART III - SIGNATURES - PLEASE SIGN.

Selectmen/ Aldermen/ Trustees Signatures:

Handwritten signatures in blue ink.

T/C/V Clerk Signature:

Handwritten signature: Candace Bunker

Date Filed:

1.12.16

Please sign ORIGINAL and return it for Transportation signature.

AGENCY OF TRANSPORTATION APPROVAL:

Signed copy will be returned to T/C/V Clerk.

APPROVED:

Representative, Agency of Transportation

DATE:

5/12/2016



**Received**

**JAN 13 2016**

Policy, Planning & Intermodal  
Development Division

**Vermont Statutes Annotated**

**19 V.S.A. § 305. Measurement and inspection**

**§ 305. Measurement and inspection**

(a) After reasonable notice to the selectboard, a representative of the agency may measure and inspect the class 1, 2, and 3 town highways in each town to verify the accuracy of the records on file with the agency. Upon request, the selectboard or their designee shall be permitted to accompany the representative of the agency during the measurement and inspection. The agency shall notify the town when any highway, or portion of a highway, does not meet the standards for its assigned class. If the town fails, within one year, to restore the highway or portion of the highway to the accepted standard, or to reclassify, or to discontinue, or develop an acceptable schedule for restoring to the accepted standards, the agency for purposes of apportionment under section 306 of this title shall deduct the affected mileage from that assigned to the town for the particular class of the road in question.

(b) Annually, on or before February 10, the selectboard shall file with the town clerk a sworn statement of the description and measurements of all class 1, 2, 3, and 4 town highways and trails then in existence, including any special designation such as a throughway or scenic highway. When class 1, 2, 3, or 4 town highways, trails, or unidentified corridors are accepted, discontinued, or reclassified, a copy of the proceedings shall be filed in the town clerk's office and a copy shall be forwarded to the agency.

(c) All class 1, 2, 3, and 4 town highways and trails shall appear on the town highway maps by July 1, 2015.

(d) At least 45 days prior to first including a town highway or trail that is not clearly observable by physical evidence of its use as a highway or trail and that is legally established prior to February 10, 2006 in the sworn statement required under subsection (b) of this section, the legislative body of the municipality shall provide written notice and an opportunity to be heard at a duly warned meeting of the legislative body to persons owning lands through which a highway or trail passes or abuts.

(e) The agency shall not accept any change in mileage until the records required to be filed in the town clerk's office by this section are received by the agency. A request by a municipality to the agency for a change in mileage shall include a description of the affected highway or trail, a copy of any surveys of the affected highway or trail, minutes of meetings at which the legislative body took action with respect to the changes, and a current town highway map with the requested deletions and additions sketched on it. A survey shall not be required for class 4 town highways that are legally established prior to February 10, 2006. All records filed with the agency are subject to verification in accordance with subsection (a) of this section.

(f) The selectboard of any town who are aggrieved by a finding of the agency concerning the measurement, description, or classification of a town highway may appeal to the transportation board by filing a notice of appeal with the executive secretary of the transportation board.

(g) The agency shall provide each town with a map of all of the highways in that town together with the mileage of each class 1, 2, 3, and 4 highway, as well as each trail, and such other information as the agency deems appropriate

Excerpt of 19 V.S.A. § 305 - *Measurement and inspection* from Vermont Statutes Online located at –  
<http://legislature.vermont.gov/statutes/section/19/003/00305>

December 2015

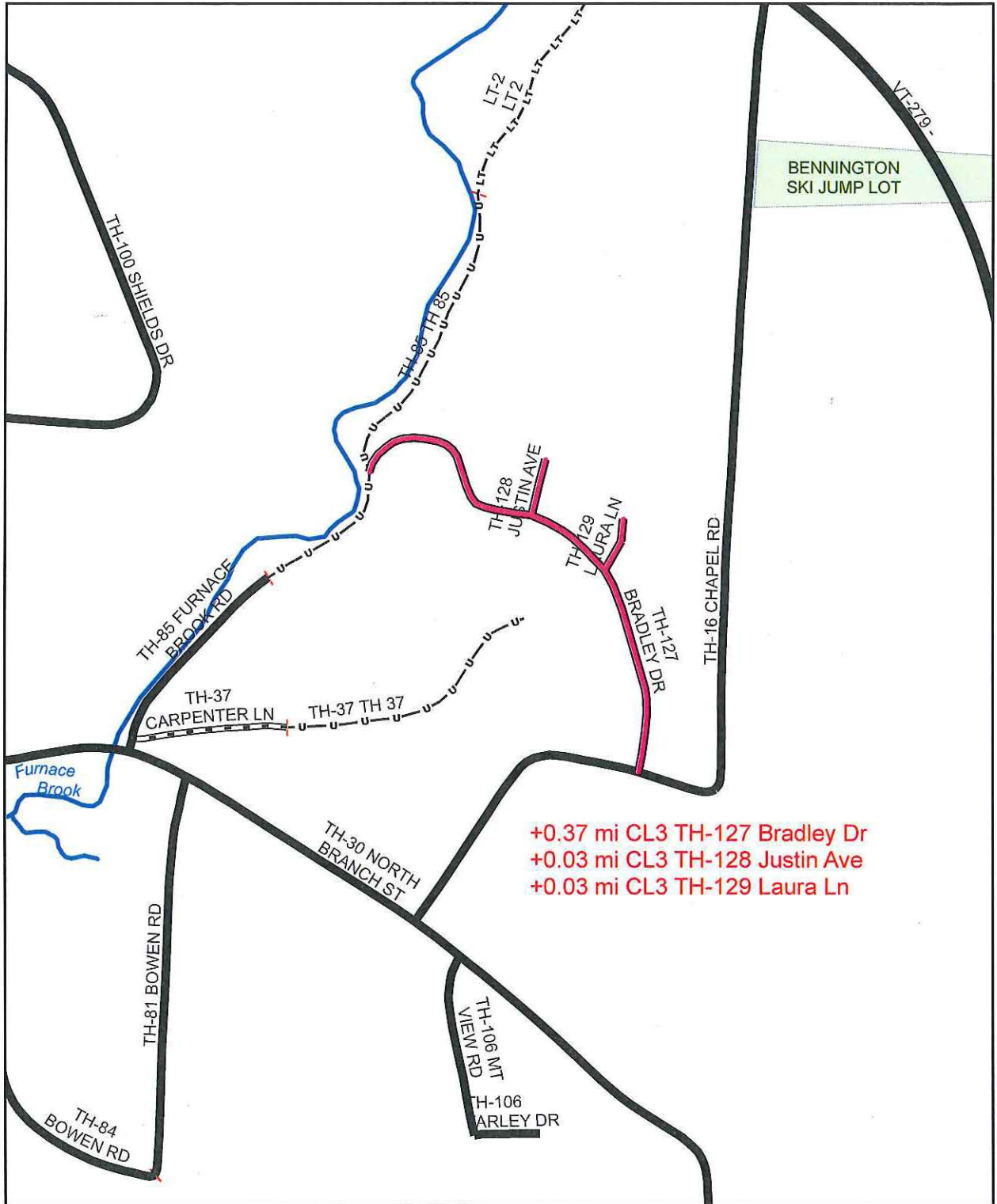

+0.37 mi CL3 TH-127 Bradley Dr  
 +0.03 mi CL3 TH-128 Justin Ave  
 +0.03 mi CL3 TH-129 Laura Ln

### Mileage Certificate Change BENNINGTON

(CTCODE: 0202)

Mapping Section  
 Division of Policy, Planning and Intermodal Development  
 Vermont Agency of Transportation - February 2016

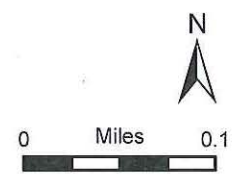



**ORDER FOR LAYING OUT AND ACCEPTANCE OF HIGHWAYS IN COUNTRY TERRACE  
DEVELOPMENT BY THE TOWN OF BENNINGTON**

**THE SELECT BOARD OF THE TOWN OF BENNINGTON, VERMONT,**

having given thirty (30) days' notice of hearing regarding its intent to the laying out and acceptance of the following three highway rights-of-way in the Country Terrace Development:

a highway right-of-way 1927.50 feet in length and 50 feet in width known as Bradley Drive leading from Chapel Road to and through Country Terrace Development;

TH-127  
0.37 mi.

a highway right-of-way 170.06 feet in length and 50 feet wide known as Justin Avenue consisting of a cul-du-sac situate in the Country Terrace Development; and

0.03 mi  
TH-128

a highway right-of-way 161.60 feet in length and 50 feet wide known as Laura Lane consisting of a cul-du-sac situate in the Country Terrace Development,

0.03 mi.  
TH-129

and being more particularly described in Schedule A attached hereto and incorporated herein by reference, to all persons owning or interested in the land abutting the same; having given notice to the Bennington Planning Commission; and having posted a copy of that notice in the Bennington Town clerk's Office at least thirty (30) days prior to the date set for hearing, and having published said notice in the Bennington Banner, a newspaper having a general circulation in the area, at least ten (10) days prior to the date set for hearing, all as required by law,

**HEREBY ORDERS** the laying out and acceptance of Bradley Drive, Justin Avenue and Laura Lane in the Country Terrace Development for use as public highways.

Dated at Bennington, Vermont, November 23, 2015.

**SELECT BOARD  
TOWN OF BENNINGTON, VERMONT**

  
\_\_\_\_\_  
Thomas H. Jacobs, Chair

  
\_\_\_\_\_  
John McFadden, Vice Chair

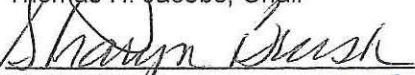
  
\_\_\_\_\_  
Sharyn Brush

  
\_\_\_\_\_  
Justin Corcoran

  
\_\_\_\_\_  
Donald Campbell

  
\_\_\_\_\_  
Michael Keane

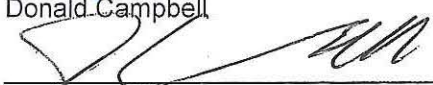
  
\_\_\_\_\_  
James Carroll