

**CERTIFICATE OF HIGHWAY MILEAGE
YEAR ENDING FEBRUARY 10, 2012**

Fill out form, make and file copy with the Town Clerk, and mail ORIGINAL, before February 20, 2012 to:
Vermont Agency of Transportation, Division of Policy, Planning and Intermodal Development,
One National Life Drive, Montpelier, VT 05633.

We, the members of the legislative body of MIDDLEBURY in ADDISON County
on an oath state that the mileage of highways, according to Vermont Statutes Annotated, Title 19, Section 305,
added 1985, is as follows:

PART I - CHANGES TOTALS - Please fill in and calculate totals.

Town Highways	Previous Mileage	Added Mileage	Subtracted Mileage	Total	Scenic Highways
Class 1	3.889			3.889	0.000
Class 2	15.720			15.720	0.000
Class 3	46.10		0.03	46.07	0.000
State Highway	16.768			16.768	1.386
Total	82.477			82.447	1.386
* Class 1 Lane	0.510			0.510	0.000
* Class 4	2.83	0.03		2.86	
* Legal Trail	0.65			0.65	
* Unidentified Corridor	0.00				

* Mileage for Class 1 Lane, Class 4, Legal Trail, and Unidentified Corridor classifications are NOT included in total.

PART II - INFORMATION AND DESCRIPTION OF CHANGES SHOWN ABOVE. Adjustments by

- NEW HIGHWAYS:** Please attach Selectmen's "Certificate of Completion and Opening". S. Moulton 4/10/2012
- DISCONTINUED:** Please attach SIGNED copy of proceedings (minutes of meeting).
- RECLASSIFIED/REMEASURED:** Please attach SIGNED copy of proceedings (minutes of meeting).
- SCENIC HIGHWAYS:** Please attach a copy of order designating/discontinuing Scenic Highways.

IF THERE ARE NO CHANGES IN MILEAGE: Check box and sign below.

PART III - SIGNATURES - PLEASE SIGN.

Selectmen/ Aldermen/ Trustees Signatures:

William H. Poirier
Town Manager

T/C/V Clerk Signature:

[Signature]

Date Filed:

2-21-2012

Please sign ORIGINAL and return it for Transportation signature.

AGENCY OF TRANSPORTATION APPROVAL: Signed copy will be returned to T/C/V Clerk.

APPROVED:

[Signature]
Representative, Agency of Transportation

DATE:

6/25/2012

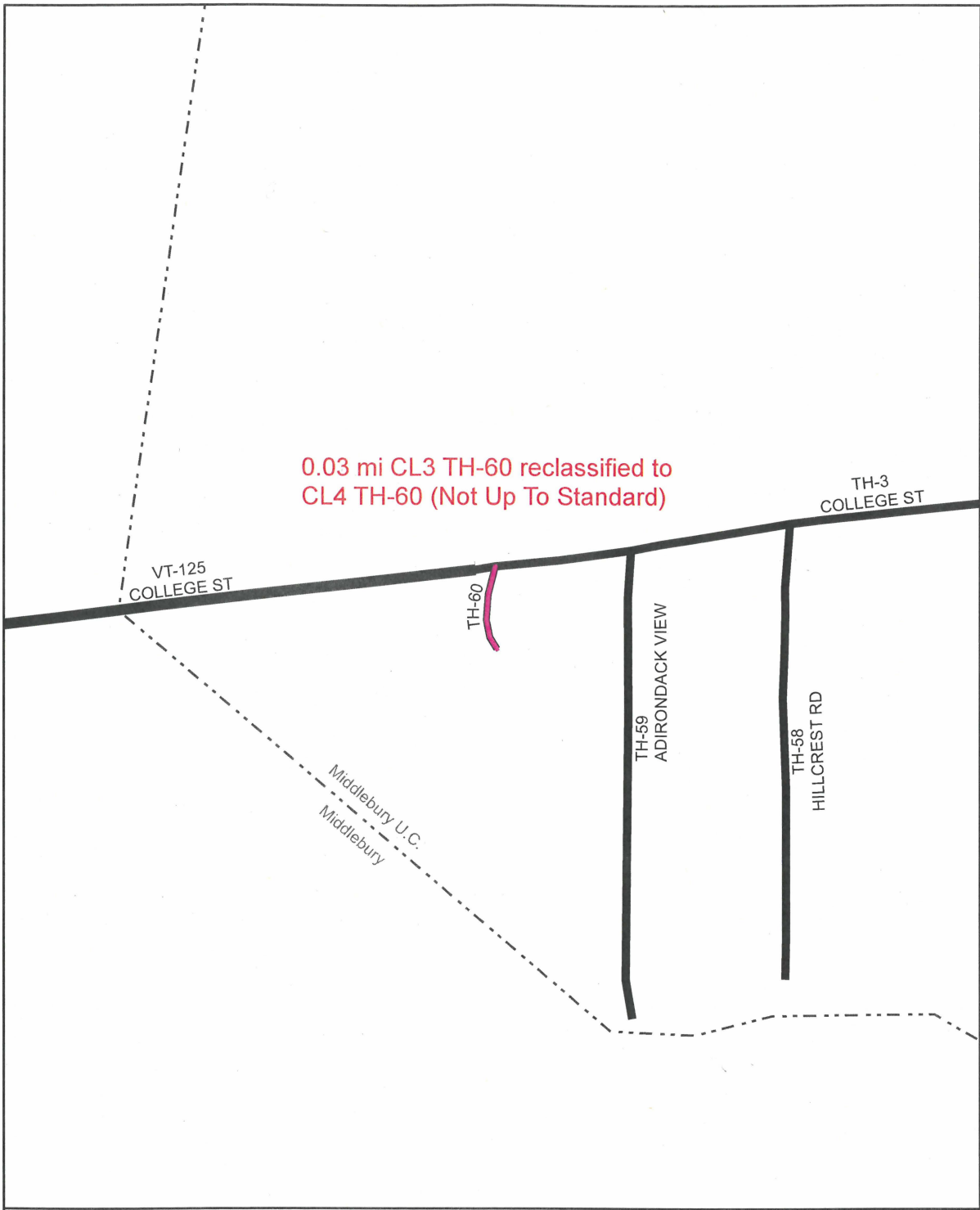

**Mileage Certificate Change 2012
MIDDLEBURY**

Mapping Unit
Division of Policy and Planning
Vermont Agency of Transportation -- April 2012

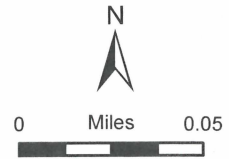

Moulton, Sara

From: Moulton, Sara
Sent: Tuesday, February 21, 2012 1:30 PM
To: 'Fred Dunnington'
Cc: Kevin Behm; Bill Finger; Daniel Werner
Subject: RE: Middlebury 2012 Highway Mileage Certificate
Attachments: Middlebury_TH20.jpg

I've updated the surface types for the various segments as noted on the maps and I've corrected the distance of the arcs for TH-113 and TH-99.

TH-20 (see attached jpg)

The 0.96-mile segment of TH-20 that is noted as "All Class 4" is already Class 4. The difference in the road centerline symbols is to note the difference in surface type. Based on the orthophotos, the road surface types of these two sections look quite different. The eastern section looks like it is at least graded earth if not better. The western section looks either unimproved or untravelled.

TH-60

My supervisor (Johnathan Croft) suggests that the Mapping Unit reclassify this highway as Class 4 Not Up To Standard for this year since you state that the Town does not plow or maintain it as a Class 3 town highway. The Town can then decide what formal action it wants to take in regard to the permanent status of this road.

Please let me know if you have any questions.

Sara Moulton, GISP
Mapping & GIS Specialist, Mapping Unit
Division of Policy and Planning
Vermont Agency of Transportation (VTrans)
Tel: 802-828-2109

-----Original Message-----

From: Fred Dunnington [<mailto:fdunnington@TownOfMiddlebury.org>]
Sent: Tuesday, February 21, 2012 9:04 AM
To: Moulton, Sara
Cc: Kevin Behm; Bill Finger; Daniel Werner
Subject: Middlebury 2012 Highway Mileage Certificate

Sara -

Attached is Middlebury's 2012 Highway Mileage Certificate, a hard copy of which is in the mail to you.

Call me if there are questions.

Thanks,

Fred
Fred S. Dunnington
Middlebury Town Planner
(802) 388-8100 x 208

Middlebury
rdsmall 2/21/2012
pdpv 4/10/2012
THDATA 4/10/2012
sum map 4/10/2012

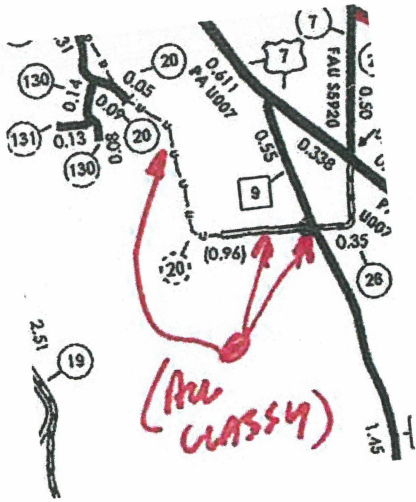

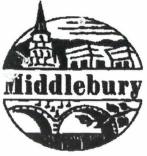

Town of Middlebury Vermont

94 Main Street, Middlebury VT 05753

Town Website: <http://www.middlebury.govoffice.com>

Information
388-8100

Town Clerk
388-8100 x 211

Town Manager
388-8100 x 200

Recreation
388-8100 x 205

Listers Office
388-8100 x207

Planning/Zoning
388-8100 x 208

Accounting
388-8100 x 203

Water Billing
388-8100 x 207

Ass't Town /Business
Manager
388-8100 x 201

Public Works
388-4045

Wastewater Plant
388-0498

Police
Non-Emergency
388-3191
Emergency 911

FAX
388-4364

Sara Moulton
Mapping & GIS Specialist
VT Agency of Transportation
One National Life Drive
Montpelier VT 05633-5001

Re: Middlebury 2012 Certificate of Highway Mileage

Dear Ms. Moulton:

On behalf of the Middlebury Select Board and Town Manager, enclosed is our 2012 Certificate of Highway Mileage.

There are no new highways to add, nor any other SelectBoard actions altering the status of any Town Highways during this past year.

Enclosed are copies of the highway maps on which I have marked some things in red. Most of these are merely map drafting corrections that do not affect the mileage certificate, but correct what is paved vs shown as gravel/dirt.

I did notice that a change had appeared on you map of Boardman St., showing it connecting between TH 113 and TH 99. This connecting segment will some day be a future Town street, but it is not so yet. The mileages of TH 99 and 113 are correct and it should be shown as on earlier maps (a 2003 one is enclosed and marked to illustrate it - it should be shown the same as 2003. The center segment is gravel and is physically blocked to vehicular travel at the west end (east end of TH 113).

Finally, I also noticed that a tiny "street" TH 60 , off College St VT 125. The Town does not actually plow or maintain this - it is a College house driveway. Apparently this has been on the maps for many years. I suppose there should be some formal action of the Select Board to alter its classification or throw it up to the College. Please advise as to what should be done for this year (maybe subtract 0.03 class 3 miles and add 0.03 miles to provisional class 4 status?)

I copied the attachments and gave them to Kevin Behm at ACRPC as well so he could correct his GIS maps. Please don't hesitate to call me at 388-81200 x208 or email at fdunnington@townofmiddlebury.org if you have any questions.

Sincerely,

Fred S. Dunnington
Middlebury Town Planner

Cc: Bill Finger, Town Manager
Ann Webster, Town Clerk

February 17, 2012



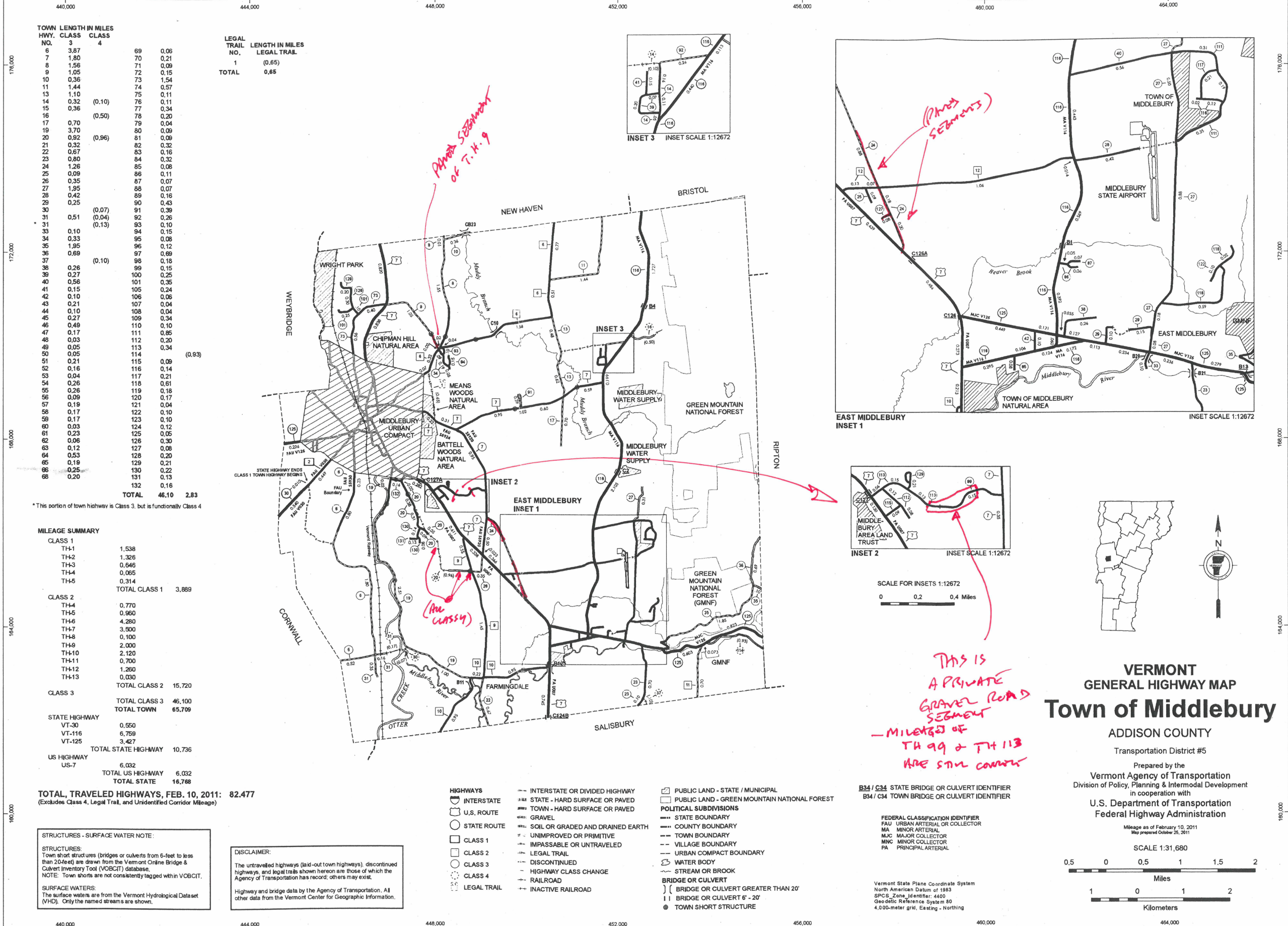

TOWN HWY. NO.	LENGTH IN MILES	LEGAL TRAIL NO.	LENGTH IN MILES
6	3.87	69	0.06
7	1.80	70	0.21
8	1.56	71	0.09
9	1.05	72	0.15
10	0.36	73	1.54
11	1.44	74	0.57
13	1.10	75	0.11
14	0.32	76	0.11
15	0.36	77	0.34
16	(0.50)	78	0.20
17	0.70	79	0.04
19	3.70	80	0.09
20	0.92	81	0.09
21	0.32	82	0.32
22	0.67	83	0.16
23	0.80	84	0.32
24	1.26	85	0.08
25	0.09	86	0.11
26	0.35	87	0.07
27	1.95	88	0.07
28	0.42	89	0.19
29	0.25	90	0.49
30	(0.07)	91	0.39
31	0.51	92	0.26
31	(0.13)	93	0.10
33	0.10	94	0.15
34	0.33	95	0.08
35	1.95	96	0.12
36	0.69	97	0.89
37	(0.10)	98	0.18
38	0.26	99	0.15
39	0.27	100	0.25
40	0.56	101	0.35
41	0.15	105	0.24
42	0.10	106	0.08
43	0.21	107	0.04
44	0.10	108	0.04
45	0.27	109	0.34
46	0.49	110	0.10
47	0.17	111	0.85
48	0.03	112	0.20
49	0.05	113	0.34
50	0.05	114	(0.93)
51	0.21	115	0.09
52	0.16	116	0.14
53	0.04	117	0.21
54	0.26	118	0.61
55	0.26	119	0.18
56	0.09	120	0.17
57	0.19	121	0.04
58	0.17	122	0.10
59	0.17	123	0.10
60	0.03	124	0.12
61	0.23	125	0.05
62	0.06	126	0.30
63	0.15	127	0.09
64	0.53	128	0.20
65	0.19	129	0.21
66	0.25	130	0.22
68	0.20	131	0.13
		132	0.16
	TOTAL	46.10	2.83

*This portion of town highway is Class 3, but is functionally Class 4

MILEAGE SUMMARY	
CLASS 1	
TH-1	1.538
TH-2	1.326
TH-3	0.646
TH-4	0.065
TH-5	0.314
TOTAL CLASS 1	3.889
CLASS 2	
TH-4	0.770
TH-5	0.960
TH-6	4.280
TH-7	3.500
TH-8	0.100
TH-9	2.000
TH-10	2.120
TH-11	0.700
TH-12	1.260
TH-13	0.030
TOTAL CLASS 2	15.720
CLASS 3	
TOTAL CLASS 3	46.100
TOTAL TOWN	65.709
STATE HIGHWAY	
VT-30	0.550
VT-116	6.759
VT-125	3.427
TOTAL STATE HIGHWAY	10.736
US HIGHWAY	
US-7	6.032
TOTAL US HIGHWAY	6.032
TOTAL STATE	16.768

TOTAL, TRAVELED HIGHWAYS, FEB. 10, 2011: 82.477
 (Excludes Class 4, Legal Trail, and Unidentified Corridor Mileage)

STRUCTURES - SURFACE WATER NOTE:
STRUCTURES:
 Town short structures (bridges or culverts from 6-feet to less than 20-feet) are drawn from the Vermont Online Bridge & Culvert Inventory Tool (VOBCIT) database.
 NOTE: Town shorts are not consistently tagged within VOBCIT.

SURFACE WATERS:
 The surface waters are from the Vermont Hydrological Dataset (VHD). Only the named streams are shown.

DISCLAIMER:
 The untraveled highways (laid-out town highways), discontinued highways, and legal trails shown herein are those of which the Agency of Transportation has record; others may exist.

Highway and bridge data by the Agency of Transportation. All other data from the Vermont Center for Geographic Information.

- | | | | |
|---|---|---|--|
| HIGHWAYS
INTERSTATE
U.S. ROUTE
STATE ROUTE
CLASS 1
CLASS 2
CLASS 3
CLASS 4
LEGAL TRAIL | INTERSTATE OR DIVIDED HIGHWAY
STATE - HARD SURFACE OR PAVED
TOWN - HARD SURFACE OR PAVED
GRAVEL
SOIL OR GRADED AND DRAINED EARTH
UNIMPROVED OR PRIMITIVE
IMPASSABLE OR UNTRAVELED
LEGAL TRAIL
DISCONTINUED
HIGHWAY CLASS CHANGE
RAILROAD
INACTIVE RAILROAD | PUBLIC LAND - STATE / MUNICIPAL
PUBLIC LAND - GREEN MOUNTAIN NATIONAL FOREST
POLITICAL SUBDIVISIONS
STATE BOUNDARY
COUNTY BOUNDARY
TOWN BOUNDARY
VILLAGE BOUNDARY
URBAN COMPACT BOUNDARY
WATER BODY
STREAM OR BROOK
BRIDGE OR CULVERT
BRIDGE OR CULVERT GREATER THAN 20'
BRIDGE OR CULVERT 6' - 20'
TOWN SHORT STRUCTURE | B34 / C34 STATE BRIDGE OR CULVERT IDENTIFIER
B34 / C34 TOWN BRIDGE OR CULVERT IDENTIFIER
FEDERAL CLASSIFICATION IDENTIFIER
FAU URBAN ARTERIAL OR COLLECTOR
MA MINOR ARTERIAL
MLC MAJOR COLLECTOR
MNC MINOR COLLECTOR
PA PRINCIPAL ARTERIAL |
|---|---|---|--|

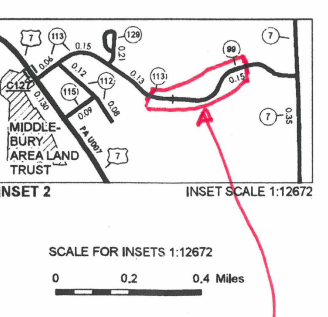

This is a private gravel road segment - mileage of TH 99 & TH 113 are still correct

SCALE FOR INSETS 1:12672
 0 0.2 0.4 Miles

Vermont State Plane Coordinate System
 North American Datum of 1983
 SPCS Zone Identifier: 4400
 Geodetic Reference System 80
 4,000-meter grid, Easting - Northing

VERMONT GENERAL HIGHWAY MAP
Town of Middlebury
 ADDISON COUNTY
 Transportation District #5
 Prepared by the Vermont Agency of Transportation
 Division of Policy, Planning & Intermodal Development
 in cooperation with U.S. Department of Transportation
 Federal Highway Administration
 Mileage as of February 10, 2011
 Map prepared October 25, 2011

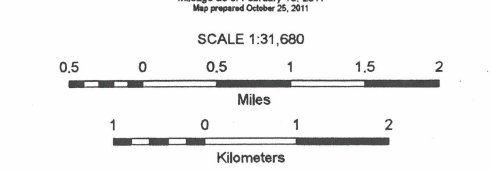

F. Dunnington 2/1/2012

TOWN HWY. NO.	LENGTH IN MILES CLASS 3	CLASS 4	TOTAL
6	0.52	72	0.15
15	0.36	73	0.58
19	0.17	74	0.57
20	0.07	75	0.11
21	0.32	76	0.11
43	0.21	77	0.34
44	0.10	78	0.20
45	0.27	79	0.04
46	0.49	80	0.09
47	0.17	81	0.09
48	0.03	82	0.32
49	0.05	83	0.16
50	0.05	84	0.32
51	0.21	88	0.07
52	0.16	89	0.16
53	0.04	90	0.43
54	0.26	95	0.08
55	0.26	96	0.12
56	0.09	97	0.69
57	0.19	98	0.18
58	0.17	100	0.25
59	0.17	105	0.24
60	0.03	106	0.06
61	0.23	107	0.04
62	0.06	108	0.04
63	0.12	109	0.34
64	0.53	110	0.10
65	0.19	119	0.18
66	0.25	120	0.17
68	0.20	121	0.04
69	0.06	123	0.10
70	0.21	124	0.12
71	0.09	125	0.05
TOTAL		12.87	

MILEAGE SUMMARY

CLASS 1	
TH-1	1.538
TH-2	0.877
TH-3	0.646
TH-4	0.965
TH-5	0.314
TOTAL CLASS 1	3.440
CLASS 2	
TH-4	0.770
TH-5	0.960
TH-6	0.950
TH-7	0.810
TH-8	0.100
TH-13	0.030
TOTAL CLASS 2	3.620
CLASS 3	
TOTAL CLASS 3	12.870
TOTAL TOWN	19.930
STATE HIGHWAY	
VT-125	0.108
TOTAL STATE HIGHWAY	0.108
US HIGHWAY	
US-7	0.470
TOTAL US HIGHWAY	0.470
TOTAL STATE	0.578

TOTAL, TRAVELED HIGHWAYS, FEB. 10, 2011: 20.508
(Excludes Class 4, Legal Trail, and Undertied Corridor Mileage)

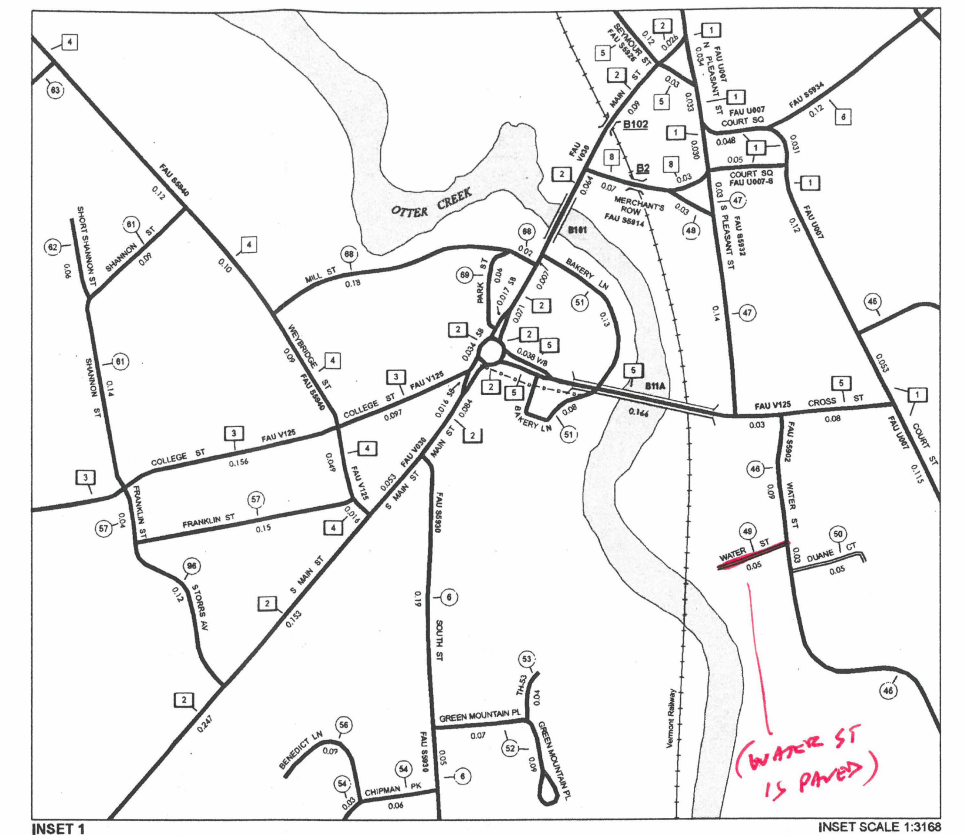
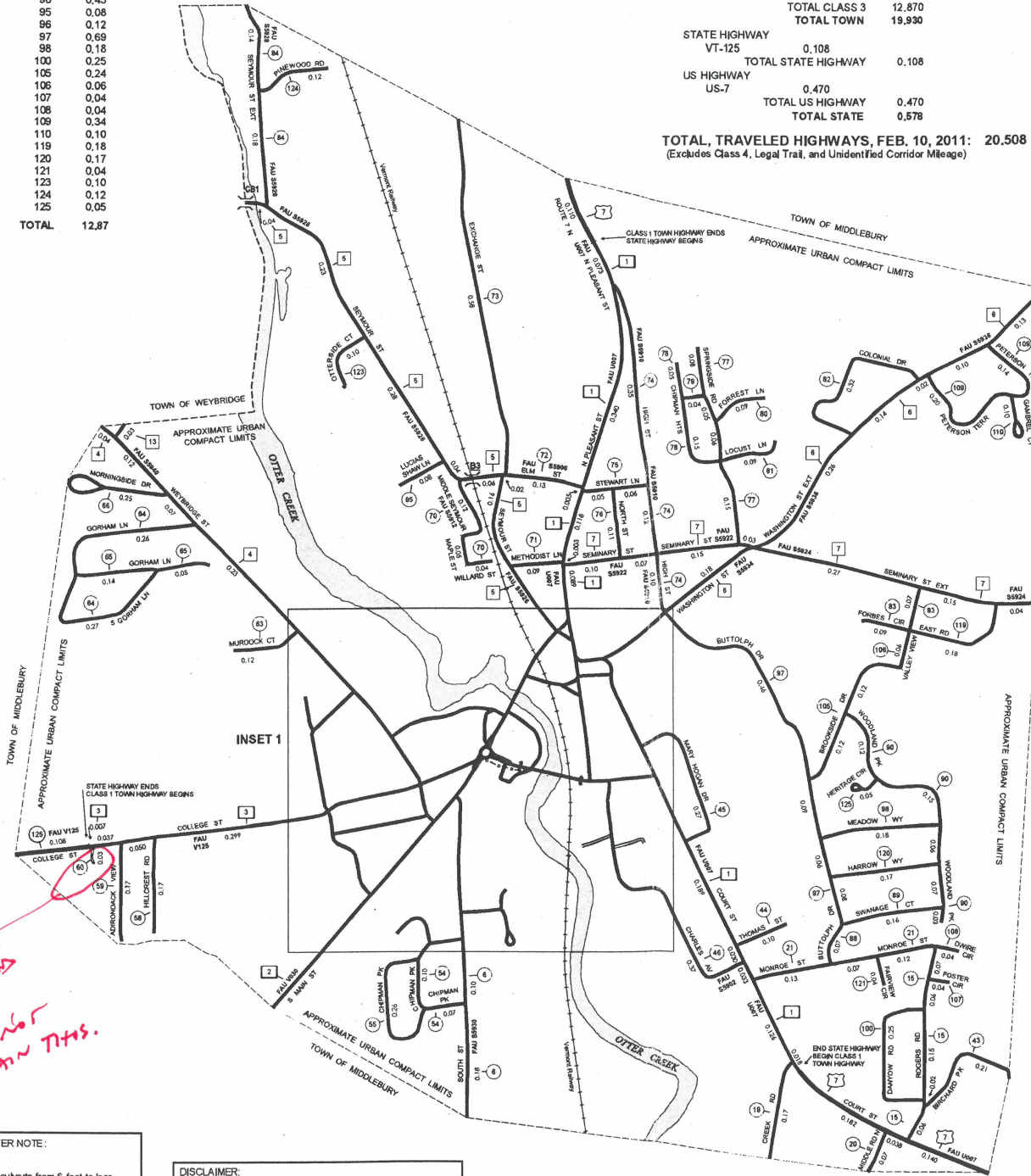

- HIGHWAYS**
- INTERSTATE OR DIVIDED HIGHWAY
 - STATE - HARD SURFACE OR PAVED
 - TOWN - HARD SURFACE OR PAVED
 - GRAVEL
 - SOIL OR GRADED AND DRAINED EARTH
 - UNIMPROVED OR PRIMITIVE
 - IMPASSABLE OR UNTRAVELED
 - LEGAL TRAIL
 - DISCONTINUED
 - HIGHWAY CLASS CHANGE
 - RAILROAD
 - INACTIVE RAILROAD
- PUBLIC LAND**
- POLITICAL SUBDIVISIONS
 - STATE BOUNDARY
 - COUNTY BOUNDARY
 - TOWN BOUNDARY
 - VILLAGE BOUNDARY
 - URBAN COMPACT BOUNDARY
 - WATER BODY
 - STREAM OR BROOK
- BRIDGE OR CULVERT**
- BRIDGE OR CULVERT GREATER THAN 20'
 - BRIDGE OR CULVERT 6' - 20'
 - TOWN SHORT STRUCTURE
- B34 / C34 STATE BRIDGE OR CULVERT IDENTIFIER**
- B34 / C34 TOWN BRIDGE OR CULVERT IDENTIFIER**
- FEDERAL CLASSIFICATION IDENTIFIER**
- FAU URBAN ARTERIAL OR COLLECTOR
 - MA MINOR ARTERIAL
 - MJC MAJOR COLLECTOR
 - MNC MINOR COLLECTOR
 - PA PRINCIPAL ARTERIAL

THIS IS MAINTAINED AS A PRIVATE ROAD (CONCRETE) - TOWN DOES NOT MAINTAIN THIS.

STRUCTURES - SURFACE WATER NOTE:

STRUCTURES:
Town short structures (bridges or culverts from 6-feet to less than 20-feet) are drawn from the Vermont Online Bridge & Culvert Inventory Tool (VOBCIT) database.
NOTE: Town shorts are not consistently tagged within VOBCIT.

SURFACE WATERS:
The surface waters are from the Vermont Hydrological Dataset (VHD). Only the named streams are shown.

DISCLAIMER:

The untraveled highways (laid-out town highways), discontinued highways, and legal trails shown herein are those of which the Agency of Transportation has record; others may exist.

Highway and bridge data by the Agency of Transportation. All other data from the Vermont Center for Geographic Information.

Vermont State Plane Coordinate System
North American Datum of 1983
SPCS_Zone_Identifier: 4400
Geodetic Reference System: 80
2,000-meter grid, Easting - Northing

VERMONT GENERAL HIGHWAY MAP
Urban Compact of Middlebury

ADDISON COUNTY
Transportation District #5

Prepared by the
Vermont Agency of Transportation
Division of Policy, Planning & Intermodal Development
in cooperation with
U.S. Department of Transportation
Federal Highway Administration

Mileage as of February 10, 2011
Map prepared October 26, 2011

SCALE 1:6,336

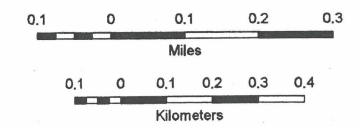

F. Dunnington 2/1/2012

