

ANCIENT ROAD DOCUMENTATION THAT SHOULD BE INCLUDED WITH THE CERTIFICATE OF HIGHWAY MILEAGE

A Copy of the Original Document Recording the Laying Out of the Road

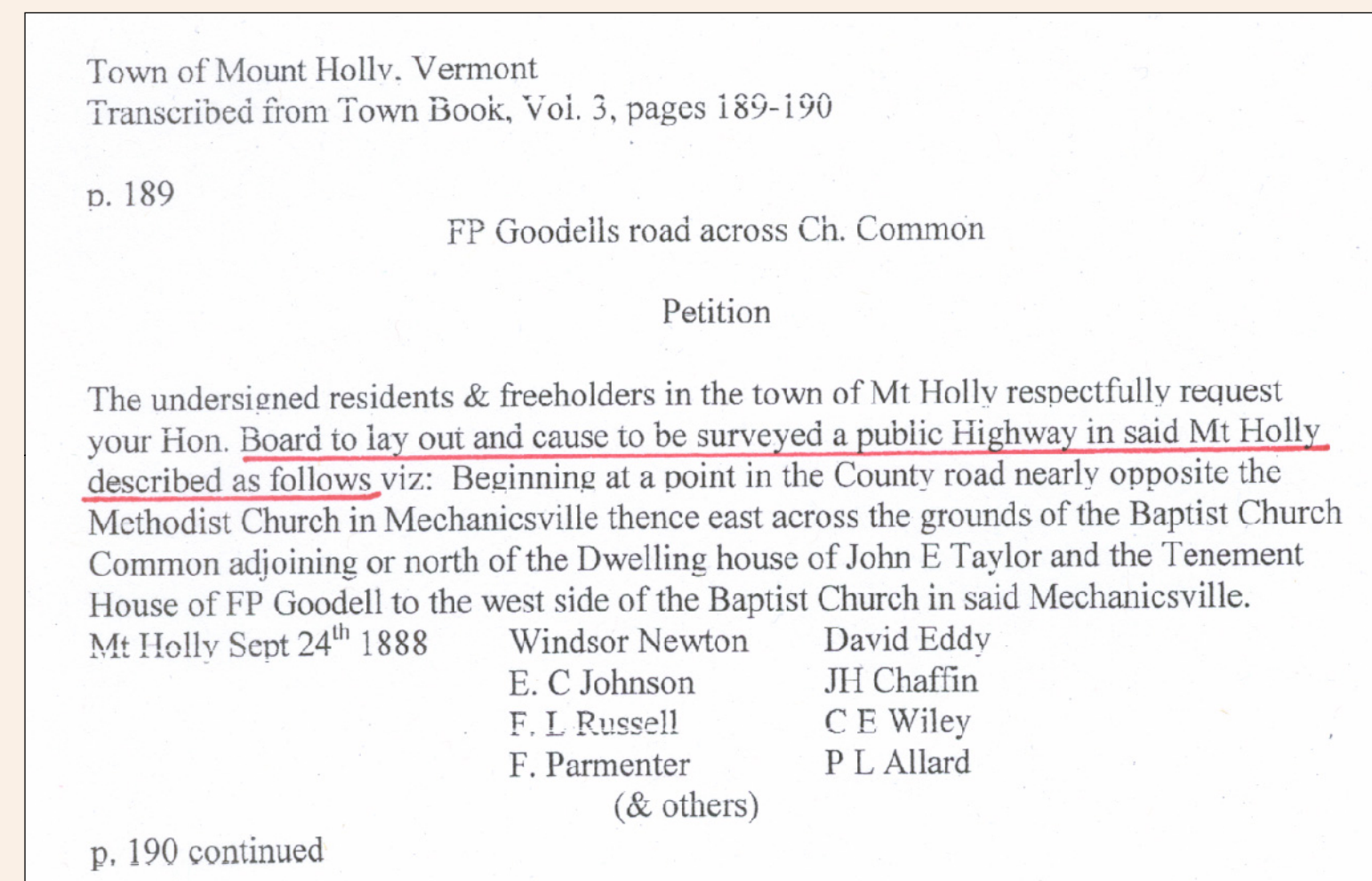
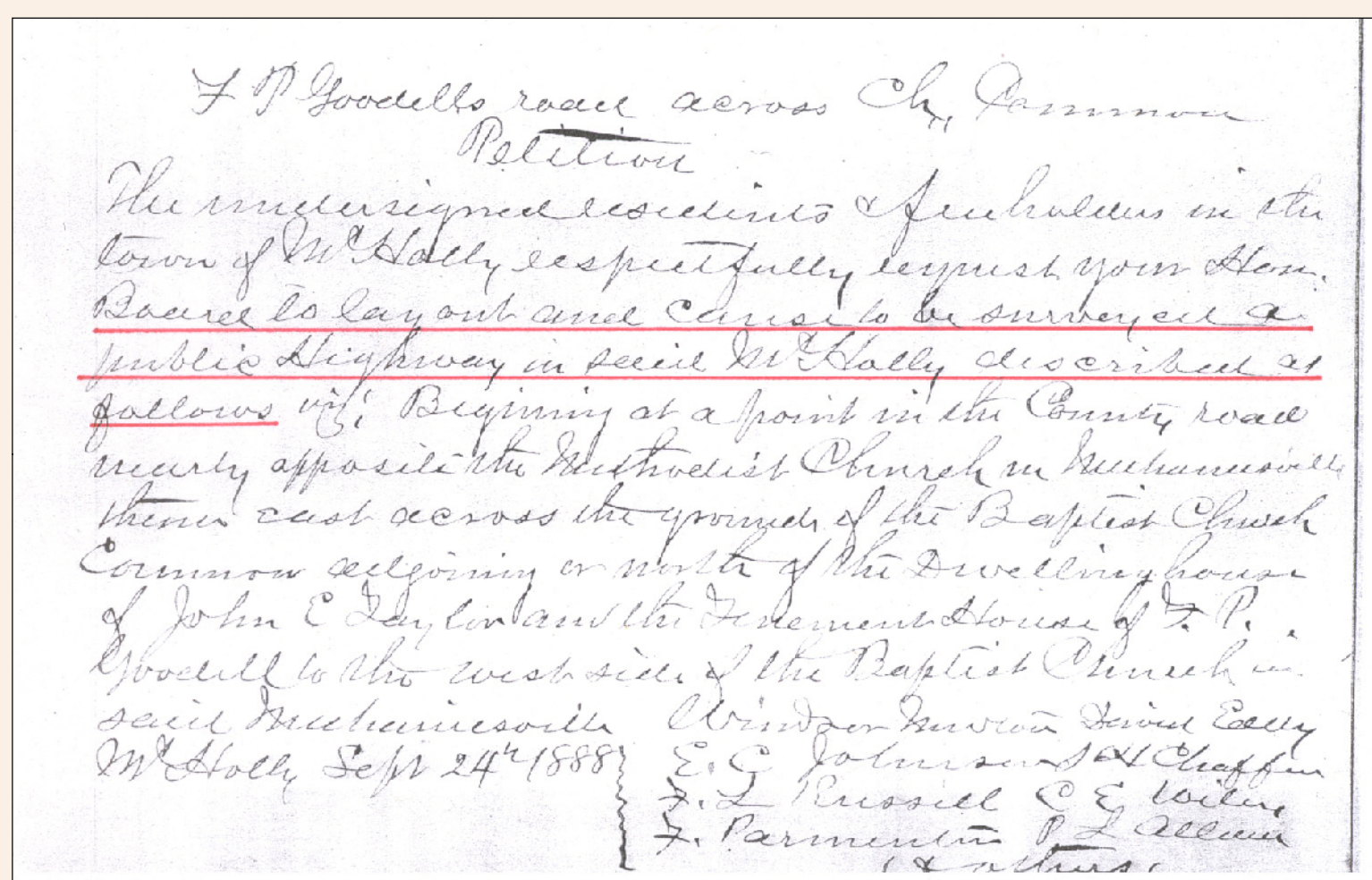

If the original is difficult to read, please include a transcription.

Translate into modern references where the road is located.

If the description is something like:

"the highway commences at a point 3 rods and 15 links from the N.W. corner of the barn of Levi Moore ...",

VTrans will be unable to map that unless it is translated into modern references.

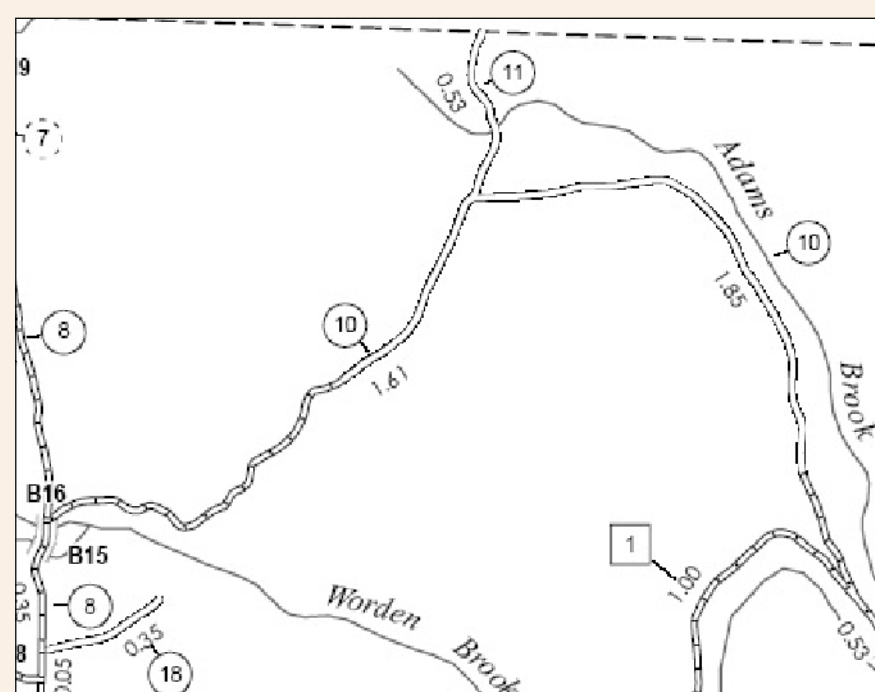

An example of a modern reference:
the road starts at a point 500 feet south of the intersection of TH-10 (Sample Hill Rd) and TH-11 (Another Rd) ...

Submit evidence that the addition was addressed and approved by the current selectboard.

Include a copy of the selectboard minutes of the meetings at which the selectboard took action on the road.

"Observable and Used" or "Unobservable and Unused"

Although it is not required, it is helpful to have it noted somewhere in the proceedings whether the ancient road to be added is "observable and used" or "unobservable and unused."

Questions? Call 802-828-2600